

# Flambeau River State Forest and other State Lands Sustainable Forestry Timber Sales

Includes sales from  
Flambeau River State Forest – 8 sales  
Kimberly Clark Wildlife Area – 1 sale  
Tuscobia State Trail – 1 sale  
Pershing Wildlife Area – 2 sales  
Sawyer County State Lands – 3 sales

## November 11, 2014



# Flambeau River State Forest Sale Locator Map

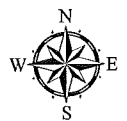
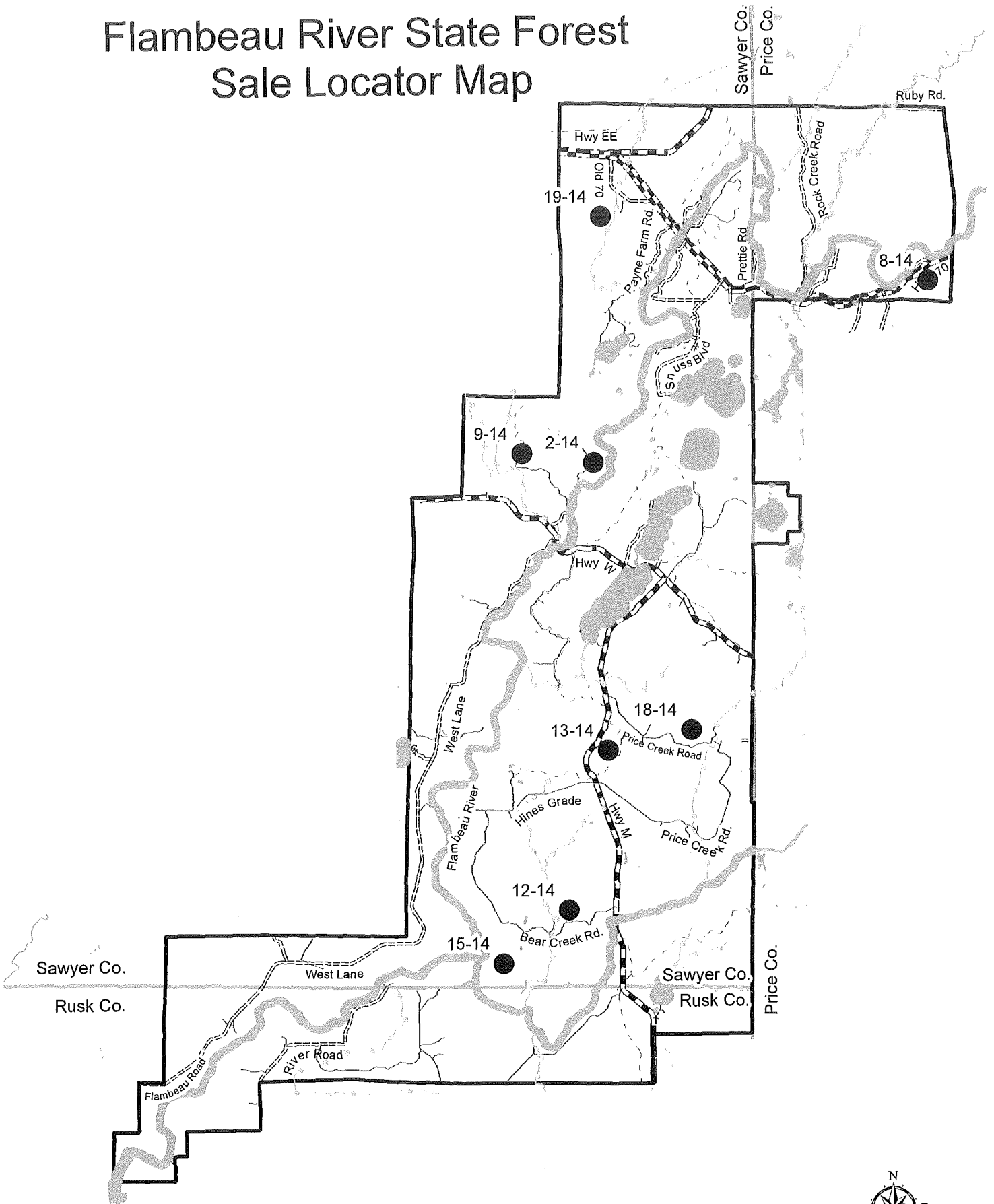

**2014 NOVEMBER TIMBER SALES**  
**FLAMBEAU RIVER STATE FOREST**  
W1613 COUNTY ROAD W  
WINTER, WI 54896  
(715) 332-5271

Sealed bids for sales in this packet will be received by the Wisconsin Department of Natural Resources, Flambeau River State Forest, at the Flambeau Forest Headquarters, Winter, Wisconsin until **1:30 p.m. on November 11, 2014** and publicly opened immediately thereafter for timber stumpage on the Flambeau River State Forest and other state lands. Sealed bids for the other state lands should also be received at the Flambeau Forest Headquarters. Sealed bids for sales not sold on November 11<sup>th</sup> will be received at the Flambeau Forest Headquarters until **1:30 p.m. on December 12, 2014.**

**NO BID BOND REQUIRED. See Condition #8 under Bidding and Finance.**

For inspection of Flambeau River State Forest timber sales for bidding, ATVs will be permitted.

The sales on the Flambeau River State Forest will use the mill scale ticket system for pulpwood. Sales with saw logs included in the pulp price will also use the mill scale ticket system.

The contractor shall notify a DNR Forester or Forest Technician 3 days prior to beginning work on sale. Before work begins on sale, contractors will be required to have a pre-sale meeting with either a Forest Technician or a Forester.

**The State does not plow snow on state forest roads.** If a sale is located on a state forest road, the contractor is responsible for plowing the snow. The following are state forest roads: Tower Hill, Bass Lake, Price Creek, Hines Grade, Bear Creek, Skinner Creek, and Hervas.

**Operational Trees**

If an operational tree(s) is(are) cut, the contractor is required to contact the Forester either by leaving a message at the office or by leaving a note in the lock box the day the operational tree(s) is(are) cut.

**Forest Certification**

The sales in this packet are certified to the standards of the Forest Stewardship Council (FSC) – Certificate #SCS-FM/COC-00070N and the Sustainable Forestry Initiative (SFI) – Certificate #NSF-1Y941-SF7. Forest products from these sales may be delivered to the mill as “FSC and/or SFI certified” so long as the contractor hauling the forest products is chain-of-custody (COC) certified or covered under a COC certificate from the destination mill. The purchaser is responsible for maintaining COC after leaving the sale area.



***All tracts in this packet meet Forest Certification.***

**TRAINING REQUIREMENT**

The purchaser shall ensure that the actual logging contractor engaged in performance of this contract complies with the Wisconsin SFI (Sustainable Forestry Initiative) Training Standard as adopted by the Wisconsin SFI Implementation Committee (SCI). Criteria for the standard can be found at the website [www.fistausa.org/sfi\\_standards](http://www.fistausa.org/sfi_standards) or by contacting the Forest Industry Safety & Training Alliance (FISTA). Purchaser agrees to provide documentation to Seller that the training has been attained prior to initiating sale.

**SOIL DISTURBANCE AND RUTTING**

- a. The Purchaser agrees to take all steps and precautions to avoid and minimize soil disturbances, such as soil compaction and rutting. If soil disturbances occur, the Purchaser agrees to work cooperatively to mitigate and repair any and all instances of soil disturbance.
- b. Excessive soil disturbance (as defined in Table 1) shall not be permitted. Purchaser agrees to contact Seller in the event of an excessive soil disturbance.

*Table 1. Thresholds for soil disturbances.*

<b><u>Timber Sale Infrastructure</u></b>	<b><u>Soil disturbances are excessive if:</u></b>
<i>Roads, Landings, Skid Trails, and General Harvest Area</i>	<ul style="list-style-type: none"> <li>▪ A gully or rut is 6 inches deep or more and is resulting in channelized flow to a wetland, stream, or lake.</li> </ul>
<i>Roads, Landings, and Primary Skid Trails</i>	<ul style="list-style-type: none"> <li>▪ In a riparian management zone (RMZ) or wetland, a gully or rut is 6 inches deep or more and 100 feet long or more.</li> <li>▪ In an upland area (outside of RMZ), a gully or rut is 10 inches deep or more and 66 feet long or more.</li> </ul>
<i>Secondary Skid Trails and General Harvest Area</i>	<ul style="list-style-type: none"> <li>▪ A gully or rut is 6 inches deep or more and 100 feet long or more.</li> </ul>

**Note:** The depth is to be measured from the original soil surface to the bottom of the depression. If individual lug depressions are visible, the depth would be measured to the lesser of the two depths (the "top" of the lug). The length is measured from the start of the "too deep" section to the end of the "too deep" section. Measurements are not cumulative.

- c. Prior to sale completion the Purchaser shall mitigate and repair soil disturbances to the Seller's satisfaction.

For questions on the following properties please contact the person listed:

- Other state lands in Sawyer County** – Jim Kujala (715) 634-9658 ext. 3506
- Kimberly Clark Wildlife Area** – Tom Onchuck (715) 762-1358
- Tuscobia State Trail** – Tom Onchuck (715) 762-1358
- Pershing Wildlife Area** – Scott Lindow (715) 748-4955
- Flambeau River State Forest** – Heidi Brunkow (715) 332-5271 ext. 106

**FLAMBEAU RIVER STATE FOREST  
AND OTHER STATE LANDS  
General Sale Conditions**

**Bidding and Financing**

1. To bid on a tract, each species must be bid on (per cord or MBF) and the minimum total sale value must be met. The advertised value (per cord or MBF) is provided as a reference value only - a bid on each species at its advertised value will automatically meet the minimum total sale value when all species are added together. A bid will be rejected if any individual species/product bid is \$0.
2. A bid must be made on all species and products listed by tract including lump sum sales.
3. All bids must be by tract number and sealed in individual envelopes marked on the outside, Bid on Tract \_\_\_\_.
4. Whole tree (chipping) bids will be adjusted by adding overrun factors to cruised volumes. Notification prior to bidding will be required. Approved areas allowing whole tree logging will be identified along with specific overrun factors to be used. If for any reason the contract is not whole tree harvested, the contractor will pay 25% more than the bid value per species that anticipated whole tree harvest. Whole tree harvest (chipping) includes all wood and bark.
5. All bids will include the following:
  - A. Tract Number
  - B. List of species to be harvested and estimated volume
  - C. Bid price, per unit for each species and product
  - D. Signature and address of each bidder
6. Persons desiring to bid on more than one tract must submit a separate bid for each tract.
7. Bids will be opened in a random order from a draw of the hat. Prior to the reading of a bid, a contractor may elect to withdraw the bid. The contractor or representative of the contractor must declare this at the bid opening before any bids for the specified tract are read.
8. **BID BOND NOT REQUIRED.** Winning bidders will have 6 weeks from the date of the bid opening to submit an acceptable performance bond to the department. If the winning bidder fails to execute the contract and submit an acceptable performance bond, the bidder shall be required to forfeit to the department an amount equal to 10% of the total bid amount. Failure to forfeit the 10% penalty will result in the bidder being considered ineligible to bid on any state timber sales for a two-year period.
9. An Irrevocable Letter of Credit may be used as a Performance Bond. *The expiration date of all letters of credit must be maintained for four full years.* Contact the Forest Headquarters for details regarding the clauses required in the letter.

**Contracts & Extensions**

1. Contracts must be signed and returned to the Flambeau River State Forest or appropriate property within 30 days of the bid letting.
2. All contracts will be issued for a period of two years, unless otherwise noted. It is understood that all contracts are expected to be completed during the initial contract. Extensions are not automatic.
3. Requests for extensions must be submitted prior to the expiration date of the contract. The performance bond may be retained if requests are not submitted by the expiration date.

**Payments**

1. Purchaser agrees to make stumpage payments within 30 days of billing, unless otherwise specified in the payment schedule.
2. Late interest penalty – Purchaser agrees to pay a late interest penalty of 1.5% for every 30 days on past due stumpage in excess of the 30 day period. In addition, failure to pay within the 30 day period will result in the Purchaser having to prepay for the remainder of the sale. Two such payment breaches, even on separate State sales, will also result in the purchaser being required to prepay on all state timber sales for a two-year duration.

### Utilization Specifications

Those sales without an increased utilization option will have the following standards:

Standard Utilization - Unless otherwise specified, standard specifications will be as follows:

Aspen pulpwood	4" top diameter
Hardwood pulpwood	4" top diameter
Softwood pulpwood	4" top diameter
Hardwood sawlogs	10" top diameter inside bark
Softwood sawlogs	8" top diameter, inside bark

Merchantable trees are those that have one or more 100 inch pulpwood sticks with a minimum top diameter of four inches.

### Cutting and Skidding Specifications

1. All timber marked or designated for cutting will be utilized whether or not the quantity is more or less than the estimated volume.
2. All decking must be done on the sale if it is not specifically designated. Permission to do otherwise must be obtained from the Forest Superintendent.
3. Any young growth bent or held down by felled trees must be promptly released.
4. The Department of Natural Resources reserves the right to stop operations if unreasonable, excessive, or avoidable damage occurs or will occur. The contractor may be held responsible to repair any or all damage.
5. Although summer logging may be permitted, during wet periods the soils may become soft and susceptible to rutting. Soils may become too wet after storms and extended wet spells. Operations will be suspended during these periods.
6. The Department of Natural Resources may change, suspend or terminate any timber sale contract or portion of contract with no penalties to the State if errors in timber sale planning or designing cause or may cause serious environmental damage, or may cause aesthetic concerns, or are not sound silvicultural practices, or violate any county, state, or federal law or regulation.
7. Any bole damage to residual trees will be considered unnecessary.
8. Trees that are marked with an "X" are not to be cut. They are leave trees. All snags will be reserved unless a safety concern, then the snags will be cut and left for coarse woody debris.
9. **Extra caution is needed to avoid damaging existing pockets of regeneration throughout select cut sale areas.** These pockets of regeneration should not have trees felled into them or skid trails run through them.
10. If collecting firewood for home, a firewood permit is required. **A permit is also required for collection of burls.**

### Slash Requirements

1. All slash requirements will be done concurrent with sale operations. For town roads, state forest roads, hunter/walker trails, and ATV/snowmobile trails, all slash and ends will be removed from the roads and ditches concurrently with each truckload.
2. No slash piles from landing operations may be left over 24" above the ground level. Piles shall be spread over the site before leaving.
3. Slash disposal will comply with the State Slash Law, Section 26.12(b), Wisconsin Statutes, and with requests regarding forest fires prevention and suppression made by the seller.

### Road and Camps

1. The locations of all roads, landings, and camps must be approved by the Forester prior to construction. A DNR Forester must be contacted at least 48 hours in advance for an appointment.
2. The sale area, including all roads and camps, will be kept neat, clean and free of garbage, oil cans, plastic bottles, and miscellaneous trash throughout the contract period. All residues, including oils and fluids, generated may not be buried or burned, but must be removed from the sale area and disposed of properly.
3. Those merchantable trees removed or damaged as a result of approved road building operations will be utilized.
4. All road entrances must be cleaned up of all roots, stumps, and down trees at the time of construction.
5. It will be the responsibility of the contractor to repair any road damage due to logging.
6. Contractor is required to close roads at designated map locations by placing rocks, stumps and/or cull log barriers, approximately 2 feet apart for a distance of 25 feet completely blocking the road.

7. Road approaches to surfaced roads or other government public roads are the responsibility of the Contractor. Damage to these roads is the responsibility of the Contractor.
8. **The State does not plow snow on state forest roads.** If a sale is located on a state forest road, the contractor is responsible for plowing the snow. The following are state forest roads: Tower Hill, Bass Lake, Price Creek, Hines Grade, Bear Creek, Skinner Creek, and Hervas.

**Scaling Specification**

1. All bid species of sawlogs will be scaled as such. Pulpwood products cut longer than 8' may be scaled by the board feet and converted to cords as follows: Softwood - 2.44 cds./MBF and Hardwood - 2.20 cds./MBF.
2. All logs will be scaled with the Scribner Decimal C log rule. All logs will be scaled as sawlogs if 50% sound and meet the requirements of a Grade No. 3 log or better in accordance with the National Forest Scaling Handbook. The minimum diameter for a Grade No. 3 log is 10". The maximum trim allowance is 5" unless contractor can demonstrate that market specifications dictate more trim (ties, veneer, etc.). Logs with excessive trim will be scaled at the next highest foot length.
3. Logs will be decked for scaling on pulpwood stringers with the small ends all one way (towards the road) and separated by log length. Decks will not exceed six feet in height and will be accessible for inspection from both sides of the deck. If separating for bolts, the bolts will be decked with the small ends all one way (towards the road).
4. When sap-peeled pulpwood is scaled, 12.5% will be added to hand peeled and stroke delimeter/processor peeled volume, and 16% will be added to ring debarked volume. Scale ticket must state if the load is a peeled product.
5. The mill scale ticket system will be required for pulp. Contractor is required to deposit a scale ticket in the lock box placed on the sale. These tickets are provided by the State Forest and will be filled out in their entirety. The Contractor is also required to deliver a mill ticket to the mill purchasing the forest product. This mill ticket will be returned to the Flambeau River State Forest along with a copy of the mill's scale. The Contractor is responsible for having these mill tickets and scale slips returned to the Flambeau River State Forest in a timely manner. The mill scale slip that corresponds to the lock box ticket must be received at the Flambeau River State Forest Office within 14 days of hauling.
6. If wood is to be yarded at another location other than the sale area, permission must be granted by Forester.
7. Contractors that are required to prepay must at a minimum purchase 5 or more scale tickets at a time, but it is encouraged that a full booklet of 25 scale tickets be purchased.
8. A mill scale ticket must also be placed in the ticket box for loads of scaled logs.

**Cordwood Weight Conversion Factors**

If a cordwood weight conversion is not provided by the mill purchasing the forest product, the following weight conversion factors will be used in the conversion of weight scale to standard 4' x 4' x 100" cords. Seasoned wood is normally understood to be that which was cut and dried two or more months between April 1 and October 31 before weighing. All other wood should be considered green.

CORDWOOD WEIGHT CONVERSION FACTORS  
POUNDS PER CORD

Species	Weight	Species	Weight
Hemlock	4800	Yellow Birch	5350
Tamarack	4650	Hard Maple	5100
Red Pine	4500	Elm	5000
Jack Pine	4250	Balsam Poplar	4900
Balsam	4250	White Birch	4800
White Pine	4200	Ash	4600
Spruce	4000	Soft Maple	4550
White Oak	5850	Aspen	4500
Red Oak	5500	Basswood	3850
Hickory	5400	<b>Mixed Hardwood</b>	<b>4800</b>

### **Worker's Compensation Law**

The contractor (purchaser) shall provide the Department with a Certificate of Insurance indicating that Worker's Compensation Insurance coverage is provided for all of the contractor's (purchaser's) employees working under the contract during its duration. This shall be in the Department's file prior to any performance under the contract. Such certificates of insurance shall further include the condition that the insurer shall notify the Department at the Flambeau River State Forest Headquarters within five (5) days of any change in its terms or twenty (20) days prior to termination.

### **Seasonal Restrictions**

1. No cutting can be done during the months of April, May, and June in selection harvests or pine thinnings due to bark being more easily damaged at these times, unless special permission is granted.
2. Any wood located within 400' of the Flambeau River shall be removed prior to April 1<sup>st</sup> of each contract year.
3. The State reserves the right to place additional seasonal restrictions on sales as necessary.

### **Township Restrictions**

1. It is the responsibility of the Contractor, to obtain permission from the appropriate Township to deck wood along a town road. Decking on town roads must also be permitted by the forester.
2. All road bans and weight restrictions are the responsibility of the Contractor.

### **General Conditions**

1. All provisions in the contract shall be met before the contract expires. Performance under the contract must proceed in an efficient, workman-like manner, conducive to the orderly completion of the sale. Extensions will only be considered under unusual hardship of circumstances. Details of extension conditions, damage assessments, and other provisions are addressed in the contract which is on file at the Forest Headquarters.
2. Permanent survey monuments shall be left undisturbed. Forest personnel shall be notified if one is encountered during timber sale operations.
3. Extreme caution must be used in sale operations to prevent wildfire. There are requirements outlined in the contract for fire extinguishers and spark arrestors.
4. No skidding, landing, or piling of wood products will take place on the ATV/Snowmobile trail or the State Forest roads without the Forester's approval. The following are State Forest roads: Tower Hill, Bass Lake, Price Creek, Hines Grade, Bear Creek, Skinner Creek, and Hervas. If approval is granted, decking must be at least 10' from the edge of the road or trail.
5. If a snowmobile trail is used for a timber sale operation, 3" of packed snow will be maintained on the snowmobile trail, weather permitting.

The Special Sale Conditions listed for each individual tract and the General Sale Conditions are additions to, or condensations, of a standard timber sale contract that the successful bidder must sign. A sample contract, additional information, maps for each sale, and bid forms may be obtained from the Forest Superintendent, Flambeau River State Forest, W1613, Co. Rd. W, Winter, Wisconsin 54896.

The Department of Natural Resources reserves the right to reject any or all bids.



**Tract (2-14) Big Porky Sale**

Parts of: SW, SENW, NE, Sec. 9; SE of Sec. 4; SWNE, Sec. 10, T38N-R3W of Sawyer County.

Acres 158

---

<u>Species</u>	<u>Estimated Volume</u>	<u>Advertised Value/Unit</u>
<sup>1</sup> Mixed Pulp	1300 cords	30.90
Basswood	170 cords	4.60
Aspen	550 cords	30.90
<sup>2</sup> Fir	200 cords	18.40

Minimum Acceptable  
Bid for Entire Sale  
\$61,627.00

<sup>1</sup>Mixed pulp includes 62% hard maple, 16% red maple, 5% ash, 10% yellow birch, and 7% white birch, ironwood, and cherry combined. Also, contains 7 MBF hard maple, 2 MBF red maple, 2 MBF ash, 2 MBF yellow birch and 2 MBF white birch.

<sup>2</sup>Fir includes approximately 55 cords white spruce and 5 MBF white spruce.

Other species not mentioned will be charged at the mixed pulp price.

The performance bond will be 15% of the total sale value. Contract length is approximately two years.

---

**SPECIAL SALE CONDITIONS:**

1. Equipment use will be restricted to very dry or frozen ground conditions due to wet soil conditions. A majority of the sale area is located within the Flambeau River Scenic Management Area. Harvesting within this area is allowed between October 15<sup>th</sup> and April 1<sup>st</sup> only.
2. No pole length skidding will be allowed in select cut area.
3. Existing woods roads will be used. Improvements will need to be made on several portions of the existing road system. New road construction must be approved by Forester. All wood located within the Flambeau River Scenic Management Area shall be removed prior to April 1<sup>st</sup> of each year. Decking will be permitted along woods roads.
4. No slash or logging debris is allowed in the ditches of the open access road or on the road shared by the private landowner. It is the responsibility of the contractor to keep the ditch lines clear of debris.
5. No slash or logging debris will be left across blue line onto private land.
6. All slash within 100 feet of the open access road shall be lopped and scattered to within 2 feet of ground.
7. 3" of packed snow will be maintained on snowmobile trail, weather permitting. The trail will be kept free of debris. Tepaske Lane is a town road and a snowmobile trail.
8. **All additional restrictions listed in prospectus and standard contract apply unless specified.**

**Tract (2-14) Big Porky Sale**

 **Select Cut Area (105 acres)**- Bounded by red paint, blue paint and open access road. Harvest all orange marked trees within the designated boundaries. Sever all orange marked unmerchantable stems (canopy gaps). Leave, do not cut 1)snags, 2)cull trees, 3)trees marked with an orange X. Cut only marked aspen.

 **Aspen Area (53 acres)**- Bounded by yellow paint, blue paint, and open access road. Cut all trees greater than 2 inches except for: 1)hemlock, 2)white pine, 3)oak, 4)and trees marked with an orange X.

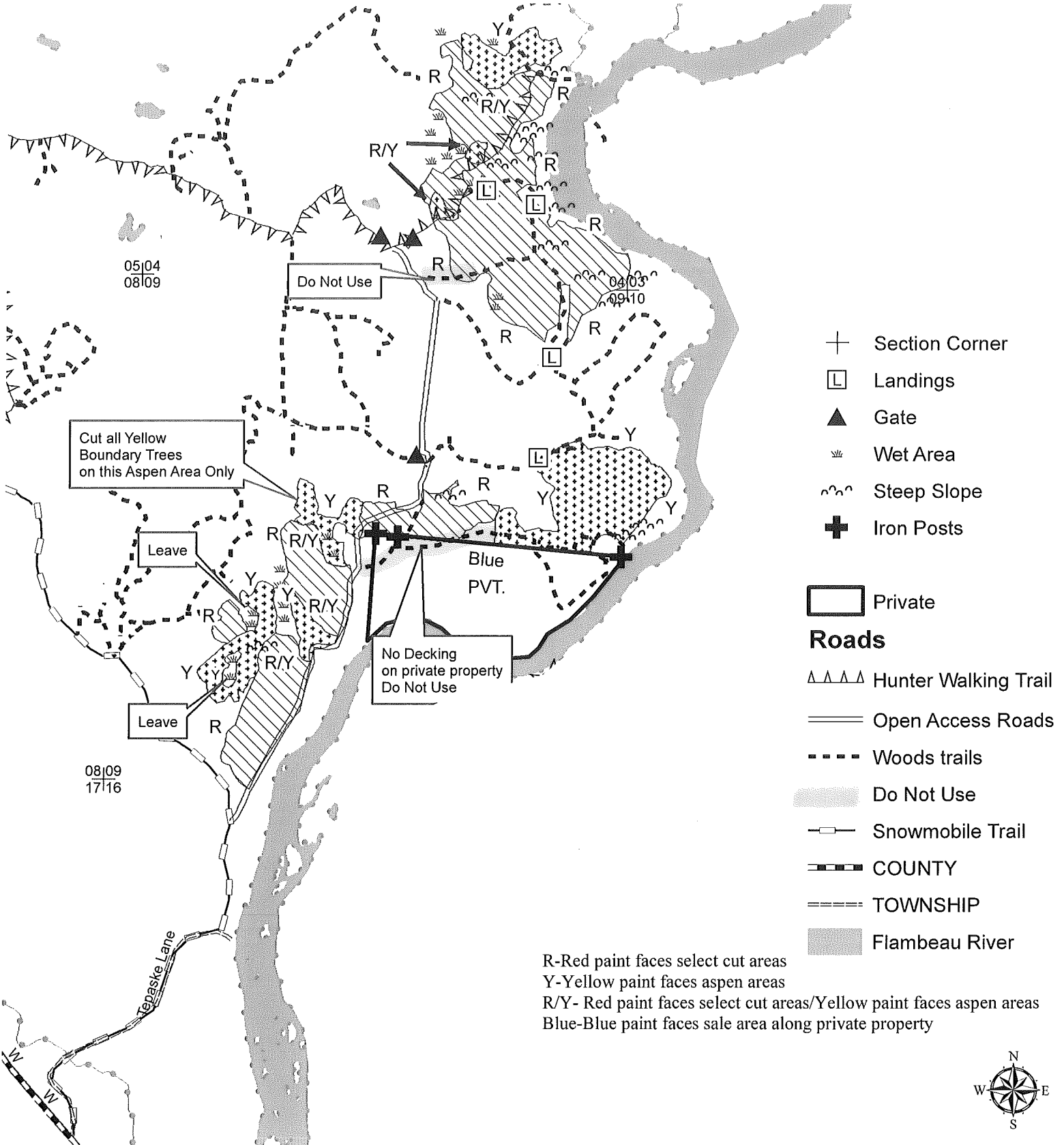

- + Section Corner
- Landings
- ▲ Gate
- ☼ Wet Area
- ⌒ Steep Slope
- ⊕ Iron Posts

- Private
- Roads**
- △△△△ Hunter Walking Trail
- ══ Open Access Roads
- Woods trails
- ▨ Do Not Use
- Snowmobile Trail
- ══ COUNTY
- ==== TOWNSHIP
- ▨ Flambeau River

R-Red paint faces select cut areas  
 Y-Yellow paint faces aspen areas  
 R/Y- Red paint faces select cut areas/Yellow paint faces aspen areas  
 Blue-Blue paint faces sale area along private property

**Tract (8-14) Price Line Dot Com Sale**

Parts of: SESE of Section 21; NW, NE, N1/2SW, SWSW of Section 22; S1/2SW of Section 15, T39N-R2W, Price County.

204 Acres

<u>Species</u>	<u>Estimated Volume</u>	<u>Advertised Value/Unit</u>
<sup>1</sup> Mixed Pulp	1650 cords	23.10
Basswood	80 cords	3.55
Aspen	900 cords	23.10
<sup>2</sup> Fir	300 cords	14.20
Hard Maple	22 MBF	210.00
Red Maple	9 MBF	105.00
Basswood	7 MBF	85.00
<sup>3</sup> Mixed Saw	7 MBF	122.00

Minimum Acceptable

Bid for Entire Sale

\$70,467.00

<sup>1</sup>Mixed pulp includes 59% hard maple, 30% red maple, 6% yellow birch, and 5% ash, white birch, and ironwood combined.

<sup>2</sup>Fir volume includes 97% balsam fir and 3% white spruce (1MBF).

<sup>3</sup>Mixed saw volume includes 3 MBF ash, 3 MBF yellow birch, and 1 MBF white birch.

Other species not mentioned will be charged at the Mixed Saw price.

The performance bond will be 15% of the total sale value. Contract length is approximately three years.

**SPECIAL SALE CONDITIONS:**

1. Entire sale is located within the Flambeau River Scenic Management Area. Within this area harvesting activities are limited to between October 15<sup>th</sup> and April 1<sup>st</sup>.
2. No pole length skidding will be allowed in the select cut areas.
3. Existing woods roads will be used. Improvements will need to be made on several portions of the existing road system. New road may need to be built with permission from the forester. Decking will be permitted along woods roads. No decking of wood will be allowed on private property or on Hwy 70 right of way.
4. No slash or trees shall be left across the blue line. Slash that is within 100 feet of Hwy 70, Old Hwy 70, and the Flambeau River shall be lopped and scattered to within 2 feet of the ground.
5. Contractor is required to close road at the locations designated on the map by placing logging debris, per sale prospectus.
7. Permission to deck wood on Old Hwy 70 must be granted by Town of Flambeau. All logging debris shall be kept off of and out of the ditch lines of Old Hwy 70. If decking is done on Old Hwy 70, all slash and ends will be removed from the road and ditches concurrently with each truck load.
8. Portions of the sale can be accessed through private property. Trees within the opening on private property shall not be damaged. When looking at the sale prior to bid opening, access to sale **MUST be done thru state property only**. Private landowner has specified location of road through his property. No ground disturbance should occur within the private landowners open area. On the east side of 9-mile creek should be a **high speed skid trail**.
9. Access roads through private shall be returned to "as good or better condition." Turnarounds can be constructed within the aspen areas and all wood should be decked from this portion of the sale in the turnaround or along the woods road on state property. No wood or logging debris will be allowed within the opening of the private landowners.
10. Trees within 100 feet of the Flambeau River have been marked on one side facing away from the river. **All conifers** within 100 feet of Hwy 70 right-of-way shall be left and extreme care should be taken not to damage any trees in this area. **No decking** of wood on Hwy 70 right-of-way.
11. **\*Caution** survey monuments within sale area. Do not damage wood posts, iron pipes, or concrete monuments. Located on map with a cross symbol.
12. There is no agreement to use the woods road out of the far west portion of the sale. Wood from this portion of the sale can be skid to a main haul road. A high speed skid road could be built at the location of the proposed road on the map.
13. Access to Aspen Area west of 9-mile creek can go thru private property.
14. **All additional restrictions listed in prospectus and standard contract apply unless specified.**

**Tract (8-14) Price Line Dot Com Sale**

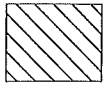

**Select Cut Area (153 acres)** - Bounded by red paint line, blue line, and Hwy 70. Harvest all orange marked trees within the designated boundaries. Sever all orange marked unmerchantable stems (canopy gaps). Cut all ironwood 5 inches and greater and all balsam fir with 2 or more sticks. Leave, do not cut 1)snags 2)cull trees 3) trees marked with an orange X. Cut only marked aspen. Trees within 100 feet of the river have been marked on one side facing away from river.

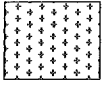

**Red Maple/Aspen Area (51 acres)** - Bounded by yellow paint line and Hwy 70. Cut all trees greater than 2 inches except for: 1) white pine 2) white spruce 3) tamarack 4) oak 5) hemlock 6)red pine.

- Y Yellow paint faces red maple/aspen areas
- G Green paint faces select cut area
- R Red paint faces select cut areas
- Blue or B Blue paint faces sale area along private property
- Leave/Leave Area Grassy opening

- R/Y Red faces select cut area Yellow faces aspen/red maple area
- Y/G Green faces select cut area Yellow faces aspen red maple area
- G/R Green faces select cut area Red faces select cut area



- ◆ \*Caution Survey Monument
- ▲ Gate
- ☹ Wet Area
- Proposed Berm
- ⊕ Section Corner
- Private Property
- Creek
- ×-×-× Proposed Road

**Roads**

- ▬ STATE
- ==== TOWNSHIP
- Open Roads
- - - Woods trails
- ▬ Main Haul Road

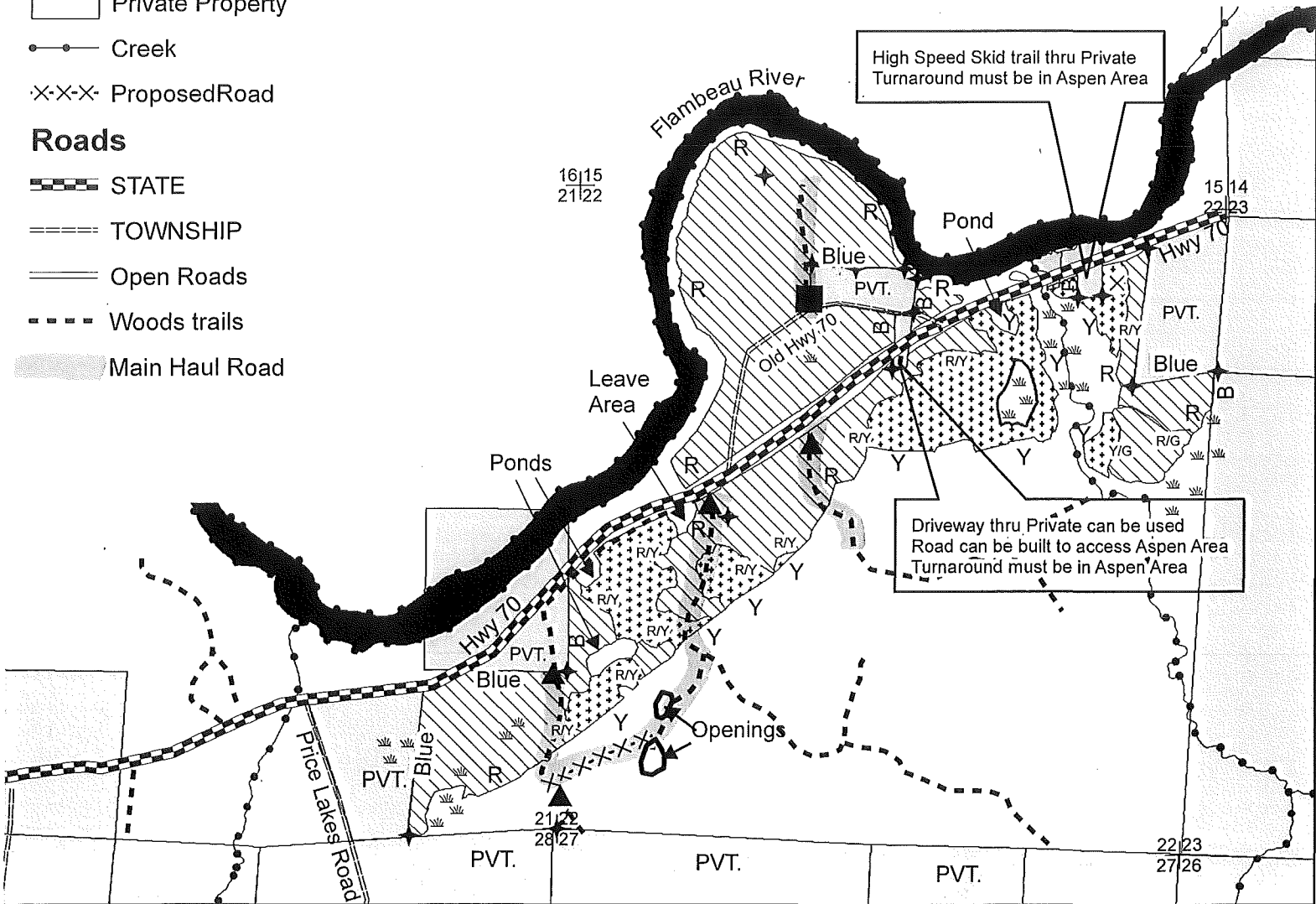

**Tract (9-14) The Flambeeze Sale**

Parts of: SENE of Section 7, NW, NE, NESW, N1/2SE of Section 8,  
and W1/2SW of Section 9, T38N-R3W, Sawyer County.

161 Acres

---

<u>Species</u>	<u>Estimated Volume</u>	<u>Advertised Value/Unit</u>
<sup>1</sup> Mixed Pulp	2800 cords	27.00
Basswood	230 cords	4.20
Aspen	1500 cords	27.00
<sup>2</sup> Spruce	190 cords	18.00
Hard Maple	21 MBF	210.00
Red Maple	8 MBF	105.00
Ash	8 MBF	72.00
Basswood	9 MBF	85.00
<sup>3</sup> Misc. Saw	2 MBF	124.00

Minimum Acceptable  
Bid for Entire Sale  
\$127,325.00

<sup>1</sup>Mixed pulp includes 32% hard maple, 40% red maple, 22% ash, 3% yellow birch, 3% white birch, ironwood, cherry and elm.

<sup>2</sup>Spruce includes 51% balsam fir and 7 MBF of spruce.

<sup>3</sup>Misc. Saw includes 1 MBF yellow birch along with a small amount of white birch and cherry.

Other species not mentioned will be charged at the mixed pulp or Misc. Saw price.

---

The performance bond will be 15% of the total sale value. Contract length is approximately two years.

**SPECIAL SALE CONDITIONS:**

1. Equipment use will be restricted to very dry to frozen ground conditions due to wet soil conditions.
2. No pole length skidding will be allowed in the select cut areas.
3. Existing woods roads will be used, unless designated as proposed road. Improvements will need to be made on several portions of the existing road system. Decking will be permitted along woods roads. No decking of wood will be allowed along the snowmobile trail. Back-ins will be permitted within the Aspen/Red Maple Areas.
4. Contractor is required to close road at the locations designated on the map by placing logging debris, per sale prospectus.
5. 3" of packed snow will be maintained on the snowmobile trail, weather permitting.
6. All logging debris shall be kept off of and out of the ditch lines of the snowmobile trail and the hunter walking trail. If decking near the snowmobile trail or hunter walking trail, all slash and ends will be removed from the road and ditches concurrently with each truck load.
7. **All additional restrictions listed in prospectus and standard contract apply unless specified.**

(Tract 9-14) The Flambeeze Sale

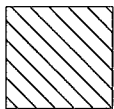

**Select Cut Area (67 acres)** - Bounded by red paint and snowmobile trail. Harvest all orange and blue marked trees within the designated boundaries. Sever all orange marked unmerchantable stems (canopy gaps). Leave, do not cut 1)snags, 2) cull trees, 3) trees marked with an orange X. Cut only marked aspen.

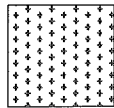

**Aspen/Red Maple Area (94 acres)** - Bounded by yellow paint and snowmobile trail. Cut all trees greater than 2 inches except for: 1) hemlock 2) white pine 3) oak 4) cherry 5) trees marked with an orange X.

R- Red paint faces select cut areas

Y- Yellow paint faces aspen/red maple areas

R/Y- Red paint faces select cut areas/Yellow paint faces aspen/red maple areas

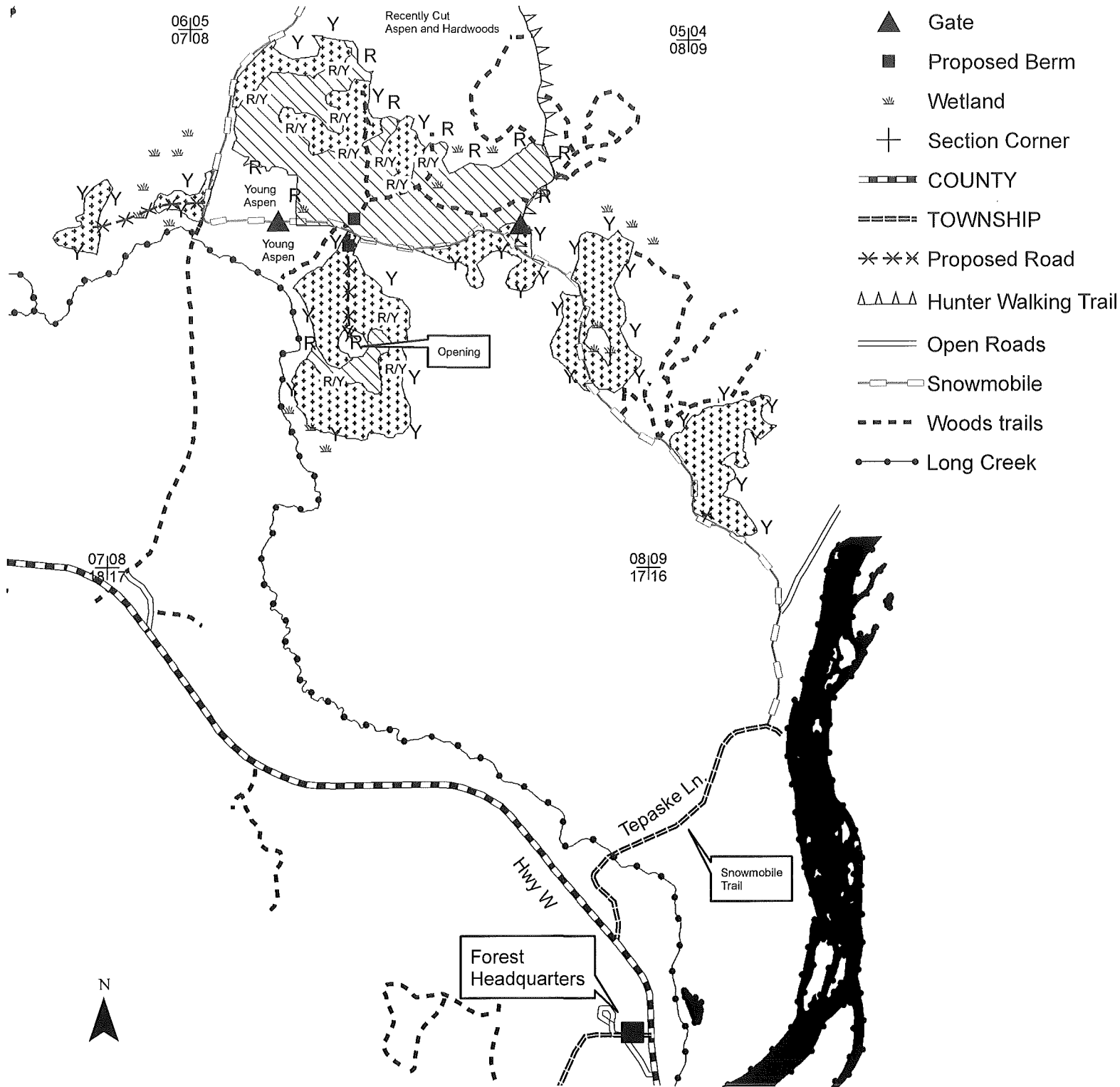

**Tract (12-14) Lone Oak Sale**

Parts of: N1/2SW, S1/2NW, SWSW, W1/2SE of Section 28,  
SESE, SENE of Section 29, T37N-R3W, Sawyer County.

97 Acres

---

<u>Species</u>	<u>Estimated Volume</u>	<u>Advertised Value/Unit</u>
<sup>1</sup> Mixed Pulp	1600 cords	32.40
Spruce	20 cords	12.40
Aspen	130 cords	32.40
Hard Maple	15 MBF	225.00
Red Maple	36 MBF	113.00
<sup>2</sup> Mixed Saw	16 MBF	101.00

Minimum Acceptable  
Bid for Entire Sale  
\$65,359.00

<sup>1</sup>Mixed pulp includes 27% hard maple, 57% red maple, 6% ash, 6% yellow birch, 4% ironwood, cherry, white birch, and elm.

<sup>2</sup>Mixed saw includes 8 MBF ash, 5 MBF yellow birch, and 3 MBF of Elm.

Other species not mentioned will be charged at the mixed pulp or mixed saw price.

---

The performance bond will be 15% of the total sale value. Contract length is approximately two years.

**SPECIAL SALE CONDITIONS:**

1. Equipment use will be restricted to very dry to frozen ground conditions due to wet soil conditions. General operational period will most likely be December through March. No cutting can be done during the months of April, May, and June in the select cut area.
2. No pole length skidding will be allowed in the select cut areas.
3. Existing woods roads will be used, unless designated as a proposed road. Improvements will need to be made on several portions of the existing road system. Decking will be permitted along woods roads. Avoid decking along Bear Creek Road if possible.  
  
Bear Creek Road is a snowmobile trail. 3" of packed snow will be maintained on snowmobile trail, weather permitting.
4. Slash that is within 100 feet of Bear Creek Road shall be lopped and scattered to within 2 feet of the ground.
5. Contractor is required to close road at the locations designated on the map by placing logging debris, per sale prospectus.
7. All logging debris shall be kept off of and out of the ditch lines of Bear Creek Road. If decking is done on Bear Creek Road, all slash and ends will be removed from the road and ditches concurrently with each truck load.
8. **All additional restrictions listed in prospectus and standard contract apply unless specified.**

**Tract (12-14) Lone Oak Sale**

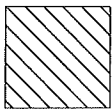

**Select Cut Area (48 acres)**- Bounded by red paint and Bear Creek Road. Harvest all orange marked trees within the designated boundaries. Sever all orange marked unmerchantable stems (canopy gaps). Leave, do not cut 1)snags, 2)cull trees, 3)trees marked with an orange X. Cut only marked aspen.

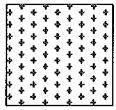

**Red Maple/Aspen Area (49 acres)**- Bounded by yellow paint and Bear Creek Road. Cut all trees greater than 2 inches except for: 1)hemlock, 2)white pine, 3)oak, 4)cherry, 5)and trees marked with an orange X.

**R-** Red paint faces select cut area.

**Y-** Yellow paint faces aspen area.

**R/Y-** Red paint faces select cut area/yellow paint faces aspen area.

**Leave-** No cut area due to small diameter or wet drainage

+ Section Corner

--- Stream

\*\*\* Proposed Road

■ Proposed Berm

Ⓟ Existing Berm

~ Steep Slope

☼ Wet

== Open Roads

- - - Woods trails

--- COUNTY

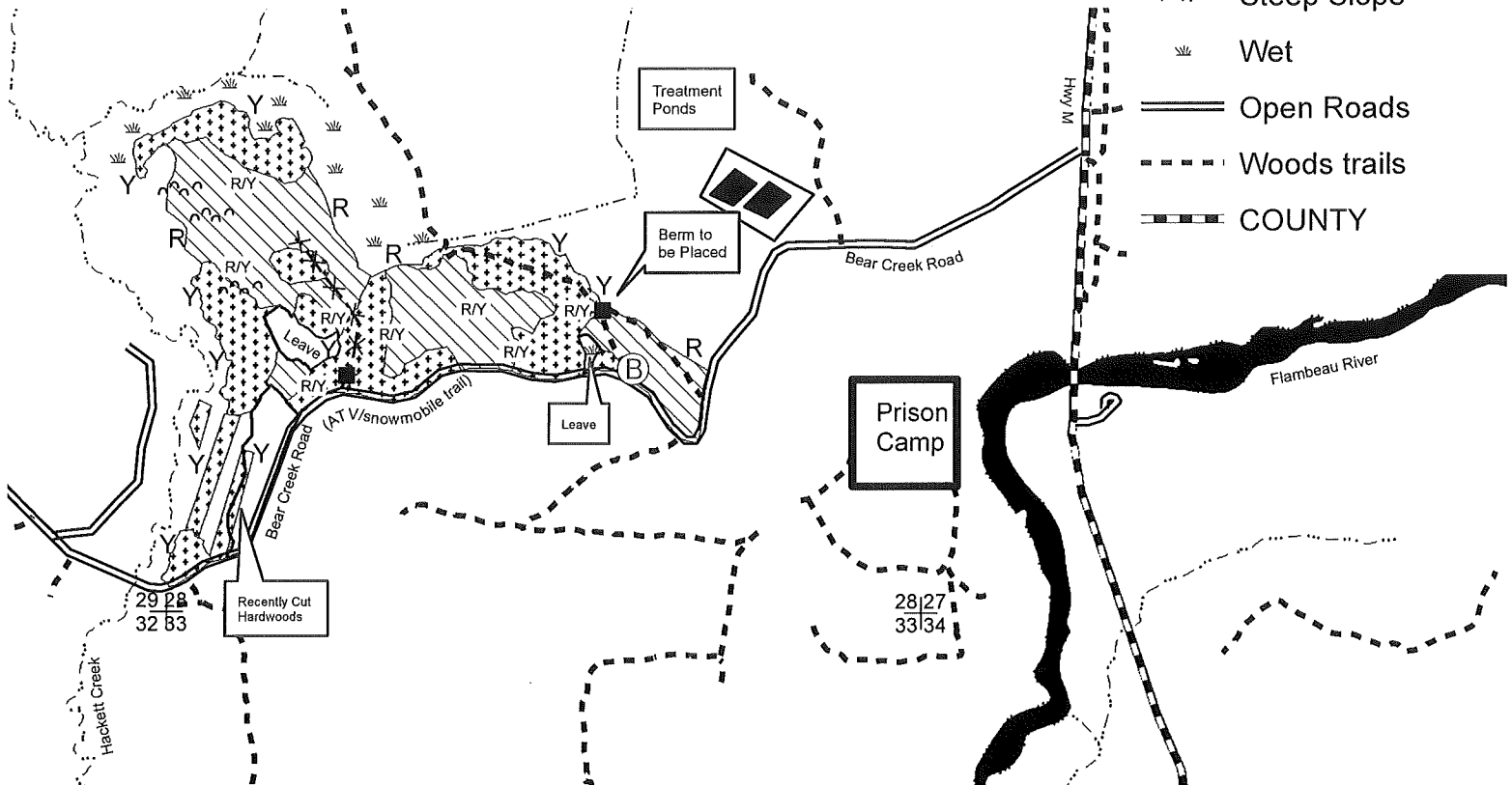



**Tract (13-14) Gill Lane Sale**

Parts of: S1/2NE, NENE, N1/2SE of Section 9, NW, W1/2NE, N1/2SW, NWNE of Section 10, and SWSW of Section 3, T37N-R3W, Sawyer County.

168 Acres

---

<u>Species</u>	<u>Estimated Volume</u>	<u>Advertised Value/Unit</u>
<sup>1</sup> Mixed Pulp	1625 cords	22.80
Basswood	280 cords	3.50
Aspen	870 cords	22.80
<sup>2</sup> Spruce	30 cords	15.20
Hard Maple	29 MBF	225.00
Red Maple	4 MBF	113.00
Ash	5 MBF	77.00
Basswood	6 MBF	98.00
<sup>3</sup> Mixed Saw	5 MBF	101.00

Minimum Acceptable

Bid for Entire Sale

\$66,777.00

<sup>1</sup>Mixed pulp includes 60% hard maple, 21% red maple, 6% ash, 8% elm, 2% yellow birch and 3% white birch, ironwood, and cherry combined.

<sup>2</sup>Spruce volume includes 37% white spruce, 26% balsam fir and 37% tamarack.

<sup>3</sup>Mixed saw volume includes 2 MBF yellow birch, 2 MBF elm, 300 BF red oak, and 80 BF of white birch.

Other species not mentioned will be charged at the mixed pulp or saw price.

---

The performance bond will be 15% of the total sale value. Contract length is approximately two years.

**SPECIAL SALE CONDITIONS:**

1. Sale shall be harvested during very dry or frozen ground conditions.
2. No pole length skidding will be allowed in the select cut areas or within the plantation.
3. Existing woods roads will be used. Improvements will need to be made on several portions of the existing road system. Decking will be permitted along woods roads and hunter walking trail. No decking will be permitted on the ATV/snowmobile trail.
4. Slash that is within 100 feet of Hwy M and Price Creek Road shall be lopped and scattered to within 2 feet of the ground.
5. Contractor is required to close road at the locations designated on the map by placing logging debris, per sale prospectus.
6. All logging debris shall be kept off of and out of the ditch lines of Hwy M, Price Creek Road, ATV/snowmobile trail, and Gill Lane.
7. Limit the crossing of the ATV/snowmobile trail to one location designated by timber sale administrator. 3" of packed snow must be maintained on the snowmobile trail, weather permitting.
8. Gill Lane needs repairs in location designated on the map. This portion of the road can only be used under frozen ground conditions unless the culvert is replaced and the road repaired. The FRSF staff will be responsible for repairing this portion of the road.
9. Avoid survey monument located within the sale area.
10. **All additional restrictions listed in prospectus and standard contract apply unless specified.**

**(Tract 13-14) Gill Lane Sale**



**Select Cut Area (67 acres)** - Bounded by red paint, ponds, and Gill Lane. Harvest all orange marked trees within the designated boundaries. Sever all orange marked unmerchantable stems (canopy gaps). Leave, do not cut 1)snags, 2)cull trees, 3)trees marked with an orange X. Cut only marked aspen.



**Aspen Area (26 acres)**- Bounded by yellow paint and Gill Lane. Cut all trees greater than 2 inches except for: 1)hemlock, 2)white pine, 3)oak, 4)cherry, 5)and trees marked with an orange X.



**Preparation Clearcut(73 acres)**- Bounded by yellow paint, Hwy M, and Aspen Area. Cut all trees greater than 2 inches.



**Spruce Plantation- (2 acres)**- Bounded by red paint, Price Creek Road, and Hwy M. Cut all orange marked trees.

R- Red paint faces select cut and plantation area.

Y- Yellow paint faces preparation clearcut and aspen area.

R/Y- Red paint faces select cut area and yellow paint faces aspen area.

NP- No paint facing preparation clearcut

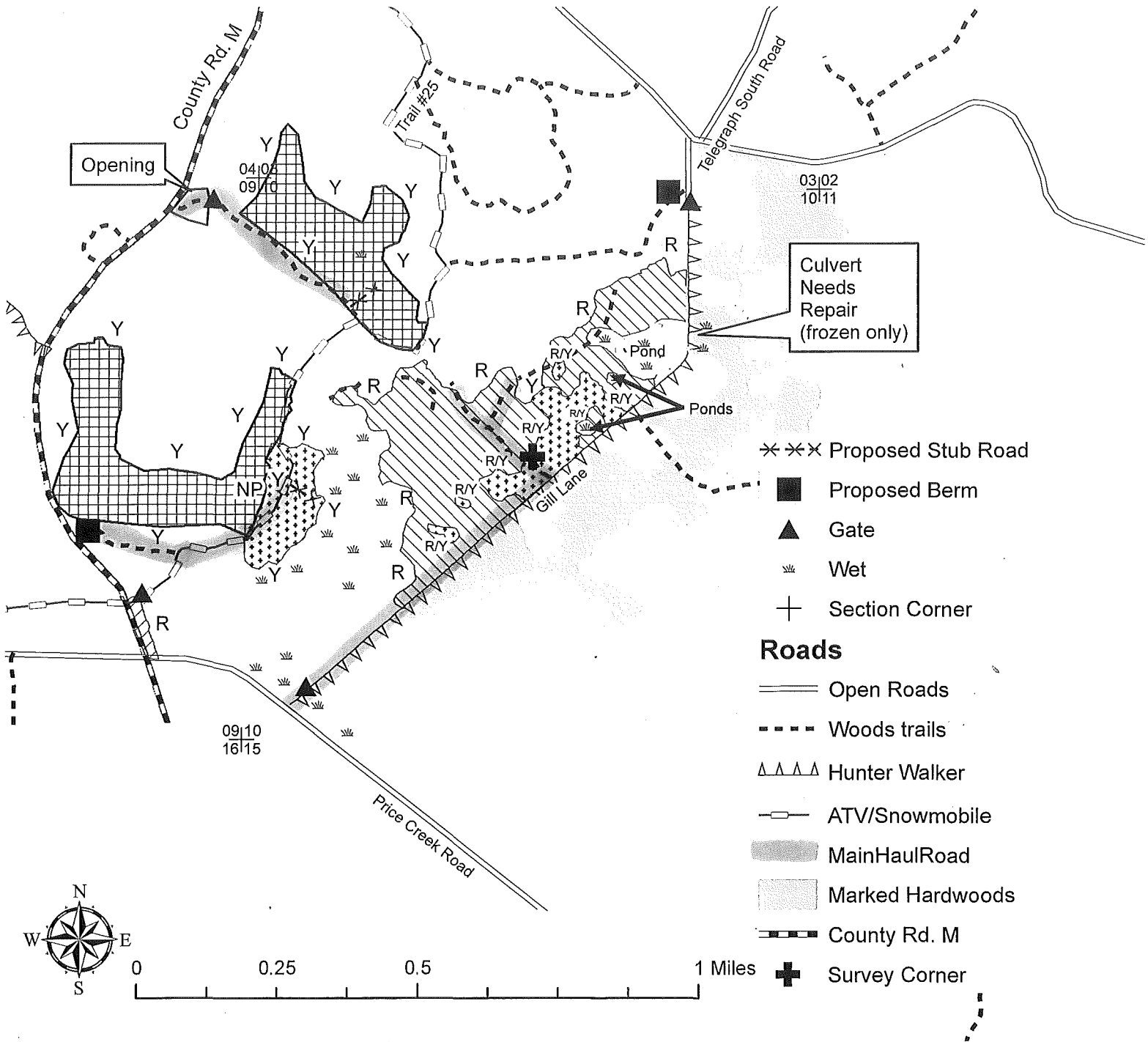

**Tract (15-14) Bear Creek Sale**

Parts of: NENW, NE of Section 6; E1/2NW of Section 5 T36N-R3W, Rusk County and SESW, SE, and NE of Sec. 31, T37N-3W, Sawyer County.

156 Acres

---

<u>Species</u>	<u>Estimated Volume</u>	<u>Advertised Value/Unit</u>	
<sup>1</sup> Mixed Pulp	1560 cords	21.90	
Basswood	150 cords	3.70	
Hard Maple	53 MBF	255.00	
Ash	10 MBF	88.00	<u>Minimum Acceptable</u>
Basswood	16 MBF	111.00	<u>Bid for Entire Sale</u>
<sup>2</sup> Misc. Saw	7 MBF	115.00	\$51,695.00

<sup>1</sup>Mixed pulp includes 85% hard maple, 6% red maple, 7% ash, and 2% yellow birch and ironwood combined.

<sup>2</sup>Misc. Saw includes 5 MBF red maple and 2 MBF yellow birch.

Other species not mentioned will be charged at the mixed pulp or misc. saw price accordingly.

---

The performance bond will be 15% of the total sale value. Contract length is approximately two years.

**SPECIAL SALE CONDITIONS:**

1. Equipment use will be restricted to frozen ground conditions due to wet soils between October 15<sup>th</sup> and April 1<sup>st</sup> because entire sale is located within the Flambeau River Scenic Management Area.
2. No pole length skidding will be allowed in the select cut areas.
3. Existing woods roads will be used unless designated proposed road. Improvements will need to be made on several portions of the existing road system. Decking will be permitted along woods roads.
4. Contractor is required to close road at the locations designated on the map by placing logging debris, per sale prospectus.
5. No new access points will be permitted.
6. All logging debris shall be kept off of and out of the ditch lines of the hunter walking trail and Bear Creek Road. If decking is done on the hunter walking trail, all slash and ends will be removed from the road and ditches concurrently with each truck load.
7. Bear Creek Road is a snowmobile trail, weather permitting, 3" of snow pack must be maintained on the trail.
8. If nearby sales are not completed prior to this sale starting, the hunter walking trail will be used for access for both sales. Bear Creek Road could potentially be used for multiple sales. It will be the responsibility of the contractors of sales to determine the logistics for hauling.
9. **All additional restrictions listed in prospectus and standard contract apply unless specified.**

**(Tract 15-14) Bear Creek Sale**

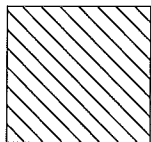

**Select Cut Area (156 acres)-** Bounded by red paint. Harvest all orange marked trees within the designated boundaries. Sever all orange marked unmerchatable stems (canopy gaps). Leave do not cut 1)snags 2)cull trees 3) trees marked with an orange X. Cut only **marked** aspen.

**Red/R-** Red paint boundaries face the select cut areas  
**Leave-** Tamarack sapling leave area has no paint line

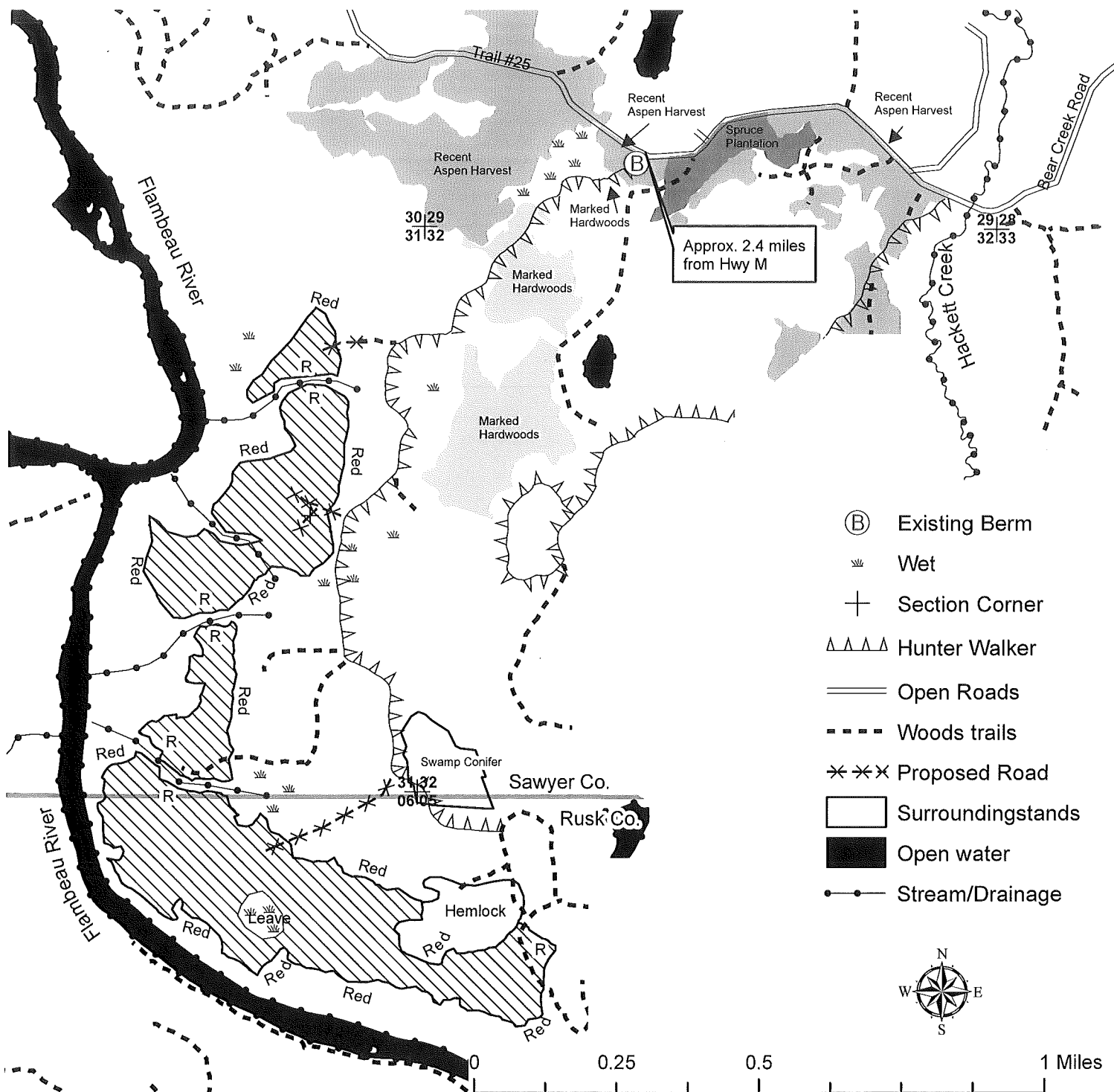

**(Tract 18-14) North Loop Sale**

W1/2SW Sec. 1, SWNE, SENW, NESW, and SE of Sec. 2, NENW,  
N1/2NE of Sec. 11 in T37N-R3W in Sawyer County.

151 acres

<u>Species</u>	<u>Estimated Volume</u>	<u>Advertised Value/Unit</u>
<sup>1</sup> Mixed Pulp	2060 cords	27.00
Basswood	30 cords	4.20
Aspen	610 cords	27.00
<sup>2</sup> Spruce	560 cords	16.80
Hard Maple	18 MBF	285.00
Red Maple	18 MBF	143.00
Ash	16 MBF	99.00
Basswood	3 MBF	117.00
<sup>3</sup> Mixed Saw	1 MBF	128.00

Minimum Acceptable

Bid for Entire Sale

\$91,391.00

<sup>1</sup>Mixed pulp includes 40% hard maple, 37% red maple, 16% ash, 5% yellow birch, 2% white birch, elm, ironwood, and cherry combined.

<sup>2</sup>Spruce volume includes 54% black spruce, 28% tamarack, and 18% balsam fir.

<sup>3</sup>Mixed saw volume includes approximately 360 BF yellow birch, 200 BF Cherry, and 240 BF white birch. Other species not mentioned will be charged at the mixed pulp or saw price.

The performance bond will be 15% of the total sale value. Contract length is approximately two years.

**SPECIAL SALE CONDITIONS:**

1. Equipment use will be restricted to very dry or frozen ground conditions due to wet soil conditions. General operational period will most likely be December through March. No cutting can be done during the months of April, May, and June in the select cut area.
2. No pole length skidding will be allowed in the select cut areas.
3. Existing woods roads will be used, unless designated as proposed road. Improvements will need to be made on several portions of the existing road system. Decking will be permitted along woods roads and Price Creek Road.
4. Slash that is within 100 feet of Price Creek Road shall be lopped and scattered to within 2 feet of the ground.
5. Contractor is required to close road at the locations designated on the map by placing logging debris, per sale prospectus.
6. All logging debris shall be kept off of and out of the ditch lines of Price Creek Road. If decking is done on Price Creek Road, all slash and ends will be removed from the road and ditches concurrently with each truckload.
7. New road construction is optional, and is limited to proposed road layout shown on the prospectus map. Modifications can be made with approval from forester.
8. Avoid government survey monuments illustrated in select cut area.
9. **All additional restrictions listed in prospectus and standard contract apply unless specified.**

**Tract (18-14) North Loop Sale**

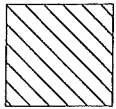

**Select Cut Area (80 acres)**- Bounded by red paint and Price Creek Road. Harvest all orange marked trees within the designated boundaries. Sever all orange marked unmerchantable stems (canopy gaps). Leave, do not cut 1)snags, 2)cull trees, 3)trees marked with an orange X. Cut only marked aspen.

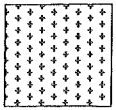

**Red Maple/Aspen Area (66 acres)**- Bounded by yellow paint and Price Creek Road. Cut all trees greater than 2 inches except for: 1)hemlock, 2)white pine, 3)oak, 4)cherry, 5)and trees marked with an orange X. Shaded areas are tamarack/black spruce areas.



**Tamarack Strips (5 acres)**- Designated by orange marked center line. Cut all trees greater than 2 inches within 50 feet of both sides of the center line except for: 1)hemlock, 2)cedar, 3)white pine. (Strips will be 100 feet wide from edge to edge) Cut orange marked trees. *Total stand is 17 acres. Area to be cut is 5 acres.*

- R- Red paint faces select cut area
- Y- Yellow paint faces aspen area
- O- Orange paint marks the center of the Tamarack strip area
- R/Y- Red paint faces select cut area and yellow paint faces aspen area

- Ⓟ Existing Berm
- ▲ Gate
- Berm to be placed
- ≡ Wet
- + Survey Monument
- Price Creek

- ══ Open Roads
- - - Woods trails
- \* \* \* Proposed Road

3536  
02 01

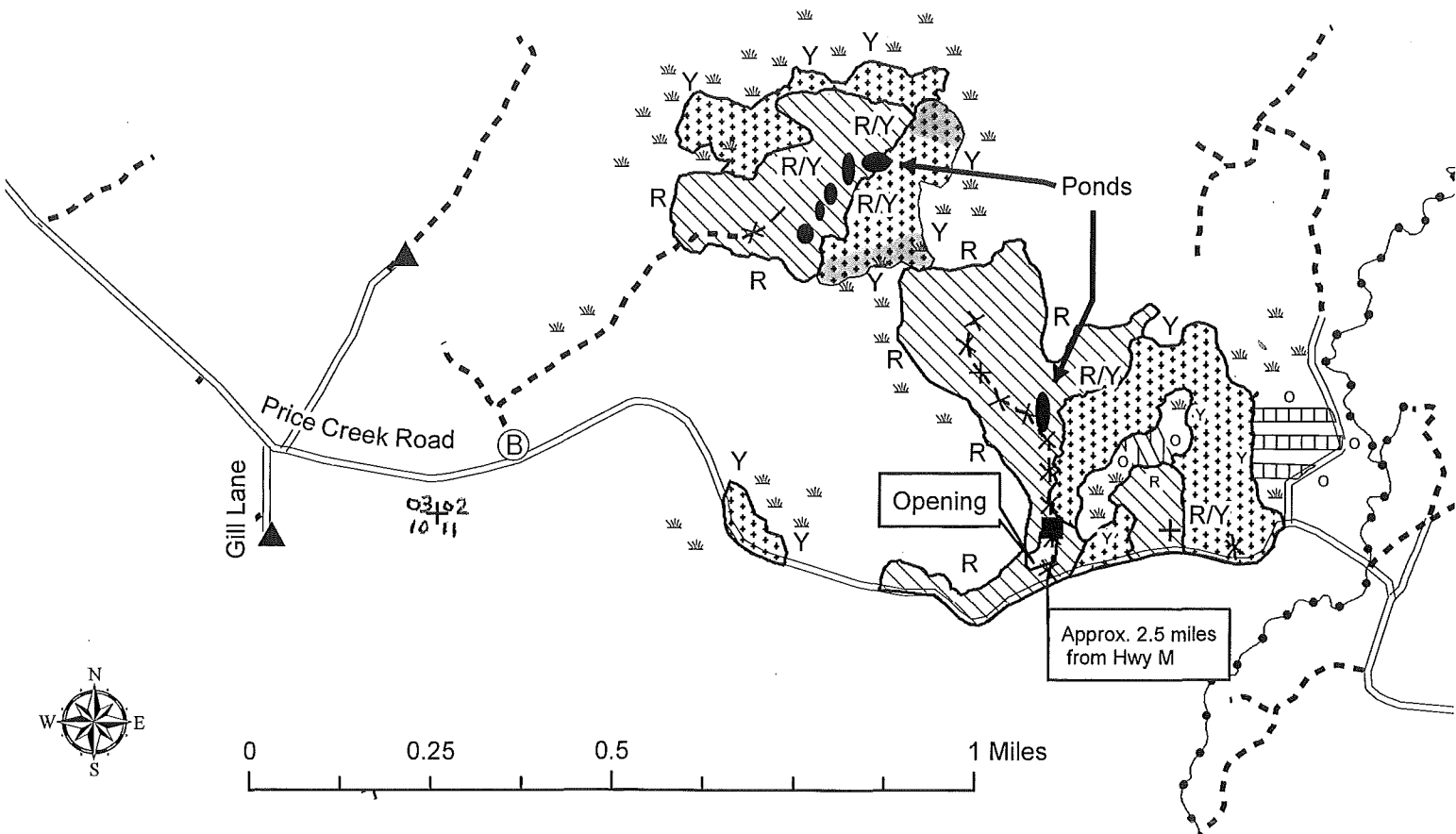

**Tract 19-14 (Non-Memorial Re-try)**

Parts of: SE¼, Sec. 16; W½NE¼, E½NW¼, Sec. 21, T-39-N, R-3-W, Sawyer County

57 Acres

---

Species	Estimated Volume	Advertised Value/Unit	
Mixed Pulp <sup>1</sup>	170 cds.	\$15.60/cd	
Aspen	400 cds	\$15.60/cd	
Balsam Fir <sup>2</sup>	170 cds	\$ 9.20/cd	
Hard Maple	3 MBF	\$159.00/MBF	Minimum Acceptable
Red Maple	9 MBF	\$ 80.00/MBF	<u>Bid for Entire Sale</u>
Misc. Sawlogs <sup>3</sup>	16 MBF	\$ 62.00/MBF	\$12,645.00

<sup>1</sup> Mixed pulp includes approximately 55% red maple, 25% hard maple, and small amounts (20% total) of ash, basswood, elm, white and yellow birch, and cherry

<sup>2</sup> Balsam Fir includes 20% spruce

<sup>3</sup> Misc. Sawlogs include approximately 10 MBF of ash and 6 MBF (combined) of basswood, yellow birch, elm, and cherry  
Any additional species will be charged the mixed pulp and misc.sawlog price, respectively.

---

The performance bond will be 15% of the total sale value. Contract length is approximately 2 years.

**SPECIAL SALE CONDITIONS:**

1. Equipment use will be restricted to frozen ground conditions only due to very wet soil conditions. Logging operations will also be restricted until after the completion of the Wisconsin muzzle-loading season, per request of the private landowner.
2. Verbal approval has been given by landowner to use existing road through the private property. The gate located on private lands indicated on the map shall remain closed and locked during non-working hours. The private road will be left in the condition it was found or better by contractor.
3. Access to the sale will require a temporary crossing to be built over the un-named stream in the area indicated on the map. All conditions of the temporary stream crossing permit, which will be obtained by the Flambeau River State Forest, will be followed by the contractor.
4. New road construction will be required and is limited to the proposed layout shown on the prospectus map. Modifications can be made with approval from forester.
5. The contractor will be required to close the road at the location indicated on the prospectus map by placing logging debris, per sale prospectus.
6. No slash will be left across the blue paint line onto private land, in any non-forested wetland, open water, or across the yellow paint line in the buffers next to the streams indicated on the map.
7. Landings will be located at least 200 ft. from streams and shall be limited to a maximum size of 100 x 200 ft.
8. Avoid damaging the government monument(s) indicated on the map.
9. Watch for small wetlands throughout the sale.
10. **All additional restrictions listed in prospectus and standard contract apply unless specified.**

**Tract 19-14 (Non-Memorial Re-try)**

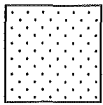

Aspen Area (57 acres) – Bounded by yellow and blue paint lines. In “Area A”, cut all trees greater than 2” except for cherry. In “Area B”, cut all trees greater than 2” except for hemlock, white pine, and tamarack. Trees are scattered in some areas within “Area B” due to wind storm in 2006.

- Existing woods road(s)
- x x x x Proposed road(s)
- ~~~~~ Stream(s)/drainage
- ⌂ Structure(s)
- ▬ Berm to be placed
- Hdwd Hardwoods
- FRSF Flambeau River State Forest land
- Leave Black ash pocket
- Ψ Wet area(s)

819  
17116

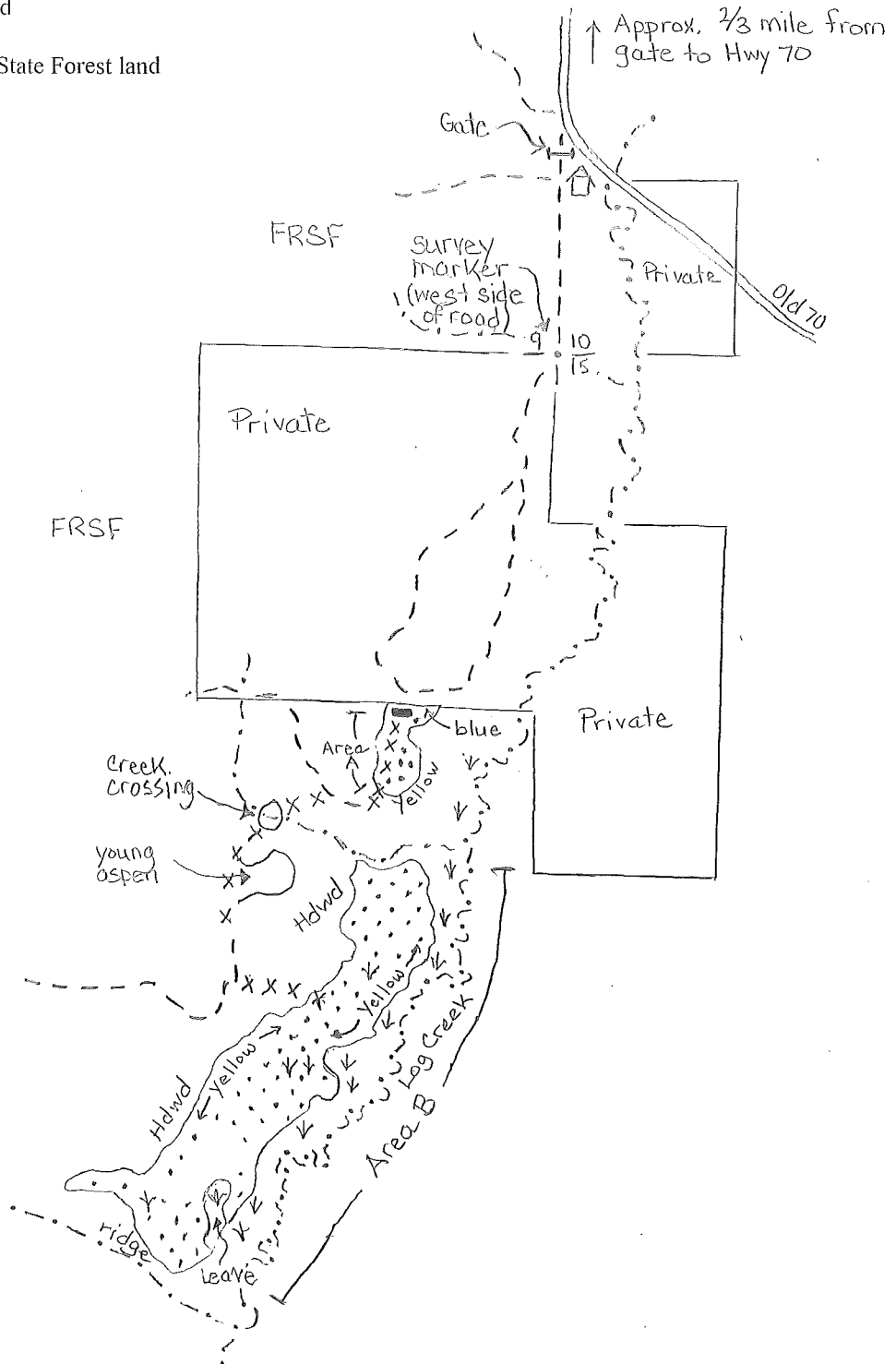



# Tract 1-14 PF

Kimberly Clark Wildlife Area

Sec. 15 T38N-R2W

For sale information contact:  
Tom Onchuck 715-7621358

<u>Species</u>	<u>Approx. Volume</u>	<u>Minimum Acceptable Bid</u>
MX Hwd	375 cords	\$19.20/cd
Aspen	325 cords	\$18.30/cd
MX Conifer	60 cords	\$16.70/cd
Tamarack	50 cords	\$16.70/cd

**Minimum Acceptable Bid for Entire Sale: \$14,984.50**

**Note:** Bid bond not required. Winning bidders will have 6 weeks from the date of the bid opening to submit an acceptable performance bond to the department. The performance bond will be 15% of the total sale value. If the winning bidder fails to execute the contract and submit an acceptable performance bond, the bidder shall be required to forfeit to the department an amount equal to 10% of the total bid amount. Failure to forfeit the 10% penalty will result in the bidder being considered ineligible to bid on any state timber sales for a two-year period. Contract length will be two years.

**Aspen Regeneration Harvest** (32 acres) Cut all stems 2" DBH and larger except for: 1). oak, 2). pine, 3). cedar, 4). hemlock, and 5). white spruce containing less than 3 sticks.

**Tamarack Seed Tree Harvest**(4 acres) Cut all stems 2" DBH and larger except for: 1). green-marked seed trees and 2). white pine.

## General Sale Conditions

- Harvest areas are bounded by wildlife area roads, yellow paint line, tag alder, and blue paint line/young aspen.
- Ground conditions will limit the majority of this sale to frozen ground.
- East-West portion of road is used as snowmobile trail. Caution is needed when operating in this area. Road will need to be maintained free of slash.
- New road construction will require the placement of logging debris/stumps to close road at completion of sale.
- No slash or logging debris is to be left across blue line onto private land.
- Rutting policy will be enforced per contract.



The Forest  
 of  
 Kimberly-Clark  
 #SCS-FM/CO-00070N  
 FSC 100%

# Tract 1-14PF

Kimberly Clark Wildlife Area  
 Sec. 15 T38N-R2W



Cert. # NSF-1Y941-SF7

**Aspen Regeneration Harvest** (32 acres) Cut all stems 2" DBH and larger except for: 1). Oak, 2). Pine, 3). Cedar, 4). Hemlock, 5). White spruce containing less than 3 sticks.

**Tamarack Seed Tree Harvest** (4 acres) Cut all stems 2" DBH and larger except for: 1). Green marked seed trees and 2). White pine

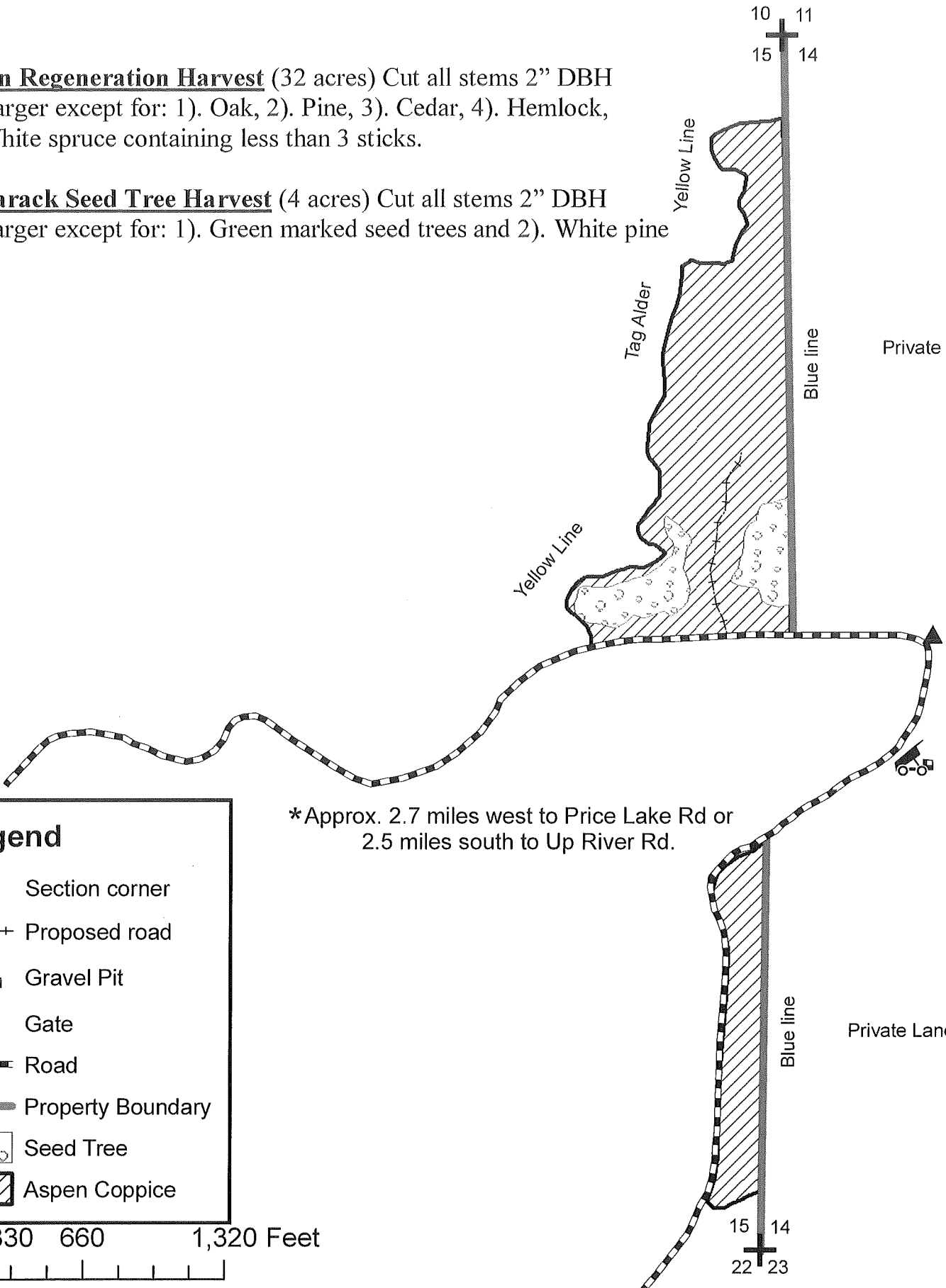

\*Approx. 2.7 miles west to Price Lake Rd or 2.5 miles south to Up River Rd.

**Legend**

- Section corner
- Proposed road
- Gravel Pit
- Gate
- Road
- Property Boundary
- Seed Tree
- Aspen Coppice



# Tract 1-15 TST

Tuscobia State Trail

T40N-R1W, T40N-R2W

<u>Species</u>	<u>Approx. Volume</u>	<u>Minimum Acceptable Bid</u>
Aspen	300 cords	\$5.00/cd
Balsam	80 cords	\$5.00/cd
Spruce	50 cords	\$5.00/cd

**Minimum Acceptable Bid for Entire Sale: \$2,150.00**

**Note:** Bid bond not required. Winning bidders will have 6 weeks from the date of the bid opening to submit an acceptable performance bond to the department. The performance bond will be **\$1000**. If the winning bidder fails to execute the contract and submit an acceptable performance bond, the bidder shall be required to forfeit to the department an amount equal to 10% of the total bid amount. Failure to forfeit the 10% penalty will result in the bidder being considered ineligible to bid on any state timber sales for a two-year period. Contract length will be two years.

**Cutting Specifications:**

Within the Tuscobia Trail right-of-way cut all aspen, balsam, spruce containing 1 or more 100" pulp sticks to 4" top and any trees designated with orange paint. All standing dead trees shall be felled.

The Tuscobia Trail ROW is 100 feet wide (50' from trail centerline). Cutting will be done from outer edge of graveled surface out to approximately 30 ft. Normal reach of processor is acceptable. No exterior boundaries will be marked.

**General Sale Conditions**

- Cutting will commence at Tower Rd. and extend west along the trail to where it crosses CO. HWY E. approximately 8 miles west of Park Falls.
- Harvesting is preferred during the time period of Nov. 15<sup>th</sup>-Dec. 15<sup>th</sup>. Other periods outside of snowmobile season will be authorized by trail manager.
- Bridge locations on Smith and Butternut Creek shall not be crossed with logging equipment.
- All wood being decked along trail must be off the graveled surface as to not impede traffic and trail will be maintained in operable condition at all times.
- Road approaches to surfaced roads and other public roads are the responsibility of the contractor as is decking wood in locations other than the Tuscobia ROW.
- All slash will be maintained at least 5 ft. off of trail and reduced to within 2 ft. of ground surface where trail is level or below surrounding land. Slash should also be kept out of non-forested wetlands, open water, or designated stream channels.
- Care will be taken as to prevent damage to non-designated species and those trees outside of the trail ROW.



www.fsc.org  
 Cert. # SCS-FM/COC-00070N  
 FSC 100%



Cert. # NSF-1Y941-SF7

**Tract 1-15 TST**  
**Tuscobia State Trail**  
 T40N-R1W, T40N-R2W  
 Price Co. WI

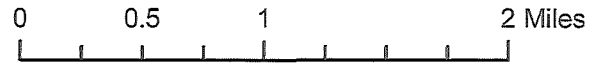
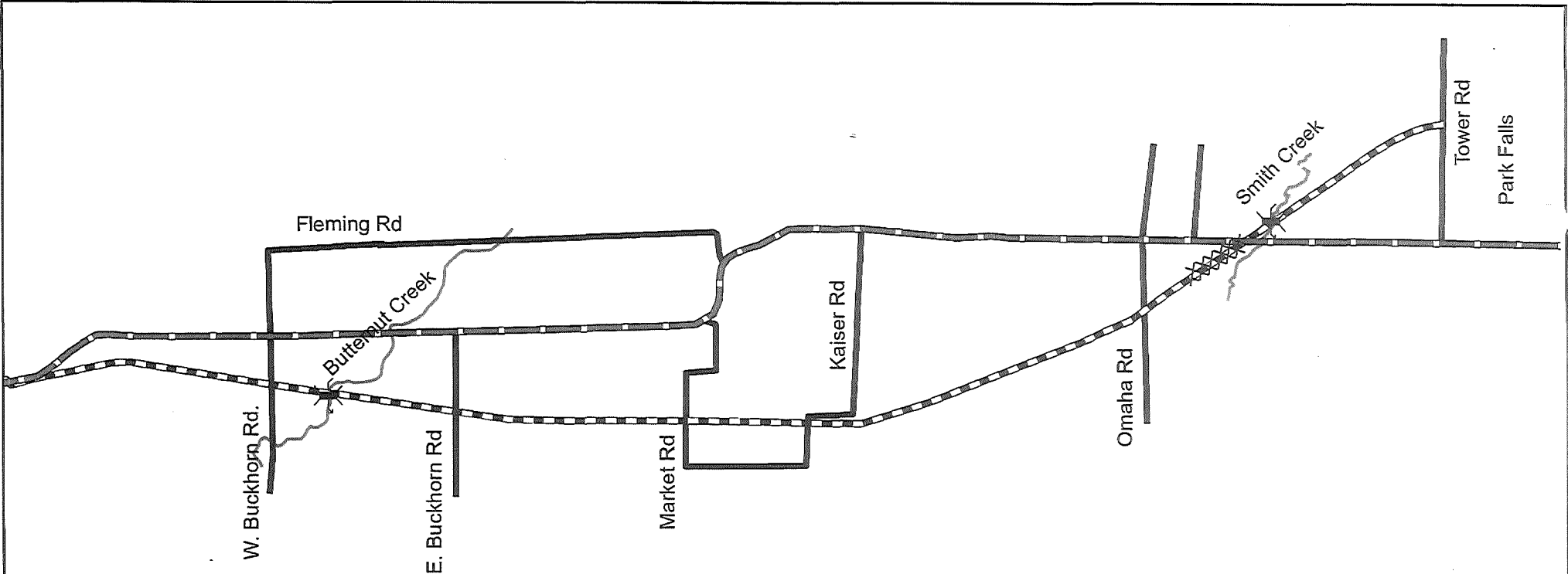

**Sale Length = 8 miles**

**Legend**

- XXXXXX No cut
- Tuscobia State Trail
- Hwy E
- Roads
- Stream
- ☆ Bridge

**Note: No cutting will take place for approx. the first 1/4 mile after trail crosses Hwy E. Cutting will resume west of blue paint.**

Sale Info:

Tom Onchuck- Forester 715-762-1358

Todd Hintz- Trail Manager 715-266-7032



State of Wisconsin  
Department of Natural Resources  
Pershing Wildlife Area

Timber Sale Prospectus  
Tract # P2-14

Section 13 T32N R4W

<u>Species</u>	<u>Estimated Volume</u>	<u>Advertised Value / Unit</u>
Aspen	400 cords	\$ 20.70 / cd
Misc. Hardwood	300cords	\$ 22.50 / cd
Basswood	20 cords	\$ 3.60 / cd
Mixed Hardwood	8 MBF	\$ 120.00 / MBF

**Minimum Acceptable Bid for Entire Sale: \$ 16,062.00**

Contract length is approximately two years. Although access is possible through the field on the west side of the sale, no decking of wood on the field is allowed. A stub road(s) within the sale area can be constructed with approval. Care must also be taken to not rut the field. Neither load trimmings, nor slash may be left on the field (must be removed daily), and snowplow berms should be feathered out to not persist in the spring and smother the clover crop.

**Harvesting Prescription:**

Sale Area: Harvest all trees 2" DBH and larger. **EXCEPT:** Swamp White Oak, Red Oak, Elm, Spruce, and green pain marked trees.

Utilize all cut trees that will make one or more 100" pulpwood stick to a 4" top D.I.B. Harvesting will only be permitted between December 1 and February 29, or during periods of frozen ground condition. **BEWARE OF OLD FENCE GROWN INTO TREES WITHIN THE SALE AREA**

**Integrated Resource Considerations:**

All snowmobile trails used by the contractor during the harvesting operation must be kept open, free of slash and logging debris and snow covered. Any new road location and construction is subject to review and approval by the Department of Natural Resources. Prior to the timber sale closeout procedure, all forest trails and logging roads used in the harvesting operation must be free of slash, logging debris, ruts and be level (pre-sale condition).

# Pershing W.A. Timber Sale Tract P2-14

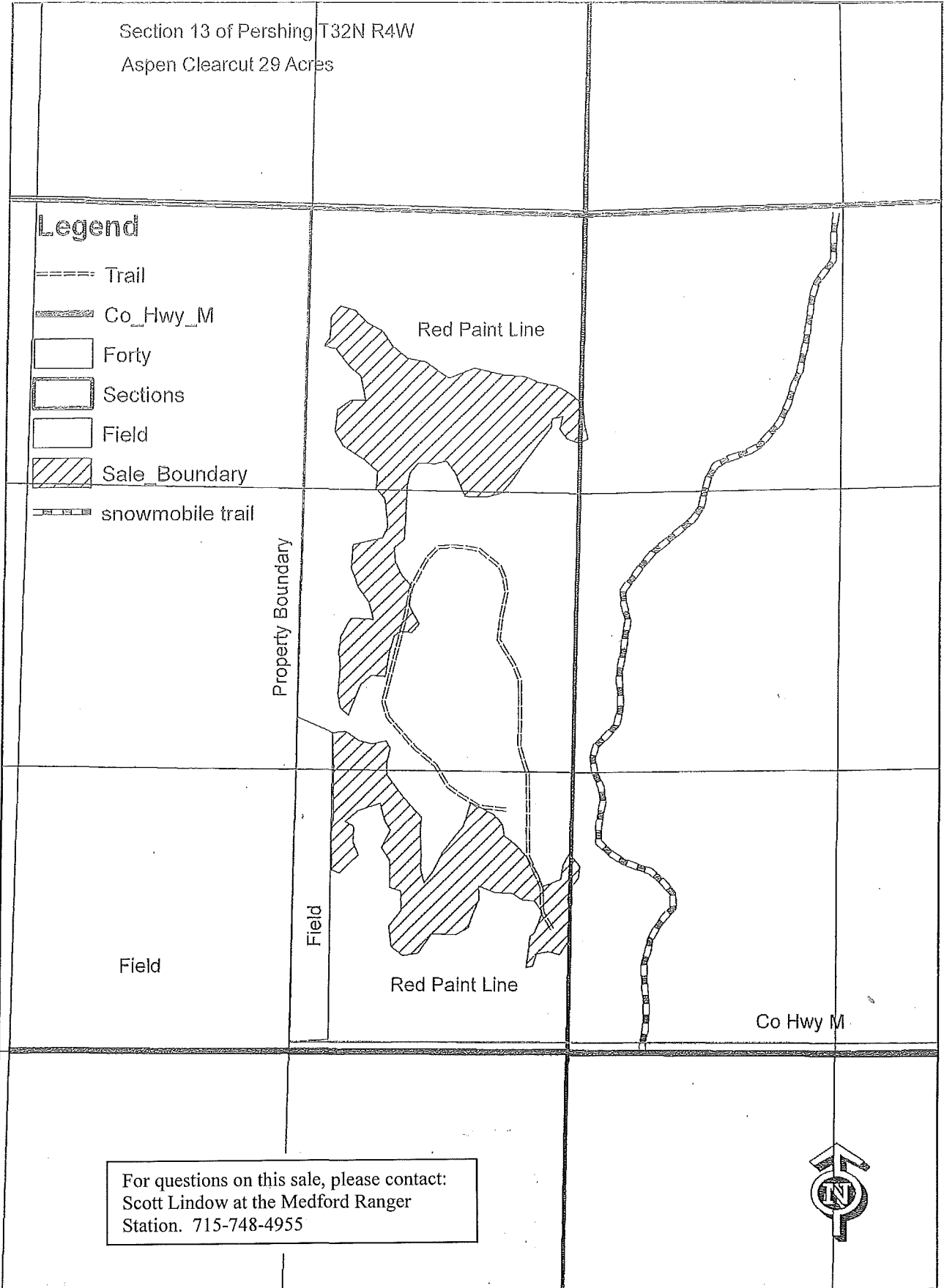

State of Wisconsin  
Department of Natural Resources  
Pershing Wildlife Area

Timber Sale Prospectus  
Tract # P3-14

Section 11 T32N R4W

<u>Species</u>	<u>Estimated Volume</u>	<u>Advertised Value / Unit</u>
Aspen	150 cords	\$ 20.70 / cd
Misc. Hardwood	100cords	\$ 22.50 / cd
Basswood	10 cords	\$ 3.60 / cd
Mixed Hardwood	5 MBF	\$ 120.00 / MBF

**Minimum Acceptable Bid for Entire Sale: \$ 5,991.00**

Contract length is approximately two years. Access will require freezing down a small section of wet ground and placement of timber mats. **Please do not ask the private landowner to the south for access – He does not want to be bothered.** Although decking of wood in the State's field is expected, care must also be taken to not rut the field. Neither load trimmings, nor slash may be left on the field.

**Harvesting Prescription:**

Sale Area: Harvest all trees 2" DBH and larger. **EXCEPT: Swamp White Oak, Red Oak, Elm, Spruce, and cherry trees.**

Utilize all cut trees that will make one or more 100" pulpwood stick to a 4" top D.I.B. Harvesting will only be permitted between December 1 and February 29, or during periods of frozen ground condition. **BEWARE OF OLD FENCE GROWN INTO TREES WITHIN THE SALE AREA**

**Integrated Resource Considerations:**









Any new road location and construction is subject to review and approval by the Department of Natural Resources. Prior to the timber sale closeout procedure, all trails and roads used in the harvesting operation must be free of slash, logging debris, ruts and be level (pre-sale condition).

# Pershing W.A. Timber Sale Tract P3-14

NESW Sec 11 T32N R4W

Aspen Clearcut 16 acres

## Legend

-  field
-  field\_windrows
-  Proposed\_Crossing
-  Gate
-  trail\_thru\_field
-  old\_fence
-  TR314Boundary
-  Sections

To Chucks Rd



Flowage under construction

Dike

Field

Red Paint

Private Land

Private Land

Contact Scott Lindow at 715-748-4955 for any questions pertaining to this timber sale.





SAWYER COUNTY STATE LANDS  
 TIMBER SALE PROSPECTUS  
 TRACT # H02-12  
 N1/2SW1/4, S1/2 NW1/4, SESW Sec,6 T37N R7W

For questions on this sale, please contact:  
 Jim Kujala at the Hayward office.  
 715-634-9658 ext.3506

Species	Estimated Volume	Minimum Bid	Cruiser Comments	Bid/Unit
ASPEN	375	\$20.00/cd		
MIXED HARDWOOD	110	\$20.00/cd	This volume contains approx. 7 cords of Basswood	

Total Bid \_\_\_\_\_

Harvesting Prescriptions: Frozen Ground only

Clear Cut with reserves Area

Cut all merchantable aspen, mixed hardwood and ironwood within the clear cut area. Utilize all pulpwood to a 4 inch top diameter. Sever all non merchantable aspen, mixed hardwood and ironwood stems 2 inches and larger. Do not cut any oak or white pine.

Aesthetic Zone Care should be taken during the harvesting operation to minimize any detrimental effects to the soils. Before the timber sale is closed, all forest skid trails and logging roads used in the harvesting operation must be leveled to presale conditions or better.

Integrated Resource Considerations -

All existing and future logging roads must be kept free of slash and logging debris. Any new forest road location or construction is subject to review and approval by the D.N.R. Forester. All slash must be removed from adjacent private land ownership, and any slash or logging debris accumulated on the landings must be lopped and scattered. Depositing slash and/or logging debris in any wetland or RMZ is prohibited. Decking of cut forest products will not be permitted on any town road right-of-way, unless prior approval is granted by the Town Chairman.

BMP's Chapter 30 permit may be required for this sale.

Wisconsin's Best Management Practices (BMP's) for Water Quality are required on all State timber sales. BMP manuals are available from your DNR office. When constructing roads, cutting timber, or skidding timber near or across wetlands, lakes, streams, or intermittent drainages know your BMP's and follow them.

LITTERING

Sale area shall be kept free of litter at all times. Enforcement action will be taken for noncompliance.

SURVEY CORNERS

Do not disturb survey corners, monuments, or surrounding witness trees.

ROADS

As per State Statute 86.02 contractor is liable for damages made to town, county, or state highway. As per SS. 86.04, timber or other objects cannot be placed on any highway right-of-way. It is recommended that landings be constructed no closer than 100' town, county, or state highways.



State Lands Timber Sale  
Weigor Wildlife Area  
S1/2 NW1/4, N1/2 SW1/4, SESW, SEC. 6 T37N R7W  
Sawyer County  
Tract H02-12 41 acres

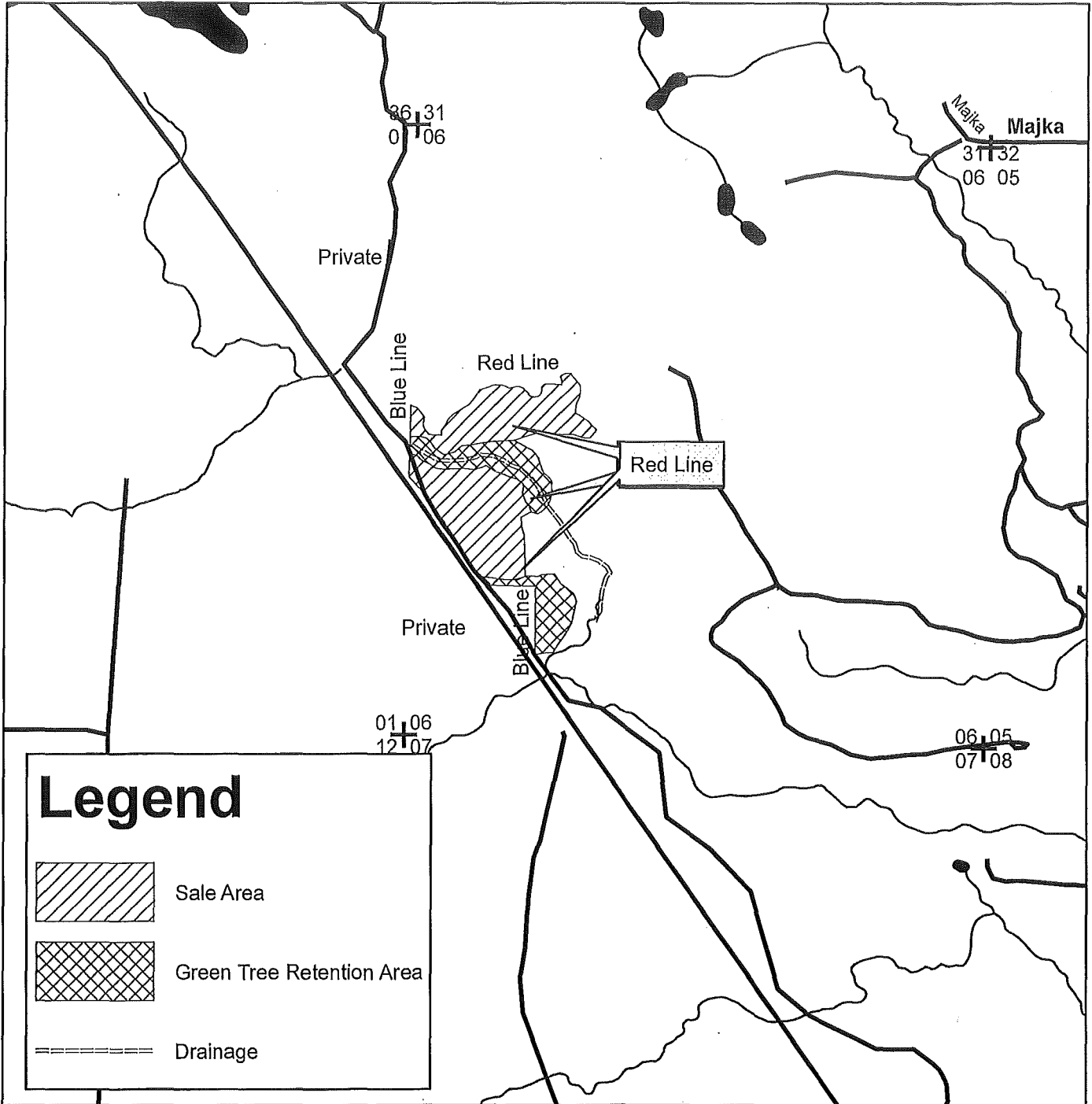

1 inch = 0.25 miles

SAWYER COUNTY STATE LANDS  
 TIMBER SALE PROSPECTUS  
 TRACT # H02-13  
 SW1/2 NW1/4 SEC 8, S1/2, SW1/4 SEC 5 T40N R6W

For questions on this sale, please contact:  
 Jim Kujala at the Hayward office.  
 715-634-9658 ext.3506

Species	Estimated Volume	Minimum Bid	Cruiser Comments	Bid/Unit
ASPEN	500 cds	\$20.00/cd		
MIXED HARDWOOD	400 cds	\$20.00/cd	Contains approx. 85% red maple, 10% white birch, 5% other hardwood. Also 5 cords or less of oak	
Balsam fir	90 cds	\$20.00/cd		
RED MAPLE	18 MBF	\$200.00/MBF	Contains approx. 500 ft. hard maple and oak	

Total Bid \_\_\_\_\_

Harvesting Prescriptions: Frozen Ground logging only  
 All logs will be scaled on the landing, piled small end out, prior to shipping.  
 No decking or cutting of wood on the Archaeological area without prior approval from State Forester

Select Cut Area

Cut all trees marked with orange paint, ironwood and merchantable aspen within select cut area boundary. Cut all balsam fir with 3 or more sticks. Utilize all pulpwood to a 4 inch top and saw logs to 10 inch D.I.B.

Clear Cut with reserves Area

Cut all aspen, white birch, red maple and ironwood within the clear cut area. Do not cut pine or oak or spruce. Sever all non-merchantable mixed hardwood and ironwood stems 2 inches and larger. Utilize all pulpwood to a 4 inch top and saw logs to 10 inch D.I.B.

Aesthetic Zone Care should be taken during the harvesting operation to minimize any detrimental effects to the soils. Before the timber sale is closed, all forest skid trails and logging roads used in the harvesting operation must be leveled to presale conditions or better.

Integrated Resource Considerations -

All existing and future logging roads must be kept free of slash and logging debris. Any new forest road location or construction is subject to review and approval by the D.N.R. Forester. All slash must be removed from adjacent private land ownership, and any slash or logging debris accumulated on the landings must be lopped and scattered. Depositing slash and/or logging debris in any wetland or RMZ are prohibited. Decking of cut forest products will not be permitted on any town road right-of-way, unless prior approval is granted by the Town Chairman.

BMP's

Wisconsin's Best Management Practices (BMP's) for Water Quality are required on all State timber sales. BMP manuals are available from your DNR office. When constructing roads, cutting timber, or skidding timber near or across wetlands, lakes, streams, or intermittent drainages know your BMP's and follow them.

LITTERING

Sale area shall be kept free of litter at all times. Enforcement action will be taken for noncompliance.

SURVEY CORNERS

Do not disturb survey corners, monuments, or surrounding witness trees.

ROADS

As per State Statute 86.02 contractor is liable for damages made to town, county, or state highway. As per SS. 86.04, timber or other objects cannot be placed on any highway right-of-way. It is recommended that landings be constructed no closer than 100' town, county, or state highways.



State Lands Timber Sale  
Chippewa flowage Property  
Sawyer County  
W1/2NW Sec 8; S1/2SW Sec. 5 T20N R6W  
Tract H0213 75 acres

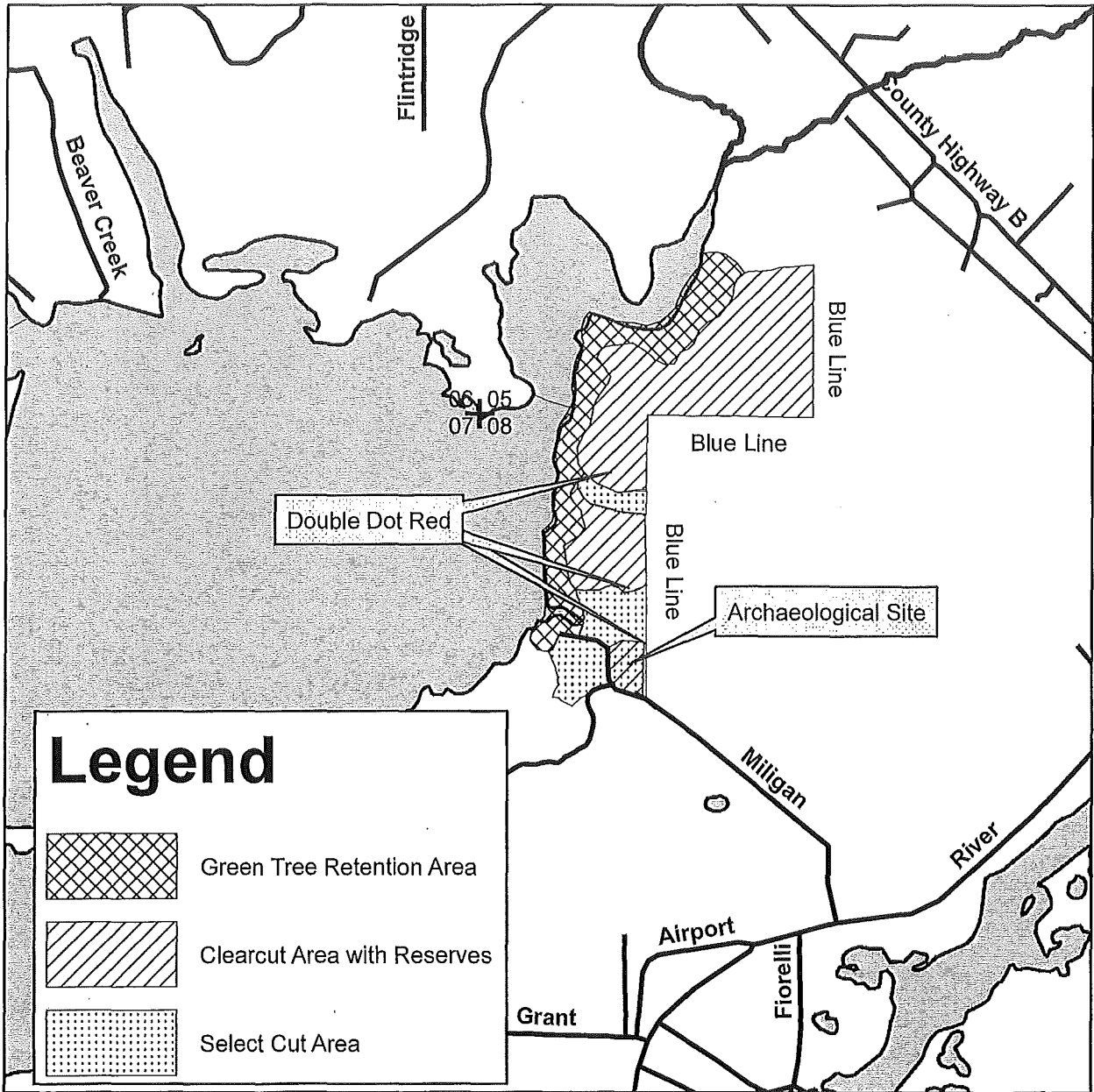

1 inch = 0.25 miles

SAWYER COUNTY STATE LANDS  
 TIMBER SALE PROSPECTUS  
 TRACT # H01-14  
 Sections, 6-7, T37N R7W

For questions on this sale, please contact:  
 Jim Kujala at the Hayward office.  
 715-634-9658 ext.3506

Species	Estimated Volume	Minimum Bid	Cruiser Comments	Bid/Unit
Mixed Hardwood	620 cds	\$20.00/cd		
Aspen	860 cds	\$20.00/cd		
Basswood	170 cds	\$5.00/cd		
fir	35 cds	\$20.00/cd		
Black Spruce	60 cds	\$20.00/cd		
Tamarack	80 cds	\$15.00/cd		
Red Pine	40 cds	\$30.00/cd		
Mixed Hardwood	25 MBF	\$100.00/MBF	MX logs contain approx. 1 MBF MH, 1 MBF BY, 7 MBF AB, 16 MBF MS	
Basswood	3 MBF	\$100.00/MBF		

Total Bid \_\_\_\_\_

Sale will likely be limited to very dry or frozen conditions due to soils and the amount of wet areas within sale boundary.

Select Marked Area A

Cut all orange marked trees also cut all merchantable aspen, fir and ironwood. Utilize pulp wood down to a 4 inch top, and hardwood saw logs to 10" DIB. All logs are to be scaled on the landing by DNR forester. Pile logs small end out.

Clear cut areas B-C

Cut all merchantable aspen, ironwood, mixed hardwood, tamarack, black spruce and orange marked red pine within the clear cut area. Sever all other mixed hardwood stems 2 inches and larger. Do not cut oak, white pine or unmarked red pine. Within this area are some patches of young unmerchantable aspen to try and work around if able to do so.

Aesthetic Zone Care should be taken during the harvesting operation to minimize any detrimental effects to the soils. Before the timber sale is closed, all forest skid trails and logging roads used in the harvesting operation must be leveled to presale conditions or better.

Integrated Resource Considerations -

All existing and future logging roads must be kept free of slash and logging debris. Any new forest road location or construction is subject to review and approval by the D.N.R. Forester. All slash must be removed from adjacent private land ownership, and any slash or logging debris accumulated on the landings must be lopped and scattered. Depositing slash and/or logging debris in any wetland or RMZ are prohibited. Decking of cut forest products will not be permitted on any town road right-of-way, unless prior approval is granted by the Town Chairman.

BMP's

Wisconsin's Best Management Practices (BMP's) for Water Quality are required on all State timber sales. BMP manuals are available from your DNR office. When constructing roads, cutting timber, or skidding timber near or across wetlands, lakes, streams, or intermittent drainages know your BMP's and follow them.

LITTERING

Sale area shall be kept free of litter at all times. Enforcement action will be taken for noncompliance.

SURVEY CORNERS

Do not disturb survey corners, monuments, or surrounding witness trees.

ROADS





As per State Statute 86.02 contractor is liable for damages made to town, county, or state highway. As per SS. 86.04, timber or other objects cannot be placed on any highway right-of-way. It is recommended that landings be constructed no closer than 100' town, county, or state highways.

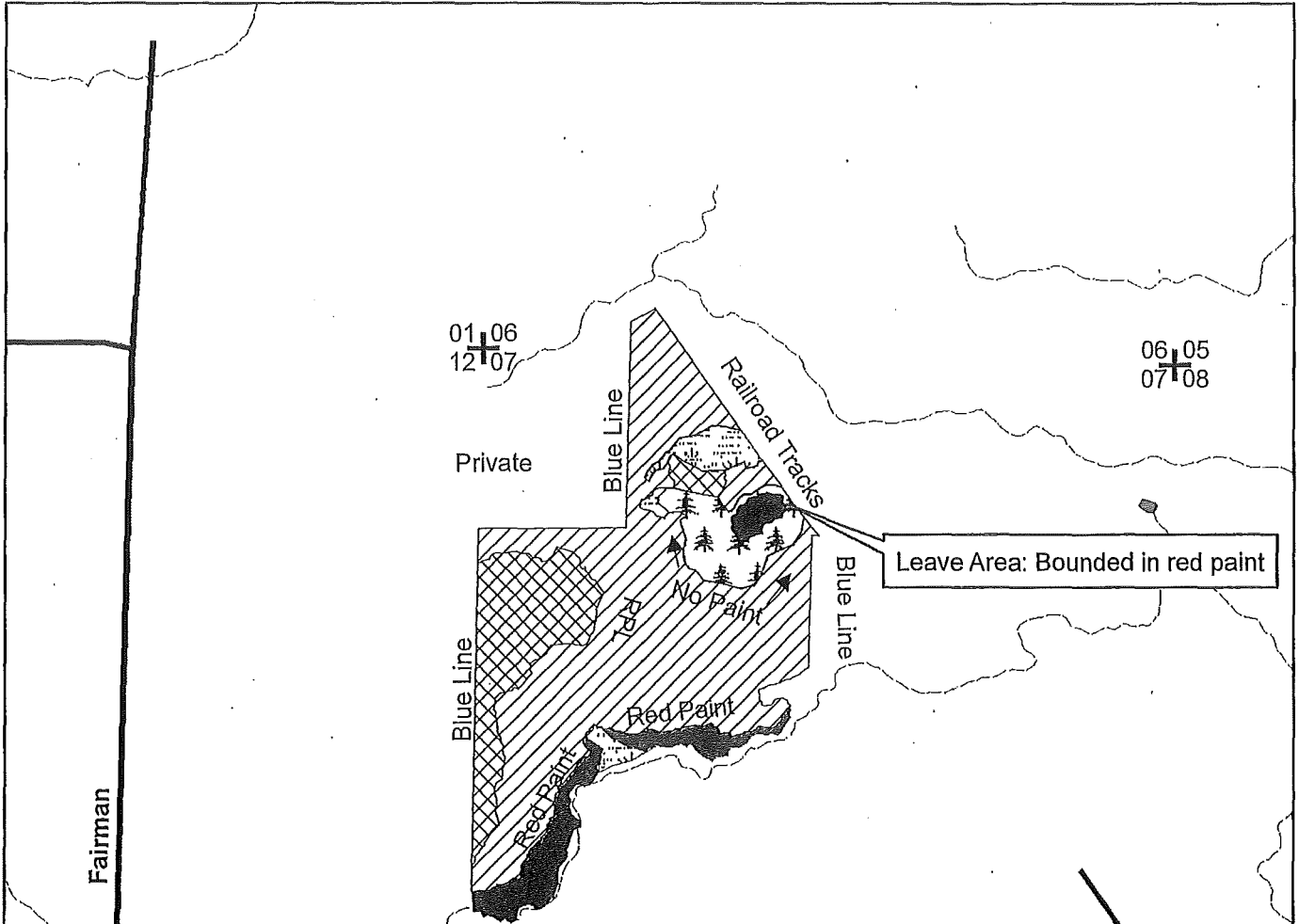

State Lands Timber Sale  
Weirgor Springs Wildlife Property  
SESW Sec. 6, NENW, S1/2NW, W1/2SW Sec. 7  
T.37N R.7W  
Town of Weirgor, Sawyer County, WI  
Tract H 01-14                      132 acres

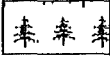

### Legend

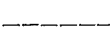
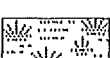
-  Timber Sale Area A (Select Cut)
-  Timber Sale Area B (Clear Cut)
-  Timber Sale Area C (Swamp Conifer Clear Cut)
-  Green Tree Retention/RMZ (No Cut)
-  Streams
-  Swamp

1 inch = 0.25 miles

**Notice:** Completion of this form is mandatory. The Department will not recognize your bid unless you complete and submit this form. Personal information collected will be used for program administration and may be provided to requesters as required by Wisconsin's Open Records law [ss. 19.31-19.39, Wis. Stats.].

Date
------

Bidder Name
-------------

Street Address	City	State	ZIP Code
----------------	------	-------	----------

Property Name (if any)	Tract Number
------------------------	--------------

Date and Hour of Bid Opening	Minimum Acceptable Bid (optional) \$
------------------------------	---

Species-All bids including Lump Sum bids must be by species	Utilization Specifications	Advertised Value Per Unit (optional)	Estimated Volume	Volume Units	Price Bid Per Unit	Total Bid Value on Estimated Volume

The award shall be based on this TOTAL BID AMOUNT:

<b>Performance Bond</b>	Will be in the form of: (select one)
<input type="radio"/> Cash	<input type="radio"/> Assurance Bond
<input type="radio"/> Personal Check	<input type="radio"/> Certificate of Deposit
<input type="radio"/> Certified Check/Money Order	<input type="radio"/> Assignment of Savings Account
<input type="radio"/> Irrevocable Letter of Credit	

I understand that any or all bids may be rejected and that consideration and awarding of a contract will be based upon my past performance and ability to complete contracts. I also understand that if I am the winning bidder, I have 6 weeks from the date of the bid opening to submit an acceptable performance bond. I also understand that if I am awarded the contract and fail to execute it or work under it, I will be required to forfeit to the Department an amount equal to 10% of my total bid amount. Failure to forfeit the 10% penalty will result in being considered ineligible to bid on any state timber sales for a two-year duration.

**Notice:** I understand:

Utilization specifications and estimated volumes are listed in the prospectus which is available upon request from the Department.

A copy of the standard timber sales contract which must be entered into is available upon request from the Department.

Signature of Bidder
Bidder's Name (Please Print or Type)
Phone Number (include area code)
Email Address (optional)