

## Overview

### What's New

- Intel Mobile Pentium® III 1.0 GHz processors with SpeedStep™ technology
- Up to 30GB Hard Drive
- CD-RW on select models
- Enhanced Battery life (up to 4 hours)
- Floppy Disk Drive Cable/Caddy (removed)

### At A Glance

- Intel Mobile Pentium® III 1.0 GHz, 850, 750, 700, MHz processors with Intel SpeedStep™ technology
- Up to 14.1-inch TFT XGA display
- Configurations as light as 4.8 lbs/2.2 kg weight
- 1.2 in/3.048 cm thin
- 128MB or 64MB SDRAM (100MHz), Upgradable to 576 MB
- Up to 30GB SMART hard drives
- User removable hard drive
- Integrated Mini PCI modem/NIC combo on select models
- Full-size keyboard
- Windows 2000/Windows NT 4.0 (Dual Install) or Windows 98 SE
- Protected by a three-year, worldwide limited warranty — Certain restrictions and exclusions apply. Consult the Compaq Customer Support Center for details.

### What's Special

- Thin and light design with integrated MultiBay
- 4.8 lb/2.2 kg light
- 1.2 in/3.048 cm thin
- Magnesium display enclosure
- Dual battery support
- Common docking solutions across the Armada E and M Series
- Industry leading PC lifecycle solutions

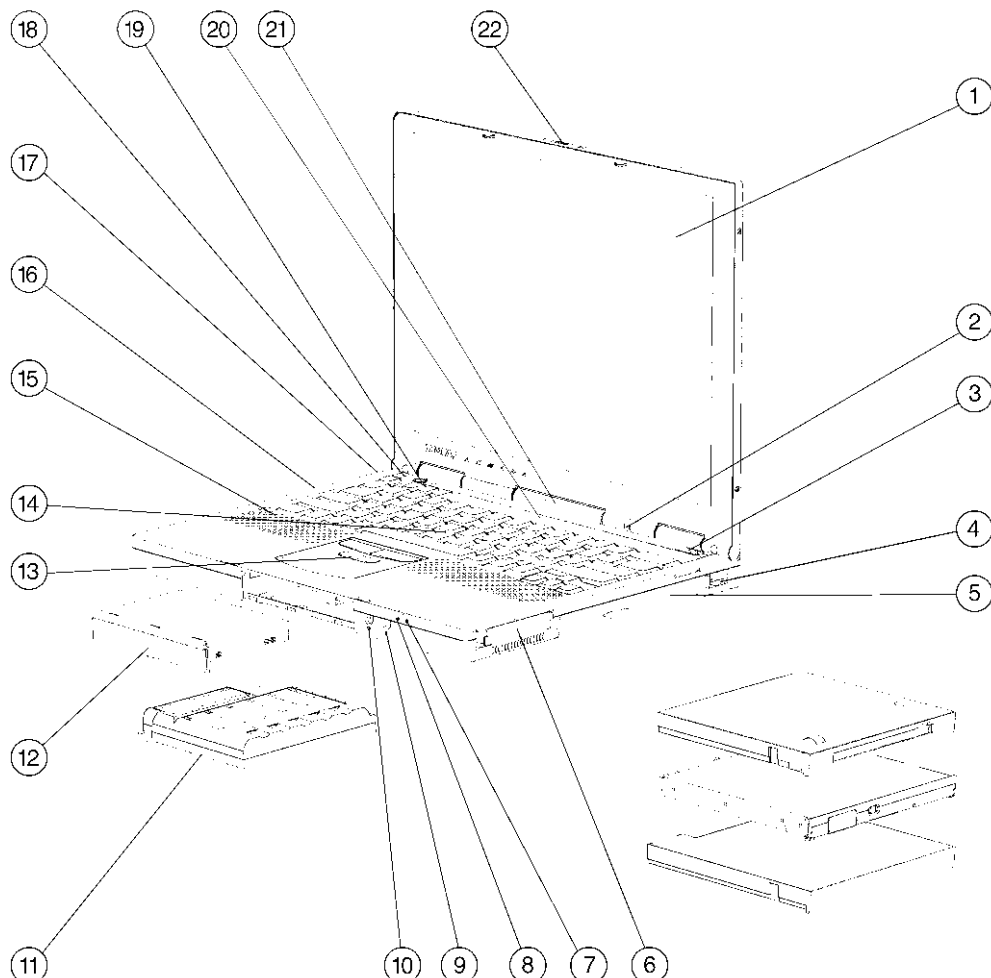

- |  |                                       |
|--|---------------------------------------|
| 1. Color Display   | 10. Stereo Speaker/Headphone-out port |
| 2. Microphone  | 11. Primary Battery                   |
| 3. Power Switch  | 12. Primary Hard Drive                |
| 4. RJ-11/RJ-45 ports   | 13. Left/Right/Third Mouse Buttons    |
| 5. MultiBay (holds 12.7mm diskette drive, CD-RW, 24X CD-ROM, 8X DVD-ROM, SuperDisk 2X LS-120, second battery, second hard drive) | 14. 3D Pointing Device                |
| 6. PC Card Slots (2)   | 15. Stereo Speakers                   |
| 7. Battery Charging Light  | 16. Cable Lock Connector              |
| 8. System-On Light   | 17. NTSC/PAL Video Connector          |
| 9. Microphone-in port  | 18. Lid Switch                        |
|  | 19. Suspend Button                    |
|  | 20. Easy Access Internet Buttons      |
|  | 21. System Status LEDs                |
|  | 22. Display Latch                     |

**COMPAQ**

## Standard Features

<b>Processor and Panel</b>	14.1-inch color TFT XGA with 1024 x 768 resolution (up to 16.7M colors internal)	
<i>One of the following:</i>	1.0 GHz on Intel Mobile Pentium® III processor 850 MHz on Intel Mobile Pentium® III processor 750 MHz on Intel Mobile Pentium® III processor 700 MHz on Intel Mobile Pentium® III processor 650 MHz on Intel Mobile Pentium® III processor	
	13.3-inch color TFT XGA with 1024 x 768 resolution (up to 16.7M colors internal)	
	700 MHz on Intel Mobile Pentium® III processor	
	<i>Note: Mobile Pentium® III processors feature Intel SpeedStep™ technology.</i>	
	<i>Note: Mobile Pentium® III processors feature 256KB integrated cache.</i>	
<b>Memory</b>	Standard 128 MB - 100MHz SDRAM (64MB down on board, 64MB slot one, second slot open)	Maximum 576 MB - 100MHz SDRAM
<i>One of the following:</i>	Standard 64 MB - 100MHz SDRAM (down on board, two slots open)	Maximum 576 MB - 100MHz SDRAM
	<i>Note: Due to the non-industry standard nature of some third-party memory modules, we strongly recommend using only Compaq branded memory modules to ensure compatibility.</i>	
<b>Integrated Communications</b>	Type I Mini PCI	
	Compaq 56K (V.90) Modem or	
	Compaq 56K (V.90) Modem plus 10/100 NIC	
	<i>Note: Designed only to allow faster downloads from V.90 compliant sources. Maximum achievable download transmission rates currently do not reach 56 KB/s, and will vary with line conditions.</i>	
	<i>Note: Modem availability is subject to country regulatory approval</i>	
<b>Keyboard</b>	102-key compatible keyboard with isolated, inverted-T cursor control keys, and right-control key, special feature hotkeys for instant access to power conservation, QuickLock/QuickBlank (ex: FN+F6), toggle between internal and external, or simultaneous displays, battery gauge, speaker volume control, brightness and contrast	
<b>Easy Access Internet Buttons</b>	The Armada M700 comes with four Easy Access Internet Buttons allowing quick access to your most popular Internet sites, files and applications. The buttons come pre-set; however, they are user-customizable and designed to increase productivity by providing one-touch access.	
<b>Pointing Device</b>	EasyPoint IV™ 3D Pointing Stick	
<b>PC Card Slots</b>	Two Type II/One Type III PC Card Slot(s) which support both 32-bit CardBus ( <a href="#">Full support in Windows 9.x and Windows 2000</a> ) and 16-bit PC Cards; zoom video support in bottom slot.	
<b>Storage</b>	Diskette Drives	1.44 MB
		CD-RW Drive
	Optical Drives	8X DVD-ROM Drive
		24X CD-ROM Drive
	Removable Drives	Zip 250 Drive (MultiBay)
		IBM 1GB Micro Drive (PC Card Drive)
	Hard Drives	30-GB SMART Hard Drive
		20-GB SMART Hard Drive
	<i>One of the following:</i>	12-GB SMART Hard Drive
		10-GB SMART Hard Drive

## Standard Features

<b>Multimedia</b>	Compaq <i>Premiere•Sound™</i> for enhanced stereo audio Integrated 16-bit Sound Blaster Pro-compatible stereo audio Integrated stereo speakers and microphone Software volume control Headphone-out Microphone-in Software MPEG1 support, MPEG2 and DVD CD-RW-Drive <i>(on select models)</i> 8X DVD-ROM Drive with movie playback software <i>(on select models)</i> 24X CD-ROM Drive <i>(on select models)</i> RCA CompositeTV-out port 2X AGP graphics 8MB SDRAM	
<b>Interfaces</b>	PC Card Enhanced Parallel EPP/ECP Serial Port TV out connector NTSC/PAL External Monitor PS/2 External Keyboard/Pointing Device  Expansion Base Headphone/Line-out Microphone in DC Power RJ-11 (modem) RJ-45 (NIC) Infrared Port  USB Port LED status indicators	Two Type II/One Type III 1 (can be used to connect external diskette drive) 1 1 1 1 Supports Y-cable in order to attach both Keyboard and Mouse simultaneously 1 1 1 1 1 (Model dependent) 1 (Model dependent) 1 (4 Mb/s support) (IrDA 4 MB compliant. IR performance will vary depending on performance of IR peripherals and application used.) 1 7
<b>Graphics</b>	ATI Mobility Pro, 64-bit video graphics with 8-MB SDRAM for increased color depth and graphics performance	
<b>Operating System</b>	Windows 2000/Windows NT 4.0 (Dual Install) <i>Note: On Dual Install systems, the end user must make a one-time selection at initial start up. End users who need to change to another Operating System (OS) other than the one originally selected must obtain a new license for that OS.</i> Windows 98 SE (Second Edition)	
<b>Software</b>	Compaq Insight Management Agents Compaq Intelligent Manageability Diagnostics for Windows 2000, 9.x or NT DVD Solution Compaq Power Management Compaq Security Management Online Safety and Comfort Guide Fax Central for Windows 2000, 98 and NT Acrobat Reader Reference Guide	
<b>System Recovery</b>	Each unit is shipped with a CD kit for quick recovery (erases hard disk and restores manufacturer installed image) and software recovery (installs only selected standard software)	

## Standard Features

<b>Intelligent Manageability</b>	<p>Compaq Intelligent Manageability, a key component of PC Lifecycle Solutions, is the broad set of manageability features found on all Compaq Deskpro desktops, Armada Notebooks, Professional Workstations and ProLiant server products. These best-in-class features on PC clients comply with industry standards, such as DMI and Wired for Management, while pioneering new ground in client manageability. Compaq introduced the industry's first line of manageable clients in 1995 and has been driving the industry ever since. With Compaq's lifecycle management philosophy, enterprises have all of the pieces for end-to-end management and proven tools for hassle-free management of PCs and significantly lower Total Cost of Ownership.</p> <p>Intelligent Manageability offers solutions in the areas of Initial Configuration and Deployment, Asset Tracking and Security, Software Updating and Management, and Fault Notification and Recovery. For more information, visit our Web site: <a href="http://www.compaq.com/im">www.compaq.com/im</a>.</p>
<b>Security</b>	<p>Configuration Control Hardware Memory Change Alert Ownership Tag Set-up Password Power-On Password DriveLock QuickLock QuickBlank Enabled for PC SmartCard options</p>
<b>Power Supply</b>	External AC adapter, 6-foot power cord included. Total length including External AC adapter is 12 feet (3.66 meters)
<b>Battery</b>	<p>The Armada M700 provides 4 hours of battery life using the standard 8-cell Lilon battery. With the additional 6-cell MultiBay battery installed, battery life may be increased to over 6.25 hours.</p> <p><b>Note:</b> Actual results may vary with product model, configuration, and individual usage. Compaq results of 4:01 (hr:min) were achieved running eTesting Labs Inc.'s BatteryMark™ Test version 4.0.1 on an M700 with an Intel Pentium III 1.0 GHz CPU, 14.1-inch XGA panel, 128 MB RAM, 30 GB HDD, CD-RW, 8-cell Lilon battery, and combination NIC/modem. System parameters were set according to eTesting Lab's recommendations: panel brightness 50%, hard drive standby and video idle time 3 minutes, Intel Speedstep battery optimized mode. The same configuration achieved 6:23 when the CD-RW was replaced with the 6-cell Lilon MultiBay battery.</p> <p><b>Note:</b> This test was performed without independent verification by eTesting Labs Inc. eTesting Labs Inc. makes no representations or warranties as to the result of the test. BatteryMark is a trademark of Ziff Davis Publishing Holdings Inc., and affiliate of eTesting Labs Inc., in the U.S. and other countries.</p>
<b>Power Conservation</b>	<p>Intel SpeedStep™ technology allows a Battery Optimized Mode where CPU draws 50% of normal power yet affords 70 to 80 % of maximum PIII processing speed)</p> <p>Hibernation Instant-On via Standby Pop-ups with three presets One custom level of power conservation ACPI compliant</p>
<b>MultiBay Devices</b>	MultiBay devices may be swapped with the system powered on (hot) or in suspend mode (warm) under Windows 98 SE or Windows 2000 (except MultiBay Zip drive or MultiBay secondary hard drive). MultiBay devices can be swapped with system power off under any supported operating system.
<b>Service and Support</b>	<p>Compaq Services includes a three-year, Worldwide Limited Warranty, pick-up or carry-in, upgrade to on-site warranty or additional two-year warranty available, and toll-free 7 x 24 hardware technical phone support.</p> <p><b>Note:</b> Certain restrictions and exclusions apply. Consult the Compaq Customer Support Center for details.</p>

## Standard Features

### Naming Convention

The Etymology of a Model name:

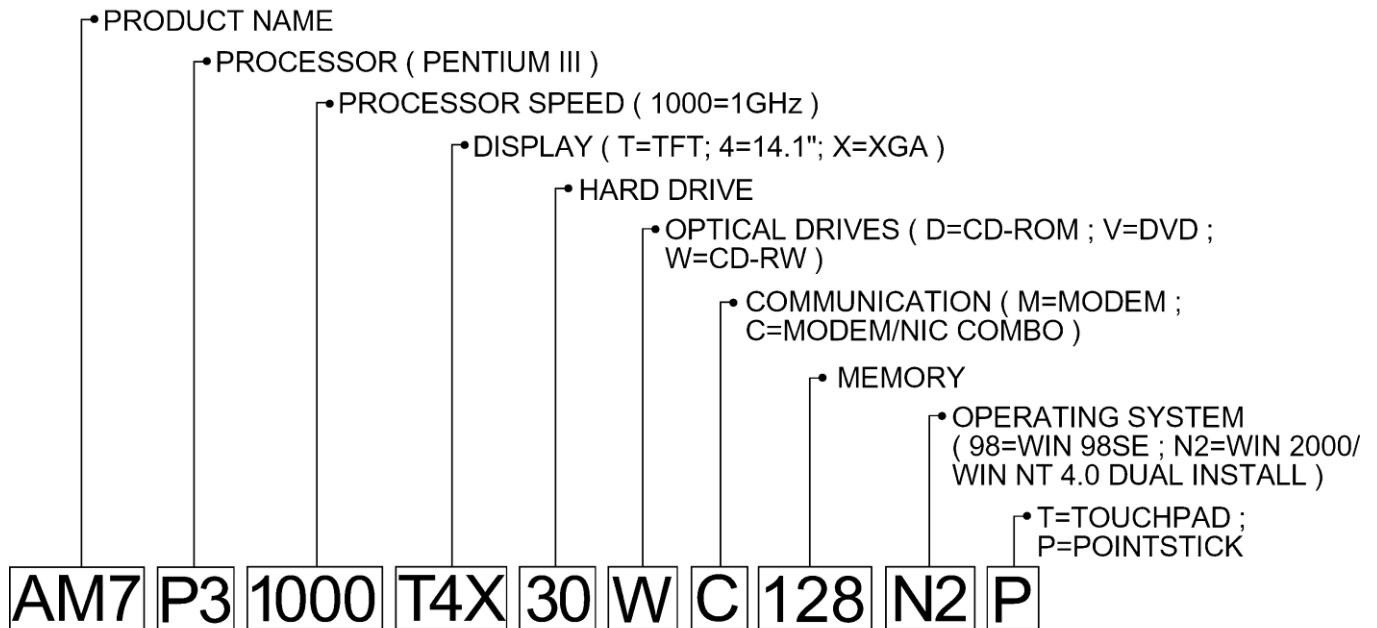

## Standard Features

### Models

<b>AM7P31000T4X30WC128N2P</b> 470011-802	<b>Display</b>	14.1-inch color TFT XGA
	<b>Processor</b>	Intel Pentium III 1.0 GHz
	<b>Cache Memory</b>	256-KB integrated
	<b>Memory</b>	Standard 128 MB SDRAM
		Maximum 576 MB SDRAM
	<b>Optical Drive</b>	CD-RW Drive IDE
	<b>Hard Drive</b>	30-GB SMART
	<b>Modem</b>	Mini-PCI V.90 modem/10/100 TX NIC Combo
	<b>Graphics</b>	64-bit video graphics with 8-MB SDRAM
	<b>Audio</b>	Compaq Premier•Sound™
	<b>Software</b>	Windows 2000/NT4.0 (Dual Install)

<b>AM7P31000T4X30WC12898P</b> 470011-801	<b>Display</b>	14.1-inch color TFT XGA
	<b>Processor</b>	Intel Pentium III 1.0 GHz
	<b>Cache Memory</b>	256-KB integrated
	<b>Memory</b>	Standard 128 MB SDRAM
		Maximum 576 MB SDRAM
	<b>Optical Drive</b>	CD-RW Drive IDE
	<b>Hard Drive</b>	30-GB SMART
	<b>Modem</b>	Mini-PCI V.90 modem/10/100 TX NIC Combo
	<b>Graphics</b>	64-bit video graphics with 8-MB SDRAM
	<b>Audio</b>	Compaq Premier•Sound™
	<b>Software</b>	Windows 98 SE

<b>AM7P31000T4X20VC128N2P</b> 470011-813	<b>Display</b>	14.1-inch color TFT XGA
	<b>Processor</b>	Intel Pentium III 1.0 GHz
	<b>Cache Memory</b>	256-KB integrated
	<b>Memory</b>	Standard 128 MB SDRAM
		Maximum 576 MB SDRAM
	<b>Optical Drive</b>	8X DVD-ROM Drive IDE
	<b>Hard Drive</b>	20-GB SMART
	<b>Modem</b>	Mini-PCI V.90 modem/10/100 TX NIC Combo
	<b>Graphics</b>	64-bit video graphics with 8-MB SDRAM
	<b>Audio</b>	Compaq Premier•Sound™
	<b>Software</b>	Windows 2000/NT4.0 (Dual Install)

<b>AM7P31000T4X20VC12898P</b> 470011-791	<b>Display</b>	14.1-inch color TFT XGA
	<b>Processor</b>	Intel Pentium III 1.0 GHz
	<b>Cache Memory</b>	256-KB integrated
	<b>Memory</b>	Standard 128 MB SDRAM
		Maximum 576 MB SDRAM
	<b>Optical Drive</b>	8X DVD-ROM Drive IDE
	<b>Hard Drive</b>	20-GB SMART
	<b>Modem</b>	Mini-PCI V.90 modem/10/100 TX NIC Combo
	<b>Graphics</b>	64-bit video graphics with 8-MB SDRAM
	<b>Audio</b>	Compaq Premier•Sound™
	<b>Software</b>	Windows 98 SE

## Standard Features

**AM7P3850T4X20VC128N2P**  
470006-422

<b>Display</b>	14.1-inch color TFT XGA
<b>Processor</b>	Intel Pentium III 850 MHz
<b>Cache Memory</b>	256-KB integrated
<b>Memory</b>	Standard 128 MB SDRAM Maximum 576 MB SDRAM
<b>Optical Drive</b>	8X DVD-ROM Drive IDE
<b>Hard Drive</b>	20-GB SMART
<b>Modem</b>	Mini-PCI V.90 modem/10/100 TX NIC Combo
<b>Graphics</b>	64-bit video graphics with 8-MB SDRAM
<b>Audio</b>	Compaq Premier•Sound™
<b>Software</b>	Windows 2000/ NT4.0 (Dual Install)

**AM7P3850T4X20VC12898P**  
470006-421

<b>Display</b>	14.1-inch color TFT XGA
<b>Processor</b>	Intel Pentium III 850 MHz
<b>Cache Memory</b>	256-KB integrated
<b>Memory</b>	Standard 128 MB SDRAM Maximum 576 MB SDRAM
<b>Optical Drive</b>	8X DVD-ROM Drive IDE
<b>Hard Drive</b>	20-GB SMART
<b>Modem</b>	Mini-PCI V.90 modem/10/100 TX NIC Combo
<b>Graphics</b>	64-bit video graphics with 8-MB SDRAM
<b>Audio</b>	Compaq Premier•Sound™
<b>Software</b>	Windows 98 SE

**AM7P3750T4X12VC128N2P**  
206647-008

<b>Display</b>	14.1-inch color TFT XGA
<b>Processor</b>	Intel Pentium III 750 MHz
<b>Cache Memory</b>	256-KB integrated
<b>Memory</b>	Standard 128 MB Maximum 576 MB
<b>Optical Drive</b>	8X DVD-ROM Drive IDE
<b>Hard Drive</b>	12-GB SMART
<b>Modem</b>	Mini-PCI V.90 modem/10/100 TX NIC Combo
<b>Graphics</b>	64-bit video graphics with 8-MB SDRAM
<b>Audio</b>	Compaq Premier•Sound™
<b>Software</b>	Windows 2000/NT 4.0 (Dual Install)

**AM7P3750T4X12VC6498P**  
206647-002

<b>Display</b>	14.1-inch color TFT XGA
<b>Processor</b>	Intel Pentium III 750 MHz
<b>Cache Memory</b>	256-KB integrated
<b>Memory</b>	Standard 64 MB Maximum 576 MB
<b>Optical Drive</b>	8X DVD-ROM Drive IDE
<b>Hard Drive</b>	12-GB SMART
<b>Modem</b>	Mini-PCI V.90 modem/10/100 TX NIC Combo
<b>Graphics</b>	64-bit video graphics with 8-MB SDRAM
<b>Audio</b>	Compaq Premier•Sound™
<b>Software</b>	Windows 98 SE

## Standard Features

<b>AM7P3700T4X12VC64N2P</b> 205862-008	<b>Display</b>	14.1-inch color TFT XGA
	<b>Processor</b>	Intel Pentium III 700 MHz
	<b>Cache Memory</b>	256-KB integrated
	<b>Memory</b>	Standard 64 MB
		Maximum 576 MB
	<b>Optical Drive</b>	8X DVD-ROM Drive IDE
	<b>Hard Drive</b>	12-GB SMART
	<b>Modem</b>	Mini-PCI V.90 modem/10/100 TX NIC Combo
	<b>Graphics</b>	64-bit video graphics with 8-MB SDRAM
	<b>Audio</b>	Compaq Premier•Sound™
	<b>Software</b>	Windows 2000/ NT4.0 (Dual Install)

<b>AM7P3700T4X12VC6498P</b> 205862-002	<b>Display</b>	14.1-inch color TFT XGA
	<b>Processor</b>	Intel Pentium III 700 MHz
	<b>Cache Memory</b>	256-KB integrated
	<b>Memory</b>	Standard 64 MB
		Maximum 576 MB
	<b>Optical Drive</b>	8X DVD-ROM Drive IDE
	<b>Hard Drive</b>	12-GB SMART
	<b>Modem</b>	Mini-PCI V.90 modem/10/100 TX NIC Combo
	<b>Graphics</b>	64-bit video graphics with 8-MB SDRAM
	<b>Audio</b>	Compaq Premier•Sound™
	<b>Software</b>	Windows 98 SE

<b>AM7P3700T4X12VM64N2P</b> 205861-008	<b>Display</b>	14.1-inch color TFT XGA
	<b>Processor</b>	Intel Pentium III 700 MHz
	<b>Cache Memory</b>	256-KB integrated
	<b>Memory</b>	Standard 64 MB
		Maximum 576 MB
	<b>Optical Drive</b>	8X DVD-ROM Drive IDE
	<b>Hard Drive</b>	12-GB SMART
	<b>Modem</b>	Mini-PCI V.90 modem
	<b>Graphics</b>	64-bit video graphics with 8-MB SDRAM
	<b>Audio</b>	Compaq Premier•Sound™
	<b>Software</b>	Windows 2000/ NT4.0 (Dual Install)

<b>AM7P3700T4X12VM6498P</b> 205861-002	<b>Display</b>	14.1-inch color TFT XGA
	<b>Processor</b>	Intel Pentium III 700 MHz
	<b>Cache Memory</b>	256-KB integrated
	<b>Memory</b>	Standard 64 MB
		Maximum 576 MB
	<b>Optical Drive</b>	8X DVD-ROM Drive IDE
	<b>Hard Drive</b>	12-GB SMART
	<b>Modem</b>	Mini-PCI V.90 modem
	<b>Graphics</b>	64-bit video graphics with 8-MB SDRAM
	<b>Audio</b>	Compaq Premier•Sound™
	<b>Software</b>	Windows 98 SE



### Standard Features

**AM7P3700T3X10DC64N2P**  
470006-992

<b>Display</b>	13.3-inch color TFT XGA
<b>Processor</b>	Intel Pentium III 700 MHz
<b>Cache Memory</b>	256-KB integrated
<b>Memory</b>	Standard 64 MB SDRAM Maximum 576 MB SDRAM
<b>Optical Drive</b>	24X CD-ROM Drive IDE
<b>Hard Drive</b>	10-GB SMART
<b>Modem</b>	Mini-PCI V.90 modem/10/100 TX NIC Combo
<b>Graphics</b>	64-bit video graphics with 8-MB SDRAM
<b>Audio</b>	Compaq <i>Premier•Sound™</i>
<b>Software</b>	Windows 2000/ NT4.0 (Dual Install)

**AM7P3700T3X10DC6498P**  
470006-990

<b>Display</b>	13.3-inch color TFT XGA
<b>Processor</b>	Intel Pentium III 700 MHz
<b>Cache Memory</b>	256-KB integrated
<b>Memory</b>	Standard 64 MB SDRAM Maximum 576 MB SDRAM
<b>Optical Drive</b>	24X CD-ROM Drive IDE
<b>Hard Drive</b>	10-GB SMART
<b>Modem</b>	Mini-PCI V.90 modem/10/100 TX NIC Combo
<b>Graphics</b>	64-bit video graphics with 8-MB SDRAM
<b>Audio</b>	Compaq <i>Premier•Sound™</i>
<b>Software</b>	Windows 98 SE

## Options

<b>Memory</b>	256-MB 100MHz Memory Upgrade	161554-B21
	128-MB 100MHz Memory Upgrade	400313-B21
	64-MB 100MHz Memory Upgrade	400312-B21
	(Due to the non-industry standard nature of some third-party Memory modules, we strongly recommend using only Compaq branded Memory modules to ensure compatibility.)	
<b>Monitors</b>	TFT8020 Flat Panel Color 18-inch (carbon)	159244-001
	TFT5010 Flat Panel Color 15-inch (carbon)	154486-001
	TFT 5005 Flat Panel Color 15-inch (carbon)	201430-001
	S710 17-inch CRT (carbon)	154499-002
	S510 15-inch CRT (carbon)	168636-002
<b>MultiBay Hard Drives</b>	30-GB SMART Hard Drive	212791-B25
	20-GB SMART Hard Drive	212790-B25
	10-GB SMART Hard Drive	212789-B25
<b>MultiBay Storage Devices</b>	Zip 250 Drive	217387-B25
	CD-RW Drive	136186-B25
	8X DVD-ROM Drive	138320-B25
	24X CD-ROM Drive	298452-B25
	2X Superdisk LS-120 Drive	197895-B25
	IBM 1GB Microdrive (PC card Device)	217390-B25
<b>Connectivity</b>	1394 PC Card	177593-B25
	Compaq 56K (V.90) Modem plus 10/100 NIC Type II Mini PCI Card	149373-001
	For additional compatible PC Cards, view the Compaq PC Card Solutions List on the Compaq Web site at: <a href="http://www.compaq.com/support/techpubs/pcmcia/">http://www.compaq.com/support/techpubs/pcmcia/</a>	
	Note: Designed only to allow faster downloads from V.90 compliant sources. Maximum achievable download transmission rates currently do not reach 56 KB/s, and will vary with line conditions.	
<b>Wireless Connectivity</b>	Compaq WL100 11 Mb/s Wireless LAN PC Card	146927-001
	Compaq WL400 11 Mb/s Wireless LAN Hardware Access Point	158603-001
	Compaq WL 300 Software Access Point 11Mb/s	157209-B21
	For more information on Compaq WLAN Wireless LAN solutions visit: <a href="http://www.compaq.com/products/wlan/wl100-specifications.html">http://www.compaq.com/products/wlan/wl100-specifications.html</a>	

## Options

<b>Expansion Bases</b>	ArmadaStation EM	383500-001
	ArmadaStation EM with NIC	120266-001
	ArmadaStation Tower Stand	123129-B25
	Convenience Base EM	382500-001
	Convenience Base EM with NIC	120971-001
	Convenience Base Monitor Stand	122931-B25
	Port Replicator EM	382300-001
	PCI IBM Token Ring Card	133749-B21
	PCI Cardbus Reader	127397-B25
<b>Power</b>	Primary Battery (8-cells)	134111-B21
	Common Armada Power Solutions – Armada E500, Armada M300 and Armada M700	
	MultiBay Battery (6-cells)	387937-B25
	External Battery Charger	135555-001
	AC Adapter 50W	120765-001
	Auto Power Adapter/Charger	401043-B25
	Aircraft Power Adapter	386504-B21
	AC Line Cord (10-ft/3.1 m)	217932-002
<b>Input Devices</b>	External Enhanced III Keyboard (carbon)	118003-008
	Compaq 2 Button Mouse (carbon)	103180-B21
	USB Mouse	195255-B25
	External 10-Key Numeric Keypad (carbon)	294317-B21
<b>Security</b>	Biometrics PC Card	146805-B25
	Security Cable Lock	294316-B21
	Compaq Smart Card PC Card Reader	135646-B25
<b>Invaluable Accessories</b>	Compaq Armada Headset with microphone	220460-001
	MP1400 Microportable Projector	174626-001
	MP1800 Microportable Projector	180226-001
	MP2800 Microportable Projector	180228-001
	Multimedia Adapter & Remote Kit ( <i>comes with the MP1800, optional for the MP1400</i> )	174963-001
	MP1600 Video Adapter	116298-001
	MP1600 Lamp replacement kit	118052-001
	MP1800/1400 Lamp replacement kit	189789-001
	MP2800 Lamp replacement kit	215464-001

---

## Options

Carrying Cases	Compaq Value Case	294266-B21
	Compaq Workstation Case	294267-B21
	Compaq Global Case	294268-B21
	Compaq Professional Case (nylon)	401366-B21
	Compaq Professional Case (leather)	401367-B21
	<b><i>Armada M300 and Armada M700 specific</i></b>	
	Compaq M Series Portfolio Case	167337-B21
	Compaq Ultralight Case	167336-B21
For additional Compaq Brand cases, call 1-800-888-5903.		

## Memory

### Compaq Armada M700

#### STANDARD MEMORY

64-MB SDRAM installed on the System Board

Memory		Slot 1	Slot 2
Standard	64 MB	Empty	Empty
	128 MB	64 MB	Empty

#### STANDARD MEMORY PLUS OPTIONAL MEMORY

Support for up to 576 MB of SDRAM memory is available with the installation of optional SDRAM Memory Kits in addition to the 64-MB SDRAM on the System Board.

Memory		Slot 1	Slot 2
Up To	192 MB	64 MB	64 MB
	256 MB	64 MB	128 MB
	320 MB	128 MB	128 MB
	384 MB	64 MB	256 MB
	384 MB	256 MB	64 MB
	448 MB	128 MB	256 MB
	576 MB	256 MB	256 MB

Note: This chart does not represent all possible memory configurations.

Following are memory options available from Compaq:

- 256-MB 100 MHz Memory Upgrade 161554-B21
- 128-MB 100 MHz Memory Upgrade 400313-B21
- 64-MB 100 MHz Memory Upgrade 400312-B21

Note: Due to the non-industry standard nature of some third-party memory modules, we strongly recommend using only Compaq branded memory modules to ensure compatibility.

## Storage

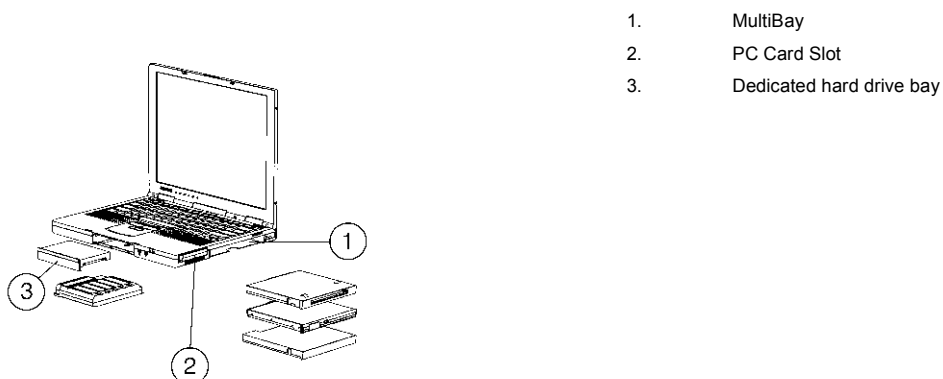

## DRIVE SUPPORT

System Drive Support	Quantity Supported	Drive Bay Supported
<b>Removable Media</b>		
1.44-MB Diskette Drive	1	MultiBay
CD-RW Drive	1	MultiBay
8X DVD-ROM Drive	1	MultiBay
24X CD-ROM Drive	1	MultiBay
2X SuperDisk LS-120	1	MultiBay
Zip 250 Drive	1	MultiBay
IBM 1GB Micro Drive (PC Card Drive)	2	PC Card Slot
<b>Hard Drives</b>		
30-GB SMART Hard Drive	2	Dedicated hard drive bay
20-GB SMART Hard Drive	2	Dedicated hard drive bay
12-GB SMART Hard Drive	2	Dedicated hard drive bay
10-GB SMART Hard Drive	2	Dedicated hard drive bay

## Technical Specifications

<b>System Unit</b>	<b>Dimensions (HxWxD)</b>	14.1-inch TFT panel display	12.4 x 9.8 x 1.2 in/31.4 x 24.9 x 3.048 cm
		13.3-inch TFT panel display	12.4 x 9.8 x 1.2 in/31.4 x 24.9 x 3.048 cm
<b>Weight</b>		14.1-inch TFT panel display/weight saver	5.1 lbs/2.3 kg
		13.1-inch TFT panel display/weight saver	4.8 lbs/2.2 kg
<b>Stand-Alone Power Requirements</b>	Nominal Operating Voltage (Li-Ion)	14.4V (8-cell), 10.8V (6-cell)	
	Average Operating Power	15W	
	Peak Operating Power	30W	
<b>Power Supply</b>	Rated Input Voltage	90 to 264 VAC (auto-switching)	
	Rated Input Current	< 60W	
	Rated Frequency	47 to 63 Hz	
<b>Temperature</b>	Operating	50° to 95° F/10° to 35° C	
	Non-operating	-4° to 140° F/-20° to 60° C	
<b>Relative Humidity</b>	Operating	10% to 90% relative humidity, non-condensing	
	Non-operating	5% to 95% relative humidity, 101.6° F/38.7° C Maximum wet-bulb temperature	
<b>Shock</b>	Operating	10 G, 11 ms, half-sine	
	Non-operating	60 G, 11 ms, half-sine	
<b>Vibration</b>	Operating	0.5 G zero-to-peak, 10 to 500 Hz, 0.25 oct/minimum sweep rate	
	Non-operating	1.0 G, zero-to-peak, 10 to 500 Hz, 0.5 oct/minimum sweep rate	
<b>Maximum Altitude (unpressurized)</b>	Operating	0 to 10,000 ft/(0 to 3,048 m)	
	Non-operating	0 to 30,000 ft/(0 to 9,144 m)	

## Technical Specifications

<b>14.1-Inch Color TFT XGA Display</b>	<b>Dimensions (HxW)</b>	11.22 x 8.46 in/28.5 x 21.5 cm	
	<b>Diagonal Size</b>	14.1 in/35.81 cm	
	<b>Mounting</b>	Internal Panel Supports, Side Mounted	
	<b>Number of Colors</b>	Up to 16.8M	
	<b>Contrast Ratio</b>	150:1	
	<b>Brightness</b>	120nt typ	
	<b>Pixel Resolution</b>	Pitch	0.264 x 0.264 mm
		Format	1024 x 768
		Configuration	RGB stripe
	<b>Backlight</b>	Edge Lit	
	<b>Character Display</b>	80 x 25	
	<b>Total Power Consumption</b>	4.2W	
<b>13.3-Inch Color TFT XGA Display</b>	<b>Dimensions (HxW)</b>	10.6 x 8 in/26.9 x 20.3 cm	
	<b>Diagonal Size</b>	13.3 in/33.8 cm	
	<b>Mounting</b>	Internal Panel Support	
	<b>Number of Colors</b>	Up to 16.8M	
	<b>Contrast Ratio</b>	150:1	
	<b>Brightness</b>	120nt typ	
	<b>Pixel Resolution</b>	Pitch	0.264 x 0.264 mm
		Format	1024 x 768
		Configuration	RGB Stripe
	<b>Backlight</b>	Edge Lit	
	<b>Character Display</b>	80 x 25	
	<b>Total Power Consumption</b>	4.2W	



## Technical Specifications

### Hard Drives

<b>30GB</b>	<b>Capacity</b>	30 GB	
	<b>Height</b>	0.5 in/12.7 cm	
	<b>Width</b>	2.75 in/70 mm	
	<b>Interface</b>	ATA-5	
	<b>Transfer Rate</b>	Synchronous (Maximum)	66.6 MB/s
		Security	ATA Security
	<b>Seek Time</b> (typical reads, including settling)	Single Track	2.5 ms
		Average	12 ms
		Maximum	23 ms
	<b>Rotational Speed</b>	4200 rpm	
	<b>Logical Blocks</b>	58,605,120	
	<b>Operating Temperature</b>	41° to 131° F/5° to 55° C	
<b>20GB</b>	<b>Capacity</b>	20 GB	
	<b>Height</b>	0.374 in/9.5 mm in/12.5 mm	
	<b>Width</b>	2.75 in/70 mm	
	<b>Interface</b>	ATA-5	
	<b>Transfer Rate</b>	Synchronous (Maximum)	66.6 MB/s (Drive Capability)
		Security	ATA Security
	<b>Seek Time</b> (typical reads, including settling)	Single Track	2.5 ms
		Average	12 ms
		Maximum	23 ms
	<b>Rotational Speed</b>	4200 rpm	
	<b>Logical Blocks</b>	~ 39,070,080	
	<b>Operating Temperature</b>	41° to 131° F/5° to 55° C	
<b>12GB</b>	<b>Capacity</b>	12 GB	
	<b>Height</b>	0.5 in/12.7 cm	
	<b>Width</b>	2.75 in/70 mm	
	<b>Interface</b>	ATA-4	
	<b>Transfer Rate</b>	Synchronous (Maximum)	66.6 MB/s (Drive Capability)
		Security	ATA Security
	<b>Seek Time</b> (typical reads, including settling)	Single Track	2.5 ms
		Average	12 ms
		Maximum	23 ms
	<b>Rotational Speed</b>	4200 rpm	
	<b>Logical Blocks</b>	23,579,136	
	<b>Operating Temperature</b>	41° to 131° F/5° to 55° C	

## Technical Specifications

### Hard Drives *(continued)*

<b>10GB</b>	<b>Capacity</b>	10 GB	
	<b>Height</b>	0.5 in/12.7 cm	
	<b>Width</b>	2.75 in/70 mm	
	<b>Interface</b>	ATA-4	
	<b>Transfer Rate</b>	Synchronous (Maximum)	66.6 MB/s (Drive Capability)
		Security	ATA Security
	<b>Seek Time</b> (typical reads, including settling)	Single Track	3 ms
		Average	12 ms
		Maximum	23 ms
	<b>Rotational Speed</b>	4200 rpm	
	<b>Logical Blocks</b>	~ 19,792,896	
	<b>Operating Temperature</b>	41° to 131° F/5° to 55° C	

<b>Diskette Drive</b>	<b>Diskette Size</b>	3.5 in	
	<b>Activity Indicator</b>	On system	
	<b>Height</b>	0.5 in/12.7 mm	
	<b>Bytes per Sector</b>	512	
	<b>Sectors per track</b>	High density	18 (1.44 MB)/15 (1.2 MB)
		Low density	9
	<b>Tracks per side</b>	High density	80 (1.44 MB)/80 (1.2 MB)
		Low density	80
	<b>Read/Write heads</b>	2	
	<b>Access Times</b>	Track-to track (high/low)	3 ms/6 ms
		Average (high/low)	94 ms/174 ms
		Settling time	15 ms
		Latency average	100 ms

## Technical Specifications

<b>External AC Adapter</b>	<b>Dimensions (HxWxD)</b>	1.15 x 2.375 x 1.4 in/2.92 x 6.03 x 3.6 cm	
	<b>Weight</b>	0.66 lb/0.3 kg	
	<b>Power Supply (Input)</b>	Operating Voltage	90 to 260 VAC RMS
		Operating Current	1.1 A RMS
		Operating Frequency Range	47 to 63 Hz AC
		Maximum Transient	4/50 kV
<b>Li-Ion Battery Pack (8-cell)</b>	<b>Dimensions (HxWxD)</b>	4.79 X 4.17 X 0.79 in/121.7 x 106 x 20 mm	
	<b>Weight</b>	0.97 lb/0.44 kg	
	<b>Energy</b>	Voltage	14.8 V
		Amp-hour capacity	3.2 Ah
		Watt-hour capacity	47.4Wh
	<b>Temperature</b>	Operating	32° to 104° F/0° to 40° C
		Non-operating	32° to 140° F/0° to 60° C
<b>CD-RW Drive</b>	<b>Center Hole Diameter</b>	0.59 in/1.5 cm	
	<b>Disk Diameter</b>	12 cm/8 cm	
	<b>Disk Thickness</b>	0.047 in/1.2 mm	
	<b>Track Pitch</b>	0.74 µm	
	<b>Access Times</b> (typical reads, including settling)	Random	< 150 ms
		Full-Stroke	< 225 ms
	<b>Audio Output Level</b>	Line-out	0.7 Vrms
	<b>Cache Buffer</b>	128 KB/s (minimum)	
	<b>Data Transfer Rate</b> (typical, including settling)	Sustained (16X)	150 KB/s
		Sustained 4X DVD	5,520 KB/s
		Normal PIO Mode 4 (single burst)	16.6 MB/s
	<b>Start-up Time</b>	< 15 sec	
	<b>Stop Time</b>	< 6 sec	

## Technical Specifications

8X DVD-ROM Drive	<b>Center Hole Diameter</b>	0.59 in/1.5 cm
	<b>Disc Diameter</b>	12 cm/8 cm
	<b>Disc Thickness</b>	1.2 mm
	<b>Track Pitch</b>	0.74 $\mu$ m
	<b>Access Times</b> (typical reads, including settling)	Random (typical) < 180 ms DVD Media
		Full-Stroke (typical) < 300 ms DVD Media
		Random (typical) < 120 ms CD Media
		Full-Stroke (typical) < 200 ms CD Media
	<b>Cache Buffer</b>	128 KB/s (minimum)
	<b>Data Transfer Rate</b> (typical, including settling)	Max 24X CD 3600 KB/s (150 KB/s at 1X CD rate)
		Max 8X DVD 10,800 KB/s (1352 KB/s at 1X DVD rate)
		Normal PIO Mode 4 (single burst) 16.6 MB/s
	<b>Start-up Time</b>	< 15 sec
	<b>Stop Time</b>	< 6 sec
24X CD-ROM Drive	<b>Applicable Disk</b>	CD-ROM (Mode 1, 2 and 3), CD-XA ready (Mode 2, Form 1 and 2), CD-I ready (Mode 2, Form 1 and 2), CD-R (read only), CD Plus, Photo CD (Single and Multi-session), CD-Extra, Video CD, CD-WO (fixed packets only), CD-Bridge
	<b>Center Hole Diameter</b>	0.59 in/1.5 cm
	<b>Disk Diameter</b>	12 cm, 8 cm
	<b>Disk Thickness</b>	0.047 in/1.2 mm
	<b>Track Pitch</b>	1.6 $\mu$ m
	<b>Access Times</b> (typical reads, including settling)	Random < 150 ms
		Full-Stroke < 300 ms
	<b>Audio Output Level</b>	Line-out 0.7 Vrms
	<b>Cache Buffer</b>	128 KB
	<b>Data Transfer Rate</b> (typical, including settling)	Sustained (16X) 150 KB/s (sustained 1X)
		Variable 1500 to 3600 KB/s (10X to 24X)
		Normal PIO Mode 4 (single burst) 16.66 MB/s
	<b>Start-up Time</b>	< 8 sec
	<b>Stop Time</b>	< 4 sec

## Technical Specifications

Intel PRO/100+ Mini PCI	<b>Ethernet Features</b>	10 Mb/s Ethernet: IEEE 802.3 standard 10Base T 100 Mb/s Ethernet: IEEE 802.3u standard 100Base TX Full Duplex at 10 and 100Mb/s Auto-Negotiation Wake on LAN from all power managed states, including soft off (S5) Boot on LAN from OFF Lower Power State on Link Loss
	<b>Data Link Layers</b>	IEEE 802.2 LLC SNAP
	<b>Software support</b>	Artisoft Lantastic 7.0, 8.0, Dedicated Server 1.1 Banyan 7.x, 8.5x IBM LAN Server Version 1.2, 1.3, 2.0, 4.0 Microsoft NT 3.51, NT 4.0. Windows 2000 Novell Netware 3.1x, 4.x, 5.x
	<b>Protocol support</b>	TCP/IP Novell IPX/SPX and Microsoft compatible Novel IPX ODI Microsoft NetBEUI Sun Microsystems PC-NFS Banyan Vines Ethernet IBM DLC

## Technical Specifications

<b>Compaq 56K(V.90) plus Intel PRO/100+ Mini PCI</b>	<b>Form Factor</b>	Mini-PCI Type 1B per Specification
	<b>OS Support</b> (with all released Service Packs)	Windows 95 (OSR2.x), Windows 98 SE (Gold, SE), Windows NT4.0, Windows 2000, DOS Application Support under Windows
	<b>Power Management Support</b>	APM Revision 1.2, ACPI, Compaq Power Management Extensions for Windows NT
	<b>Approvals/Certifications</b>	UL, CSA, NEMKO, CCIB, Industry Canada, FCC Part 68, CTR21, FCC Part 15 Class B, Canadian ICES-003 Class B, C.I.S.P.R.22, Australian ACA, CE Mark, Other Countries
	<b>Modem Device Driver Name</b>	Compaq 56K (V.90) Mini PCI
	<b>Data Mode Capabilities</b>	V.90 (a-law, mu-law) K56flex (a-law, mu-law) V.8bis V.80 V42.bis, MNP5 (Compression) V.42 (LAPM, MNP2-4) (Error Correction) V.34 (file date: 10/96) Optional symbol rates: 2800, 3429 Asymmetric Symbol rates Synchronous primary channel data signaling rates: 3600, 31200 Automatic rate re-negotiation V.32bis V.32 V.23 V.22bis V.22 V.21 Bell 212A Bell 103J
	<b>Fax Mode Capabilities</b>	TIA-578-S (Class 1) T.30, T.4 (Group 3) V.17 V.29 V.27ter V.21 Channel 2
	<b>Command Set</b>	V.250 (Partial) TIA-602 Identification: +GMI, +GMM, +GMR Port control: +IPR, +ICF, +IFC, +lirr Modulation: +MS, +MR, +MA Error control: +ES, +ER, +EB, +ESR, +ETBM Data compression: +DS, +DR V.251

Compaq PCs use genuine Microsoft® Windows®

[www.Microsoft.com/privacy/howtotell](http://www.Microsoft.com/privacy/howtotell)

Microsoft and Windows are trademarks of Microsoft Corporation in the U.S. and other countries.