



It's prime time.

NEWEA 2016 Annual Conference & Exhibit

January 24–27, 2016 | Boston Marriott Hotel, Copley Place, Boston, Massachusetts

Exhibitor Prospectus

New England Water Environment Association
10 Tower Office Park, Suite 601
Woburn, MA 01801-2155
(T) 781-939-0908 (F) 781-939-0907
WWW.NEWEA.ORG | mail@newea.org





DEAR EXHIBITOR:

We invite you to join the New England Water Environment Association (NEWEA) in Boston, MA, January 24–27, 2016 for the 2016 Annual Conference & Exhibit, which brings together water quality professionals to exchange ideas, learn and debut cutting-edge technology and innovative products.

The NEWEA Annual Conference & Exhibit is the **LARGEST WATER QUALITY CONFERENCE** held in New England. This event will attract more than 2,000 attendees, providing your company the best opportunity to **ATTRACT NEW PROSPECTS, INTRODUCE NEW PRODUCTS** and give **PRODUCT DEMONSTRATIONS TO BUYERS** in the water industry. The conference features 30+ technical sessions and one centrally-located Exhibit Area on two interconnected floors with more than 200 booths.

BOOK EARLY TO SAVE MONEY AND SECURE YOUR EXHIBIT SPACE!

Be among those who take advantage of this opportunity and book your booth space by September 11 (postmarked) to receive the discounted booth fee. Booths are assigned based on past years of participation **FOR ALL APPLICATIONS RECEIVED BY SEPTEMBER 11, 2015**

If you need more information, please contact Amy Anderson, Exhibits Chair, at 781-213-4901 or amy.anderson@arcadis-us.com or speak to a staff member at the NEWEA office at 781-939-0908 or mail@newea.org.

WE LOOK FORWARD TO YOUR PARTICIPATION IN THE 2016 NEWEA ANNUAL CONFERENCE AND EXHIBIT!

Thank you!

Gain Additional Exposure

Get additional valuable exposure and increase awareness for your company by becoming a conference sponsor; participating in the exhibitor directory (printed and online); or by placing ads in the NEWEA Journal.

About NEWEA

Established in 1929, the New England Water Environment Association is a dynamic organization of more than 2100 water quality professionals who are dedicated to the preservation of water quality and water resources throughout New England.

AS AN EXHIBITOR, YOU GET FREE PROMOTION IN NEWEA'S PUBLICATIONS!

- Conference Announcement
- Online Exhibitor Directory—www.newea.org
- A listing in the **NEWEA JOURNAL**
- Official Conference Program and Exhibitor Directory
- Web Announcements

In order to have your company listing appear in the publications, space reservation must be received by the preregistration deadline and space fees must be current.



EXHIBIT AT THE LARGEST WATER QUALITY SHOW

BOOTH EQUIPMENT AND SERVICE INFORMATION

The Exhibit Area will be centrally located on the 3rd and 4th floors interconnected by an internal stairwell at the Boston Marriott Copley Place Hotel. Exhibits will be open Monday through Wednesday.

Each booth space rented will include the following:

- One 10' W x 8' D exhibit booth, ceiling is 8' high (exhibit area is carpeted)
- 8' high back drape and 3' high side rails
- One 2' x 6' draped and skirted table
- 7" x 44" exhibitor identification sign
- Two folding chairs and wastebasket
- Admission for FOUR representatives, which include:
 - Two full access badges (admittance to Exhibit Area AND technical sessions)
 - Two exhibit badges (admittance to Exhibit Area only)
 - Admission to the Monday and Tuesday Evening Receptions
- Free Exhibit Hall Passes - Good for Wednesday, January 27, 2016

***ADDITIONAL EXHIBIT HALL PASSES AND EVENT TICKETS MAY BE PURCHASED SEPARATELY ONSITE.**

Electricity, other utility connections and materials are not provided with the space. Order forms for these items are available through the official exhibit service contractor. Please note that electricity is ordered through the hotel. Exhibitors will be notified electronically by the official service contractor when the service manual is available. NEWEA assumes no responsibility or liability for any of the foregoing services performed and materials delivered.

EXHIBITORS RATES & FEES

	"Discount" Registration*	Standard Registration
Exhibit Booth (10'W x 8'D)	\$1250.00	\$1500.00

*Exhibitor application must be postmarked on or before Friday, September 11, 2015 to qualify for the discounted registration

APPLICATION/ASSIGNMENT OF SPACE

Reserve your space online at www.newea.org or complete the enclosed Exhibitor Space Application. Confirmations will be emailed upon receipt of successful applications!

Booth reservations will be assigned in date receipt order. **PREFERENCE IS GIVEN ON PAST PARTICIPATION FOR APPLICATIONS RECEIVED BY THE SEPTEMBER 11, 2015 DEADLINE ONLY.** If the requested space is not available, the most comparable space will be assigned. Booth assignments will be forwarded to the exhibitors within a reasonable time prior to the exposition.

SIGN UP EARLY FOR 2017

Exhibitors who display at the 2016 Annual Conference will have an opportunity to reserve the same booth for the 2017 Annual Conference. Sign up will take place on Wednesday, January 27, 2016 at 1:00 PM. Watch for more details!

EXHIBIT HALL SCHEDULE

Sunday, January 24, 2016	
12:00 Noon–6:00 PM	Exhibitor Set-up (3rd floor)
2:00 PM–6:00 PM	Exhibitor Set-up (4th floor)-tentative*
Monday, January 25, 2016	
8:00 AM–10:00 AM	Exhibitor Set-up
10:30 AM–6:30 PM	Exhibit Area Open
4:30 PM–6:30 PM	Exhibit Reception (3 rd floor)
Tuesday, January 26, 2016	
8:00 AM–6:30 PM	Exhibit Area Open
4:30 PM–6:30 PM	Exhibit Reception (4 th floor)
Wednesday, January 27, 2016	
8:30 AM–1:00 PM	Exhibit Area Open (Open to public)
11:00 AM–1:00 PM	Exhibit Brunch (3 rd & 4 th floors)
1:00 PM–3:00 PM	Exhibitor Breakdown
*THE EXACT TIMES FOR EXHIBITOR SET-UP WILL BE FINALIZED IN THE CONFIRMATION EMAIL FROM NEWEA.	



EXHIBITOR BENEFITS

The New England Water Environment Association's 2016 Annual Conference & Exhibit in Boston will be a gathering of water quality professionals who are committed to preserving, protecting and managing the water environment. The Exhibit Area will showcase products, services and educational opportunities for water quality professionals.

Exhibit space entitles you to many benefits and services:

- Dedicated exhibit time, including receptions, coffee breaks and brunch (Wed.) held in the Exhibit Area.
- Recognition as an exhibitor in the official conference program.
- Complimentary listing in the online exhibitor directory.
- One centrally-located Exhibit Area on two floors.
- Complimentary final registration list for Annual Conference 2015.
- Exhibit Area raffles and cash drawings.
- Sponsorship opportunities to promote your company.
- Four complimentary badges to attend the conference.
- Entertainment stations located around the Exhibit Area.
- Free Exhibit Hall Passes - Good for Wednesday, January 27, 2016

TECHNICAL PROGRAM — HEAR THE LATEST TOPICS AND TRENDS IN THE INDUSTRY

Take advantage of more than 30+ technical sessions and keep your employees abreast of new trends in the industry! Session include: Alternative Project Delivery, Asset Management, Collection Systems, CSO, Energy, Government Affairs, Industrial Wastewater, Informational Technology and Automation, Laboratory Practices, Microconstituents, Plant Operations, Public Education, Research, Residuals Management, Safety, Small Community Outreach, Stormwater, Sustainability, Utility Management, Water for People, Water Reuse, Watershed Management and Young Professionals.

NETWORK WITH OTHER WATER QUALITY PROFESSIONALS

The Annual Conference & Exhibit is the largest water quality conference in New England. Its ongoing success can be attributed to its attendees and exhibitors. The conference continues to draw all types of water professionals in the industry. Whether you want to network with an educator, plant operator, engineer, or scientist, we've got you covered.

Annual Conference* Registrants' Primary Job Functions

105	Educators and Students
242	Engineering and Design Staff
201	Engineering, Laboratory, Operations Management
824	Purchasing/Marketing/Sales
235	Operations
199	Other (Regulators, Public Officials, etc.)
50	Scientific and Research Staff

*Data from 2015 Annual Conference

Annual Conference Attendance Figures

	2010	2011	2012	2013	2014	2015
Attendees	1049	1033	1088	1091	1084	1032
Exhibitors	728	760	820	812	840	824
Total Attendance	1777	1793	1908	1903	1924	1856



EXHIBIT TERMS — OFFICIAL RULES AND REGULATIONS

1. LOCATION OF EXHIBITS: The exposition will be held at the Marriott Copley Place Hotel, Boston, Massachusetts. All measurements and booth layouts shown on the floor plan are as accurate as possible, but the New England Water Environment Association (NEWEA) reserves the right to make such modifications and changes in booth assignments as may be necessary to adjust the floor plan at any time to meet the needs of NEWEA, its Attendees and Exhibitors.

2. EXHIBITOR EQUIPMENT AND SERVICES: Standard booth size is 10'W x 8'D with a ceiling height of 8' high unless otherwise noted on the floorplan. Each booth will include one 6' draped table, two chairs, wastebasket, side-rails and drape backdrop for each booth in addition to one company identification sign. Exhibitors shall notify the NEWEA office with any specific requests pertaining to oversized equipment or other items. NEWEA holds the right to deny exhibitors permission to show specific pieces of equipment, displays, etc., based on dimensions and/or weight.

3. APPLICATIONS: Applicants must use the Exhibit Space Application to request a booth space. Payments must accompany the application and contract. Return Exhibit Space Applications to NEWEA by fax (781-939-0907) or mail to: NEWEA, 10 Tower Office Park, Suite 601, Woburn, MA 01801 or online at www.newea.org.

4. ASSIGNMENT OF SPACE: Priority of space assignments will be based upon availability on a first-come, first-served basis as determined by the date of receipt of Exhibit Space Application with preference given based on past participation **FOR THOSE APPLICATIONS RECEIVED BY THE SEPTEMBER 11TH DEADLINE** (refer to exhibit space application). Exhibitors who wish to avoid assigned space adjacent to that of another exhibitor should so indicate on the application. Exhibitors who desire assignment next to each other should submit their applications together; however, each will need to submit a separate application form. Booth assignment letters will be forwarded to the exhibitors within a reasonable time prior to the Exposition.

5. EXHIBITOR SERVICE MANUAL: The manual will be posted online and will contain order forms and shipping instructions from the official service contractor for your booth space. The service contractor will notify exhibitors electronically prior to the Exposition. Note: electricity is ordered through the hotel.

6. INSTALLATION OF EXHIBITS:

Sunday, January 24, 12 Noon–6:00 PM (3rd floor)

Sunday, January 24, 2:00–6:00 PM (4th floor)

Monday, January 25, 8:00–10:00 AM

All exhibits must be set up by 10:00 AM on January 25, 2016.

7. EXHIBIT HOURS:

Monday, January 25, 10:30 AM–6:30 PM

Tuesday, January 26, 8:00 AM–6:30 PM

Wednesday, January 27, 8:30 AM–1:00 PM

8. DISMANTLING OF EXHIBITS: No packing or dismantling of exhibits will be allowed until the official closing of the exhibit area at 1:00 PM on Wednesday, January 27. **FAILURE TO ABIDE BY THIS POLICY WILL RESULT IN LOSS IN BOOTH SELECTION PREFERENCE PRIORITY FOR THE 2017 ANNUAL CONFERENCE.** All exhibits must be removed from the exhibit area by 4:00 PM on Wednesday, January 27. Materials not removed by this time will be put in storage at the Exhibitor's expense. There is no space available for storage of empty cartons, crates, etc. Arrangements may be made with the exhibit service contractor for storage.

9. EXHIBIT SET-UP AND DISMANTLING, including unloading and loading of materials and equipment, is governed by Boston Union Guidelines. Hand Carry - Exhibitors may hand carry one item, one time, in or out of the facility without having to access the loading dock. Hand-carried is defined as one item that can be easily carried by an individual, without the need for dollies or other mechanized equipment weighing less than 30 lbs. Unions claim jurisdiction under all other circumstances. Privately Owned Vehicles— Exhibitors may load and unload: Automobiles, Station Wagons, Mini Vans, SUV's, Pick-Up Trucks and Vans. Exhibitors may use their own equipment limited to carts, dollies, and hand trucks. Exhibitors can not use motorized or hydraulic devices. Any vehicle requiring dock use is under Union jurisdiction.

10. EXHIBIT FACILITY: The Exhibitor assumes responsibility and liability for losses, damages and claims arising out of injury or damage to the Exhibitors' displays, equipment and other property brought upon the premises of the Boston Marriott Copley Place Hotel and shall indemnify and hold harmless the Hotel and NEWEA and their agents, servants and employees from any and all such losses, damages and claims. There is no other agreement or warranty between the Exhibitor and NEWEA except as set forth in this document. The rights of NEWEA under this contract shall not be deemed waived except as specifically stated in writing and signed by an authorized officer of NEWEA.

11. SECURITY AND INSURANCE: NEWEA will provide security service from 12:00 Noon, January 24, 2016 through 3:00 PM January 27, 2016 during the hours when the exhibit area is not open to the public. However, the Exhibitor is solely and fully responsible for his/her own exhibit material and should insure his/her exhibit against loss or damage from any causes whatsoever. Security for booths outside of the Exhibit Hall will be limited as booths outside of Exhibit Hall are accessible during periods when the exhibits are not open. All property of the Exhibitor is understood to remain in its care, custody, and control in transit to or from or within the confines of the Boston Marriott Copley Place Hotel.

12. CARE OF BUILDING AND EQUIPMENT: Exhibitors, or Agents, must not injure or deface the walls or floors of the building, the booths, or the equipment of the booths. When such damage appears, the Exhibitor is liable to the owner of the property so damaged. All materials used in decorations must be flameproof. Electric wiring must conform to Electric Code Safety Rules, and all applicable fire laws, electrical codes and other laws, which affect the installation, conduct and disassembly of the exhibit. Combustible material or explosives are not permitted in the exhibit hall. The Exhibitor shall also comply with all reasonable requests of officials of the Boston Marriott Copley Place Hotel with respect to installation, conduct and disassembly of its exhibit.

13. CANCELLATION OF EVENT: In the event that it is necessary to cancel a portion of or all of the NEWEA 2016 Annual Conference and/or the exhibits, due to any cause beyond the direct control of NEWEA including, but not limited to damage to or destruction of the convention and exhibit building, labor strikes, adverse weather conditions, the Exhibitor shall be reimbursed only for actual direct costs not incurred by NEWEA.

14. CANCELLATION OF EXHIBIT REGISTRATION: In the event that an Exhibitor desires to cancel a reservation, NEWEA must receive a request for cancellation in writing and a refund will only be granted if NEWEA is able to fill the reserved booth with a replacement Exhibitor.



EXHIBIT SPACE APPLICATION

(Register online at www.newea.org)

EXHIBITING COMPANY: INFORMATION PROVIDED WILL APPEAR ON BADGES, PROGRAM, WEBSITE, AND EXHIBITOR DIRECTORY.

☐ Check if business address has changed

Company Name (exactly as it should appear in listings, badges, program)

Former Company Name (provide if name changed within last 5 years)

Address

City, State, Zip

Business Phone Number

Business Fax Number

Website

CONTACT INFORMATION: ALL FUTURE INSTRUCTIONS AND EXHIBIT BOOTH INFORMATION WILL BE SENT TO THE CONTACT PERSON.

☐ Check if contact name has changed

Contact Name

Contact Address

City, State, Zip

Contact Phone Number

Contact Email

Questions? Contact NEWEA at 781-939-0908 or mail@newea.org

BOOTH PREFERENCE: BOOTHS ARE 10'W X 8'D AND CEILING HEIGHT IS 8' HIGH EXCEPT AS NOTED ON THE FLOOR PLAN. LIST PREFERRED BOOTH(S) INCLUDING MULTIPLES BELOW:

1st

2nd

3rd

4th

5th

ASSIGNMENT OF BOOTH: BOOTHS WILL BE ASSIGNED UPON AVAILABILITY ON A FIRST-COME, FIRST-SERVED BASIS AS DETERMINED BY THE DATE OF RECEIPT OF APPLICATION WITH PREFERENCE GIVEN BASED ON PAST PARTICIPATION FOR THOSE APPLICATIONS RECEIVED BY SEPTEMBER 11TH IN ACCORDANCE WITH THE FOLLOWING SCHEDULE (CHECK ONE):

☐ More than 25 years ☐ 25 to 21 years ☐ 20 to 16 years ☐ 15 to 11 years ☐ 10 to 6 years ☐ 5 to 1 years ☐ New registrants

BOOTH LOCATION: (SPECIAL REQUESTS AND IF ANY, LIST COMPANIES THAT YOU PREFER NOT TO BE LOCATED NEAR)

Is Booth Location more important to your company than being near a company you prefer NOT to be? ☐ Yes ☐ No

1. _____ 2. _____

Use the space below to indicate any special requests (e.g. to be located next to another company, etc.). Requests are not guaranteed.

PAYMENT INFORMATION	"DISCOUNT" REGISTRATION Postmarked ON or BEFORE Friday, September 11, 2015	REGISTRATION Postmarked AFTER Friday, September 11, 2015	# OF BOOTHS REQUESTED (limit 10 booths)	TOTAL
BOOTH REGISTRATION	\$1250.00	\$1500.00		
<input type="checkbox"/> Check (payable to NEWEA)	Check number:		Amount Enclosed/To be charged:	
<input type="checkbox"/> Credit Card (MC, Visa, AMEX, Discover)	Credit Card Number:			
	Exp. Date:	Signature:		

Registrations may be completed online at newea.org or sent by fax when paying with credit card.
Fax registrations to NEWEA at **781-939-0907** or Mail to: **NEWEA, 10 TOWER OFFICE PARK, SUITE 601, WOBURN, MA 01801-2155**

CONTRACT TERMS AND CONDITIONS:

- This agreement shall be made and effective only upon acceptance by both NEWEA and the exhibitor. NEWEA reserves all rights to the Exhibit and may reject any and all proposed agreements or make reassignments as necessary.
- The exhibitor agrees to abide by all terms, conditions, and regulations set forth in the "Exhibit Terms - Official Rules and Regulations."

Authorized Signature (Contract is not valid without signature) _____ Date: _____

Print Name of Signature: _____

OFFICE USE ONLY	
Date Received	Booth #
Entered	Confirmation Sent

NEW ENGLAND WATER ENVIRONMENT ASSOCIATION

JANUARY 25 - 27, 2016
MARRIOTT COPLEY PLAZA - LEVEL 3
BOSTON, MASSACHUSETTS

LEGEND

- FE = FIRE EXTINGUISHER
- FFS = FIRE ALARM STROBE
- FHC = FIRE HOSE CABINET
- *NOTE: ALL FIRE EQUIPMENT MUST BE EXPOSED AT ALL TIMES
- E = WALL MOUNTED ELECTRICAL BOX



ELECTRICAL COMES FROM THE WALLS, COLUMNS AND WALL MOUNTED BOXES

CEILING HEIGHTS

AS NOTED ON FLOOR PLAN
7'9" TO UNDERSIDE OF FIRE STROBES
CEILING HEIGHT BENEATH LOW PIPING AS NOTED

Inventory as of 02/20/2015

Dimension	Size	Qty	SqFt
8x10'	80	95	7,600
10x10'	100	7	700
Totals:	102	8,300	

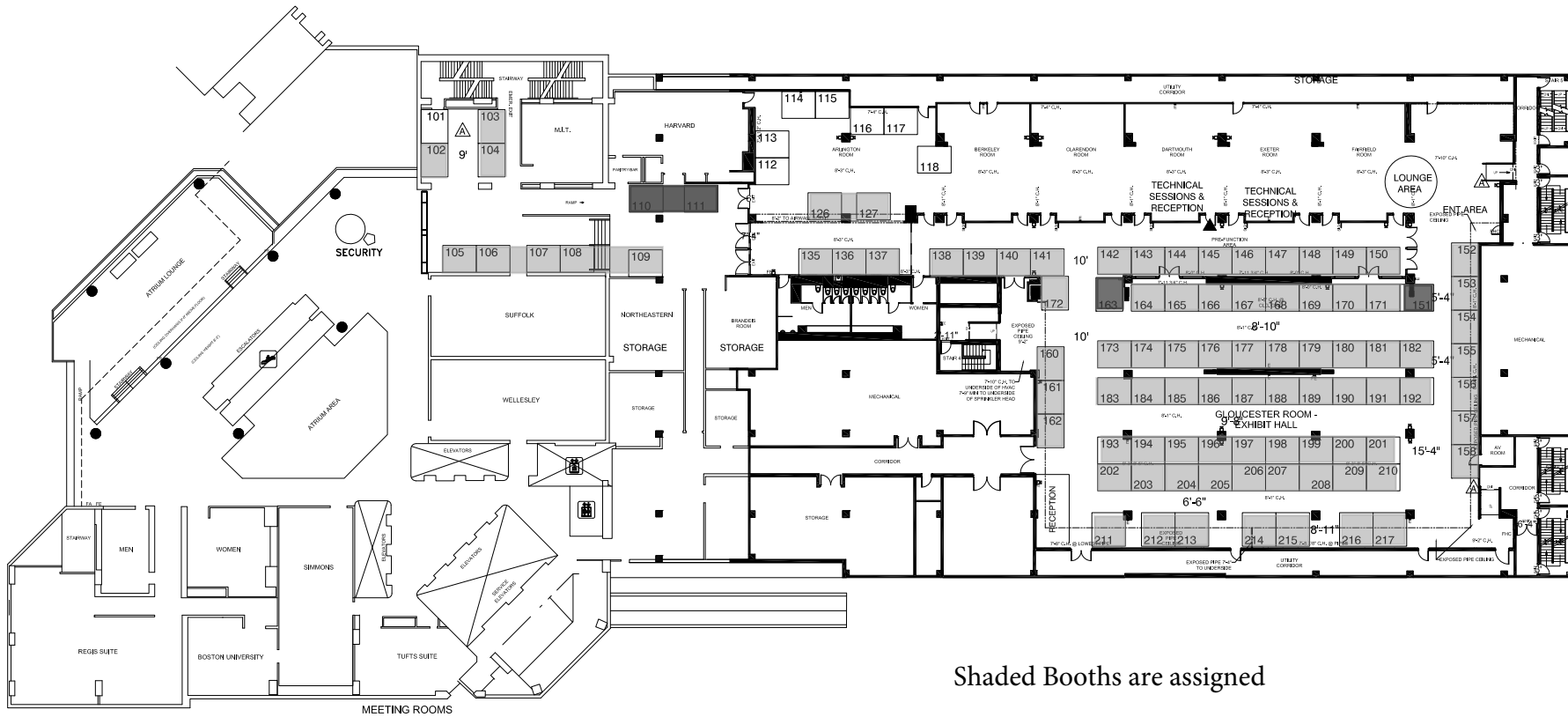

Shaded Booths are assigned

Drawing Started on: 02/20/15 JS		
REVISIONS		
NUMBER	DATE	INITIAL
1	00/00/00	00
2	00/00/00	00
3	00/00/00	00
4	00/00/00	00
5	00/00/00	00

FREEMAN BOSTON

NORTH EAST REGIONAL DESIGN CENTER	
File Name:	NEWEA16_LVL3
Show Name:	NEWEA 2016
Show Dates:	January 25 - 27, 2016
Facility:	Marriott Copley Plaza Hotel
Job Number:	TBD
Acct. Exec.:	Ashley Agostino
Acct. Loc.:	Freeman Boston

DISCLAIMER
EVERY EFFORT HAS BEEN MADE TO ENSURE THE ACCURACY OF ALL INFORMATION CONTAINED ON THIS FLOOR PLAN. HOWEVER NO WARRANTIES, EITHER EXPRESSED OR IMPLIED ARE MADE WITH RESPECT TO THIS FLOOR PLAN. IF THE LOCATION OF BUILDING COLUMNS, UTILITIES OR OTHER ARCHITECTURAL COMPONENTS OF THE FACILITY IS A CONSIDERATION IN THE CONSTRUCTION OR USAGE OF AN EXHIBIT, IT IS THE SOLE RESPONSIBILITY OF THE EXHIBITOR TO PHYSICALLY INSPECT THE FACILITY TO VERIFY ALL DIMENSIONS AND LOCATIONS.
© COPYRIGHT 2007, FREEMAN CO. ALL RIGHTS RESERVED.

NEW ENGLAND WATER ENVIRONMENT ASSOCIATION

JANUARY 26 - 28, 2015
MARRIOTT COPLEY PLAZA - LEVEL 4
BOSTON, MASSACHUSETTS

New Exhibitor Location

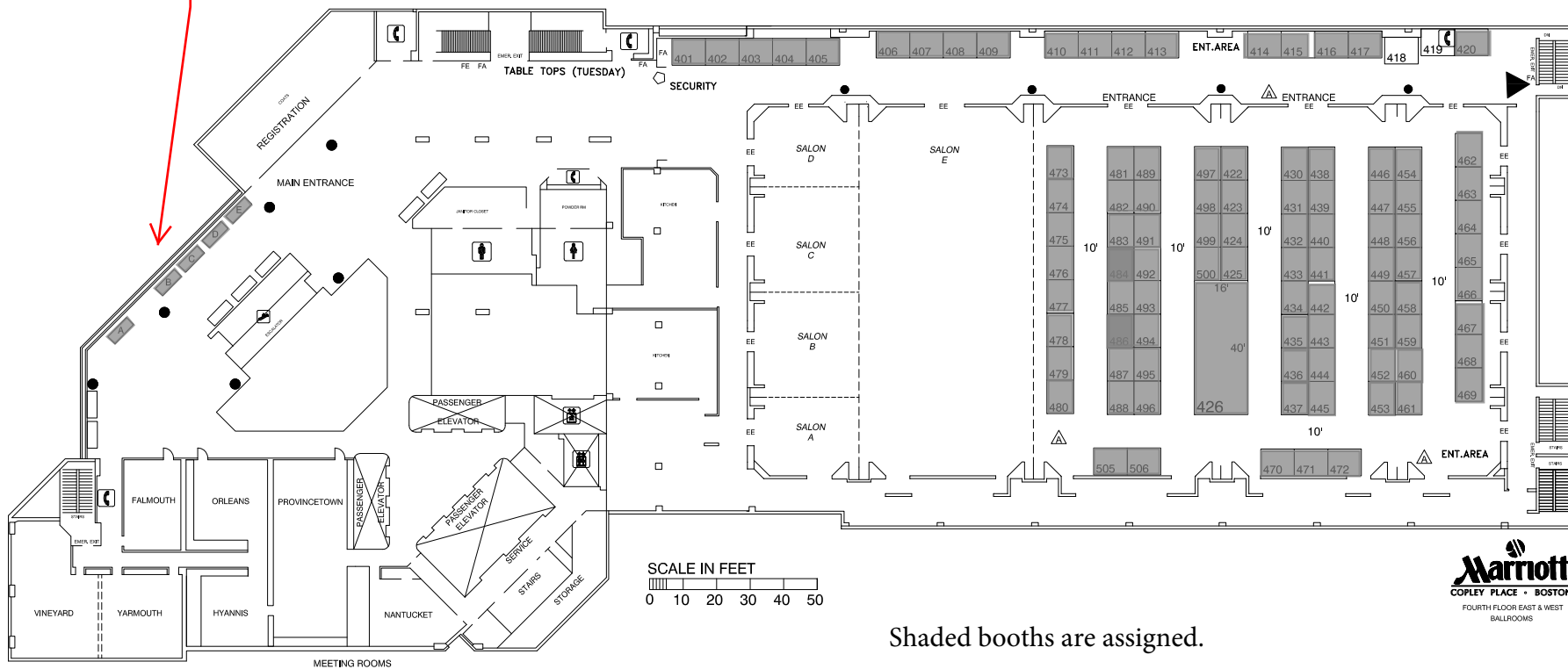

Shaded booths are assigned.

LEGEND:

- = 2'6" DIA. COLUMN
- FA = FIRE ALARM
- FE = FIRE EXTINGUISHER
- ♂ = MEN'S REST ROOM
- ♀ = WOMEN'S REST ROOM
- ⬆ = PASSENGER ELEVATOR
- ⬆ = FREIGHT ELEVATOR
- ⬆ = ESCALATOR
- ☎ = TELEPHONE

CEILING HEIGHTS:

SALONS A-D & H-K 14'
SALONS E-G 17'5"-22'

Inventory as of 01/15/2015

Dimension	Size	Qty	SqFt
8x10'	80	97	7,760
16'x40'	640	1	640
Totals:	98	8,400	

Drawing Started on:	12/17/14	CS
REVISIONS		
NUMBER	DATE	INITIAL
1	01/15/15	CS
2	09/00/00	00
3	00/00/00	00
4	00/00/00	00
5	00/00/00	00

FREEMAN
BOSTON

NORTH EAST REGIONAL
DESIGN CENTER

File Name:	NEWEA15 Lvl 4 FP
Show Name:	NEWEA 2015
Show Dates:	January 26 - 28, 2015
Facility:	Marriott Copley Plaza Hotel
Job Number:	410333
Acct. Exec:	Ashley Agostino
Acct. Loc:	Freeman Boston

DISCLAIMER

EVERY EFFORT HAS BEEN MADE TO ENSURE THE ACCURACY OF ALL INFORMATION CONTAINED ON THE FLOORPLAN. HOWEVER NO WARRANTIES, EITHER EXPRESSED OR IMPLIED ARE MADE WITH RESPECT TO THIS FLOORPLAN. IF THE LOCATION OF BUILDING COLUMNS, UTILITIES OR OTHER ARCHITECTURAL COMPONENTS OF THE FACILITY IS A CONSIDERATION IN THE CONSTRUCTION OR USAGE OF AN EXHIBIT, IT IS THE SOLE RESPONSIBILITY OF THE EXHIBITOR TO PHYSICALLY INSPECT THE FACILITY TO VERIFY ALL DIMENSIONS AND LOCATIONS.

©COPYRIGHT 2007, FREEMAN CO.
ALL RIGHTS RESERVED.



NEWEA WOULD LIKE TO THANK THEIR 2015 ANNUAL CONFERENCE EXHIBITORS & SPONSORS!

Last year's conference was very successful with more than 1,856 registrants and 206 exhibit booths displaying the latest products and services for the water quality industry. Companies from every region of the country as well as Canada were represented.

2015 LIST OF EXHIBITORS

ACF Environmental
ADS Environmental Services
Advanced Drainage Systems, Inc.
Aerisa
Aero-Mod
AllMax Software, Inc.
Amiad
ANUA
AP/M CentriPipe
APG-Neuros
Aqua-Aerobic
Aqua Solutions, Inc.
Aquagen Infrastructure Systems, Inc.
Aquaturno Systems, Inc.
Aquionics
ARCH Chemicals, Inc.
Aries Industries, Inc.
ASA Analytics
Asahi/America, Inc.
Assmann Tanks/Ayer Sales, Inc.
Associated Electro-Mechanics, Inc.
Atlantic Fluid Technology, Inc.
Autrol America
BAU/HOPKINS
BDP Industries, Inc.
Bilfinger Airvac Water Technologies
Bio Organics Catalyst, Inc.
BioSec Enviro, Inc.
BISCO Pump Systems
Blake Equipment Co.
Blue Water Technologies, Inc.
BMC Corporation
Brentwood
Burt Process
Butterworth, Inc.
C.N. Wood Co., Inc.
Cabot Norit Activated Carbon
Calgon Carbon UV Technologies
Carl Lueders & Company, Inc.
Carlsen Systems, LLC
Carter Pump
Casella Organics
Cerlic Controls NE (CCNE)
Chester Engineers
Claro Global
ClearStream Environmental
Continental Carbon Group
Coyne Chemical Environmental Svcs.
Cretex Specialty Products
CUES
D.L. Thurrott, Inc.
Danfoss VLT Drives
David F. Sullivan and Associates, Inc.
DeZURIK, Inc.
DN Tanks
Duall Division
Duke's Root Control, Inc.
Duperon Corporation
Dutchland
Eastern Pipe Service, LLC
EcoVerde
Electroswitch Corp.
Enduro Composites, Inc.
Entex Technologies, LTD
Environmental Dynamics International
Environmental One

Environmental Operating Solutions
EPOXYTEC
eRPortal Software Group, LLC
EST Associates, Inc.
Esteem Wireless Modems
ETS-UV by Neptune Benson
Evoqua Water Technologies
F.R. Mahony & Associates, Inc.
F.W. Webb Co.
Fairfield Service Co.
Fay, Spofford & Thorndike
Fiber Technology Corporation
Fiberglass Fabricators Inc
Flottweg Separation Technology Inc
Flow Assessment Services LLC
FlowWorks, Inc.
Flygt Products
Ford Hall Company
Fournier Industries, Inc.
Franklin Miller, Inc.
G.L. Lyons Associates
Gabriel Novac & Associates Ltd.
Gardner Denver Nash LLC
GE Water & Process Technologies
Geomembrane Technologies Inc.
Godwin Pumps of America
Grande Water Management Systems
Green Mountain Pipeline Services
Grundfos Pumps Corporation
Hach Company
Hach Flow
Hanna Instruments
Hayes Pump, Inc.
Hazen and Sawyer, PC
High Tide Technologies
HOBAS Pipe USA
Holland Company
Hydro-Dyne
Hydro Gate
Hydro Logic
Hydromatic Pump - Pentair
ICS Healy-Ruff
IDModeling, Inc.
Infrastructure Technologies
Innovyze, Inc.
Innovair B
IPEX USA LLC
IPM Systems, LLC
J.D.V. Equipment Corp
J&R Sales and Service, Inc.
JCS Industries, Inc.
Jesco-Lutz Pump Corp.
JWB Company
Kemira Water Solutions, Inc.
Kruger, Inc.
Kusters Water
KWS Manufacturing Co. Ltd.
Lakeside Equipment Corporation
Lane Enterprises, Inc.
Lightnin/SPX
LOBEPRO Rotary Pumps
M.A. Selmon Company
The MAHER Corporation
Maltz Sales Company, Inc.
Manning Environmental
Martinez Couch & Associates LLC

McIntosh Controls Corp.
Mechanical Solutions, Inc.
MGD
Mixtec
MJK
National Filter Media
National Oilwell Varco
National Water Main Cleaning Co.
Neptune Chemical Pump Company
Netsch
New England Environmental
Equipment
Noxon
Oakson
OCV
Opti Float/Cox Research
OSS, Inc.
Ovivo
Parkson Corporation
Pavers by Ideal
Penn Valley Pump
Perma-Liner Industries, LLC
Philadelphia Mixing Solutions
PhilAerator GmbH
PINNACLE OZONE Solutions, LLC
POND Technical Sales
Precision Sytems
PRIMEX Controls
Prominent Fluid Controls, Inc.
Process Wastewater Technologies
PULSCO, Inc.
Pump Systems Inc.
Purafil
QCEC Wastewater Samplers
R.H. White Construction Co., Inc.
RACO Manufacturing & Engineering Co.
Rain for Rent
Red Valve/Tideflex
Resource Management, Inc.
Rexa
R.I. Analytical Laboratories, Inc.
RITEC Environmental LLC
Robuschi USA
Rockwell Automation
Rootx
Ross Valve Mfg. Co.
Rotork Controls
Russell Resources, Inc.
SAF-T-FLO
Sanitaire
Scavin Equipment Co., LLC
Schreiber
Schulz Group
Scott Safety
Sedaru
Shelter Works
Smith & Loveless
SNF Polydyne, Inc.
Spartan Tool
Spencer
Sprayroq, Inc.
Stacey DePasquale Engineering
Statewide Aquastore, Inc.
Sorensen Systems LLC
Sustainable Generation

Swan Analytical USA
Sydex USA, LLC
Synagro Northeast LLC
SyTech, Inc.
Technology Sales Associates, Inc.
Teledyne Isco
TcTech/Boyson New England
Technology Sales Associates, Inc.
Ted Berry Company
Thirsty Duck
Trident Actuators
Triplepoint Water Technologies
TrojanUV
Truax Corporation
Trumbull Industries
Turtle Plastics
UGSI Chemical Feed, Inc.
Sullivan Associates
Ultra-Tech
United Blower, Inc.
United Concrete Products Inc.
United Water
USABlueBook
Varec-Biogas
Vari-Tech, LLC
Viking Chains
Vogelsang
Vulcan Industries, Inc.
Walker Wellington, LLC
Wastecorp Pumps, LLC
Water & Waste Equipment, Inc.
Water Resource Technologies
Watson Marlow Pumps Group
WESCOR Associates, Inc.
WesTech Engineering
Whipps, Inc.
WhiteWater, Inc.
WILCO-EMU
Wind River Environmental
Winters Instruments
Woodard & Curran
Yeomans Chicago Corp.
YSI

"...The NEWEA Annual Conference...is a fantastic opportunity to showcase our products and network... This is simply not to be missed."

—Ed Quann,
F.R. Mahony & Associates