



FENCE PERMIT REQUIREMENTS

What is the process to apply for a fence permit?

1. Complete the fence permit application and a simple plot plan, drawn to scale, showing the proposed fence location in relationship to property (illustrated below.)
2. Call City Hall to schedule inspections
 - Block fence requires three inspections 1st lift (about 2 ft high and rebar), last lift, and final.

SAMPLE FENCE SITE PLAN

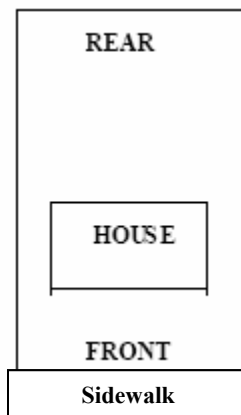

Indicate the limits of the fence by marking area as follows: XXXXX

Indicate Meter Box location with: □

Indicate Fire Hydrant with: ○

Indicate Light Post with: ●

I don't know where my or my neighbor's property lines are located; can the City visit my property and find them?

- No, only a commercial registered surveyor can physically locate property lines. Surveyors can be found in any Yellow Pages under "Surveyors – Land".

Permitted Fences, Hedges and Walls (Mendota Municipal Code 17.16.055)

1. Fences, hedges and walls, not greater than six (6) feet in height, shall be permitted on or within all rear and side property lines on interior lots and on or to the rear of all front yard setback lines.
2. No fence, wall or hedge over three (3) feet in height shall be permitted in any required front yard reversed corner lot, except on parcels of five acres or more.
3. Fences or structures over six feet in height, to enclose tennis courts or other game areas located within the rear half of the lot, shall be composed of wire mesh capable of admitting at least ninety (90) percent of light as measured on a reputable light meter. Such fences shall be permitted in the required side or rear yard and subject to a conditional use permit.