

*2015 Fall Current Concepts in Dermatology Seminar*  
*Sponsored by:*  
*American Osteopathic College of Dermatology*

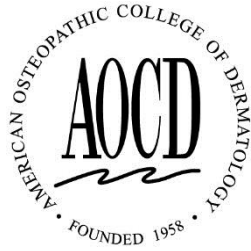

**EXHIBITOR PROSPECTUS**



*Dear Exhibitor,*

The American Osteopathic College of Dermatology invites you to join our team of exhibitors at our ***Current Concepts in Dermatology, Fall 2015 Meeting***. Our Meeting will be held at the Loews Royal Pacific Resort at Universal Orlando, FL, October 15-18, 2015.

This conference is the perfect opportunity for networking with professionals at every level of the field. Our comparatively smaller size gives you greater accesses and more face-to-face time with conference attendees. You will have the opportunity to mingle with program directors, department chairs, political advocates, experts, and up-and-coming physicians throughout the day. Meal breaks, receptions and other activities provide ample time to mix and mingle.

We also have many sponsorship opportunities at this conference with a wide variety of price points. If you would like to increase your presence, or are unable to attend but would like to still make your company known to our members, sponsorship is a great way to amplify your visibility.

We encourage you to review the enclosed material and embrace the opportunity to meet and get to know our organization.

The AOCD was recognized in 1958 as a Specialty College of the American Osteopathic Association. Just as the osteopathic profession has grown over the past 100 years, the AOCD has also grown. Our college now has 507 Fellows. The College participates in the accreditation of 28 residency programs that train more than 150 residents annually. When their training is finished and they become certified, they are awarded Fellow of the American Osteopathic College of Dermatology.

The American Osteopathic College of Dermatology has grown tremendously over the last five decades to become a strong and influential specialty college. Our presence is well established in academic and clinical settings throughout the United States, as well as in many political arenas. American Osteopathic College of Dermatology is dedicated to promoting the practice of osteopathic dermatology on a national level.

Sincerely,

*Marsha A. Wise*

Executive Director, AOCD  
Executive Director, Foundation for Osteopathic Dermatology

# The Venue

October 15-18, 2015

Loews Royal Pacific Universal, Orlando, FL

Loews Royal Pacific Resort at Universal Orlando—where a tropical paradise meets an oasis of fun.

6300 Hollywood Way

Orlando, FL 32819

(407) 503-3000

AOCD has made arrangements for a reduced nightly room rate of \$229.00. Rooms in the block are limited and available on a first come-first served basis. To make reservations at the Loews call 1-866-360-7395 or log on to the AOCD's Group Web page, <http://uo.loewshotels.com/en/Royal-Pacific-Resort/GroupPages/AOCD>. Be sure to mention you are with the American Osteopathic College of Dermatology.

Loews Royal Pacific Resort at Universal Orlando® offers guests a chance to enjoy a South Seas atmosphere without sailing halfway around the globe. All guests receive exclusive theme-park benefits that will make their time at Universal Orlando even more thrilling. Located right on the grounds of Universal Orlando, the excitement couldn't be any closer.

The property has 1,000 luxurious guestrooms, including 51 suites—and a stunning lagoon-style pool as well as a children's water play area. Complimentary Wi-Fi throughout the hotel and in the pool areas ensure you're never out of touch.

## Directions

The Orlando International Airport is located approximately 15 minutes (13 miles) from Loews Royal Pacific Resort. From Orlando International Airport, take the north exit onto the Beachline Expressway (FL-528) West approximately 11 miles to Interstate 4 (I-4) East. Take I-4 East to exit 75A (Universal Studios) and turn left onto Universal Boulevard. Continue on Universal Boulevard to Hollywood Way and turn left. Loews Royal Pacific Resort is on the left at 6300 Hollywood Way. NOTE: FL-528 is a toll road with two tolls of \$0.75 and \$1.00 each between Orlando International Airport and Loews Royal Pacific Resort.

Take time to dine in one of the many delicious restaurants located on the Loews property.

## Islands Dining Room

A large, luxurious Indonesian-style dining room serves the best Pacific Rim cuisine and traditional fare around, with a unique evening Children's Buffet and Bali-style play area that provide a well-deserved meal-time break for parents. Open daily for breakfast and dinner.

## Emeril's Tchoup Chop

An Orlando dining experience unlike any other ever, famous master chef Emeril Lagasse's restaurant features Asian cuisine "kicked up a notch." Reservations are required.

## On-site Character Breakfast

Every Sunday, enjoy traditional breakfast favorites with an island twist at Loews Royal Pacific Resort, while your favorite theme-park characters stop at each table to interact and pose for photos.



## **Character Dining & Kids Play Area at Islands Dining Room**

Enjoy special appearances by some of your favorite Universal Orlando Resort theme-park characters while you dine. Get ready for great food and fun for the whole family. We have a special dining room just for kids, with kiddie-size tables and chairs, a flat-screen TV playing cartoons, a Bali-style play area and toys. A kids' menu is also available.

## **Jake's American Bar**

Featuring a variety of appetizers, salads, sandwiches and entrees, Jake's has something for every member of the family to enjoy.

## **Orchid Court Lounge & Sushi Bar**

Blending the various tastes, cultures and traditions of the South Pacific, the Orchid Court's menu features modern, inventive sushi and sashimi presentations along with Asian-inspired desserts. The Orchid Court Sushi Bar is open daily. The Orchid Court lounges host a continental breakfast each morning.

## **Bula Bar & Grille**

Bula means "welcome" in Fijian, and you'll definitely feel at home in this casual poolside eatery. Enjoy food and beverages with a tropical flair, including fruity drinks, sandwiches, wraps and the Big Bula Burger.



# EXHIBIT INFORMATION

You are cordially invited to exhibit at this educational meeting of the American Osteopathic College of Dermatology. The scientific program will be varied and have broad appeal for dermatologists. Physicians attending this conference will be eligible for an anticipated 24 1-A continuing medical education credits approved by the AOCD/AOA and AAD.

## Why Exhibit?

The overall purpose of the convention is to educate osteopathic dermatology physicians about the latest techniques and trends in dermatology and to provide opportunities for professional networking. Exhibitors and other contributors to this continuing medical education program receive recognition through special mailings to members and are listed in the AOCD Newsletter and Conference Program.

It is expected that the available space will fill quickly, so please reserve your space as soon as possible to assure your participation. Space will be on a "first come first served" basis. Approximately 200 Dermatologists, Dermatology Residents, Medical Students, and staff from throughout the United States are expected to attend this conference. Approximately 200 Dermatologists, Dermatology Residents, Medical Students, and staff from throughout the United States are expected to attend this conference.

**WHEN:** Thursday through Sunday, October 15—18, 2015

**WHERE:** Loews Royal Pacific at Universal Orlando

**EXHIBIT SETUP:** Thursday, October 15, 2015, 8:00 am

**DISMANTLE:** Saturday October 17, 2015, 5:30 pm - Sunday October 18, 2015, 10:30 am

## EXHIBIT HOURS:

### Thursday, October 15

8:00 am -5:00 pm Set up  
4:00 pm – 6:00 pm Meeting Registration

### Friday, October 16

6:00 am-7:00 am Breakfast  
11:30 am-12:00 pm Break  
3:00 pm – 3:30 pm Break  
7:00 pm Reception/Dinner

### Saturday, October 17

6:00 am-7:00 am Breakfast  
10:00 am-10:30 am Break  
3:00 pm-3:30 pm Break  
5:30 pm – 6:00 pm Break with Exhibitor/Door Prize Drawing

### Sunday, October 19

7:00 am-8:00 am Breakfast

## Attendee Lists

Attendee lists will be available the day of the conference and will not be mailed or distributed prior to the conference.

### **Grantor Attendance Policy**

Representatives of commercial supporters may attend an educational activity, but may not engage in promotional activities while in the room where the CME activity takes place. No commercial promotional materials shall be displayed or distributed in the same room as the CME activity. Exhibits are permitted at AOCD meetings, however, they shall not influence nor interfere with the presentation of the CME activity.

### **Giveaways and Promotional Items**

The AOCD requests compliance with all applicable industry, state and federal regulatory and governmental agency guidelines (AMA, PhRMA, OIG, FDA, FCC, FTC, AdvaMed, etc...). Acceptable giveaways should primarily entail a benefit to patients, be related to the physician's work, and should not be of substantial value. Giveaways may only be distributed from the exhibitor's booth, and may not be mailed to attendees after the meeting or delivered to outside locations during the meeting.

Prize contests, awards, drawings, raffles or lotteries of any kind held at any time or place within the auspices of the meeting are not permitted. Attendees may not be registered for drawings, raffles or lotteries, which might be conducted after the AOCD Spring Meeting. Gaming devices of any description are not permitted in the exhibit hall. The AOCD, in its sole discretion, shall have the right to prohibit the distribution of any samples it deems objectionable or otherwise inappropriate.

### **Cancellation and Refund Policy**

Full refunds (less \$100 processing fee) are available if requested in writing at least one month prior to the date of the program.

The AOCD is not responsible for "acts of god" such as inclement weather, delays in airline travel, or governmental restrictions on travel due to national emergencies. Refunds will not be made if participants are delayed or unable to attend because of these issues.



AOCD sincerely appreciates the partnership of our exhibitors, and each year we take their feedback into account and develop new ways to drive traffic to every table.

## Exhibitor Information Table Top Exhibit Fees

Entire Conference: \$1500.00

Daily Fee: \$600.00/day

Included in the exhibiting fees is one six foot table, draped and skirted, two chairs, two conference registrations as well as the use of the AOCD conference rate when booking hotel rooms at the Loews Royal Pacific Resort. Access to electricity will be provided by request at an additional fee. Each company should provide the necessary information to the shipping department at the hotel for shipment of packages both to and from the conferences. The AOCD will not be responsible for these charges.

### Exhibiting Schedule

Each day will feature didactic sessions beginning at 7:00 am. Beverage breaks will be provided throughout the conference and will provide our physicians with the opportunity to explore the exhibit floor. On Friday, October 16, a Reception is planned from 6:30 pm – 8:30 pm. This event is open to members and their families as well as exhibitors and is the perfect opportunity for exhibitors to mingle with attendees and establish relationships at the outset of the conference.

### Badges

Badges for pre-registered exhibit personnel will not be mailed prior to the conference. Exhibitor badges will be available for pickup during registration hours and will be held under the company name. Exhibitors are encouraged to wear their own company supplied name badges.

### Shipping

The Loews Royal Pacific Resort receiving department handles all package shipping and receiving at the loading dock at the rear of the building. The receiving department can accept deliveries Monday through Friday, from 8:00 am to 5:00 pm and on Saturday, from 10:00 am to 2:00 pm. The loading dock area is closed on Sunday. Packages can be shipped to the resort **at least seven days before** the scheduled function. Packages can weigh up to 50 pounds each. An additional charge will apply for packages weighing more than 50 pounds. A handling fee of \$5 will be charged for each additional package beyond 10. Each company should provide the necessary information to the shipping department at the hotel for shipment of packages both to and from the conference. The AOCD will not be responsible for these charges.

Ship to: American Osteopathic College of Dermatology Exhibits/Oceana 6  
Attention: Erica Carvalho, CMP  
Loews Royal Pacific Resort at Universal Orlando®  
6300 Hollywood Way  
Orlando, Florida 32819-7614

Number of packages in shipment:  
Hold For: Recipient Name  
Arrival Date:

Please advise your conference manager in advance of your shipment's arrival, including method of shipment, expected date and time of the shipment, and where and when you expect your shipment to be delivered.

Upon departure, your outgoing packages must be taped closed, with a completed shipping label attached. Further, a member of the shipping and receiving staff must be informed of their location and that the packages are ready for shipment. We also recommend that you have a packing slip both inside and outside of each package. Guests will be responsible for the packing and returning of all packages.



### **Boats/Water Taxi**

Guests staying at Loews Royal Pacific Resort receive complimentary transportation to and from Universal Studios®, Universal's Islands of Adventure® and Universal CityWalk® Entertainment Complex via water taxi. Boats leave every 15 to 20 minutes from the resort's boat dock located adjacent to the pool area. Hours of operation are one hour prior to theme park opening until CityWalk® closes at 2:00 am.



### **Business Center**

PSAV Presentation Services manages the business center located in the hotel's conference center. Hours of operation are Monday through Friday from 7:00 am to 5:30 pm and Saturday from 7:00 am until noon. The business center is closed on Sunday. Access to the business center computers and printer is available 24 hours a day with your room key. Fax and copy services, as well as computer and copier rentals are available at the business center.

### **Check-in and Check-out**

Guests staying at Loews Royal Pacific Resort may check-in after 4:00 pm. Check-out is before 11:00 am. Video checkout is available in all rooms on the introduction channel of the television set. Receipts can be e-mailed directly to you or picked up at the front desk.

### **On Site Security**

The AOCD is not responsible for any loss or damage to exhibitor property.

### **Keys**

The security department locks all meeting room doors each evening and unlocks the doors each morning. Keys can be provided for office and storage areas. Back door locks can be changed upon request for \$25 per door. Once re-keyed, only security can access the room.

**Please contact the AOCD at [swood@aocd.org](mailto:swood@aocd.org) for exhibitor room floor plan, shipping order forms, and electricity order forms.**



## Thursday, October 15, 2015

8:00 am-12:00 pm	AOCD BOT Meeting	
12:00 pm – 1:00 pm	Leaders Luncheon	<b>SPONSORSHIP AVAILABLE</b>
1:00 pm-5:00 pm	Resident In Training Exam	<b>SPONSORSHIP AVAILABLE</b>
8:00 am-5:00 pm	Exhibitor Set Up	
4:00 pm -8:00 pm	AOCD Program Director Meeting	

## Friday, October 16, 2015

6:00 am-7:00 am	Breakfast	<b>SPONSORSHIP AVAILABLE</b>
7:00 am-7:30 am	CLIA PROFICIENCY	
7:30 am-11:30 am	Lectures	
11:30 am-12:00 pm	Break with Exhibitors	<b>SPONSORSHIP AVAILABLE</b>
12:00 pm- 1:30 pm	Lunch Lecture	
1:30 pm-3:00 pm	Lectures	
3:00 pm- 3:30 pm	Break with Exhibitors	<b>SPONSORSHIP AVAILABLE</b>
3:30 pm- 4:30 pm	Lectures	
4:30 pm-5:30 pm	Business Meeting	
6:30 pm	Wine Reception	<b>SPONSORSHIP AVAILABLE</b>
7:00 pm	Presidential Celebration	<b>SPONSORSHIP AVAILABLE</b>

## Saturday, October 17, 2015

6:00 am-7:00 am	Breakfast	<b>SPONSORSHIP AVAILABLE</b>
7:00 am-10:00 am	Lectures	
10:00 am-10:30 am	Break with Exhibitors	<b>SPONSORSHIP AVAILABLE</b>
10:30 am-11:30 am	Lectures	
11:30 am-1:00 pm	Lunch Lecture	
1:00 pm-3:00 pm	Lectures	
3:00 pm- 3:30 pm	Break with Exhibitors	<b>SPONSORSHIP AVAILABLE</b>
3:30 pm- 5:30 pm	Lectures	
5:30 pm- 6:00 pm	Break with Exhibitor/Door Prize Drawing	

## Sunday, October 18, 2015

6:30 am-8:00 am	Breakfast	<b>SPONSORSHIP AVAILABLE</b>
8:00 am-12:00 am	Lectures	
12:00 pm- 1:30 pm	Lunch on your own	
1:30 pm-4:30 pm	Lectures	
5:00 pm	End of Conference	



# AOCD Sponsorship Opportunities

## WHY SPONSOR?

Sponsorship is an effective way to stand out from competitors and increase brand recognition with attendees. Sponsors benefit from dedicated pre-conference e-mails, logo exposure, promotion through social media, on-site signage and more!

### **Daily Breakfast in the Exhibit Hall \$5,000**

Breakfast is served in the exhibit hall every morning, kicking off a full-day of lectures and activities. Breakfast sponsors can expect acknowledgement on hall signage, mentions on all print and web materials, and agendas.

### **Beverage Break Stations \$3,000 per break**

Morning and afternoon coffee breaks are much-appreciated during a long day of lectures and events. Beverage break stations are located in the exhibit hall, where sponsors will see on-site signage. Sponsorship will also be acknowledged throughout all conference materials.

### **Leadership Luncheon \$5,000**

Provide lunch for a gathering of board members, program directors and education committee members. This is a wonderful opportunity and see your logo prominently displayed for this select group of physicians!

### **Snacks To Go! \$5000.00**

At the end of day, send our attendees off with a bottle of water, trail mix or a granola bar. Sponsors will be recognized with signs, as well as acknowledgement in all conference materials.

### **Resident In-Service Exam \$5,000**

AOCD residents will gather to take the annual required in-service exam. Sponsorship of coffee breaks, snacks, or a lunch is acknowledged in all conference materials and on-site signage.

### **Resident Sponsored Giveaways \$2,000**

This is an opportunity to sponsor giveaways such as gift cards, an iPad, or other great prizes to the Resident Members. Each gift can be given away with a note from the sponsoring company. For any larger items a representative from the sponsoring company is invited to be present for the giveaway. The giveaway sponsors will be in marketing materials, and featured in *The Dermline* publication.

### **Attendee Conference Bag \$6,000**

See your logo on every bag that attendees use to carry the items and information from exhibitors, as well as laptops and conference materials!

### **Bag Inserts \$3000**

Bag inserts are one of the only opportunities that guarantee distribution of your message to each and every AOCD Meeting attendee. Maximize return on a past investment by leveraging a pre-existing marketing piece or research study, or create a new concept/message. Insert will require AOCD approval.

### **Lanyards \$2,000**

Lanyards provide an ideal way to wear their badge, while prominently showcasing your corporate logo. Badges are worn for all days of the conference.

### T-Shirts \$7000

See your logo on the AOCD conference t-shirt. The t-shirt is a long time staple of the AOCD meeting. Sponsors will be recognized with signs as well as acknowledgement in all conference materials.

### Ball Caps/Visors \$5000

Another popular item for our attendees. Your logo will be at eye level to all. Enjoy onsite signage, recognition in marketing materials, and acknowledgement in the event program.

### Registration Portfolios \$3000

A portfolio folder will be provided for each attendee and will provide a place to keep additional handouts, evaluation forms, and a small note pad for note taking. Sponsors will be recognized with signs, as well as acknowledgement in all conference materials.

### Wine Reception \$5,000

Prior to the Presidential Celebration, guests will enjoy a wine and cheese reception, giving them an opportunity to mingle before the events of the evening begin. Exclusive sponsors of this pre-event enjoy onsite signage, recognition in marketing materials, and acknowledgement in the event program.

### Presidential Celebration \$15,000

The Presidential Celebration will be held on Friday, October 16, 2015 from 7:00 pm – 8:30 pm. Sponsors will be recognized with signs at the popular event, as well as acknowledgement in all conference materials.

Product Theaters are 45-minute sessions that provide a high value, live educational opportunity for supporters to reach engaged DO Physicians. These sessions deliver a forum to gather and discuss issues on patient education, specific products and therapeutic areas. AOCD recognizes that Product Theaters are promotional and may concentrate of a specific product or drug. These sessions do NOT receive CME credit. **Please contact the AOCD for more information regarding product theater opportunities.**

### Conference Floor Plan

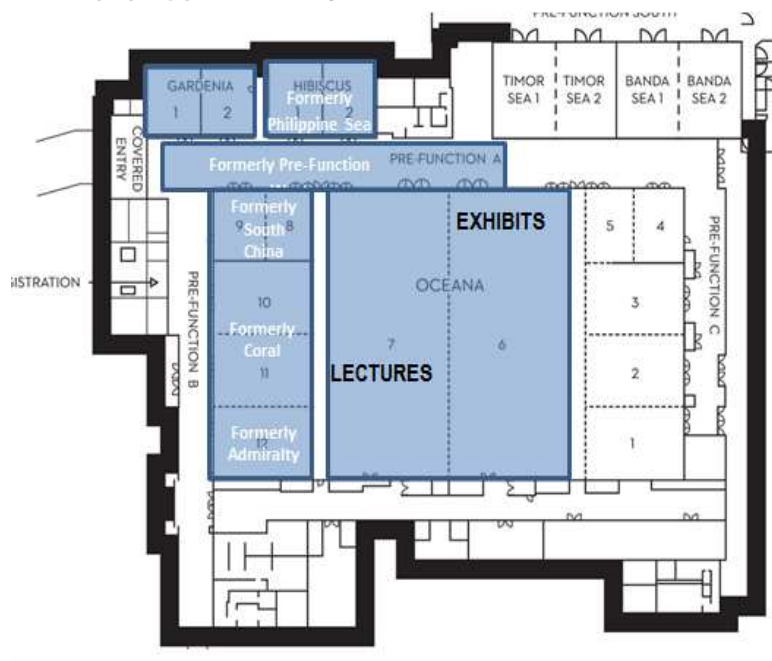

**Our Exhibition Hall will be located in Oceana Ballroom 6**

Over 9,000 square feet will be available for our Exhibitors to spread out to Meet and Greet our attendees.

**EXHIBITOR APPLICATION FORM  
 AOCD Current Concepts in Dermatology, Fall 2015  
 October 15-18, 2015**

To ensure exhibit space, complete this application and mail to PO Box 7525, Kirksville, MO 63501 or fax to 660-627-2623. Deadline for receipt of exhibit fee is Wednesday, September 30, 2015. Space is assigned as a “first come first served” basis.

Exhibit Fee: \$1500.00

Gratis to Diamond, Platinum and Gold Corporate Members  
 \$750.00 for Silver and Bronze Corporate Members  
 \$1000.00 for Pearl Corporate Members

\_\_\_\_\_ Entire Conference \$1500.00                      \_\_\_\_\_ Partial \$600.00/day  
 \_\_\_\_\_ I will require electricity (additional fees may apply)  
 \_\_\_\_\_ I have enclosed a check.  
 \_\_\_\_\_ Please bill my credit card for the amount \$\_\_\_\_\_ CVV# \_\_\_\_\_

Name as it appears on card: \_\_\_\_\_

Card # \_\_\_\_\_ Expiration Date: \_\_\_\_/\_\_\_\_/\_\_\_\_

Company Name: \_\_\_\_\_

Contact Name \_\_\_\_\_

Phone Number \_\_\_\_\_

Address \_\_\_\_\_

City \_\_\_\_\_ State \_\_\_\_\_ Zip Code \_\_\_\_\_

Email Address \_\_\_\_\_

Exhibitor Representatives Attending (2 conference registrations are gratis w/exhibitor sign-up. Additional exhibitor registrations are \$50.00 per person). Please list representatives w/their email addresses.

\_\_\_\_\_  
 Name Email

\_\_\_\_\_  
 Name Email

\_\_\_\_\_  
 Name Email

\_\_\_\_\_  
 Name Email

If you are unsure at this time of the representatives who will be attending this meeting, forward their name(s) at your earliest convenience so that appropriate information can be sent to them. Please make checks payable to: AOCD, PO Box 7525, Kirksville, MO 63501.



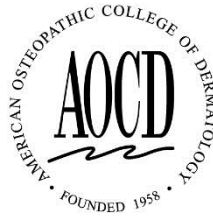

**AOCD Current Concepts in Dermatology  
 October 15-18, 2015  
 Loews Royal Pacific Resort  
 Orlando, FL  
 Sponsorship Registration Form**

Company Name \_\_\_\_\_

Address \_\_\_\_\_

City \_\_\_\_\_ State \_\_\_\_\_ Zip Code \_\_\_\_\_

Phone Number \_\_\_\_\_ Fax Number \_\_\_\_\_

Contact Person \_\_\_\_\_ Email Address \_\_\_\_\_

On-Site Contact \_\_\_\_\_ Email Address \_\_\_\_\_

- |  |                       |
|--|-----------------------|
| <input type="checkbox"/> Daily Breakfast in the Exhibit Hall | \$5,000 per breakfast |
| <input type="checkbox"/> Beverage Break Stations             | \$3,000 per break     |
| <input type="checkbox"/> Leadership Luncheon                 | \$5,000               |
| <input type="checkbox"/> Snacks To Go!                       | \$5,000 per offering  |
| <input type="checkbox"/> Resident In-Service Exam            | \$5,000               |
| <input type="checkbox"/> Resident Sponsored Giveaways        | \$2,000               |
| <input type="checkbox"/> Attendee Conference Bag             | \$6,000               |
| <input type="checkbox"/> Bag Inserts                         | \$3,000               |
| <input type="checkbox"/> Lanyards                            | \$2,000               |
| <input type="checkbox"/> T-Shirts                            | \$7,000               |
| <input type="checkbox"/> Ball Caps/Visors                    | \$5,000               |
| <input type="checkbox"/> Registration Portfolios             | \$3,000               |
| <input type="checkbox"/> Wine Reception                      | \$5,000               |
| <input type="checkbox"/> Presidential Celebration            | \$15,000              |

Total Amount Enclosed \_\_\_\_\_

Payment Information:  Check Enclosed  Bill my credit card for the amount \_\_\_\_\_

Name on Card \_\_\_\_\_

Card # \_\_\_\_\_ Expiration \_\_\_\_\_ CVV# \_\_\_\_\_

Please return form by fax at 660-627-2623, by email to: [mwise@aocd.org](mailto:mwise@aocd.org), or by mail to:

AOCD  
 PO Box 7525  
 Kirksville, MO 63501

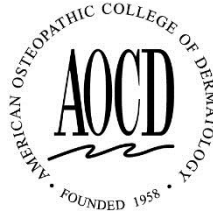

American Osteopathic College of Dermatology  
P.O. Box 7525 Kirksville, MO 63501  
Office: 660-665-2184 800-449-2623 Fax: 660-627-2623  
[swood@aocd.org](mailto:swood@aocd.org)

Letter of Agreement Regarding Terms,  
Conditions and Purposes of an Educational Grant

between **American Osteopathic College of Dermatology** and \_\_\_\_\_  
(Company)

Title of CME Activity: **Current Concepts in Dermatology Meeting and Scientific Seminar**

Location Date(s)

Company (name/Branch) \_\_\_\_\_

Contact Person \_\_\_\_\_

Address \_\_\_\_\_

City, State, Zip \_\_\_\_\_

Telephone \_\_\_\_\_ Fax \_\_\_\_\_ Email \_\_\_\_\_

The above Company wishes to provide support for the named continuing medical education activity by means of (indicate which option):

1. Unrestricted educational grant for support of the CME activity in the amount of \$ \_\_\_\_\_
2. Restricted grant to reimburse expenses for:

a. Speaker(s)

\_\_\_\_\_ To include all Expenses

\_\_\_\_\_ Travel Only

\_\_\_\_\_ Honorarium Only (Honorarium Amount to be determined by AOCD)

- b. Support for catering functions \_\_\_\_\_ in the amount of \$ \_\_\_\_\_ (see 10.d. on the back of this agreement)

c. Other (e.g. equipment loan, brochure distribution, etc.)

\_\_\_\_\_  
\_\_\_\_\_

## CONDITIONS

1. Statement of Purpose: program is for scientific and educational purposes only and will not promote the Company's products, directly or indirectly.
2. Control of Content & Selection of Presenters & Moderators: **American Osteopathic College of Dermatology** is ultimately responsible for control of content and selection of presenters and moderators. Company, or its agents, will respond only to **American Osteopathic College of Dermatology's** initiated requests for suggestions of presenters or sources of possible presenters. Company will suggest more than one name (if possible); will provide speaker qualifications, will disclose financial or other relationships between Company and speaker, and will provide this information in writing. **American Osteopathic College of Dermatology** will record role of Company, or its agents, in suggesting presenter(s); will seek suggestions from other sources, and will make selection of presenter(s) based on balance and independence.
3. Disclosure of Financial Relationships: **American Osteopathic College of Dermatology** will ensure disclosure to the audience of (a) Company funding and (b) any significant relationship between the **American Osteopathic College of Dermatology** and the Company (e.g. grant: recipient) or between individual speakers or moderators and the Company.
4. Involvement in Content: there will be no "scripting," emphasis, or influence on content by the Company or its agents.
5. Ancillary Promotional Activities: no promotional activities will be permitted in the same room or obligate path as the educational activity. No product advertisements will be permitted in the program room.
6. Objectivity & Balances: **American Osteopathic College of Dermatology** will make every effort to ensure that data regarding the Company's products (or competing products) are objectively selected and presented, with favorable and unfavorable information and balanced discussion of prevailing information on the product(s) and/or alternative treatments.
7. Limitations of Data: **American Osteopathic College of Dermatology** will ensure, to the extent possible, disclosure of limitations of data, e.g., ongoing research, interim analyses, preliminary data, or unsupported opinion.
8. Discussion of Unapproved Uses: **American Osteopathic College of Dermatology** will require that presenters disclose when a product is not approved in the United States for the use under discussion.
9. Opportunities for Debate: **American Osteopathic College of Dermatology** will ensure opportunities for questioning or scientific debate.
10. Independence of **American Osteopathic College of Dermatology** in the use of Contributed Funds:
  - a. Funds should be in the form of an educational grant made payable to **American Osteopathic College of Dermatology**.
  - b. All other support associated with this CME activity (e.g. distributing brochures, preparing slides) must be given with the full knowledge and approval of **American Osteopathic College of Dermatology**.
  - c. No other funds from the Company will be paid to the program director, faculty, or other involved with the CME activity (additional honoraria, extra social events, etc.).
  - d. Funds may be used to cover the cost of one or more modest social activities held in conjunction with the educational program, which furthers the CME educational experience and/or allows an educational discussion and exchange of ideas. If Company sponsors a social event, the requirements set forth in Sections 1, and 3-5 will still apply.

The Company agrees to abide by all requirements of the AOA Guidelines for Relationships between Accredited Sponsors and Company of CME as well as all requirements of the **ACCME Standards for Commercial Support**.

The **American Osteopathic College of Dermatology** agrees to:

- 1) abide by the AOA Guidelines for Relationships between Accredited Sponsors and Company of CME;
- 2) acknowledge educational support from the Company in program brochures, syllabi, and other program materials, and
- 3) upon request, furnish the Company a report concerning the expenditure of the funds provided.

---

Company Representative (print name)

Email

---

Company Representative Title

---

Signature

Date

**AOCD:** **Marsha A. Wise**  
Executive Director

[mwise@aocd.org](mailto:mwise@aocd.org)  
Email

---

Signature

Date

American Osteopathic College of Dermatology  
PO Box 7525  
Kirksville, MO 63501

Address Service Requested



## *Save the Dates!*

March 30- April 3, 2016  
Ritz Carlton Battery Park  
2 West Street  
New York, NY

Phone: (212) 344-0800

A block of rooms has been reserved for meeting attendees at a discounted rate of  
of  
\$ 345.00 per night plus tax.  
Reservations must be booked by  
February 29, 2016 to  
receive this special rate. After this date,  
rates and availability cannot be  
guaranteed.

March 29- April 2, 2017  
Ritz Carlton Atlanta  
181 Peachtree Street, Northeast  
Atlanta, GA

Phone: (404) 659-0400

A block of rooms has been reserved for meeting attendees at a discounted rate of  
of  
\$ 239.00 per night plus tax.  
Reservations must be booked by  
February 27, 2017 to  
receive this special rate. After this date,  
rates and availability cannot be  
guaranteed.