



09-035700.0417

GALL STEVEN E & BEVERLY L

GALL STEVEN E & BEVERLY L
5245 HORSESHOE BEND RD
TROY, OH 45373

LEGAL INFORMATION

TREASURE COVE
PLATTED 6/99
LOT#: 13

ACRES: 93.8000 M: 0.0000

	OWNERSHIP	MAILING ADDRESS	CITY	STATE	ZIP	DATE	AMOUNT	CONV #	JS	VALID
1	GALL STEVEN E & BEVERLY L	5245 HORSESHOE BEND RD	TROY	OH	45373	10/28/2003	186000	: A : 0	<input type="checkbox"/>	<input checked="" type="checkbox"/>
2							0		<input type="checkbox"/>	<input type="checkbox"/>
3							0		<input type="checkbox"/>	<input type="checkbox"/>

X: LISTER: DA DATE: 05/31/2005 TIME: 12:00:00 AM LETTER LETTER REC'D GIS CODE

STREET/ROAD	TOPOGRAPHY	PU-UTILITIES-PR	NEIGHBORHOOD	INFLUENCE FACTORS	PROPERTY LOCATION
<input checked="" type="checkbox"/> PAVED <input type="checkbox"/> GRAVEL <input type="checkbox"/> DIRT <input type="checkbox"/> SIDEWALKS <input type="checkbox"/> CURBS	<input checked="" type="checkbox"/> LEVEL <input type="checkbox"/> HIGH <input type="checkbox"/> LOW <input type="checkbox"/> ROLLING <input type="checkbox"/> STANDARD	<input type="checkbox"/> WATER <input type="checkbox"/> SEWER <input type="checkbox"/> GAS <input type="checkbox"/> ELECTRIC <input checked="" type="checkbox"/> STANDARD	<input type="checkbox"/> IMPROVING <input type="checkbox"/> STATIC <input type="checkbox"/> DECLINING <input type="checkbox"/> OLD <input type="checkbox"/> STANDARD	<input type="checkbox"/> A. NO ROAD <input type="checkbox"/> B. TOPGRHY <input type="checkbox"/> C. EX FRONT <input type="checkbox"/> D. QUANTITY <input type="checkbox"/> E. SZ/SHAPE	<input type="checkbox"/> F. RESTRICT <input type="checkbox"/> G. WOOD LT <input type="checkbox"/> H. VACANCY <input type="checkbox"/> I. WATER FRONT <input type="checkbox"/> J. OTHER/CDU
					6658 TREASURE LN, COMMENT CHANNEL LOT TriOB=110

LAND COMPUTATIONS								
CODES:	LAND TYPE	SIZE	M	RATE	C	INF	M VALUE	C
F: FRONT R: REAR	FR:F	F94 D102	ST500	DP82	ADJ410		38500	0
HS: HOME SITE								
SM: SMALL ACRE								
WA: WASTE								
RD: ROAD								
EA: EASEMENT								
TOTAL							38500	0

VALUATION SUMMARY				
ASSESSMENT YEAR	2008	2005	2004	
REASON FOR CHANGE	RAPP	RAPP	2004	
APPRAISED	LAND	38500	38500	42310
VALUE	IMPR	126100	122100	83830
	TOTAL	164600	160600	126140
ASSESSED	LAND	13480	13480	14810
VALUE	IMPR	44140	42740	29340
	TOTAL	57620	56220	44150

OCCUPANCY	EXTERIOR	FLOOR	AREA	CONST	VALUE
<input checked="" type="checkbox"/> SNGL FMLY <input type="checkbox"/> DUPLEX <input type="checkbox"/> TRIPLEX <input type="checkbox"/> CONVR <input type="checkbox"/> MOBILE HM <input type="checkbox"/> BI/L TRI/L <input type="checkbox"/> MOD/MAN	<input type="checkbox"/> WOOD <input type="checkbox"/> STUCCO <input checked="" type="checkbox"/> ALM/VYNL <input type="checkbox"/> CONC BLK <input type="checkbox"/> METAL <input checked="" type="checkbox"/> BRICK <input type="checkbox"/> STONE	1	1754	FR	81000
ROOFING	ROOF TYPE				
<input type="checkbox"/> METAL <input type="checkbox"/> SLT/TLE <input checked="" type="checkbox"/> SHINGLES <input type="checkbox"/> SHAKES <input type="checkbox"/> COMPOSITE	<input checked="" type="checkbox"/> GABLE <input type="checkbox"/> HIP <input type="checkbox"/> GAMBREL <input type="checkbox"/> MANSARD <input type="checkbox"/> FLAT				
SUBTOTAL					81000

FLOORS	B	1	2	3	U		VALUE
CONCRETE	<input type="checkbox"/>	<input type="checkbox"/>	<input type="checkbox"/>	<input type="checkbox"/>	<input type="checkbox"/>		
WOOD	<input type="checkbox"/>	<input type="checkbox"/>	<input type="checkbox"/>	<input type="checkbox"/>	<input type="checkbox"/>		
TILE/COMPO	<input type="checkbox"/>	<input checked="" type="checkbox"/>	<input type="checkbox"/>	<input type="checkbox"/>	<input type="checkbox"/>		
CARPET	<input type="checkbox"/>	<input checked="" type="checkbox"/>	<input type="checkbox"/>	<input type="checkbox"/>	<input type="checkbox"/>		
INT. FINISH	B	1	2	3	U		
PLASTER/DW	<input type="checkbox"/>	<input checked="" type="checkbox"/>	<input type="checkbox"/>	<input type="checkbox"/>	<input type="checkbox"/>		
PANELING	<input type="checkbox"/>	<input type="checkbox"/>	<input type="checkbox"/>	<input type="checkbox"/>	<input type="checkbox"/>		
UNFINISHED	<input type="checkbox"/>	<input type="checkbox"/>	<input type="checkbox"/>	<input type="checkbox"/>	<input type="checkbox"/>		
ACCOMMODATIONS							
# OF ROOMS		6					
BEDROOMS		3					
FIREPLACES							
HEAT & AC	B	1	2	3	U		
NO HEAT	<input type="checkbox"/>	<input type="checkbox"/>	<input type="checkbox"/>	<input type="checkbox"/>	<input type="checkbox"/>		
CTRL HEAT	<input type="checkbox"/>	<input checked="" type="checkbox"/>	<input type="checkbox"/>	<input type="checkbox"/>	<input type="checkbox"/>		
HW/STEAM	<input type="checkbox"/>	<input type="checkbox"/>	<input type="checkbox"/>	<input type="checkbox"/>	<input type="checkbox"/>		
ELECTRIC	<input type="checkbox"/>	<input type="checkbox"/>	<input type="checkbox"/>	<input type="checkbox"/>	<input type="checkbox"/>		
HEAT PUMP	<input type="checkbox"/>	<input type="checkbox"/>	<input type="checkbox"/>	<input type="checkbox"/>	<input type="checkbox"/>		
FLR/WALL	<input type="checkbox"/>	<input type="checkbox"/>	<input type="checkbox"/>	<input type="checkbox"/>	<input type="checkbox"/>		
STVE/SPCE	<input type="checkbox"/>	<input type="checkbox"/>	<input type="checkbox"/>	<input type="checkbox"/>	<input type="checkbox"/>		
CTRL A/C	<input type="checkbox"/>	<input checked="" type="checkbox"/>	<input type="checkbox"/>	<input type="checkbox"/>	<input type="checkbox"/>		
PLUMBING	BASE					<input checked="" type="checkbox"/>	
X FULL BATH		1					
X HALF BATH							
X FIXTURES							
SUBTOTAL							96530
GRADE FACTOR							110 %
UNADJUSTED VALUE							106180
FACTOR							100 %

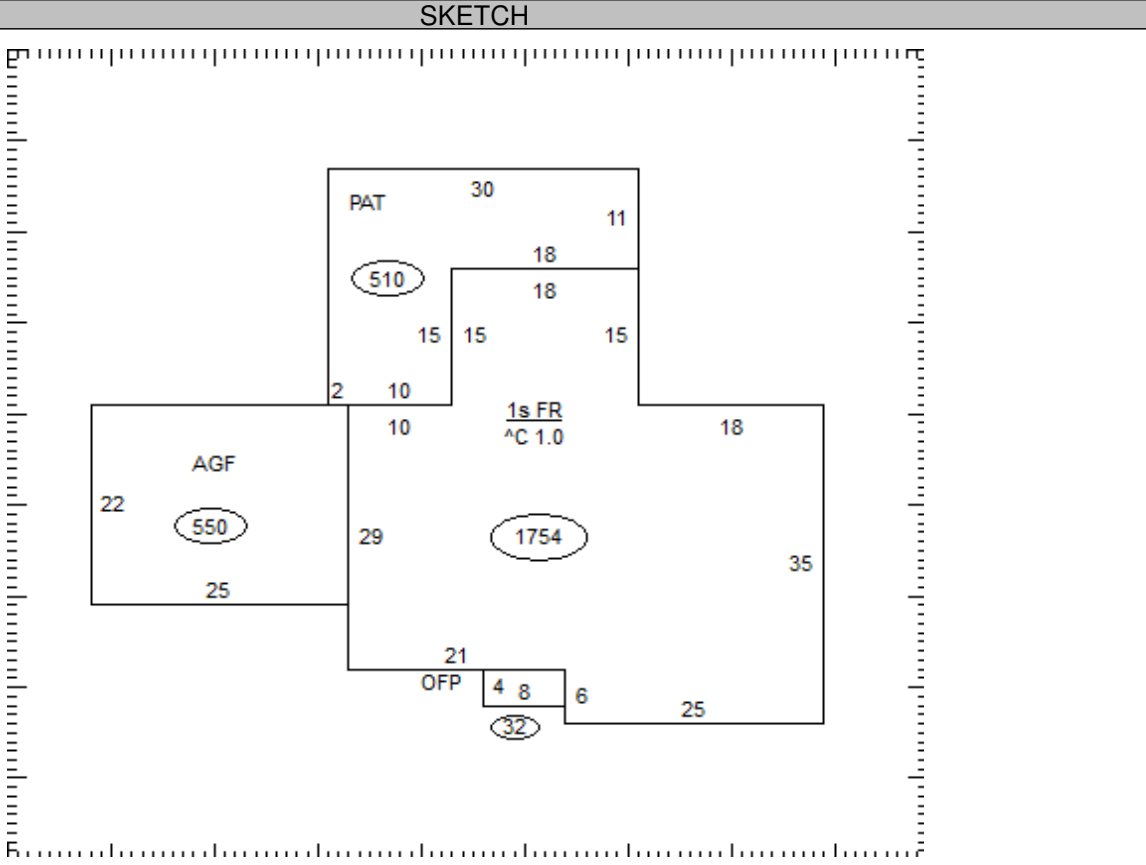

OCCUPANCY	ST.HT	SIZE	AREA	GRADE	PRICE	AGE	REMD	CND	UNADJ VAL	PHYS	PHYS VAL	FUNC	TRUE VAL
DWELLING	1	SK	1754	C+		2000		A	106180	5	100870		126100
1													
2													
3													
4													
5													
6													
7													
8													
9													
10													
11													

09-035700.0417

TOTAL 126100

COMMENTS
30 L/F BRICK TRIM 8' HIGH Dwelling has an Economic Factor of 125%