

c:\myfiles\pw\_production\dms52216\Std.501-1.dgn [Metric] 2 December 2014 7:19 AM

STATE	PROJECT	SHEET NUMBER

NOTE:

1. Lap longitudinal reinforcement not less than 325 mm.
2. Lap transverse reinforcement not less than 225 mm.
3. Eliminate all longitudinal and transverse reinforcing steel, wire, or bars where plain portland cement concrete pavement or base is required.
4. Provide the same type of dowel assemblies and tie bars for joints in plain portland cement concrete pavement as shown for joints in reinforced pavement.
5. Space transverse expansion joints at a minimum of 85 meters.
6. Space transverse contraction joints for reinforced concrete pavement at not more than 12 meter intervals and for plain concrete pavement or base at not more than 6 meter intervals.
7. See Standard M501-2 for joint details and joint sealing details.
8. Dimensions without units are millimeters.

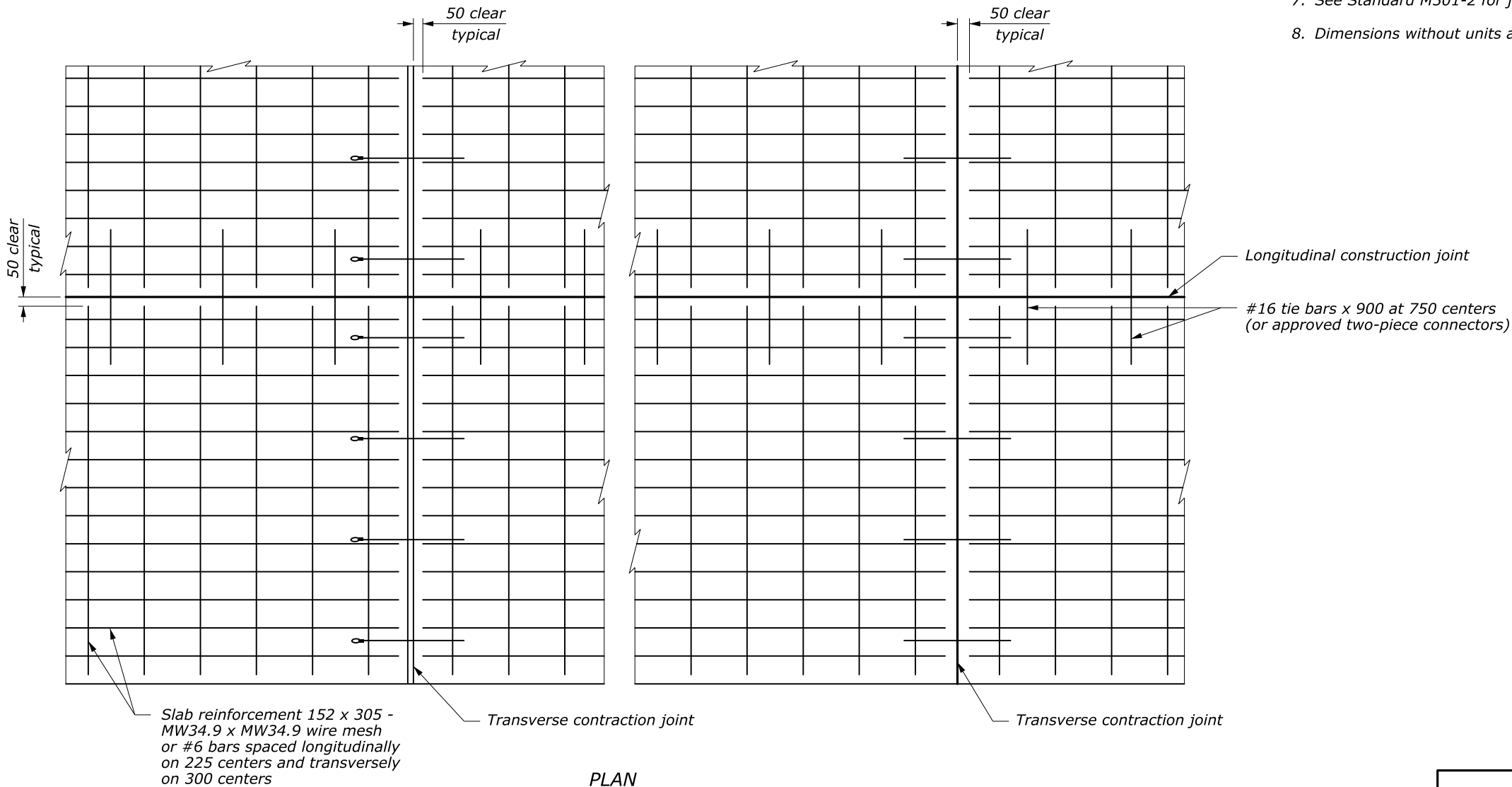

NO SCALE

U.S. DEPARTMENT OF TRANSPORTATION FEDERAL HIGHWAY ADMINISTRATION FEDERAL LANDS HIGHWAY	
METRIC STANDARD	
<b>PORTLAND CEMENT CONCRETE PAVEMENT</b>	
STANDARD APPROVED FOR USE 3/1996	STANDARD
REVISED: 5/1997 DRAFT: 12/2014	M501-1