

PRINCIPAL'S WELCOME MESSAGE

As a large comprehensive high school, Susan E. Wagner High School is able to offer its students a wide range of required and elective courses, as well as extracurricular team and club activities. Within this setting, students participate in a learning center, based on their interest and academic performance. Each Center serves as a small learning community with an exclusively assigned teacher-coordinator, guidance counselor, and assistant principal. Additionally, each learning center is designed to provide students with a community service focus and a comprehensive exposure to selected areas of pre-professional and career study, as well as to the academic and reasoning skills necessary to pursue post-secondary education and training in colleges, technical, and business schools. A fundamental part of each center's program is the enrichment, support, and guidance services available, including college and career counseling and tutorial assistance.

Although we require students to work hard, ample opportunity is provided for participation in an array of extracurricular student activities: from team sports to cultural interests, from intellectual pursuits to theatrical performances.

Students at Wagner High School are also expected to conduct themselves in a responsible manner at all times and to obey the rules and procedures of the school.

A student at Wagner High School may look forward to many highly rewarding educational and personal experiences. New academic vistas will be explored, new friendships will be made, new perspectives on life will be developed, and the opportunity to mature in one of the finest high schools in New York City will be offered.

Learning Centers at Wagner High School

Scholars Academy
Institute for Law and Politics
Academy of Finance
Academy of Entrepreneurs
Institute for the Theatrical Arts (Performing Arts)
Visual Arts Academy
Leadership Academy
Academy of the Sciences
Exploration Academy
Air Force Junior ROTC
Media Arts Academy
Sports Management Academy
Vocational Preparatory
Music Academy (Performing Arts)
Academy of Language and Culture

SUSAN E. WAGNER HIGH SCHOOL WEBSITE

<http://www.wagnerhigh.net>

The Susan E. Wagner High School Website will provide you with a wealth of information regarding Wagner High School's policies, procedures, academic requirements, extracurricular activities such as clubs and sporting events, and academic intervention services such as tutoring schedules.

Our faculty utilizes PupilPath to post class assignments and announcements to further your informational needs. You will also find e-mail links to our faculty for easy communication. We encourage students and parents to access PupilPath (online grade book) where you can view student's academic standing within their individual classes.

- Click on the **PARENT** tab located at the top of the home page of our website, www.wagnerhigh.net.
- Scroll down to **PupilPath.com**.
- Click on that link, which will redirect you to PupilPath.com.
- Once you have entered your information, you will be eligible to receive all email notifications.

We are confident that the variety of programs and events offered at Susan E. Wagner High School will enrich your educational experience.

MISSION STATEMENT

It is the mission of Susan E. Wagner High School to create a unified community of students, parents and educators, which will provide a rigorous instructional program in a caring and nurturing environment. This community will strive to stimulate in each child a thirst for knowledge, which will result in the acquisition of the skills and competencies necessary to be successful and to be life long learners. It is our desire that all students will experience the social, emotional and intellectual growth necessary to become socially conscious citizens with a respect for all peoples of our diverse society.

REQUIRED SUMMER ASSIGNMENTS

Susan E. Wagner High School requires Summer Assignments be completed for incoming ninth grade students in English and mathematics as well as students in several advanced placement classes. You may locate these assignments and their due dates on the Wagner High School website home page at www.wagnerhigh.net.

CODE OF BEHAVIOR

1. Students must present their student I.D. card upon entering the school building.
2. Always carry your I.D. card and program card and present them upon the request of a staff member.
3. Always be where your program card indicates you should be.
4. Use the Main Entrance to enter the building when you arrive at school. If you arrive before the start of classes, you must wait in the cafeteria or the main campus. Students whose programs end early must wait in the auditorium.
5. At no time may you loiter in the halls, stairwells, grounds, or vicinity of the school. **YOU ARE REQUIRED TO BE IN ALL CLASSES, INCLUDING CAFETERIA, ON TIME.**
6. Electronic devices such as cell phones, iPods, or handheld video games are prohibited in the school building.
7. Alcoholic beverages, drugs, and other illegal substances are forbidden.
8. Smoking is prohibited in the school building and on school property.
9. Gambling is prohibited in the school building and on school property.
10. Hats, caps, and other inappropriate headwear (e.g., bandannas, stockings, etc.) may not be worn in the building by male or female students. They will be confiscated and only returned to your parent or guardian, who will be required to come to the school. (Also see the "Dress Code" on page 5.)
11. In order to use the elevator, you must first obtain written permission from the Deans' Office and or the AP/Instructional Support Services.
12. By Chancellor's Regulation, any student who uses or is in possession of a weapon; uses force or inflicts serious injury upon school personnel; uses extreme force against or inflicts serious injury upon other students; sells or distributes or is in possession of illegal drugs, or engages in behavior which creates a substantial risk or results in injury, will be suspended by the Superintendent and may be expelled from school.
13. By Chancellor's Regulation, students may not bring beepers, cell phones and other electronic devices to school. They will be confiscated and only returned to your parent or guardian, who will be required to come to the school.
14. In order to participate in extracurricular activities, you must be a paid member of the student government. In addition, no books or money may be owed to the school. All applicable eligibility requirements must be met. Excessive absence and/or lateness or repeated violation of the Code of Behavior will result in exclusion from these activities.
15. Always conduct yourself properly. Anything that is illegal, infringes on the rights of others, or interferes with the educational process is forbidden and will result in disciplinary action. The behavior listed below under "Department of Education Citywide Standards of Conduct and Disciplinary Measures" is also prohibited.
16. **Bullying, cyber bullying, use of derogatory comments, racial, ethnic, or religious slurs, or other inappropriate remarks or actions will not be tolerated and will be dealt with immediately and the appropriate penalties will be imposed. If necessary, law enforcement will be notified.**

CAFETERIA

RULES OF CONDUCT IN THE CAFETERIA

1. During the school day you may be in the cafeteria only when programmed for lunch.
2. Follow all instructions given by the personnel supervising the cafeteria. Disruptive behavior will not be tolerated.
3. All students should be able to eat in healthful surroundings. Therefore, **KEEP THE CAFETERIA CLEAN.** You are responsible for making certain that your table is cleared before you leave. Place all garbage in the containers provided. Do not throw anything on the floor.
4. Never throw anything, stand or sit on tables, or cut in line. Disruptive behavior will not be tolerated.
5. Food and beverages are not allowed out of the cafeteria.
6. Students who violate the rules of conduct for the cafeteria, or act in a disruptive manner, will lose cafeteria privileges and will be subject to other disciplinary actions.

PROCEDURES IN THE CAFETERIA

1. Enter the cafeteria via the rear entrance (near the Falcon Cafe). You must have, and you will be asked to scan your school I.D. card in order to enter the cafeteria.
2. Exit the cafeteria through the doors near the Main Lobby.
3. Lavatories adjacent to the cafeteria are the only ones to be used during your cafeteria period.
4. Students who want to see their guidance counselor should visit guidance first; then obtain a pass to the cafeteria.
5. If you want to use the library during your lunch period, you must adhere to the following procedures:
 - a. Fifteen minutes after the start of the lunch period announcement will be made by the dean-in-charge.
 - b. School ID Cards will be collected and you will be escorted to the Library; your school ID card will be given to the librarian, who will return it to you before you leave the Library.
 - c. If you do not wish to eat lunch, you may go directly to the Library. You must arrive on time and remain in the Library for the entire period.

USE OF THE LIBRARY

You may use the library during your lunch period or any period during which you have not been programmed for a class. No food or beverage is permitted in the library. You must follow the directions of the librarian and maintain proper decorum. A student ID card is required for entrance.

LAVATORY PROCEDURES

Students must hand over their student id card to staff assigned to the lavatory. Students must sign the log in book. The maximum number of students allowed in the lavatory is three. Students will receive their id card back upon inspection of the lavatory.

DRESS CODE

Students have the right to determine their own dress except where such dress creates a distraction, is dangerous or interferes with the learning and teaching process. It is important that you remember what clothing is **inappropriate** in school. Included are:

- Halter tops, spaghetti strap tops and tube tops
- Tank top T-shirts without sleeved T-shirt underneath
- Tight ribbed underwear tank top
- Sheer tops without undershirts
- Any clothing which exposes the midriff
- Shorts or skirts which are revealing
- Going barefoot or in stocking feet
- Clothing with writing or pictures which are suggestive, obscene, or distasteful; or which is worn in a distracting manner (e.g., exposed underwear). Of course, hats, caps, visors, head bands or other head gear are not permitted.

Students who are in violation of the dress code will be referred to their guidance counselor and parents will be notified.

ATTENDANCE

You are required to attend school and follow your program every day school is in session. Your attendance in school is very important. Good attendance is reflected in good grades. When you are absent, late, or cutting your home will be notified. Students with less than the Department of Education's Promotion Policy Goal of 90% attendance may receive a reduction on the class work portion of their report card grade unless they submit to their teachers acceptable absence notes (e.g., death in family, doctors notes, etc)

1. If you are absent from school, you must do the following when you return:
 - a. Have your parent or guardian write a note giving the reason for your absence. Make certain the note includes your name, OSIS #, official class, and the date(s) of your absence(s). A medical note should accompany your parent's note when you have received medical care or if you have been absent from school five or more consecutive days due to illness.
 - b. Have all your subject class teachers read and sign the note. Return the note the following day, signed by your subject teachers, to your third period class teacher, who will send the note to the Attendance Office. All notes must be presented within five days after you return to school.
 - c. Make up all assignments. Ask you teachers about our free tutorial services.
 - d. In case of a lengthy or anticipated absence, your parent or guardian must notify your guidance counselor or grade advisor, teachers and the Attendance Office.
 - e. Family vacations should be planned to coincide with vacation days. Teachers are not obligated to make prior arrangements for assignments, projects, and other instructional activities involving work that has not yet been assigned. Student absence for vacation not on the calendar will be treated as unexcused absence.

NYC DEPARTMENT OF EDUCATION RANDOM SCANNING POLICY

Students at New York City middle schools and high schools might be required to pass through metal scanning devices similar to those used to screen airline passengers. These scanning devices detect weapons and dangerous instruments such as firearms, knives and box cutters. The scanners will be temporarily installed in schools throughout the City without prior announcement. The use of these mobile scanning devices is part of a new safety initiative by the New York City Police Department (NYPD).

LATENESS

- It is your responsibility to arrive at school and in each class on time. Because lateness interferes with learning and achievement, it could result in academic failure and disciplinary actions. If you arrive late to school, you must report directly to class. However, if you are late more than twenty minutes into 2nd period, you must report to the Late Room (Auditorium A). Upon entering the Late Room, present your student ID card and have your I.D. number recorded. Be advised that there is no talking and no food allowed in the Late Room.
- Chronic lateness may lead to detention. Students who do not appear for detention will be suspended.
- Students who are late to school will receive a wake up call at 6:45 A.M. the following morning.

CUTTING

There is no legitimate reason for cutting. If you are not present in your subject class, and your name does not appear on the daily absence list, you will be marked cutting. Cutting is a serious matter, and your parents will be notified. It will result in a reduction of the class work portion of your grade as well as in disciplinary action and possible failure in the course.

PASSES

In order to get the best possible education, you must be in your assigned classes every day for the full class period. Passes are issued only in exceptional circumstances.

1. Room Passes - You may not leave a classroom during class time without an authorized pass and the permission of the teacher. You must sign the log in order to obtain a pass. Passes may not be given out during the first 10 minutes or the last 10 minutes of class.
2. Early Excuse Passes - Early excuse passes are granted only for urgent reasons, such as medical appointments. If possible, appointments should be made at hours that do not conflict with school. In order to obtain an early excuse pass, you must report to the Welcome Center, in Room 116. You must present a note signed by your parent or legal guardian requesting early dismissal. An early excuse pass will be issued once their note has been verified by a telephone call to your parent or guardian. Students who are not 18 years of age may not leave unless accompanied by a parent or guardian.

3. Medical Excuse Passes - If you become ill and need the Medical Room (A-173), you must obtain a pass from your subject teacher. If you are deemed ill enough to be sent home, your parent will be called to school to take you home. You may only leave the building with a parent or guardian.
4. Call Passes - The call slip pass will indicate the day and time of your appointment. Show the call slip pass to the appropriate subject teacher **before** keeping your appointment.

STUDENT GOVERNMENT

The Student Government at Wagner High School is made up of senior class representatives, as well as representatives from our Learning Centers. Meetings are held monthly to help plan and organize school wide events. The COSA is the Coordinator of Student Activities and advises the Student Government.

Students wishing to run for office must meet the following qualifications:

1. A minimum cumulative average of 80%
2. Evidence of school service and citizenship
3. Good attendance
4. No failures due to absence or cutting
5. Evidence of leadership such as holding an office in the Student Government, National Honor Society, SING, school club, team, or participated in Council for Unity
6. Active member of the Learning Center

CLUBS AND ACTIVITIES

African Culture	Filipino	Polish
Albanian	French	Russian
Anime	Gay Straight Alliance	Senior Awards
Arena (Video Game)	Greek	Senior Breakfast
Art	Hip-Hop	Senior Luncheon
Asian American	Horticulture	Senior Prom
Asian Dance	Indian Dance	Show Choir
Belly Dance	International Festival	SING
Bengali	Italian	Soca
Black Box Theatre	Karaoke	Spanish
Celtic	Key	Spring Musical
Chess/Board Game	Knitting	Sri Lankan
Chinese Dance Club	Korean Fan	Step Team
Christian	Latino	Twirlers
Creative Writing	Loving Bones	Wagner Pride Parade
Dance Company	Modern Korean Dance	Weightlifting, Strengthening and Conditioning:
Debate Club	Muslim	Baseball (Boys), Basketball
Egyptian	Palestinian	(Girls + Boys), Softball,
Engineers	National Honor Society	Football
Explorers	New Student Luncheon	Winter/Spring Concerts
Federal Reserve Challenge	Pep Rally	

TEAMS

BOYS

Team

Baseball – Boys Varsity
Baseball – Boys Jr. Varsity
Basketball – Boys Varsity
Basketball – Boys Jr. Varsity
Basketball – Boys Freshman
Bowling – Boys Varsity
Cross Country – Boys Varsity
Football – Boys Varsity
Football – Boys Jr. Varsity
Golf – Boys Varsity
Handball – Boys Varsity
Indoor Track – Boys Varsity
Lacrosse – Boys Varsity
Outdoor Track – Boys Varsity
Soccer – Boys Varsity
Swimming – Boys Varsity
Tennis – Boys Varsity
Volleyball – Boys Varsity
Wrestling – Boys Varsity

Coach

Robert Nappo
Donato Pesce
Joseph Coscia
Douglas Elwell
Nicholas Capofari
Chris Colombo
Walter R. Ivers
Alan A. Paturzo
James Esposito
Joseph Coscia
Chris Colombo
Walter R. Ivers
Robert Tycenski
John Padula
Francesca McAuliffe
Ellen Cartmell-Kaht
Scott Fuchs
Larry Ng
Gary White

GIRLS

Team

Basketball – Girls Varsity
Basketball – Girls Jr. Varsity
Bowling – Girls Varsity
Cross Country – Girls Varsity
Flag Football – Girls Varsity
Golf – Girls Varsity
Gymnastics – Girls Varsity
Handball – Girls Varsity
Indoor Track – Girls Varsity
Lacrosse – Girls Varsity
Outdoor Track – Girls Varsity
Soccer – Girls Varsity
Softball – Girls Varsity
Softball – Girls Jr. Varsity
Stunt - Girls Varsity
Swimming – Girls Varsity
Tennis – Girls Varsity
Volleyball – Girls Varsity
Volleyball – Girls Jr. Varsity

Coach

Tom Rizzo
Nicole Ruggiero
Jodee Becker
Stephen Corrigan
B.Pelinkovic
Adam Kulak
Jennifer Cava
Nicole Ruggiero
Stephen Corrigan
Gary White
Stephen Corrigan
Carleen Rago
Marco Altieri
Megan McNichol
V. DiPaolo/B. Winkler
Jaime Ross
Susan Skronski
Marco Alteri
Bashkim Pelinkovic

SUSAN E. WAGNER HIGH SCHOOL
GARY M. GIORDANO, PRINCIPAL

Scott McBratney, Athletic Director
Ignazio Marinello, Athletic Director

Wagner Falcons Team Contract

Congratulations on being selected to be part of a Susan E. Wagner High School athletic team. Susan E. Wagner High School is a member of the Public School Athletic League. Therefore, each student athlete must abide by the rules by the P.S.A.L., school coaches and administration. Participation in sports is a privilege and any student-athlete not following the team contract may no longer be allowed to participate. The rules below are applicable to all student-athletes both in season and during the off-season.

1. Eligibility

- All student athletes must have a valid medical & consent form on file in order participate in any sport. Medical forms are to be filled out by a doctor and are valid for 1 year of date of issuance. Consent forms are to be filled out by a parent or guardian and are valid for the current school year. Both forms are available in the Student Government & Athletic Directors' offices.
- **The 5+1 Rule** - In order to gain and/ or maintain eligibility a student-athlete must pass five credit bearing courses + physical education in the most recent marking period. A student-athlete is accountable for passing five credit bearing courses + physical education each marking period that he/she participates in PSAL athletics with the exception of:
 - Incoming 9th grade student-athletes are eligible to compete in PSAL activities immediately upon entry into high school. The second report card is the first report card used to determine continued eligibility for 9th grade students.
 - A senior programmed for 4 or 5 classes who fails one class, in his/her senior year, will be eligible for PSAL so long as the failed class is not required for graduation.

- The date report cards are issued within a school is the official date for determining PSAL eligibility.
- At least three of the five subjects passed must be core subjects – English, Mathematics, Social Studies, and/or Science.
- **The 10 Credit Rule** - A student-athlete must accumulate a minimum of ten (10) credits, not including physical education, in the two semesters prior to the eligibility period (all credits accumulated in night school and summer school are included). This rule takes effect beginning with a student's third semester in high school.
- A student-athlete who is academically ineligible may become academically eligible by passing five credit bearing subjects and physical education in the most recent marking period, provided the student fulfills the 10 credit rule and the GPA requirement.
- At the end of each marking period a student must achieve, at a minimum, 90% attendance for that marking period in order to be considered for athletic eligibility.
- There is a minimum, cumulative GPA requirement of “65” for all report cards issued.
- A student must be present in school and must attend all assigned classes in order to participate in any team practice, scrimmage, league or non-league game, meet, contest or try-out on that day. Exceptions to this rule may be granted by the school Athletic Director on a case by case basis.

Please see the Athletic Director for any additional academic eligibility requirements.

2. Conduct

- Players are strictly prohibited from using alcohol, tobacco products & any illegal substances/drugs.
- Players are required to follow all rules regarding behavior as outlined in the Chancellor’s Disciplinary Code. This includes bullying and hazing.
- Suspended students are not eligible to participate in any team practice, scrimmage, league or non-league game, meet, contest or try-out during the period of their suspension.
- All players are to treat teammates and coaches with respect and courtesy. Behavior that results in profanity or demonstrates a lack of self control will not be tolerated and will lead to disciplinary measures.
- Coaches are the only persons allowed to interact with referees and umpires. Players are strictly prohibited from arguing and berating the officials.

- Players are expected to conduct themselves in a proper manner when traveling and competing in away games and matches.
- Any player with a dean's office record may be prohibited from participation depending on the nature of the incidents.
- All athletes are required to display good sportsmanship at all times while representing Susan E. Wagner High School. Any player found to have participated in unsportsmanlike behavior may be subject to disciplinary measures, including team and school suspensions.
- All athletes are required to use social media in a responsible and respectful manner. Additionally, individual teams may have more prohibitive policies that must be followed.

3. Participation

- Being a member of a team does not guarantee playing time in games. Playing time is determined at the sole discretion of the coach. Any issues with playing time must be addressed at an appropriate time, usually before or after practice
- Players are required to attend ALL practices and games. In an event where it is impossible for a player to attend a practice or game (illness, injury, family obligation, etc.), the head coach must be informed prior.
- Most teams have an athletic fee to participate. A detailed notice will be given to each player to outline the cost of participating and the expenditures generated through this fee. Players experiencing financial difficulties should speak to their coach about alternative measures.
- All players are expected to return any equipment that is the property of Susan E. Wagner High School at the end of the season in which they participate. Any unreturned equipment will result in a "book account" and will lead to school-wide restrictions.
- Players are encouraged to participate in any fundraising opportunities provided by the coaches.

4. Parents

- Parents are expected to properly conduct themselves as well. Profanity, aggressive behavior and arguing will not be tolerated. Any parent found to have violated this policy may be unable to attend future events/ practices.
- Parents are encouraged to speak to the coaches in the event any issues arise. However, appointments should be made to discuss such issues.
- Parents are expected to attend all orientation meetings for each sport their child plays.

5. Additional Team Specific Guidelines

- Each team may distribute additional guidelines to follow. These guidelines are above and beyond what is listed in this team contract. They will include necessary routines and protocols which must be followed. Failure to adhere to these rules may result in disciplinary measures, including team and school suspensions.

I have read and fully understand the rules and regulation outlined in this contract. Any violation of this contract may result in disciplinary action and removal from the team.

Player

Date

Parent/ Guardian

Date

\n_____
Coach

Date

Athletic Director

Date

GRADUATION REQUIREMENTS

Please refer to the Wagner High School website for details at www.wagnerhigh.net.

GUIDANCE AND COUNSELING

Guidance and counseling services are available for every student in our school. These services include assistance with educational planning, interpretation of test scores, bereavement counseling, college and career information, help with home, school and or social concerns, or any questions you would like to discuss with your counselor or grade advisor.

You will be seen regularly as part of our guidance and counseling program. In addition, you may see your counselor or advisor by writing a note or email to request an appointment or by coming to the Guidance wing before or after school or at the start of your lunch period.

TUTORING

Tutoring services are available before and after school and during all lunch periods. Preparation for Regents is provided. See our school website for more details. Please speak to your guidance counselor for information.

YOUTH DEVELOPMENT COUNSELOR

The Youth Development Program provides assistance to students who are experiencing problems with school, family, peers, drugs, etc. Through individual and group counseling, students are helped to look at themselves, their behavior, attitudes, values, etc., and learn to deal with these problems in a constructive manner. The Peer Leadership Group, as part of this program, attempts to help participants arrive at positive solutions to problems.

COLLEGE AND CAREER OFFICE

The **College and Career Office** is located in Room A194. Services include: one to one advising, college presentations, college visits, College Newsletter, college catalogue files, college applications, and college entrance exams. The **College and Career Center** located in the school library provides access to Naviance, the college related website and SAT/ACT tutorial.

MEDIATION CENTER

Student and staff mediators are available to assist you to resolve problems you may be having with other students, before the problems get out of hand and cause disciplinary sanctions to be imposed.

Mediation is a way of solving conflicts by formulating solutions. Under the supervision of the Wagner High School Dean's office, the Mediation Center provides students with the opportunity to resolve conflicts in a neutral setting. This process helps students gain a greater understanding of themselves, respect for other's points of view and develop mediation and negotiation skills.

COUNCIL FOR UNITY

The COUNCIL FOR UNITY was created to promote unity and safety between and among the diverse racial, ethnic and religious groups that make up a school and community. It is a movement that generates respect for differences and provides powerful support systems for participants, which extend for life. The program will keep its focus on meeting the deepest needs of children.

HONOR ROLL

Students are recognized for their scholastic achievement by placement on the Honor Roll. Students with an overall average of at least 90% are placed on the Honor Roll.

MERIT ROLL

Students are recognized for their scholastic achievement by placement on the Merit Roll. Students with an overall average of at least 80% are placed on the Merit Roll.

NATIONAL HONOR SOCIETY

The National Honor Society is an active society of students supporting Wagner High School and our community. Students nominated for the National Honor Society on the basis of academic performance also must qualify on the basis of character, service, and leadership. Nomination is based on the student's grade point average. Students must have been in attendance at Wagner High School for two complete terms. The academic committee reviews each applicant according to the above standards. Each student must have completed a minimum of one term of service. Students must submit a written application detailing areas of service and recommendations from three teachers.

LIBERTY PARTNERSHIP PROGRAM

Liberty Partnership Program (LPP) is a tutoring program that is based from the College of Staten Island. They provide Wagner High School with 2 college interns who are here on a daily basis. LPP is located in the guidance wing and students are only allowed to attend it during their lunch periods.

THE UNIVERSITY AT SUSAN E. WAGNER

Our University Program offers eligible students the opportunity to take many of our advanced level courses which total over 80 college credits. Additionally this program offers SAT/ACT Preparation and the opportunity for students to take high school courses that have received College Preparatory certification.

Advanced Placement

Our students may earn college credits by taking Advanced Placement courses, which culminate in the examinations given each spring. The academic rigor associated with the curriculum of these courses, as well as the higher weighting, provides students with a great advantage when applying to colleges and universities. Advanced placement courses are offered in Biology, Calculus AB, English Literature and Composition, English Language and Composition, French Language, Spanish Language, World History, Human Geography, U.S. Government & Politics, United States History, and Statistics.

College Now

Students participate in college-level or college preparatory courses tuition-free. These courses are given either before or after the regular school day. Course offerings are in areas of Behavioral and Social Sciences, Business, Communications, English/Writing, Humanities, Mathematics, Political Science and Science. College Now courses are offered through CUNY colleges. Students also may participate in freshman orientation courses designed to assist them in making a smooth transition from high school to college.

College and University Partnerships

Susan E. Wagner is partnered with St. Johns University in providing students with the opportunity to earn college credits while taking challenging courses during their regular school day schedule. The academic rigor associated with the curriculum of these courses provides students with a great advantage when applying to colleges and universities. Additionally, students can earn college credit which translates into a huge financial benefit since these courses are accepted by most major universities. These courses include: Italian Grammar, Italian Culture, French in Action/Advanced Placement French, Spanish Grammar I, Spanish Grammar II/Advanced Placement Spanish, Advanced Placement Biology I, Advanced Placement Biology II, Advanced Placement Literature and Composition, Opera, Accounting, Digital Photography, Drawing and Illusion, Pre-Calculus, Calculus, Statistics, Advanced Acting and World Geography.

SAT Preparation Program

SAT and ACT preparation courses are offered off site by numerous test prep companies including Princeton Review, Revolution Prep, Test Takers and Kaplan. Contact information is available in the College and Career office. These courses are often available to Wagner students at a reduced cost

College Preparatory Course Certification

This certification is designated to high school courses that are academically rigorous. A careful quantitative analysis by the New York City Department of Education has determined that students who pass these courses have a higher rate of college persistence. At Wagner High School the following courses meet this criteria: Anatomy and Physiology, Criminal Justice, Forensics, Pre-Calculus and Psychology.

REPORT CARDS

Report cards are issued three times a term at about six week intervals. The third report card grade for the term is the only grade which is recorded on the transcript. This grade is cumulative. The first two report cards in a term are issued to inform the student and the parent of the student's progress, absence, lateness, cutting; positive comments and negative comments are indicated. Parents and students can access report cards on Pupilpath.com. If there are any questions, please contact the guidance department or the assistant principal of the subject area.

PARENT-TEACHER CONFERENCES

Parent-Teacher conferences are held in October and March. They are scheduled immediately after the first marking period for each term.

USE OF THE LIBRARY

You may use the library during your lunch period or any period during which you have not been programmed for a class. No food or beverage is permitted in the library. You must follow the directions of the librarian and maintain proper decorum. An ID card is required for entrance.

BOOKS

Books are issued by your subject class teachers. At the end of each term, all textbooks must be returned. If you lose a book you must pay for it. When a book is returned, a receipt must be issued to you. Keep this receipt for your records. Textbooks for students with uncleared book accounts will not be issued and participation in extracurricular and co-curricular activities will be jeopardized. The same penalties apply for unreturned library books.

HOMEWORK

Homework at the secondary level is assigned in most academic areas each night. Homework is a most beneficial activity for the students. The assignments are appropriate and challenging. Homework is important because it:

- is an integral part of your subject grade
- provides an opportunity to practice and master skills
- provides time/opportunity for students to review materials for better retention
- provides time for problem solving/creative thinking
- provides enrichment stimulation and activities
- enables classroom time to be used more efficiently
- provides an opportunity for students to gain self-confidence
- provides students the challenge of organizing their time and resources
- helps develop a positive attitude toward school and learning through individual discovery

VISITORS

All visitors must provide identification and sign in at the Main entrance security desk. Visitors will then be directed to the Welcome Center where they will remain until escorted to their appointment location. Students are prohibited from bringing visitors to the building.

ELEVATOR

Elevator passes may be obtained from the Deans' Office when a note from a doctor is provided. No other students are permitted to use the elevator.

WORKING PAPERS

Working papers may be obtained from the Medical Room. These must be returned with a doctor's note stating that you are fit to work. If you wish, a doctor's appointment may be arranged through the Medical Office.

BELL SCHEDULE **2014-2015**

Period	Monday – Friday	Minutes
0	7:20 – 8:05	45
1	8:10 – 8:56	46
2	9:00 – 9:44	44
3	9:48 – 10:32	44
4	10:36 – 11:20	44
5	11:24 – 12:08	44
6	12:12 – 12:56	44
7	12:59 – 1:43	44
8	1:46 – 2:30	44

ANSWERS TO COMMON QUESTIONS

1. What if I do not have my program card or my I.D. card?

Students will receive a temporary ID upon entry to the building and then must purchase a replacement in the Student Government office. Report to the Student Government office during the first 15 minutes of your lunch period to obtain an I.D. card. You will have to pay for their replacement.

2. What if I need a program change?

Forms for all program changes will be provided during your official class or your third period class. **A student's request to eliminate or add a class can result in changes to their entire program.** Changes are made for technical reasons only. You must continue following your program until you receive the program change.

3. What do I do if I am experiencing problems that are interfering with my studies?

Make an appointment to see your guidance counselor or grade advisor immediately. There are many services available to help students.

4. How do I get help with personal problems?

See your guidance counselor or go to the Youth Development Office located in Room 110.

5. How do I get help concerning alcohol, smoking, drugs, gambling, etc.?

See your guidance counselor or go to the Youth Development Office located in Room 110.

6. What if I have a problem with another student?

Tell your teacher or guidance counselor and/or go to the Deans' Office located in room 171. These matters are handled confidentially and expediently.

7. What if I receive a cut class phone message in error?

See your subject class teacher and ask for a correction to be made.

8. What if I am marked absent from official class or second period in error?

Have your subject teachers make a notation on the absence card that you were present and bring the card to the Attendance Office in Room 110A at the beginning of your assigned lunch period.

9. How do I replace a lost book?

Report it to your subject teacher. You will be required to pay for the book.

10. Where is the Lost and Found?

The Lost and Found is located in the Student Government Office.

11. What if I don't feel well?

Report to your subject class and request a pass to the Medical Room.

12. What do I do if I have a problem with transportation, Metro Card or lunch tickets?

Report to the Falcon's Nest at the beginning of your assigned lunch period.

13. How do I plan my schedule?

You will meet with your counselor or grade advisor each term to plan your courses.

14. Whom do I see for help with planning for college, vocational schools, scholarships, summer programs, SAT's, PSAT's, or career plans?

Make an appointment to see the College and Career counselor in Room 194.

15. Whom do I see if I want to join a club?

Go to Room 197 at the beginning of your lunch period.

16. How do I join a team?

See the Assistant Principal of Physical Education/Athletic Director (Rm. 183) or the coach. Listen carefully to daily announcements informing you about tryouts. You must bring a completed medical form to the first tryout.

17. Why can't I drop a class?

Susan E. Wagner High School is an annualized school and once you commit to a class during programming you are expected to adhere to your requested schedule.

18. How is detention run?

Detention is held during morning hours of 7:20AM – 8:10AM and during lunch periods. Students are not permitted to arrive late, change their dress code, talk or sleep. Failure to comply with the rules of detention will result in further disciplinary action such as suspension.

19. What happens if a student cuts detention?

Students have 5 school days to serve their detention. If a detention is not served within that time period, he/she may be suspended for insubordination.

20. What happens if a student does not show up for suspension?

All students on suspension are required by Law to report to school for a minimum of 2 hours. Suspension hours are held from 7:20AM-9:20AM. Students are required to be on time and to show up in dress code and with their school supplies ready to work and get credit in their respective classes. Attendance will be officially recorded. If a student does not show up for suspension they will be marked as an unlawful absence. All suspensions must end with a parent conference.

21. What is the smoking policy?

Smoking is prohibit on school grounds at all times. Students found to be in violation of Chancellor's Regulation B12 will be subject to appropriate disciplinary measures. Cigarette are a prohibited item and must not be brought to school. Students found in possession of cigarettes are also subject to disciplinary action.

ADMINISTRATION	Extension	Room
Principal	1072	107
Assistant Principal /Operations	1085	108
Assistant Principal /Guidance	1022	102
Assistant Principal / Safety and Security	1721	172
Assistant Principal / Data Services	1035	103

ASSISTANT PRINCIPALS OFFICES	Extension	Room
English	2541	254
Foreign Languages	2101	210
Health and Physical Education	1831	183
Mathematics	2601	260
Performing and Visual Arts	1203	120
Science	3561	356
Social Studies	1541	154
Instructional Support Services	1301 and 2372	130 and 237
Career Arts	1831	183

DEPARTMENT OFFICES	Extension	Room
English	2542	254
Foreign Languages	2102	210
Health and Physical Education	1844	183
Mathematics	2602	260
Performing Arts	1203	120
Science	3562	356
Social Studies	1542	154
Instructional Support Services	1302 and 2372	130 and 237
Career Arts	1601	160
AFJROTC	5581	B58
Visual Arts	2845	283A

SCHOOL CONTACTS	Extension	Room
Admission and Discharge	1043	104D
Athletic Director	1831	183
Attendance	6044	104R
College and Career	1943	194
Deans'	1713	171
General Office	1093	109
Health Resource Room	5462	B46A
Library	2901	290
Lost and Found - Student Government Office	1975	197
Medical Room and Working Papers	1731	173
Parent Coordinator	1151	115
Parent Teacher Association	1151	115
Program Office	1031	103
Youth Development Office	6049	110L
Student Government	1975	197
AFJROTC	5582	B58
National Honor Society	1972	197

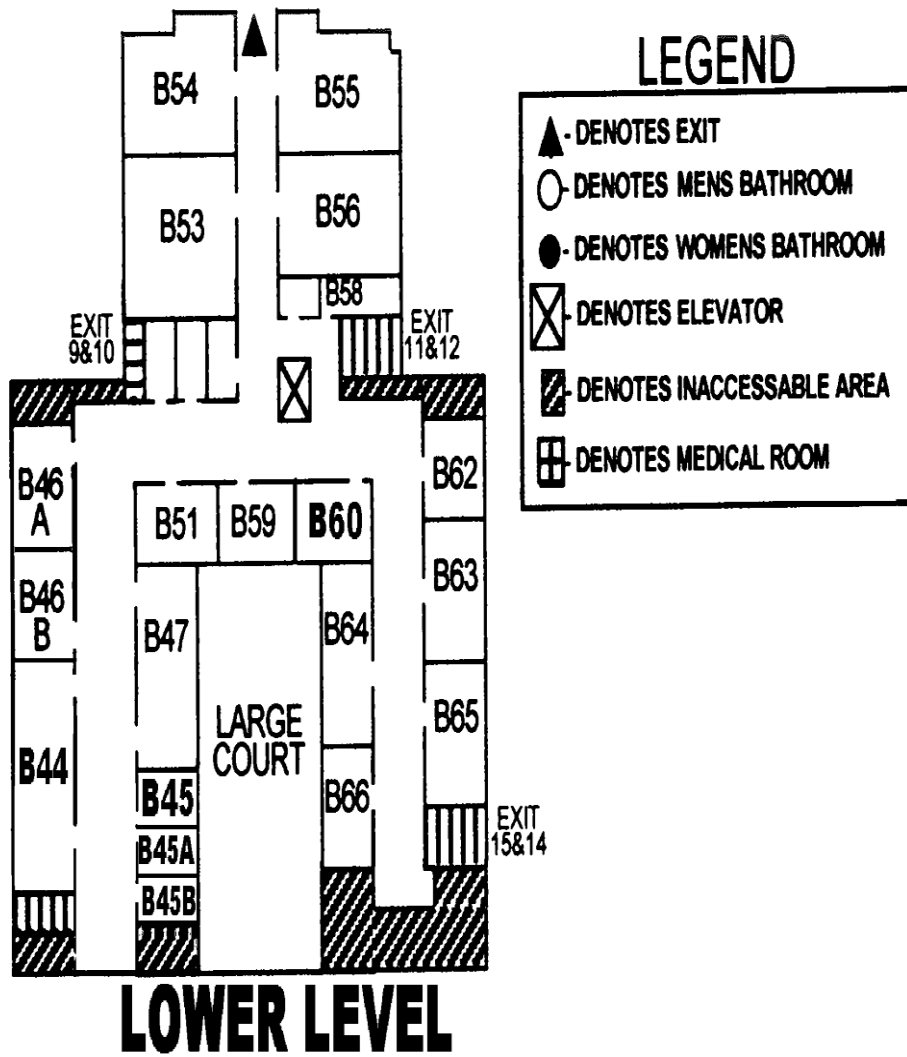

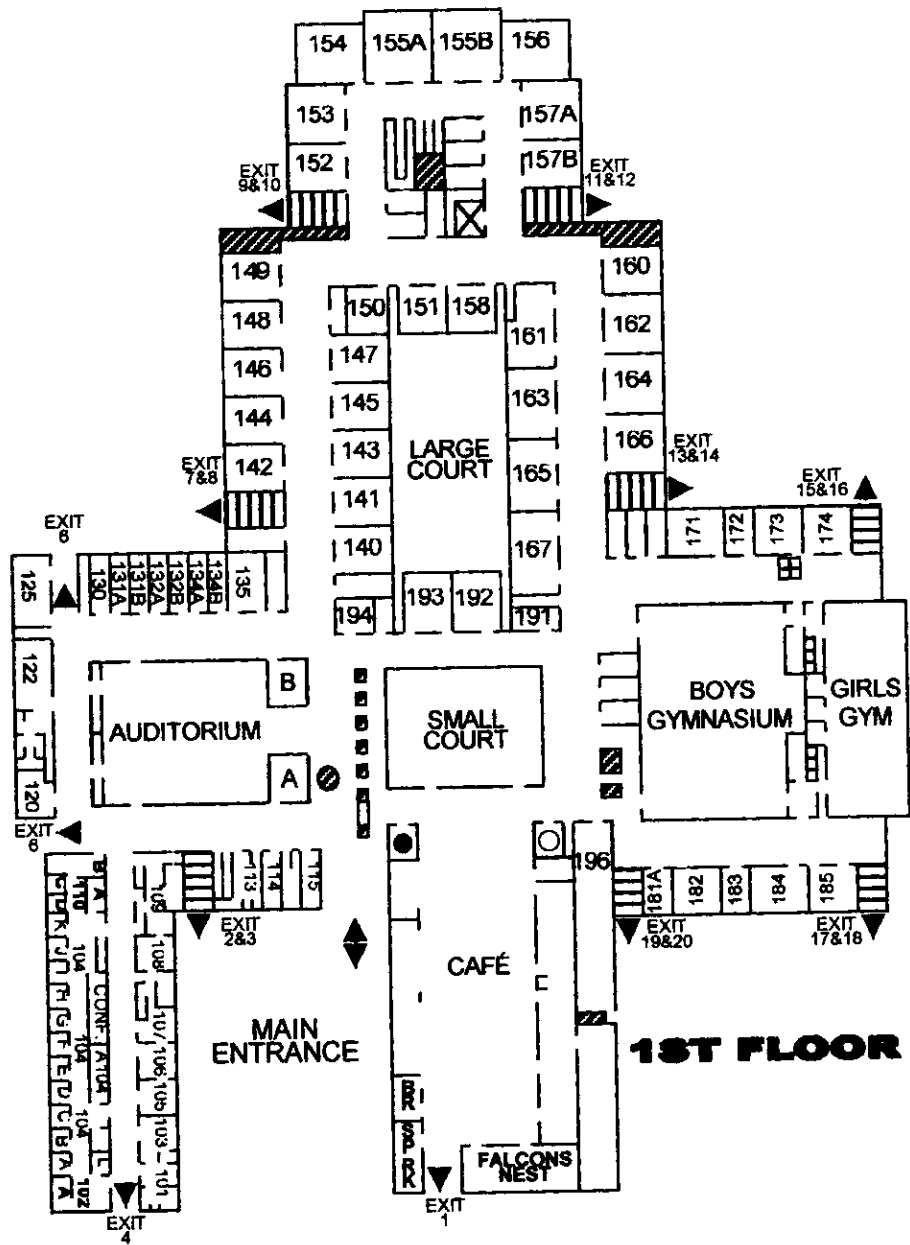

1ST FLOOR

