

Arriving at: ★ 12089 Clarence Center Rd, Akron, NY 14001-9332

· [Get Reverse Directions](#)

Distance: 59.3 miles    Approximate Travel Time: 1 hour 23 mins

· [Text Only Driving Directions](#)



Full Route

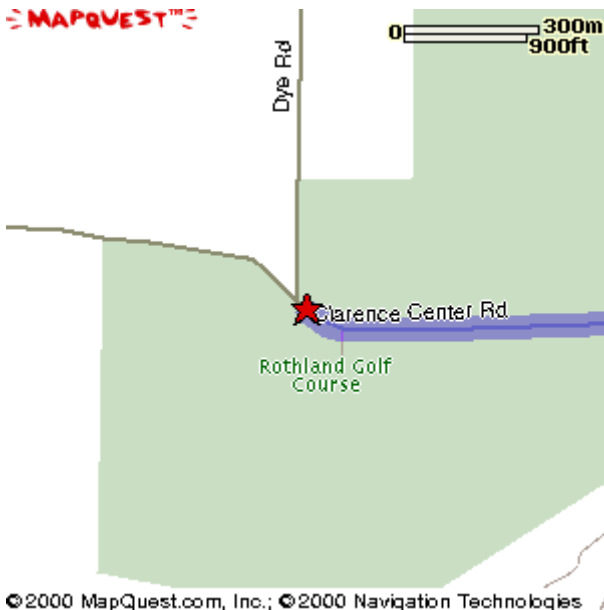

Destination

Directions	Miles
1. Start out going North on <b>KNOLLWOOD CRES</b> by turning left.	0.2
2. Turn <b>LEFT</b> onto <b>KNOLLWOOD DR.</b>	0.5
3. Turn <b>LEFT</b> onto <b>EAST AVE/NY-96.</b>	0.2
4. Turn <b>LEFT</b> onto <b>ALLENS CREEK RD.</b>	1.6
5. Turn <b>LEFT</b> onto <b>MONROE AVE/NY-31.</b>	0.0
6. Take the <b>I-590 SOUTH</b> ramp.	0.3
7. Merge onto <b>I-590 S.</b>	2.0
8. Take <b>I-390 SOUTH RAMP</b> towards <b>CORNING/NEW YORK STATE THRUWAY.</b>	0.7

- |  |      |
|--|------|
| 9. Merge onto <b>I-390 S.</b>  | 4.3  |
| 10. Take the <b>I-90/THRUWAY</b> exit, exit number <b>12B.</b>                           | 0.3  |
| 11. Keep RIGHT at the fork in the ramp.  | 0.5  |
| 12. Keep RIGHT at the fork in the ramp.  | 0.3  |
| 13. Merge onto <b>I-90 W/NEW YORK STATE TRWY</b> (Portions toll).                        | 39.2 |
| 14. Take the <b>RT-77</b> exit, exit number <b>48A</b> , towards <b>PEMBROKE/MEDINA.</b> | 1.0  |
| 15. Turn RIGHT onto <b>NY-77.</b>  | 0.7  |
| 16. Turn RIGHT onto <b>NY-5.</b>   | 3.0  |
| 17. <b>NY-5</b> becomes <b>NY-5/MAIN RD.</b>   | 2.0  |
| 18. Turn RIGHT onto <b>BUELL ST/NY-93.</b>   | 1.0  |
| 19. Turn SLIGHT LEFT onto <b>CLARENCE CENTER RD.</b>                                     | 1.7  |

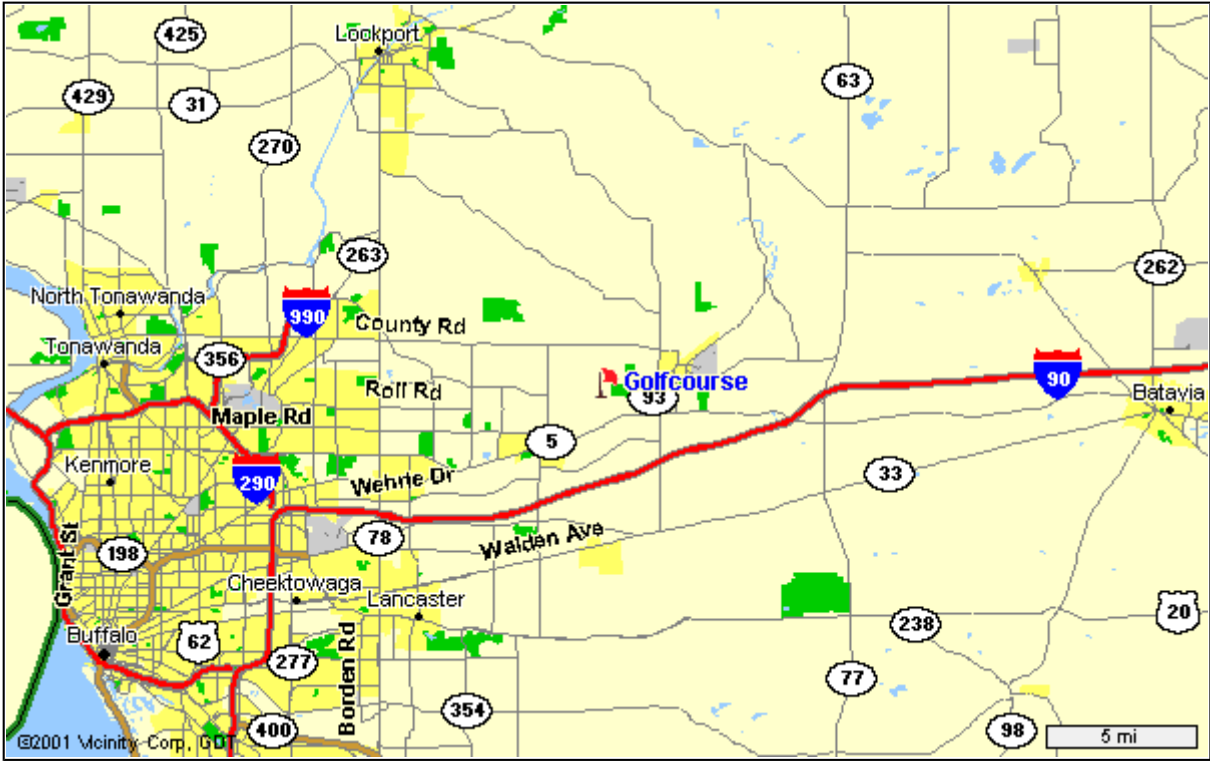

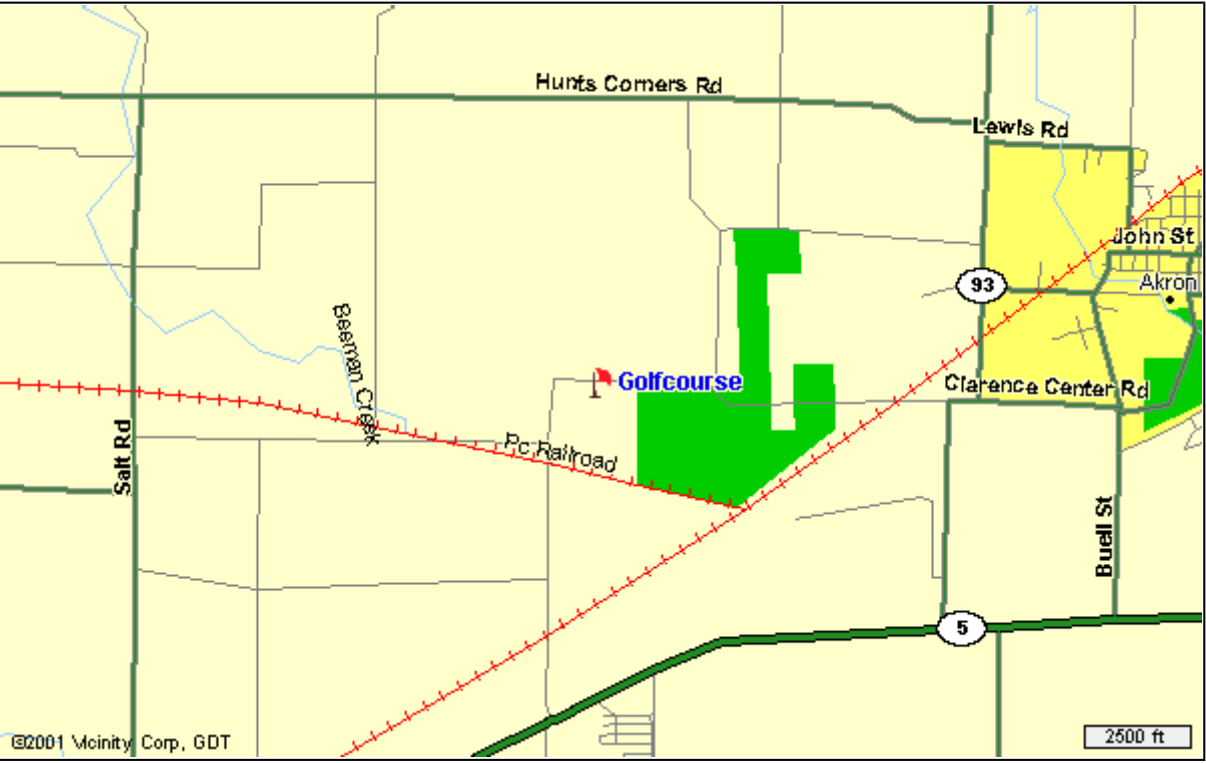

# Golf Course Guide

[Home](#) > [New York](#) > [Akron](#)

## Red/Gold at Rothland Golf Course - Public

12089 Clarence Center Rd  
Akron, New York 14001  
Erie County  
(716) 542-4325

[Web Address](#)

[Weather](#)

[Local Information](#)

[Driving Directions](#)

## Green Fees

Weekdays \$18.50

Weekend \$24.00

Tee-times accepted Y

Rental Carts Available Y

## Resources

[Yahoo! Yellow Pages](#)

[Yahoo! Auctions: Golf](#)

[Yahoo! Shopping: Golf](#)

[Yahoo! Travel: Plan a Trip](#)

## Course Information

Holes 18

Architect(s) Bill Ross

Year Built 1975

Public/Private Public

Guest Policy Open

Credit Cards VISA, MasterCard,  
Discover Accepted

Season Open: 4/20 Closed:  
11/15

Driving Range Y

Rental Clubs Y

Pro On Site Y

Metal Spikes  
Allowed N

TEES	PAR	YARDS	SLOPE	USGA
Championship				
Middle	72	6486	112	70.20
Forward	72	5843	112	71.30
Other				

# Red/Gold Course at Rothland Golf Course (Public)

12089 Clarence Center Rd  
Akron, NY 14001  
United States (Erie County)  
Phone: (716)542-4325  
Fax: (716)542-3815  
Web: [www.rothlandgolf.com](http://www.rothlandgolf.com)  
E-mail: [golf@rothlandgolf.com](mailto:golf@rothlandgolf.com)



## the course

<b>Users' Rating</b>	4.0 <a href="#"><u>REVIEW THIS COURSE</u></a>
<b>Year Built</b>	1975
<b>Designer</b>	Bill Ross
<b>Pro/Manager</b>	Jeff Randall
<b>Number of Holes</b>	18-hole
<b>Greens</b>	Bent Grass
<b>Fairways</b>	Bluegrass
<b>Water Hazards in Play</b>	Yes
<b>Number of Rounds Played Annually</b>	32,000 (estimated)
<b>Greens Aerated</b>	April September
<b>Overseeding Schedule</b>	No Overseeding
<b>Number of Sand Bunkers</b>	1-10
<b>Other Courses at Rothland Golf Course</b>	<a href="#"><u>Gold/White Course</u></a> , <a href="#"><u>Red/White Course</u></a>

## tees

Tees	Yardage	Rating		Slope		Par
		Men's	Ladies'	Men's	Ladies'	
White	6486	70.2	N/A	112	N/A	72
Red	5843	71.3	N/A	112	N/A	72

## fees

<b>Weekday Peak Season - 18 holes</b>	\$18.50
<b>Weekday Peak Season - 9 holes</b>	\$11.00

**Weekends Peak Season - 18 holes**

\$24.00

**Weekends Peak Season - 9 holes**

\$12.75

**Please Note:** The information contained here is accurate as of our last update. Contact the course for current rates before making a tee-time.

## pro shop

<b>Classification</b>	Public
<b>Guest Policy</b>	Open
<b>Dress Code</b>	No tank tops or cutoffs
<b>Metal Spikes</b>	Not Allowed
<b>Fivesomes</b>	Not Allowed
<b>Season</b>	Apr 20 to Nov 15
<b>Tee Times</b>	Accepted
<b>Earliest time to call</b>	6:45 AM
<b>Pro Shop Phone</b>	(716)542-4325
<b>Pro Shop Opens</b>	6:45 AM
<b>Pro Shop Closes</b>	N/A

## rankings

Find detailed information about [GOLF MAGAZINE](#) and [Golfweek rankings](#).

## additional comments

This club has three nine hole courses that are played in three eighteen hole combinations. The Red Course is the longest of the three and fairly open. The Gold Course has water that comes into play on eight of its nine holes. The White Course has water that comes into play on five holes and its fairways are tree lined. The club offers a twilight rate after 3 PM on the weekends.

- E-mail the course: [golf@rothlandgolf.com](mailto:golf@rothlandgolf.com)
- Submit an [update for this course](#) to Golfcourse.com — Please include the course name and location (city, state) along with your updated information.

# Red/White Course at Rothland Golf Course (Public)

12089 Clarence Center Rd

Akron, NY 14001

United States (Erie County)

Phone: (716)542-4325

Fax: (716)542-3815

Web: [www.rothlandgolf.com](http://www.rothlandgolf.com)

E-mail: [golf@rothlandgolf.com](mailto:golf@rothlandgolf.com)



## the course

### Users' Rating

### REVIEW THIS COURSE

### Year Built

1971

### Designer

Bill Ross

### Pro/Manager

Jeff Randall

### Number of Holes

18-hole

### Greens

Bent Grass

### Fairways

Bluegrass

### Water Hazards in Play

Yes

### Number of Rounds Played Annually

32,000 (estimated)

### Greens Aerated

April  
September

### Overseeding Schedule

No Overseeding

### Number of Sand Bunkers

1-10

### Other Courses at Rothland Golf Course

[Red/Gold Course](#), [Gold/White  
Course](#)

## tees

Tees	Yardage	Rating		Slope		Par
		Men's	Ladies'	Men's	Ladies'	
White	6348	68.7	N/A	110	N/A	72
Red	5878	69.5	N/A	110	N/A	72



# Gold/White Course at Rothland Golf Course (Public)

12089 Clarence Center Rd

Akron, NY 14001

United States (Erie County)

Phone: (716)542-4325

Fax: (716)542-3815

Web: [www.rothlandgolf.com](http://www.rothlandgolf.com)

E-mail: [golf@rothlandgolf.com](mailto:golf@rothlandgolf.com)



## the course

### Users' Rating

### REVIEW THIS COURSE

### Year Built

1987

### Designer

Bill Ross

### Pro/Manager

Jeff Randall

### Number of Holes

18-hole

### Greens

Bent Grass

### Fairways

Bluegrass

### Water Hazards in Play

Yes

### Number of Rounds Played Annually

32,000 (estimated)

### Greens Aerated

April  
September

### Overseeding Schedule

No Overseeding

### Number of Sand Bunkers

1-10

### Other Courses at Rothland Golf Course

[Red/Gold Course](#) , [Red/White Course](#)

## tees

Tees	Yardage	Rating		Slope		Par
		Men's	Ladies'	Men's	Ladies'	
White	6176	68.1	N/A	112	N/A	72
Red	5519	68.0	N/A	112	N/A	72

Scorecard

Red/Gold Course at Rothland Golf Course

Hole	1	2	3	4	5	6	7	8	9	Out
White	439	421	393	425	137	427	168	358	561	3329
Red	428	412	385	360	122	412	153	349	480	3101
Men's Hcp	3	2	6	4	9	5	8	7	1	
+ / -										
Men's Par	5	4	4	4	3	4	3	4	5	36
Ladies' Par	5	4	4	4	3	4	3	4	5	36
+ / -										
Ladies' Hcp	3	2	6	4	9	5	8	7	1	

Hole	10	11	12	13	14	15	16	17	18	In
White	367	367	142	406	392	515	177	486	305	3157
Red	335	315	125	344	336	459	124	414	290	2742
Men's Hcp	7	3	6	8	9	1	5	2	4	
+ / -										
Men's Par	4	4	3	4	4	5	3	5	4	36

# Scorecard

## Red/White Course at Rothland Golf Course

Hole	1	2	3	4	5	6	7	8	9	Out
White	439	421	393	425	137	427	168	358	561	3329
Red	428	412	385	360	122	412	153	349	480	3101
Men's Hcp	3	2	6	4	9	5	8	7	1	
+ / -										
Men's Par	5	4	4	4	3	4	3	4	5	36
Ladies' Par	5	4	4	4	3	4	3	4	5	36
+ / -										
Ladies' Hcp	3	2	6	4	9	5	8	7	1	

Hole	10	11	12	13	14	15	16	17	18	In
White	362	391	501	170	524	150	301	330	290	3019
Red	286	385	488	146	472	150	284	278	288	2777
Men's Hcp	7	2	1	4	3	6	5	8	9	
+ / -										
Men's Par	4	4	5	3	5	3	4	4	4	36

**Scorecard**  
**Gold/White Course at Rothland Golf Course**

Hole	1	2	3	4	5	6	7	8	9	Out
White	367	367	142	406	392	515	177	486	305	3157
Red	335	315	125	344	336	459	124	414	290	2742
Men's Hcp	7	3	6	8	9	1	5	2	4	
+ / -										
Men's Par	4	4	3	4	4	5	3	5	4	36
Ladies' Par	4	4	3	4	4	5	3	5	4	36
+ / -										
Ladies' Hcp	7	3	6	8	9	1	5	2	4	

Hole	10	11	12	13	14	15	16	17	18	In
White	362	391	501	170	524	150	301	330	290	3019
Red	286	385	488	146	472	150	284	278	288	2777
Men's Hcp	7	2	1	4	3	6	5	8	9	
+ / -										
Men's Par	4	4	5	3	5	3	4	4	4	36

# **Club Facilities & Amenities**

## **Red/White Course at Rothland Golf Course (Public)**

<b>Golf Carts</b>	Both gas and electric carts available
<b>Golf Cart Rental Fees</b>	\$20.00 per cart (18 holes), \$12.00 per cart (9 holes)
<b>Pull Cart Rentals</b>	Pull carts available for \$2.00 rental fee.
<b>Rental Clubs Available</b>	Yes
<b>Caddies Available</b>	No
<b>Driving Range</b>	Yes, Hitting balls from grass
<b>Additional Training Facilities</b>	Putting Green, Sand and Chipping Area, and Teaching Pro
<b>Pro On Site</b>	Yes
<b>Facility Management</b>	Internal
<b>Ownership Type</b>	Independent/Partnership
<b>Part of Real Estate Development</b>	No

# **Additional Course Information**

## **Gold/White Course at Rothland Golf Course (Public)**

### **Credit Cards Accepted**

Visa  
Master Card  
Discover

### **Discount Packages**

Senior  
Other

### **Senior Discount**

50 or older

### **Restaurant/Food Availability**

Restaurant and snack bar

### **Bar**

Full service bar located on premises

# **ROTHLAND GOLF COURSE**

**Akron NY - Buffalo NY**

**27 Hole Golf Course with Golf Driving Range, Golf Lessons, and Golf Outings.**



## **GOLF THE WAY IT SHOULD BE**

Is it important to you to be treated like a customer, not herded around like sheep? When you have a tee time, would you like to tee off for your round of golf near that time? Would you like to complete an 18 hole round of golf in a decent amount of time? We have rangers on the course to make sure that play moves along at an acceptable pace, and to help insure that your round of golf will be enjoyable. If you answered yes to any or all of these questions, Rothland Golf Course is where you should be golfing.

Our Professional staff treats golfers like Golfers! We offer 27 holes of golf which render 3 combinations of par 72 golfing pleasure. Our Golf Course is groomed for optimum playing conditions. At the completion of your round, our spacious clubhouse features a "pub" style menu with a complete beverage selection and delicious food.

## **GROUP GOLF OUTINGS**

Group golf outings are the specialty of the house. A return rate of over 80% tells us that our attention to detail is appreciated by our golfers. We cater to groups from 32 to 200 and our banquet facilities offer indoor or outdoor views of the golf course. The varied banquet menu will satisfy your taste buds and your wallet. We will work with you to fit your event plans into your budget.

## **GOLF LESSONS - GOLF INSTRUCTION**

Our Golf Professional offers a wide variety

of programs at our natural turf driving range. Series, individual, and group lessons are available to all age groups. Our summer junior program graduated over 200 students, schooled not only in the fundamentals of the golf swing but also golf etiquette.



## SEASON PASSES

Season passes are available in limited quantities. Call for details of our annual program, or email us at [seasonpass@rothlandgolf.com](mailto:seasonpass@rothlandgolf.com).

## PUBLIC GOLF COURSE

Affordable public play is the hallmark of Rothland Golf Course. The quality and playability of a golf course that can be enjoyed by all walks of life is what we strive for. Our reputation attracts golfers, our amenities keep them coming back. Senior discount programs are available.

## TEE TIMES, GOLF COURSE RULES

Tee times may be made up to seven days in advance, we are open every day. We even help you putt - Rothland Golf Course is now a SOFT SPIKE ONLY facility!

Click here to look over our [scorecard and yardage](#). Click here to be kept up to date on [special rates and events at Rothland Golf](#). Click here and we'll email you [Rothlands Golf Tips](#) - a monthly email that will help you improve your game.

Jeff Randall  
Director of Golf

Gene Ashe  
Head Golf Professional

Gary Roth  
Course Superintendent



# SCORECARD and DIRECTIONS

Akron NY - Buffalo NY

Golf Lessons and Golf Instruction for Western New York Golfers of all ages.



## SCORECARD

Here's our scorecard with course rating and slope information, [directions](#) follow.

Make sure you keep Rothland Golf Course in mind when it comes to Professional Golf Lessons and Golf Instructions. We have golf instruction and golf lessons for seniors, juniors, and ladies. We look forward to working with you to help you improve your game at our soft spikes only golf course.



### Red Course

Hole #	1	2	3	4	5	6	7	8	9	Out
White	439	421	393	425	137	427	168	358	561	3329
Red	428	412	385	360	122	412	153	349	480	3101
Par	5	4	4	4	3	4	3	4	5	36

### White Course

Hole #	1	2	3	4	5	6	7	8	9	Out
White	362	391	501	170	524	150	301	330	290	3019
Red	286	385	488	146	472	150	284	278	288	2777
Par	4	4	5	3	5	3	4	4	4	36

## Gold Course

Hole #	1	2	3	4	5	6	7	8	9	Out
White	367	367	142	406	392	515	177	486	305	3157
Red	335	315	125	344	336	459	124	414	290	2742
Par	4	4	3	4	4	5	3	5	4	36

## Course Ratings / Slope

	Men	Women
Red / Gold	70.2 / 112	71.3 / 112
Red / White	68.7 / 110	69.5 / 110
Gold / White	68.1 / 112	68.0 / 112

## DIRECTIONS

### From Buffalo NY and Southtowns:

Take Rt. 5 (Main Street) East past Clarence Hollow

Turn Left on Barnum Road in Clarence, travel less than 3 miles to Rothland Golf Course.

*Drive time from the City of Buffalo Eastern City Line: 19 Minutes*

### From Rochester NY and points East:

Take the NYS Thruway exit 48A, Pembroke NY.

After you pass through the toll, turn Right on Rt. 77 (North) to Rt. 5, about 1 mile  
Turn Right on Rt. 5 (West) to Rt. 93 in Akron, a blinking yellow caution light is at the intersection.

Turn Right on Rt. 93 (North), travel about two miles to Clarence Center Rd.

Turn Left on Clarence Center Rd (West), travel about 1 1/2 miles to Rothland Golf Course.

*Drive time from Exit 48A: 11 Minutes*