



**TOWN OF BOW
DRIVEWAY PERMIT FORM**

PERMIT # _____ PUBLIC WORKS DIRECTOR OR DESIGNEE INITIALS: _____

APPLICANT: _____ CONTACT#: _____ DATE: _____

PROPERTY ADDRESS: _____

CONTACT #: _____

ADDRESS/LOCATION: _____

PLEASE CHECK ONE:

- New Construction - \$15.00
- Resurface/Modify - No Cost

Please fill out this application to the best of your ability. The Public Works Director or designee will assist you in answering any questions you have regarding the application.

As the landowners(s), I/we hereby agree to the following conditions:

- A. to bear all costs of construction and materials (including required drainage structures) necessary to complete the driveway to the Town of Bow satisfaction:
- B. to hold harmless the Town of Bow and its duly appointed agents and employees against any action for personal injury and/or property damage sustained by reason of the exercise of this permit; and
- C. to abide by the provisions of the Driveway Regulations and the specifications below:
 - 1) Driveway apron 20' minimum paved 5'
 - 2) That the driveway be constructed in the location and with the dimensions as diagrammed on the back of the application:
 - 3) That any change or exceptions to the below specifications have written approval of the Public Works Director; and
 - 4) That the Public Works Director has the right to remove or correct – at the owner’s expense – any driveway entrance not built in accordance with the Town of Bow Driveway Regulations or as outlined on this application form.

APPLICANT’S SIGNATURE: _____

PERMIT FEE (Except for resurfacing/modify): \$15.00 Please make check(s) payable to: TOWN OF BOW

PLEASE DIAGRAM THE PROPOSED DRIVEWAY ON THE NEXT PAGE

OFFICE USE ONLY

Permit Fee (\$15.00) paid _____ Yes _____ No Check # _____ Sketch Attached _____ Yes _____ No

Bond required _____ Yes _____ No Cost of Bond _____

**TOWN OF BOW DRIVEWAY
PERMITS FORM PAGE 2**

DRIVEWAY DIAGRAM

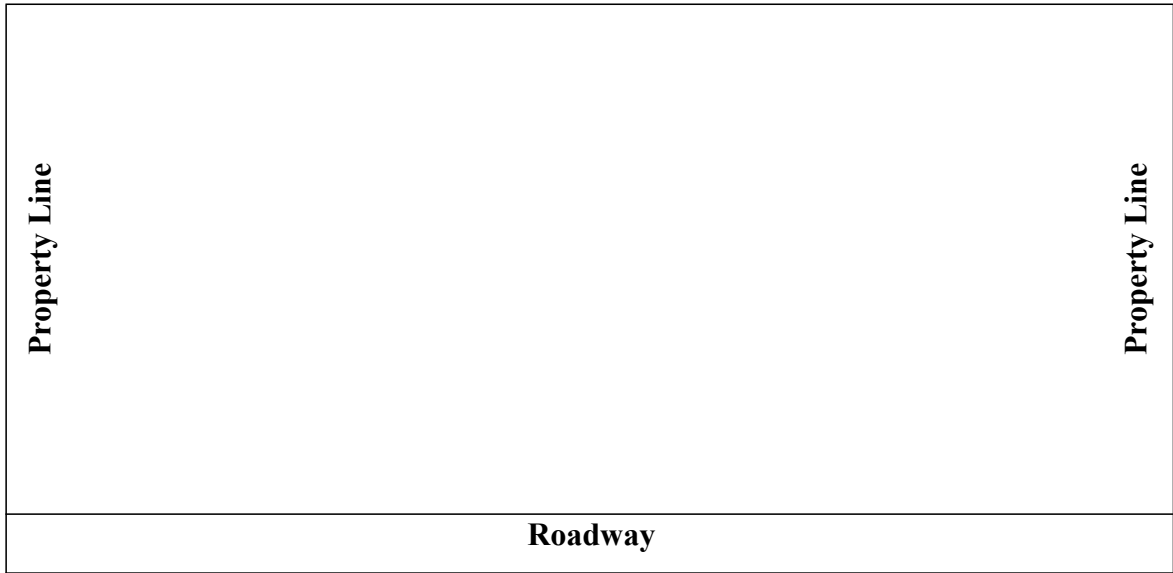

(Use back of page if necessary)

Road Name: _____ Address: _____

Notes: _____

FOR PUBLIC WORK DEPARTMENT USE ONLY

The following requirements must be met (to be filled out by Public Works Director)

1. Culvert pipe with headers: _____ Size _____
2. Inlet control stable and proper: _____
3. Outlet drains sufficiently: _____
4. No requirements other than required specifications: _____
5. Additional requirements to be met: _____

Building Permit #: _____ (new construction only)

Director or Designee Initials: _____ Date: _____

FIRE COMMENTS: _____

POLICE COMMENTS: _____