

UTAH OIL AND GAS CONSERVATION COMMISSION

m

REMARKS: WELL LOG _____ ELECTRIC LOGS _____ FILE X WATER SANDS _____ LOCATION INSPECTED _____ SUB REPORT/abd _____

DATE FILED **4-28-83**

LAND: FEE & PATENTED _____ STATE LEASE NO. _____ PUBLIC LEASE NO. **U-21794** INDIAN _____

DRILLING APPROVED: **4-28-83 - OIL/GAS**

SPUDDED IN: _____

COMPLETED: _____ PUT TO PRODUCING: _____

INITIAL PRODUCTION: _____

GRAVITY A.P.I. _____

GOR. _____

PRODUCING ZONES: _____

TOTAL DEPTH: _____

WELL ELEVATION: **5059' GR**

DATE ABANDONED: **1-1-85 Application Rescinded**

FIELD: **3/80 Wildcat**

UNIT: **Desert Lake**

COUNTY: **Emery**

WELL NO. **Desert Lake Unit #2** API #**43-015-30164**

LOCATION **1850** FT. FROM (S) LINE. **700** FT. FROM (W) LINE. **NWSW** 1/4 - 1/4 SEC. **13**

| TWP. | RGE. | SEC. | OPERATOR | TWP. | RGE. | SEC. | OPERATOR |
|------|------|------|----------|------------|------------|-----------|---------------------------------|
| | | | | 17S | 12E | 13 | AMOCO PRODUCTION COMPANY |

UNITED STATES
DEPARTMENT OF THE INTERIOR
GEOLOGICAL SURVEY

MINERALS MANAGEMENT
SERVICE

REGISTRATION AND SPECIAL LOCATIONS
RECEIVED

APPLICATION FOR PERMIT TO DRILL, DEEPEN, OR PLUG BACK

1a. TYPE OF WORK
 DRILL DEEPEN PLUG BACK

b. TYPE OF WELL
 OIL WELL GAS WELL OTHER Wildcat SINGLE ZONE MULTIPLE ZONE

2. NAME OF OPERATOR
 Amoco Production Company

3. ADDRESS OF OPERATOR
 501 Airport Dr., Farmington, NM 87401

4. LOCATION OF WELL (Report location clearly and in accordance with any State requirements.*)
 At surface 1850' FSL x 700' FWL
 At proposed prod. zone Same

5. IF INDIAN, ALLOTTEE OR TRIBE NAME

6. UNIT AGREEMENT NAME
 Desert Lake Unit

7. FARM OR LEASE NAME

8. WELL NO.
 2

9. FIELD AND POOL, OR WILDCAT
 Wildcat

10. SEC., T. R., M., OR BLK. AND SURVEY OR AREA
 NW/4, Section 13, T17E R12E

11. COUNTY OR PARISH 13. STATE
 Emery Utah

12. DISTANCE IN MILES AND DIRECTION FROM NEAREST TOWN OR POST OFFICE*
 Approximately 20 miles southeast of Wellington

14. DISTANCE FROM PROPOSED* LOCATION TO NEAREST PROPERTY OR LEASE LINE, FT. (Also to nearest drlg. unit line, if any)
 4580

15. NO. OF ACRES IN LEASE
 37,714

16. NO. OF ACRES ASSIGNED TO THIS WELL
 Wildcat

17. DISTANCE FROM PROPOSED LOCATION* TO NEAREST WELL, DRILLING, COMPLETED, OR APPLIED FOR, ON THIS LEASE, FT.
 7550'

18. PROPOSED DEPTH
 2550'

19. ROTARY OR CABLE TOOLS
 Rotary

20. ELEVATIONS (Show whether DF, RT, GR, etc.)
 5059' GL

21. APPROX. DATE WORK WILL START*
 As soon as permitted

PROPOSED CASING AND CEMENTING PROGRAM

| SIZE OF HOLE | SIZE OF CASING | WEIGHT PER FOOT | SETTING DEPTH | QUANTITY OF CEMENT |
|--------------|----------------|-----------------|---------------|--|
| 12-1/4" | 9-5/8" | 32.3# H-40 | 200' | 230 cu ft class H w/2% CaCl ₂ |
| 8-3/4" | 5-1/2" | 14# K-55 | 2550' | 585 cu ft class H 50:50 poz, w/6% g 0.8% FLA, tail in w/380 cu ft class H neat. |

Amoco Production Company proposes to drill the above wildcat well to a depth of 2550 to test the Moenkopi and Kaibab formations. Surface hole will be drilled with native mud. Hole will then be drilled to TD with a water base low solids non-dispersed mud system. Two 60-foot conventional cores will be taken in the Moenkopi formation. Shallow aquifers will not be over pressured. Completion will be based on open hole logs. Copies of all logs run will be furnished upon reaching total depth. Copies of location plats are attached as well as additional information required by NTL-6.

THIS WELL IS BEING DRILLED AS A TIGHT HOLE AND INFORMATION IS TO BE KEPT CONFIDENTIAL.

CONFIDENTIAL

IN ABOVE SPACE DESCRIBE PROPOSED PROGRAM: If proposal is to deepen or plug back, give data on present productive zone and proposed new productive zone. If proposal is to drill or deepen directionally, give pertinent data on subsurface locations and measured and true vertical depths. Give blowout preventer program, if any.

24. SIGNED D.A. Shoemaker TITLE District Engineer DATE 4-25-83

(This space for Federal or State office use)

PERMIT NO. WT 1212 APPROVAL DATE E. W. Gwynn
 APPROVED BY [Signature] TITLE District Oil & Gas Supervisor DATE JUN 10 1983

CONDITIONS OF APPROVAL, IF ANY:

NOTICE OF APPROVAL

CONDITIONS OF APPROVAL ATTACHED
TO OPERATOR'S COPY

FLARING OR VENTING OF
GAS IS SUBJECT TO NTL-6
LATE 1980

State 046

COMPANY AMOCO PRODUCTION COMPANY

LEASE DESERT LAKE WELL NO. 2

SEC. 13, T 17S, R 12E SLM
EMERY COUNTY, UTAH

LOCATION 1850'ESL 700'FWL

ELEVATION 5059 ungraded ground

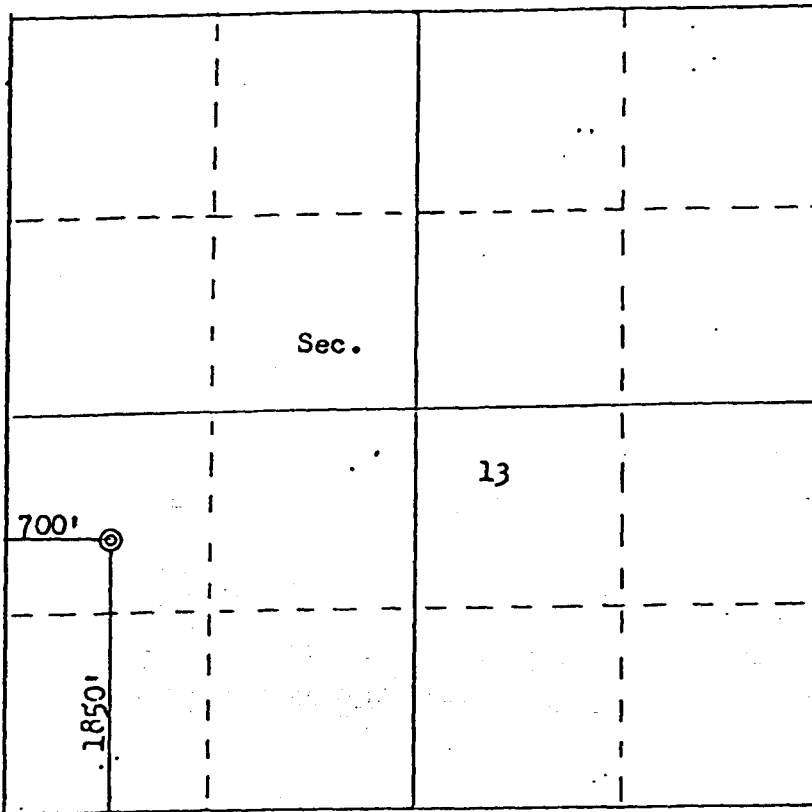

SCALE—4 INCHES EQUALS 1 MILE

THIS IS TO CERTIFY THAT THE ABOVE PLAT WAS PREPARED FROM FIELD NOTE OF ACTUAL SURVEYS MADE BY ME UNDER MY SUPERVISION AND THAT THE SAME ARE TRUE AND CORRECT TO THE BEST OF MY KNOWLEDGE AND BELIEF.

SCALE:

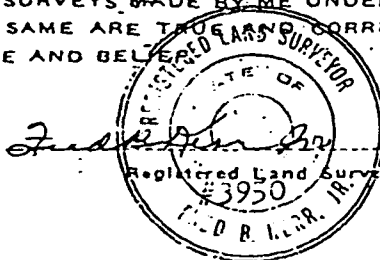

SURVEYED March 23, 1983

Amoco Production Company
Well No. 2
Section 13, T. 17 S., R. 12 E.
Emery County, Utah
Desert Lake Unit
Lease U-21794

Supplemental Stipulations

- 1) Adequate precautions must be taken to protect and isolate fresh water aquifers. At abandonment, plugging and cementing procedures shall insure that all fresh water aquifers are isolated and protected.
- 2) Amoco shall insure that all individuals working at or near the location are aware of and comply with all applicable stipulations.
- 3) A pre-construction on-site shall be arranged by Amoco at which representatives of the BLM, Amoco and the dirt contractor shall be present.
- 4) Roads shall be constructed where flagging was located during the on-site inspection. Driving surface widths of the road is to be limited to 16 feet with turnouts at least every 1,000 feet or less as determined by terrain. Roads will be crowned and ditched or sloped with water bars and water turnouts where feasible, if the well is a producer. Changes in finished road design may be required by the BLM.
- 5) On sidehill sections where the road material contains over 50 percent rock and cross slope is from 10 to 65 percent, the road shall be outsloped from 2 to 4 percent. On all other side hill sections the road shall be insloped or crowned with appropriate ditches in either case.
- 6) The canyon wall behind the blow pit shall be protected from discoloration.
- 7) Littering of access roads or pad area by personnel involved in the drilling operation or construction shall be prevented or corrected by Amoco. Litter pickup along access roads or in the pad area may be required. Collected garbage and trash will be disposed of at an authorized landfill. Drained equipment oil will be disposed of in pits at drill sites or at a landfill.
- 8) The completed road used for a producing well shall be maintained so that the travel surface is free of excessive ruts, holes, soft spots, slides and washboards. The road, drainages, and shoulders shall be free of large rocks, vegetative debris and slides. Drainage ditches shall be relatively free of sediments and not excessively eroded. Low water crossings shall be maintained.

- 9) During periods of weather when activity would result in deep rutting (6 inches or more) of the driving surface or excessive disturbance on the right-of-way, a stop work order may be verbally issued by the Authorized Officer with a follow-up written order. An authorization to resume work will be required.
- 10) Residues and contaminated earth in mud pits may be required to be completely removed if, with reclamation, same would be near or exposed at the surface.
- 11) Any production facilities will be painted a single, low gloss, pastel color that will blend with the color of soils, rock or vegetation. Color will be approved by the BLM's representative.
- 12) Reclamation, when determined necessary by the BLM, will return all disturbed areas to a color and topographic form that blends with the surroundings. Any topsoil stockpiled will be redistributed and the area seeded as specified by the BLM at the time of reclamation. Erosion control devices will be required as determined by the BLM.

UNITED STATES
DEPARTMENT OF THE INTERIOR
GEOLOGICAL SURVEY

APPLICATION FOR PERMIT TO DRILL, DEEPEN, OR PLUG BACK

1a. TYPE OF WORK
 DRILL DEEPEN PLUG BACK
 b. TYPE OF WELL
 OIL WELL GAS WELL OTHER Wildcat SINGLE ZONE MULTIPLE ZONE

2. NAME OF OPERATOR
Amoco Production Company

3. ADDRESS OF OPERATOR
501 Airport Dr., Farmington, NM 87401

4. LOCATION OF WELL (Report location clearly and in accordance with any State requirements)
 At surface 1850' FSL x 700' FWL
 At proposed prod. zone Same

14. DISTANCE IN MILES AND DIRECTION FROM NEAREST TOWN OR POST OFFICE*
Approximately 20 miles southeast of Wellington

15. DISTANCE FROM PROPOSED* LOCATION TO NEAREST PROPERTY OR LEASE LINE, FT. (Also to nearest drlg. unit line, if any) 4580

16. NO. OF ACRES IN LEASE 37,714

18. DISTANCE FROM PROPOSED LOCATION* TO NEAREST WELL, DRILLING, COMPLETED, OR APPLIED FOR, ON THIS LEASE, FT. 7550'

19. PROPOSED DEPTH 2550'

21. ELEVATIONS (Show whether DF, RT, GR, etc.)
5059' GL

23. PROPOSED CASING AND CEMENTING PROGRAM

| SIZE OF HOLE | SIZE OF CASING | WEIGHT PER FOOT | SETTING DEPTH |
|--------------|----------------|-----------------|---------------|
| 12-1/4" | 9-5/8" | 32.3# H-40 | 200' |
| 8-3/4" | 5-1/2" | 14# K-55 | 2550' |

5. LEASE DESIGNATION AND SERIAL NO.
U-21794

6. IF INDIAN, ALLOTTEE OR TRIBE NAME

7. UNIT AGREEMENT NAME
Desert Lake Unit

8. FARM OR LEASE NAME

9. WELL NO.
2

10. FIELD AND POOL, OR WILDCAT

11. TOWNSHIP, RANGE, OR SECTION
Section 13, R12E

12. COUNTY OR PARISH, STATE
Emery Utah

20. ROTARY OR CABLE TOOL
Rotary

22. APPROX. DATE WORK WILL START*
As soon as permitted

APR 28 1983
DIVISION OF OIL, GAS & MINING
WHITE RISE

12

QUANTITY OF CEMENT
 230 cu ft class H w/2% CaCl₂
 585 cu ft class H 50:50 pos, w/6% gel
 0.8% FeAO tail w/380 cu ft class H net

Amoco Production Company proposes to drill the above wildcat well to a depth of 2550 to test the Moenkopi and Kaibab formations. Surface hole will be drilled with native mud. Hole will then be drilled to TD with a water base low solids non-dispersed mud system. Two 60-foot conventional cores will be taken in the Moenkopi or marlion shallow aquifers will not be over pressured. Completion will be based on open hole logs. Copies of all logs run will be furnished upon reaching total depth. Copies of all logs run will be furnished upon reaching total depth. Copies of all logs run will be furnished upon reaching total depth. Copies of all logs run will be furnished upon reaching total depth.

THIS WELL IS BEING DRILLED AS A TIGHT HOLE AND INFORMATION IS TO BE KEPT CONFIDENTIAL.

CONFIDENTIAL

IN ABOVE SPACE DESCRIBE PROPOSED PROGRAM: If proposal is to deepen or plug back, give data on present productive zone and proposed new productive zone. If proposal is to drill or deepen directionally, give pertinent data on subsurface locations and measured and true vertical depths. Give blowout preventer program, if any.

24. SIGNED D. H. Shoemaker TITLE District Engineer

(This space for Federal or State office use)

PERMIT NO. _____ APPROVAL DATE _____

APPROVED BY _____ TITLE _____

APPROVED BY THE STATE
OF UTAH DIVISION OF
OIL, GAS, AND MINING
DATE: 4-28-83
BY: James A. ...

COMPANY AMOCO PRODUCTION COMPANY

LEASE DESERT LAKE WELL NO. 2

SEC. 13, T 17S, R 12E SLM
EMERY COUNTY, UTAH

LOCATION 1850' FSL 700' FWL

ELEVATION 5059 ungraded ground

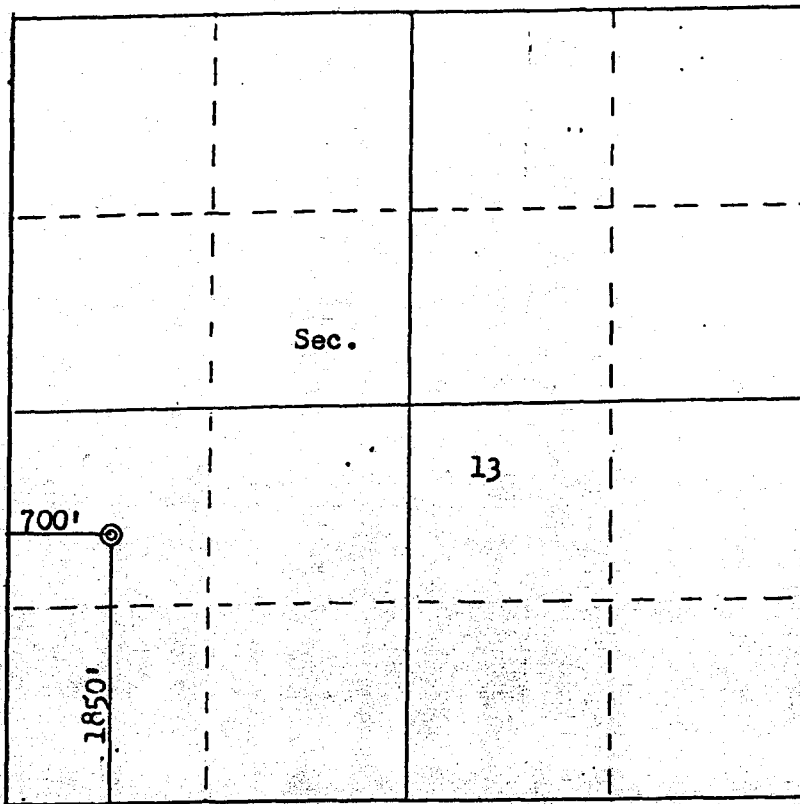

SCALE—1 INCHES EQUALS 1 MILE

THIS IS TO CERTIFY THAT THE ABOVE PLAT WAS PREPARED FROM FIELD NOTE OF ACTUAL SURVEYS MADE BY ME UNDER MY SUPERVISION AND THAT THE SAME ARE TRUE AND CORRECT TO THE BEST OF MY KNOWLEDGE AND BELIEF.

SEAL:

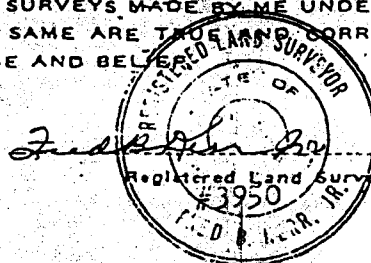

SURVEYED March 23 1983

SUPPLEMENTAL INFORMATION TO FORM 9-331-C

Desert Lake Unit No. 2
1850' FSL x 700' FWL, Section 13, T17S, R12E
Emery County, Utah

1. Geological Name of Surface Formation: Entrada
2. Estimated Tops of Important Geological Markers:

| | | <u>Expected Fluids</u> |
|-----------|-------|------------------------|
| Carmel | 300' | water |
| Navajo | 520' | water |
| Kayenta | 870' | water |
| Wingate | 980' | water |
| Chinle | 1290' | water |
| Moenkopi | 1540' | oil |
| Kaibab | 2370' | oil |
| White Rim | 2520' | oil |
| TD | 2550' | |

3. Estimated Depths Anticipated to Encounter Water, Oil, Gas, or Other Mineral-Bearing Formations:

See Item No. 2 Above

4. Casing Program: See Form 9-331C, Item No. 23
5. Operators Minimum Specifications for Pressure Control Equipment are Explained on Attached Schematic Diagram. After running surface casing and prior to drilling out, the BOP and other pressure equipment will be tested to the full working pressure rating as shown on the attached diagram. Thereafter, the BOP will be checked daily for mechanical operations only, and will be noted on the IADC Drilling Report. (See Exhibit BOP-3000)
6. Mud Program:
Drilling fluid to TD will be a low solids non-dispersed mud system.
7. Auxiliary Equipment:
Kelly cock, floor sub with full opening valve, geolograph, mudlogging unit (2-man type).
8. Testing Program:
Drill stem tests may be taken at approximately 1500-1700', 2340-2450'
Coring program

Two, 60-foot conventional cores will be taken in the Moenkopi formation.

Logging Program

Open hole logs will include the following from the base of the surface casing to TD:

DIL-GR-SP
FDC-CNL-GR w/Caliper
BHC Sonic - GR
Dipmeter
Long Spaced Digital Sonic Log
Borehole Televiewer

Completion will be based on these logs.

9. No abnormal pressures, temperatures, or hydrogen sulfide gas is anticipated.
10. Operations will commence when approved and will last approximately five (5) weeks from start to finish.

MULTI-POINT SURFACE USE & OPERATIONS PLAN

Desert Lake Unit No. 2
700' FWL & 1850' FSL, Section 13, T17S, R12E
Emery County, Utah

1. EXISTING ROADS:

- A. Proposed well site as staked: NW/4, SW/4, Section 14, T17S, R12E, See Exhibit "C"
- B. Route and distance from nearest town or locatable reference to where well access route leaves main road: See Exhibit "B"
- C. Access road to location color-coded or labeled: See Exhibit "A"
- D. If exploratory well, all existing roads within a 3-mile radius of wellsite: See Exhibit "D"
- E. If development well, all existing roads within a 1-mile radius of wellsite: N/A
- F. Plans for improvement and/or maintenance of existing roads:

Amoco proposes to repair and improve the jeep trail from its point of beginning in Section 23, T17S, R13E, to its end at the well site in Section 13, T17S, R13E. All access roads will be bar ditched on up-hill side, when necessary. See Exhibit "D". From the well site to the Price river a new road, approximately 1/2 mile in length, will be built for the purpose of hauling water. The BLM's representative (Sid Vogelpohl) will be notified at least 48 hours prior to any surface disturbing activities associated with new access roads or drill pad location.

2. PLANNED ACCESS ROADS:

- 1. Width: 16 feet
- 2. Maximum Grade: 2%
- 3. Drainage Design: Crowned and ditched with water bars
- 4. Turnouts: Every 1000 feet.
- 5. Location and size of culverts, location of any major cuts or fills: None
- 6. Surfacing Material: Native Soil
- 7. Gates, cattleguards, or fencecuts: None
- 8. Centerline stake for new or reconstructed access: Centerline flagging for access and location is in place. Roads will be constructed where flagging was located during the onsite inspection.

3. LOCATION OF EXISTING WELLS:

- 1. Water wells: None
- 2. Abandoned wells: 1 (Lucky Flats Unit No. 1, NE/4, SE/4, Section 27, T17S, R12E)
- 3. Temporarily Abandoned wells: None
- 4. Disposal wells: None
- 5. Drilling wells: Desert Lake Unit No. 1
- 6. Producing wells: None
- 7. Shut-in wells: None
- 8. Injection wells: None
- 9. Monitoring or observation wells: None

4. LOCATION OF EXISTING AND/OR PROPOSED FACILITIES:

A. Lessee Operated/Owned Facilities within a 1-Mile Radius:

- (1) Tank Batteries: None
- (2) Production Facilities: None
- (3) Oil Gathering Lines: None
- (4) Gas Gathering Lines: None
- (5) Injection Lines: None
- (6) Disposal Lines: None

B. New Lessee Operated/Owned Facilities in the Event of Production:

- (1) Location of all Lines: Location of all lines are to be on the drillsite.
- (2) Dimension of Facilities: Approximately 125' x 125'
- (3) Construction Methods and Materials: Amoco and OSHA approved construction methods and materials will be used.
- (4) Protective Measures and Devices to Protect Livestock and Wildlife: Pits will be fenced and covered until dry, then backfilled. A pumping unit, if installed, will be fenced. Recycle pumps, if any, will be enclosed.

C. Plan for Rehabilitation of Disturbed Areas No Longer Needed for Operations After Construction is Completed:

Areas no longer needed will be leveled and contoured to as nearly the original topography as is feasible. The top soil will be evenly spread over the entire location after contouring is complete. The area will be reseeded with recommendations from the Bureau of Land Management.

5. LOCATION AND TYPE OF WATER SUPPLY:

- A. Location and Type by Map or Description: Water will be hauled from the Price River in Section 13, T17S, R12E, which is approximately 1/2 mile from the drill site.
- B. Transportation & Roads: Water will be trucked from Price River over newly constructed access roads. See Exhibit "D".
- C. Water Well to be Drilled: None

6. SOURCE OF CONSTRUCTION MATERIALS:

- A. Location by Map or Description: Construction materials will be obtained from the disturbed area.
- B. Federal or Indian Land Ownership: Bureau of Land Management administers surface resources out of Price River Resource Area Office.
- C. Construction Material Obtained and Used: No construction material will be hauled in for this project.

D. Access Roads on Federal or Indian Land to Construction Material Source: None Required.

7. METHODS FOR HANDLING WASTE DISPOSAL:

1. Cuttings: A 100' x 100' x 5' reserve pit will be built on location to hold all drilling waste.
2. Drilling Fluid: See 1, above
3. Produced Fluids, Oil and Water: To be contained in the reserve pit until clean-up, then skimmed or burned as the situation dictates. Drained equipment oil will be disposed of in pit.
4. Sewage: To be buried or trucked from the location after operations are concluded.
5. Garbage and Other Waste: Will be contained in a steel mesh portable trash container 8' x 12' x 6' enclosed, and will be hauled from location to an authorized landfill when filled.
6. Clean Up After Rig Removal: The surface of the drill pad will be graded. The "mouse" and "rat" holes, sewage, burn pits, etc., will be filled as soon as possible; the reserve pit will be fenced on all four sides until dry, then filled, recontoured and seeded.

8. AUXILIARY FACILITIES: Camps and/or Airstrips

Noen Planned.

9. WELL SITE LAYOUT:

1. Drill Pad Cross Section: See Exhibit "F"
2. Location of Mud Tanks, Reserve Pit, Burn and Trash Pit, Etc.: See Exhibit "E"
3. Rig Orientation: See Exhibit "E"
4. Pits: All pits will be unlined as requested by the BLM. The canyon wall behind the blow pit will be protected from discoloration.

10. PLANS FOR RESTORATION OF SURFACE:

1. All pits and holes will be filled after rig removal except the reserve pit which will be fenced on all four sides.
2. Six to eight inches of topsoil on the entire pad site or all available topsoil shall be removed and stock piled. Revegetation and rehabilitation of the location and access roads will be handled per BLM specifications.
3. Pits will be fenced per stipulations during drilling operations and after rig release.
4. Reserve pit oil will be removed, burned or the pit flagged as necessary.
5. Rehabilitation and reseeding will take place within 90 days of completion of operations or as weather conditions permit.
6. Upon completion of drilling operations, the BLM will be notified so that an inspection may be conducted to determine if mitigating measures in addition to those included in this surface use plan are necessary.

11. OTHER INFORMATION:

1. General Description of Surface: The general topography and soil characteristics are a slight knoll on a bench above the bottom of Stove Gulch, with a rocky, sandy loam soil, and juniper trees and native grasses.
2. Surface Use and Surface Ownership: The area is primarily used for cattle and sheep grazing.

(3) Proximity of Water, Occupied Dwellings, Archaeological, Historical, or Cultural Sites: Price River is located approximately 1/2 miles northeast of drill site. There are no occupied dwellings in the area. There are no historical, cultural, or archaeological sites in the general area. See Exhibit "G"

12. OPERATOR'S REPRESENTATIVE: S. D. Blossom
Phone (Office): 505-325-8841
Address: 501 Airport Drive, Farmington, NM 87401

13. CERTIFICATION: I hereby certify that I, or persons under my direct supervision, have inspected the proposed drillsite and access route, that I am familiar with the conditions which presently exist; that the statements made in this plan are, to the best of my knowledge, true and correct; and, that the work associated with the operations proposed herein will be performed by AMOCO PRODUCTION COMPANY and its contractors and subcontractors in conformity with this plan and the terms and conditions under which it is approved.

DATE:

4/26/83

S. D. Blossom
S. D. Blossom, District Superintendent

EXHIBIT BOP-3000
MINIMUM BLOW-OUT PREVENTER REQUIRMENTS
3,000 psi W.P.

NOTE:

1 DRILLING NIPPLE TO BE SO CONSTRUCTED THAT IT CAN BE REMOVED WITHOUT USE OF A WELDER, THROUGH ROTARY TABLE OPENING; WITH MINIMUM I.D. EQUAL TO PREVENTER BORE.

2 WEAR RING TO BE PROPERLY INSTALLED IN HEAD.

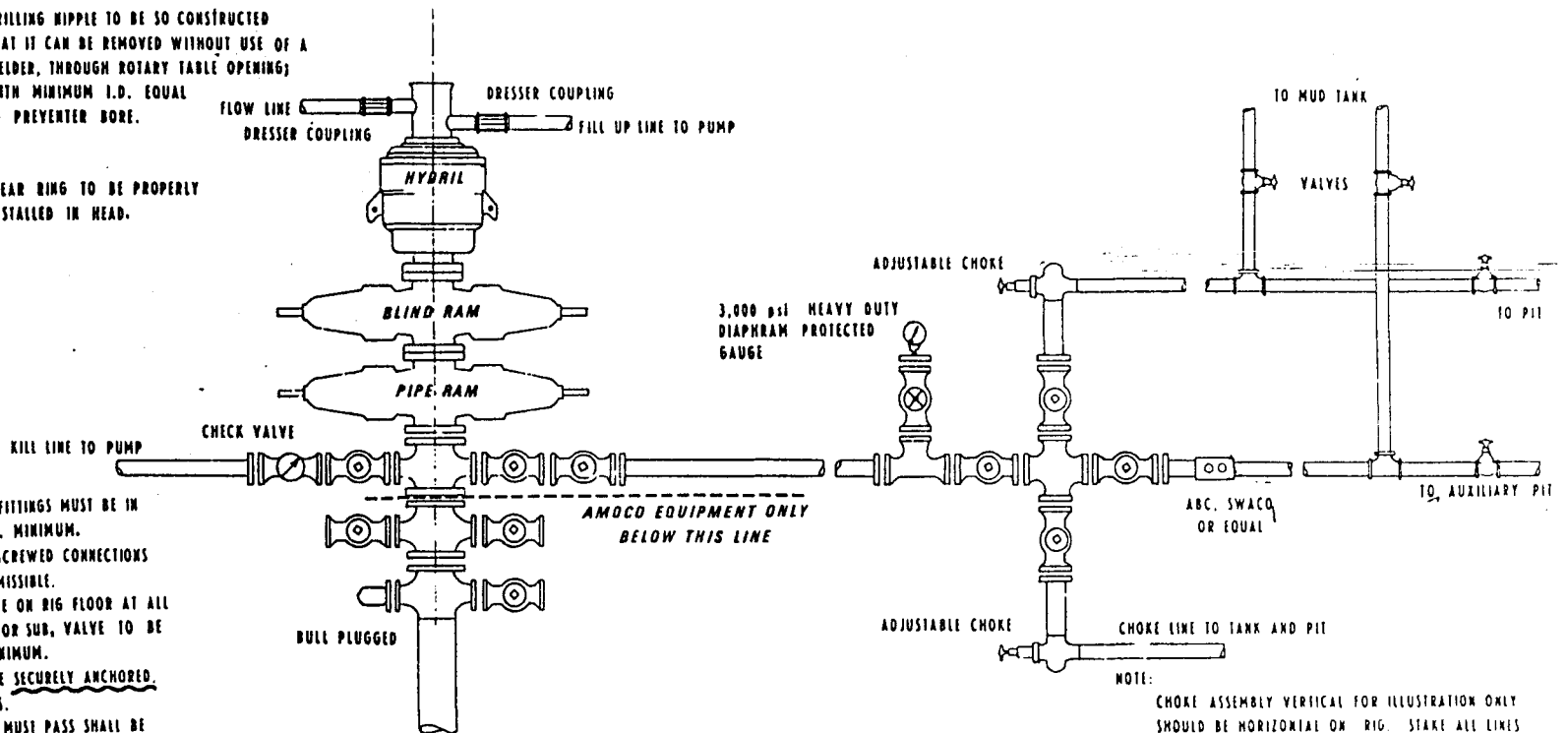

NOTE:

- 1 BLOW-OUT PREVENTERS AND ALL FITTINGS MUST BE IN GOOD CONDITION 3,000 psi W.P. MINIMUM.
- 2 ALL FITTINGS TO BE FLANGED. SCREWED CONNECTIONS DOWNSTREAM FROM CHOKES PERMISSIBLE.
- 3 SAFETY VALVE MUST BE AVAILABLE ON RIG FLOOR AT ALL TIMES WITH PROPER CONNECTION OR SUB, VALVE TO BE FULL BORE 3,000 psi W.P. MINIMUM.
- 4 ALL CHOKE AND KILL LINES TO BE SECURELY ANCHORED, ESPECIALLY ENDS OF CHOKE LINES.
- 5 EQUIPMENT THROUGH WHICH BIT MUST PASS SHALL BE AS LARGE AS INSIDE DIAMETER OF THE CASING BEING DRILLED THROUGH.
- 6 KELLY COCK ON KELLY.
- 7 EXTENSION WRENCHES AND HAND WHEELS TO BE PROPERLY INSTALLED AND BRACED AT ALL TIMES.
- 8 BLOW-OUT PREVENTER CONTROL TO BE LOCATED AS CLOSE TO DRILLERS POSITION AS FEASIBLE.
- 9 BLOW-OUT PREVENTER CLOSING EQUIPMENT TO INCLUDE 10 GALLON ACCUMULATOR, TWO INDEPENDENT SOURCES OF PUMP POWER ON EACH CLOSING UNIT INSTALLATION, AND MEET ALL IADC SPECIFICATIONS.

NOTE:

ALL VALVES TO BE FULL OPENING

NOTE:

CHOKE ASSEMBLY VERTICAL FOR ILLUSTRATION ONLY SHOULD BE HORIZONTAL ON RIG. STAKE ALL LINES SECURELY EVERY 30' AND AT END OF LINE.

Profile for
 AMOCO PRODUCTION CO. #2 DESERT LAKE
 1850'FSL 700'FWL Sec. 13-T17S-R12E SLM
 EMERY COUNTY, UTAH

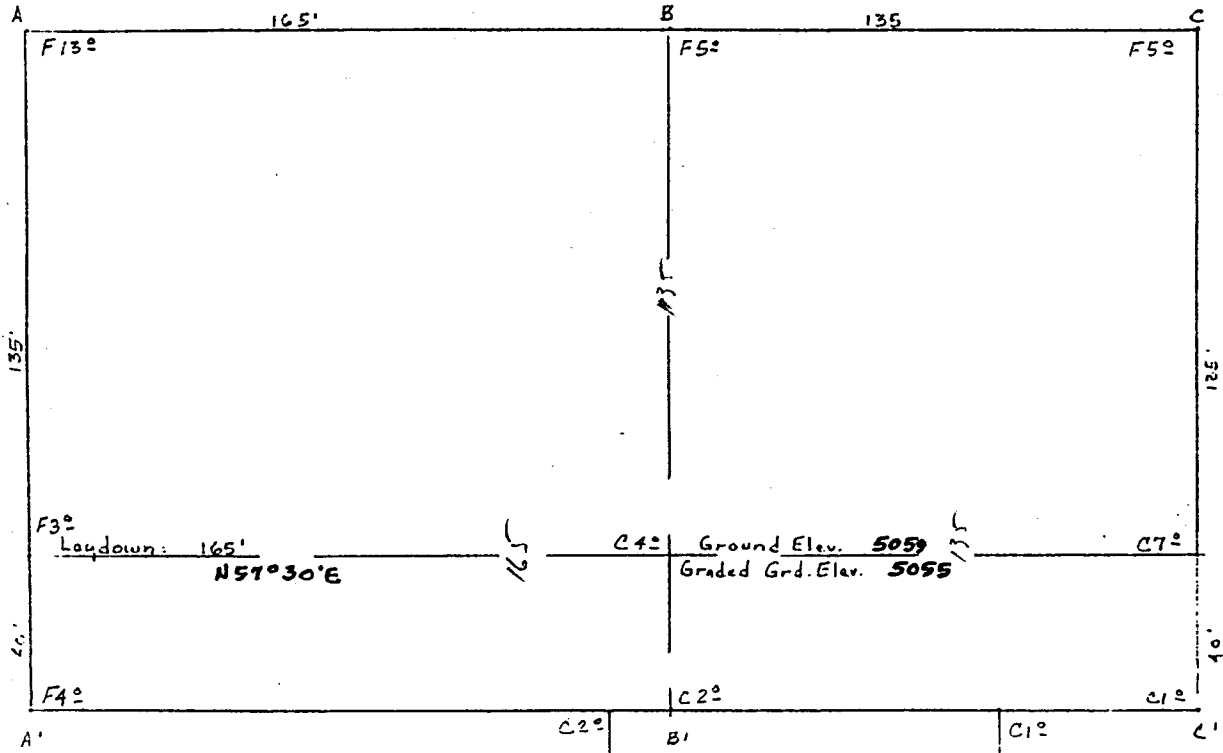

Scale: 1"=50'

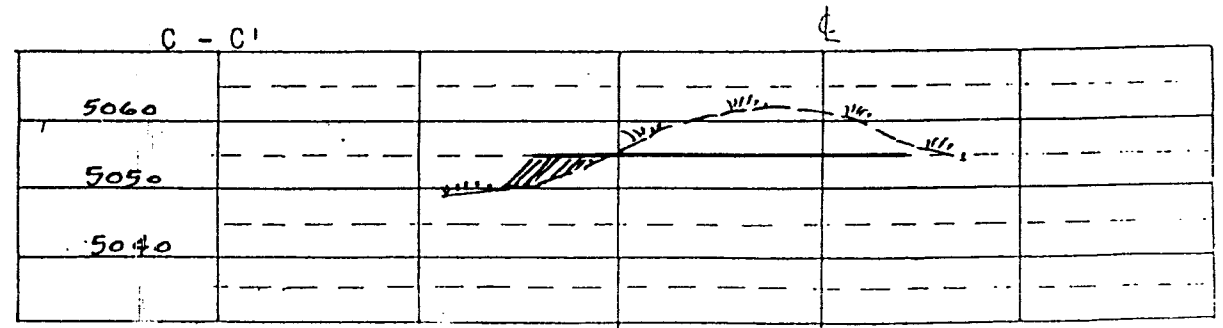
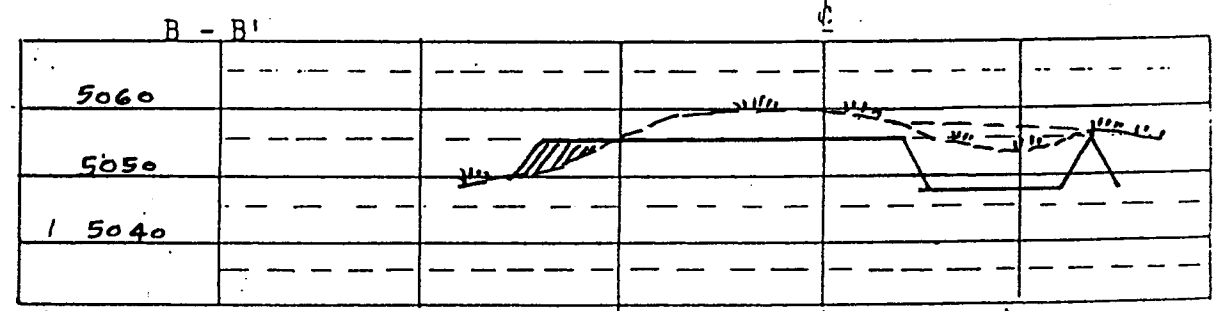
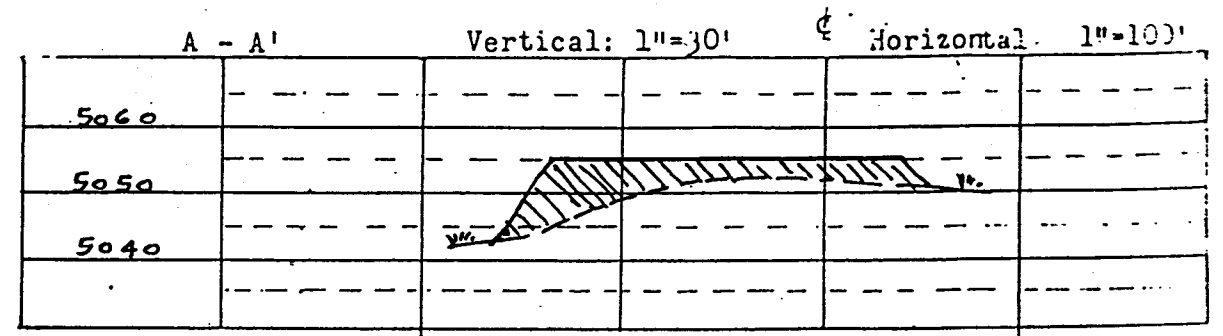
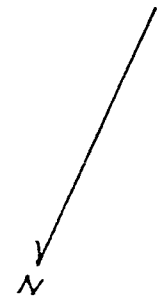

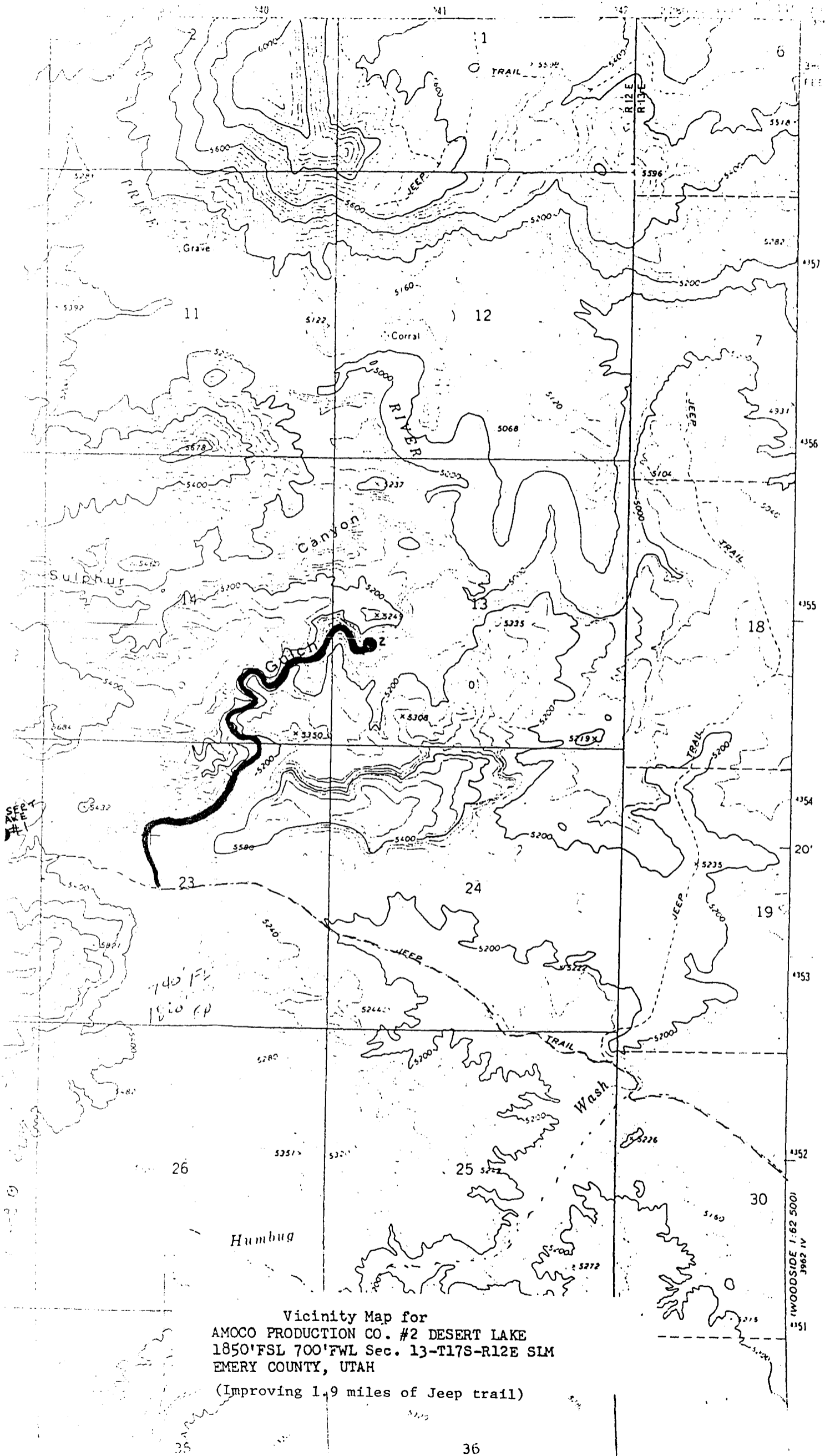

Vicinity Map for
 AMOCO PRODUCTION CO. #2 DESERT LAKE
 1850'FSL 700'FWL Sec. 13-T17S-R12E S1M
 EMERY COUNTY, UTAH
 (Improving 1.9 miles of Jeep trail)

Farmington District Transportation Sketch
 Denver Region
 Desert Lake No. 2
 Emery County, Utah
 Amoco WI: 100%

Rail Point, Grand Junction, CO 155 miles
 Mud Point Grand Junction, CO 155 miles
 Cement Point - Grand Junction, CO 155 miles

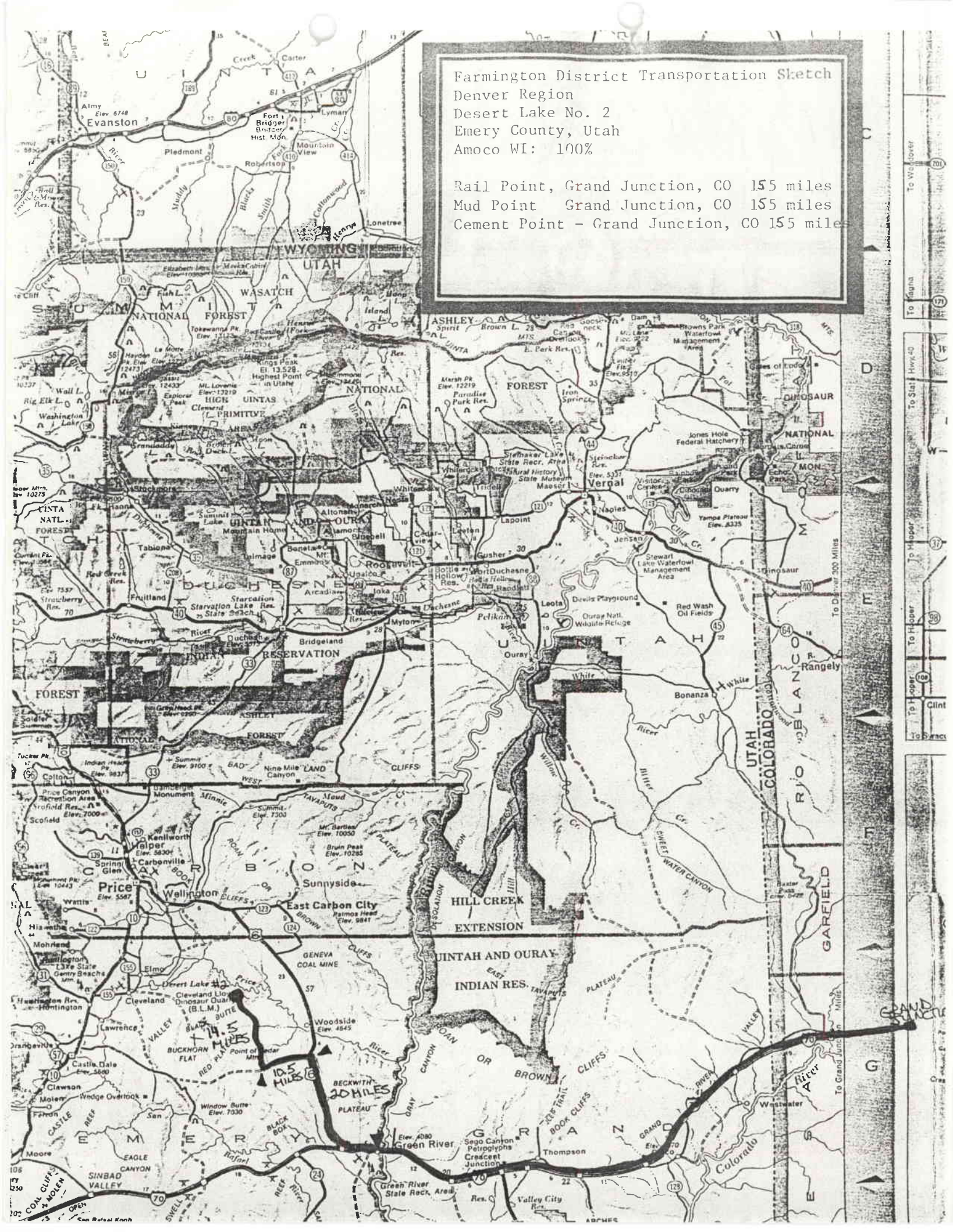

CONFIDENTIAL

OPERATOR AMOCO PRODUCTION CO

DATE 4-28-83

WELL NAME DESERT LAKE UNIT #2

SEC NW SW 13 T 17S R 12E COUNTY EMERY

CONFIDENTIAL

43-015-30164

API NUMBER

FED

TYPE OF LEASE

POSTING CHECK OFF:

INDEX

HL

NID

PI

MAP

PROCESSING COMMENTS:

RJF ✓

APPROVAL LETTER:

SPACING:

A-3

DESERT LAKE
UNIT

c-3-a

CAUSE NO. & DATE

c-3-b

c-3-c

SPECIAL LANGUAGE:

RECONCILE WELL NAME AND LOCATION ON APD AGAINST SAME DATA ON PLAT MAP.

AUTHENTICATE LEASE AND OPERATOR INFORMATION

VERIFY ADEQUATE AND PROPER BONDING *FED*

AUTHENTICATE IF SITE IS IN A NAMED FIELD, ETC.

APPLY SPACING CONSIDERATION

ORDER _____

UNIT *DESERT LAKE*

c-3-b

c-3-c

CHECK DISTANCE TO NEAREST WELL.

CHECK OUTSTANDING OR OVERDUE REPORTS FOR OPERATOR'S OTHER WELLS.

IF POTASH DESIGNATED AREA, SPECIAL LANGUAGE ON APPROVAL LETTER
CONFIDENTIAL

IF IN OIL SHALE DESIGNATED AREA, SPECIAL APPROVAL LANGUAGE.

CONFIDENTIAL

April 28, 1983

Amoco Production Company
501 Airport Drive
Farmington, New Mexico 87401

RE: Well No. Desert Lake Unit #2
NWSW Sec. 13, T.17S, R.12E
1850 FSL, 700 FWL
Emery County, Utah

Gentlemen:

Insofar as this office is concerned, approval to drill the above referred to oil/gas well is hereby granted in accordance with Section 40-6-11, Utah Code Annotated 1953; and predicated on Rule A-3, General Rules and Regulations and Rules of Practice and Procedure.

Should you determine that it will be necessary to plug and abandon this well, you are hereby requested to immediately notify the following:

RONALD J. FIRTH - Chief Petroleum Engineer
Office: 533-5771
Home: 571-6068

Enclosed please find Form OGC-8-X, which is to be completed whether or not water sands (aquifers) are encountered during drilling. Your cooperation in completing this form will be appreciated.

Further, it is requested that this Division be notified within 24 hours after drilling operations commence, and that the drilling contractor and rig number be identified.

The API number assigned to this well is 43-015-30164.

Sincerely,

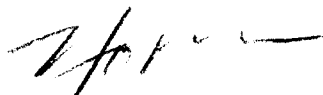
Norman C. Stout
Administrative Assistant

NCS/as
cc: Oil & Gas Operations
Enclosure



STATE OF UTAH
NATURAL RESOURCES
Oil, Gas & Mining

Scott M. Matheson, Governor
Temple A. Reynolds, Executive Director
Dianne R. Nielson, Ph.D., Division Director

4241 State Office Building • Salt Lake City, UT 84114 • 801-533-5771

September 25, 1984

Bureau of Land Management
Branch of Fluid Minerals
P.O. Box 970
Moab, Utah 84532

Gentlemen:

Re: Applications to Drill Over One Year Old

Enclosed is a list of wells in your district that were given State approval to drill over one year ago. We have received copies of federal approval as noted.

Please let me know what action, if any, the Bureau of Land Management is taking on these wells.

Thank you for your help in keeping our records up to date.

Sincerely,

A handwritten signature in cursive script that reads "Claudia Jones".

Claudia Jones
Well Records Specialist

clj
Attachment
cc: Dianne R. Nielson
 Ronald J. Firth
 John R. Baza
 File
00000005/1-2

Attachment I
Bureau of Land Management
September 24, 1984

Amoco Production Company
Well No. Desert Lake Unit #2
Sec. 13, T. 17S., R. 12E.
Emery County, Utah
API #43-015-30164
Lease No. U-217934
State Approval - April 28, 1983
Federal Approval - June 10, 1983

Skyline Oil Company
Well No. Federal #10-11
Sec. 10, T. 16S., R. 12E.
Emery County, Utah
API #43-015-30147
Lease No. U-43777
State Approval - Dec. 16, 1982
Federal Approval - Dec. 27, 1982

Amoco Production Company
Well No. USA AMOCO "M" #1
Sec. 5, T. 37S., R. 13E.
San Juan County, Utah
API #43-037-30934
Lease No. U-39585
State Approval - September 12, 1983
Federal Approval - not received

Amoco Production Company
Well No. USA AMOCO "L" #1
Sec. 22, T. 37S., R. 13E.
San Juan County, Utah
API #43-037-30935
Lease No. U-39579
State Approval - September 12, 1983
Federal Approval - not received

Amoco Production Company
Well No. USA AMOCO "N" #1
Sec. 24, T. 37S., R. 13E.
San Juan County, Utah
API #43-037-30936
Lease #U-30582
State Approval - September 12, 1983
Federal Approval - Not received



STATE OF UTAH
NATURAL RESOURCES
Oil, Gas & Mining

Scott M. Matheson, Governor
Temple A. Reynolds, Executive Director
Dianne R. Nielson, Ph.D., Division Director

4241 State Office Building • Salt Lake City, UT 84114 • 801-533-5771

January 15, 1985

Bureau of Lands Management
Branch of Fluid Minerals
P O Box 970
Moab, Utah 84532

Gentlemen:

Re: Well No. Desert Lake Unit #2 - Sec. 13, T. 17S., R. 12E.
Emery County, Utah - AP1 #43-015-30164 - Lease #U-21794
Operator - Amoco Production Company

The above referred to well in your district was given Federal approval to drill June 10, 1983. This office has not received notification of any activity on this location.

Please let me know what action, if any, the Bureau of Land Management is taking on this well.

Thank you for your help in keeping our records up to date.

Sincerely,

A handwritten signature in cursive script that reads "Claudia L. Jones".

Claudia L. Jones
Well Records Specialist

cc: Dianne R. Nielson
Ronald J. Firth
John R. Baza
File
0009S/24

3162 (U-065)
(U-21794)

Moab District
P. O. Box 970
Moab, Utah 84532

28 JAN 1985

Amoco Production Company
501 Airport Drive
Farmington, NM 87401

Re: Rescinding Application for
Permit to Drill
Well No. Desert Lake Unit 2
Sec. 13, T. 17 S., R. 12 E.
Emery County, Utah
Lease U-21794

Gentlemen:

The Application for Permit to Drill the referenced well was approved on June 10, 1983. Since that date, no known activity has transpired at the approved location.

Applications for permit to drill are effective for a period of one year. In view of the foregoing, this office is rescinding the approval of the referenced application.

Should you intend to drill at this location at a future date, a new application for permit to drill must be submitted.

If you have any questions, please contact the Branch of Fluid Minerals at (801) 259-6111.

Sincerely,

Kenneth W. Eber

Acting District Manager

cc:
State of Utah, Division of Oil, Gas and Mining
Price River Resource Area

bcc:
U-942, Utah State Office

CFreudiger/cf 1/25/85



STATE OF UTAH
NATURAL RESOURCES
Oil, Gas & Mining

Scott M. Matheson, Governor
Temple A. Reynolds, Executive Director
Dianne R. Nielson, Ph.D., Division Director

4241 State Office Building • Salt Lake City, UT 84114 • 801-533-5771

February 1, 1985

Amoco Production Company
501 Airport Drive
Farmington, New Mexico 87401

Gentlemen:

Re: Well No. Desert Lake Unit #2 - Sec. 13, T. 17S., R. 12E.
Emery County, Utah - API #43-015-30164 - Lease #U-21794

In concert with action taken by the Bureau of Land Management, January 28, 1985, approval to drill the above referred to well is hereby rescinded.

A new "Application for Permit to Drill" must be filed with this office, for approval, prior to future drilling of the subject location.

Sincerely,

A handwritten signature in cursive script that reads "John R. Baza".

John R. Baza
Petroleum Engineer

clj

cc: Dianne R. Nielson
Ronald J. Firth
File

0087S/13



United States Department of the Interior

IN REPLY REFER TO

3162 (U-065)

BUREAU OF LAND MANAGEMENT
Moab District
P. O. Box 970
Moab, Utah 84532

FEB 28 1985

RECEIVED

MAR 04 1985

DIVISION OF OIL
GAS & MINING

State of Utah
Division of Oil, Gas and Mining
355 West North Temple
3 Triad Center, Suite 350
Salt Lake City, Utah 84180-1203

Attention: Ms. Claudia L. Jones

Re: Request on Status of Wells

Gentlemen:

We are replying to your various requests for status on the following wells:

- 1) Amoco Production Company ^{LA}
Well No. Desert Lake Unit 2
Sec. 13, T. 17 S., R. 12 E.
Lease U-21794

Rescinded APD January 28, 1985.

- 2) Thomas D. Harrison
Well No. Pioneer 2A
Sec. 13, T. 20 S., R. 23 E.
Lease U-0148171-B

Grand Resource area is involved in field inspections trying to identify which well is producing on this lease, the Pioneer 2 or Pioneer 2A.

- 3) Skyline Oil Company
Well No. Federal 10-11
Sec. 10, T. 16 S., R. 12 E.
Lease U-43777

Rescinded APD January 28, 1985.



Save Energy and You Serve America!