

# IH600R / IC602

6" Incandescent Remodel / Reflector w/ Regressed Lens

DISCONTINUED

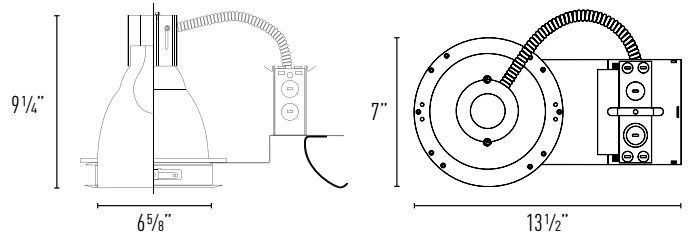

**Cut-out:** 6 3/4"

**DESCRIPTION**

Incandescent recessed downlight providing uniform distribution. For medium to high ceilings. Ideal for task lighting and general lighting.

**LAMP**

- A19 100W max.
- A21 150W max.
- PAR30 75W max.
- PAR38 150W max.

**SOCKET**

E26 medium base

**REFLECTOR OPTICS**

Specification grade reflector with 1.2mm thickness. 1 1/2" regressed lens available in multiple lens types; Albalite, Sand Blasted, Prismatic, Fresnel, Clear Tempered, or Frosted Spot.

**MOUNTING FRAME**

Frame is constructed from heavy duty galvanized steel. Three high tension springs secure housing into ceiling with up to 5/8" thickness.

**LISTING**

ETL listed for thru-branch wiring and wet locations. For Non-IC recessed installation. ETL listed to US and Canadian standards.

Order Matrix | Example: IH600R

A	
A	Series
IH600R	6" Incandescent Remodel

**6" Reflector with Regressed Lens**

Specification grade low iridescent reflector with 1 1/2" regressed lens.

**Specify Lens Type:**

- AB: Albalite, -SB: Sand Blasted, -PR: Prismatic, -FR: Fresnel,
- CR: Clear Tempered, -FSP: Frosted Spot
- OD: 7 1/4"

<b>IC602C-B</b>	Clear Reflector / Black Metal Ring
<b>IC602C-MO</b>	Clear Reflector / Mocha Metal Ring
<b>IC602C-MW</b>	Clear Reflector / White Metal Ring
<b>IC602C-SN</b>	Clear Reflector / Satin Nickel Metal Ring
<b>IC602SD-B</b>	Semi Diffused Reflector / Black Metal Ring
<b>IC602SD-MO</b>	Semi Diffused Reflector / Mocha Metal Ring
<b>IC602SD-MW</b>	Semi Diffused Reflector / White Metal Ring
<b>IC602SD-SN</b>	Semi Diffused Reflector / Satin Nickel Metal Ring
<b>IC602W-B</b>	White Reflector / Black Metal Ring
<b>IC602W-MO</b>	White Reflector / Mocha Metal Ring
<b>IC602W-MW</b>	White Reflector / White Metal Ring
<b>IC602W-SN</b>	White Reflector / Satin Nickel Metal Ring

