

# IH600R / IC603

6" Incandescent Remodel / Baffle with Regressed Lens

DISCONTINUED

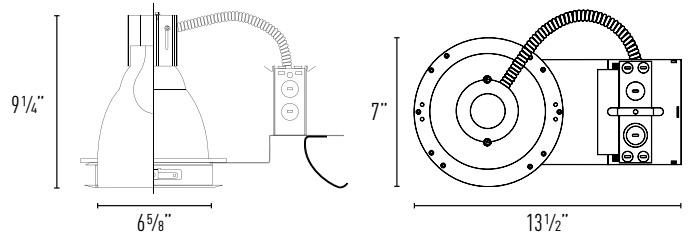

**Cut-out:** 6 3/4"

### DESCRIPTION

Incandescent recessed downlight providing uniform distribution. For medium to high ceilings. Ideal for task lighting and general lighting.

### LAMP

A19 100W max.  
A21 150W max.  
PAR30 75W max.  
PAR38 150W max.

### SOCKET

E26 medium base

### REFLECTOR OPTICS

Specification grade reflector with 1.2mm thickness and baffle. 1 1/2" regressed lens available in multiple lens types; Albalite, Sand Blasted, Prismatic, Fresnel, Clear Tempered, or Frosted Spot.

### MOUNTING FRAME

Frame is constructed from heavy duty galvanized steel. Three high tension springs secure housing into ceiling with up to 5/8" thickness.

### LISTING

ETL listed for thru-branch wiring and wet locations. For Non-IC recessed installation. ETL listed to US and Canadian standards.

Order Matrix | Example: IH600R

A	
A	Series
IH600R	6" Incandescent Remodel

### 6" Baffle with Regressed Lens

Specification grade reflector with baffle and 1 1/2" regressed lens.

#### Specify Lens Type:

-AB: Albalite, -SB: Sand Blasted, -PR: Prismatic, -FR: Fresnel,  
-CR: Clear Tempered, -FSP: Frosted Spot  
OD: 7 1/4"

IC603B-B	Black Baffle / Black Metal Ring
IC603B-MO	Black Baffle / Mocha Metal Ring
IC603B-MW	Black Baffle / White Metal Ring
IC603B-SN	Black Baffle / Satin Nickel Metal Ring
IC603W-B	White Baffle / Black Metal Ring
IC603W-MO	White Baffle / Mocha Metal Ring
IC603W-MW	White Baffle / White Metal Ring
IC603W-SN	White Baffle / Satin Nickel Metal Ring

