

## FEATURES & SPECIFICATIONS

**INTENDED USE** — Round straight aluminum pole for up to 20-foot mounting heights. The shape of the base cover makes it ideal for use with the Lithonia Lighting MRP.

**CONSTRUCTION** — Shaft: One-piece extruded 6063-T6 aluminum alloy with T6 temper. Round straight tube is uniform in cross-section down length of shaft with no taper.

Anchor base: Cast from A356 aluminum alloy and heat treated to T6 temper. Base plate and shaft are circumferentially welded top and bottom. Base plate bolt circle is 7-1/2".

Hand hole: Reinforced 2" x 4" hand hole is located 18" above base. Cover and attachment hardware furnished.

Hardware: Stainless steel.

Top cap: Removable top cap provided with drill-mount poles.

Decorative base/cover: Made of die-cast aluminum. Decorative base slides over the pole matching a key slot in the pole baseplate allowing a reveal between the baseplate and the decorative base cover. The decorative base cover is 17-1/2" tall combined with the height of the matching baseplate for a total height of 20-1/4".

Finish: Must specify finish.

Grounding: Provision located inside handhole rim. Grounding hardware is not included (provided by others).

Anchor bolts: Fabricated from carbon steel bar with minimum-yield strength of 55,000 psi. Upper portion of anchor bolt is galvanized per ASTM A-153. Each anchor bolt is furnished with hex nuts, flat washer and leveling shims.

NOTE: Specifications subject to change without notice.

Actual performance may differ as a result of end-user environment and application.

Catalog Number
Notes
Type

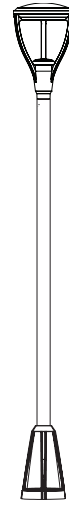

Anchor Base Poles

# RSAO

**ROUND STRAIGHT ALUMINUM WITH OMERO™ DECORATIVE BASE/COVER**

**Example: RSAO 12 4C DM19AS DDB**

### ORDERING INFORMATION

Lead times will vary depending on options selected. Consult with your sales representative.

Series	Nominal fixture mounting height	Nominal shaft base size/wall thickness	Mounting <sup>2</sup>	Options	Finish <sup>8</sup>
RSAO	8 – 20 feet (See back page.)	(See back page.) <sup>1</sup>	<u>Tenon mounting<sup>3</sup></u> PT Open top T20 2-3/8" O.D. (2" NPS) T25 2-7/8" O.D. (2-1/2" NPS) T30 3-1/2" O.D. (3" NPS) T35 4" O.D. (3-1/2" NPS) <u>Drill mounting<sup>4</sup></u> DM19 1 at 90° DM28 2 at 180° DM28PL 2 at 180° with one side plugged DM29 2 at 90° DM32 3 at 120° DM39 3 at 90° DM49 4 at 90° <u>CSX/DSX/AERIS™/OMERO™ Drill mounting<sup>4</sup></u> DM19AS 1 at 90° DM28AS 2 at 180° DM29AS 2 at 90° DM32AS 3 at 120° DM39AS 3 at 90° DM49AS 4 at 90° <u>AERIS™ Suspend drill mounting<sup>4,5</sup></u> DMxxAST_ <u>OMERO™ Suspend drill mounting<sup>4,5</sup></u> DMxxMRT_	<u>Shipped installed</u> L/AB Less anchor bolts VD Vibration damper TP Tamper proof MAEX Match existing <sup>6</sup> USPOM United States point of manufacture <sup>7</sup>	<u>Standard colors</u> DDB Dark bronze DWH White DBL Black DMB Medium bronze DNA Natural aluminum <u>Classic colors</u> DSS Sandstone DGC Charcoal gray DTG Tennis green DBR Bright red DSB Steel blue <u>Architectural colors (powder finish)<sup>8</sup></u>

NOTES:

- 6" diameter poles available, consult factory.
- When ordering tenon mounting and drill mounting for the same pole, follow this example: DM28AS/T20. The combination includes a required extra handhole.
- T30 and T35 tenons available on 5" shafts only.
- The drilling template to be used for a particular luminaire depends on the luminaire that is used. Refer to the Technical Data Section of the Outdoor Binder for Drilling Templates.
- Insert "1" or "2" to designate fixture size; e.g. DM19AST2.
- Must add original order number.
- Use when mill certifications are required.
- Finish must be specified. Additional colors available; see [www.lithonia.com/archcolors](http://www.lithonia.com/archcolors) or Architectural Colors brochure (Form No. 794.3).

### HANDHOLE ORIENTATION

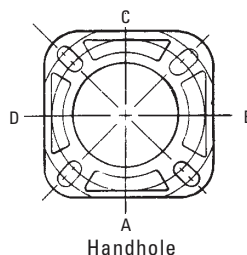

**IMPORTANT INSTALLATION NOTES:**

- Do not erect poles without having fixtures installed.
- Factory-supplied templates must be used when setting anchor bolts. Lithonia Lighting will not accept claim for incorrect anchorage placement due to failure to use factory template.
- If poles are stored outside, all protective wrapping must be removed immediately upon delivery to prevent finish damage.
- Lithonia Lighting is not responsible for the foundation design.

# RSAO Round Straight Aluminum Poles with OMERO™ Decorative Base/Cover

TECHNICAL INFORMATION										
Catalog Number	Nominal mounting height (ft)	Pole Shaft Size (in x ft)	Wall Thickness (in)	EPA (ft <sup>2</sup> ) with 1.3 gust			Max. fixture weight (lbs)	Bolt Circle (in)	Bolt Size (in. x in. x in.)	Approximate ship (lbs.)
				80 mph	90 mph	100 mph				
RSAO 8 4C	8	4 x 8	0.156	11.2	8.6	6.8	125	7-1/2	3/4 x 18 x 3	32
RSAO 10 4C	10	4 x 10	0.156	8.2	6.1	4.7	100	7-1/2	3/4 x 18 x 3	36
RSAO 12 4C	12	4 x 12	0.156	6	4.3	3.2	110	7-1/2	3/4 x 18 x 3	30
RSAO 12 4-5C	12	4-1/2 x 12	0.156	8.1	6	4.8	80	7-1/2	3/4 x 18 x 3	38
RSAO 14 4C	14	4 x 14	0.156	4.1	2.8	1.9	75	7-1/2	3/4 x 18 x 3	35
RSAO 14 4-5C	14	4-1/2 x 14	0.156	5.8	4.2	3.3	60	7-1/2	3/4 x 18 x 3	42
RSAO 14 5C	14	5 x 14	0.156	7.8	6	4.7	100	7-1/2	3/4 x 18 x 3	39
RSAO 16 4C	16	4 x 16	0.156	2.8	1.6	1	150	7-1/2	3/4 x 18 x 3	38
RSAO 16 4-5C	16	4-1/2 x 16	0.156	4.2	2.8	2.1	50	7-1/2	3/4 x 18 x 3	46
RSAO 16 5C	16	5 x 16	0.156	5.9	4.4	3.4	175	7-1/2	3/4 x 18 x 3	46
RSAO 18 4-5G	18	4-1/2 x 18	0.188	5.7	4	3.1	123	7-1/2	3/4 x 18 x 3	68
RSAO 18 5C	18	5 x 18	0.156	4.3	3.1	2.4	150	7-1/2	3/4 x 18 x 3	48
RSAO 20 4-5G	20	4-1/2 x 20	0.188	4.3	2.9	2.1	95	7-1/2	3/4 x 18 x 3	74
RSAO 20 5C	20	5 x 20	0.156	3	2.1	1.5	150	7-1/2	3/4 x 18 x 3	54

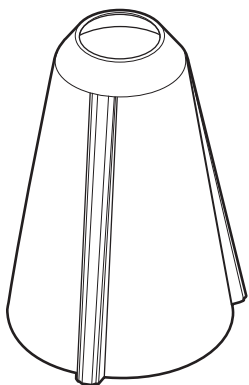

POLE DATA					
Shaft base size	Bolt circle A	Bolt projection B	Base square C	Template description	Anchor bolt description
4"	7-1/2"	3-1/4"	13"	ABTEMPLATE PJ50070	AB18-0
4-1/2"	7-1/2"	3-1/4"	13"	ABTEMPLATE PJ50070	AB18-0
5"	7-1/2"	3-1/4"	13"	ABTEMPLATE PJ50070	AB18-0

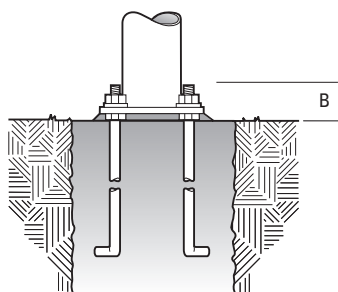
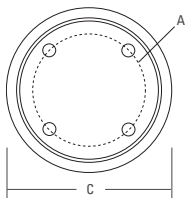

**IMPORTANT:**

- These specifications are intended for general purposes only. Lithonia Lighting reserves the right to change material or design, without prior notice, in a continuing effort to upgrade its products.