

PROPOSAL FOR THE BOISE AIRPORT PEDESTRIAN BRIDGE PROJECT

I would like to thank the Boise Arts Council and the committee for their thoughtful guidance throughout this public art process. I enjoyed developing this proposal for the Boise Airport Pedestrian Bridge and I am honored to be considered for this opportunity and possible inclusion into the robust Boise public art collection. I recognize, that if awarded this commission, additional refinement of the art maybe required. I am enthusiastic to engage in a deeper collaboration with the group. Following your review of the enclosed materials, should you have additional questions, I am available to assist.

I found the process of researching and designing this concept to be informative and rewarding. Through research, phone conferences, a very thorough site visit with Karen Bubb, meeting with committee members, and conversations with Boise residents (past and present) I was provided me with more insight and useful information than I am usually afforded, was inspiring, and furthered the scope of this proposal. I have a deep appreciation for the cultural renaissance that is well under way in Boise. As a public artist, I am privileged to explore many communities. During my Boise visit, I was highly moved by the scope, caliber, and creativity of the art I experienced; it exceeds many collections I have experienced. Following my trip to Boise, I understood the mandate upon me; to develop concepts commensurate with the existing collection would require serious consideration and be a significant undertaking.

The scope of projects, roles, and collaborations I have undertaken in the past decade have honed my ability to listen, communicate, and collaborate with a diverse range of professionals. Developing site specific commissions has taught me that the essence of apt design lies in an artists' ability to balance the needs of the site with the hopes of the stakeholders. The ability to listen, communicate and participate in an engaged, collaborative design process imparts cost-savings, efficiency of installation, and most importantly, art that resonates with the site and within its community. I endeavor to realize integrated art that is lyrical on approach, gracious when experienced, and reflective upon departure.

The criteria outlined for the Pedestrian Bridge art is rigorous. The site is considerable in scale and proportion; it is semi-open to the elements; the budget requires integrity of materials within economy of construction and avoidance of appearing pre-fabricated or industrial; and the theme needs to be innovative, accessible, and enduring. These are significant considerations to insure the artwork imparts a signature experience to travelers to and from Boise Airport. I determined early on, even before being selected as a finalist, that an etched glass treatment in concert with a suspended mobile would be an apt feature for this opportunity. I have been exploring art that transcends the veil of architecture; I am fascinated with art that moves from the two-dimensional plane to the three-dimensional plane and back again through careful use of proportion, composition, palette, negative space, and interaction with ambient light or wind. The discipline required to arrive at these solutions reveals the essence of the marriage between art and architecture; done well, it is a refined, elegant, interesting, and enduring solution that brings art enhancements into the design vocabulary.

The art I experienced at the Boise Airport was creative, colorful, well integrated and had grounded, representational overtone. Additionally while touring the City, I experienced a wide range of styles, materials, and installations. I came away from my Boise visit with an understanding of the visual narrative that defines the City. This proposal is a direct response to the cultural renaissance you are cultivating and a nod to the wonder of air travel. Viewing land forms, highways, rivers, lakes, and clouds from the air, fascinates us. Our earliest memories of sky-gazing, identifying shapes in the clouds, and following contrails left by shiny silver jets that criss cross the skies are universal experiences. Sky gazing transcends race, religion, class, and age; simply put "flying" is magic. The Pedestrian Bridge is the conduit to an experience; you travel through it to go or return from elsewhere. I was inspired to develop a theme for the art that would prime the audience with anticipation of their journey or remind them of the magical, airborne realm they have just returned from. The array of art I propose has a hint of whimsy but remains noble through gracious lines, formal composition, and gentle tenor.

PROPOSAL FOR THE BOISE AIRPORT PEDESTRIAN BRIDGE PROJECT

The Pedestrian Bridge is a significant site which gave me considerable pause at the inception of my design process. Following my tour of the airport and Boise, I was fired up to develop a sizeable mobile for the Airport and community. Much thrashing ensued as I sought a concept with relevance to the site, the region, the function of air travel, and that could be responsibly realized within the budget. I wanted to present a universally appealing, innovative, and timeless theme that involved a signature gesture made from smaller representational forms. After several fitful concept explorations, I realized the recurring shape within my notes and sketches were cloud forms. Once I identified the kernel of genuine inspiration, the remainder of the concept fell into place fluidly and completely. The sculpture would be dynamic, bold streams of contrails zipping through a bank of tumbling clouds. The concept had direction and momentum, while encouraging the audience to pause and reflect. The art was highly visible from within or outside the Pedestrian Bridge and supported the inclusion of color, shadow, form, implied motion, wayfinding, and economy. The solutions are sophisticated in composition, durable, and made of beautiful materials with interactive qualities. It is a confluence of theme, material, and experience as one enters or departs Boise.

The stainless steel and acrylic Mobile is made of two elements, each approximately 50' in length and with a total length of 65'. It will be suspended compactly against the arched beams in the center of the Bridge, where the most height and clearance are available. The mobile is 2.5' in height so, its lowermost elements will be suspended at least 10' from the Bridge floor. The overall composition of the Mobile is long and narrow, complimenting the Bridge proportions. If desired, I can include a small range of kinetic motion within each acrylic baffle. The effect would be that the acrylic cloud forms would rock back and forth slightly with ambient airflow. For the Etched Glass Mural, I propose to etch approximately 60 feet of the glass; 30 feet per side, directly to your right as you enter or the bridge from either approach. Similar to clouds moving across the sky, the Mural begins as a hint of imagery, gathers intensity, and then tapers off in a gentle wisp. The Mural responds to changes in ambient light throughout the day; at night the imagery will glow from within, creating visual interest within the architectural canvas. Motorists and audiences from outside the Pedestrian Bridge will have significant vantages of the art from a myriad of locations. Coupled with the mobile, this mural will be a prominent steward for the site, the Airport, and Boise travelers.

I am impressed with your goal to merge art, architecture, and theme to achieve a memorable, harmonious, environment for travelers and visitors to Boise. Employing site-specific art to serve as a gateway, inspire discourse, and elevate a community is an important aspect of my work. Similar to the function of travel, I create art to function as a cultural bridge, bringing people and ideas together through a shared experience. I am enthusiastic to refine my concept in consultation with the committee. I intend for this art to be a welcoming beacon, encouraging happy interaction and coincidence between residents or visitors.

When reviewing my proposal and qualifications, I would like to emphasize that the projects I have realized were informed and furthered through committee insight and stakeholder collaboration. These artworks represent the passion, goals, and hopes which the group had for their site and facility; it is my privilege to interpret and honor their enthusiasm with tangible, enduring art. I do not design art to support a grandiose, unilateral vision; I create real work, for real institutions, to improve the lives of real people. Authenticity of theme and integrity of craftsmanship endow a site with a timeless, beloved artwork that functions as a welcoming ambassador for decades. This is the valuable work I bring to communities. I have developed (and am currently developing) work for similar public settings and I am enthusiastic for the opportunity to do so in Boise. I appreciate and thank you for your review and consideration.

TECHNICAL OVERVIEW FOR THE BOISE AIRPORT PEDESTRIAN BRIDGE PROJECT

DIMENSIONS

The contrail elements which form the Mobile are 50' L and 55' L respectively. Combined, they encompass total dimensions of 65' in length, 6' in width and 2.5' in height. The acrylic baffles that comprise the contrail forms start at 10" and taper proportionately to 2.5' at the terminating end of the contrail. There is 375' of stainless steel rod and 75 square feet of acrylic within the sculpture. The Etched Glass Murals are approximately 30' in length and 6' in height. They will be etched onto the existing windows.

FABRICATION

The suspension system for the Mobile will be made of formed stainless steel rod suspended from the arching steel roof joists of the Pedestrian Bridge. Each acrylic cloud form will be attached to the rod through a custom hardware system; as noted in the narrative, I can design this system to have controlled kinetic action. The graduated acrylic forms will be CNC laser cut yielding precise form with crisp polished edges. The Etched Glass Mural will be etched on site with the windows in place. I have realized several installations in this fashion and it is an effective, efficient means of enlivening the space. To etch the windows, I will apply a pre-cut vinyl mask to the windows. The positive lines of the mural will have the masking removed while the negative (un-etched) surface will retain their masking for protection. Once the vinyl has been weeded and I am confident the imagery is precise, I will tent off the area, and etch the glass with a 400 grit (super fine) aluminum oxide compound. This etching will slightly frost the glass in a highly controlled pattern. Once etched the protective vinyl masking will be removed, the glass cleaned, and the mural will be complete. I have sourced a local vendor in Boise to provide me with the vinyl masks and installation assistance.

SITE PREPARATION

I will provide the architect and general contractor with detailed drawings and descriptions of the attachment point load bearing information and any special needs required to integrate the Mobile into the site. If I am selected for the commission, I will work with you to resolve any site preparation questions well in advance of installation. During the etching process, I will need to cordon off a small area to etch the mural. I can do one side at a time and etch in the overnight hours to insure pedestrian flow is not impacted.

INSTALLATION

I anticipate installation of the Mobile will be efficient, requiring one day for site prep and two days for installation. Due to the need to work during off peak hours, the etched murals may take three days to complete. I am prepared to coordinate these details with the Airport and their designated facilities manager. As with all my installations, I will do my utmost to minimize impact to the facility while the art is being installed. If necessary, I will install the work during off hours to minimize impact to the Bridge.

FINISHES & MAINTENANCE

The palette for the Mobile is a descending palette of blue. These colors are lovely and subdued and readily available in acrylic. If you would prefer a more colorful palette within the range of sunset colors, I can accommodate this palette preference. The Etched Glass mural has no color, it is simply a light frosted white color inherent to an etched application.

I have designed this artwork to be both durable and maintenance free. The Mobile is a highly responsible solution for a heavily trafficked, public transit facility. The stainless steel and acrylic

TECHNICAL OVERVIEW FOR THE BOISE AIRPORT PEDESTRIAN BRIDGE PROJECT

surfaces are extremely durable and not be affected by UV exposure, temperature differentials, or moisture. Suggested maintenance for these art features is an occasional dusting with a soft cloth. The flat, unformed baffles of the acrylic are designed to swipe easily with a duster atop a pole; a curved

surface would have been a dust collector. The flat, perpendicular construction of this mobile eliminates this concern. The Etched Glass Murals do not require any special cleaning. They may be washed in the same fashion as an untreated window. The etching is so delicate that it is nearly imperceptible through touch and will not affect the structural integrity of tempered glass. I have etched significant murals in tempered glass. This etching solution has been thoroughly vetted by many architects and engineers and deemed responsible.

LIGHTING

As currently designed, I have not made any suggestions for integrated lighting; I have designed these artworks to function well with the existing lighting systems. Should external lighting of the Mobile be desired, I will work with the architect to arrive at optimal lighting options.

SCHEDULE

Should I be awarded this commission, I will finalize design and palette criteria, address engineering concerns, and resolve any technical questions. I will resubmit any necessary visuals, drawings, or materials samples. I anticipate this project will require three to four months of fabrication time.

INSURANCE

I maintain excellent insurance coverage for my work throughout fabrication, travel, and installation. I have an excellent safety record for the monumental installations I have realized.

SUMMARY

Though I have noted this sentiment throughout the written materials in this proposal, I would like to take this final opportunity to encourage the committee to share their hopes for the final palette, imagery, or refinements of this concept. It is the spirit of collaboration that breathes true life into a site specific installation; I will work with you to address any concerns you have regarding the final details of these concepts Thank you again for your consideration.

BUDGET FOR THE BOISE AIRPORT PEDESTRIAN BRIDGE PROJECT

Artist fee	\$ 3,000
Administration	\$ 1,500
Materials	\$ 10,000
Fabrication	\$ 21,500
Travel to Site	\$ 2,000
Art transport	\$ 1,500
Engineering	\$ 1,000
Hardware	\$ 2,000
Modeling	\$ 2,000
Crating	\$ 500
Installation	\$ 5,000
<hr/>	
TOTAL	\$ 50,000

RECENT PROJECTS



Forensic Science Institute
Univ. of Central Oklahoma



ARcare
Augusta, AR



Hypertherm
Hanover, NH



SETH PALMITER
MOTIVATED
METAL

21 Goldies Road
Putney, Vermont 05346

802-722-4140

Seth@MotivatedMetal.com

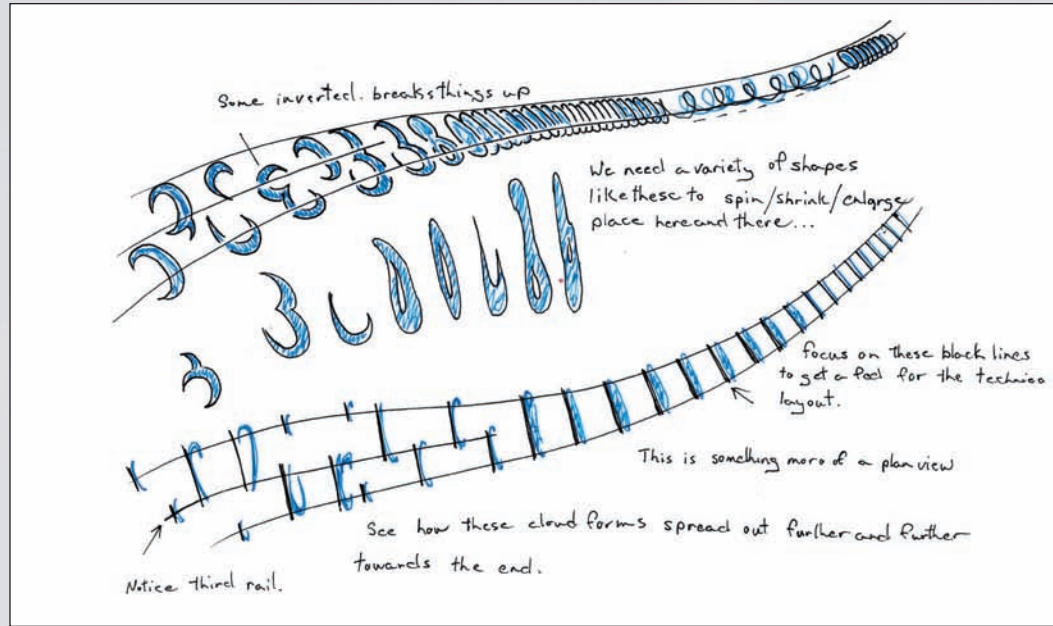

INITIAL SKETCH OF MOBILE CONSTRUCTION



ETCHED GLASS SAMPLE

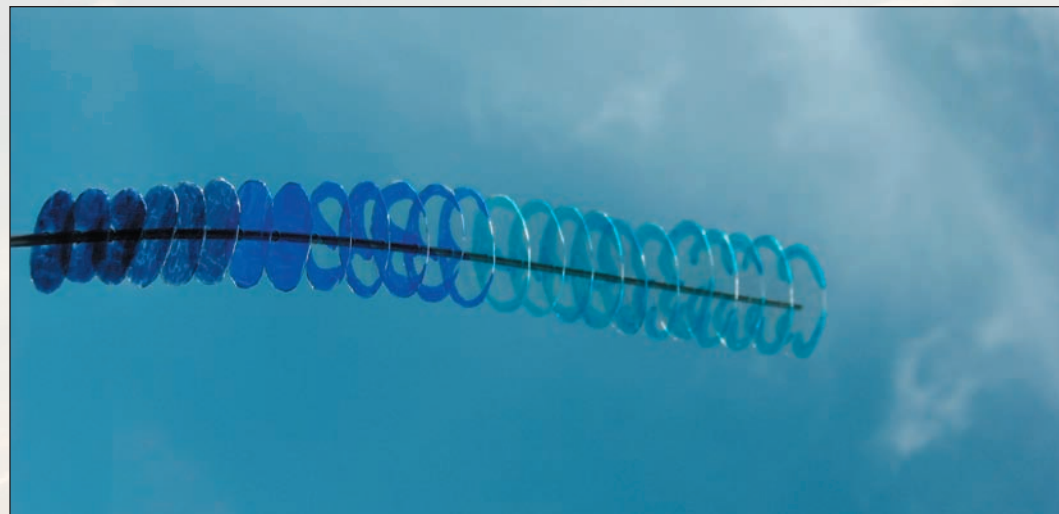
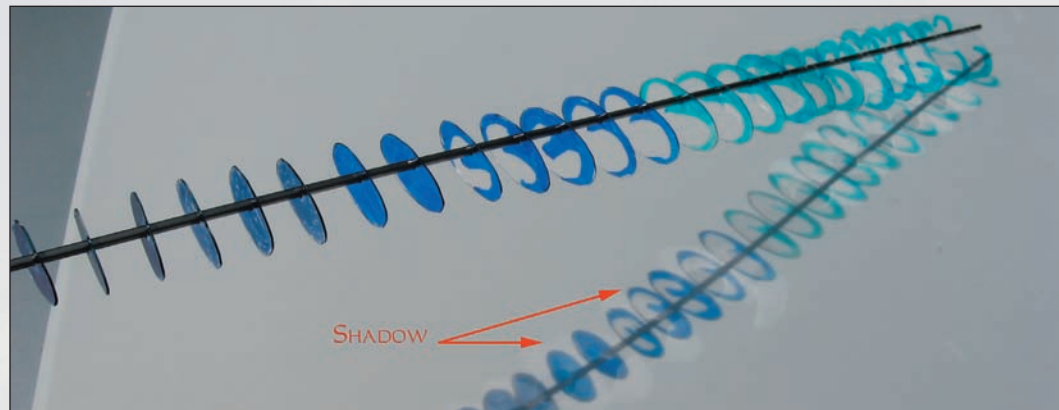

SIMPLE MODEL OF MOBILE



INITIAL DIGITAL MODEL OF MOBILE AND ETCHED GLASS MURAL

CLIENT: City of Boise, Boise Airport

LOCATION: 3201 Airport Way Boise City, ID 83705

DATE: June 12, 2013

MANAGER: Karen Bubb

NOTE: Enclosed are initial inspirations for the project.
I can refine this proposal per your directives.

SCALE: not to scale

PRELIMINARY PROPOSAL
PAGE 1 OF 4

© Seth Palmiter 2013

RECENT PROJECTS



Delta Campus
Brattleboro, VT



World Trade Center
Norfolk, VA

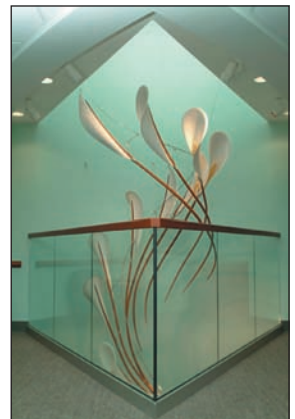

Kingsbury Cancer Center
Keene, NH



SETH PALMITER
MOTIVATED
METAL

21 Goldies Road
Putney, Vermont 05346

802-722-4140

Seth@MotivatedMetal.com

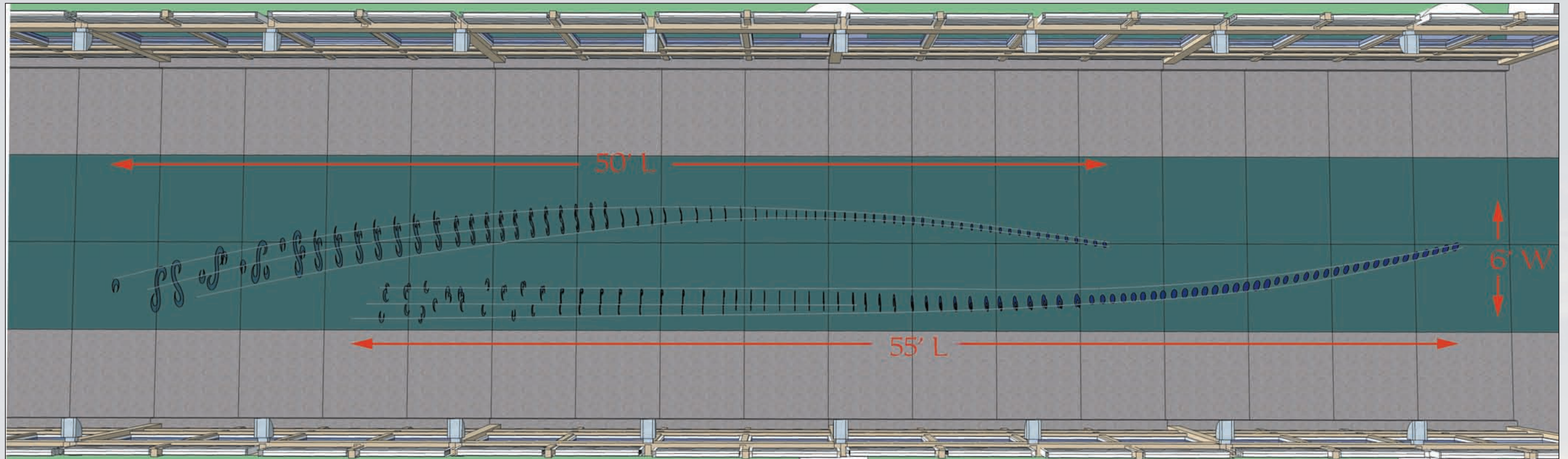

PLAN VIEW OF PEDESTRIAN BRIDGE MOBILE



EXTERIOR VIEW OF PEDESTRIAN BRIDGE MOBILE AND ETCHED GLASS MURAL

CLIENT: City of Boise, Boise Airport

LOCATION: 3201 Airport Way Boise City, ID 83705

DATE: June 12, 2013

MANAGER: Karen Bubb

NOTE: Enclosed are initial inspirations for the project.
I can refine this proposal per your directives.

SCALE: not to scale

PRELIMINARY PROPOSAL
PAGE 2 OF 4

© Seth Palmiter 2013

RECENT PROJECTS



Forensic Science Institute
Univ. of Central Oklahoma



ARcare
Augusta, AR



Hypertherm
Hanover, NH



SETH PALMITER
MOTIVATED
METAL

21 Goldies Road
Putney, Vermont 05346
802-722-4140

Seth@MotivatedMetal.com

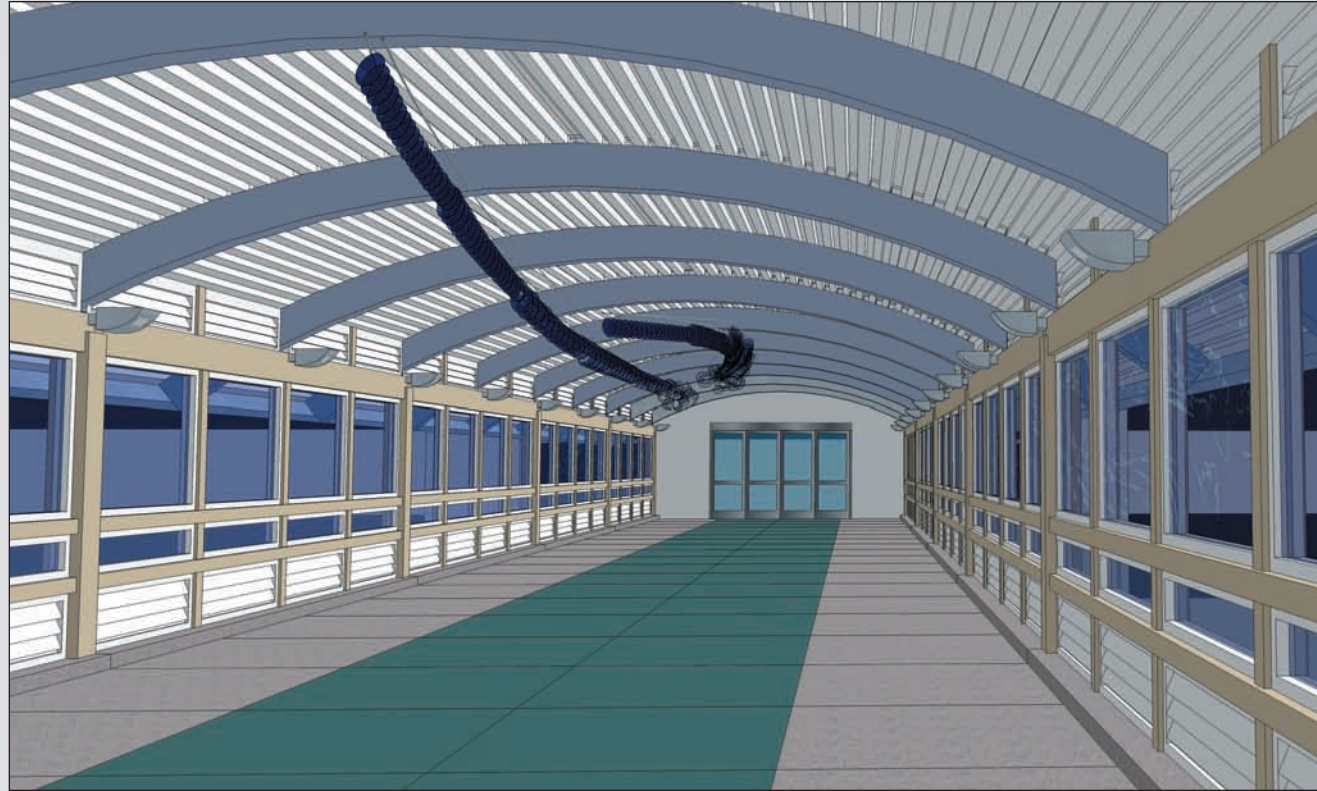

MOBILE IN RELATION TO THE BRIDGE ENTRANCE

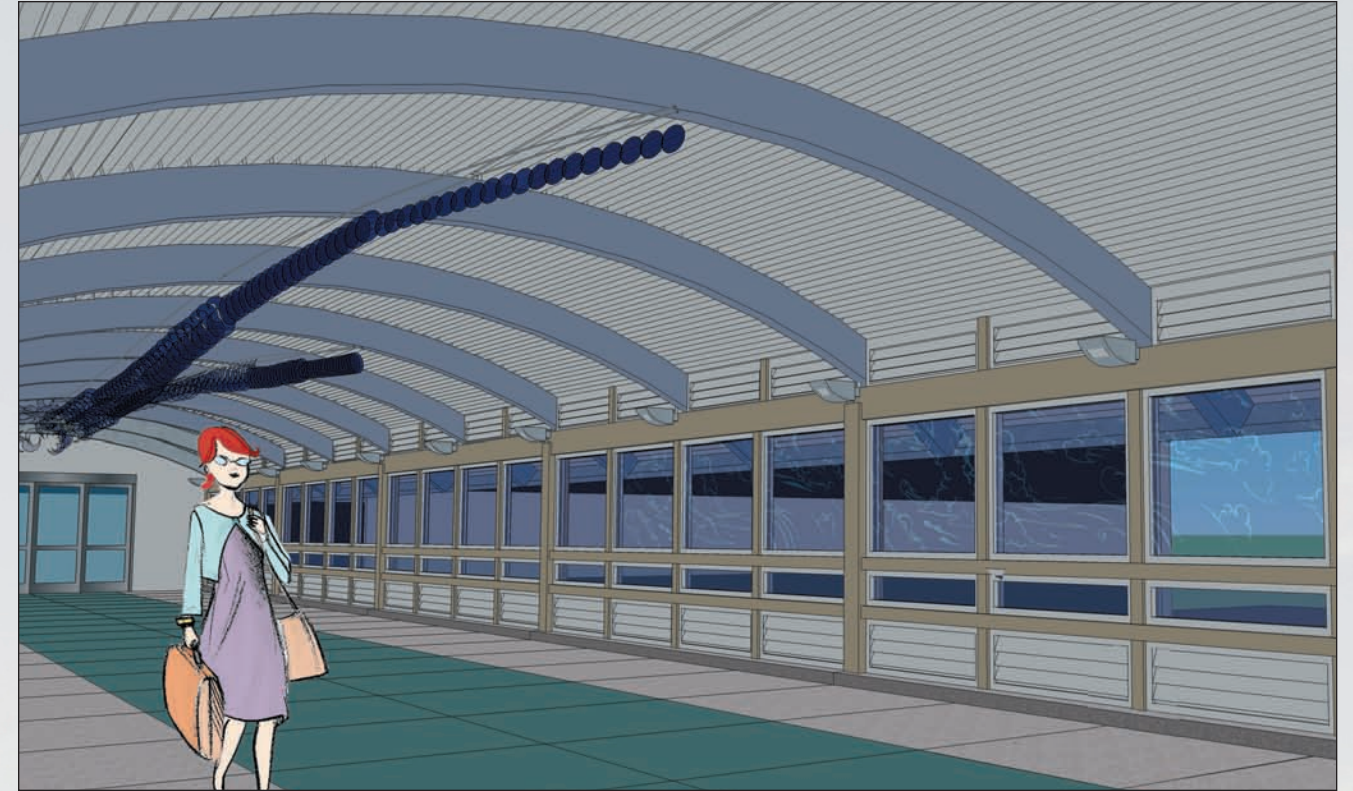

ETCHED GLASS ADJACENT TO THE BRIDGE ENTRANCE

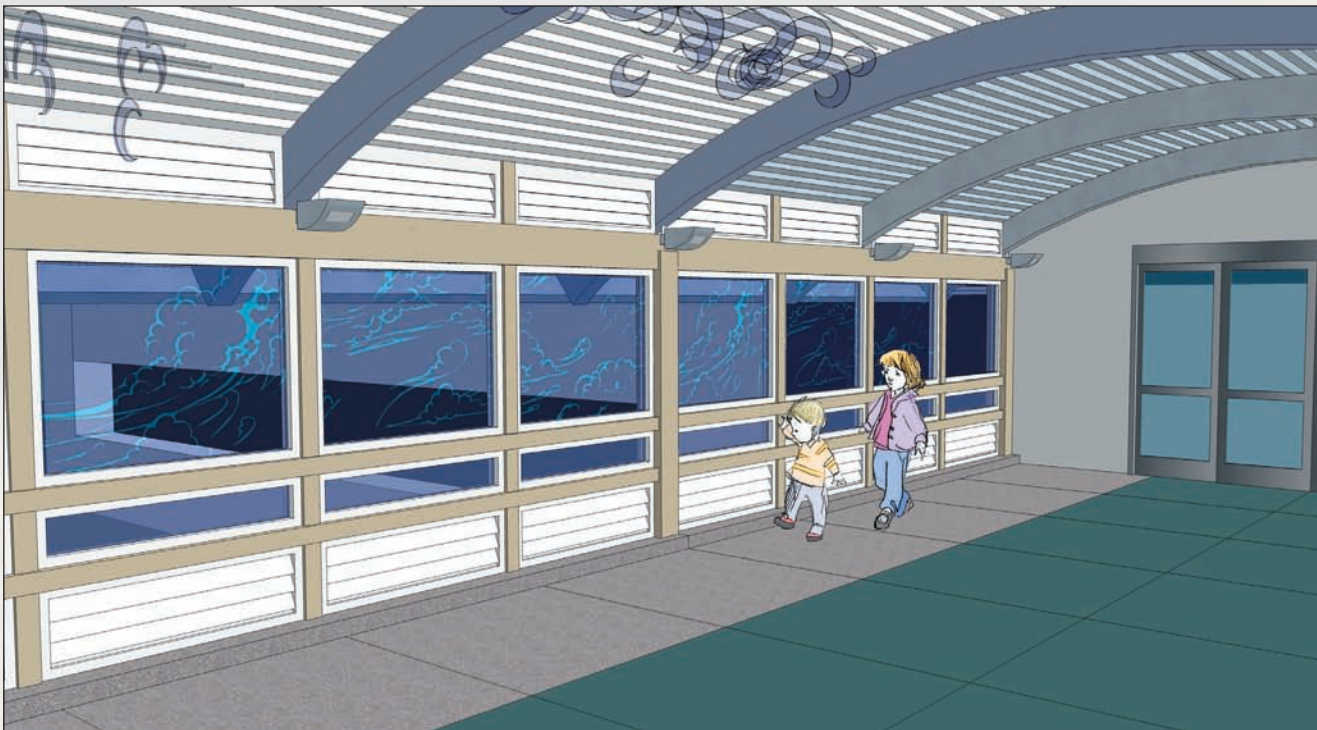

ETCHED GLASS ADJACENT TO THE PARKING GARAGE EXIT

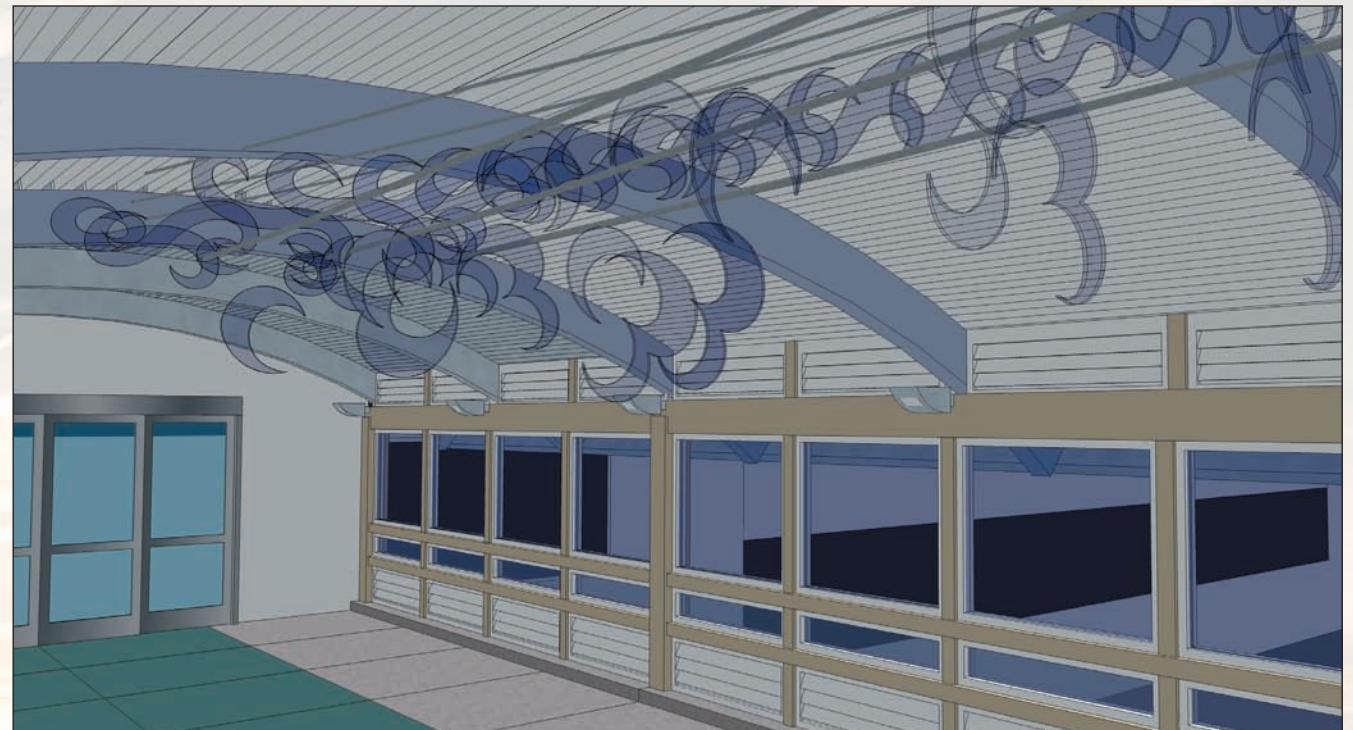

MOBILE IN RELATION TO THE PARKING GARAGE EXIT

CLIENT: City of Boise, Boise Airport

LOCATION: 3201 Airport Way Boise City, ID 83705

DATE: June 12, 2013

MANAGER: Karen Bubb

NOTE: Enclosed are initial inspirations for the project.
I can refine this proposal per your directives.

SCALE: not to scale

PRELIMINARY PROPOSAL
PAGE 3 OF 4

© Seth Palmiter 2013

RECENT PROJECTS



Delta Campus
Brattleboro, VT



World Trade Center
Norfolk, VA

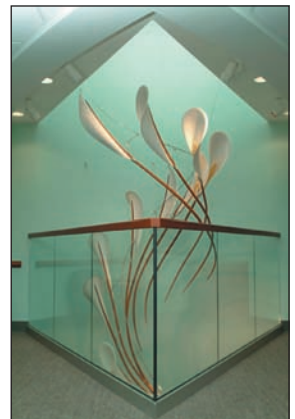

Kingsbury Cancer Center
Keene, NH



SETH PALMITER
MOTIVATED
METAL

21 Goldies Road
Putney, Vermont 05346

802-722-4140

Seth@MotivatedMetal.com



MURAL INSPIRATION

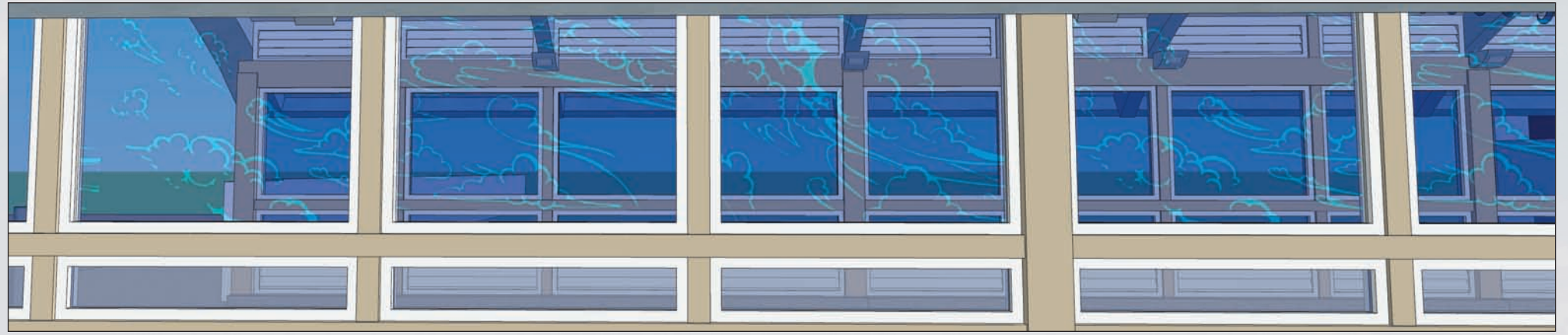

EXTERIOR VIEW OF ETCHED GLASS MURAL

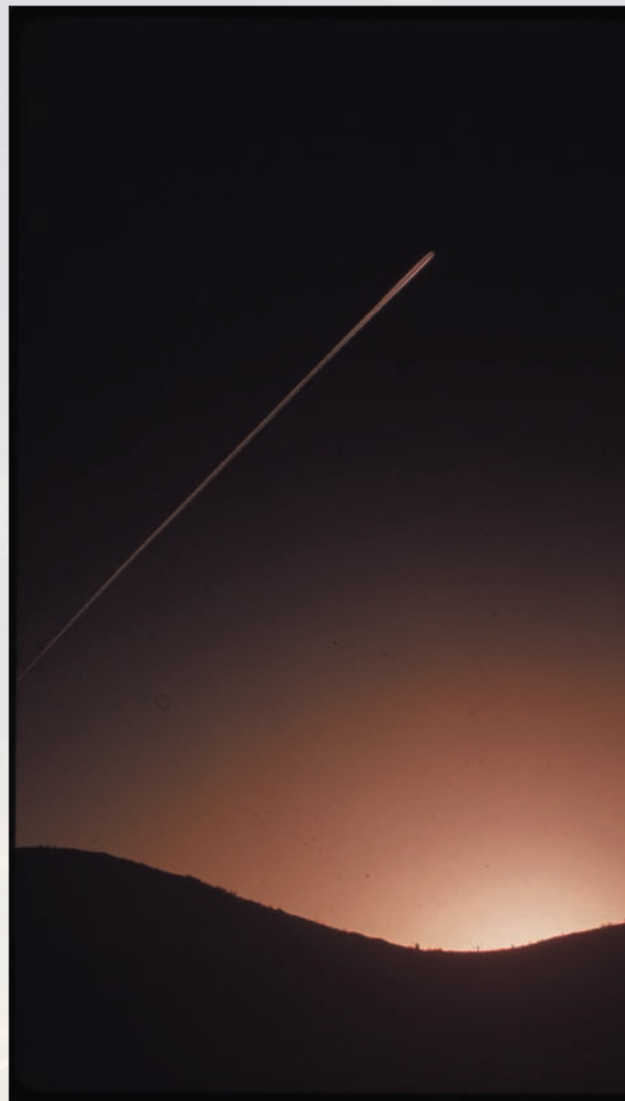

MOBILE INSPIRATION

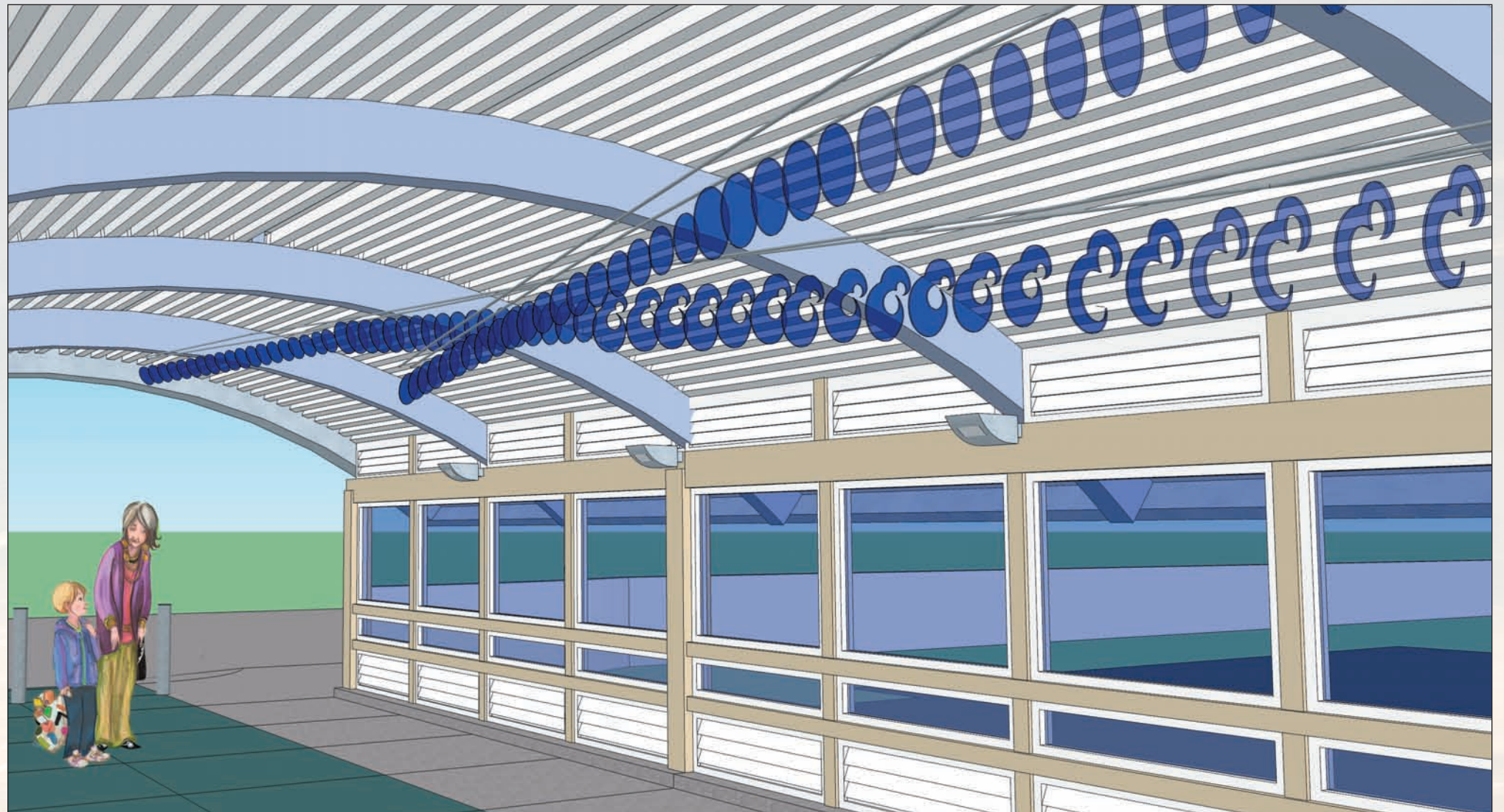

MOBILE, VIEW FROM PARKING GARAGE TO AIRPORT ENTRANCE

CLIENT: City of Boise, Boise Airport

LOCATION: 3201 Airport Way Boise City, ID 83705

DATE: June 12, 2013

MANAGER: Karen Bubb

NOTE: Enclosed are initial inspirations for the project.
I can refine this proposal per your directives.

SCALE: not to scale

PRELIMINARY PROPOSAL
PAGE 4 OF 4

© Seth Palmiter 2013