

For Residential and Commercial Applications

Job Name		Engineer / Architect	
Job Location		Wholesaler	
Submittal Date		Contractor	

MRU2 Series Safety+PLUS® Appliance Gas Excess Flow Valve – 5/8 OD Flare x Male Iron Pipe

Use: For use with natural, manufactured, mixed, liquefied-petroleum (LP) gas, and LP gas-air mixtures.

Design Features:

- **Helps prevent gas fires and explosions** due to gas line ruptures or disconnects at the appliance
- **Automatic valve activation** immediately restricts gas flow to a non-hazardous level to help avert a dangerous buildup of gas in the home
- **Automatic reset** once the gas line has been properly repaired
- **24 hour, maintenance-free protection** for the life of the product with no parts to wear, break, or misalign over time
- **100% Performance tested**

Operating Specifications:

Temperature: -20° to 150° F
Pressure: 1/2 PSI maximum

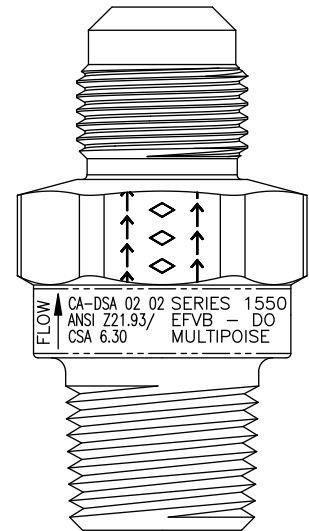

Installation: **Omni-directional** - can be installed in any orientation, horizontal to vertical

FLOW CAPACITY						
Model No.	Capsule	Label Color	Flow Capacity (BTU/HR) @ 0.5" W.C.	Maximum Flow Rate (BTU/HR) @ 0.5" W.C.	Closing Flow Rate (BTU/HR) @ 0.5" W.C.	Bypass Flow Rate (SCFH)
MRU2-10-8	1560	Gold	110,000 @ 0.5" W.C.	165,000 @ 0.5" W.C.	186,000 @ 0.5" W.C.	< 2.5
MRU2-10-12L	1550	Green	102,000 @ 0.5" W.C.	118,000 @ 0.5" W.C.	135,000 @ 0.5" W.C.	< 2.5
MRU2-10-12	1560	Gold	110,000 @ 0.5" W.C.	165,000 @ 0.5" W.C.	186,000 @ 0.5" W.C.	< 2.5

* W.C. = Water Column

VALVE MATERIAL SPECIFICATIONS	
Body	Brass
Seat	POM
Diaphragm	Rubber

This specification and all information contained herein is the confidential and exclusive property of BrassCraft Manufacturing, and shall not be disclosed to others without the written consent of BrassCraft Mfg. This specification must be returned to BrassCraft Mfg. if requested.



MRU2 Series Safety+PLUS® Appliance Gas Excess Flow Valve – 5/8 OD Flare x Male Iron Pipe

Part Listing:

- MRU2-10-8 P 5/8" OD flare (15/16-16 thread) x 1/2" MIP, 1560 capsule, polybagged
- MRU2-10-12L P 5/8" OD flare (15/16-16 thread) x 3/4" MIP (tapped 1/2" FIP), 1550 capsule, polybagged
- MRU2-10-12 P 5/8" OD flare (15/16-16 thread) x 3/4" MIP (tapped 1/2" FIP), 1560 capsule, polybagged

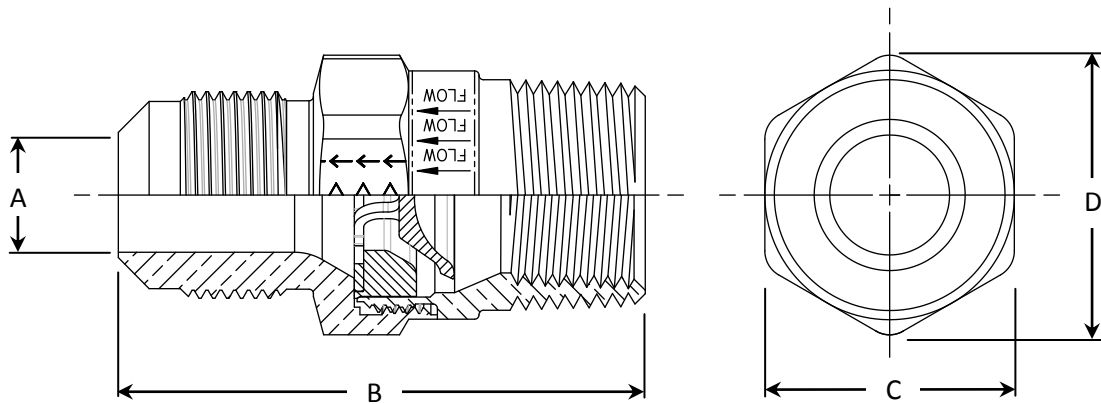

PART DIMENSIONS (Inches)				
Model	DIA. A	DIM. B	HEX. C	DIM. D
MRU2-10-8	.50	2.38	1-1/8	1.26
MRU2-10-12L	.50	2.38	1-1/8	1.26
MRU2-10-12	.50	2.38	1-1/8	1.26

Listings & Certifications:

- IAPMO listed to ANSI Z21.93-13 / CSA 6.30-13 standard “Excess Flow Valves” (file #4213)
- CSA listed to ANSI Z21.93-13 / CSA 6.30-13 standard “Excess Flow Valves” (file # 204593)



This specification and all information contained herein is the confidential and exclusive property of BrassCraft Manufacturing, and shall not be disclosed to others without the written consent of BrassCraft Mfg. This specification must be returned to BrassCraft Mfg. if requested.

BrassCraft®