

Communication Card

Let us know you worshipped at Wesley Church this morning by completing the communication/attendance registration card which was handed to you when you entered the sanctuary. Families can sign just one card but should list each individual in the family in attendance. If you have recently moved or changed telephone numbers, be sure to indicate that information. New residents and visitors: please provide as much of the contact information as possible.

Each week on the reverse side of the communication card, you will find a list of opportunities in which you can become involved at Wesley Church. This week's card includes several for you to consider. These are only for your consideration; you are not obligated to check any of these boxes. Completed cards should be deposited in the baskets located near each entrance — or place in the offering plate.

Thank you for letting us know you worshipped at Wesley today.



Easter Flowers

This year, white Easter lilies, white hyacinths, and various colors of tulips will be the flowers of choice to decorate the sanctuary for the gladsome Easter Sunday. **This coming Friday is the deadline to order Easter flowers (please use one form per flower).** Flowers can be ordered in honor of or in memory of a loved one. As is the Wesley tradition, orders will also be taken for plants to be placed at Geisinger House of Care in Danville. Easter flower order forms can be found on the desk in the Third Street narthex, on the Donation Station at the Murray Avenue entrance, and on the Hospitality Table in the Market Street vestibule.

Persons who order Easter plants should remember that all flowers must be taken from the sanctuary after the Easter morning worship service. If you do not want the plant for yourself, please find a shut-in, friend, or a relative who might appreciate the floral gift at this time of the year. If you order a flower but will not be in attendance, please indicate on your order form that you will pick up your plant during the week that follows Easter.

Funeral/Memorial Service Planning

When most of us hear the words funeral/memorial service planning we think quickly of funeral homes, merchandise, and finances. Yet, very few folks who pre-plan funeral services with funeral homes record information regarding the worship service itself.



Does your family know what Scripture or other readings you would like read at your funeral? Are there hymns that you would want sung or read to those who attend?

On Tuesday, March 19, you will be offered an opportunity to record service information so that both your family and Wesley Church may have that information on hand. Regardless of your age, situation, or family, you should consider attending and being part of the conversation. Pastor Gary will lead a time of discussion regarding funerals and memorial services through the eyes of persons of faith. A simple form with personal requests can be completed while you attend or taken home for further thought and family discussion.

Two separate times of gathering are being offered: Tuesday, March 19, at 10 a.m., or Tuesday, March 19, at 7 p.m. Each session will be about an hour. For further information, or if you have questions regarding the funeral planning, please call Pastor Gary at the church office (784.1407).

Serving you today . . .

Pastor:

Gary Weaver

Minister of Music:

Pat Gensemer

Liturgists:

Brian Willis ~ 8 a.m.
Jane Bercher ~ 10:30 a.m.

Acolytes:

Tanner Kocher ~ 8 a.m.
John Bodenman ~ 10:30 a.m.

Greeters:

Brenda Payne
~ Third Street, 8 a.m.
Linda Boyer
~ Market Street, 8 a.m.
Patty Shaffer
~ Third Street, 10:30 a.m.
Patty O'Brien
~ Market Street, 10:30 a.m.

Ushers (8 a.m.):

Linda Boyer
Brenda Payne

Ushers (10:30 a.m.):

The Men of Wesley

Sound Technicians:

John Shively ~ 8 a.m.
Steve Karaffa ~ 10:30 a.m.

Combined Nursery (8 a.m.):

Eileen Thomas

Infant Nursery (10:30 a.m.):

Donna Gillaspay
Amelia Davis

Toddler Nursery (10:30 a.m.):

Glenda Kowalski
Adria Unger

Altar Guild:

Norma Beyers
Joan Erwine

This week at Wesley . . .

Today:

6 p.m. ~ Singers of Faith
6:30 p.m. ~ Nothing But Nets
7 p.m. ~ Starlight

Monday:

1 p.m. ~ Wesley Quilters
4 p.m. ~ VITA
5 p.m. ~ 5th/6th Boys Basketball
5:30 p.m. ~ Joyful Ringers
6 p.m. ~ Brownies
6:30 p.m. ~ Bells In Bloom

Tuesday:

1 p.m. ~ Prayer Shawl Ministry
3 p.m. ~ CCCS Basketball
4 p.m. ~ VITA
6 p.m. ~ Pampered Chef Show

Wednesday:

10 a.m. ~ "Invitation to the
New Testament"
4 p.m. ~ VITA
6:30 p.m. ~ Sugar Factory
5 p.m. ~ 5th/6th Boys Basketball
6:30 p.m. ~ Pictorial Church History
6:30 p.m. ~ "Invitation to the
New Testament"
7 p.m. ~ Gospel of Mark

Thursday:

12 noon ~ UMW Hospitality Lunch
4:30 p.m. ~ Kinder Choir
5 p.m. ~ Wesley Family Singers
7:15 p.m. ~ Sanctuary Choir

Friday - Saturday:

UMYF Mission Team Lock-In

Saturday:

8 - 10 a.m. ~ Flapjack Breakfast
10:30 a.m. - 12:30 p.m.
~ Community Friendship Meal
by Wesley UMW

Next Sunday, The Fifth Sunday in Lent

8 a.m. ~ Worship ~ 9:15 a.m. ~ Sunday School
10:30 a.m. ~ Worship
2 p.m. ~ Nick Beers Eagle Scout Award Ceremony
7 p.m. ~ Starlight

Wesley United Methodist Church

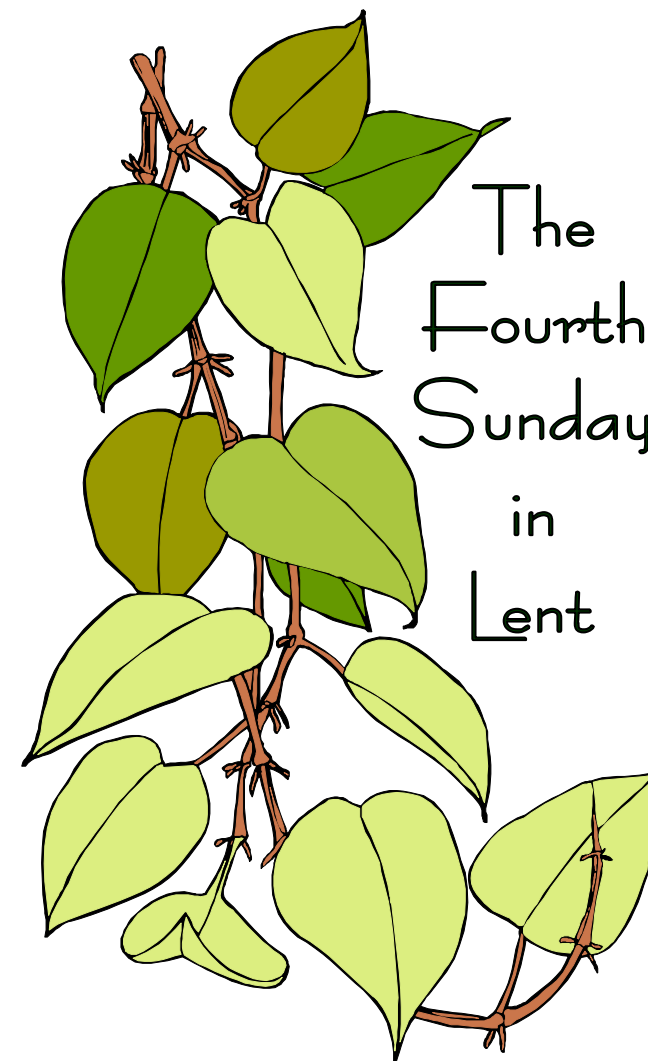

The
Fourth
Sunday
in
Lent

March 10, 2013

The Mission of Wesley Church is to:

KNOW

Jesus Christ as Lord and Savior.

GROW

in faith through worship, prayer,
and study.

GO . . .

in service to Christ and His world.

*The purpose of Wesley Church
is to
create disciples who serve Jesus Christ.*

Wesley United Methodist Church
130 West Third Street, Bloomsburg, Pennsylvania 17815-1709
Telephone: 570.784.1407 Fax: 570.784.7937
www.wesleybloom.org

Welcome to Wesley Church And A Celebration Of Worship

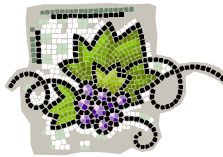

We are glad you are with us today!

*Please stand where indicated by the asterisk.



THE PRELUDE

“Pastorale on Hymn Tune ‘St. Columba, Lord, as to Thy Cross We Flee’”
Jack Goode

*THE CALL TO WORSHIP

Shawl making:

A piece of string, a scrap of yarn, an old hook in hand:
artifacts of a life, insignificant in isolation, together a story;
at once old and yet now unfolding.

Community:

**An ending, a beginning, a dream unfolding:
milestones in a common life, misunderstood in isolation,
together compelling;
we share the breadth of emotions this morning.**

This morning together in our differences, we experience the sacred.

*THE OPENING HYMN

“Immortal, Invisible, God Only Wise” UMH # 103

*THE OPENING LENTEN PRAYER

**The vine emerges from the earth, nourished and nourishing.
Rises without visible connection; roots hidden, promise unknown.
Strong to withstand storms, fragile when plucked too soon.
So it is that we grow . . .
nourished by invisible connections to our living God,
called to nourish that which is seen
and that which is yet buried within.
Allow us to feel your Spirit move this morning. Amen**



THE CHILDREN’S CHAT



THE BLESSING OF THE PRAYER SHAWLS

Leader:

Gracious, loving, and healing God,
bless these shawls that they might be tangible evidence
of the love and prayers of this congregation.

Response:

**Loving God,
may Your grace be upon these shawls
made with love and prayers.
Bless the hands that made these shawls to be the hands of blessings.
May the people who receive them
be embraced with Your love, hope, joy and peace.
Wrap Your everlasting arm around them**

**with Your steadfast and unconditional love.
May the shawls represent Your loving arm
to uphold them with warmth and care.
May they feel Your presence and comfort when they use them.
Loving God, reach out to those who receive the shawl with Your
healing hand and Your power for their wellness and wholeness.
Give them wisdom, strengthen them
and bless them in all things they do.
In Jesus name we pray, Amen.**



THE PASTORAL PRAYER

THE LORD’S PRAYER

**Our Father, who art in heaven,
hallowed be Thy name
Thy kingdom come, Thy will be done
on earth as it is in heaven.
Give us this day our daily bread.
And forgive us our trespasses,
as we forgive those who trespass against us.
And lead us not into temptation,
but deliver us from evil.
For Thine is the kingdom, and the power,
and the glory, forever. Amen.**



*THE GOSPEL LESSON

John 15 1 - 8 NT Pew Bible Pages 102/103

Leader: This is the Word of the Lord.

People: Thanks be to God.

THE SERMON

“I Am the True Vine”

Gary D. Weaver, Pastor

THE HYMN (10:30 a.m.)

“The Branch The Bends With Clustered Fruit”

**The branch that bends with clustered fruit
Still needs the pruner’s blade
To keep it close to vine and root
Or else its strength will fade.**

**The spindly, twisted, tangled coil
Of branches over-grown
Produces nothing from its toil
But feeds itself alone.**

**The pruner’s hook will gently play
Where fruitful growth is seen
But like an axe will slash away
The empty net of green.**

**O God, who fills with rain and sun
The grapes we press for wine,
Cut off the growth out fears have spun
And prune us to Your vine.**



THE OFFERING OF OUR TITHES AND GIFTS

THE ORGAN OFFERTORY (8 a.m.)

“Offertoire”

Jonas Blewitt

THE DEDICATION OF OUR GIFTS TO GOD (8 a.m.)

**Praise God, from whom all blessings flow;
praise Him, all creatures here below;
praise Him above, ye heavenly host;
praise Father, Son, and Holy Ghost. Amen.**

THE PRAYER OF DEDICATION (8 a.m.)

**Accept this Lenten offering, O God,
as a token of our desire to be responsible stewards,
an expression of our love for You,
and a sign of our willingness
to be of even greater service in the future;
in Jesus’ name we pray. Amen**



THE OFFERTORY ANTHEM (10:30 a.m.)

“Look To The Rose”

Sanctuary Choir

Joseph M. Martin

*THE CLOSING HYMN

“This Is My Father’s World”

UMH # 144

*THE BENEDICTION

**Because Christ lives, because the Spirit flourishes, the headline reads:
Grace, mercy, and peace are yours. The news is good.
This Lent, may we accept the good news with joy
and serve God gladly. Amen.**

*THE POSTLUDE

“Allegro”

Antonio Vivaldi



The Sanctuary Choir anthem has been given in memory of
Our Loved Ones
by Max and Elizabeth Miller

The altar flowers are presented to the glory of God and in loving memory of
Mr. and Mrs. C. Bruce Hartzel, Mr. and Mrs. Carl R. Cope,
and Mr. and Mrs. J. Myron Paul
By The Family

The rosebud which graces the altar is presented to the glory of God
and in honor of the birth of
Kai Elizabeth English.
Kai was born on February 13, 2013,
and is the daughter of Megan Brown and Cameron English,
granddaughter of Denise and Thomas Brown
and Jill (Bennett) and Dan English,
and great granddaughter of Carol and Fred Bennett.

Nothing But Nets

Today, members of the Wesley UM Youth Fellowship will be asking for your contributions to benefit "Nothing But Nets."



"Nothing But Nets" is a global, grassroots campaign to raise awareness and funding to fight malaria, a leading cause of death among children in Africa. "Nothing But Nets" provides everyone the opportunity to join the fight against malaria. Contributions go towards the cost of purchasing a long-lasting, insecticide-treated bed net, distributing it, and educating communities on its use.

"Nothing But Nets" works with UN partners like UNICEF, the UN Refugee Agency, and the World Health Organization to purchase nets, transport them to Africa, and distribute them to families. Net distributions are typically part of a wider public health effort within a country coordinated by the Ministry of Health, the UN and other local and international organizations.

This morning, the youth are asking for any donation you are willing to give to help contribute to this important cause. With one million children dying each year from malaria, Wesley youth want to do all they can to help. Every \$10 collected today will purchase one net. Tonight, the youth will "earn" the amount of money collected by shooting baskets in the gym. The youth, as a group, will try to make one basket for every \$1 collected.

Thank you for your support of this effort to save lives in Africa.

UMW Hospitality Luncheon

All UMW women are invited and encouraged to bring a guest to this Thursday's Hospitality Luncheon. It will take place in the social room at 12 noon. Following lunch, the UMW Prayer and Self-Denial Program will take place along with a short business meeting. Those who are in need of transportation should contact Marg Laytar (389.1013) or Kathy Finnerty (387.8930).



Softball at Wesley

Softball season is just around the corner. Spring training baseball season has started. We want you to be part of family fellowship. Softball games are Monday evenings from 6 o'clock to approximately 8 o'clock. All are invited to join in the fun — you must be at least 13 years of age to play. Hope to see you on the field! For additional information, contact Ken Beere (683.6533) or Phil Burrell (387.1122).



Flapjack Breakfast at Applebee's, Bloomsburg

Sponsored by the Sojourners SS Class

Saturday, March 16, 2013

serving from 8 - 10 a.m.



Cost is \$7 per adult
\$4.50 for children under ten

This is a fundraiser to benefit the UMYF summer mission trip to Newfane, New York.

Please come out and show your support.

Ham Dinner

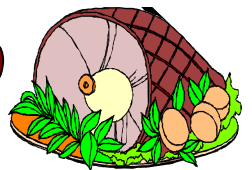

sponsored by The Men of Wesley to benefit Camp Victory

Saturday, March 23, 2013 ~ Serving 4 - 7 p.m.

The meal includes: ham, glazed sweet potatoes, corn, green beans, and biscuits.

Adults: \$8 Children 6 - 12 years: \$3 under 6: free

All proceeds will benefit a workday at Camp Victory sponsored by the Men on May 4, 2013.

Food Cupboard Needs for the month of March

Canned Vegetables ~ Canned Tuna



Please consider contributing a can or two each time you worship this month. Items can be left at the Donation Station.

Crusaders Spring Rummage Sale

Friday, April 5 ~ 8 a.m. - 4 p.m. & Saturday, April 6 ~ 8 a.m. - 1 p.m.



The Crusaders Spring Rummage Sale is just around the corner and they will take any of your unwanted items for this sale. Please take items to the Crusader storage room in the catacomb area of the church basement. As always, the Crusaders appreciate your support through your contributions and through your purchases.

"Ecclesiastical Guide to Bird Watching" ~ Wesley's 2013 All-Church Retreat at Wesley Forest ~ April 5 - April 7, 2013



Open up your hearts and mind so that you can:

Know . . . Jesus Christ as Lord and Savior,
Grow . . . in faith through worship, prayer and study.
Go . . . in service to Christ and His world.

If you haven't been part of a Wesley all-church retreat, this is the time to join-in for an enjoyable, inspirational, and memorable weekend. There is a well-rounded plan for worship and study that will include fun, games, and crafts for the younger generation. In addition, there will be hiking for one and all and terrific meals at the camp dining hall. And, of course, everyone's favorite — campfires will be an added highlight to end the day.

If you don't want to spend the entire weekend on retreat, you can attend for just the Saturday session. Be sure to arrive early, and join the over-nighters in order to get the day off to a rousing start.

Sign up now — register and indicate your preferences by completing the form on the back.

Friday, April 5

6:00 p.m.: campers arrive at Wesley Forest; bunk assignments distributed ~ 8:00 p.m.: closing worship

Saturday, April 6

8:00 a.m.: breakfast ~ 8:45 a.m.: worship

9:30 - 11:30 a.m.: adults and older youth: "Ecclesiastical Guide to Bird Watching" with Pastor Byron Krapf
children's guided time of learning ~ craft

12:00 p.m.: lunch

1:00 - 3:00 p.m.: "free" time and/or guided tour; suggested directions/instructions; children w/ parents or another adult

3:00 - 4:30 p.m.: all-group activity (recreation in field)

5:00 p.m.: dinner

6:00 - 8:00 p.m.: "Ecclesiastical Guide to Bird Watching"; children in supervised activity time

8:30 p.m.: closing worship

Sunday, April 7

8:00 a.m.: breakfast ~ 9:00 a.m.: pack, load up ~ 10:00 a.m.: closing worship ~ 11:00 a.m.: depart for home

Friday evening, April 5, through Sunday morning, April 7, 2013

"Ecclesiastical Guide to Bird Watching"



Wesley's 2013 All-Church Retreat at Wesley Forest

Registration

Name: _____

Address: _____

Telephone: _____ E-mail: _____

Adults: \$55 ____ Youth: \$25 ____ Children age 6 and under are free (includes meals and lodging)

One-day, Saturday Camp — for those who want to come just for the day — Adults: \$25 ____ Youth: \$15 ____ (includes lunch and dinner)

Child care needed: Yes No

Will be able to provide transportation: Yes No Will need transportation: Yes No

Complete this form, and mail to Wesley United Methodist Church, 130 West Third Street, Bloomsburg, PA 17815-1709

Communication Card

Please print all information.



United Methodist Church
130 West Third Street, Bloomsburg, PA

Dr. / Mr. / Mrs. / Ms.

Name: _____ Change in contact information

E-mail address: _____

- 1st-Time Guest
- 2nd-Time Guest
- Regular Attendee
- Member

Address: _____ Apt: _____

Town/City: _____ State: _____ Zip: _____

Best Contact Telephone: (____) _____

Complete this section
only if visiting
or if a change

If 1st or 2nd-time guest, how did you hear about Wesley Church? _____
(Name of person who invited you, radio, website, newspaper, other.)

This Week's Opportunities

The Fourth Sunday in Lent, March 10, 2013

- I/we would like to attend the UMW Hospitality Luncheon this Thursday, and I will bring a friend.
- I/we would like to purchase tickets for the Men of Wesley's Ham Dinner to be held on Saturday, March 23, to benefit Camp Victory.
- I/we would like to attend the March 30 Easter basket-making and breakfast at 9 a.m.
- I/we would like to be a part of, or receive information about, the UMW Evening Gatherings.
 - I need child care for the meetings: yes no

Please be sure to provide your contact information if you sign up for these Wesley activities.

E-mail: _____ Telephone: _____