



Nechi Institute: Centre of Indigenous Learning Est. 1974

Course Calendar 2015-16





Welcome to Nechi

The Nechi Institute: Centre of Indigenous Learning offers specialized training to addictions counsellors working in Indigenous communities. Our teaching model applies theory to practice through role-playing, experiential learning and group work.

For over 40 years, Nechi has been a leader in delivering comprehensive addictions treatment research and training, both theory and experiential. We are pleased you are considering studying with us.

Before you register

In order to register for classes, you must meet the following requirements:

- You must have achieved one (1) year sobriety if you have a history of addictions.
- You must be 18 years of age or older (some exceptions may apply).
- You must agree to abstain from the use of alcohol and illicit drugs throughout training.
- Some of our courses, require that you have good academic standing in English 30-1 and English 30-2.
- Eligibility for Mature Student status will be reviewed.

Visit Nechi

You can visit Nechi any time during regular office hours for a tour of the grounds. Please call ahead to ensure that a staff member is available to answer your questions.

Questions?

Contact Student Services Monday to Friday between 8:30 a.m. and 4:30 p.m. MST:

780.459.1884 – Edmonton, AB

800.459.1884 – Toll Free

nechi@nechi.com



CONTENTS

Message from the Director of Operations	...4
Our History	...5
Nechi Institute's Noble Cause	...6
What's New!	...7
About Nechi	...8
Mission Statement	...9
General Admission Requirements	...11
Process for Application	...13
Withdrawal, Cancellation, Grievance Procedures	...14
Training Hours & Attendance	...15
Grading	...16
Student Resources	...17
Graduation	...18
Maps	...19
Students in Residence	...20
Preparing for Training	...21
International Scholarship and Intern Trainer Development	...22
Training Programs and Paths to Post Secondary	...23
Post-diploma Articulation Agreements	...24
Nechi Courses & Program Listings	...25
CAT	...25
ACT	...27
TOT	...29
IASC – Year 1	...30
IASD – Year 2	...33
Specialty Courses	...35
Youth Worker Training Series	...36
Application Checklist	...37
Application for Admission	...38

Message from the Director of Operations



Thank you for considering Nechi for your personal and professional training!

Over forty years ago, Nechi was built on the Indigenous world-view defined by universal “truths” and by natural values such as honesty, caring, and respect. With the ongoing guidance of Elders and our Board of Governors, we continue to incorporate these principles to initiate a transformative healing process for Indigenous communities.

Although Nechi was primarily established to provide essential tools to Indigenous individuals and communities to help improve the health and wellbeing of our people, we also accept applications into our programs from the general public and international students. Nechi encourages learning and holistic healing for individuals, families and communities.

Our Indigenous Addictions Services Diploma (IASD) program is now complete and ready for delivery. We continue to have ongoing discussions with other post-secondary institutes for full transferability of our IASD to other post-secondary institutes.

Nechi is committed to continuing its mission by renewing and strengthening our programs and services. We will assist in the advancement of health and wellbeing in all communities. We will work with kindness, honesty, care, and compassion to incorporate our beliefs and noble cause in all aspects of our program delivery. We continue to implement Nechi’s Noble Cause for change within the organization, to create opportunity for new growth, of which core values are guiding principles moving Nechi Institute forward. We thank you, the Indigenous health care professional and wellness workers who continue to help construct and foster this future.

For the coming year, Nechi will engage in curriculum redesign of our Community Wellness Certificate program, a program owned by Nechi, and in the past co-delivered with Keyano College before the MOU dissolved in 2011. Students who are missing courses in CWC will be given an opportunity to complete the program when the revised program is ready for delivery at Nechi in 2016.

The training you receive at Nechi is designed to heal and transform you, as you advance your studies in the helping field. At Nechi, we can help you create a solid spiritual foundation – that you can build a career on.

Ishnish! Hai-Hai! Thank you!

OUR HISTORY

Nechi Institute was established in 1974, by a small group of committed individuals, to meet the growing need for addictions prevention and recovery resources for Indigenous people.

Today, through culturally responsive training, research and health promotions initiatives, Nechi provides counselors, health care workers, social workers, educators, community service agencies, government agencies, and other members of the helping professions with the tools and resources to help heal the pain and devastation caused by addictions and abuse.

Internationally recognized as one of the finest Indigenous training, research and health promotions centres in the world, Nechi Institute is a powerful resource for Indigenous people and communities addressing issues such as mental health issues, historical trauma, drug and alcohol misuse, gambling problems, family violence, and prescription drug abuse.

Nechi Institute uses the Experiential Learning Model, encouraging students to “learn through doing.” Courses in each series are comprised of structured exercises, large and small group as well as individual work assignments, brainstorming sessions, support groups, energizing exercises, role play and computer/smart board technology which provide opportunities to practice new skills.

Students are encouraged to participate in all aspects of training and are required to complete a written assignment or exam at the conclusion of each course.

Nechi Institute offers a number of programs, some of which are transferable to many universities and tribal colleges.



DR. BETTY BASTIEN

BOARD OF GOVERNORS

Dr. Betty Bastien - Chair Piikani Nation, Treaty 7

Angelina Pratt - Vice Chair Athabasca Chipewyan Nation, Treaty 8

Dr. Cora Weber-Pillwax - Secretary/Treasurer, Calling Lake Settlement, Métis Nation

Gerald Cunningham East Prairie Métis Settlements

Lillian M. Shirt Saddle Lake Cree Nation, Treaty 6

Stephen Didzena Dene Tha', Treaty 8

NECHI INSTITUTE'S NOBLE CAUSE

**Individual integrity is the foundation and survival of the collective.
Nechi is a way to make harmony real in the world.**

**Through the Core Values of:
Integrity, Respect, Harmony, Openness,
Honesty, Service, Accountability, Wellness**





INDIGENOUS ADDICTIONS SERVICES DIPLOMA PROGRAM

The Indigenous Addictions Services Diploma (IASD) program is designed to provide students with excellent academic education in addictions and the credentials needed to advance post-secondary education studies. Graduates from the IASD program will be qualified and prepared to serve in communities in various capacities.

COMMUNITY WELLNESS CERTIFICATE

For this year, we will be redesigning our Community Wellness Certificate and the revised program will be offered at Nechi in 2016. All former students who attended CWC in previous years however did not complete, are encouraged to contact Nechi Institute regarding completion of the Community Wellness Certificate when it is offered at Nechi Institute.

Transformational Experience!

Come and experience the Spirit of Nechi!

TAWOW

W e l c o m e

ABOUT NECHI

Tawow means *Welcome* in Cree
Welcome to the Nechi Experience.

People who walk through the doors of the Nechi Institute: Centre of Indigenous Learning experience a unique blending of academic curriculum and traditional Indigenous culture; a powerful combination that ensures healing and transformation. Nechi also incorporates traditional Indigenous spirituality to enhance each students' learning experience. These shared spiritual and traditional values result in a solid foundation of Indigenous awareness that enhances self-esteem, personal growth and greater respect for individuals, families and communities.

We hold the principle that addictions-free lifestyles create stronger self-awareness and promotes healthier environments. Though the work begins here, the results are seen in our communities as we, Indigenous people, live healthy addictions-free lifestyles.

MISSION STATEMENT

“Nechi is an Indigenous Movement committed to holistic healing and healthy addictions-free lifestyles.”

PHILOSOPHY

Nechi’s philosophy is founded upon the spirituality of all Indigenous peoples: for our collective well being. It is through the Indigenous way of knowing, healing and learning, that Indigenous people master our challenges and determine our destinies.

NECHI BELIEFS

The vision and spiritual development of Nechi’s staff and Board of Governors are rooted in the well being of the collective Indigenous community.

Each person has the ability to make a commitment to personal wellbeing, which is a natural state of being.

Every person is a teacher, a learner and a healer.

The cultural context for training and treatment of Indigenous people is critical to success so the process of training, research and health promotions must embody Indigenous ways of knowing, healing and learning.

Our approach to training, research and health promotions must be holistic and balanced, focusing on the physical, mental, emotional and spiritual dimensions of the individual.

The people we serve will be honoured. People know what they need and must be able to contribute to their own healing.

Nechi and the communities it serves are involved in a healing process.

Healing and wellness must be components of training, research and health promotions. The approach must be comprehensive, addressing the individual in the context of the Indigenous community. Healing and wellness of the individual contributes to the healing of the family and the community.

Addictive dependencies are diseases which can be treated and from which recovery is possible.

Voluntary service contributes to the wellness of individuals, families, agencies and communities.

HOLISTIC APPROACH TO INDIGENOUS HEALING

Our programs and resources are developed with an Indigenous world view. Nechi Institute is one of the few training, research and health promotions organizations in the world operated primarily for Indigenous by Indigenous.

This Indigenous experience is fundamental to the success of our programs.

Indigenous culture and traditional values are incorporated into all programs; hence the daily training session opens with a Smudging Ceremony, prayer and/or a handshake circle. Participants are encouraged, however not obligated to attend prayers and ceremonies.

CULTURAL ACTIVITIES AND CEREMONIES

Sweat Lodge ceremonies can be held as part of the cultural component and to meet the needs of the staff and students.

As this aspect of our activities becomes more self-sufficient, we return to the traditional ways of our people in a meaningful and valued manner. Our Elders, Board of Governors, and Staff members support and encourage movement in this direction.

The majority of our training courses are opened by Traditional Elders and Spiritual Helpers from the community which sets the tone for the week by sharing traditional teachings and/or ceremonies.



GENERAL ADMISSION REQUIREMENTS & APPLICATION PROCESS



Applying to Nechi programs is easy and straightforward.

The following table cross-references the various programs offered by Nechi and the appropriate application process that a student should follow in order to enroll.

How to Apply to Nechi Programs

Program	How to Apply
Community Addictions Training (CAT)	Follow the Nechi Application Process
Advanced Counsellor Training (ACT)	Follow the Nechi Application Process
Training of Trainers (TOT)	Follow the Nechi Application Process
Specialty Nechi Courses	Follow the Nechi Application Process
<i>Community Wellness Certificate (CWC)</i> <i>UNDER REVIEW</i>	<i>Follow the Nechi Application Process with Transcripts</i>
Indigenous Addictions Services Diploma (IASD) Year 1 and Year 2	Follow the Nechi Application Process with References and Transcripts

Age & Sobriety Requirement

- A minimum period of one (1) year sobriety (if the student has a history of addictions)
- Eighteen (18) years of age or older are requirements for all persons attending in-house training at Nechi Institute.
- All students must abstain from the use of alcohol and illicit drugs throughout their training experience. We ask students and sponsoring agencies for their continued support regarding this important criteria. Our concern for those students sponsored with less than the minimum required period of sobriety is they may be in more need of treatment than of training. We would not be able to meet our goals or those of the sponsoring agency to train addictions counselors.

Interview Requirement

- Students applying for Advanced Counselor Training are required to complete an interview questionnaire.
- Students applying for the Indigenous Addictions Services Diploma are required to complete a suitability questionnaire and personal profile (resume or Curriculum Vitae).

Pre-Requisites & Mature Admission

Applicants for the Indigenous Addictions Services Diploma (IASD) and Community Wellness Certificate (CWC) program must possess an Alberta High School Diploma or equivalent with a mark of 50% in English 30-1 or 65% in English 30-2. Admission to the programs of mature students, 21 years of age or older, with less than a High School Diploma, will be based upon grades achieved in a reading and writing skills pre-admission test.

Reference Requirement

Applicants to the Indigenous Addictions Services Certificate (IASC) program are required to submit two (2) references using the IASC reference form. The completed reference forms must be submitted in sealed envelopes directly to the Student Services Coordinator.

Application Requirements

New and returning students are required to complete all steps of the application process. Acceptance into programs and courses will be determined based on the review and assessment of information from one or all of the following sources:

- Student Application Form
- Interview Questionnaire/Personal Profile
- Student Summary Sheets
- Instructor's Feedback
- References
- High School Achievement or Pre-Admission Test Score

Accreditation and Certification

Nechi Institute's courses are accredited and certified by: National Indigenous Accreditation Board (NIAB), Canadian Addiction Counsellor's Certification Federation (CACCF), Canadian Council on Professional Certification (CCPC), First Nations Wellness/Addiction Counsellor Certification Board (FNWACCB).

Nechi courses are also accredited through our membership with the Alberta Council on Admissions and Transfers (ACAT) and First Nations Adult Higher Education Consortium (FNAHEC).

*What was once the vision of a few
is now the hope of many*



PROCESS FOR APPLICATION

1. A completed application form, interview questionnaire, reference forms, and high school transcripts, if applicable, are to be mailed to Nechi Institute. If a student is being sponsored, the application form must be signed by the Director or designate of the sponsoring agency. Send completed forms by mail to:

Nechi Institute: Centre of Indigenous Learning
P.O. Box 2039, Station Main,
St. Albert, Alberta T8N 2G3
By fax to: 780-458-1883

2. Application forms, which are not complete, will not be processed until all required information is submitted. It is the responsibility of the student to follow-up on their application submission to ensure that all required correspondence has been received by Student Services.
3. **The first course of the Community Addictions Training (CAT) Series (Communication & Ethics) is a pre-requisite** for attendance in the remaining seven (7) courses.

Completion of the CAT Certificate is a pre-requisite to admission in the Advance Counsellor Training (ACT) Certificate. All ACT courses are designed on CAT courses and provide advanced knowledge.

4. Notification of acceptance will be mailed to the student and sponsoring agency. Letters will include course schedules and when applicable, a map to the centre and details regarding dormitory-style residence.
5. Fees are payable to the Nechi Institute and are due one week prior to the first day of the program. Student will not be permitted to start until all required fees have been received.
6. For some programs, training is delivered approximately one week every month to allow working student's time to integrate their new knowledge and skills, as well, ease scheduling difficulties for their employers.
7. **Nechi Institute does not arrange** practicum placement or employment. All practicum required courses must be arranged by the student and submitted one month before course end date.
8. Students must contact Student Services to confirm their attendance one week prior to commencement of their program.

WITHDRAWAL, CANCELLATION, GRIEVANCE PROCEDURES AND POLICIES

Withdrawal Procedures for Nechi Institute Programs

A student may withdraw from a program at any time, in writing. However, we strongly encourage speaking first with your Trainer or the Director of Training/designate. Students who withdraw from a program may be eligible to apply to retake the same program, and may be subject to additional fees. *NOTE: Students are strongly encouraged to retake the course within one year following.*

Cancellation Policy

A 10% Administration fee is applied if you cancel more than 10 business days prior to the start of a course. NO REFUND applies if you cancel in less than 10 business days prior to start of a course; tuition will be credited towards a future course. *Nechi Institute reserves the right to cancel a course with insufficient registration upon which Nechi Institute will reimburse 100% of paid fees or advance credits towards another course.*

Change of Name or Address

Please notify the Student Services Coordinator in writing immediately of any name changes so student records remain accurate. Name change documentation must be included.

It is vital that changes in telephone number or address be updated in the student record. To change an address, students can provide information in person, by telephone or by mail to the Student Services Coordinator.

Transcripts

Transcripts & Certificates will be provided at the conclusion of your program. Please allow six (6) to eight (8) weeks for processing. Additional transcripts and certificate replacements may be ordered at a cost of \$15 each.

Grievance

The term grievance for the purpose of Nechi Training refers to students who have expressed dissatisfaction with certain conditions such as but not limited to:

- re-writes
- suspension
- termination
- living conditions
- student conflict
- student summary sheets

Grievance Procedures

Should conflict or dissatisfaction arise between students, or students and Trainers, the grievance procedures are the same.

- 1) Students are first encouraged to resolve the matter between themselves and the other party.
- 2) If the difference is not resolved, they can request the assistance of a trainer or a mediator of an increasingly higher authority should the matter continue to not be resolved. Trainers can intervene when requested if the matter is between students.
- 3) The Director of Training/Designate can also assist (when requested to by writing) if it is between student and Trainer.
- 4) If this matter is not resolved by the Director of Training/Designate, the Director of Operations (CEO) may address the issue if a request is issued in writing.
- 5) If the problem is still not resolved by the Director of Operations (CEO), the grievance may be submitted in writing to the Board Chair outlining the progressive steps taken to resolve the matter.
- 6) The Board Chair will review the grievance, determine if all appropriate steps have been followed and render a final decision in accordance with the organizations procedures, policies and guidelines.
- 7) The Board Chair’s decision will be final.

TRAINING HOURS & ATTENDANCE

Required Training Hours

Advanced Counsellor Training (45 hours)

- Sunday morning – 8:30 a.m. – 10:30 a.m. - Culture
- Class begins immediately following cultural presentation
- Monday – Friday – 8:30 a.m. – 4:30 p.m.
- Support Group – 3 days for 1 hour (4:30 – 5:30 p.m.)

Community Addictions Training (40 hours)

- Sunday evening – 7:00 p.m. – 9:00 p.m.
(*REQUIRED: Culture Night every week except for Summer Session)
- Monday to Friday – 8:30 a.m. -4:30 p.m.
- Support Group – 3 days for 1 hour (4:30 – 5:30 p.m.)

Community Wellness Certificate (45 hours)

- *Saturday evening – 7:00 p.m. – 10:00 p.m.
(*Culture Night- First class only)*
- *Sunday – Friday – 8:30 a.m. – 4:30 p.m.*

Indigenous Addictions Services Certificate (39 hours)

- Monday to Friday – 8:30 a.m. -4:30 p.m.
(Excluding Statutory Holidays)

Indigenous Addictions Services Diploma (39 hours) + Practicum

- Monday to Friday – 8:30 a.m. -4:30 p.m.
(Excluding Statutory Holidays)

Pharmacology (PHARM) (21 hours)

- Tuesday to Thursday - 8:30 a.m. – 4:30 p.m.
(As scheduled)

Training of Trainers (TOT) (40 hours)

- *Sunday evening – 7:00 p.m. – 10:00 p.m.
(*Culture Night, first class only)
- Monday – Friday – 8:30 a.m. – 4:30 p.m.

TOT Weekend Session (40 Hours)

- Saturday (8:30 a.m. – 4:30 p.m.) X 3
- Sunday (8:30 a.m. – 4:30 p.m.) X 2

**All other courses start at 8:30 a.m. – 4:30 p.m.
as scheduled.**

Attendance & Punctuality

Attendance and punctuality in all aspects of training is mandatory including assigned evening support group meetings.

- **Students will be deducted 2 points for every hour missed, for any reason.**
- **Your Instructor may assign you a make-up assignment for time missed, however you will still be deducted points.**
- **Due to required certification hours, if you miss more than seven (7) hours during the training week you will have to repeat the course. THERE ARE NO EXCEPTIONS.**

Absenteeism

Nechi training is founded on the Experiential Learning Model and therefore; participation and attendance is critical to a successful training outcome.

Continued tardiness will first be discussed privately with the student, Trainer(s) and the Director of Training/Designate (if necessary). Should the behavior continue, the student will be asked to withdraw from the course. **If this occurs, the sponsoring agency will be notified.**

If you are going to be absent or late, please notify the Trainer(s) or the Student Registrar, prior to the course.

Arrangements must be made with Student Services to attend a missed or failed course **within one** training year (space permitting).

Failure to complete the missing course within one year will result in a forfeit of payment, and the student will be required to pay for all fees before commencement of any class.

GRADING

Grades for Nechi Institute Courses

Students will receive a written outline at the beginning of each course with the objectives and content, and the trainer’s expectations regarding attendance, evaluation and assignments.

Exceptions include Personal Growth course of the Community Addictions Training Certificate and Suicide Prevention and Grieving and Culture and Traditional Values courses of the Advanced Counsellor Training Certificate. The Trainer(s) will explain the grading system for each course.

A grade of less than 50% for any given course will result in a re-write of the assessment for that course.

A grade of less than 50% for either the Indigenous Addictions Services Certificate/Diploma or the Community Wellness Certificate will result in a re-write of the assessment for that course.

Student Summary Sheets

Within thirty (30) days following the completion of each course provided that the student is in good standing with no outstanding fees, Student Summary Sheets will be mailed. These provide information pertaining to student performance, attendance, assessment marks and relevant Trainer comments. Copies of Student Summary Sheets are placed in each student’s file.

Students may direct any questions, concerns or request for further clarification on the Summary Sheet to the Trainer who submitted the evaluation. Amendments or corrections to the document may be made by the lead Trainer, when applicable, after full consultation has been held with the Director of Training/Designate to determine the need for amendment.

Student Progress

It is our policy to inform sponsoring agencies of their student’s progress, we will continue this practice by sending copies of the student’s attendance, punctuality, and marks to the sponsors, as requested.

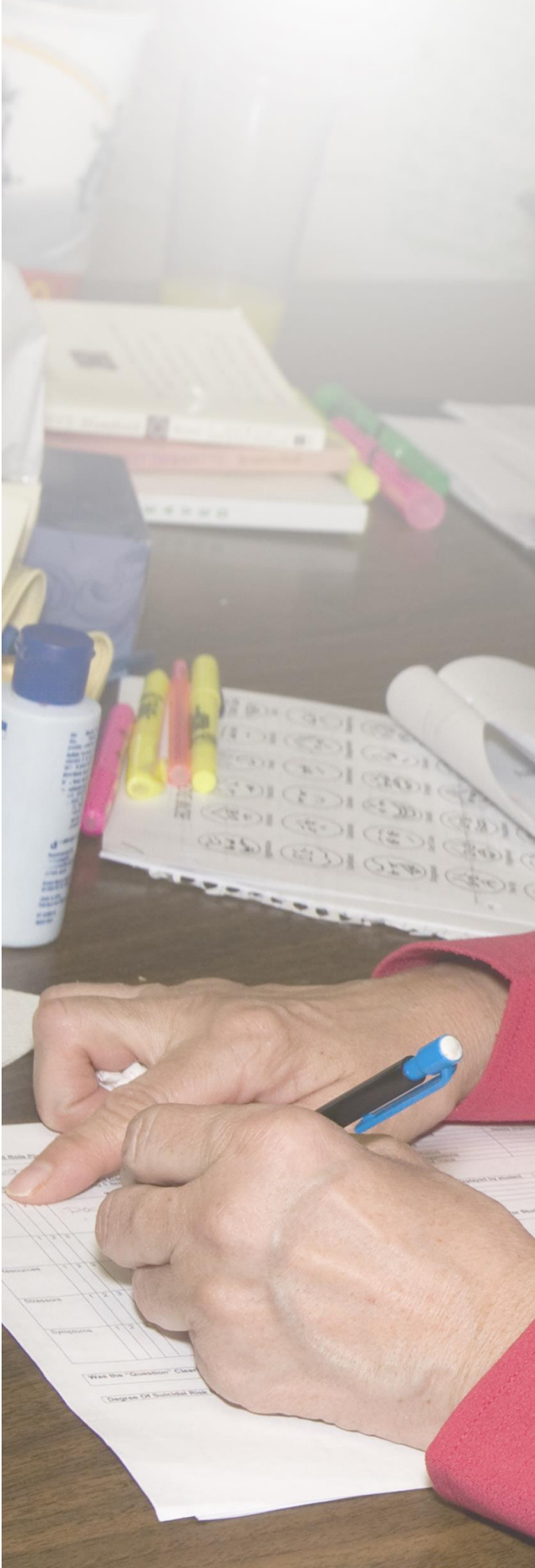

STUDENT RESOURCES

Computer Use

Students must abide by the Acceptable Computer Use Policy posted in the computer lab and with all conditions outlined in the Computer Network Acceptable Use Policy form (signed at the start of their training program).

Laptop Computer Use

Laptops are not allowed in training sessions unless required as a teaching or learning aid for legitimate reasons. Notification to the Trainer is required prior to commencement of training.

Telephone Voice Messaging Service

Please ensure your employer, family and friends are aware of the student voice mail number:

(780) 459-0984

This number is the ONLY number they may use for non-emergency contact.

No phone calls or messages will be taken during training unless it is an EMERGENCY.

Pay Phone

Two pay phones are provided for student use. In consideration of your peers, please limit telephone calls to ten minutes. Long distance phone cards are not available for purchase at Nechi, please ensure you buy enough credits to last you during your stay.

Cell Phones

Cell phones are not permitted on the training sets or breakout rooms, while training is in progress. You will be asked to turn your cell phone's off before class begins, and throughout the day. Students may use their cell phones during breaks and after classes.

To avoid distractions for the Poundmaker's Lodge Treatment Centre clientele, students are not permitted to use cell phones in the foyer, cafeteria and smoking area.

Nechi Resource Library

For further information about the Library contact the Director of Training/Designate (780) 459-1884.





GRADUATION

Graduation and Certificates of Completion are issued to students who successfully complete all course requirements:

- Advanced Counsellor Training Certificate (ACT)
- Community Addiction Training Certificate (CAT)
- Community Wellness Certificate (CWC)
- Indigenous Addictions Services Certificate (IASC)
- Indigenous Addictions Services Diploma (IASD)
- Training of Trainers Certificate (TOT)

Students are encouraged to assist in preparation for the graduation ceremony.

Students are eligible to participate fully in the graduation ceremony if they have successfully completed 100% of all course requirements and all course fees has been paid. **No exceptions will be made.**

Students who HAVE successfully completed their course of study will receive their certificate in the mail. Please allow six (6) to eight (8) weeks for delivery.

Students who have NOT completed the course requirements will receive their certificate upon completion of the program.

Students who have completed 75% of all course requirements may be allowed to partake in the graduation ceremonial march, at the discretion of the Director of Training/Designate. However, will not receive a graduation certificate until all courses have been completed.

Students with an outstanding invoice for tuition or textbooks will NOT receive certificates until all outstanding amount is paid in full and will not be permitted to participate in the Graduation Ceremony.

Student Health & Wellness

Some participants may experience difficulty coping with a new awareness which may arise in training. These students are encouraged to attend counseling or therapy as part of their professional development. Nechi Institute will provide referrals for those students requiring professional counseling or therapy.

Personal disclosures will receive an appropriate response to ensure the safety of all students. The Trainer(s) will identify high-risk situations which are required by law to be reported (e.g. homicide, suicide, child abuse).

Medical Information

Students are required to complete a Medical Information form at the beginning of training. This information is collected in case of emergency as well, to alert staff of special diet restrictions. Our food services provider does not accommodate special diets, so the student will need to make alternate arrangements.

MAPS

Training Area Map

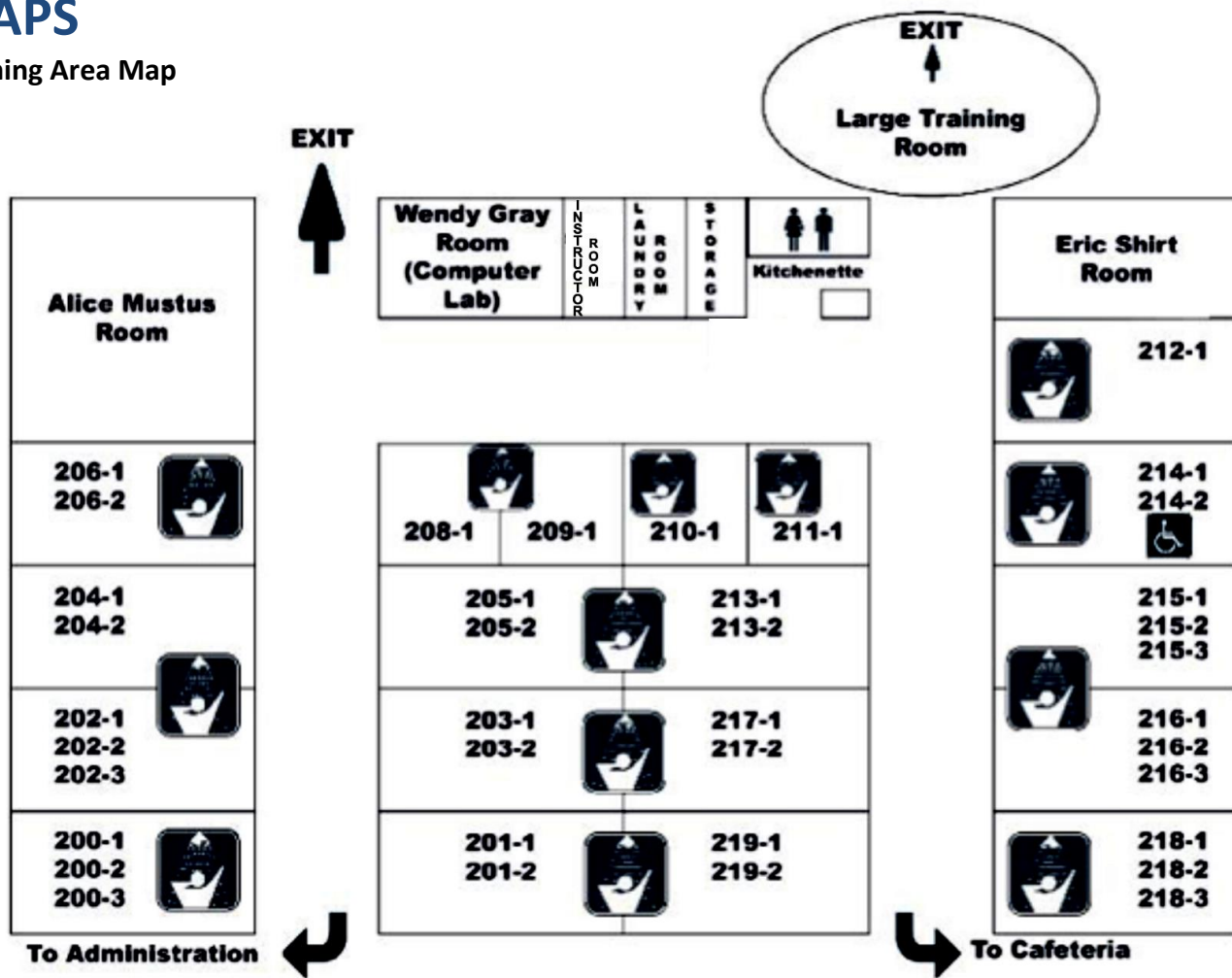

Building/Parking

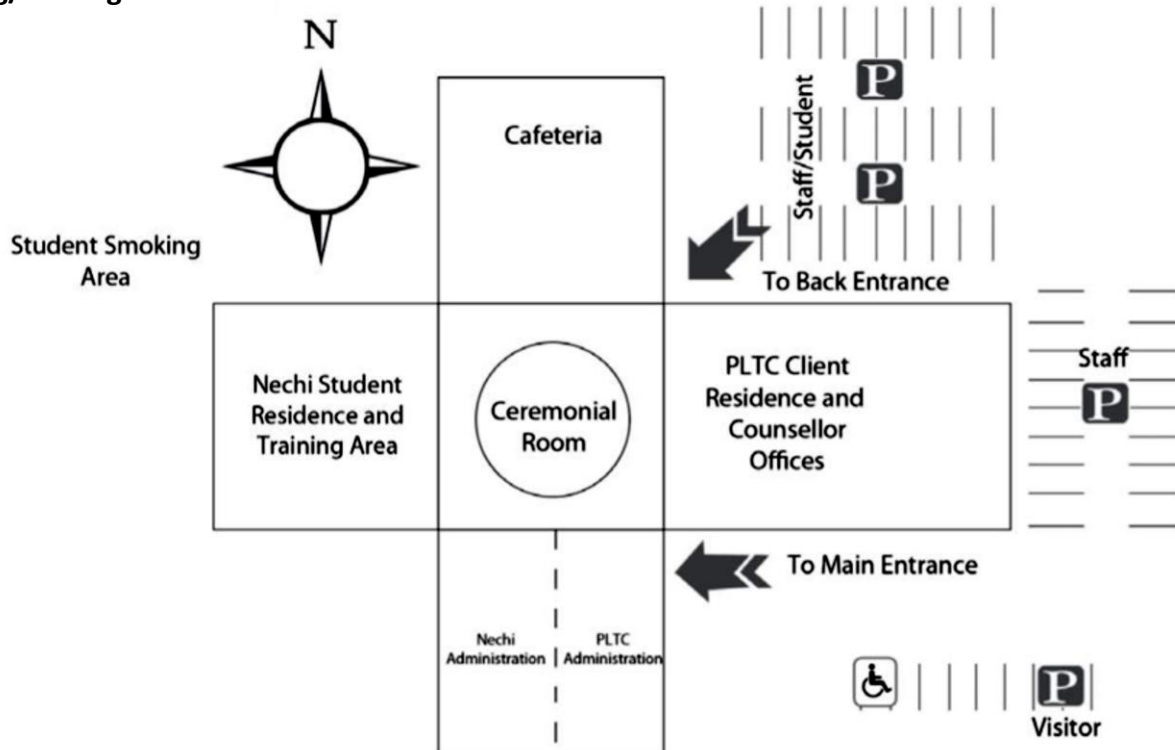

Map

STUDENTS IN RESIDENCE

Alcohol and Drugs

Alcohol and/or illicit drugs are NOT permitted on the premises.

Students who are under the influence of alcohol or illicit drugs will be asked to withdraw immediately and leave the premises. **THERE ARE NO EXCEPTIONS!**

Fire Safety

Only registered students and approved guests are permitted to stay overnight in our facility. To ensure optimal fire safety for all individuals in our Centre, students are required to sign in and out of the log book located in the kitchenette. This is a rule from the Fire Marshall's Office and is necessary for staff to account for all residents in the event of an emergency.

For those persons who smudge please note that with the exception of the training rooms, smudging will activate the smoke detectors. You are encouraged to smudge in the large training room.

First Aid

In case of emergency, should a First Aid attendant be required during office hours, please contact the Trainer or main Nechi reception. After hours, please dial 911. A First Aid kit is located in the Nechi Kitchenette as well in room #211.

Smoking

Due to provincial bylaws, smoking is not permitted anywhere inside the Centre. There is a designated outdoor smoking area for students across the road from the cafeteria. Please adhere to the designated smoking areas. There is no smoking in front of the main entrance or Nechi residence doors. You must smoke 5 meters (15 feet) from all entrance ways.

Parking

Students can park their vehicles in the parking lot located at the north-east side of the building. During the winter months, plug-ins are available.

The parking lot is unsupervised and parking is at your own risk.

Quiet Times

All students are asked to lower voice tones while the Ceremonial Room is being used.

In consideration of fellow students and Poundmaker's Lodge clients, please be out of the foyer and pit areas by 10:00 p.m.

Smudge Ceremonies for Poundmaker's Lodge clients are held daily, please acknowledge posted signs.

Pipe Ceremonies are held by Poundmaker's Lodge during the week, please acknowledge posted signs.



PREPARING FOR TRAINING

Students are strongly encouraged to reside at our Centre in Sturgeon County. Although not mandatory, feedback suggests students who do, enjoy a greatly enhanced program. Our dorm rooms (single beds) can accommodate 34 students.

Accommodations and meals are offered during program sessions, with payment of all applicable fees. **All students staying in residence will be charged an accommodation fee that includes meals, there are no opportunities to opt out of meal fees when staying in residence.** Nechi supplies all bedding linens, pillow, blankets, quilts and towels to each student. Students are not permitted to bring personal bedding. Students may bring their own toiletries, an alarm clock and a small study lamp (optional).

NOTE: Students are not to remove plates, cups, or utensils from the dining room during or after meals, and abide by set meal schedules.

Assigned Rooms

- Students residing at Nechi will be assigned a room. Please **do not** change or alter the arrangements. Use only rooms provided: i.e. bedrooms and training rooms. Elders and students with special needs will be given consideration in this matter. Exceptions for extenuating circumstances are allowed at the discretion of the Student Services.
- The schedule of cleaning times is posted. For sanitary reasons, as well as convenience to the cleaning staff, we ask students to keep all items, except suitcases, off the floor.
- Do not move or rearrange furniture. No trespassing through your neighbour's room to shortcut to the training room.
- Remember to remove personal items from your room when your session ends. **ALL STUDENTS MUST BE CHECKED OUT OF THEIR ROOMS AFTER BREAKFAST.** This allows the janitorial staff to prepare for the next training set. Students may store their luggage in the Eric Shirt room or in their cars.

Administration

Student Services is available Monday-Friday 10:15 a.m. to 10:30 a.m. and 12:30 p.m. to 1:30 p.m. and 4:00 to 4:15 p.m. for student assistance. Costs for faxing: \$1.00/page or photocopier requests at \$0.25/page, may be directed to your Trainer during break.

Cleanliness

Students are expected to be respectful of the Centre by maintaining cleanliness of ALL training areas: bedrooms, bathrooms, computer lab, laundry room and kitchenette.

Students are assigned cleaning tasks for common areas, i.e. training rooms, kitchen, etc. You are required to immediately return all dirty dishes to the kitchen after use. **Food and drinks are not permitted in the bedrooms and training rooms, or computer lab.**

Personal Property

Students are responsible for their own training material, personal items and valuables. You are encouraged to leave valuables at home. Nechi Institute assumes no responsibility for lost, misplaced, or stolen items.

Dress Code

Students are encouraged to present a professional appearance. Wearing of controversial or inappropriate clothing is discouraged. For safety reasons and in case of fire alarms, shoes must be worn in all public places. Students are asked to dress appropriately as tasks or protocol indicates; i.e. ceremonies (see your Trainer for clarification).

Outside Appointments

To reduce absenteeism, students are encouraged to make all outside prior to or after the training week. Time away to attend to outside appointments results in points and hours being docked for not being present.



INTERN TRAINER DEVELOPMENT

Realizing your full potential sometimes requires you to step outside of the image you created for yourself.

Upon space availability, Nechi is able to sponsor one foreign student per year to attend our training programs. We have trained students from New Zealand, Australia, South Africa, Central America, Sri Lanka and Thailand. Accommodations, tuition, texts and materials will be provided. Students are responsible for their own food, travel, money for incidentals, entertainment, and any other miscellaneous or personal expenses while interning. Applicants are also responsible for securing the appropriate visas.

Applicants will indicate how they will benefit from attending Nechi Institute, and how they will bring the training back to their country and incorporate it into their work. This can be accomplished by way of an essay, phone interview, or audiovisual presentation. Letter(s) of support from their agency, funders, and community members are encouraged. The successful applicant may attend a variety of programs dependent upon our training schedule, travel dates and their approved length of stay in Canada.

For further information regarding this unique training opportunity, contact our Training Department.

The Intern Program at Nechi allows individuals to develop their capacity as trainers.

Applicants wishing to intern at Nechi Institute need to possess basic Trainer/facilitator knowledge and skills, including certificate from CCPC following the completion of the eight-week Community Addictions Training Series (CAT), and the five week Advanced Counsellor Training Series (ACT), and 21 hours Pharmacology Course, which are pre-requisites for CCPC certification. Preferably, applicants have successfully completed Nechi Institute’s four-week Training of Trainers Series (TOT) (or equivalent) to grasp the full concept of facilitating effectively.

Intern Trainers experience training by apprenticing in the CAT and ACT Series with the guidance and role modeling of an experienced Trainer. During the practicum, interns are expected to experience all aspects of training: workshop planning, designing, facilitating, assessing student progress, report writing, etc. Intern Trainer’s progress and evaluation is focused on Trainer and Facilitator competencies similar to those taught in the TOT series. The entire process may take up to two years to complete.

If you are interested in applying as an Intern Trainer with Nechi Institute, please submit your resume and letter of application to the Director of Operations.

TRAINING PROGRAMS & PATHS TO POST SECONDARY CREDIT TRANSFER IS CURRENTLY UNDER REVIEW

Accreditation and Certification

Nechi Institute’s courses are accredited and certified by: National Indigenous Accreditation Board (NIAB), Canadian Addiction Counsellor’s Certification Federation (CACCF), Canadian Council on Professional Certification (CCPC), First Nations Wellness/Addiction Counsellor Certification Board (FNWACCB).

Nechi courses are also accredited through our membership with the Alberta Council on Admissions and Transfers (ACAT) and First Nations Adult Higher Education Consortium (FNAHEC).

*Discussion regarding course transfer and career paths are ongoing, once we receive a formal transfer process, we will be happy to update this page.
Stay tuned!*

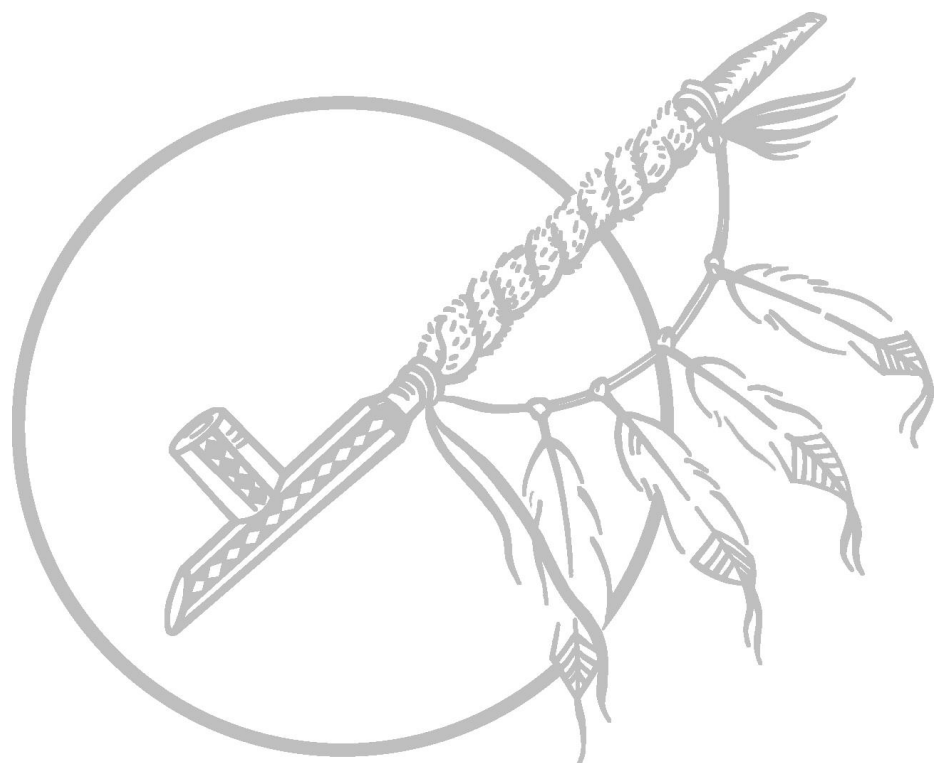

POST-DIPLOMA ARTICULATION AGREEMENTS

Nechi Institute programs are accredited and transferable to many university and college programs. Transfer of credits to post-secondary institutes across Canada is taken on a case-by-case basis when no articulated agreement is present. Currently, Nechi Institute has post-diploma articulation/transfer agreements with the following post secondary institutions:

GRANT MacEWAN COLLEGE, EDMONTON, AB SOCIAL WORK DIPLOMA & ABORIGINAL MENTAL HEALTH DIPLOMA

Students who have completed the Community Addictions Training Certificate (CAT) or the Advanced Counsellor Training Certificate (ACT) are eligible to receive advanced credit toward this diploma program. The Aboriginal Mental Health Diploma Program will receive a maximum of 13 credits.

ATHABASCA UNIVERSITY, ATHABASCA, AB BPA (HUMAN SERVICES)

Students who have completed the Indigenous Addictions Services Certificate (IASC) or the Community Wellness Certificate (CWC) will be granted 30 credits. These students are required to present an additional 30 credits prior to admittance into the program. Students who have completed the Indigenous Addictions Services Diploma Program (IASD) will receive 60 credits.

NICOLA VALLEY INSTITUTE OF TECHNOLOGY, BC SOCIAL WORK

Currently being negotiated.

UNIVERSITY OF LETHBRIDGE, LETHBRIDGE, AB BACHELOR OF HEALTH SCIENCES - ADDICTIONS COUNSELLING PROGRAM (POST - DIPLOMA)

Students who have completed the Indigenous Addictions Services Certificate Program (IASC) will receive a block transfer on a case by case basis in a

five-course qualifying program (Health Sciences 2120 Health Sciences 2245, Psychology 1000, Sociology 1000, and one of Library Science 2000 or Writing 1000) are eligible for admission.

Currently negotiating Diploma (IASD)

BRANDON UNIVERSITY, BRANDON, MB BACHELOR OF FIRST NATIONS AND ABORIGINAL COUNSELLING DEGREE PROGRAM

Students who have completed the Indigenous Addiction Services Diploma Program (IASD) are granted 60 credits. **Currently under negotiation**

BLUE QUILLS FIRST NATIONS COLLEGE Students who have completed the Indigenous Addictions Services Certificate (IASC) will be granted credit toward the Indigenous Social Work Degree Program. **(Second Year under negotiation)**

UNIVERSITY OF CALGARY

Students who have been admitted into the Bachelor of Social Work Degree program at Blue Quills First Nations College may be granted admittance and advanced credit into the Bachelor of Social Work Degree program at the University of Calgary.

Prior Learning Assessment and Recognition (PLAR)

Students wishing to transfer credits, challenge exams, or complete Prior Learning Assessments should consult with the Registrar at the post-secondary institute of their choice regarding minimum grade point average (GPA) and additional credit requirements to determine individual program eligibility.



NECHI COURSES & PROGRAM LISTING

The following programs and their associated courses are conducted by Nechi Institute:

- Advanced Counsellor Training (ACT)
- Community Addictions Training (CAT)
- Community Wellness Certificate (CWC)
- Indigenous Addictions Services Certificate (IASC) Year 1
- Indigenous Addictions Services Diploma (IASD) Year 2
- Training of Trainers (TOT)
- Other specialty courses offered

Under each program heading are listed individual courses that make up the program.

NOTE: *We are currently reviewing IAC and CWC so we will notify you when these courses will be ready for delivery.*

COMMUNITY ADDICTIONS TRAINING CERTIFICATE

Nechi Institute’s Community Addictions Training Certificate (CAT) offers students training in alcohol and drug counselling skills. This program consists of eight courses; each course relates to and builds on skills learned during the previous course.

CAT 1	Communication & Ethics
CAT 2	Addictions
CAT 3	Family Disease
CAT 4	Assessment & Intervention
CAT 5	Treatment
CAT 6	Aftercare
CAT 7	Personal Growth
CAT 8	Prevention

Students attend classes which are 5 and 1/2 days in length and travel to our Centre for a total of eight weeks during a ten-month period. This program is also offered as an eight-week summer session. Pre-requisite is one-year sobriety (if you have a history of addictions).

Nechi Courses and Programs

Each course in CAT is approved for 40 hours study credit by the Canadian Council of Professional Certification. Each course is also approved for 40 hours training by the Canadian Addictions Counselor Certification Federation.

CAT 1: Communication & Ethics

Hours: 40 hours Credits: 3 credits

Course Description:

This course will provide an orientation to training as well as professional and personal ethics related to the role of addictions counselors in communities. Students are provided the knowledge to understand the process of communication.

CAT 2: Addictions

Hours: 40 hours Credits: 3 credits

Course Prerequisite: Completion of CAT1

Course Description:

This course will provide the student with the knowledge to understand the process of addictions for the individual: the symptoms and physical effects of alcohol and drug abuse, and the categories of drugs. Students also receive instruction on the defense mechanisms people employ.

CAT 3: Family Disease

Hours: 40 hours Credits: 3 credits Course

Prerequisite: Completion of CAT1

Course Description:

This course will provide knowledge needed to understand the impact of alcoholism and addiction on all members of the family. Students learn how family members enable the alcoholic to continue to drink and to protect him/her from his/her addiction. Students receive instruction on skill development and time to practice the skills needed to help clients begin stopping the enabling process.

CAT 4: Assessment & Intervention

Hours: 40 hours Credits: 3 credits Course

Prerequisite: Completion of CAT1

Course Description:

Students enrolled in this course will be provided with instruction to develop the knowledge and skills needed to assess the readiness of the alcoholic and family members to enter treatment. Instruction for skill development will be given in the process of recruiting and development of an intervention team and in conducting interventions in communities. Students will be given time to practice their skill development using role-play exercises.

CAT 5: Treatment

Hours: 40 hours Credits: 3 credits Course

Prerequisite: Completion of CAT1

Course Description:

This course will provide instruction to develop knowledge and skills to understand the process of treatment in the community and in a treatment center. Students will also be given instruction to develop an understanding of the need for proper documentation of client interactions and progress.

CAT 6: Aftercare

Hours: 40 hours Credits: 3 credits Course

Prerequisite: Completion of CAT1

Course Description:

This course will provide instruction to develop the knowledge and skills to assist clients to maintain sobriety after leaving a treatment centre. Particular focus is given to strategies and skills to understand and prevent relapse.

Nechi Courses and Programs

CAT 7: Personal Growth

Hours: 40 hours Credits: 3 credits Course

Prerequisite: Completion of CAT1

Course Description:

This course will give the students an opportunity to examine aspects of personal growth related to their own lives as well as those of their clients. Opportunities will be provided to explore a variety of personal growth techniques.

CAT 8: Prevention

Hours: 40 hours Credits: 3 credits Course

Prerequisite: Completion of CAT1

Course Description:

The students will be provided with instruction to develop the knowledge to design a community prevention program for Aboriginal youth. Students will also be part of a team to plan a community development activity within the class.

ADVANCED COUNSELLOR TRAINING CERTIFICATE

Nechi Institute's Advanced Counsellor Training Certificate (ACT) provides advanced skills development and in-depth knowledge in specific areas. The ACT certificate is comprised of five courses; each course relates to and builds upon the previous sessions.

ACT 1	One to One Counselling
ACT 2	Family Dynamics
ACT 3	Group Dynamics
ACT 4	Suicide Prevention & Grieving
ACT 5	Culture & Traditional Values

Students attend courses which are 6 and 1/2 days in length and travel to our Centre for a total of five weeks during a five-month period. Pre-requisite is one-year sobriety (if you have a history of addictions) and successful completion of the CAT Series.

Each course in ACT is approved for 45 hours study credit by the Canadian Council of Professional Certification.

ACT 1: One to One Counselling

Hours: 45 hours Credits: 3 credits

Course Prerequisite: CAT Certificate

Course Description:

This course will give students an understanding of human development (life cycle), with increased knowledge and appropriate skills to become a more effective counselor. Students will also be given class time to practice their one to one counseling skills.

ACT 2: Family Dynamics

Hours: 45 hours Credits: 3 credits

Course Prerequisite: CAT Certificate

Course Description:

This course will provide students with instruction on theories of complex family dynamics. There will be ample class time allotted to practice observation skills through role-play exercise.

ACT 3: Group Dynamics

Hours: 45 hours Credits: 3 credits

Course Prerequisite: CAT Certificate

Course Description:

This course will provide instruction to help students understand how groups function. Observation of the training group itself during the week of training enhances the learning process.

Nechi Courses and Programs

ACT 4: Suicide Prevention & Grieving

Hours: 45 hours Credits: 3 credits

Course Prerequisite: CAT Certificate

Course Description:

The first part of the week will provide instruction on the symptoms of suicide and the skill development needed to conduct client assessments. Students will also practice conducting suicide assessment interviews in role-play exercises. The second part of the week focuses on the grieving process, working through the grieving process and counseling a grieving client.

ACT 5: Culture & Traditional Values

Hours: 45 hours Credits: 3 credits

Course Prerequisite: CAT Certificate

Course Description:

This course provides students with an opportunity to examine their own values and beliefs about traditional culture and spirituality. Students will have opportunities to participate in traditional spiritual ceremonies.

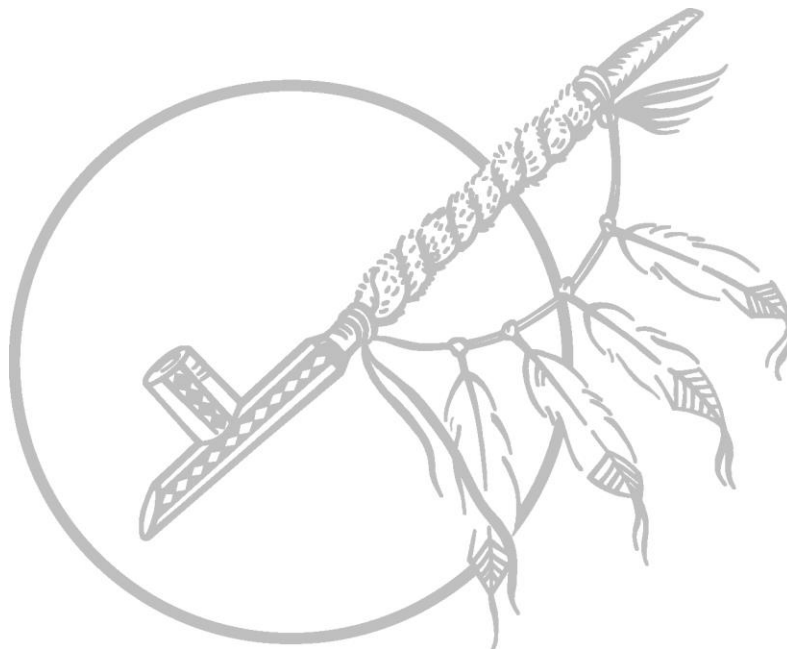
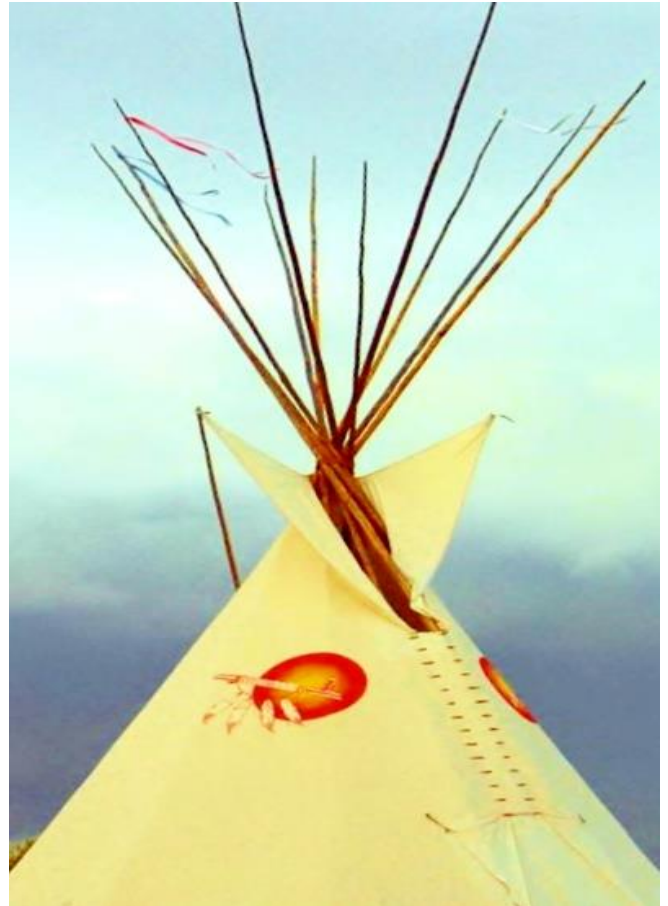

Nechi Courses & Programs

TRAINING OF TRAINERS CERTIFICATE

The content of the program focuses on issues such as communication, the development of a safe learning environment, course design, needs assessment, adult learning theory, experiential learning methods, preparation of learning objectives, group dynamics/group facilitation skills (including dealing with problem behaviours), and evaluation of learning. Training is comprised of 4 Series:

- TOT 1: Exploring Training Elements
- TOT 2: The Training Cycle
- TOT 3: Facilitation Process
- TOT 4: Master Plan Competencies

Hours: 40 hours

Course Prerequisite: None

Each course builds on the next to ensure that all four modules are progressive and designed to provide effective training for facilitators. If a student misses one module, they will have to redo the entire training series.

Course Description:

These courses provide students with the opportunity to develop the knowledge, skills, and awareness needed to effectively design and lead training activities in

Aboriginal organizations and communities. Past graduates are now trainers within their sponsoring organizations or are private contractors and consultants.

The content of the program focuses on issues such as communications, the development of a safe learning environment, course design, needs assessment, adult learning theory, experiential learning methods, preparation of learning objectives, group dynamics/group facilitation skills (including dealing with problem behaviours) and evaluation of learning.



Nechi Courses and Programs

INDIGENOUS ADDICTIONS SERVICES CERTIFICATE/DIPLOMA

This new two (2) year diploma program is designed to provide students with an excellent academic addictions diploma and/or the credentials needed to pursue further post-secondary education opportunities.

Course pre-requisites include:

- High school diploma with a grade of 50% in English 30-1 or 65% in English 30-2 or equivalent
- Mature admission available for those over 21 who pass an English Equivalency Exam*

Year 1 – 10 Courses 39 hours each + Seminars

IASC 1001	Colonization, Decolonization and Healing
IASC 1002	Communication and Ethics I
IASC 1003	Human Development I
IASC 1004	Health Inclusion: Across the Life Span
IASC 1005	Physiology & Pharmacology of Drugs & Alcohol
IASC 1006	Referral & Assessment
IASC 1007	Supportive Counseling Interventions
IASC 1008	Treatment Planning
IASC 1009	Case Management & Record Keeping
IASC 1010	Harm Reduction & Aftercare

Year 2 – 10 Courses 39 hours each and 1 Practicum

IASD 2001	Communications & Ethics II
IASD 2002	Concurrent Disorders
IASD 2003	Legal Advocacy
IASD 2004	Addictions, Mental Health and FASD
IASD 2005	Family and Addictions
IASD 2006	Group Counseling
IASD 2007	Grief & Loss
IASD 2008	Crisis Intervention
IASD 2009	Introduction to Health Promotion
IASD 2010	Evaluation of Community Based Programs (12 weeks)

YEAR ONE

IASC 1001: Colonization, Decolonization and Healing

Hours: 39 hours Credits: 3 credits

Course Prerequisites Required

Course Description:

This course will examine through an Indigenous pedagogical framework the historical process of colonization, decolonization and healing. Students will research and explore decolonization methodologies throughout the world and assess contemporary issues in the healing process. Students will examine the meaning and impacts of colonization, decolonization, cultural survival, community and nation rebuilding.

IASC 1002: Communication and Ethics I

Hours: 39 hours Credits: 3 credits

Course Prerequisites Required

Course Description:

This course examines the importance of ethical communication and techniques for the inclusion of effective communication skills for addiction counsellors. The course emphasizes the contextual realities of Indigenous peoples, and identity in relation to communication and ethics. Students will also review Indigenous responsibilities and practices (cultural protocols) as an approach for empowerment and health.

IASC 1003: Human Development I

Hours: 39 hours Credits: 3 credits

Course Prerequisites Required:

Course Description:

This course is designed to introduce students to Principles of Human Development from both an Indigenous and Western framework. Within the Indigenous learning experiences, students will review traditional teachings on Human Development or what it means to be human. From a Western perspective students will learn about western theoretical perspectives and how these impact current practice in an addictions counseling setting.

Nechi Courses and Programs

IASC 1003: Human Development I

Continued:

Applications drawn from both theoretical frameworks will be reviewed and practiced through experiential and hands on learning opportunities. Assignments will be based on these experiences and students will be encouraged to develop a practice model that considers the client's worldview and conditions for enhancing their growth and development as individuals in early recovery from an addictive lifestyle.

IASC 1004: Health Inclusion: Across the Lifespan

Hours: 39 hours Credits: 3 credits

Course Prerequisites Required

Course Description:

The course will examine how colonization has affected our Indigenous populations by stigmatizing and marginalizing various sectors of the population. In particular it will review restorative healing methods utilizing Indigenous values of social responsibility and care for people within our circle.

Indigenous and Western best practices related to prevention, intervention and healing will be explored in the context of the aftermath of colonization and its impact on Indigenous populations. Active Addiction; Concurrent Disorders; Fetal Alcohol Spectrum Disorder; HIV/AIDS; Hepatitis C; grief and loss and other issues currently facing our communities will be examined in this course.

Through simulated practice experiences students will become familiar with specific resources to respond appropriately to client needs. Students are expected to demonstrate that their counseling is guided by relevant (population specific) principles and processes, that their selection and use of theory, models and frameworks is appropriate, and that their relationships reflect qualities suitably responsive to the needs, preferences and best interests of their clients.

IASC 1005: Physiology and Pharmacology of Drugs and Alcohol

Hours: 39 hours Credits: 3 credits

Course Prerequisites Required

Course Description:

This course will examine the pharmacology of current drugs of abuse, including their classification and effects. Students will have a basic understanding of the pharmacology of psychoactive drugs. The topics will include: a review of how addictions become another tool in the process of colonization; basic principles of pharmacology; pharmacokinetics; tolerance and dependence; dependence liability; therapeutic and toxic effects of specific psychoactive drugs. Alcohol - specific signs and symptoms as indicated by assessment is covered as well.

Students will also learn pharmacological terms and concepts to conduct effective assessment, counseling, treatment and make appropriate referrals.

IASC 1006: Referral and Assessment

Hours: 39 hours Credits: 3 credits

Course Prerequisites Required

Course Description:

This course will broaden the students understanding of the assessment and treatment of addictions within Indigenous individuals, families and communities within the historical context of colonization with a more specific focus on multi-generational trauma.

The course will explore past and current practices related to principles of effective screening and assessment, including a broad range of western and holistic assessment instruments and procedures. Practice simulations are used extensively to integrate the process and principles and prepare the students to apply them in Indigenous treatment centers and communities.

Nechi Courses and Programs

IASC 1007: Supportive Counselling Interventions

Hours: 39 hours Credits: 3 credits

Course Prerequisites Required

Course Description:

This course will explore Traditional Indigenous methods of healing, as well as explore contemporary counseling best practices. The students will develop counseling techniques and skills to work with clients who are in the process of recovering from addictions and/or experiencing mental health issues. Students will examine relapse prevention models and also learn about the stages of recovery, how to identify the warning signs of relapse and how to assist clients in developing a relapse prevention plan. Students will develop skills to engage clients and family members in traditional teachings and healing practices based on mutually agreed upon goals and expectations of the counseling intervention process. Students will also engage in facilitating appropriate referrals and services when planning with a client.

IASC 1008: Treatment Planning

Hours: 39 hours Credits: 3 credits

Course Prerequisites Required

Course Description:

This course will enable the students to learn effective treatment practices and demonstrate the ability to evaluate, problem solve, set goals, and negotiate treatment plans with clients. In addition, the student will develop the skills to create effective client-counsellor contracts and action plans, including individualized treatment plans, evaluation, and management of treatment and or services using both Western and Indigenous practices. Furthermore, the students will be able to identify and utilize natural helping systems to facilitate counseling processes, effective resource utilization, client advocacy, involvement of family, community, and other support networks.

IASC 1009: Case Management & Record Keeping

Hours: 39 hours Credits: 3 credits

Course Prerequisites Required

Course Description:

This course is intended to enable students to manage a caseload and fulfill the functions, roles, referrals and expectations associated with the administration of the agency's substance abuse program(s). The student will be able to work within the policies, programs and regulations of the treatment setting, with a working knowledge of the community social services network, and the ability to engage in constructive working relationships with treatment teams. Provision of educative and treatment services for family members, record keeping, and demonstrating an understanding of the professional addiction counselor's mandate, competencies and boundaries are goals of this course.

IASC 1010: Harm Reduction & Aftercare

Hours: 39 hours Credits: 3 credits

Course Prerequisites Required

Course Description:

This course explores the enduring process of managing recovery and aftercare. Students will be introduced to a range of theories and models to better understand the process of change for individuals, families and communities, and how effective after-care strategies contribute to the healing, empowerment and growth of communities struggling with addiction as a product of multigenerational trauma. The students will examine harm reduction policies and programs and research harm reduction strategies both nationally and internationally. The students will also look at current benefits and challenges in harm reduction programs compared to traditional abstinence based models.

Nechi Courses and Programs

YEAR TWO

IASD 2001: Communications & Ethics II

Hours: 39 hours Credits: 3 credits

Course Prerequisite: IASC

Course Description:

The student will develop effective listening, writing, and presentation skills necessary for positive communication when dealing with colleagues, clients, agency staff, community members, and the general public.

IASD 2002: Concurrent Disorders

Hours: 39 hours Credits: 3 credits

Course Prerequisite: IASC

Course Description:

This course will provide students with a basic understanding of dual diagnosis or concurrent disorders and explore knowledge, skills and strategies to help people living with both mental health and addictions issues.

IASD 2003: Legal Advocacy

Hours: 39 hours Credits: 3 credits

Course Prerequisite: IASC

Course Description:

This course will provide students with a basic understanding of the relevant legal contexts concerning mental health and addictions services for Indigenous peoples. Legal procedures and protocols for sharing information with other service providers and Professional liability issues will be discussed. Relevant Federal and Provincial Legislation and Acts will be reviewed in order to provide students with knowledge of advocacy and how it can assist clients with getting the services that they need.

IASD 2004: Addictions, Mental Health, Fetal Alcohol Spectrum Disorders

Hours: 39 hours Credits: 3 credits

Course Prerequisite: IASC

Course Description:

This course will examine current addiction, mental health and fetal alcohol spectrum disorders and the

relationship between these disorders. It will also explore the role of the addictions worker in the assessment, intervention and prevention of these disorders and examine the impact these disorders have had on individuals, families and communities, in particular, Indigenous people of Canada.

IASD 2005: Family and Addictions

Hours: 39 hours Credits: 3 credits

Course Prerequisite: IASC

Course Description:

Family counseling techniques strategies of balancing needs, facilitating family interactions and decision-making procedures are discussed. Effective models for working with substance abuse in the family and structural family therapy approaches will be studied. Skills in understanding the interrelationship between family systems, dependency and drug usage will be developed by the student. Students will also examine the multi-generational effects of the Residential School System on the family system.

IASD 2006: Group Counselling

Hours: 39 hours Credits: 3 credits

Course Prerequisite: IASC

Course Description:

This course will provide students with a basic understanding of group counseling processes. Students will learn how to integrate Indigenous and mainstream approaches in conducting and evaluating meaningful group processes. The students will explore different group counseling approaches, group process theories, roles of the group facilitator and resolving conflict within the group.



Nechi Courses and Programs

IASD 2007: Grief and Loss

Hours: 39 hours Credits: 3 credits

Course Prerequisite: IASC

Course Description:

This course will look at a holistic approach and the effects of grief and loss on the physical, emotional, mental and spiritual well-being of human beings. Students will examine historical and cultural perspectives of grief and loss as it relates to Indigenous peoples. A number of grief and loss theories will be examined including cultural loss, attachment issues, suicide and how these issues are related to Indigenous peoples with mental health and addictions issues. Various approaches to dealing with grief and loss issues will be discussed.

IASD 2008: Crisis Intervention

Hours: 39 hours Credits: 3 credits

Course Prerequisite: IASC

Course Description:

The content of this course provides an overview of crisis intervention strategies and possible outcomes experienced by individuals who face mental health and/or addictions. The course will examine different approaches and theories in crisis intervention. The students will review a number of case studies and activities to assist them with developing and enhancing their skills in crisis intervention.

IASD 2009: Introduction to Health Promotion

Hours: 39 hours Credits: 3 credits

Course Prerequisite: IASC

Course Description:

This course will emphasize knowledge, skills and attitudes conducive to increasing potential for wellness and health. Activities directed towards increasing the overall level of well-being and actualizing the health potential of individuals, families, groups, and communities in general will be examined.

In today's world there is an increasing need for a positive, constructive approach to health and wellness. There is a general shift in people's priorities in health

care because they are recognizing the benefits of living a healthy lifestyle. They are recognizing the connection between the mind/body/spirit and engaging more in health enhancing behaviors, which not only impact on the body, but also on the attitudes which create a better framework for wellness or healing.

IASD 2010: Evaluation of Community Based Programs

Hours: 39 hours Credits: 3 credits

Course Prerequisite: IASC

Course Description:

The study of the model of community development will precede the introduction of skills necessary to understand the principles of program evaluation. The course will provide basic tools in the evaluation of community based programs to aid in making administrative decisions in terms of operational and organizational issues. Students will explore options to address various risk factors and compare the impact of different social and ecological factors in community development. Students will develop knowledge and skills for social change, prevention, community facilitation and education.

IASD 2011: Year 2 Practicum

Hours: 420 hours Credits: 3 credits

Course Prerequisite: IASD

COURSE DESCRIPTION:

Students will demonstrate competency of the acquired theory from the classroom and practice this theory in the workplace.

This competency, as well as a demonstrated understanding of the link between all courses and the practicum will be articulated in the learning journal kept during the practicum as well as throughout the program.

Nechi Specialty Courses

SPECIALTY COURSES

Aboriginal Peoples and Communities (APC)

Course Description:

The purpose of the Aboriginal Peoples and Communities is to help AHS Employees and Government Funded Agencies explore their knowledge of Indigenous history and contemporary cultures in order to better understand how to work with Indigenous Peoples and Community.

Adult Children of Alcoholics (ACOA)

Course Description:

This five-day course explores the impact of growing up around unhealthy behaviours or addictions. It will enhance your relationships and enrich your recovery.

Beyond Trauma and Abuse (JHH)

Course Description:

Nechi Institute is proud to present Beyond Trauma and Abuse course for men or women. This course will benefit you, your family, and your community.

Fetal Alcohol Spectrum Disorders (FASD)

Course Description:

This dynamic comprehensive course is for caregivers, family members, frontline workers, advocates, and those affected by this diverse disorder. Topics include identifying resources, communicating the importance of diagnosis, promoting prevention, educating your community, and developing support networks.

Gambling Awareness: Treatment and Recovery Issues (GA)

Course Description:

This relevant, much-needed program is specifically for those seeking to help others cope with this potentially devastating addiction. Students are asked to refrain from engaging in gambling activities in an effort to increase awareness of gambling addictions.

Group Facilitation (GF) *

Course Description:

This unique course provides participants with the opportunity to develop the knowledge, skills and awareness required to effectively facilitate groups in Aboriginal organizations and communities.

Indigenous Smoking Cessation Training

Course Description:

This five-day course covers four modules: traditional tobacco, commercial tobacco, tobacco prevention, and tobacco control strategies. The Peer Educator component will provide skills to assist community advocates to conduct brief interventions with documented research resource material founded on cultural principles.

Our Spirit Survived (OSS): Healing from Residential School

Course Description:

The goal of this course is to establish an objective or cognitive understanding of the history and legacy of the residential school experience in Canada. Students will explore the impacts of the residential school on the lives of Aboriginal individuals, families and communities, and the importance for survivors to grieve and cope with loss.

Pharmacology (PHARM)

Course Description:

This three-day (21 hour) course introduces students to a basic understanding of the role of pharmacology in the addictions field. It is accredited through CACCF and is used for the CACCF exam and testing requirements for the International Addiction Counselor Certification.

Youth Tobacco Cessation (YTC)

Course Description:

This course will focus on the necessary skills and techniques required to educate youth on the consequences of nicotine use and addiction. A variety of tools will be employed, such as the "Ditch the Spit" on-line module and the Nechi Tobacco Projects kit.

Nechi Specialty Courses

YOUTH WORKER TRAINING SERIES

Nechi Institute and the Association of Youth Solvent Addictions Committee (YSAC) partnered for the purpose of developing and delivering curriculum to meet the need for training in the area of youth and addictions.

- 1. Communicating With Youth (CWY)
- 2. Youth Addictions (YA)
- 3. Survival Skills for Youth Workers (SSYW)
- 4. Healthy Sexuality (HS)

These courses are approved for 40 hours study credit by the Canadian Council of Professional Certification.

Communicating with Youth (CWY)*

Course Description:

Students will advance their abilities to overcome barriers to effective listening, communicate with resistant youth, effectively apply the Awareness Wheel Model, and utilize greater problem solving techniques.

Youth Addictions (YA)*

Course Description:

This course will provide students with general knowledge in the area of youth development and growth and introduce the students to youth alcohol, drug and inhalant use and addiction. Students will learn to identify the impact of alcohol, drug and inhalant use and addiction on the normal development of youth.

Survival Skills for Youth Workers (SSYW)*

Course Description:

When students complete this program they will gain the ability to establish boundaries, intervene effectively, negotiate, enhance self-esteem, and manage reactive behaviours.

Healthy Sexuality (HS)*

Course Description:

Students will benefit from this respectful and effective workshop where sexuality is presented in a safe, non-threatening environment. During this course the student will explore and have an understanding of healthy sexuality, learn traditional teachings, foster trust, and experience confidential and safe disclosure.





APPLICATION CHECK LIST

ACT, CAT, TOT & Specialty Programs:

One (1) year sobriety
(if you have a history of addictions)

Completed application form

Confirmation of attendance one (1) week
prior to class start

Paid Program & Textbook Fees one (1)
week prior to program start date

ACT Certificate

One (1) year sobriety
(if you have a history of addictions)

Completed application form

Confirmation of attendance one (1) week
prior to class start

Completed interview questionnaire

IASC/IASD

One (1) year sobriety
(if you have a history of addictions)

Completed Nechi Institute application
form

Sent High School transcripts

Contact the Nechi Director of Training
to arrange for CWC Interview

Confirmation of attendance one (1)
week prior to class start

Paid Program & Textbook Fees one (1)
week prior to program start date

Eighteen (18) years or older

**Fax completed application form to:
780.458.1883**



APPLICATION FOR ADMISSION

PROTECTING PERSONAL INFORMATION

Nechi Institute: Centre of Indigenous Learning ("NECHI") is committed to compliance with the laws of Canada and Alberta respecting the privacy of personal information. The personal information you provide in this application form is collected by Nechi for authorized purposes including admission and registration; administration of records, scholarships and awards, student services; alumni relations and fundraising; and Institute planning and research. Some of the personal information collected will be disclosed to sponsoring and funding agencies that require reporting on the students they fund. In addition, Nechi may disclose your personal information: when required to do so by law, and to a public authority when, in the judgment of Nechi there appears to be an imminent danger which could be avoided by disclosing the information. By signing this form you are consenting to the collection and use of personal information as set out in the aforementioned manner. If you have questions about the collection, use and disclosure of personal information, please contact the Nechi at 780.459.1884 or mail: P.O. Box 2039, Station Main, St. Albert, AB T8N 2G3.

SECTION A: PERSONAL INFORMATION

PLEASE COMPLETE THE FOLLOWING INFORMATION						Date of Birth and Gender are used in the student records management process to identify and differentiate our students. Failure to provide this information will result in Nechi not being able to properly process your application.			
HAVE YOU PREVIOUSLY APPLIED FOR OR ATTENDED NECHI TRAINING? YES <input type="checkbox"/> NO <input type="checkbox"/>		ARE YOU AN INTERNATIONAL STUDENT? YES <input type="checkbox"/> NO <input type="checkbox"/>		NECHI STUDENT ID (IF KNOWN)		GENDER F <input type="checkbox"/> M <input type="checkbox"/>		DATE OF BIRTH (D/M/YYYY)	
FIRST NAME				LAST NAME				MIDDLE NAME/INITIAL	
HAVE YOU TAKEN OUR TRAINING UNDER ANOTHER NAME? FORMER NAME (if applicable)									
BOX/APT NO./STREET				CITY/TOWN		PROVINCE		POSTAL CODE	
COUNTRY		HOME TELEPHONE# ()		WORK TELEPHONE# ()		MESSAGES CAN BE LEFT AT:			
EMAIL:									

INFORMATION COLLECTED BELOW PROVIDES A PROFILE OF NECHI STUDENTS AND NON IDENTIFYING AGGREGATE STATISTICAL DATA FOR FUNDERS.

LAST GRADE OR DEGREE COMPLETED PLEASE INDICATE ONLY ONE <input type="checkbox"/> ELEMENTARY (K-6) <input type="checkbox"/> JR. HIGH (7-9) <input type="checkbox"/> SR. HIGH (10-12) <input type="checkbox"/> COLLEGE <input type="checkbox"/> UNDERGRADUATE <input type="checkbox"/> GRADUATE <input type="checkbox"/> PHD		WHAT COURSE ARE YOU APPLYING FOR? PLEASE INDICATE ONLY ONE <input type="checkbox"/> CAT – COMMUNITY ADDICTIONS TRAINING Are you applying for our Summer Session: _____ <input type="checkbox"/> ACT – ADVANCED COUNSELOR TRAINING <input type="checkbox"/> TOT – TRAINING OF TRAINERS <input type="checkbox"/> IASC – INDIGENOUS ADDICTIONS SERVICES CERTIFICATE <input type="checkbox"/> IASD – INDIGENOUS ADDICTIONS SERVICES DIPLOMA <input type="checkbox"/> SPECIALTY COURSE		SPECIALTY COURSES NOT LISTED: Applications are accepted on a first-come, first-served basis provided the application is complete, prerequisites met and full fee submitted. NECHI RESERVES THE RIGHT TO CANCEL ANY COURSE WHEN MINIMUM REGISTRATION LEVEL IS NOT ACHIEVED AND TO MAKE ANY CHANGES TO COURSE CONTENT AS CIRCUMSTANCES REQUIRE. Every reasonable effort will be made to advise students of cancellations before commencement date.	
--	--	--	--	---	--

IMPORTANT: I WILL BE STAYING IN RESIDENCE YES ☐ NO ☐ NOTE: All Accommodation Fees Applicable

*** PLEASE NOTE: ANY TRAINING NOT COMPLETED WITH ONE (1) YEAR OF THE PROGRAM START WILL RESULT IN ADDITIONAL ACCOMMODATION FEES***

ADDITIONAL HERITAGE If you wish to declare that you are of Aboriginal ancestry within the meaning of the Constitution Act of 1982, please indicate ONE ONLY. <input type="checkbox"/> STATUS INDIAN (FIRST NATION) <input type="checkbox"/> NON-STATUS INDIAN <input type="checkbox"/> BILL C-31 <input type="checkbox"/> METIS <input type="checkbox"/> INUIT <input type="checkbox"/> OTHER _____		BAND NAME TREATY AREA _____		HOW DID YOU FIRST HEAR ABOUT NECHI? <input type="checkbox"/> FRIEND/RELATIVE <input type="checkbox"/> NEWSPAPER AD <input type="checkbox"/> POSTER/FLYER <input type="checkbox"/> RESOURCE PERSON <input type="checkbox"/> INFORMATION PACKAGE <input type="checkbox"/> INTERNET/EMAIL <input type="checkbox"/> OTHER _____	
--	--	---------------------------------------	--	--	--

PLEASE READ BEFORE SIGNING THIS APPLICATION:

I, the applicant, consent to the collection and use of personal information as stated in Protecting Personal Information above. **I UNDERSTAND THAT ONE OF THE CONDITIONS OF MY ADMISSION TO NECHI IS MY AGREEMENT THAT I WILL ABSTAIN FROM THE USE OF ALCOHOL AND ILLICIT DRUGS FROM THE TIME OF MY ADMISSION TO THE COMPLETION OF MY COURSE.** NOTE: If you are in RECOVERY there is a one (1) year sobriety requirement prior to taking training.

SIGNATURE OF APPLICANT	DATE OF APPLICATION
------------------------	---------------------

*****IMPORTANT INFORMATION – PLEASE READ BEFORE PROCEEDING*****

NOTE: SECTION A – PERSONAL INFORMATION AND SECTION B – SPONSOR & EMPLOYMENT INFORMATION MUST BE COMPLETED.

SECTION C – PERSONAL HISTORY FOR APPLICANTS MUST BE COMPLETED.

SECTION B

All students are assessed a fee for textbooks and graduation. An agreement regarding these fees and travel costs should be discussed between the sponsoring agency and the applicant.

EMPLOYER OR SPONSORING AGENCY	SUPERVISOR/CONTACT	
BOX/STREET ADDRESS	PROVINCE	POSTAL CODE
PHONE ()	FAX ()	
LENGTH OF APPLICANTS EMPLOYMENT AT PRESENT AGENCY/ORGANIZATION		
APPLICANT'S EMPLOYMENT POSITION/TITLE		

THIS SECTION TO BE COMPLETED BY THE AUTHORIZED REPRESENTATIVE OF THE SPONSORING AGENCY

<p>Is this applicant</p> <p>1. A Volunteer? YES <input type="checkbox"/> NO <input type="checkbox"/></p> <p>2. A Counsellor? YES <input type="checkbox"/> NO <input type="checkbox"/></p> <p>3. In a Management Position? YES <input type="checkbox"/> NO <input type="checkbox"/></p> <p>4. Entitled to receive the T22A? YES <input type="checkbox"/> NO <input type="checkbox"/></p> <p><i>For the purposes of taxation, all funders are required to respond to #4.</i></p>	<p>Total Volunteer Hours Completed</p> <p>_____</p>
---	---

PLEASE READ BEFORE SIGNING THIS APPLICATION

I, the Sponsor/Employer, agree to sponsor the applicant for Nechi Training. If the applicant is accepted into Nechi Training, I agree to accept financial responsibility for tuition, books, accommodation fees, and travel costs associated with the training for the student unless the applicant and this agency have another agreement in place.

AUTHORIZED AGENT (PRINT CLEARLY):	AUTHORIZED AGENCY SIGNATURE (PRINT NAME):	
DATE	FOR OFFICE USE ONLY	

NOTE: Payment for this applicant must be received by our office prior to the commencement of training. Once payment has been received, the student will be notified via telephone by Student Services of their confirmed start date!

*****IMPORTANT INFORMATION – PLEASE READ BEFORE PROCEEDING*****

It is your responsibility to ensure all requested information is supplied.
Incomplete applications will not be accepted for consideration by our Selection Committee.

SECTION C
PERSONAL HISTORY FOR ALL APPLICANTS

PLEASE DESCRIBE YOUR HISTORY WITH ADDICTIONS.

DO YOU HAVE ANY EXPERIENCE IN THE FIELD OF ADDICTIONS COUNSELLING, HUMAN SERVICES OR MANAGEMENT? IF SO, PLEASE PROVIDE DETAILS.

ARE YOU EMPLOYED? DESCRIBE YOUR EMPLOYMENT SITUATION AND HOW YOU THINK NECHI TRAINING WILL ASSIST YOU PERSONALLY OR PROFESSIONALLY?

HAVE YOU TAKEN ANY ADULT EDUCATION COURSES? IF YES, PLEASE PROVIDE DETAILS.



Nechi Institute: Centre of Indigenous Learning
PO Box 2039 Stn Main
St. Albert, Alberta
Canada T8N 2G3

