

REINFORCING BAR SCHEDULE

(4 SPAN CONTINUOUS UNIT 3, SPANS H THRU K)

BAR	NO.	SIZE	TYPE	LENGTH	WEIGHT
* A1	754	5	STR.	40'-11"	32178
A2	754	5	STR.	40'-11"	32178
* B1	261	6	STR.	27'-4"	10715
* B2	156	6	STR.	51'-0"	11950
B3	369	5	STR.	26'-10"	10327
* B30	87	4	STR.	25'-11"	1506
* B31	58	4	STR.	20'-0"	775
* B32	29	4	STR.	28'-0"	542
* B33	58	4	STR.	27'-5"	1062
B34	352	5	STR.	52'-11"	19428
* C1	2	5	STR.	40'-11"	85
* J1	80	4	8	1'-5"	70
* K1	8	8	2	25'-4"	541
* K2	8	8	1	14'-9"	315
* K3	12	6	STR.	10'-1"	182
K4	36	4	STR.	17'-9"	427
K5	36	4	STR.	7'-1"	170
K6	72	4	STR.	10'-1"	485
K7	4	6	STR.	40'-11"	246
* S1	48	5	3	6'-1"	305
S2	48	4	6	2'-7"	83
S3	432	4	5	2'-9"	794
S4	12	5	4	3'-7"	45
U1	18	4	7	8'-11"	107
* U2	72	4	2	14'-10"	713

TOTAL REINFORCING STEEL	(LBS.)	60945
* TOTAL EPOXY COATED REINFORCING STEEL	(LBS.)	64290

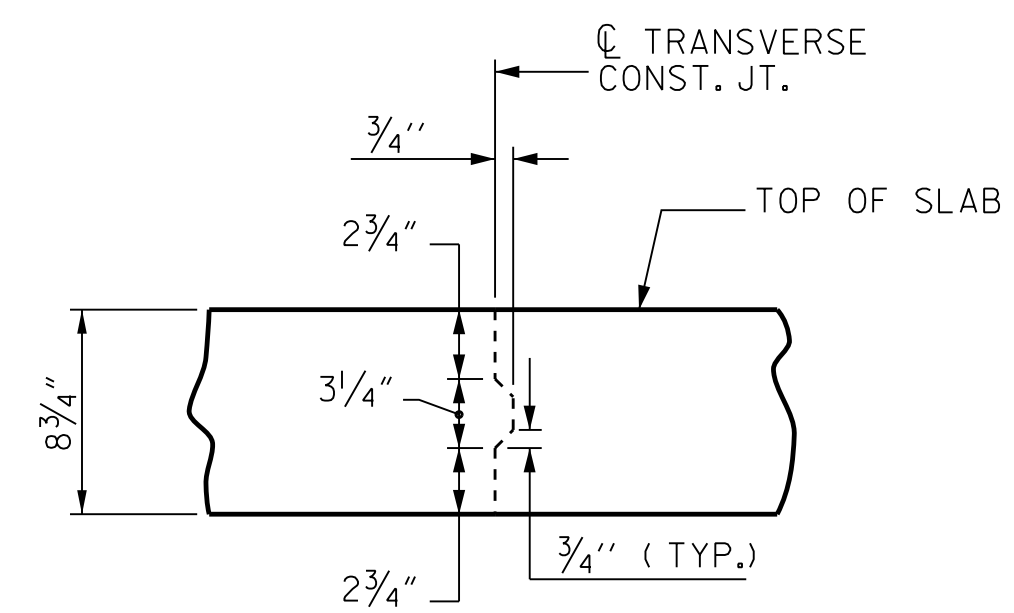

TRANSVERSE CONSTRUCTION JOINT DETAIL

NOTE: REINFORCING STEEL IN SLAB NOT SHOWN. LONGITUDINAL REINFORCING STEEL SHALL BE CONTINUOUS THRU JOINT

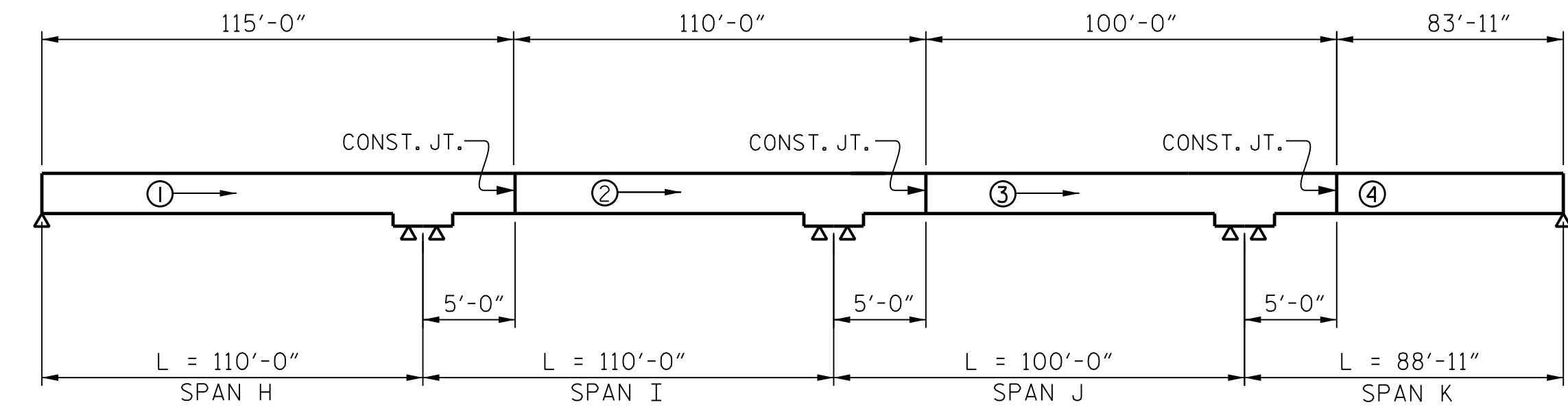

POURING SEQUENCE (UNIT 3)

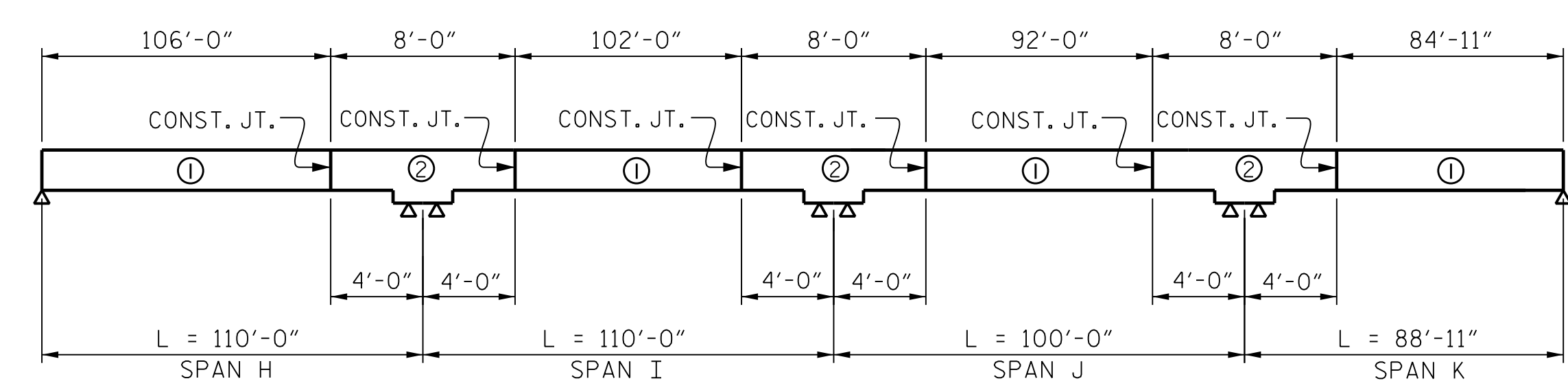

OPTIONAL POURING SEQUENCE (UNIT 3)

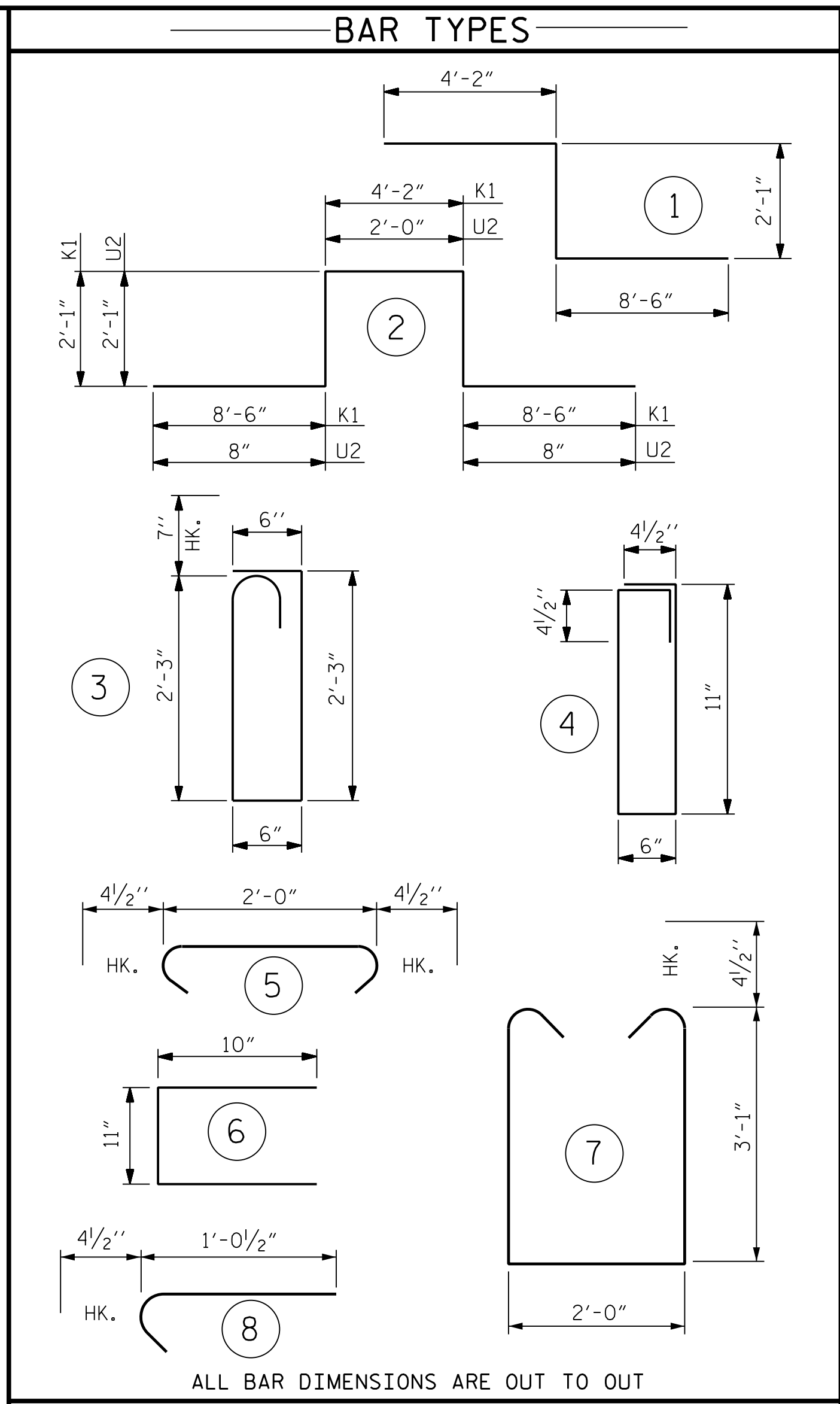

ALL BAR DIMENSIONS ARE OUT TO OUT

SUPERSTRUCTURE BILL OF MATERIAL

	CLASS AA CONCRETE (CU. YDS.)	REINFORCING STEEL (LBS.)	EPOXY COATED REINFORCING STEEL (LBS.)
POUR 1	175.6		
POUR 2	167.1		
POUR 3	153.2		
POUR 4	118.6		
TOTALS**	614.5	60945	64290

**QUANTITIES FOR BARRIER RAIL ARE NOT INCLUDED

PROJECT NO. R-2514B
 ONSLOW/JONES COUNTY
 STATION: 173+54.46 -L-

SHEET 3 OF 3

SUPERSTRUCTURE REINFORCING STEEL LENGTHS ARE BASED ON THE FOLLOWING MINIMUM SPLICE LENGTHS

BAR SIZE	SUPERSTRUCTURE EXCEPT APPROACH SLABS, PARAPET, AND BARRIER RAIL		APPROACH SLABS		PARAPET AND BARRIER RAIL
	EPOXY COATED	UNCOATED	EPOXY COATED	UNCOATED	
#4	2'-0"	1'-9"	2'-0"	1'-9"	2'-9"
#5	2'-6"	2'-2"	2'-6"	2'-2"	3'-5"
#6	3'-0"	2'-7"	3'-10"	2'-7"	4'-4"
#7	5'-3"	3'-6"			
#8	6'-10"	4'-7"			

G:\CKE Projects\CKE_R2514B Onslow Jones Co\Structures\Site 4\NR-2514B_SD_04_BOM_03.dgn 2/3/2015 7:09:47 PM CKE_R2514B_PDF_full.plt:cfgr R2514B_str.tbl

ASSEMBLED BY : M. HOGAN	DATE : 01/14
CHECKED BY : R. COFFMAN	DATE : 07/14
DESIGN ENGINEER OF RECORD : P. HOLSHOUSER	DATE : 10/14
DRAWN BY : JMB 5/87	REV. 8/16/99 RWW/LES
CHECKED BY : SJD 9/87	REV. 5/1/06 TLA/GM
	REV. 10/1/11 MAA/GM

DocuSigned by:
Paul R. Holdseuer
1C6F948FEC44D... 2/3/2015

STATE OF NORTH CAROLINA
 DEPARTMENT OF TRANSPORTATION
 RALEIGH

**STANDARD
 SUPERSTRUCTURE
 BILL OF MATERIAL
 (LEFT LANE)**

REVISIONS						SHEET NO.
NO.	BY:	DATE:	NO.	BY:	DATE:	
1			3			54-44
2			4			TOTAL SHEETS 75

THE LOUIS BERGER GROUP, Inc.
 1001 Wade Avenue, Suite 400
 Raleigh, NC 27605-3322
 NC COA No. F-0840

STD. NO. BOM2 STR. #4