



January 8-10



2002 STX SHOOTOUT
@ Compton Family Ice Arena
TEAM GUIDE

University of Notre Dame



2002 BANTAM MINOR STX SHOOTOUT



Friday, January 8 through Sunday, January 10, 2016

GOLD

BLUE

A1. Chicago Mission, IL	B1. CA Wave, CA
A2. Little Caesars, MI	B2. Anaheim Jr Ducks, CA
A3. Chicago Fury, IL	B3. Pittsburgh Pens Elite, PA
A4. Belle Tire , MI	B4. San Diego Gulls, CA
A5. Green Bay Jr Gamblers, WI	B5. Westchester Express, NY

ICE FACILITY CODE

COMPTON FAMILY ICE ARENA	
CFIA Lefty Smith Rink	Lefty
CFIA Olympic Rink	Olympic

FRIDAY, JANUARY 8, 2016

<u>Start</u>	<u>End</u>	<u>Rink</u>	<u>Home</u>	<u>Away</u>
7:30am	9:00am	Olympic	A2. Little Caesars, MI	B2. Anaheim Jr Ducks, CA
7:40am	9:10am	Lefty	A1. Chicago Mission, IL	B1. CA Wave, CA
9:10am	10:40am	Olympic	A5. GB Jr Gamblers, WI	B5. Westchester Express, NY
9:20am	10:50am	Lefty	A3. Chicago Fury, IL	B3. Pittsburgh Pens Elite, PA
10:50am	12:20pm	Olympic	A4. Belle Tire , MI	B4. San Diego Gulls, CA
11:00am	12:50pm	Lefty	College Pre Game Skates	
1:00pm	2:25pm	Lefty	B1. CA Wave, CA	A2. Little Caesars, MI
2:35pm	4:00pm	Lefty	B5. Westchester Express, NY	A1. Chicago Mission, IL
3:00pm	4:30pm	Olympic	B2. Anaheim Jr Ducks, CA	A3. Chicago Fury, IL
4:10pm	5:35pm	Lefty	B4. San Diego Gulls, CA	A5. GB Jr Gamblers, WI
4:40pm	6:10pm	Olympic	B3. Pittsburgh Pens Elite, PA	A4. Belle Tire , MI
7:35pm		Lefty	Univ of Notre Dame	Western Michigan Univ.

SATURDAY, JANUARY 9, 2016

<u>Start</u>	<u>End</u>	<u>Rink</u>	<u>Home</u>	<u>Away</u>
8:00am	9:30am	Lefty	A2. Little Caesars, MI	B5. Westchester Express, NY
8:20am	9:50am	Olympic	A3. Chicago Fury, IL	B1. CA Wave, CA
9:40am	11:10am	Lefty	A4. Belle Tire , MI	B2. Anaheim Jr Ducks, CA
10:00am	11:30am	Olympic	A1. Chicago Mission, IL	B4. San Diego Gulls, CA
11:20am	12:50pm	Lefty	A5. GB Jr Gamblers, WI	B3. Pittsburgh Pens Elite, PA
2:20pm	3:50pm	Lefty	B5. Westchester Express, NY	A3. Chicago Fury, IL
4:00pm	5:30pm	Lefty	B4. San Diego Gulls, CA	A2. Little Caesars, MI
4:10pm	5:40pm	Olympic	B1. CA Wave, CA	A4. Belle Tire , MI
5:40pm	7:10pm	Lefty	B2. Anaheim Jr Ducks, CA	A5. GB Jr Gamblers, WI
5:50pm	7:20pm	Olympic	B3. Pittsburgh Pens Elite, PA	A1. Chicago Mission, IL

SUNDAY, JANUARY 10, 2016

<u>Start</u>	<u>End</u>	<u>Rink</u>	<u>Home</u>	<u>Away</u>
8:00am	9:30am	Lefty	A4. Belle Tire , MI	B5. Westchester Express, NY
8:00am	9:30am	Olympic	A3. Chicago Fury, IL	B4. San Diego Gulls, CA
9:40am	11:10am	Lefty	A2. Little Caesars, MI	B3. Pittsburgh Pens Elite, PA
9:40am	11:10am	Olympic	A5. GB Jr Gamblers, WI	B1. CA Wave, CA
11:20am	12:50pm	Lefty	A1. Chicago Mission, IL	B2. Anaheim Jr Ducks, CA

Locker/Facility Tours**Sunday, Jan. 10**

8:00am	Little Caesars & Pittsburgh Pens Elite
8:20am	Green Bay & CA Wave
9:45am	Belle Tire & Westchester
10:00am	Chicago Fury & San Diego
10:15am	Chicago Mission & Anaheim



COMPTON DIRECTIONS STX SHOOTOUT



From Indiana Toll Road:

Use Exit 77 (South Bend/Notre Dame). Turn right (south) onto SR 933/Bus.31. Go south - at Angela Rd. turn left (east). Go East, turn left (north) onto Joyce Dr. Compton Family Ice Arena is located on the right (Corner of Joyce and Angela). Bus loading/unloading will be at the North/Main Entrance of the arena.

From Indianapolis:

Follow U.S. 31 North. That becomes SR 933/Bus.31 just south of South Bend. Proceed through South Bend and continue north. Turn Right (east) onto Angela Rd. Go east, turn left (north) onto Joyce Dr. Compton Family Ice Arena is located on the right (corner of Joyce and Angela). Bus loading/unloading will be at the North/Main Entrance of the arena.

From O'hare Airport:

Take Route 190 east out of O'Hare to Route 90 east (Kennedy Expressway) toward downtown Chicago. Merges with Route 94 south (Dan Ryan Expressway). Take Skyway exit off the Dan Ryan and remain on Route 90 to Indiana Toll Road. Eventually merges with Route 80. Use Exit 77 (South Bend/Notre Dame).

Notes:

An alternative route: Take Route 190 east out of O'Hare to Interstate 294 south (Tri-State Tollway) and follow the signs for 80/294 and then Interstate 80-90 (Indiana Toll Road). Use Exit 77 (South Bend/Notre Dame).



Map and Parking Information

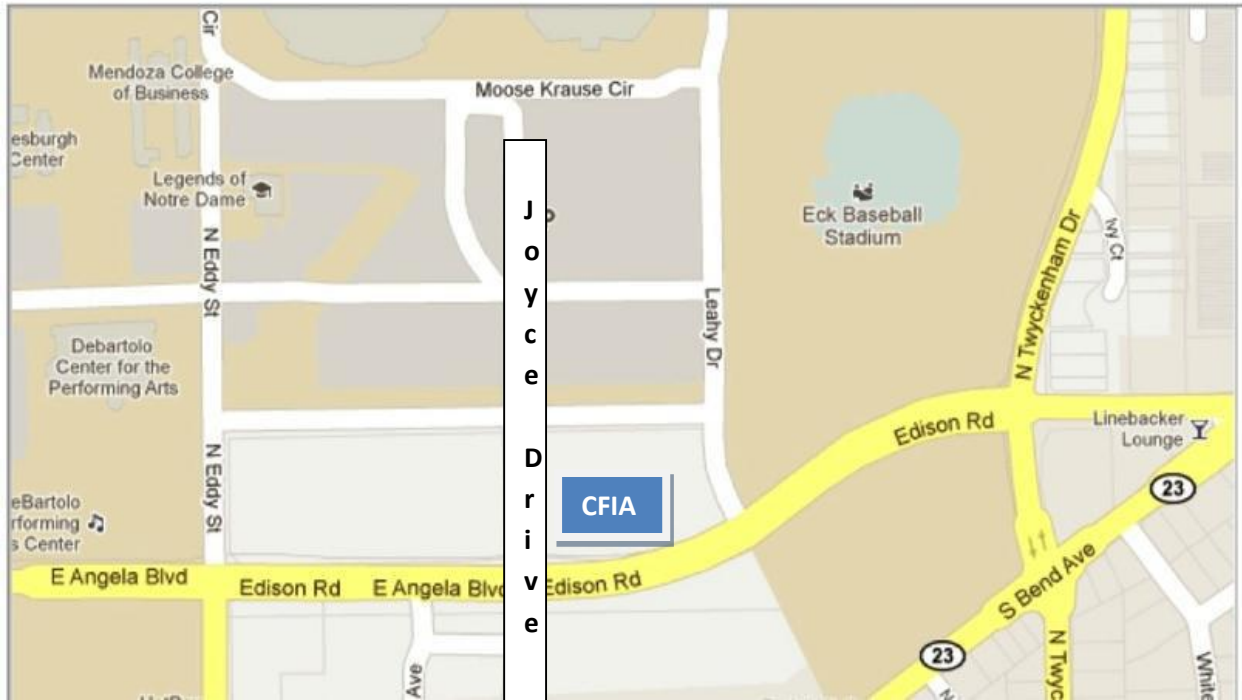

General Parking:

All other Vehicles can park in any of the Joyce Center or Compton Family Ice Arena Lots.



Arena Details



Opened in October 2011, the Compton Family Ice Arena anchors the south edge of campus, adjacent to the Joyce Center and west of the Irish track and field facility. The state-of-the-art arena houses two ice rinks and was designed to support the Notre Dame hockey programs and those in the local community. The facility was made possible by a generous lead gift from Kevin and Gayla Compton, who also own the San Jose Sharks of the National Hockey League (NHL). With its eye-catching, barrel-vaulted roof and bow trusses, the main arena has two levels with a capacity of 5,000—both seated and standing room combined—with the majority of the seats a comfortable, chair-back style. The student section and hockey band seating are located on the west end of both levels. O’Brien’s, the exclusive club for Fighting Irish Hockey games, is located on the upper level, as well as mezzanine level seating and the media center. Open concourses on both levels provide ample standing room.

The Charles W. “Lefty” Smith Jr. Rink, the 200' x 90' playing surface of the main arena, honors the first coach in the Notre Dame hockey program. The Olympic-size rink can be divided into smaller rinks to be used by the Irish Youth Hockey League (IYHL) and support the USA Hockey Athlete Development Model (ADM), figure skating, public skating, and broomball. The building also houses numerous offices, locker rooms, and training facilities.





Arena Map

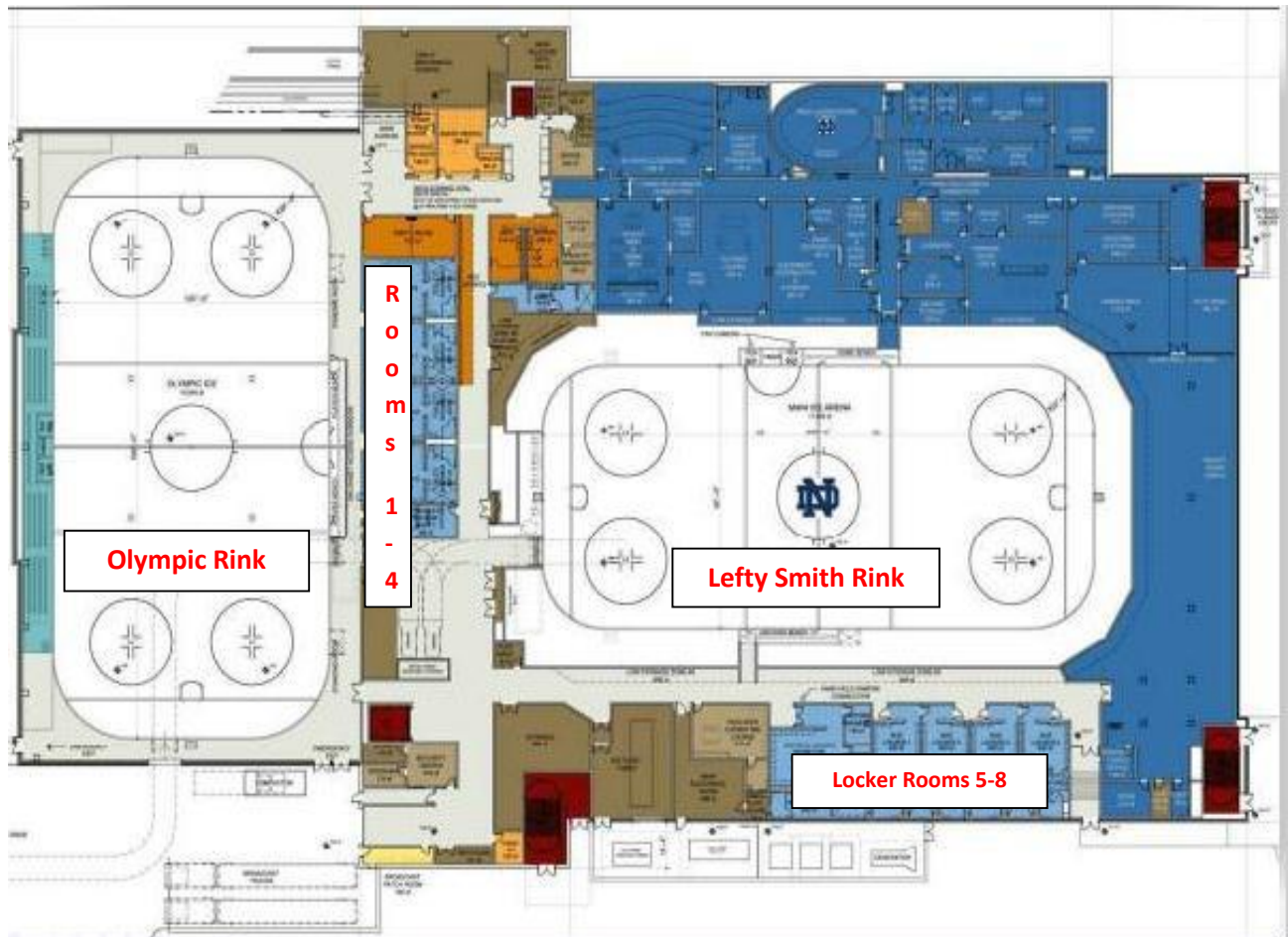



Local Hospitals



Memorial Hospital - Level II Trauma Center

615 N. Michigan St.

South Bend, IN 46601

574-647-1000

www.qualityoflife.org

Directions from CFIA: Turn West (right) onto Angela/Edison from CFIA.

When you get to SR933/Business 31, turn South (left). Travel .7 miles and Memorial Hospital will be on the right.

St. Joseph Regional Medical Center

5215 Holy Cross Parkway (Intersection of Main & Douglas)

Mishawaka, IN 46545

574-335-5000

www.sjmed.com

Directions from CFIA: Turn East (left) onto Angela/Edison from CFIA. When you get to SR-23, turn North (Left). Travel to Douglas Rd., turn East (right).

Travel 1.9 miles. St. Joseph Regional Medical Center will be on the right.

MedPoint

6913 North Main St.

Granger, IN 46530

574-647-1550

Directions from CFIA: Turn East (left) onto Angela/Edison from CFIA. When you get to SR-23, turn North (left). Travel 2.7 miles to Cleveland Rd., turn

East (right). Travel 0.6 miles to Main St, turn South (right). MedPoint will be on the right.



South Bend/Mishawaka Map

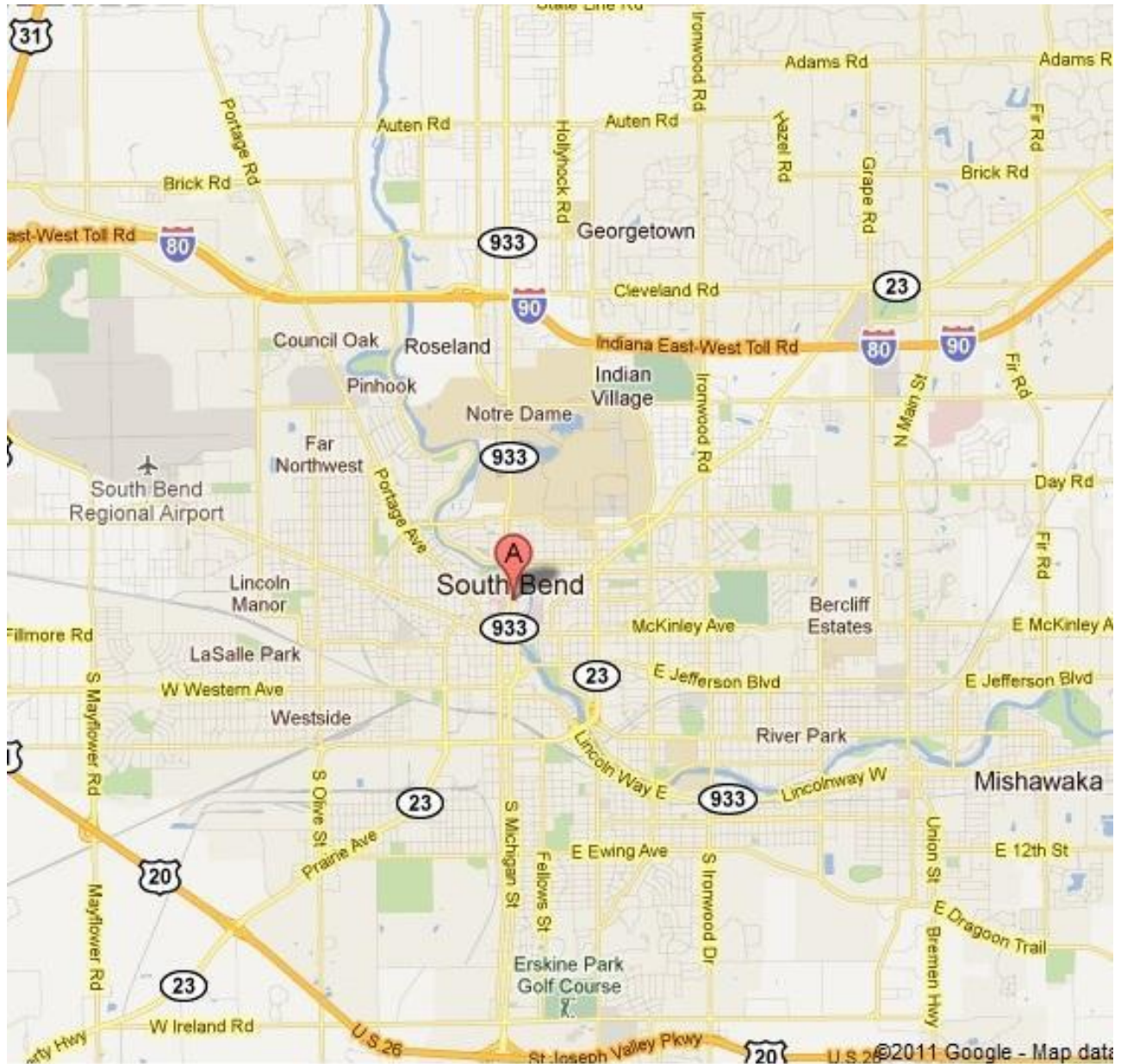



Area Restaurants

**Parisi's Italian Ristorante**

1412 South Bend Ave.
574-232-4244
0.5 miles from CFIA

Hot Box Pizza

1234 Eddy St.
574-246-9445
0.2 miles from CFIA

Five Guys Burgers & Fries

1233 Eddy St. #110
574-234-1800
0.2 miles from CFIA

The Mark Dine & Tap

1234 Eddy St. #111
574-204-2767
0.2 miles from CFIA

McAllister's Deli

1130 Angela Blvd. #102
574-232-8560
0.2 miles from CFIA

Rocco's Pizza

537 N. Saint Louis Blvd
574-233-2464
0.8 miles from CFIA

Between the Buns

1803 South Bend Avenue
574-247-9293
0.8 Miles from CFIA

Barnaby's

713 E. Jefferson Ave
574-288-4981
1.4 miles from CFIA

Original Pancake House

1430 N. Ironwood Dr.
574-232-3220
1.1 miles from CFIA

Tippecanoe Place

620 W. Washington St.
574-234-9077
1.7 miles from CFIA

Main Street Pub & Grill

2046 South Bend Ave
574-271-9895
0.9 miles from CFIA

Nick's Patio

1710 N. Ironwood Dr.
574-277-7400
1.1 miles from CFIA

Hacienda Mexican

1501 N. Ironwood Dr.
574-272-5922
1.0 miles from CFIA

Mulligan's Bar & Grill

1705 South Bend Ave.
574-277-5666
0.2 miles from CFIA

Studebagels

1801 South Bend Ave
574-277-4440
0.8 miles from CFIA

Carmela's at Macri's

214 N. Niles Ave
574-280-4824
1.2 miles from CFIA

Maury's Pat's Pub

901 West 4th St.
Mishawaka, IN
574-259-8282

Jimmy John's

54570 N. Ironwood
574-277-8500
1.1 miles from CFIA

Chipotle Mexican Grill

1250 N. Eddy #101
574-251-0175
0.2 miles from CFIA

Einstein Bagels

2019 South Bend Ave
574-272-2622
0.9 miles from CFIA

Domino's Pizza

1627 Edison Rd.
574-271-0300
0.1 miles from CFIA



Area Attractions



University Park Mall

www.simon.com/mall/?id=192

6501 N. Grape Rd. Mishawaka, IN 46545

College Football Hall of Fame

www.collegefootball.org

111 South St. Joseph St. South Bend, IN

1-800-440-FAME

Potawatomi Zoo

www.potawatomizoo.org

500 S. Greenlawn South Bend, IN 46615

574-235-9800

Morris Performing Arts Center

www.morriscenter.org

211 N. Michigan St. South Bend, IN 46601

574-235-9190

Studebaker Museum

www.studebakermuseum.org

201 S. Chapin St. South Bend, IN 46601

574-235-9714

South Bend Silverhawks Baseball

www.minorleaguebaseball.com/index.jsp?sid=t550

Coveleski Stadium

501 W. South St. South Bend, IN 46601

574-235-9988

Waiver

**UNIVERSITY OF NOTRE DAME COMPTON FAMILY ICE ARENA
WAIVER, RELEASE, AND INDEMNIFICATION AGREEMENT FOR MINORS (YOUNGER THAN AGE 18)
2015-2016**

I, _____, am the parent or guardian of a minor child, _____, who will be participating in ice skating, ice hockey, and/or broomball activity (collectively "Activity") at the Compton Family Ice Arena ("Arena") at the University of Notre Dame du Lac, Notre Dame, Indiana (the "University") during the period of time starting with the date of my signature below through June 30, 2015. I am fully aware that my child's participation in this Activity is totally voluntary. In consideration of the University's agreement to permit my son or daughter to participate in the Activity, the receipt and sufficiency of which consideration is hereby acknowledged, I agree as follows:

1. I, individually, and on behalf of my minor child and our respective heirs, successors, assigns, and personal representatives, hereby release, acquit and forever discharge the University and its employees, agents, servants, officers, trustees, and representatives (in their individual and official capacities) from any and all liability whatsoever, including liability for the University's own negligence, for any and all damages, losses or injuries (including death, mental anguish or emotional distress) to myself, my child and/or property, including but not limited to any claims, demands, actions, causes of action, damages, costs, expenses (including hospital and medical expenses) and attorneys' fees, which arise out of, occur during, or result from my child's participation in the aforementioned Activity, including travel to and from the University and including without limitation any loss, claim, demand or suit that my child might assert once he/she attains the age of majority.

2. I, individually, and on behalf of my minor child and our respective heirs, successors, assigns, and personal representatives, hereby agree to indemnify, defend and hold harmless the University and its employees, agents, servants, officers, trustees and representatives (in their individual and official capacities) from any and all liability, loss or damages incurred or sustained (including injury or damage to persons and/or property) as a result of any claims, demands, damages, actions, causes of action, judgments, costs, expenses (including hospital and medical expenses) and/or attorneys' fees, which result from, arise out of, or relate to my child's participation in the aforementioned Activity or arising out of his or her travel to and from the University.

3. I agree that this Waiver, Release, and Indemnification Agreement is governed by the laws of the State of Indiana and is intended to be as broad and inclusive as permitted by the laws of the State of Indiana. If any portion hereof is held invalid, it is agreed that the balance hereof shall, notwithstanding, continue in full legal force and effect. In the event of any cause of action related to the Activity, I agree that jurisdiction lies with the Superior Court of St. Joseph County, Indiana or the U. S. District Court of Northern District of Indiana.

4. I hereby acknowledge and accept that there are certain risks, known and unknown, including bodily injury and death, inherent in my child's participation in ice skating, the game of ice hockey, and/or the game of broomball. I, on my own behalf and on behalf of my minor child, have knowingly and voluntarily decided to assume the risk of these inherent dangers in consideration of the University's permission to allow my minor child to participate in the aforementioned Activity. I hereby release and discharge the University from any and all negligence, including the University's own negligence, in connection with my child's participation in the Activity, including travel to and from the University, except for any gross negligence or willful and wanton misconduct on the part of the University. I hereby acknowledge and agree that the University may permit my child to engage in any ice skating, ice hockey, or broomball activity at the Arena and that I assume sole responsibility for preventing my child from engaging in any ice skating, ice hockey, or broomball activity in which I do not want him/her to participate.

5. I hereby agree that, if my child engages in any ice hockey or broomball activity at the Arena, I shall have sole responsibility for ensuring that he/she will wear at all times while on the ice rink surface all protective equipment required by the Arena for such activity, including a helmet that meets the Arena's requirements. I hereby acknowledge that noncompliance with any such requirement may result in my child's ejection from the Arena on the date(s) on which the requirement is violated.

6. I hereby represent and warrant that, if my child will engage in any ice hockey activity at the Arena, he/she will be a current, registered member of USA Hockey, Inc./ Hockey Canada at the time of that ice hockey activity. I further agree that I shall prevent and shall have the sole responsibility for preventing my child from engaging in any ice hockey activity at the Arena during any period of time that my child is not a registered member of USA Hockey, Inc. / Hockey Canada.

7. By signing this Waiver, Release, and Indemnification Agreement, I hereby acknowledge and represent that I have read this entire document, that I understand its terms and provisions, that I understand that it affects my legal rights and those of my child, that it is a binding Agreement, and that I have signed it knowingly and voluntarily.

Parent or Guardian Signature

Parent or Guardian Name (Printed)

Date

USA Hockey/Hockey Canada registration Confirmation Number :