

CLOGRENNANE LIME LTD
CLOGRENNANE
CARLOW
IRELAND
A CRH GROUP COMPANY

T: 059 9131811
F: 059 9131607
E: office@clogrennane.ie
www.irishlime.ie



County Secretary,
Clare County Council,
Unit 1,
Westgate Business Park,
Kilrush Road,
Ennis,
Co. Clare.

30th September 2005.

Re:- Application to the Environmental Protection Agency for an IPPC Licence.
Planning reference: P04/615, PL 03.208121.

Dear Sir,

We hereby notify Clare County Council that in accordance with the Environmental Protection Agency, that Clogrennane Lime Limited, Raheendoran, County Carlow, Reg. No. 400, will be applying for an IPPC Licence for class 13.3 *The production of lime in a kiln* at their proposed plant at Ryan Bros. (Ennis) Ltd., Toonagh Quarry, Ballybrody, Ennis, Co. Clare (Grid reference E 130155 N 183351). A environmental impact statement is enclosed with this letter. A copy of the application for an the IPPC Licence, the environmental impact statement and such further information relating to the application as may be furnished to the Agency in the course of the Agency's consideration of the application will, as soon as practicable after receipt by the Agency, be available for inspection or purchase at the Headquarters of the Agency.

Yours Sincerely,

Larry Byrne,
Technical Director,
Clogrennane Lime Ltd.

Application to the Environmental Protection Agency for an
IPPC Licence.

Date: 30th September 2005.

Notice is hereby given in accordance with the Environmental Protection Agency that Clogrennane Lime Limited, Raheendoran, County Carlow, Reg. No. 400, will submit information to support the application for an Integrated Pollution Prevention and Control Licence (IPPC Licence) for *class 13.3. The production of lime in a kiln* at their proposed plant at Ryan Bros. (Ennis) Ltd., Toonagh Quarry, Ballybrody, Ennis, Co. Clare (Grid Reference E 130155 N 183351).

An environmental impact statement will be submitted with this application and to the Planning Department of Clare County Council.

A copy of the application for the IPPC Licence, the environmental impact statement and such further information relating to the application as may be furnished to the Agency in the course of the Agency's consideration of the application will, as soon as practicable after receipt by the Agency, be available for inspection or purchase at the Headquarters of the Agency.

e-mail: tourspain@latestinfo.co.uk
 request line: 0818 22 02 90

York Nov 2005 £ 679pp call
 American Holidays 01 6733800

1170747 or nepmestis@bommail.com

THE IRISH TIMES Saturday, September 24, 2005

INTERIORS

INTERIOR DESIGN

A complete, convenient design service. Practically your lifestyle & budget. www.dublin.ie Ph: 2943675

KITCHENS

KITCHENS, The Old e, Ballymore Eustace, Co. Wick. Specialists in contemporary and kitchen design. www.ns.com - Ph: (045) 864169
IGN - Independent expert fitting service. Ph Margaret www.mynewkitchen.ie

SHUTTERS

Window Shutters. Call 01 454 4444 www.breeninteriors.com

SOFAS & CHAIRS

OFFERED By "O'Tooles" sofa, Corner sofas made to Newmarket Sq., D8. Tel. www.otooles.ie
FACTORY Ireland's best The Mill, Mill St, D8. Powerscourt House, 046085. Albert Qy., Cork www.thesofafactory.com

JOBS

Easy to find at www.nanny.ie

SOFT FURNISHINGS

A LOOSE COVER making service nationwide. All upholstery also. Ph: 01 8350716. www.irishloosecovers.com.
FABRIQUE Interiors Dunshaughlin, Curtain & Upholstery fabric, finest quality at affordable prices. 01 8241716
FABRIQUE Interiors Dunshaughlin, Curtain & Upholstery fabric, finest quality at affordable prices. 01 8241716

TILES

SALE NOW ON up to 50% off many lines. Polished porcelain tiles reduced to only €30.00 sq. yard. Dublin Tile, 88 Thomas Street, opposite Vicar St. Tel: (01) 6771361.

WINDOWS

TREASURE your timber frames and allow us to double glaze them! Free estimates nationwide. Tel: 047 831766

ANTIQUES FINE ARTS / CURIOS

VERY OLD NATIONAL Cash Register, silver finish. 044 73284 6-7pm
VICTORIAN MAHOGANY TABLE, telescopic, with two inserts, seats 10-12, €4,700 o.n.o. also 8 Victorian spoonback chairs. €2,400 o.n.o. both excellent condition Ph: 086 2594206.
VICTORIAN OVER-MANTLE Mirror 6ft x 6 ft overall. 1 "B Branch" Waterford Glass Chandelier. Plus 1 pair of Waterford "2 Branch" wall lights. Bergere suite of furniture - all items in mint cond., must be seen in situ., Ph: 086 3108181, 6-7pm.

APPOINTMENTS

ACCOUNTING

View jobs from
ESCA
 Executive Selection
 Consultancies Association
 ON
nicemove.ie

WWW.ATLASPG.IE

ARCHITECTURE

A BETTER JOB IN ARCHITECTURE & Construction. Tech Skills Resources. Ph Kathleen 01-6390390 E: resources@techskills.ie, www.techskills.ie

WWW.DESIGNSTAFF.IE Jobs within Architecture and Commercial Interiors Tel: 01 406 1838 / pat@designstaff.ie

CHILDCARE

AT BELGRAVE AGENCY Full & Part-time Nannies available, www.nanny.ie Tel: 01-2809341

HOTELS

HOTEL & CATERING Opportunities - www.richmond.ie

LEGAL

Due to expansion, a busy Dublin 2 law firm requires:
 • One Conveyancing solicitor and one Litigation solicitor with at least one years exp.
 • Two legal secretaries with at least one years exp.
 Please forward CV to info@keans.ie

JUNIOR LEGAL SECRETARY required for busy, friendly practise based in Templeogue. Opportunity for advancement. Apply by e-mail with CV to info@griffinsolicitors.ie

LEGAL SECRETARY - Busy Bray firm (4 Solicitors) require Legal Secretary with not less than 4 years experience. Good salary with possibility of flexible hours. Apply to Box No. Z9317, The Irish Times, 10-16 D'Olier Street, Dublin 2.

LGE LAW FIRMS req Legal Secs with 60wpm Audio & min 2 yrs exp. legal@marybremin.ie

SOLICITOR required for Residential Conveyancing, Dublin 4 firm. Experience in Residential Conveyancing essential. Phone Margaret at 8363551

THE LEGAL PANEL - www.thepanel.com - Contact Sarah Randall.

POSTS IN EDUCATION

PRIMARY TEACHER (Permanent) required for the 7th November 2005 at Glenageary Killiney N.S., Killiney Road, Killiney, Co. Dublin. (12 Teacher School including the Principal) under the patronage of the Church of Ireland Archbishop of Dublin. Applications with curriculum vitae and references to Chairperson, The Rectory, Killiney Road, Killiney, Co. Dublin no later than 8th October 2005. A list of suitable applicants may be set up from which future vacancies may be filled within a four-month period from the date of this advertisement. Enclose SAE for return of documents.

PERMANENT TEACHER required for Scoil Eoin (under the patronage of the Catholic Archbishop of Dublin), Greendale Rd., Kibarraek, Dublin 5. School has 19 teachers including principal. Apply with C.V., references and S.A.E. to Rev. Chairperson by Mon 10th Oct. 2005.

LEGAL NOTICES

APPLICATION TO THE ENVIRONMENTAL PROTECTION AGENCY FOR AN IPPC LICENCE

Notice is hereby given in accordance with the Environmental Protection Agency that Clogrennane Lime Limited, Raheendoran, County Carlow, Reg. No. 400, will submit information to support the application for an IPPC Licence for class 13.3. The production of lime in a kiln at their proposed plant at Ryan Bros. (Ennis) Ltd., Toonagh Quarry, Ballybrody, Ennis, Co. Clare (Grid Reference E130155 N 183351). An environmental impact statement will be submitted with this application and to the Planning Department of Clare County Council. A copy of the application for the IPPC Licence, the environmental impact statement and such further information relating to the application as may be furnished to the Agency, in the course of the Agency's consideration of the application will, as soon as practicable after receipt by the Agency, be available for inspection or purchase at the Headquarters of the Agency.

THE IRISH TIMES
 Interiors/Exteriors
 Christmas Supplement
 2005

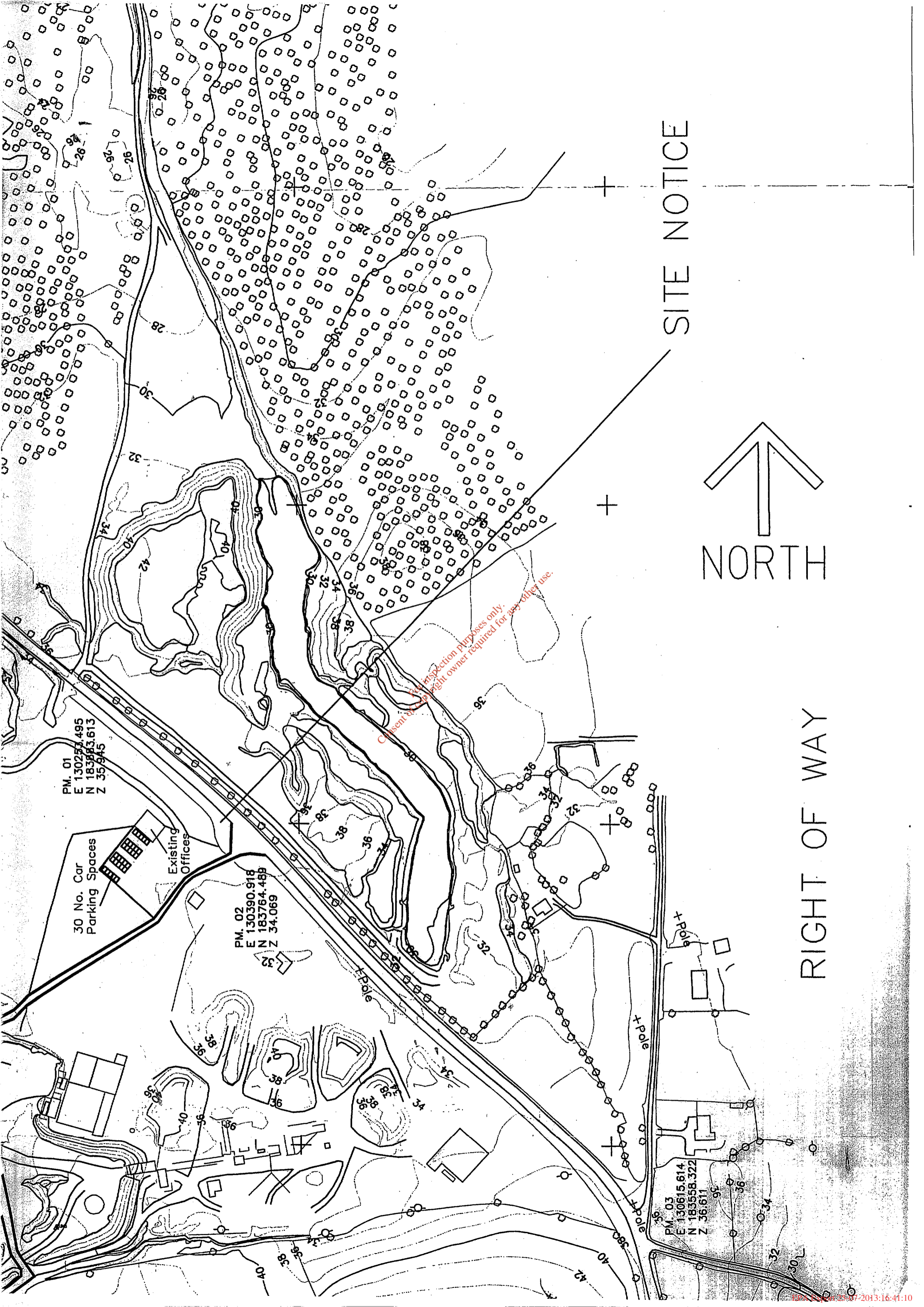

PM. 01
E 130253.495
N 183553.613
Z 35.945

30 No. Car
Parking Spaces
Existing
Offices

PM. 02
E 130390.918
N 183764.489
Z 34.069

PM. 03
E 130615.614
N 183558.322
Z 36.611

For inspection purposes only.
Consent of copyright owner required for any other use.

SITE NOTICE

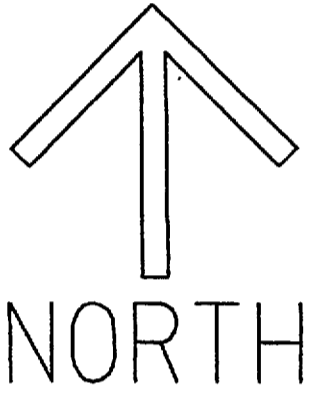

RIGHT OF WAY



RYAN BROS. (ENNIS) LTD

Toonagh Quarry, Ennis, County Clare

Republic of Ireland

Telephone +353 (0)65 683 7644

Facsimile +353 (0)65 683 7047

QUARRY MATERIALS • CONCRETE PRODUCTS



Planning Ref. P04/615

To Whom It May Concern:

1. Ryans Bros. (Ennis) Ltd., Toonagh Quarry, Ennis, Co. Clare is a wholly owned subsidiary of the CRH Group.
The site location, use of raw materials and the rights to existing access are all granted to Clogrennane Lime Ltd. due to our common ownership and are verified in the attached letter from our Company Secretary.
2. Both Ryan Bros. (Ennis) Ltd. and Clogrennane Lime Ltd. are owned by the CRH Group. The accompanying letters show the letterheads from both companies with their reference to CRH. Please find attached details of both companies from the Companies Registration Office and a letter from the Company Secretary of Ryan Bros. (Ennis) Ltd. acknowledging that they are a wholly owned subsidiary of CRH plc.
3. The proposed new development will help to utilise the existing extraction volumes more efficiently and will increase the existing extraction by approx. 15% annually. An extensive survey of reserves has already been carried out and the results of this survey show that there are ample reserves within the existing quarry for longer than the lifetime of a kiln.
4. As General Manager of Ryan Bros. (Ennis) Ltd., I give consent to the employees of Clogrennane Lime to their use of the existing canteen and toilet facilities.
5. As General Manager of Ryan Bros. (Ennis) Ltd., I give consent to the employees of Clogrennane Lime to use the proposed car parking spaces as designated in the revised site drawing.

Yours Sincerely,

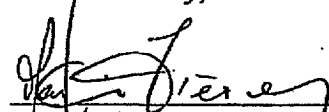
Martin Tierney,
General Manager,
Ryan Bros. (Ennis) Ltd.

10th June 2004