

Retail For Lease

Seven Mile & Farmington Center

Seven Mile Rd & Farmington Road ~ Livonia, MI



Up To 27,000 Square Feet Available

- ◆ Join Kmart in this Center.
- ◆ Out-lot Available.

Demographic Facts:

	<u>3 Mile</u>	<u>5 Mile</u>
2009 Population	84,819	221,795
2009 Est. Median HH Income	\$78,012	\$74,040

Schostak
BROTHERS & COMPANY

www.schostak.com

17800 Laurel Park Drive, Suite 200C

Livonia, Michigan 48152

(248) 262-1000

For More Information Contact:

Rick Reardon

(248) 357-6142

Retail For Lease

Seven Mile & Farmington Center

Seven Mile Rd & Farmington Road ~ Livonia, MI

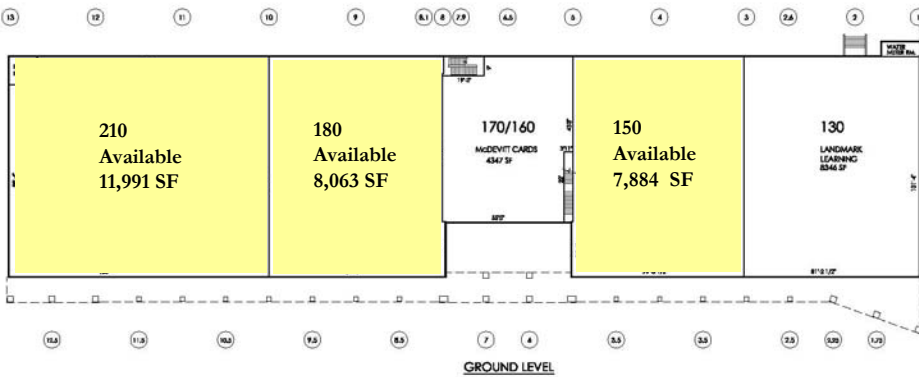

NOTE:
 SCALE: UNITS, SQUARE FEET, AND AREA ARE ALL BASED ON AERIAL PHOTOGRAPHS.
 NUMBER OF SQUARE FEET AND NUMBER OF SQUARE FEET ARE APPROXIMATE.
 PROPERTY OWNERS SHALL BE RESPONSIBLE FOR CURRENT STATUS AND ACCURACY.
 THIS IS NOT A CONTRACT. ALL INFORMATION IS FOR INFORMATIONAL PURPOSES ONLY.
 THE INFORMATION IS NOT TO BE USED FOR ANY OTHER PURPOSES WITHOUT THE WRITTEN CONSENT OF THE PROPERTY OWNER.
 THE INFORMATION IS NOT TO BE USED FOR ANY OTHER PURPOSES WITHOUT THE WRITTEN CONSENT OF THE PROPERTY OWNER.



7 & FARMINGTON
 LIVONIA, MICHIGAN

LEASE PLAN

DATE	PREPARED BY	REVISION
11/11/08	SC	1

Schostak
 BROTHERS & COMPANY
 11000 WOODLAND DRIVE, SUITE 100, LIVONIA, MI 48150

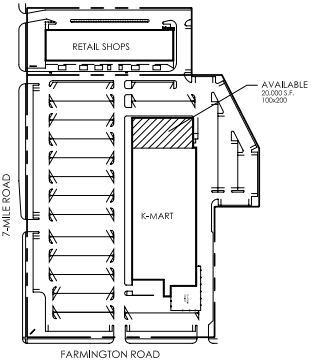
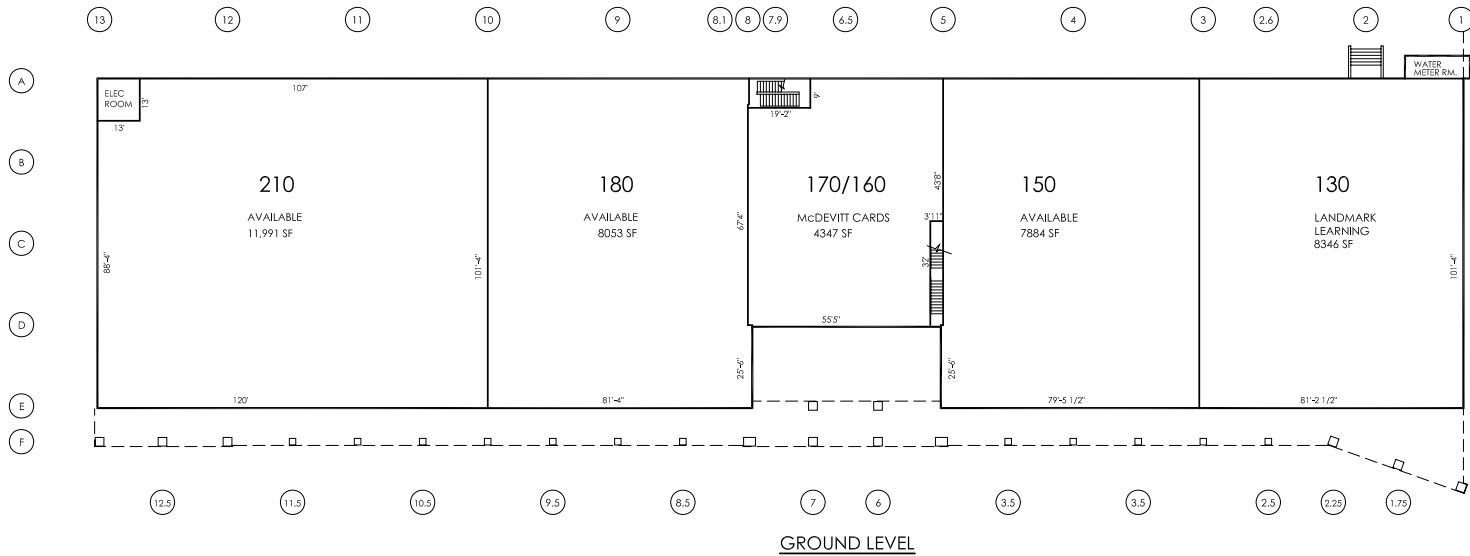

SITE PLAN
NO SCALE

NOTE:
LAYOUT, DIMENSIONS, LOCATIONS AND DECS ETC. ALL SUBJECT TO VERIFICATION AND FINAL REVIEW OF ARCHITECT AND OWNER. PLAN IS FOR INFORMATIONAL PURPOSES ONLY.
PROSPECTIVE TENANT NAMES ARE REPRESENTATIVE OF CURRENT INTEREST AND ACTIVITY AND DO NOT CONSTITUTE A BIDDING OR EXECUTED LEASE. OWNER ASSUMES NO LIABILITY FOR THE INFORMATION SHOWN AND OFFERS NO ASSURANCE THAT THE PLAN CAN BE MET OR BE OTHERWISE ATTAINABLE.

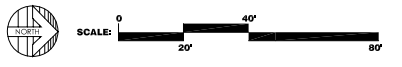

1787L24_3-21-05

PROJECT
7 & FARMINGTON
LIVONIA, MICHIGAN

REVISIONS

NO.	DATE	DESCRIPTION
11	3/21/05	
14	3/18/09	
15	3/29/04	
16	3/21/05	

DRAWING TITLE
LEASE PLAN

DATE	DRAWN BY	DRAWING #
4/17/09	APPROVED BY	L-1

Schostak
BROTHERS & COMPANY
17800 LAUREL PARK DRIVE NORTH #200C (248)242-1000 LIVONIA, MICHIGAN 48152



7 & Farmington Center

Farmington Rd (Average Daily Traffic - 35,918)

7 Mile Rd (Average Daily Traffic - 22,366)

Pollyanna Dr

Stamford Dr

Gable St

Mayfield Ave

Woodring St

Westmore St

Shadyside St



Date: 05/05/10

Current Geography Selection: (3 Selected) 1,3,5 mile radii: 7 mile rd & Farmington rd

Your title for this geography: 7 Mile Rd & Farmington Rd

Lat: 42.426100 **Long:** -83.374900

City: Livonia **Pop:** 102,211

County: Wayne County **Pop:** 2,005,415

Zip: 48152 **Pop:** 32,515

Demographic Snapshot Comparison Report

	1 Miles:	3 Miles:	5 Miles:
Population: 2009			
Total Population	10,253	85,041	222,362
Male Population	49.1%	48.5%	48.7%
Female Population	51.0%	51.5%	51.3%
Median Age	42.5	42.9	41.6
Population Density (per sq. mi.)	3,263.7	3,007.7	2,831.2
Employees	3,945	47,837	161,543
Establishments	501	4,075	10,665
Income: 2009			
Median HH Income	\$90,234	\$78,929	\$75,066
Per Capita Income	\$29,503	\$29,482	\$29,230
Average HH Income	\$86,376	\$77,944	\$76,312
Households: 2009			
Total Households	3,427	31,748	83,885
Average Household Size	2.97	2.64	2.60
Household Growth 1990 - 2000	8.2%	8.2%	8.2%
Housing: 2009			
Owner Occupied Housing Units	67.9%	68.4%	67.1%
Renter Occupied Housing Units	15.4%	18.4%	19.7%
Vacant Housing Units	16.8%	13.3%	13.2%
Race: 2009			
White	87.9%	87.5%	83.7%
Black	6.4%	6.0%	9.2%
American Indian, Eskimo, Aleut	0.0%	0.2%	0.2%
Asian	4.3%	4.7%	5.0%
Hawaiian or Pacific Islander	0.0%	0.0%	0.0%

Other	0.4%	0.4%	0.4%
Multirace	1.0%	1.3%	1.5%
Ethnicity: 2009			
Hispanic	2.8%	2.3%	2.5%
Non-Hispanic	97.2%	97.7%	97.5%

Current year data is for the year **2009**, 5 year projected data is for the year **2014**. More About Our Data.
Demographic data © 2009 by Experian/Applied Geographic Solutions.

© **2010. DemographicsNow is brought to you by Alteryx, LLC.**

Alteryx, DemographicsNow.com and the Alteryx and DemographicsNow.com logos are trademarks of Alteryx, LLC.
All rights reserved.

[Privacy Statement](#) | [License Agreement](#)