

create your own

# CHALKBOARD CHORE CHART

PRESENTED BY MARTHA STEWART LIVING™

## YOU WILL NEED:

### PAINT DEPT.

- 1 quart Glidden® DUO™ Paint + Primer interior latex paint, eggshell base finish—Martha Stewart Living™ Washed Denim MSL162
- ½ cup powdered, white non-sanded tile grout
- 1½in-wide blue painter's tape
- Two 4in foam paint rollers
- Two 4in paint trays
- Martha Stewart Living Textured Metallic specialty paint—Hard Frost
- Martha Stewart Living 3pc Visual Texture Paint and Palette Knife set

### BUILDING MATERIALS DEPT.

- 2ft x 4ft Masonite board (Eucaboard)
- Sieve or window screening

### HARDWARE & TOOLS DEPT.

- Small Olfa™ box cutter
- Metal straightedge
- Drill with standard 5/32in bit
- Martha Stewart Living 1in Ring cabinet hardware knob (Bedford Nickel finish)
- Martha Stewart Living Bedford 3in Canopy Cup cabinet hardware pull (Bedford Nickel finish)

- ½in sheet metal screws #8
- Screwdriver

### CLEANING DEPT.

- Whisk

### KITCHEN DEPT.

- Removable contact paper

### MAIN AISLES

- 2.5 quart bucket with lid

### OTHER

- Header template (printed from computer)

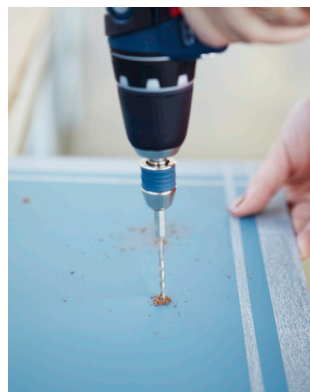

## HOW-TO:

1. Pour 1 quart paint into a 2.5-quart bucket. Sift in ½ cup powdered, non-sanded tile grout and whisk well. Paint two to three coats on a 2ft x4ft Masonite board, including the edges. Let dry between all coats (paint is dry when it no longer feels cool to the touch). To save time, place roller and roller tray in a zip baggie between coats instead of cleaning over and over.

2. Using blue painter's tape, tape off a stripe 1 inch below the top of the board and 1 inch above the bottom of the board. Cut ¼-inch strip out of tape using a straightedge and box cutter. Paint stripes with foam roller and remove tape while paint is wet. Repeat process on the sides of the board.

3. From your computer, print out the header you want to use at the top of the board (such as "Chores"). Choose a chunky font in an easy-to-read size. Place pieces of removable contact paper on board. Tape down your printed header template over contact paper, making sure it is evenly spaced and centered on the board. Cut out lettering with box cutter, beginning with the inside edges of the letters before the outside edges. Remove templates. Remove letters from the contact paper.

4. Using the trowel from the Paint and Palette Knife Set, trowel specialty paint over stencils, being careful not to cover interior shapes of letters. Carefully remove stencil while paint is wet.

5. Remove interior shapes, using the knife to lift contact paper up. Let paint dry completely.

6. Drill holes for chalk and eraser holders.

7. Using screws, attach canopy cup pull upside-down to hold chalk and attach ring knob to hang an eraser.

8. Prime board by rubbing it all over with chalk, then erasing it completely. Enjoy your finished piece!



Share your project with us on Instagram using the hashtag #DIHWorkshop and @ms\_living in the photo caption!