

# HARMONY™ COLLECTION

By Legacy Window Coverings

## Shutters



Pricing & Ordering Information

# Shutters

by Legacy Window Coverings



Bag open, with flaps closed.



Bag open, with flaps open. Chart on back of left flap



# Shutters

by Legacy Window Coverings

## TABLE OF CONTENTS

---

### GENERAL PRODUCT INFORMATION

Ordering Information .....	2
Composite Shutter Features and Benefits .....	3
Composite Plus Shutter Features and Benefits .....	4
Wood Shutter Features and Benefits .....	5
Product Summary .....	6-7
Frame Configurations .....	8-10
Rectangular Shutter Information .....	11-16

### SPECIALTY SHUTTERS

Specialty Shapes Information .....	17
------------------------------------	----

### MEASURING INFORMATION

Measuring Information .....	19
Panel Configuration .....	20-21
Bay Posts and Slim Fit Bay Posts .....	22

### SHUTTER TERMINOLGY

Selling Terms .....	23-24
---------------------	-------

### ORDER FORMS

Specilaty Shutter Order Form .....	25
French Door Shutter Order Form A& B .....	26
French Door Shutter Order Form C& D .....	27
French Door Shutter Order Form Type E .....	28
French Door Shutter Order Form Type F .....	29
Track System Shutter Order Form .....	30-31
Slider Information Key .....	34-35
Custom Color Match Policy & Consent Form .....	36

### HARMONY™ DIFFERENCE

Wood Shutter Checklist .....	37
Composite Benefits .....	38

### WARRANTY INFORMATION

Limited Lifetime Warranty .....	39
---------------------------------	----

# Shutters

by Legacy Window Coverings

## Ordering Information

### Ordering information

---

#### How long is the lead-time?

The lead-time starts from the day the order goes into production.

There are two different lead-times for your orders.

#### Lead-times

Standard Shutter: 6-8 weeks

Specialties and Custom Colors: 10 weeks

Lead time does not include shipping to JCP staging location.

#### Tracking your order:

There are several ways you can track your orders:

1. Log on to [www.harmonyjcp.com](http://www.harmonyjcp.com), click on Track Order. Enter the PO number in the box and click on Submit. This will provide you with the arrival date to your JCP staging location.
2. Email LWC at [jcp@legacywc.com](mailto:jcp@legacywc.com).
3. Contact our customer service department at 866-924-9201.

# Shutters

by Legacy Window Coverings

## Composite Shutters Features and Benefits

### Composite Shutter - Composite Wood with Polycoating

FEATURES	BENEFITS
21 frame type options	Large selection of frame designs to complement any décor
1 $\frac{1}{8}$ " , 2 $\frac{1}{2}$ " , 3 $\frac{1}{2}$ " , 4 $\frac{1}{2}$ " (elliptical shape) louvers	5 classic solid colors with furniture quality finish
	Withstand temperatures more than 140 degrees without warping
	Shutter is 97% wood, strong and durable
	Matching colors in Fauxwood Blinds
Patented polypropylene coating	Resists fading, yellowing, chipping, cracking, scratching and moisture damage
	Incorporates an advanced UV inhibitor to protect furnishings/floors /rugs/home
	Protects people and pets with no VOC (volatile organic chemical compounds) gas emissions
	Nontoxic and non-hazardous to protect people and pets
Medium density fiberboard (MDF) in louvers	Resists denting, twisting, cupping, bowing and warping
	Solid core louvers add stability
	Prevents bowing problems associated with other hollow shutters programs
Environmentally friendly wood	From trees with a growth cycle of only 8 years (other trees 100 years)
Superior insulation properties	An R-value of 4.63 to reduce heating and electric bills

FEATURES	BENEFITS
Engineered reinforced stiles	Exclusive proprietary manufacturer process used to reinforce engineered wood stiles in shutters
	Radio frequency gluing process bonds wood with pressure, heat and a proprietary chemical formulation
	Opposite and opposed grains in multiple layers of wood bonded together provide additional quality and strength
	Provide an unsurpassed stability in cores that resist bowing, twisting and cupping
Mortise and tenon joints	Structurally superior joints withstand tension stress over time
	Provide additional strength to resist shear and raking forces
Concealed and recessed magnets	Panels close tighter and have a cleaner, streamlined appearance (no bolt-on magnets)
Simpler tension setting on louvers	A Phillips screwdriver sets the tension for all louvers
Superior stainless steel fastener system	Fasteners resist corrosion and rust longer than the industry standard and are reinforced with brads at top and bottom
Seven designer hinge finishes	Coordinate with paints, stains and home décor
Optional InvisibleTilt™	Provides an unobstructed view and a streamlined appearance
Optional offset tilt rod	Provides an unobstructed view and a streamlined appearance
Optional stainless steel hinges	Will not rust in high moisture areas
Specialty styles and systems available	See specialty shutter section
Limited lifetime warranty	Guarantees quality and durability
	Hand crafted for superior workmanship
Optional motorization available	Remote control motorization to tilt louvers

# Shutters

by Legacy Window Coverings

## Composite Plus Shutter Features and Benefits

### Composite Plus Shutter

FEATURES	BENEFITS
21 frame type options	Large selection of frame designs to complement any décor
1 $\frac{1}{8}$ " , 2 $\frac{1}{2}$ " , 3 $\frac{1}{2}$ " , 4 $\frac{1}{2}$ " (elliptical shape) louvers	21 classic solid colors with furniture quality finish
	Matching colors in Fauxwood Blinds
	Nontoxic and non-hazardous to protect people and pets
Advanced Polymer	Resists warping, moisture and shrinkage
	Built with added resistance to denting
	Industry - leading colorfast performance
Superior insulation properties	An R-value of 4.63 to reduce heating and electric bills

FEATURES	BENEFITS
Engineered reinforced stiles	Exclusive proprietary manufacturer process used to reinforce engineered wood stiles in shutters
	Radio frequency gluing process bonds wood with pressure, heat and a proprietary chemical formulation
	Opposite and opposed grains in multiple layers of wood bonded together provide additional quality and strength
	Provide an unsurpassed stability in cores that resist bowing, twisting and cupping
Mortise and tenon joints	Structurally superior joints withstand tension stress over time
	Provide additional strength to resist shear and raking forces
Concealed and recessed magnets	Panels close tighter and have a cleaner, streamlined appearance (no bolt-on magnets)
Simpler tension setting on louvers	A Phillips screwdriver sets the tension for all louvers
Superior stainless steel fastener system	Fasteners resist corrosion and rust longer than the industry standard and are reinforced with brads at top and bottom
Seven designer hinge finishes	Coordinate with paints, stains and home décor
Optional InvisibleTilt™	Provides an unobstructed view and a streamlined appearance
Optional offset tilt rod	Provides an unobstructed view and a streamlined appearance
Optional stainless steel hinges	Will not rust in high moisture areas
Specialty styles and systems available	See specialty shutter section
Limited lifetime warranty	Guarantees quality and durability
	Hand crafted for superior workmanship
Optional motorization available	Remote control motorization to tilt louvers

# Shutters

by Legacy Window Coverings

## Wood Shutters Features and Benefits

### Selectwood Shutters - Premium Hardwood

FEATURES	BENEFITS
21 frame type options	Large selection of frame styles and designs to complement any décor
2½", 3½" and 4½" (elliptical shape) louvers	Selectwood provides a more pronounced texture and open grain in wood
	Selectwood provides an easier movement due to less weight in louvers
	13 rich designer stain colors with distinct wood grains
	10 paint colors with furniture quality finish
Limited lifetime warranty (three-year colorfast)	Guarantees quality and durability
	Hand crafted for superior workmanship

### Premium Wood Shutters - Hand-Selected Premium Wood

FEATURES	BENEFITS
21 frame type options	Large selection of frame styles and designs to complement any décor
1¼", 1⅞", 2½", 3½", 4½" (elliptical shape) louvers	Premium Wood provides a uniform appearance for smoother paint and stain finishes
	Premium Wood provides a rich and distinct wood grain for stains
	29 rich designer stain colors, the largest selection in Premium Wood to fit any decor
	21 paint colors, the largest selection to fit any decor
Custom color matching (Refer to Custom Color Match Form)	Allows matching of any paint or stain in the home
Superior insulation properties	An R-value of 4.63 to reduce heating and electric bills
Limited lifetime warranty (three-year colorfast)	Guarantees quality and durability
	Hand crafted for superior workmanship

### Premium Wood and Selectwood are available with the features and benefits listed below:

FEATURES	BENEFITS
Quarter sawn wood	More expensive cut of wood, provides consistent grains and adds to beauty
	Adds strength, stability and durability to louvers
	Less susceptible to cupping, bowing and warping
Engineered reinforced stiles	Exclusive proprietary manufacturer process used to reinforce engineered wood stiles in shutters
	Radio frequency gluing process bonds wood with pressure, heat and a proprietary chemical formulation
	Opposite and opposed grains in multiple layers of wood bonded together provide additional quality and strength
	Provide an unsurpassed stability in cores that resist bowing, twisting and cupping
Prescription wood conditioning	Patented technique dries the wood to emulate the regional location in which the shutter will be installed
	Less susceptible to shrinking and swelling than competitors' shutters
Hand sanded and finished	Finely sanded and coated five times with high-quality stains or paint
	UV-cured to prevent fading of the color over time
	Creates a fine furniture quality finish with a silken, lustrous look
Mortise and tenon joints	Structurally superior joints withstand tension stress over time
	Provide additional strength to resist shear and raking forces
Concealed magnets	Panels close tighter and have a cleaner, streamlined appearance
	No bolt-on magnet
Simpler tension setting on louvers	A Phillips screwdriver sets the tension for all louvers
Superior stainless steel fastener system	Fasteners resist corrosion and rust longer than the industry standard and are reinforced with brads at top and bottom
Seven designer hinge finishes	Coordinate with paints, stains and home décor
Optional InvisibleTilt™	Provides an unobstructed view and a streamlined appearance
Optional offset tilt rod	Provides an unobstructed view and a streamlined appearance
Optional stainless steel hinges	Will not rust in high moisture areas
Specialty styles and systems available	See specialty shutter section
Optional motorization available	Remote control motorization to tilt louvers

08202015\_v1.0



# Shutters

by Legacy Window Coverings

## Product Summary

### COMPOSITE COLORS

No.	Color Name	Hinge Color
1	Pure White	Silk White
2	Silk White	
3	Bright White	
4	Pearl	Pearl
5	Creamy	Bisque

### COMPOSITE PLUS COLORS

No.	Color Name	Hinge Color
1	Pure White	Silk White
2	Silk White	
3	Bright White	
4	Pearl	Pearl
5	Ivory Lace	
6	Marshmallow	
7	Creamy	Bisque
8	Cameo	
9	Crisp Linen	
10	Bisque	
11	Butter	
12	String	Nickel Plated
13	Moondust	
14	Sea Mist	Silk White
15	Ice	Nickel Plated
16	Chai	
17	Stone Grey	
18	Brown Grey	
19	Clay	
20	Decorator's White	Silk White
21	Classic Black	Black

### SELECTWOOD COLORS

No.	Color Name	Hinge Color
1	Pure White	Silk White
2	Silk White	
3	Bright White	
4	Pearl	Pearl
5	Creamy	Bisque
6	Crisp Linen	
7	Moondust	Nickel Plated
8	Ice	Antique Brass
9	Rustic Gray	
10	Limed White	
11	Goldenrod	
12	Cherry	
13	Black Walnut	
14	Red Oak	
15	Rich Walnut	
16	Old Teak	
17	Spring Rose	
18	Red Mahogany	
19	Dark Mahogany	
20	Wenge	
21	Auburn	
22	Acorn	
23	Sumatra	

### HARMONY™ PREMIUM WOOD COLORS

No.	Color Name	Hinge Color
1	Pure White	Silk White
2	Silk White	
3	Bright White	
4	Pearl	Pearl
5	Ivory Lace	
6	Marshmallow	Bisque
7	Creamy	
8	Cameo	
9	Crisp Linen	
10	Bisque	
11	Butter	Nickel Plated
12	String	
13	Moondust	Nickel Plated
14	Sea Mist	Silk White
15	Ice	Nickel Plated
16	Chai	
17	Stone Grey	
18	Brown Grey	
19	Clay	
20	Decorator's White	Silk White
21	Classic Black	Black
22	Rustic Gray	Antique Brass
23	Limed White	Silk White
24	Taupe	Nickel Plated
25	Natural	Antique Brass
26	Golden Oak	
27	Oak Mantel	
28	Goldenrod	
29	Pecan	
30	Cherry	
31	Dark Teak	
32	Cocoa	
33	Cordovan	
34	Mahogany	
35	New Ebony	
36	Black Walnut	
37	Red Oak	
38	Rich Walnut	
39	Old Teak	
40	Spring Rose	
41	Red Mahogany	
42	Dark Mahogany	
43	Wenge	
44	Auburn	
45	Bark	
46	Pretzel	
47	Acorn	
48	Sumatra	
49	Raisin	
50	Toffee	

**Note:** Three extra louvers are included with wood shutters. These can be used for color matching or replacement of louvers. Please leave with the consumer.



# Shutters

by Legacy Window Coverings

## Product Summary

### Composite Shutters Specifications

Description	Min.	Max.
Single Panel Width (Regular)	6"	30" 24" for 1 7/8" louver
Single Panel Width (Bi-fold & Bypass Track)	6"	24"
Single Panel Width (Bypass Track)	6"	48" for 1 7/8" louver; 50" for 2 1/2"; 3 1/2", 4 1/2" louver
Single Panel Height	10"	133"

### Composite Plus Shutters Specifications

Description	Min.	Max.
Single Panel Width (Regular)	6"	36" for 2 1/2", 3 1/2", 4 1/2" louver; 24" for 1 7/8" louver
Single Panel Width (Bi-fold & Bypass Track)	6"	24"
Single Panel Width (Bypass Track)	6"	36"- 50" for 2 1/2"; 3 1/2", 4 1/2" louver; 24"- 48" for 1 7/8" louver
Single Panel Height	10"	133"

### Selectwood Shutters Specifications

Description	Min.	Max.
Single Panel Width (Regular)	6"	42" for 3 1/2", 4 1/2" louver; 36" for 2 1/2" louver
Single Panel Width (Bi-fold)	6"	26"
Single Panel Width (Bi-fold Track)	6"	19"
Single Panel Width (Bypass Track)	6"	36" - 50" with center stile
Single Panel Height	10"	133"

### Premium Wood Shutters Specifications

Description	Min.	Max.
Single Panel Width (Regular)	6"	42" for 3 1/2", 4 1/2" louver; 36" for 2 1/2" louver 30" for 1 7/8" louver 20" for 1 1/4" louver
Single Panel Width (Bi-fold)	6"	26" 20" for 1 1/4" louver
Single Panel Width (Multi-fold Track)	6"	20"
Single Panel Width (Bypass Track)	6"	36" - 50" with center stile
Single Panel Height	10"	133"

# Shutters

by Legacy Window Coverings

## Frame Configurations

### Frame Options

Frames are available in three classifications. Each classification includes an outside mount frame and an inside mount frame.

#### Small Frames

Beaded L Frame with  
1/4" Light Block (L25)  
IB/OB

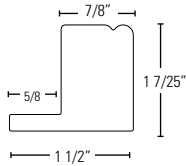

Beaded L Frame (L)  
IB/OB

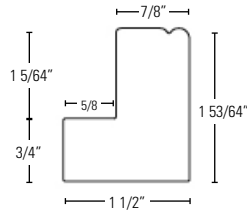

Beaded L Frame with  
1/2" Buildout (L5)  
OB

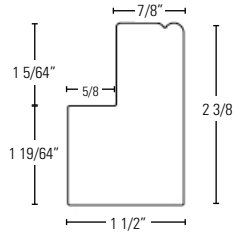

Beaded L Frame with 1"  
Buildout (L1)  
OB

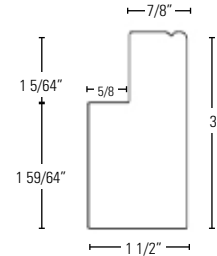

1 1/2" Bullnose Frame (TZ)  
IB

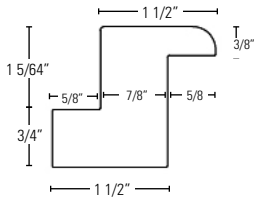

1 1/4" Beaded Frame (SZ)  
IB

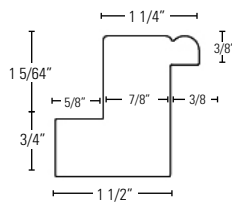

7/8" Vintage  
Hang Strip (HS)  
IB/OB

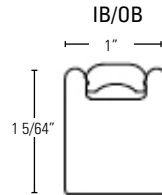

Tilt Out Z Frame (T02)  
IB

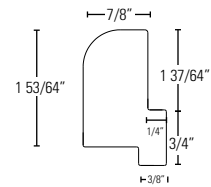

Vintage L Frame with  
1/4" Light Block (VL25)  
IB/OB

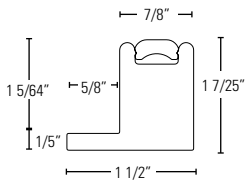

Vintage L Frame (VL)  
IB/OB

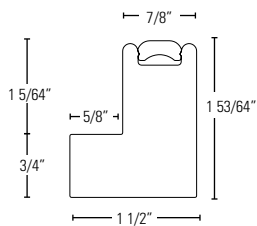

Vintage L Frame with  
1/2" Buildout (VL5)  
OB

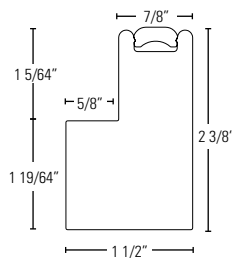

Vintage L Frame with 1"  
Buildout (VL1)  
OB

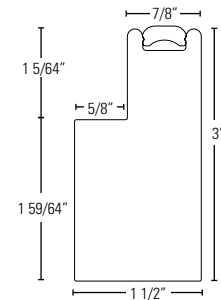

Bullnose L Frame (BL)  
OB

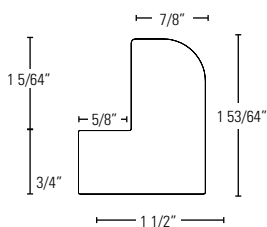

Bullnose L Frame with  
1/2" Buildout (BL5)  
OB

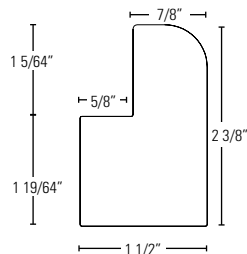

Bullnose L Frame with  
1" Buildout (BL1)  
OB

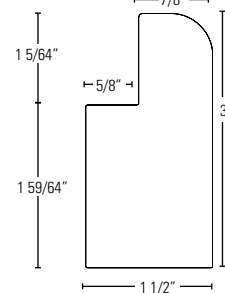

08202015\_v1.0

# Shutters

by Legacy Window Coverings

## Frame Configurations

### 2" Frames

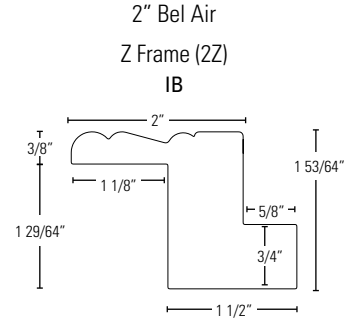
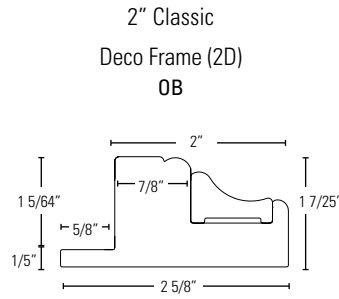
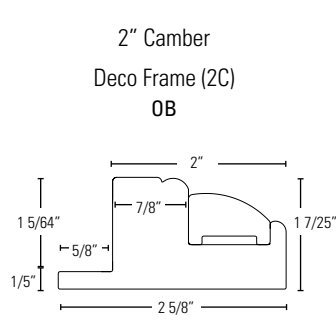

### 3" Frames

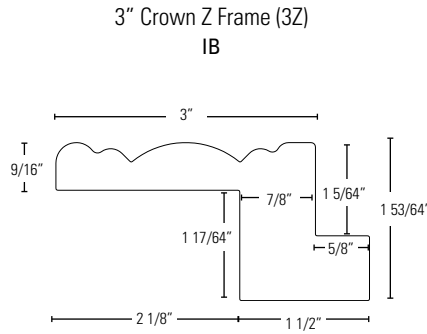
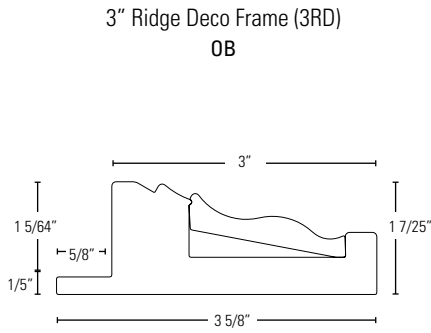

# Shutters

by Legacy Window Coverings

## Frame Configurations

### Frame Detail

The frame detail is an explanation of what is needed for framing of the shutter. The most common options are listed below.

4	all four sides intact	3R	right side is sill plate
3B	bottom frame is sill plate	3L	left side is sill plate
3T	top frame is sill plate	NB	no bottom frame
2H	top and bottom frames are sill plates	NT	no top frame - this is mostly commonly used with cafe shutters
		DS	bottom frame is sill plate with 1" divider strip (specified for specialty shape when on top of a shutter)

A standard frame is 4-sided. Due to obstructions such as a sill, there are times that a frame needs to be modified.

The most common frame detail options are as follows:

- Four-sided (four whole frames) [4]
- Three-sided top (three whole frames + sill plate) [3T], bottom [3B], right [3R], left [3L]
- Two-sided top and bottom (two whole frames + two sill plates) [2H]

The Beaded L Frame can be used as an example of what a sill plate looks like.



### Sill Plate

When ordering a frame with a sill plate, select one of the sill plates from below

#### Standard

1-1/2" Bullnose Z  
1-1/4" Bullnose Z sill plate

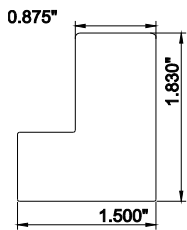

2" Bel Air Z sill plate

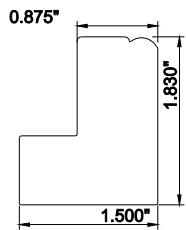

2" Deco sill plate

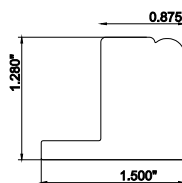

3" Ridge  
Deco sill plate

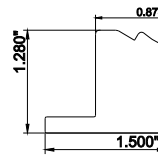

3" Crown Z  
sill plate

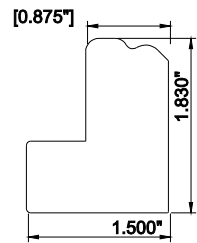

#### Optional

1-1/2" Sill Plate with 5/8"  
Light Block (L/Z)

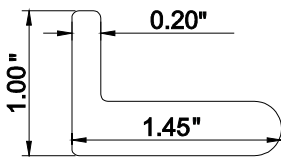

1-1/2" Sill Plate with 3/8"  
Light Block (L/Z)

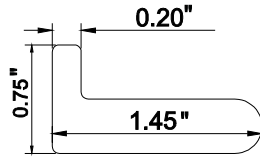

If a sill plate is not selected, the standard sill plate will be ordered. The optional sill plates are only available on Deco Frames.

# Shutters

by Legacy Window Coverings

## Rectangular Shutter Information

### Shutter Terminology

The basic shutter assembly is a panel hinged to a frame. The panel consists of louvers which pivot open and closed, with stiles on the sides and rails on the top and bottom. Panels over 74" in height require at least one divider rail for additional panel strength.

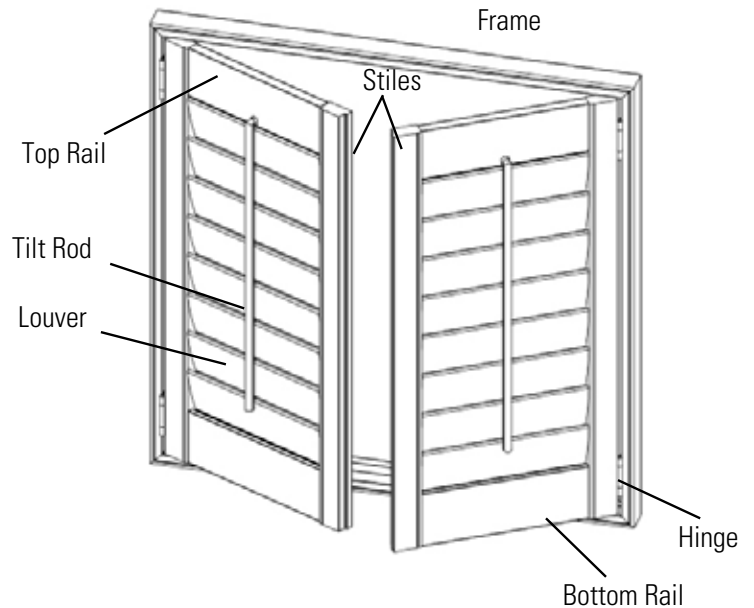

### Louvers

Four elliptical louver sizes are available: 1<sup>7</sup>/<sub>8</sub>", 2<sup>1</sup>/<sub>2</sub>", 3<sup>1</sup>/<sub>2</sub>" and 4<sup>1</sup>/<sub>2</sub>"

(1<sup>7</sup>/<sub>8</sub>" available in, Composite, Composite Plus and Premium Wood)

Louver size should be selected carefully when there is not much depth in the window. The 4<sup>1</sup>/<sub>2</sub>" louver provides the most view. However, if selected with an inside mount L Frame in a shallow window sill, it is possible that the louvers might not open. 4<sup>1</sup>/<sub>2</sub>" louvers are also not recommended on French doors. Window height and louver size dictate the size of the top and bottom rails. Rail size may vary in the same room.

Any size louver may be used with any frame type.

1 7/8" louver not available with InvisibleTilt™

1 1/4" louver available in premium wood only.

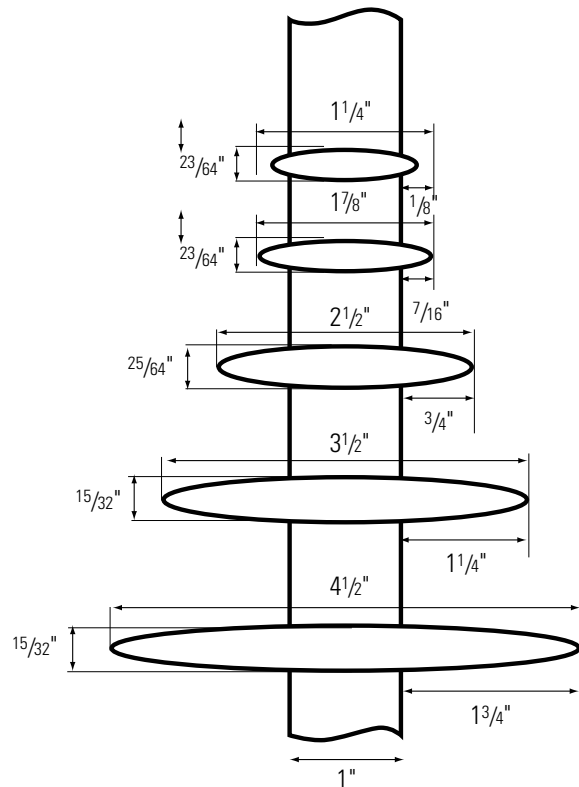

# Shutters

by Legacy Window Coverings

## Regular Shutter Information

### Decorative Panel Locks



- Available in all shutter lines
- Position: (Only available on Bottom for Track Shutters with Bottom Track; For Regular, available on Top/Bottom/both Top and Bottom)

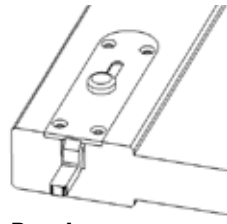

**Panel**

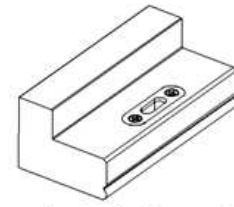

**Frame**

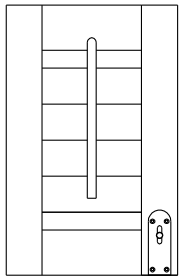

**Panel Config: L**

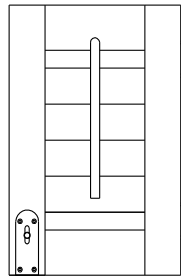

**Panel Config: R**

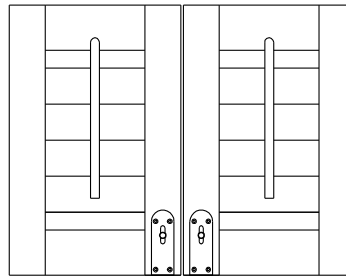

**Panel Config: LR**

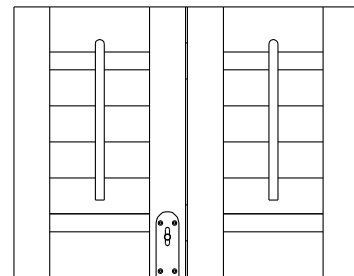

**Panel Config: LL**

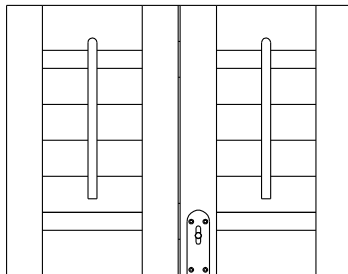

**Panel Config: RR**

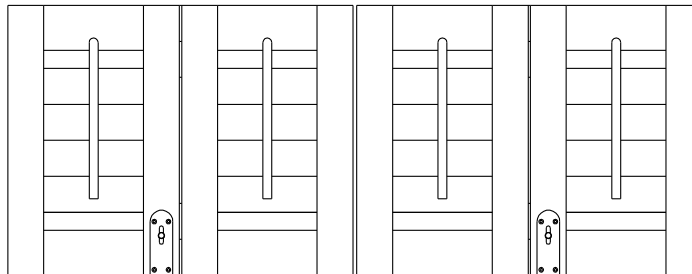

**Panel Config: LLRR**

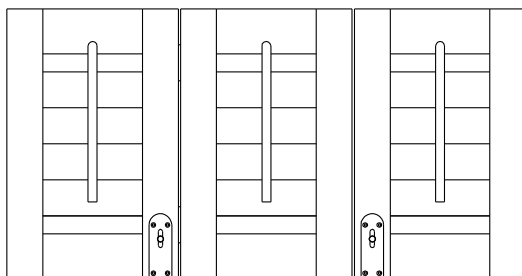

**Panel Config: LLR**

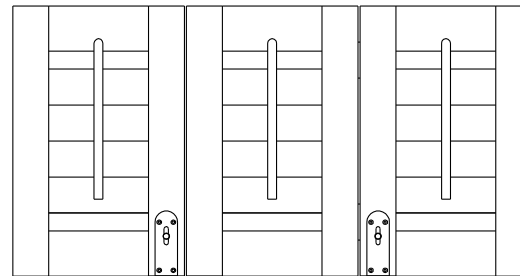

**Panel Config: LRR**

# Shutters

by Legacy Window Coverings

## Regular Shutter Information

### Decorative Ring Pulls



- For easy opening and closing
- Not available for 1.625" Stile
- Available in all shutter lines
- Please refer to the default location below
- Available finishes coordinating with hinge finishes: silk white, pearl, bisque, antique brass, bright brass, black, nickel plated and stainless steel.

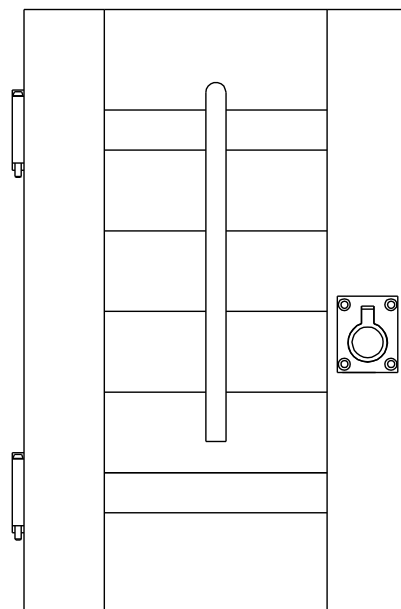

**Default**

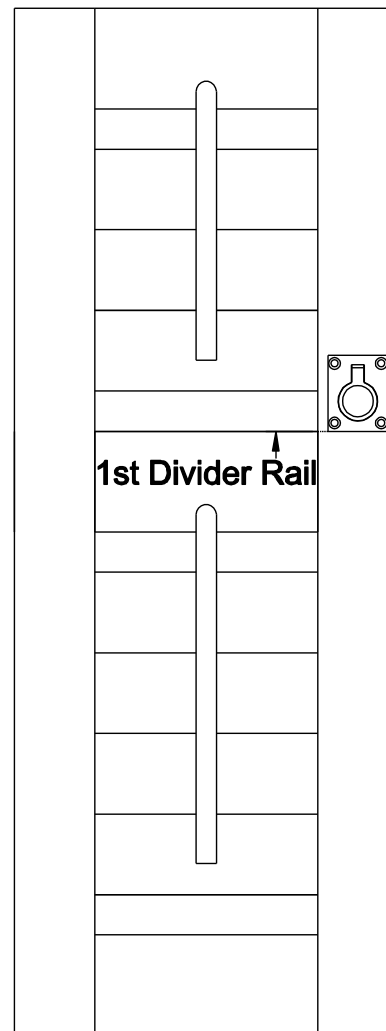

**Default when there  
are Divider Rails**



# Shutters

by Legacy Window Coverings

## Regular Shutter Information

### Both Panel Locks & Ring Pulls

- Position
  - A. Above Bottom Rail (Default)
  - B. Above 1st Divider Rail (Default when there are Divider Rails)
  - C. Custom Location

If both Panel Lock & Ring Pull are specified, the distance between them is 2.75", and the ring pull location is 6.73" from the bottom of panel. When there is no divider rail, ring pull will be above the Panel Lock (2.75" above Panel Lock) as default location; if there is a divider rail the bottom of the ring pull will line up with the top of the 1st divider rail as default location.

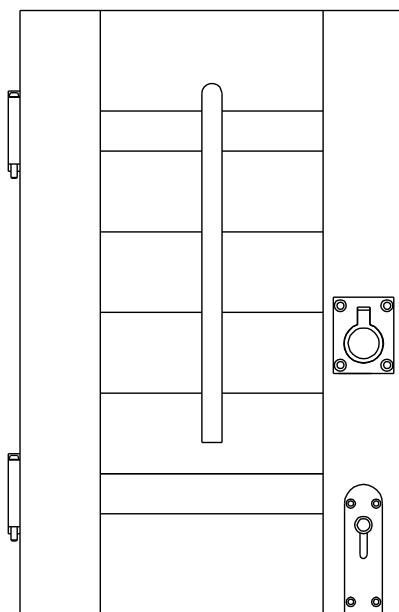

**Default**

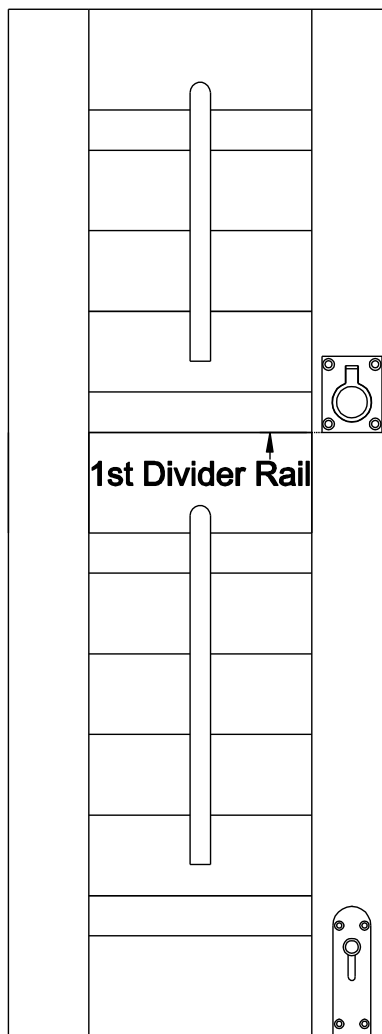

**Default when there are Divider Rails**

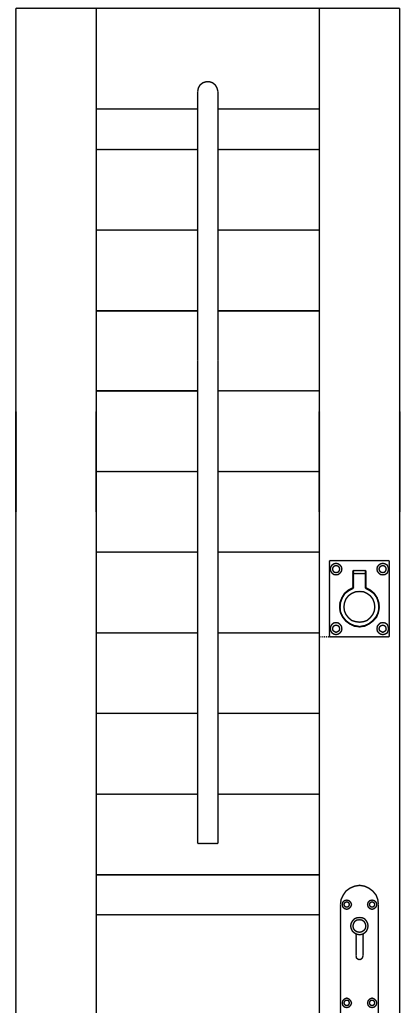

**Optional: at Custom Location**

# Shutters

by Legacy Window Coverings

## Rectangular Shutter Information

### Tilt rod

A tilt rod is a vertical piece of hardware attached to the louvers that enables them to operate in unison. Three tilt rod options are available:

- **Traditional** – This is the default option. It is a vertical bar located in the center of the panel and available offset.
- **Split** – This is a traditional tilt rod split to increase light and privacy control. This option can be accomplished without a divider rail in panels 74" or less.
- **InvisibleTilt™** – InvisibleTilt™ offers a hidden tilt system inside of the panel. This allows for view with no obstruction by the tilt rod and superior louver closure. Louvers are opened by simply moving louvers by hand. Divider rail requirements apply.

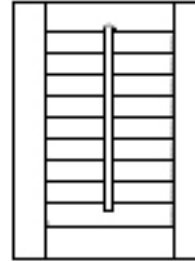

Traditional Tilt Rod

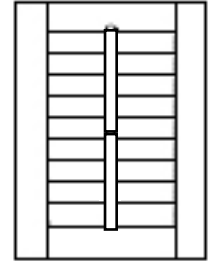

Split Tilt Rod

### Hinges

Two types of hinges are used for the Harmony™ Shutter: 2 3/8" self mortise hinges and rabbeted hinges. 2 3/8" self mortise hinges are used in hinging panel to frame. Rabbeted hinges are used in hinging panel to panel (i.e., bifold)

Standard hinges are available in silk white, pearl, bisque, antique brass (standard on all stains), bright brass, black, nickel plated and stainless steel.

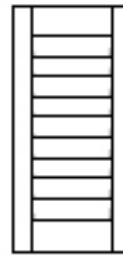

InvisibleTilt™

### InvisibleTilt™ Specifications

Louver tilting system embedded within panel stile. It is not available for 17 7/8" louver. The tilting system is split when the number of louvers exceeds the limits as listed below.

- For even numbers of louvers, the number of louvers operated by the top and the bottom tilting system will be the same.
- For odd numbers of louvers, the number of louvers operated by the bottom tilting system will be one more than the number of louvers operated by the top tilting system.
- To ensure split tilt is included, always specify on the order.

Louver Size	Maximum Possible Louvers	Panel Height Range
2 1/2"	24	54 3/4" – 57 1/4"
3 1/2"	16	54 3/4" – 58"
4 1/2"	12	54 3/4" – 60"

### Max Panel Height without Divider Rail

Product	Height
Composite	74"
Composite Plus	78"
Selectwood	78"
Premium Wood	78"

08202015\_v1.0

# Shutters

by Legacy Window Coverings

## Rectangular Shutter Information

### T-posts

A T-post is a vertical or horizontal frame piece used to divide a shutter into multiple openings. T-posts can be used to match the design of windows that have a natural break (mullion) or to accomplish a specific panel configuration. T-posts can be used creatively on top of drywall to cover multiple side-by-side windows with one shutter. T-posts are required for composite shutters and composite plus shutters greater than 96" in width and for wood shutters greater than 104" in width.

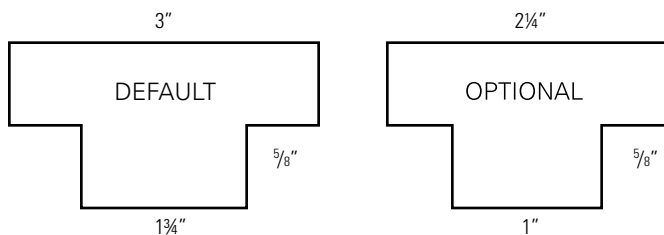
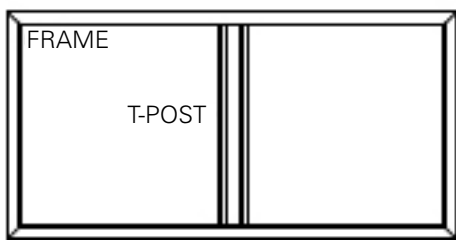

### Custom Angle T-posts and Custom Width T-Post

Custom Angle T-posts and Custom Width T-post are available in Selectwood Shutters and Premium Wood Shutters. Custom width T-posts can be no longer than 7 1/2".

### Build-out

Build-out is a piece of material that can be attached to the shutter frame. Build-out is available in 1/8" increments. It is most commonly used when there is a tile obstruction. Build-out can be ordered three ways by indicating the following in special notes:

- Depth needed (most common)
- Depth x width
- Depth x width x height
- Quarter Round available as "scribe trim," recommended with inside mount "L" frame.

### Frames with extensions

We offer frames with extensions that are one piece with the Build-out included. These are best used in French door applications for easy, seamless installs. These frames can be seen on page 8 listed under small frames.



# Shutters

by Legacy Window Coverings

## Specialty Shapes

Specialty shapes can be crafted to fit window openings beyond the conventional square or rectangle. Specialty shapes are only available in Composite Plus, Selectwood or Premium Wood, and are a perfect complement to Composite shutters or blinds.

Templates are often required. The use of deco frames is highly recommended and may not require a template. Every specialty shape is always confirmed by drawings. Do not send templates unless requested by LWC. Did you know that all specialty shapes are hinged panels? The shutter panel can be opened easily for clear access to the window. Great selling tip!



**Circle**

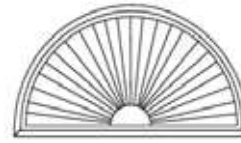

**Half Round Sunburst**

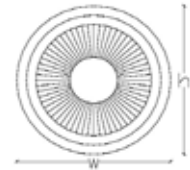

**Circle Sunburst**

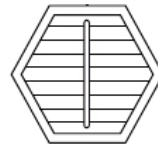

**Hexagon**

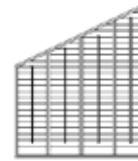

**Rake**

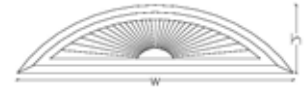

**Eyebrow Sunburst**

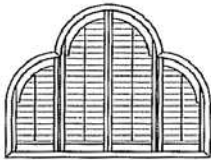

**Multi Specialty Arch**



**Oval**



**Octagon**

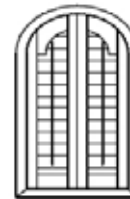

**Louvered Door Arch**

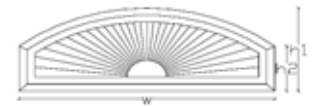

**Elongated Eyebrow Sunburst**

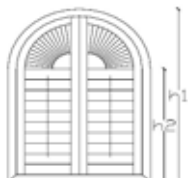

**Quarter Sunburst Panel**

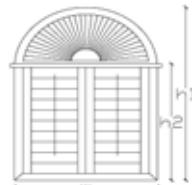

**Sunburst at Top**



**Sunburst with Horizontal Louvres**

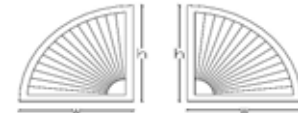

**Left and Right Quarter**

### T-POST

Harmony™ Shutters are available with regular T-Posts designed to fit standard bay (135 degrees) or corner (90 degrees) windows. In most applications, the standard bay post will be used, however additional bay posts are available. Custom Angle T-Posts (for example 150 degrees) and Custom Width T-Posts are available in Composite Plus, Selectwood and Premium Wood only.

Directions to measure for these applications can be found on our website at [www.harmonyjcp.com](http://www.harmonyjcp.com).

### CAFÉ SHUTTERS

Café shutters cover the lower half of the window opening. The heights of the panels are typically half the height of the window opening. The frame can extend to cover the entire window opening. When the frame extends beyond the panels, be aware that the light stop will still be present on the whole frame. On woods the light stop above the panels may be trimmed away.

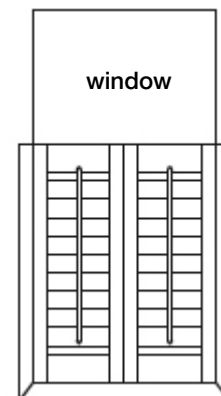
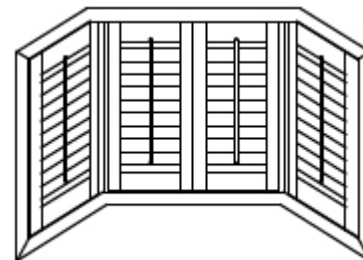

### Bi-fold and Bypass track systems

---

Track system shutters can be crafted to fit a variety of sliding glass/arcadia door windows.

#### Bi-fold

---

Bi-fold is crafted with standard 3½" box out on a single track available in all louvers sizes in Composite, Composite Plus, Selectwood and Premium Wood lines. Bi-fold is the best application for full window exposure when opened, however, panels do protrude into the room when opened. Louvers must be closed when panels are stacked back-to-back.

#### Closed Bypass

---

Track shutters in which panels can only bypass each other when louvers are in the closed position.

- Boxouts ranging from 4 1/2" to 8" in size are available for all mount types.
- Standard boxout sizes include 3 1/2", 4 1/2" and 5 1/2".
- For Outside Mounts, the 5 ½" Bypass Boxout Size is default for all louver sizes .
- For Inside and Semi-Inside Mounts, the 4 ½" Bypass Boxout Size is default for all louver sizes.

#### Open Bypass

---

Track shutters in which panels have the capability of bypassing each other when louvers are in the opened position.

- Only 2 ½" & 3 ½" louvers are available.
- Custom Boxouts ranging from 6 1/4" to 8" in size are available for all mount types.
- For 2 ½" louvers, the 6 ¼" Bypass Boxout Size is default for all mount types.
- For 3 ½" louvers, the 7 13/16" Bypass Boxout Size is default for all mount types.

Louver size should be selected carefully if the door handle projects into the room.

#### French Door

---

Shutters for French doors are available in the 2" deco, 2" Camber and L frames and are designed to mount outside of the existing trim with Build-out for louver clearance. If trim is present around the glass, measure from outside of the trim to outside of the trim.

A cut out is necessary when there is less than 1 ½" clearance from the outside edge of the knob to the edge of the existing door trim. The French door cut outs are only available in Composite Plus, Selectwood, or Premium Wood in L5 or L1 frames.

# Shutters

by Legacy Window Coverings

## Measuring Information

There are some differences in measuring when ordering blinds and shutters.

### Measuring for window squareness

1. Measure diagonally, using a metal tape measure for accurate measurements.

2. If the difference between the two measurements is greater than 1/4", we recommend an outside mount.

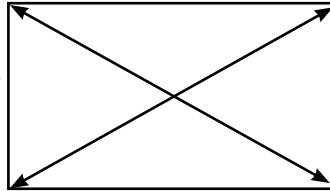

### Measuring for window width and window height

Measure the window width and the window height in three places. Use a metal measuring tape for accurate measurements.

Use the SMALLEST of the three measurements to determine the width and height when ordering inside mount shutters. Use the longest length when ordering blinds.

**For Outside Mount:**

Use the LARGEST of the three measurements to determine the width and height.

### Window size vs. Finished frame

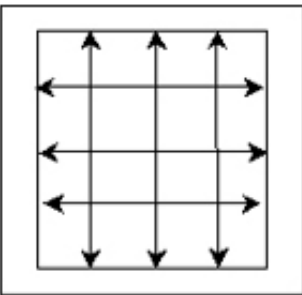

**Window size:**

Measurements inside the window given to the nearest 1/8". When using window size measurements, allowances will be taken or added.

**Finished frame:**

When providing a finished frame measurement for shutters or outside mount measurement for blinds, no factory allowances will be taken or

added. Shutters will be made to exact measurement, including the frames.

Watch for obstructions. Be sure to consider and account for obstructions that will prevent the finished product from being installed. Panel configurations and Build-out are sometimes possible solutions. When possible, take photographs or draw with dimensions - our Customer Service Department can suggest the proper way to order and install.

- Light switches
- Cabinets
- Tile surrounds
- Sink faucets
- Tilt in windows

### Divider rails

Shutter panels that exceed 74" in height require a divider rail. For each material the height requirement is different please refer to the table below. Divider rails are 3" high and add strength to shutter panels while providing versatility. Divider rails are used to divide a panel into two horizontal sections. This can be requested for aesthetic purposes or may be required to ensure that the shutter panel and louvers work properly. Divider rails are also used to match the continuity of a window that has a natural break or mullion. Each louver section is operated independently and provides light control.

If a divider rail is required and custom placement is not written on the order form, it will be placed in the middle of the panel. Divider rail location may vary by up to 2" depending on louver size.

When ordering window size, measure up from the bottom of the window opening to the center of divider rail location.

When ordering finished frame, measure up from the bottom of the frame to the middle of the divider rail location.

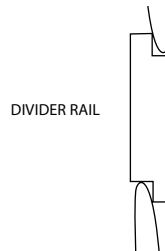

Consider the use of a divider rail when it is not required to provide a home owner an additional privacy option, much like top-down bottom-up.

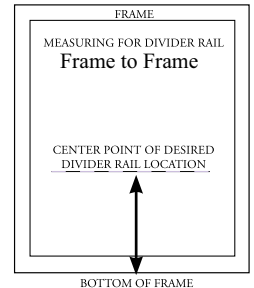

Custom size divider rails are available in Selectwood and Premium Wood up to 6 1/2".

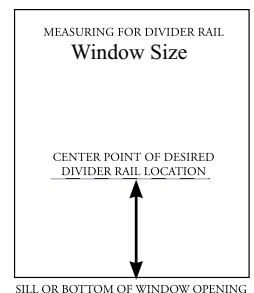

Material	Max Panel Height Without Divider Rail
Composite	74"
Composite Plus	78"
Selectwood	78"
Premium Wood	78"

# Shutters

by Legacy Window Coverings

## Panel Configuration

### Panel configuration

Numerous panel configuration options are available. Panel configurations are largely dependent on minimum and maximum sizes of shutter panels in relation to shutter widths.

The most common panel configuration options are shown.

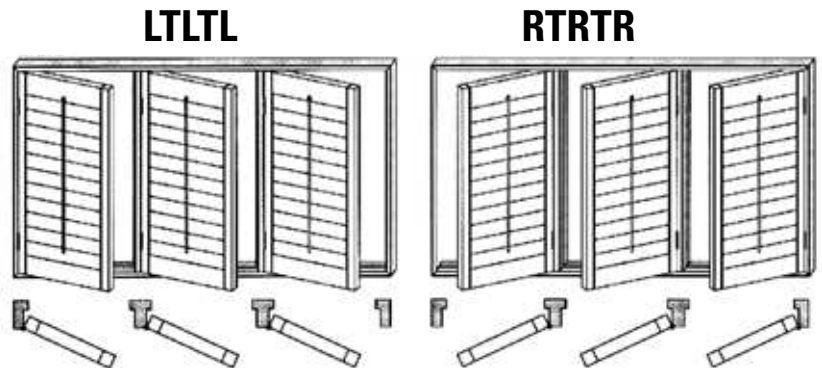
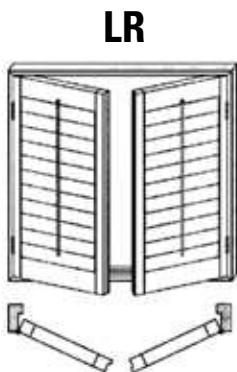
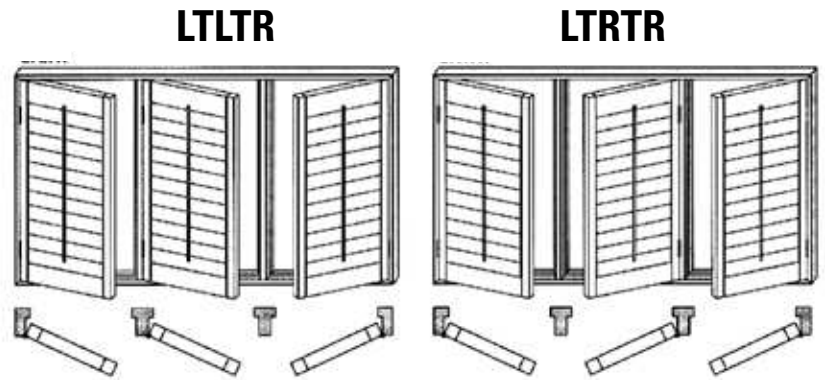
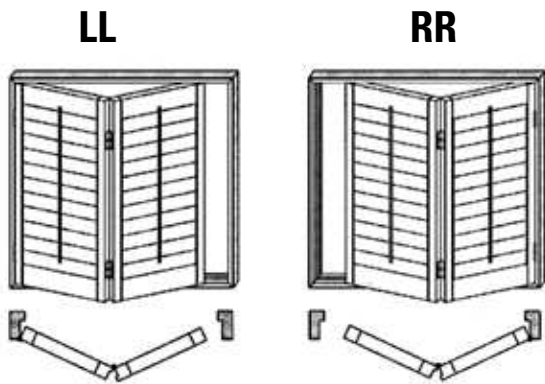
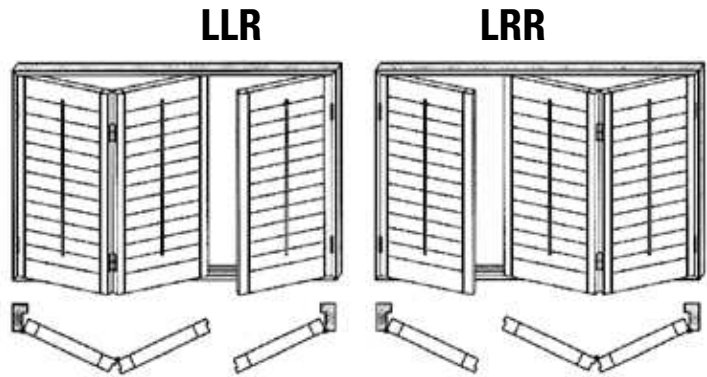
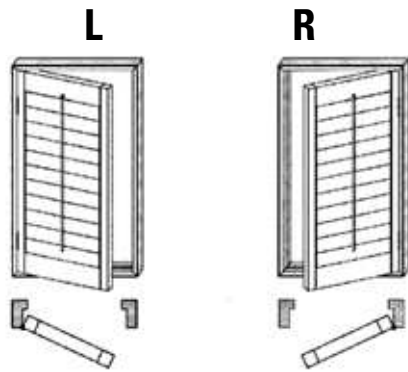



# Shutters

by Legacy Window Coverings

## Panel Configuration

### Panel configuration

**LLRR**

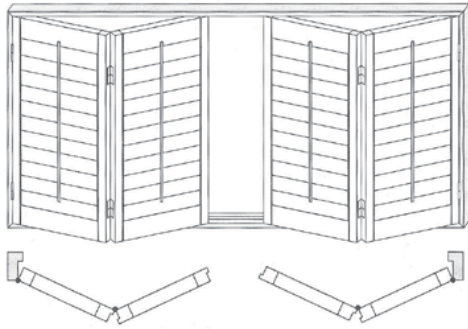

**LLTLRTRR**

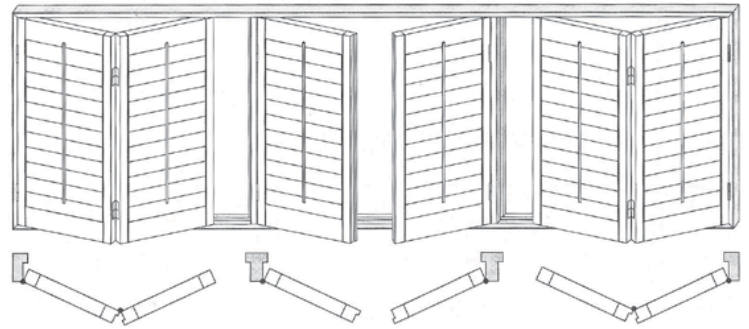

**LTLRTR**

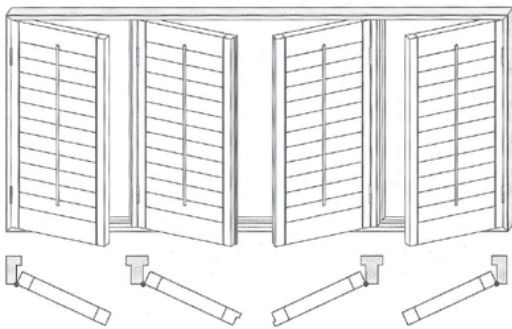

**LRTLRL**

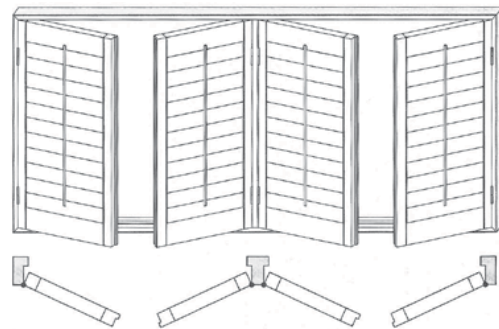

### T-posts

T-posts divide a window vertically into sections. T-posts can be used to match the design of a window that has a natural break, or mullion. T-posts can also be used to accommodate panel configurations that require more than two panels - or simply for aesthetic purposes.

Measure from the left side of the window to the center of the first T-post location for measurement A. For more than one T-post, always start from the left and measure to the center (see diagram) of each T-post.

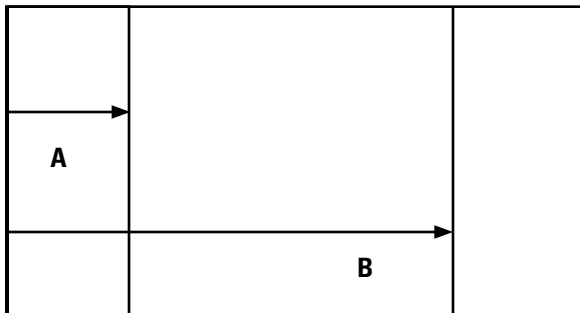

When ordering finished frame, measure from the left edge of the frame to the center of the T-post.

When existing sills are present, finished frame measurements are required to ensure the shutter frame matches the width of the sill. Be sure louver clearance is not an issue.

- See page 16 for T-post specifications

When providing T-post measurements consider equal panel widths. Is it possible to create equal openings for aesthetic value?

# Shutters

by Legacy Window Coverings

## Bay Posts and Slim Fit Bay Posts

### Options

STANDARD

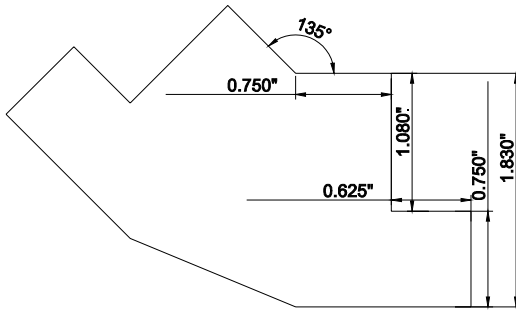

**Bay Post W/ 3/4" Light Block (L/Z/HS)**

STANDARD

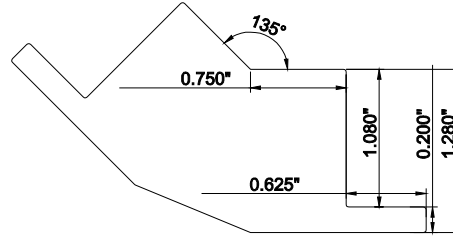

**Bay Post W/ 1/4" Light Block (Deco)**

OPTIONAL

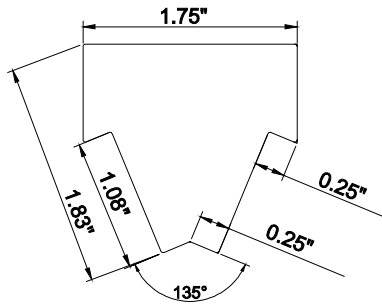

**Slim Fit Bay Post for 135 Degree (L/Z/HS)**

OPTIONAL

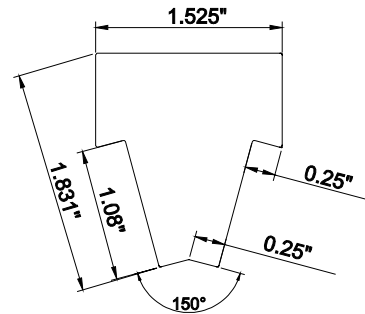

**Slim Fit Bay Post for 150 Degree (L/Z/HS)**

OPTIONAL

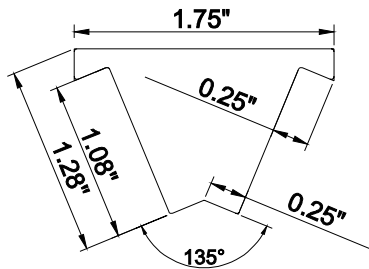

**Slim Fit Bay Post for 135 Degree Deco**

OPTIONAL

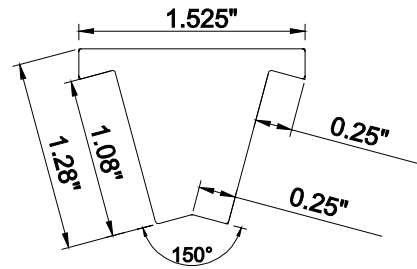

**Slim Fit Bay Post for 150 Degree Deco**



If a bay post is not selected, the standard bay post will be ordered.

# Shutters

by Legacy Window Coverings

## Selling Terms

### **Astragal stile**

Overhanging lip affixed to the right panel in a multi-panel shutter that covers the center reveal.

### **Bi-fold**

When two or more panels are hinged together and fold-up beside each other.

### **Bypass/Bi-fold track systems**

Used for arcadia door applications to provide support and guidance for panels while they are being operated.

### **Build-out**

Trim that can be attached to the frame to extend the shutter from the wall or window. It is usually used to move a shutter beyond an obstruction. Build-out is charged by panel with pricing below each shutter grid. This is a trim option. Available in 1/8" increments and surcharged.

### **Café**

Panel configuration in which a window opening has panels on the bottom half and the top half is left open.

### **Composite**

Medium density fiber board extruded with a polypropylene coating. Lifetime warranty on colorfastness and warping.

### **Composite Plus**

ABS co-polymer materials, found in auto parts, helmets and home appliances, created specifically for strength.

### **Cut-out**

Required on French doors when clearance between the escutcheon plate and the glass is less than 1 1/2".

### **Divider Rail**

Horizontal shutter component that separate a single panel into two or more independently operating sections. Divider rails are required on panels over 74" tall for Composite and 78" for all other shutters.

### **Elliptical Louver**

Oval shaped louver that adds to the overall aesthetic appeal of the shutter and ensures tight closure. Standard on all shutter lines.

### **Engineered stile**

Multiple layers of wood bonded together with pressure, heat, and glue that create the core of the stile. This process inhibits wood deformation.

### **Finished frame**

Measurement in which no factory deductions are taken.

### **Flush**

Right next to or up against; adjacent or touching.

### **Framing**

Profiles which are used to encase the shutter panels and provide a square and even mounting structure for the panels.

### **Frame detail**

Explanation of what is needed for framing of the shutter. The framing is a combination of whole frames and sill plates.

### **Hang strips**

Simple, rectangular frame pieces that are typically mounted to a window opening to support the hanging of panels.

### **Hoffman Key**

Bow-tie shaped hardware used to assemble frames.

### **Inside Mount**

A mounting method in which the product is mounted within or partially within the recessed portion of the window opening.

### **InvisibleTilt™**

This allows for view with no obstruction by the tilt rod.

### **L Frame**

L Frames can be utilized as inside or outside mounts. Typically, they are used when shutter panels need to be projected away from the wall or window to allow for louver clearance.

### **Louvers**

Panel component that rotates to offer control over light, view, privacy, and ventilation. Available in 1 7/8", 2 1/2", 3 1/2", and 4 1/2". 1 7/8" in Premium Wood, Composite and Composite Plus only.

### **Louver pins**

Hardware that connects the louver to the panel.

### **Mortise and Tenon Joinery**

Traditionally used in demanding furniture and building construction. The joint is crafted out of a mortise cut through the wood and a tenon, which fits into the mortise. Mortise and tenon joinery is standard on all Harmony™ shutters.

### **Mouse Hole**

The arch shaped recess in the top rail that allows full movement of the tilt rod to close the louvers.

### **Mullion**

A vertical or horizontal break between panes or sections of a window.

### **Out-of-Square Opening**

An opening that has unequal diagonal measurements. IB not recommended if more than 1/4" difference.

### **Outside Mount**

A mounting method in which the product is mounted to the wall or to the surface of the window casing.

### **Panel**

A shutter component that is hinged to the frame or the opening and can swing open.

### **Premium Wood**

Premium wood handcrafted with quarter-sawn wood, finished in multiple sequences of sanding and staining.

### **Prescription Wood Conditioning**

Process in which the wood is dried to conditions emulating those of the final installation location. Drying to the proper environmental conditions ensures that the shutter will resist shrinking and swelling.

### **Rabbeted Stiles**

A rabbeted stile has an interlocking shape to ensure a tighter fit between panels. The rabbet detail on the right panels close over the rabbet detail on left panel.

### **Recessed Magnet**

The hardware used to hold the panel into the frames. They are small round magnets recessed into the shutter panel.

### **Reveal**

The space between the frame and panel.

### **Selectwood**

Premium hardwood handcrafted with quarter-sawn wood, finished in multiple sequences of sanding and staining,

### **Sill Plate**

A frame type that is commonly used in three-sided applications. The sill plate is any of the frames with the decorative portion removed leaving the inner 7/8" providing something into which the panel can close.

### **Specialty Shape**

Any window that is not square or rectangular.

### **Split Tilt Rod**

A traditional tilt rod split in half to increase light and privacy control. This option can be accomplished without divider rails in panels 74" or less.

### **Stile**

The vertical side piece of a panel that is secured to the horizontal rails. The stiles have evenly spaced holes that support the louvers.

### **T-Post**

Vertical frame pieces used to divide a shutter into multiple openings.

### **Tilt Rod**

The vertical piece of hardware attached to the louvers that enable them to operate in unison.

### **Window Size**

Measurement in which allowances are taken or added.

### **Whole Frame**

Frame with no alterations.

### **Z Frame**

An inside mount frame that does not fully recess into the window opening. The frame is designed to wrap around the front of the opening or a framed window, eliminating light gaps.

# SPECIALTY SHAPE MEASURE SHEET

## Composite Plus, Premium Wood and Selectwood

Customer Name \_\_\_\_\_

Page \_\_\_\_\_ of \_\_\_\_\_

Line # \_\_\_\_\_

**Sunburst Arch Only**

A. Width: \_\_\_\_\_

B. Height: \_\_\_\_\_

C. Leg Height (if any): \_\_\_\_\_

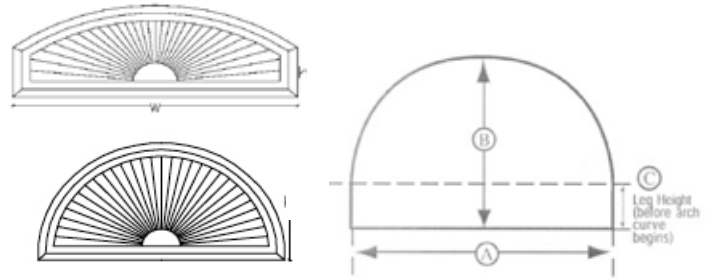

**Sunburst Arch With a Shutter or Blind Below**

A. Width: \_\_\_\_\_

B. Height to center of mullion: \_\_\_\_\_

C. Arch max. height: \_\_\_\_\_

D. Arch leg height (if any): \_\_\_\_\_

Check One:

Shutter below (line # \_\_\_\_\_ from custom order form)

Blind below (line # \_\_\_\_\_ from purchase order)

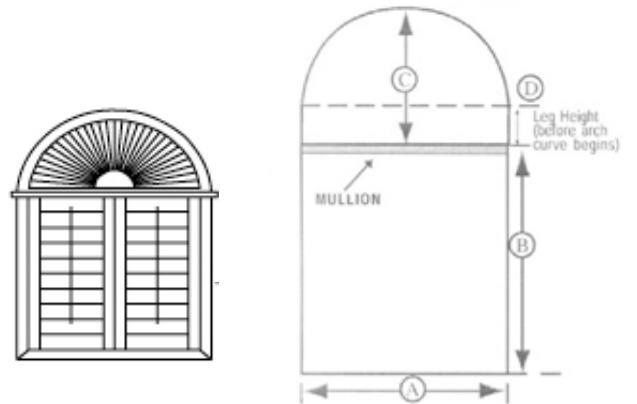

**Louvered Door Arch or Quarter Arches**

A. Width: \_\_\_\_\_

B. Height: \_\_\_\_\_

C. Leg Height (if any): \_\_\_\_\_

D. Center Leg Height: \_\_\_\_\_

Check one:

Louvered Door Arch

Louvered Door with Sunburst Top

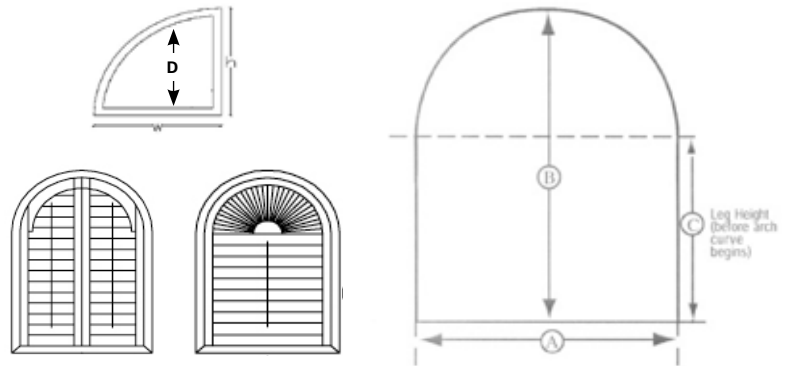

**Other Specialty Shape**

Write in the measurement and if possible draw in notes, or submit separate drawing.



Notes:

06202010\_V1.0

# FRENCH DOOR MEASURE SHEET TYPE A & B

## French Doors

NOTE: Requires 1 1/2" clearance between the outside edge of the door trim and the inside edge of the handle/lock base plate. Otherwise a cutout will be required.

Measure from outside edge of trim to outside edge of trim.

Width \_\_\_\_\_

Height \_\_\_\_\_

Outside edge of door trim to inside edge of handle/lock base plate. \_\_\_\_\_

A & B Cutouts

L - Frame Only

A panel with 2 1/2" or 3 1/2" louvers will need a 1/2" (L5) extension added to the L-Frame.

A panel with 4 1/2" louvers will need a 1" (L1) extension added to the L - Frame.

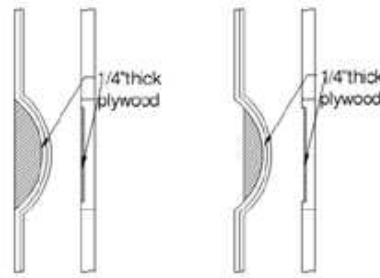
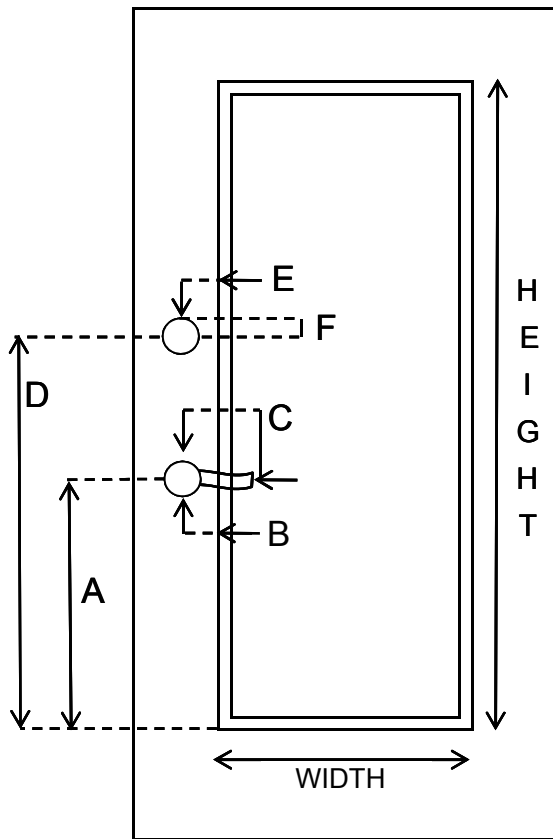

Type A

Type B

A- Door with no protruding trim  
B- Door with protruding trim

A. Bottom of existing trim to center of the knob/handle pivot. \_\_\_\_\_

B. Edge of existing trim to center of the knob/handle pivot. \_\_\_\_\_

C. End of handle to center of the knob/handle pivot. \_\_\_\_\_

D. Bottom of existing trim to center of the lock. \_\_\_\_\_

E. Edge of existing trim to center of the lock. \_\_\_\_\_

F. Center of lock/handle to top edge of the lock/handle base plate. (radius of base plate) \_\_\_\_\_

G. Projection of existing trim. \_\_\_\_\_

H. Is the knob/handle on the left or right side of the door? \_\_\_\_\_

I. Does the frame require a cutout? \_\_\_\_\_

a. If no, you must have at least 1 1/2 inches between the edge of the base plate and the existing trim.

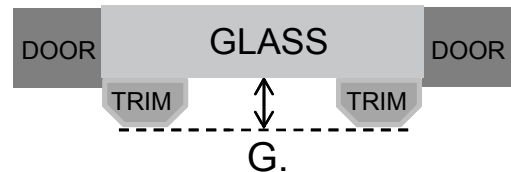

\* If your French door does not have a lock/handle, please write "N/A" on D, E, F, and H

\*\* Cutout block will be made according to "Type B" if the knob/handle or lock base plate can hit the cutout block otherwise, the cutout block will be made according to "Type A"



If your knob/handle base plate is square or rectangular we suggest using a "Type C" or "Type D" Cutout block

# FRENCH DOOR MEASURE SHEET TYPE C & D

## French Doors

NOTE: Requires 1 1/2" clearance between the outside edge of the door trim and the inside edge of the handle/lock base plate. Otherwise a cutout will be required.

Measure from outside edge of trim to outside edge of trim

Width \_\_\_\_\_

Height \_\_\_\_\_

Outside edge of door trim to inside edge of handle/lock base plate. \_\_\_\_\_



Deco Frame

L - Frame

A panel with 2 1/2" or 3 1/2" louvers will need a 1/2" (L5) extension added to the L-Frame. A Deco frame will require a 1" x 1" extension.

A panel with 4 1/2" louvers will need a 1" (L1) extension added to the L - Frame.. A Deco frame will require a 1 1/2 "x 1" extension.

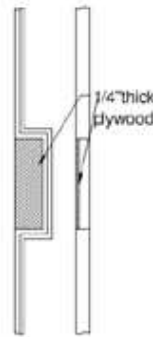
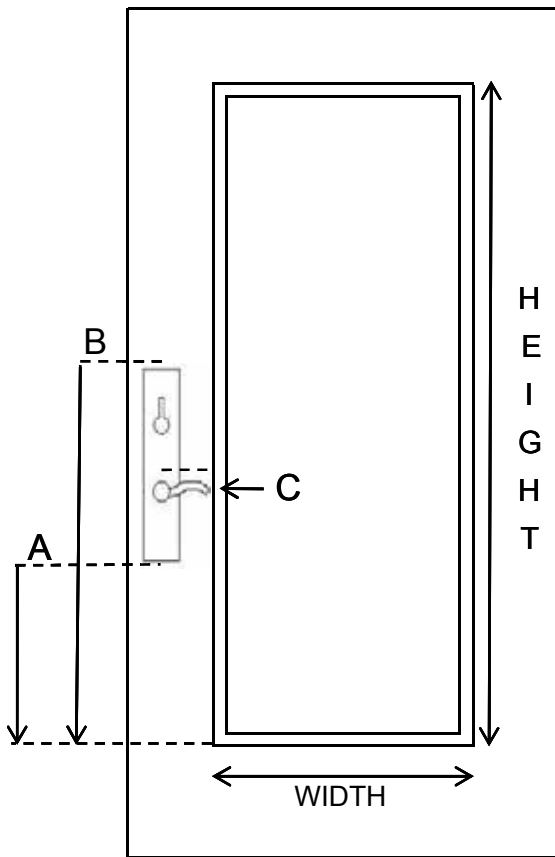

Type C  
Without  
Trim

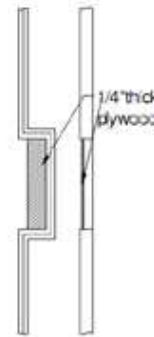

Type D  
With  
Trim

A. Bottom of existing trim to the bottom of the cutout. \_\_\_\_\_

B. Bottom of existing trim to the top edge of the cutout. \_\_\_\_\_

C. Depth of the cutout. \_\_\_\_\_

D. Projection of existing trim. \_\_\_\_\_

E. Is the knob/handle on the left or right side of the door? \_\_\_\_\_

F. Does the frame require a cutout? \_\_\_\_\_

a. If no, you must have at least 1 1/2" inches between the edge of the base plate and the existing trim.

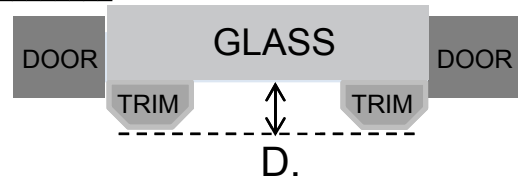

\* Depth of the cutout block is determined by your handle length plus a 1/2" inch.

\*\* We highly recommend rotating the lever handle up and down to make sure the bottom of the cutout block and the top of the cutout block are located in the proper location

\*\*\* Cutout block will be made according to "Type D" if the knob/handle or lock base plate can hit the cutout block otherwise, the cutout block will be made according to "Type C".



If your knob/handle base plate is round or oval we suggest using a "Type A" or "Type B" Cutout block



# FRENCH DOOR MEASURE SHEET TYPE E

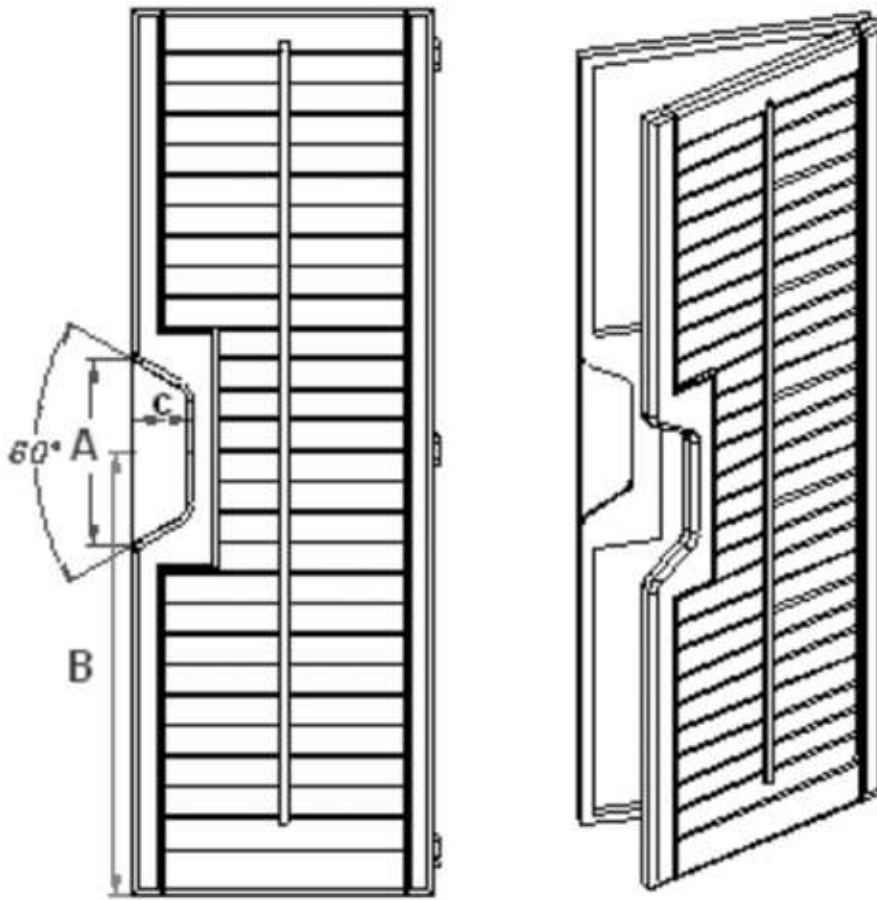

## Max frame to frame measurement only

Type E: height (A) and depth (C) of cutout

Batten thickness:

Louver Size	Batten Thickness
1 1/4", 1 7/8", 2 1/2"	1"
3 1/2"	1 3/8"
4 1/2"	1 7/8"

A	C
8 1/2"	2 1/2"
9 1/2"	3 1/2"
11"	4 1/2"
12"	3 1/2"
13 1/2"	4 1/2"

A = Height of Rectangular flush cutout \_\_\_\_\_

B = Bottom of panel to center of cutout \_\_\_\_\_

C = Depth of cutout \_\_\_\_\_

D = Projection of trim \_\_\_\_\_

E = Is the handle on the left or right side of the door? \_\_\_\_\_

F = Batten thickness 3/4" x \_\_\_\_\_

# FRENCH DOOR MEASURE SHEET TYPE F

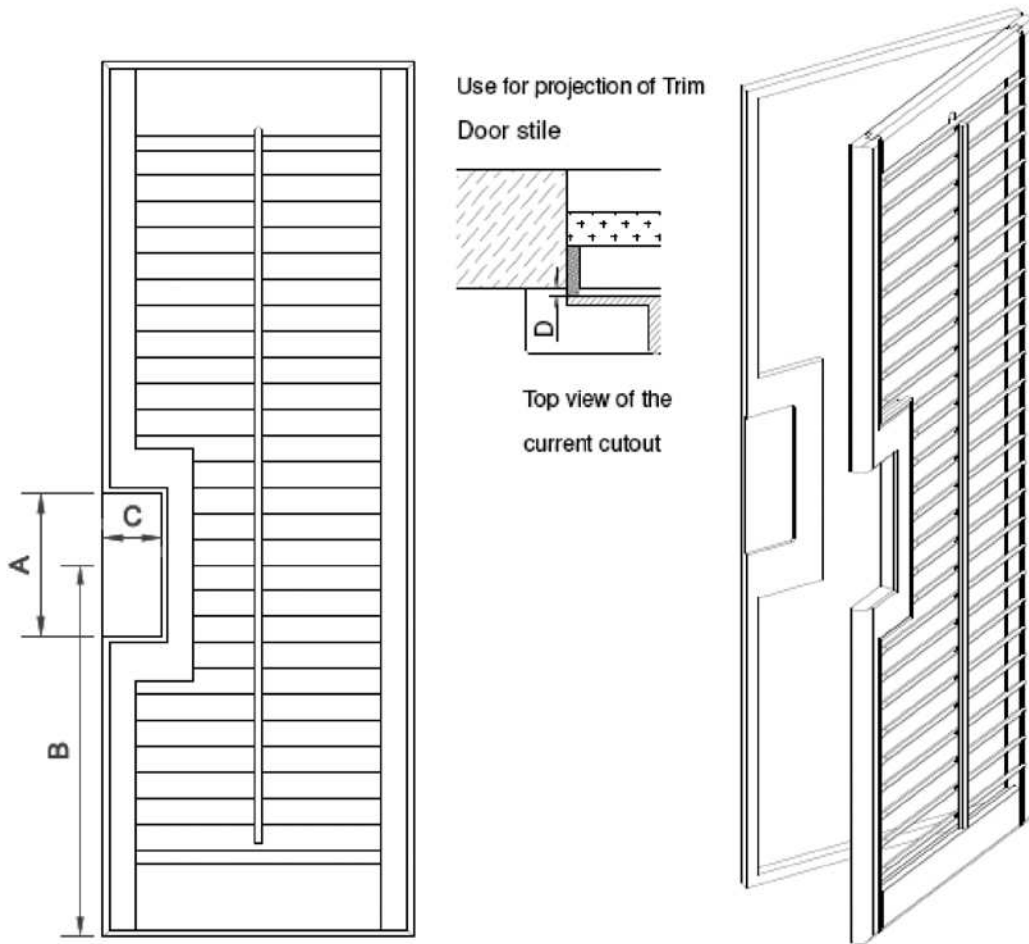

## Max frame to frame measurement only

Batten thickness:

Louver Size	Batten Thickness
1 1/4", 1 7/8", 2 1/2"	1"
3 1/2"	1 3/8"
4 1/2"	1 7/8"

A = Height of Rectangular flush cutout \_\_\_\_\_

B = Bottom of panel to center of cutout \_\_\_\_\_

C = Depth of cutout \_\_\_\_\_

D = Projection of trim \_\_\_\_\_

E = Is the handle on the left or right side of the door? \_\_\_\_\_

F = Batten thickness 3/4" x \_\_\_\_\_

# TRACK SYSTEM MEASURE SHEET

Customer Name \_\_\_\_\_  
 Page \_\_\_\_\_ of \_\_\_\_\_  
 Line # \_\_\_\_\_  
 page 1 of 2

Check one for the measurement you are providing

- Window Size** including casing
  - If casing is present, Legacy will add 3 1/2" to width and 3 1/2" to height
  - If there is no casing, Legacy will add 3 1/2" to width and 4 1/2" to height
- Finished frame-to-frame** (no deductions will be taken)  
 Measurements are from the top of fascia to the floor

- A. Width \_\_\_\_\_
- B. Height \_\_\_\_\_
- C. Divider Rail Location \_\_\_\_\_  
 (Will be placed in center if required and location is not indicated)
- D. Is there casing?  
 Yes  No
- E. Select one
  - Open Bypass
  - Closed Bypass
  - Bi-fold 90 Degree
  - Bi-fold 180 Degree

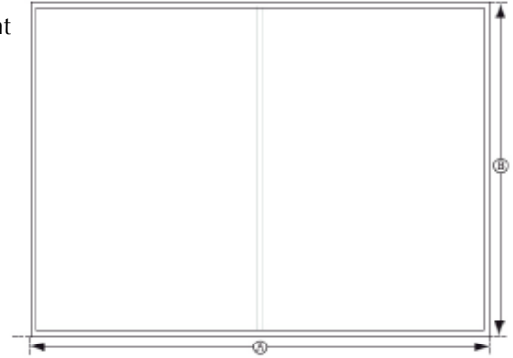

## SECTION A - BI-FOLD 90 DEGREE

### HEADER DIMENSIONS

- 3"
- 3 1/2"

### PANEL CONFIGURATION

- LL
- RR
- LLRR
- LLLL (sliders below this line are not available in Composite and Composite Plus)
- RRRR
- LLRRRR
- LLLLRR
- LLLLRRRR

### MOUNT TYPE

- Outside
- Semi-Inside
- Inside

## SECTION B - BI-FOLD 180 DEGREE

### HEADER DIMENSIONS

- 3"
- 3 1/2"

### PANEL CONFIGURATION

- LL
- RR
- LLL (Available in Select wood and Premium wood only)
- RRR (Available in Select wood and Premium wood only)
- LLRR
- LLLRRR (Available in Select wood and Premium wood only)



Outside Mount Only; Max frame-to-frame width = window width plus 3 1/2"  
 max frame-to-frame height = window height plus 3"

# TRACK SYSTEM MEASURE SHEET

Customer Name \_\_\_\_\_  
Page \_\_\_\_\_ of \_\_\_\_\_  
Line # \_\_\_\_\_  
page 2 of 2

## SECTION C - CLOSED BYPASS (Louvers must be closed to stack panels in front of each other.)

### BOXOUT

- Boxout with plain fascia
- Boxout with decorative fascia
- No boxout frame (no fascia)

### PANEL CONFIGURATION (see reverse side)

- Center Open
- Side Open two panels
- Side Open four panels
- Three Panel Center Front



Door hardware must not protrude into room more than 1 1/2". The selection of louver size should be made carefully, paying close attention to the protrusion (if any) of door casing and/or door hardware. If providing finished frame-to-frame, size should be from the top of the fascia to the floor.

## SECTION D - OPEN BYPASS (Louvers can bypass each other when louvers are in the open position.)

### BOXOUT

- Boxout with plain fascia
- Boxout with decorative fascia
- No boxout frame (no fascia)

### PANEL CONFIGURATION (see reverse side)

- |  |  |
|--|--|
| <b>2 PANEL</b>                                       | <b>4 PANEL</b>                                       |
| <input type="checkbox"/> Side Open - Right over Left | <input type="checkbox"/> Side Open - Right over Left |
| <input type="checkbox"/> Side Open - Left over Right | <input type="checkbox"/> Side Open - Left over Right |
| <b>3 PANEL</b>                                       | <input type="checkbox"/> Center Open - Front         |
| <input type="checkbox"/> Three Panel Center Front    | <input type="checkbox"/> Center Open - Back          |



Shutter must always be mounted on a flat wall. It cannot be made less than 3-1/2" wider or 3" taller than your window opening or trim measurements.

# Shutters

by Legacy Window Coverings

## Bi-Fold 90

### Outside Mount : Side View

### Min/Max Panel Width and Height

		Min	Max		
			1 1/4" Louver	1 7/8" Louver	2 1/2", 3 1/2" & 4 1/2" Louver
Single Panel Width for Bi-Fold (LL or RR)	Composite & Composite Plus	6"	NA	24"	24"
	Selectwood & Premium Wood	6"	NA	26"	26"
Single Panel Width for (LLL or RRR)	Composite & Composite Plus	NA	NA	NA	NA
	Selectwood & Premium Wood	6"	NA	20"	20"
Single Panel Height	All	10"	NA	133"	133"

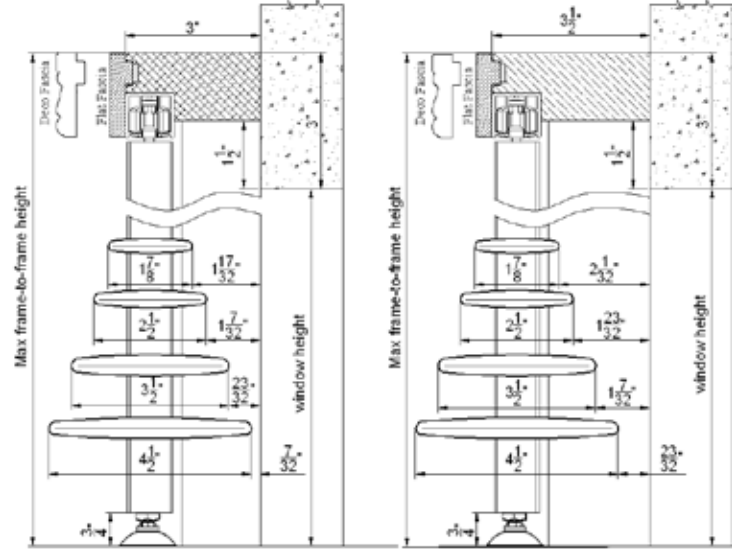

### Side View

### Top View

#### Inside Mount

#### Semi-Inside Mount

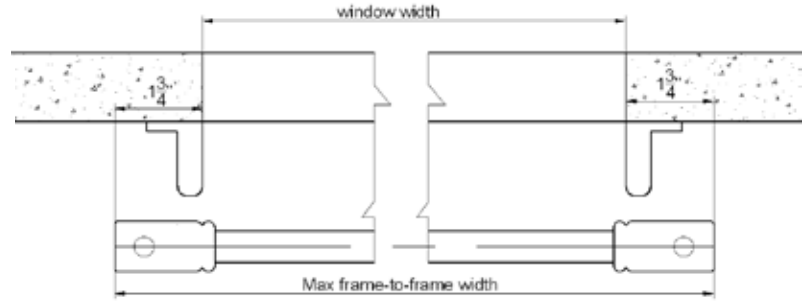
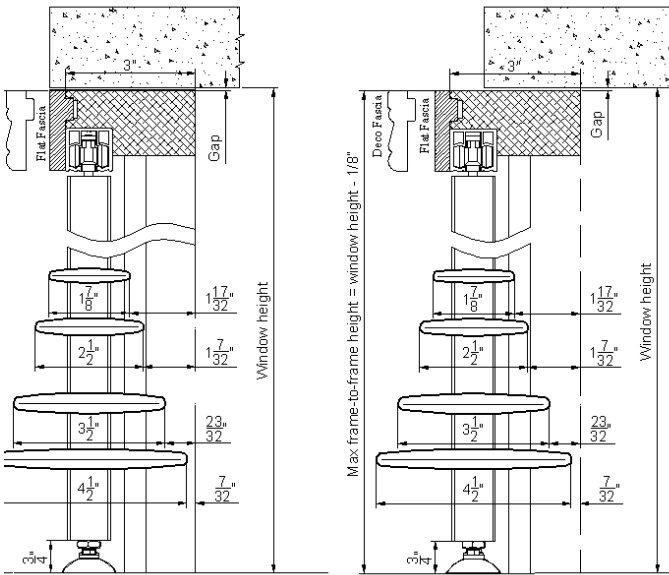

### Top View

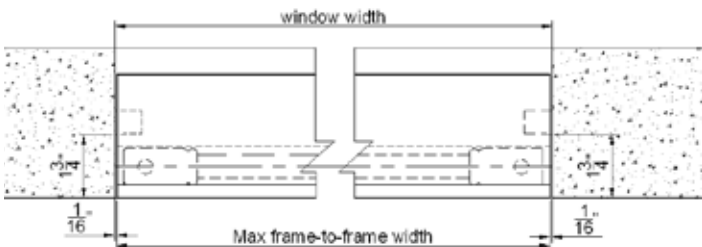

	Header Depth	Top Fascia Height	Light Block Dimensions
Outside Mount	3"	1 7/8"	1 1/2"
	3 1/2"	1 7/8"	2"
Inside Mount	3"	1 7/8"	5/8" x 3/4"
Semi-Inside Mount	3"	1 7/8"	5/8" x 3/4"

# Shutters

by Legacy Window Coverings

## Bi-Fold 180

### Min/Max Panel Width and Height

		Min	Max		
			1 1/4" Louver	1 7/8" Louver	2 1/2", 3 1/2" & 4 1/2" Louver
Single Panel Width for Bi-Fold (LL or RR)	All	6"	NA	24"	24"
	All	6"	NA	26"	26"
Single Panel Width for (LLL or RRR) Not available in Composite and Composite Plus	Composite and Composite Plus	NA	NA	NA	NA
	Premium Wood and Selectwood	6"	NA	20"	20"
Single Panel Height	All	10"	NA	133"	133"

Side View

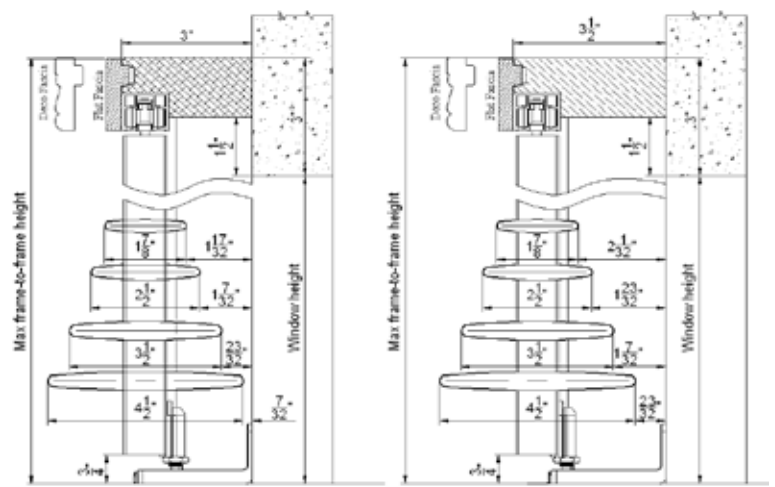

Top View

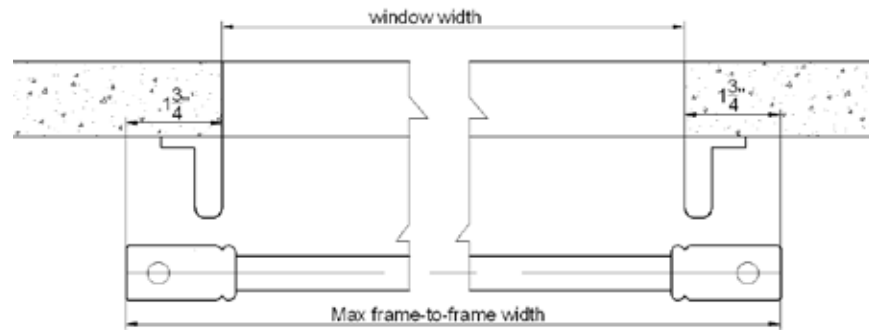

Side View

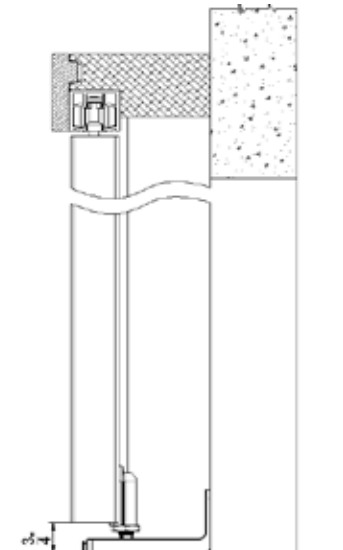

1. Bi-Fold 180 is for Outside Mount ONLY
2. A single track is pre-installed on the header.
3. Custom extensions of up to 2" are available upon request, surcharge applies.

Header Depth	Top Fascia Height	Light Block Dimensions
3"	1 7/8"	1 1/2"
3 1/2"	1 7/8"	2"

# Shutters

by Legacy Window Coverings

## Closed Bypass

### Min/Max Panel Width and Height

	Min	Max			
		1 1/4" Louver	1 7/8" Louver	2 1/2" Louver	3 1/2" & 4 1/2" Louver
Single Panel Width for Composite	6"	NA	24"	30"	30"
Single Panel Width for Selectwood & Premium Wood	6"	20"	30"	36"	42"
Single Panel Height for All	10"	NA	133"	133"	133"

### Outside Mount

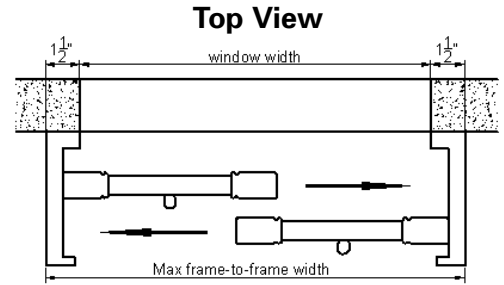

### Semi-Inside Mount

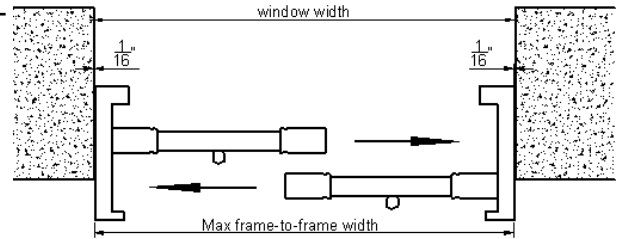

### Closed Bypass

### Inside Mount

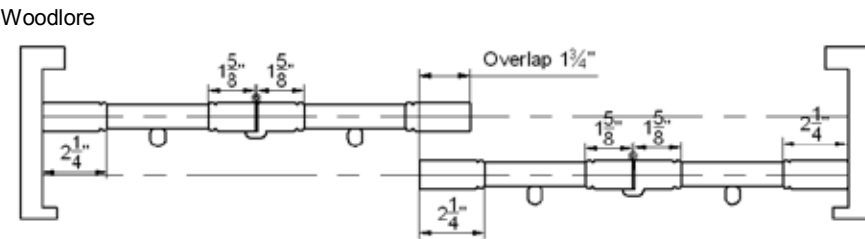
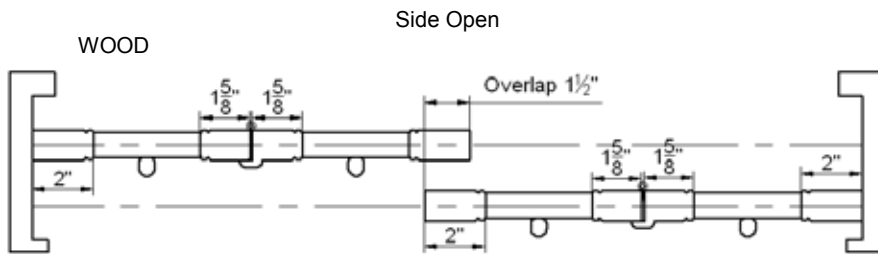
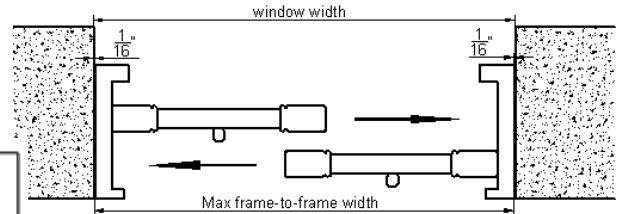

### Center Open

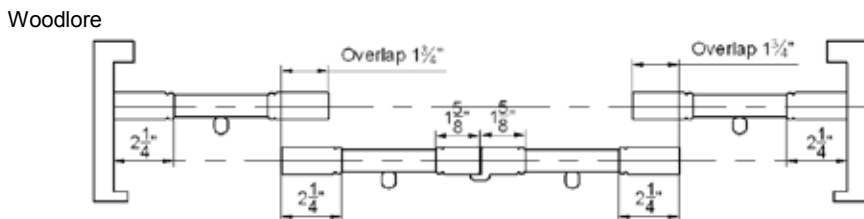
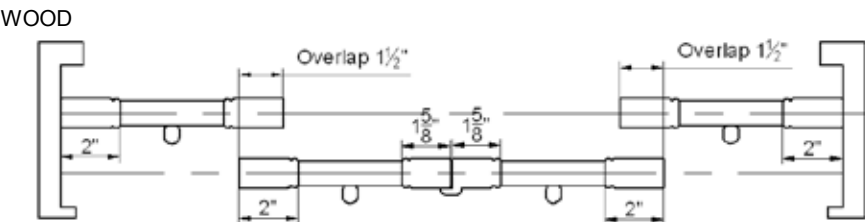

08202015\_v1.0



# Shutters

by Legacy Window Coverings

## Open Bypass

### Min/Max Panel Width and Height

	Min	Max			
		1-1/4" Louver	1-7/8" Louver	2-1/2" Louver	3-1/2" & 4-1/2" Louver
Single Panel Width for Composite & Composite Plus	6"	NA	24"	30"	30"
Single Panel Width for Selectwood & Premium Wood	6"	20"	30"	36"	42"
Single Panel Height for All	10"	NA	133"	133"	133"

### Options

#### 2 PANELS CONFIGURATION

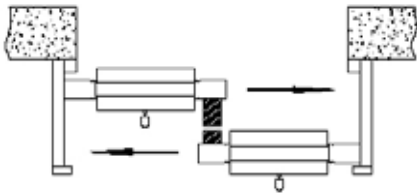

Side Open-Right over Left

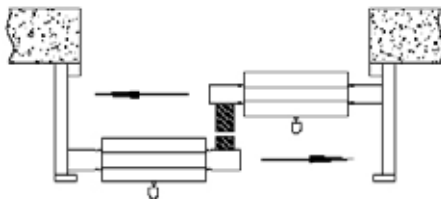

Side Open-Left over Right

#### 3 PANELS CONFIGURATION

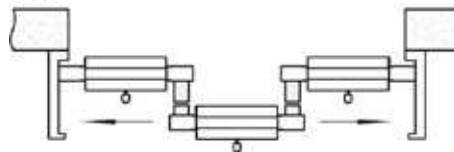

Open Bypass 3 Panel Center Front

#### 4 Panel S configuration

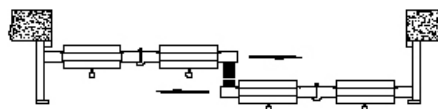

Side Open-Right over Left

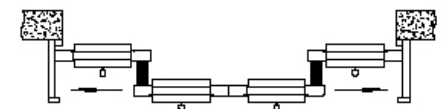

Center Open-Front



Side Open-Left over Right

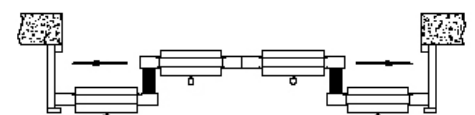

Center Open-Back

# Shutters

by Legacy Window Coverings

## Custom Color Match Policy & Consent Form

Custom color matching is available in the Premium Wood line of shutters only. To order Custom Color Match

All custom colors will be finished with the STANDARD GLOSS used on all Harmony Premium Wood Shutters. The difference in size from a color swatch to the finished product may also affect the overall look and perception of the finished product's color.

### Cancellation and Modification

Once an order has been submitted, the custom color surcharge fee is not refundable. If the customer should decide not to follow through with a custom color order AFTER the confirmation email and/or the color confirmation swatch has been sent out from the factory, the customer MUST STILL PAY for the custom color surcharge fee. If the customer decides to change the color he or she had chosen AFTER the confirmation email and/or the color confirmation swatch has been sent out from the factory, the customer MUST PAY AN ADDITIONAL custom color surcharge fee.

### Color Sample Match

We will provide the best match of our paints and stains to the Sherwin-Williams® or Benjamin Moore® paint that you specified, or the color sample that you provided. Please be aware that we will only be able to MATCH THE TONE, NOT THE TEXTURE OR FINISH of the color sample you send. Differences in material, texture, and staining and painting methods can affect the final look of a natural wood product. For color samples with multiple tones, please state clearly which tone you would like to match. To ensure that we get the best match to the color that you have chosen, please provide a sample without smudges or other color tainting marks. Remember to also keep a color sample for your reference.

### Custom Solid

- Choose a color from the Sherwin-Williams® Color™ (#657-2846 CS 4/06) or Benjamin Moore® Classic Colors® (# /M5900010), or
- Send in a color sample of solid color

### Custom Stain

- Send in a color sample of stain

### Confirmation

- A high quality digital photo will be e-mailed to the decorator to confirm the tone before the order goes to production.
- Customer may request an actual swatch to confirm the color prior to production at an additional shipping and handling fee. This is required for custom paint.

### Production Lead Time

- For RECTANGULAR product custom color orders, the lead time is SIX to EIGHT WEEKS from the day you confirm your custom color AND all other related on-hold questions.
- For SPECIALTY product custom color orders, the lead time will be EIGHT to TEN WEEKS from the day you confirm your custom color AND all other related on-hold questions.
- If customer chooses to confirm custom color with an actual swatch, it will take approximately two weeks (which will add to the lead time) from the time the factory receives the color sample of their desired color until a matching swatch is mailed to the customer.

### Color Sample Storage

As an added convenience for the customer, the wood color chip of a product that is made will be stored up to ONE YEAR for remakes, re-orders, and/or new orders. All re-orders and/or new orders from a stored color swatch are subject to the standard custom color fee. A sample from the original product is required for remakes and re-orders after one year.

This is a custom color request for:

- Custom Solid Color
- Custom Stain Color

Custom color verification:

- Digital Photo (Stain Only)
- Actual Swatch - I understand that there is an additional shipping and handling fee.

Enclosed is a color sample at least 2"x 2" in size, without smudges and color tainting marks. I understand that IWC will only be able to match the tone and not the texture of the color sample I send.

Please send a copy of this form in the package with the color sample.

*I understand and accept that there may be variations in the finished product from both the original sample color and/or the color confirmation photo/sample due to factors such as those mentioned above, and that such variations within industry tolerances do not constitute or create sufficient or valid reason for refusal of any order, nor to withhold or refuse payment towards my account. I also agree to comply fully with all the policies stated above.*

Decorator Name: \_\_\_\_\_

Sidemark: \_\_\_\_\_ PO#: \_\_\_\_\_ Date: \_\_\_\_\_

Decorator Signature: \_\_\_\_\_

Customer Signature: \_\_\_\_\_

# Shutters

by Legacy Window Coverings

## Wood Shutter Checklist

### IT'S TIME TO GET REAL ABOUT REAL WOOD SHUTTERS

You get what you pay for. When shopping for real wood shutters, we encourage you to ask tough questions and demand a shutter that is built to last. Below is a checklist of things you should expect from your shutters.

#### **Are the louvers produced from logs that are quarter sawn?**

Our shutters are made from quarter sawn wood that produces louvers of remarkable strength, stability and beauty. As a result, our shutters are less susceptible to cupping, bowing and warping. Flat sawn wood is widely substituted in less expensive wood shutters because it is much more plentiful and inexpensive.

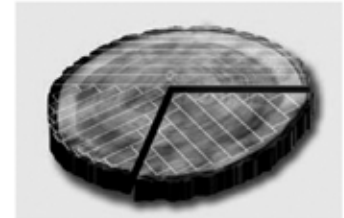

#### **Is the wood prescription conditioned?**

Kiln dried wood gets you only half way there. It doesn't mean much unless the right amount of moisture is reintroduced. We employ a patented wood drying technique to reduce shrinking and swelling in each shutter. Our wood conditioning specialist determines the humidity conditions of each customer's home location. The wood for the shutter order is dried to conditions emulating those of the final installation location.

#### **Are mortise and tenon joints used?**

Employing the right joint for the job is one of the hallmarks of fine wood crafting. Proper wood joinery is critical to the prolonged quality of a shutter. Mortise and tenon joints are far superior to butt or dovetail joints and are designed to resist shear and racking forces.



#### **How is the wood finished?**

Cheap wood shutters typically have a rough finish. Don't settle for semi-custom or pre-painted components. Our shutters are sanded and finely coated with high quality stain or paint six times, assuring a silken and lustrous finish. The finish is also UV cured which prevents fading of the color over time. Can't find the perfect color match in our palette, let us custom match your color.

#### **Are the tilt rod staples failure proof?**

Who knew staples were so important? We did. One of the most bothersome experiences of shutter ownership is staple failure. Our stainless steel staple resists corrosion and changes due to heat. They are also longer than the industry standard and affixed with friction-actuated glue.

#### **Are reinforced engineered stiles used?**

Nobody wants their shutters to cup, bow or twist. And yet we are the only manufacturer to use reinforced engineered wood, employing a procedure that bonds multiple layers of wood together with pressure, heat, and a proprietary chemical formulation. This imparts an intense level of stability to the cores of our stiles and results in a robust support system for your shutter panels.



#### **Are the louver pins one piece or two?**

Most shutters are built with a single piece louver pin. When the louver is moved, it turns in the wood. The benefit of a two piece louver pin is that one piece turns inside the other. This prevents 'lazy louvers' over time.

# Shutters

by Legacy Window Coverings

## Composite Benefits

### DON'T BE FOOLED

Real wood isn't necessarily better - and certainly not cheap wood shutters. Real wood is subject to Mother Nature's ability to grow perfect trees - which just doesn't happen. Wouldn't you prefer to own a shutter engineered to overcome life's imperfections? Oh, and it's environmentally friendly and backed by a lifetime warranty. What more could you ask for?

### IT'S GREEN

Up to 70% of a basswood tree is discarded when making a basswood shutter. When a basswood tree is cut from a forest, it takes 100 years for another basswood tree to grow in its place. Harmony Composite Shutters are made from fast-growth trees farmed in Chile, Argentina. An amazing 80-90% of the tree is used to create our shutters. Better yet, the growth cycle for these trees is only 8 years.

Harmony Composite Shutters are 97% wood. The trees are ground to pulp, then artificial "sap" is added to create a flat, uniform board - with no knots to extract, no cut-out waste. All shutters are made with a solid composite wood core, giving louvers and panels a hearty, substantial feel that is much more like natural wood than hollow vinyl products.



Our UV inhibitors protect against color fading and yellowing, and our patented polypropylene coating resists staining to ensure long-term performance in a variety of environments - withstanding temperatures up to 200°F. And with no VOC's (volatile organic chemical compounds) entering the atmosphere, Harmony Composite is the eco-friendly choice. You'll be happy to know that this coating also makes clean up a snap.

### BUILT TO LAST

Harmony Composite Shutters are engineered to resist twisting, bowing and cupping. We use reinforced engineered wood, employing a procedure that bonds multiple layers of wood together with pressure, heat, and a proprietary chemical formulation. This imparts an unsurpassed level of stability to the cores of our stiles and results in a robust support system for your shutter panels.



Our hidden, recessed magnets not only look better, they perform. Our panels close tightly and securely for a streamlined appearance.

One of the most bothersome experiences of shutter ownership is staple failure. Our stainless steel staple resists corrosion and changes due to heat. They are also longer than the industry standard and affixed with friction-actuated glue. If that weren't enough, we also use brads to reinforce the top and bottom rail. The difference truly is in the details.



### DEMAND THE BEST

Shutters can be a costly, but worthwhile investment, adding enjoyment and value to your home. That's why we stand behind our shutters. Harmony Composite offers a color-fast, lifetime warranty, which is not the case with other shutters.

JCPenney warrants against defects in materials or workmanship provided that the treatment is measured and installed correctly in the window for which they were intended, for as long as the original retail purchaser owns the product.

If you purchase a cheap wood shutter to save money, you are getting what you paid for. Instead, invest in the very best composite shutter in the market for years of trouble-free use. We set the standard. Go ahead, ask the tough questions and demand a shutter that is built to last, Harmony.



# Shutters

by Legacy Window Coverings

## Warranty

### Warranty

Legacy Window Coverings shutters are backed by a Lifetime Limited Warranty against original defects in materials or workmanship for as long as the original purchaser owns the shutter(s), provided that such products were properly installed. Any resale or other transfer of the product and/or materials voids this warranty.

Composite shutters have a Lifetime Limited warranty covering colorfastness and warping. Painted and stained shutters have a 3 year warranty covering colorfastness. Wood materials may warp in high humidity areas. The manufacturer considers this normal wear and tear and is not covered by this warranty.

Motorization components are covered for two years from the date of purchase.

### To Obtain Warranty Service

- Please contact Legacy Window Coverings for warranty assistance
- Visit [www.harmonyjcp.com](http://www.harmonyjcp.com) for product guides and technical support.

Repair or remake of defective products is the sole remedy under this warranty and in no event shall Legacy Window Coverings or its licensed distributors or dealers be liable for costs to remove and/or reinstall the product. Repairs will be made with like or similar parts. This warranty does not include shipping charges, costs of labor for measuring, installation, or trip charges. Warranty claims must be accompanied by proof of purchase, as well as details regarding the nature of the problem, location of the product, etc.

### Please Note:

This warranty does not cover any conditions caused by normal wear and tear, unauthorized repairs, accidents, alterations, misuse, abuse, exposure to the elements, excessive humidity, fading, failure to follow instructions for measurement, installation, cleaning or maintenance. This warranty is exclusive and in lieu of all other obligations, liabilities or warranties. All other warranties, both expressed and implied, are explicitly disclaimed. In no event shall Legacy Window Coverings distributors/dealers be liable or responsible for incidental or consequential damages, or for any other direct or indirect damage, loss, cost, expense or fee. Some states do not allow the exclusion or limitation of implied warranties, or incidental or consequential damages, so the above limitation may not apply to your state.

### Exceptions:

Different warranty periods and terms apply for commercial products and applications.



FOR ADDITIONAL IDEAS AND INSPIRATION PLEASE  
LOOK FOR OUR DECOR INSPIRATIONS BOOK

