

Introduction

This parts guide is designed to assist in ordering replacements parts for standard gear drives. Consult Factory for special or modified drives.

- IDENTIFY DRIVE** — Record Drive Model, Ratio and M.O. Number from nameplate.

Sample Nameplate

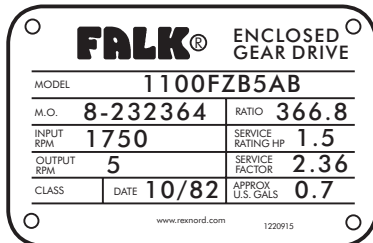

Gear Drive Identification

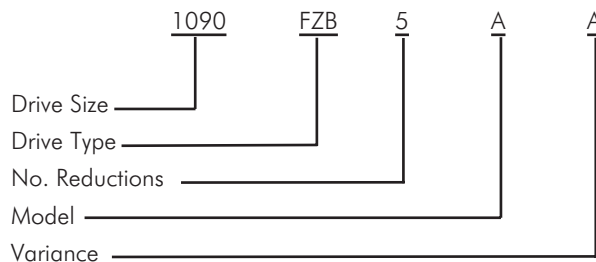

Variance Definitions

Blank = Standard Drive
 A = Drive equipped With Backstop
 S = Special — Refer to Factory

- IDENTIFY INDIVIDUAL PARTS** — Use exploded view on Pages 2 & 3 to determine Ref. No. of required parts.

1C ASSEMBLY

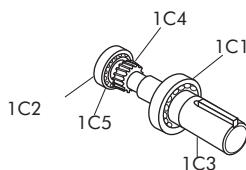

Ref. No.	Part Description
1B1	Bearing
1B2	Bearing
1B3	Shaft
1B4	Pinion
1B5	Spacer

NOTE: Replace seals, shims, and gaskets whenever reassembling a drive. Shim-gaskets and fasteners are available only in kits as shown below.

SHIMS & GASKETS — See Kit Ref. No. 100

FASTENERS — See Kit Ref. No. 130

Corrosion Protection and Storage

CAUTION: Follow guidelines below to avoid damage to parts.

- For domestic or indoor storage, Factory provides standard 24 month protection as boxed or optional 24 month protection for individual parts.
- For export or outdoor storage, Factory provides optional 18 month protection.

CAUTION: This protection does not cover exposure to elements such as standing water, etc.

Ref. No.	Part Description
14	Seal
18	Seal
18A	Seal
19	Seal
20	Dipstick
21	Seal Cage (Replace with Ref 121)
24	Seal Cage (Replace with Ref 124)
25	Seal Cage (Replace with Ref 125)
26	Bearing Cage
27	Shaft Cover (Replace with Ref 127)
28	Shaft Cover (Replace with Ref 128)
30	Shaft Cover
31	Shaft Cover
42	Spacer
43	Spacer (Sizes 60, 70 & 80)
47	Spacer
51	Thrust Plate (Sizes 90 & 100; 1070-1100)
53	Thrust Plate (Sizes 1090 & 1100/100)
54	Inner Cage (Size 70)
100	Shim-Gasket Kit (Incls Ref 84, 86, 87, 90, 94-99)
104	Housing Assembly (Incls Ref 112, 113, 20, 100, 130)
110	Head
116	Bevel Housing
117	Housing Cover
119	Yoke (Sizes 1100/100)
120	Backstop Assembly (Sizes 1100/100)
121	Seal Cage Assembly (Incls Ref 14, 21, 87)
124	Seal Cage Assembly (Incls Ref 18, 24, 86)
125	Seal Cage Assembly (Incls Ref 18, 25, 90)
127	Shaft Cover Kit
128	Shaft Cover Kit
130	Fastener Kit (Incls Ref 59, 63, 64, 65, 72-74, 80)
130	Fastener Kit (Incls Ref 62, 76, 77)
1C Shaft Assembly - Incls Ref 1C1 thru 1C4	
1C1	Bearing
1C2	Bearing
1C3	Shaft
1C4	Pinion
1C5	Spacer (Size 100)
2A Shaft Assembly - Incls Ref 2A1 thru 2A7	
2A1	Bearing
2A2	Bearing
2A4	Pinion & Shaft
2A5	Spacer (Size 1070)
2A6	Gear
2A7	Locknut
2A8	Bushing (Sizes 1080/80 & 1090/90; Not Shown)
3A Shaft Assembly - Incls Ref 3A1 thru 3A7	
3A1	Bearing
3A2	Bearing
3A3	Shaft
3A4	Pinion
3A5	Spacer (Sizes 1060-1080)
3A6	Gear
3A7	Locknut
4A Shaft Assembly - Incls Ref 4A1 thru 4A7	
4A1	Bearing
4A2	Bearing
4A4	Pinion & Shaft
4A5	Spacer (Sizes 1100/100)
4A6	Gear
4A7	Locknut
5AB Shaft Assembly - Excludes Ref 5AB4	
5AB1	Bearing
5AB2	Bearing
5AB3	Shaft
5AB4	Bevel Pinion (Replace with Ref 7AB)
5AB6	Gear
6AB Shaft Assembly - Excludes Ref 6AB6	
6AB1	Bearing
6AB2	Bearing
6AB3	Shaft (Incls Ref 6AB10)
6AB6	Bevel Gear (Replace with Ref 7AB)
6AB8	Seal Collar
6AB9	Baffle (Incls Ref 6AB11; Not Shown)
6AB10	Fasteners for Ref 6AB6
6AB11	Fasteners for Ref 6AB9
7AB Bevel Gear & Pinion (Incls Ref 5AB4, 6AB6)	

Parts Diagram

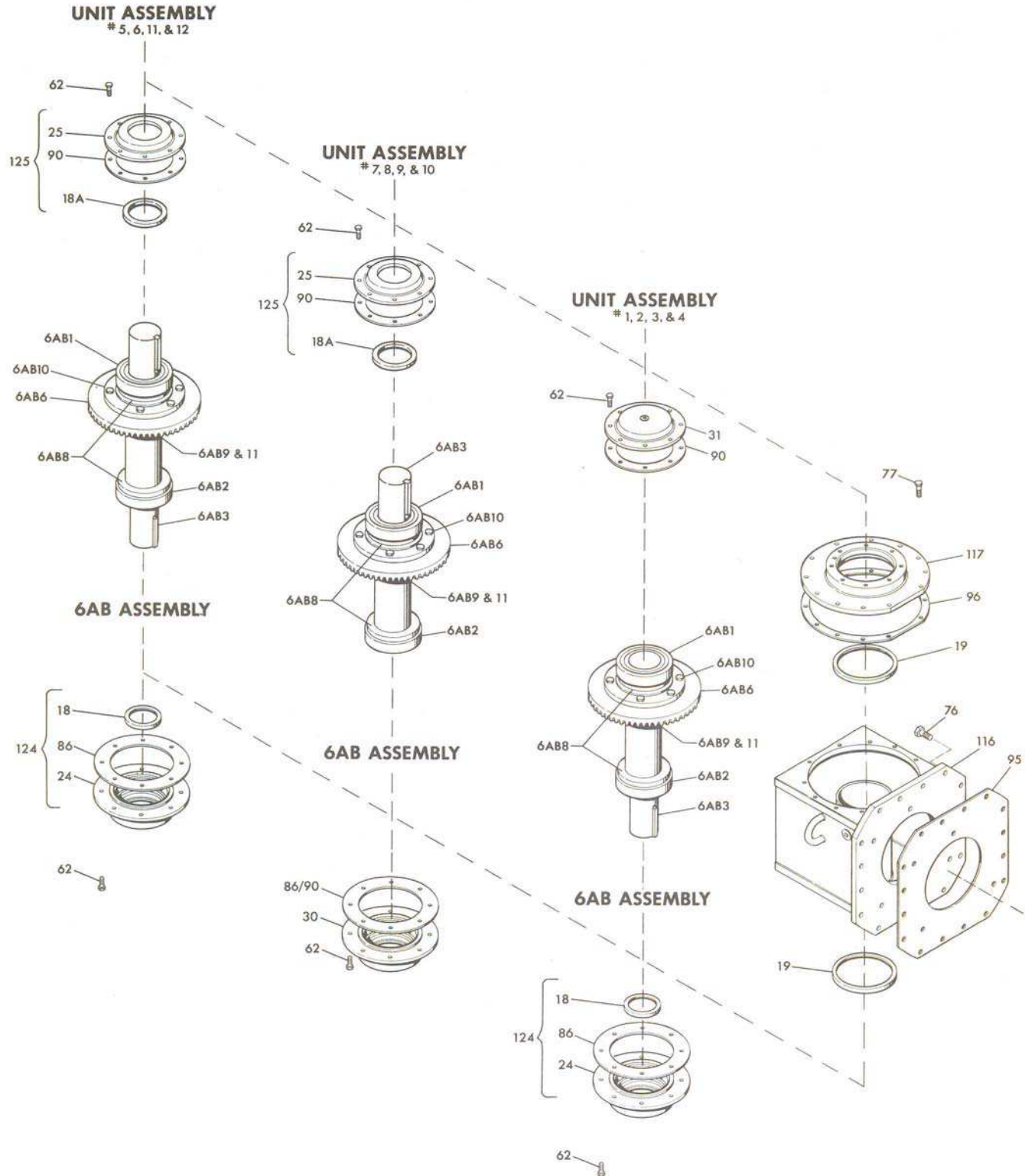

Parts Diagram

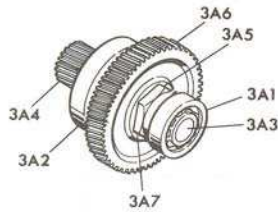

3A ASSEMBLY

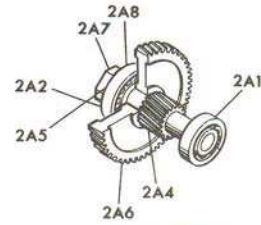

2A ASSEMBLY

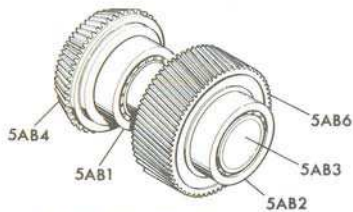
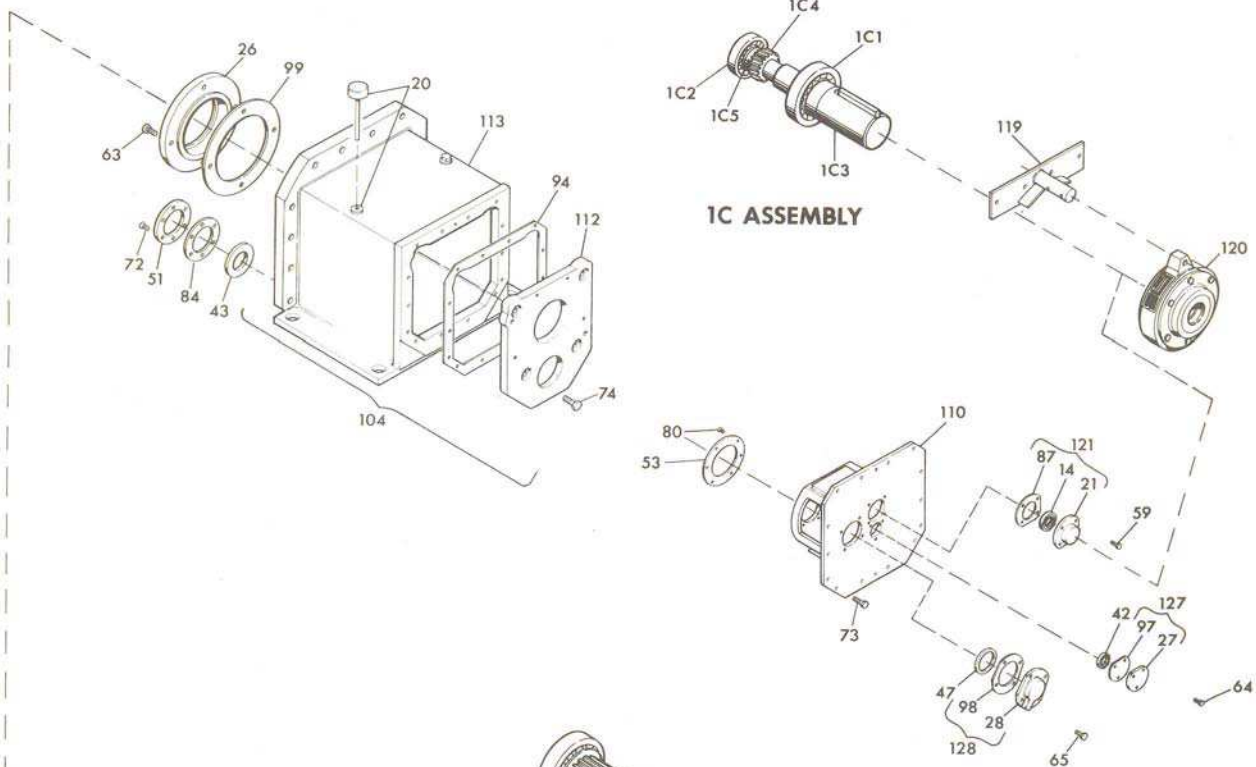

5AB ASSEMBLY

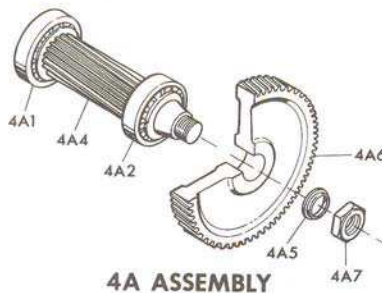

4A ASSEMBLY

TABLE 1 — 1C & 3A Shaft Assembly (Sizes 1060-1100 & 60-100, Model M) ¹

Ratio	Drive Size					Ratio	
	1060/60	1070/70	1080/80	1090/90	1100/100		
357.5	1C1, 1C3 & 1C4						357.5
437.9							437.9
536.3							536.3
656.8							656.8
804.5							804.5
985.3	1C3 & 1C4						985.3
1207							1207
1478							1478
1810							1810
357.5	3A3 & 3A4		3A3 & 3A4				357.5
437.9							437.9
536.3							536.3
656.8							656.8
804.5							804.5
985.3	3A3 & 3A4		3A3 & 3A4				985.3
1207							1207
1478							1478
1810							1810

¹ Individual components for Drive Sizes and Ratios shown in the SCREENED areas may be ordered separately. High interference fit components which must be assembled at the Factory are identified in Tables 1 & 2.

TABLE 2 — 1C, 3A & 5AB Shaft Assemblies (Sizes 60-100, Models A & B) ¹

Ratio	Drive Size					Ratio	
	60	70	80	90	100		
357.5	1C1, 1C3 & 1C4						357.5
437.9							437.9
536.3							536.3
656.8							656.8
804.5							804.5
985.3	1C3 & 1C4						985.3
1207							1207
1478							1478
1810							1810
357.5	3A3 & 3A4		3A2, 3A3 & 3A4				357.5
437.9							437.9
536.3							536.3
656.8							656.8
804.5							804.5
985.3	3A3 & 3A4		3A2, 3A3 & 3A4				985.3
1207							1207
1478							1478
1810							1810
ALL	5AB3 & 5AB6						ALL

¹ Individual components for Drive Sizes and Ratios shown in the SCREENED areas may be ordered separately. High interference fit components which must be assembled at the Factory are identified in Tables 1 & 2.