



Town of  
**Cambridge**

**COMMUNITY AND RESOURCES  
COMMITTEE MEETING**

**MONDAY 9 DECEMBER 2013**

**ATTACHMENT TO ITEM CR13.162**

**ALDERBURY SPORTSGROUND LODGEMENT OF  
LANDGATE SECTION 70A NOTIFICATION FORM**



Location of  
bore/pump and  
electrical cubicle

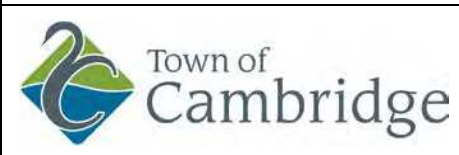

The Town of Cambridge does not warrant the accuracy of information in this publication and any person using or relying upon such information does so on the basis that the Town of Cambridge shall bear no responsibility or liability whatsoever for any errors, faults, defects or omissions in the information.

ALDERBURY  
SPORTSGROUND -  
LOCATION OF IRRIGATION  
BORE/PUMP AND  
ELCTRICAL CUBICLE

Thursday, 5 December 2013

1:2237

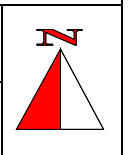

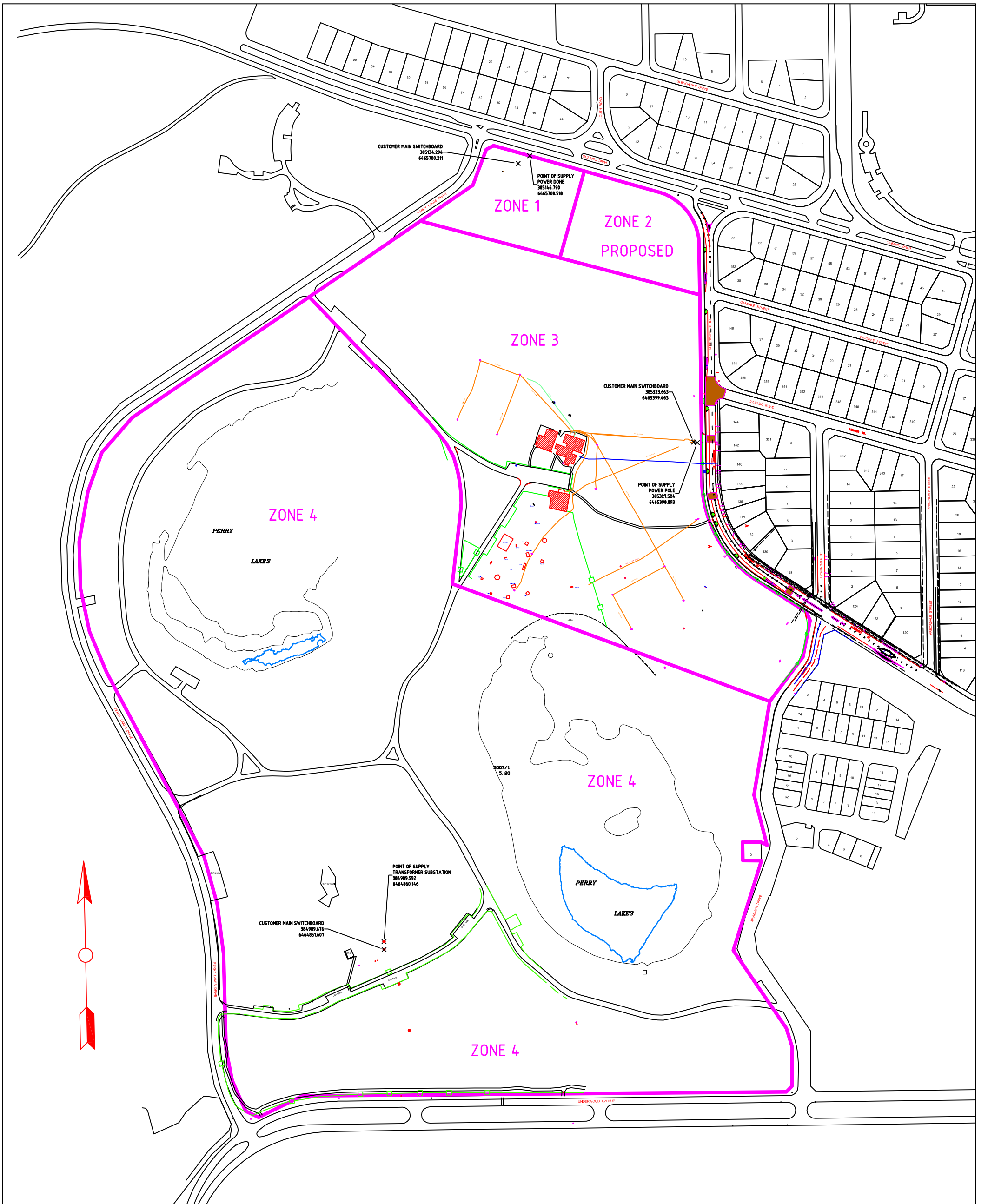

**Town of Cambridge**  
 1 BOLD PARK DRIVE,  
 FLOREAT  
 mail@cambridge.wa.gov.au

**PERRY LAKES**  
**POWER SUPPLY ZONES**  
**UTILITY SERVICES LOT 720**

**INFRASTRUCTURE**  
 DRAWING NUMBER  
**M0609 13 04**  
 DEPT ASSET YEAR NUMBER

SCALE: 1:1250

DATE: 03/12/13

DESIGNED: JCH

DRAWN: JCH

SHEET: 1 OF 1

REVISION: 4

COUNCIL APP: N/A

FILENAME: M0609 13 04.dwg

SUBURB: FLOREAT PARK

ORIGINAL DWG SIZE: **A0**

# NOTIFICATION UNDER SECTION 70A

DESCRIPTION OF LAND (Note 1)

Lot 720 on Plan 21069

EXTENT

Whole

VOLUME

2138

FOLIO

16

REGISTERED PROPRIETOR (Note 2)

Town of Cambridge of 1 Bold Park Drive, Floreat

LOCAL GOVERNMENT / PUBLIC AUTHORITY (Note 3)

Electricity Networks Corporation

FACTOR AFFECTING USE OR ENJOYMENT OF LAND (Note 4)

1. The land includes 4 separate electrical installations designated Zones 1,2,3, and 4 respectively in the attached Zone Diagram.
2. Electricity is supplied to each zone from a separate point of supply, identified on the zone drawing, in compliance with the WA electrical requirements, which can be viewed on [http://www.commerce.wa.gov.au/EnergySafety/PDF/PublicationsJWA Electrical Requirements.pdf](http://www.commerce.wa.gov.au/EnergySafety/PDF/PublicationsJWA%20Electrical%20Requirements.pdf)
3. Future use and development of the land may be affected by provisions of the WA Electrical Requirements that regulate the number of points of supply from which the electricity can be supplied to an electrical installation on one lot, and prescribe:
  - when more than one point of supply can be created for a single lot; and
  - when and to the extent it is possible to modify or upgrade a point of supply on a lot with multiple points of supply.

Dated this	day of	Year
------------	--------	------

LOCAL GOVERNMENT/PUBLIC AUTHORITY ATTESTATION (Note 5)

REGISTERED PROPRIETOR/S SIGN HERE (Note 6)

Signed

in the presence of

Signed

in the presence of

**INSTRUCTIONS**

1. If insufficient space in any section, Additional Sheet Form B1, should be used with appropriate headings. The boxed sections should only contain the words "see page....."
2. Additional Sheets shall be numbered consecutively and bound to this document by staples along the left margin prior to execution by the parties.
3. No alteration should be made by erasure. The words rejected should be scored through and those substituted typed or written above them, the alteration being initialed by the persons signing this document and their witnesses.

**NOTES**

1. **DESCRIPTION OF LAND**  
Lot and Diagram/Plan/Strata/Survey-Strata Plan number or Location name and number to be stated.  
Extent - Whole, part or balance of the land comprised in the Certificate of Title to be stated.  
The Volume and Folio number to be stated.
2. **REGISTERED PROPRIETOR**  
State full name and address of the Registered Proprietors as shown on the Certificate of Title and the address / addresses to which future Notices can be sent.
3. **LOCAL GOVERNMENT / PUBLIC AUTHORITY**  
State the name of the Local Government or the Public Authority preparing and lodging this notification.
4. **FACTOR AFFECTING THE USE AND ENJOYMENT OF LAND**  
Describe the factor affecting the use or enjoyment of land.
5. **ATTESTATION OF LOCAL GOVERNMENT / PUBLIC AUTHORITY**  
To be attested in the manner prescribed by the Local Government Act or as prescribed by the Act constituting the Public Authority.
6. **REGISTERED PROPRIETOR'S EXECUTION**  
A separate attestation is required for every person signing this document. Each signature should be separately witnessed by an Adult Person. The full name, address and occupation of the witness must be stated.



EXAMINED

OFFICE USE ONLY

**NOTIFICATION**

LODGED BY

ADDRESS

PHONE No.

FAX No.

REFERENCE No.

ISSUING BOX No.

PREPARED BY

ADDRESS

PHONE No.

FAX No.

INSTRUCT IF ANY DOCUMENTS ARE TO ISSUE TO OTHER THAN LODGING PARTY

TITLES, LEASES, DECLARATIONS ETC LODGED HEREWITH

1. _____	Received Items
2. _____	Nos.
3. _____	
4. _____	
5. _____	Receiving Clerk
6. _____	

Lodged pursuant to the provisions of the *TRANSFER OF LAND ACT 1893* as amended on the day and time shown above and particulars entered in the Register.