

# Alcatel/Adixen182TD+ Rental Agreement

## Billing Address - Accounts Payable (A/P)

Company \_\_\_\_\_  
Address \_\_\_\_\_  
City \_\_\_\_\_  
State \_\_\_\_\_ Zip Code \_\_\_\_\_

**Unfortunately, LDS cannot rent to our out of country customers.**

Date Required \_\_\_\_\_  
Time Required \_\_\_\_\_  
Rental Type \_\_\_\_\_

## Shipping Address If different from billing

Company \_\_\_\_\_  
Address \_\_\_\_\_  
Address \_\_\_\_\_  
City \_\_\_\_\_  
State \_\_\_\_\_ Zip Code \_\_\_\_\_  
Contact Name \_\_\_\_\_  
Phone Number \_\_\_\_\_  
Fax Number \_\_\_\_\_  
E-Mail \_\_\_\_\_

**New Rental Customers:** Credit card hold is **required to rent** this equipment. If net terms are established and the payment is not made within sixty (60) days, your credit card will be charged.

Card Type

Card Number

Expiration

CV Code

Card Holder Name

A signed lease agreement must be faxed to LDS in order to reserve the next available rental.

**Signed lease agreements must arrive by 12:00pm EST to ship the same day.**

**LDS leased equipment is subject to the following lease agreement terms and conditions:**

### **Fees**

A. Lease payments: **\$700.00 per week or \$2,500 per month.** Your rental begins when you RECEIVE the equipment and ends exactly one week after. In other words, weekly rentals are from Wednesday to Wednesday (example).

B. \$125.00 clean-up and service fee applies to all leased equipment.

C. **Shipping** to and from your facility **is not included** in the rental price. **LDS WILL NOT SHIP VIA FEDERAL EXPRESS OR UPS** because of **guaranteed damage** to our rental equipment.

D. **Lost Crate Fee** - LDS provides a special shipping crate to minimize the possibility of shipping damage. The equipment must be returned in this special shipping crate or a lost crate fee of \$150.00 will apply.

E. **Late Charges** - The equipment must be returned to LDS upon termination of the lease. LDS allows two (2) shipping days from the termination date for the equipment to be received at the LDS plant. A \$100.00 per day late fee applies for each day beyond the two (2) day grace period until the equipment is received at the LDS plant. Please use LDS recommended carriers and special crate to avoid both late fees and damage charges.

### **Lease Extension**

The lease can be extended based on the original terms and conditions by contacting LDS and requesting a lease extension.

### **Purchase Of Rental Equipment**

Contact LDS to determine if the equipment is eligible for purchase and a quotation to purchase will be provided. A **credit of 15%** of the total lease payments submitted to LDS for THIS lease will be applied. Prior rentals fees are not eligible for credit.

**LDS VACUUM PRODUCTS, INC.**

**Page 1 of 3**

**773 Big Tree Drive, Longwood, Florida 32750**

**Phone (407) 862-4643 Fax (407) 862-8723 e-mail: [INFO@LDSVACUUM.COM](mailto:INFO@LDSVACUUM.COM)**

# Alcatel/Adixen182TD+ Rental Agreement

## **General Lease Information**

A. All leased equipment returned to LDS must be in "original" condition (free from scratches and abuse). All equipment **must be protected from damage** and operated in a safe manner. Damages to equipment other than normal wear and tear will be billed at extra cost.

B. The leasee must provide insurance to cover the full replacement cost of the equipment if damage or loss occurs while in the leasee's possession.

C. This lease does not include installation, on site instruction or service. All required services on the above referenced equipment will be billed at the standard service rates in affect at the time the lease is executed.

D. LDS provides our customers with a leak detector, sniffer probe and manual only. It is the leasee's responsibility to provide all the connections from our equipment to your test piece. Please contact the LDS sales department to purchase the necessary fittings.

E. All leak detectors are set for general purpose parameters. If your application requires a special set up, please notify LDS prior to shipment.

## **Maintenance and Care**

Oil changes and other minor maintenance items will be required if the lease extends beyond ninety (90) days. Contact LDS service department for recommendations. The cost this maintenance is not included in the lease price.

## **Return Shipping**

A. The equipment shall be returned to LDS in the **original shipping container** designed to safety return this equipment to the LDS facility.

B. The customer is responsible for all transportation charges. All equipment must be **insured** for the total **replacement value of \$35,765**.

C. Because of **guaranteed damage** to our rental equipment, **SHIPPING VIA FEDERAL EXPRESS OR UPS IS PROHIBITED**. LDS recommends contacting us to set up the return shipment thru Yellow Guarantee (insured).

## **Other Carriers:**

The customer has the option of using other carriers **EXCEPT UPS or Federal Express**. The customer will be responsible for any shipping damage not covered by insurance and subject to late fees as specified in this lease if the equipment does not arrive at LDS within two (2) days after then rental period has ended.

These warranties are expressly IN LIEU of any other express or implied warranty and of any other obligation on the part of LDS, LDS assumes no liability in any event, for consequential damages, for anticipated or lost profits, incidental damages or loss of time or other losses incurred by the Purchaser or any third party in connection with equipment covered by the warranty or otherwise. No representation is made as to application or conditions of the use unless expressly set forth in LDS' acceptance of Purchaser's Order.

# Alcatel/Adixen 182TD+ Rental Agreement

## ALL RENTERS ARE RESPONSIBLE FOR PROVIDING THE FOLLOWING INFORMATION

In compliance with Federal OSHA Safety Standard 1910-1200, Hazard Communications "Right to Know", LDS Vacuum Products requires this form be completed to preclude the potential health risk to its service personnel and other rental customers.

### LDS PROHIBITS the use of rental equipment being exposed to:

Pathogenic germs, micro-organisms (bacteria, viruses, etc.) classes 1 to 4 and group E, radioactive materials, corrosive materials, high concentrations of oxygen, hydrogen, nuclear materials and copper (CU). **Copper** based by products formed in sputtering or etching processes are considered as a poison in some semi-conductor processes.

### Indicate gases and/or substances that may come in contact with this rental equipment

**Providing LDS with false information and/or exposing LDS rental equipment to hazardous materials will result in expenses related to the exposure including, but no limited to down-time, clean-up, medical cost, replacement equipment, contamination passed on to other customer equipment, fines and legal fees.**

The equipment is to be used for leak detection applications which do not adversely cause damage to the equipment. It shall be the customer's responsibility to contact LDS for prior written approval in if the application for use falls into the above category.

**This agreement shall supersede the terms and conditions of any purchase order issued to LDS.**

Signature

Print Name Clearly

DATE

### Model ASM 182TD+ Leak Detector Specifications:

**Vacuum Mode (minimum):** 5x10<sup>-12</sup> mbar liters per second (helium)

**Inlet Pumping Speed:** 4.4 liters per second (helium)

**Crossover Pressure At Inlet:** 6 mbar (large leak test mode)

**Roughing capacity:** 25 m<sup>3</sup>/h (15 cfm)

**Sniffing Mode (minimum):** 1x10<sup>-7</sup> mbar liters per second (helium)

**Response time on calibrated leak at inlet port:** < 0.5 second

### Integrated Functions

Auto-Calibration

Auto-Zero

Selectable languages

RS 232 and Discrete I/O

**Weight:** 193 lbs. (Without crate)

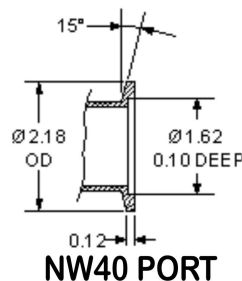

**LDS VACUUM PRODUCTS, INC.**

**773 Big Tree Drive, Longwood, Florida 32750**

**Phone (407) 862-4643 Fax (407) 862-8723 e-mail: [INFO@LDSVACUUM.COM](mailto:INFO@LDSVACUUM.COM)**

Page 3 of 3