

Low Ambient Kit for CITY MULTI® Modular Outdoor Units

Designed for PUHY and PURY T/Y(S)KMU Series Units

Job Name:

Schedule Reference:

Date:

Complete Low Ambient Kit Includes: Hood with control damper assembly and wind deflectors.

GENERAL FEATURES

- Allows system to operate at 100% COOLING capacity at reduced outdoor temperatures
 - ** PUHY Y-Series Outdoor Units - (Now down to -10°FDB Outdoor Temp.)
 - ** PURY R2-Series Outdoor Units - (Now down to -10°FDB Outdoor Temp.)

Patent Pending



IMPORTANT! The low ambient kit is only active when the outdoor unit is in cooling mode. On R2 (PURY) systems when the outdoor unit is in heating mode, the kit is inactive. Indoor units that require cooling during this time, when the outdoor temperature is below 21°F, will not function properly.

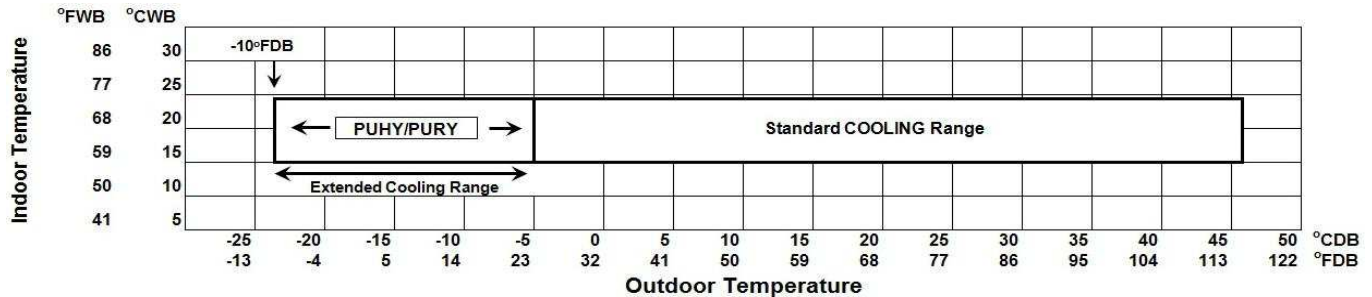

- Normal heating performance is unaffected by the low ambient kit.
- Hood and wind deflectors constructed of 20 gauge, hot-dipped galvanized G-90 steel.
- Heavy-duty polyester-based powder paint finish.
- Designed to work with both 208/230 and 460 3-phase units.
- NEMA 4X control box protects electrical components from the elements.
- ETL Recognized Component.
- Kit easily installs and connects to outdoor unit with plug in electrical connections.
- Wind deflectors easily install with existing (wire guard) fasteners & provided screws.

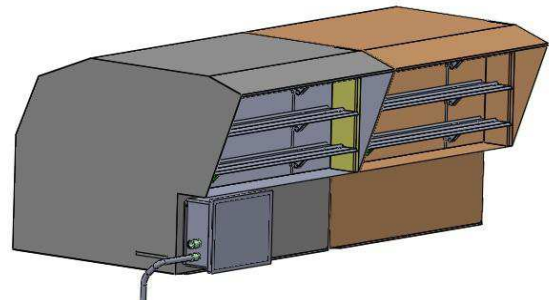
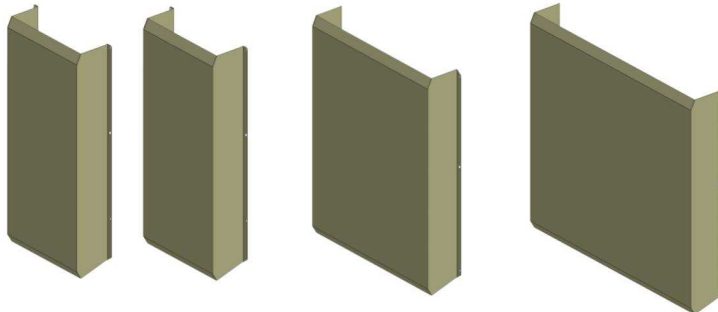
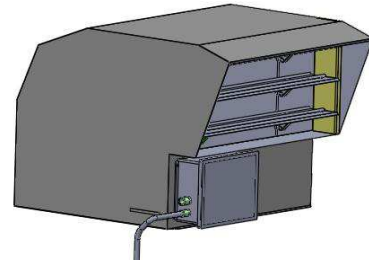

NOTES:

** Hood and wind deflectors must be used to achieve low operational range.

Outdoor unit must be mounted at least 12" off the ground or 12" above the highest average snow depth whichever is greater.

The outdoor unit may require additional mounting restraints depending on the mounting location. See engineering manual or installation instructions for guidelines.

Clearances for the sides and back of the outdoor unit must be at least 6" greater than standard installation guidelines.

Specifications

Part Number	Description	Electrical	Net Wt.	Ship Wt.	Carton Dimensions
					L x W x H
LAHK-1	Low Ambient Hood Assembly (master) with damper control box For single fan modules	208/230 1-phase .20 amp	64 lbs.	70 lbs.	43" L x 36" W x 30 1/2" H
LAHK-2	Low Ambient Hood Assembly (slave) Combined with the LAHK-1 for double fan modules	Controlled by LAHK-1	56 lbs.	62 lbs.	43" L x 36" W x 30 1/2" H
SWDK-1	Side Wind Deflector, includes 2 pieces (fits all modules)	N/A	45 lbs.	50 lbs.	54" L x 20" W x 9" H
RWDK-1	Rear Wind Deflector (1 fits small module, 2 fit the XL module)	N/A	37 lbs.	42 lbs.	54" L x 33" W x 9" H
RWDK-2	Rear Wind Deflector (1 fits large module)	N/A	40 lbs.	45 lbs.	54" L x 45" W x 9" H

Manufactured for Mitsubishi Electric US, Inc.

COMPONENTS / DIMENSIONS

Components Required per Outdoor unit(s)

For outdoor units with multiple modules, the minimum 1-3/16" separation between the modules is recommended. If modules are placed farther apart than 15" apart, more than 1 set of SWDK-1 side wind deflectors may be needed. For multiple units or module sets placed in a row, only one side wind deflector kit (SWDK-1) is needed to cover the two outside module coil surfaces.

PURY-P-T/Y(S)KMU Series

Unit model	Module Size			Component Quantity				
	S	L	XL	LAHK-1	LAHK-2	SWDK-1	RWDK-1	RWDK-2
PURY-P72(T,Y)KMU-A		1		1		1		1
PURY-P96(T,Y)KMU-A		1		1		1		1
PURY-P120(T,Y)KMU-A			1	1		1	2	
PURY-P144(T,Y)KMU-A			1	1	1	1	2	
PURY-P144YSKMU-A		2		2		1		2
PURY-P168(T,Y)SKMU-A		2		2		1		2
PURY-P192(T,Y)SKMU-A		2		2		1		2
PURY-P216(T,Y)SKMU-A		1	1	2	1	1	2	1
PURY-P240(T,Y)SKMU-A			2	2	2	1	4	
PURY-P264(T,Y)SKMU-A			2	2	2	1	4	
PURY-P288(T,Y)SKMU-A			2	2	2	1	4	

PUHY-P-T/Y(S)KMU Series

Unit model	Module Size			Component Quantity				
	S	L	XL	LAHK-1	LAHK-2	SWDK-1	RWDK-1	RWDK-2
PUHY-P72(T,Y)KMU-A	1			1		1	1	
PUHY-P96(T,Y)KMU-A		1		1		1		1
PUHY-P120(T,Y)KMU-A			1	1	1	1	2	
PUHY-P144(T,Y)KMU-A			1	1	1	1	2	
PUHY-P144YSKMU-A	2			2		1	2	
PUHY-P168(T,Y)SKMU-A	1	1		2		1	1	1
PUHY-P192(T,Y)SKMU-A	1		1	2	1	1	3	
PUHY-P216(T,Y)SKMU-A		1	1	2	1	1	2	1
PUHY-P240(T,Y)SKMU-A			2	2	2	1	4	
PUHY-P264(T,Y)SKMU-A	2		1	3	1	1	4	
PUHY-P288(T,Y)SKMU-A	1	1	1	3	1	1	3	1
PUHY-P312(T,Y)SKMU-A	1		2	3	2	1	5	
PUHY-P336(T,Y)SKMU-A		1	2	3	2	1	4	1
PUHY-P360(T,Y)SKMU-A			3	3	3	1	6	1

Dimensions

Wind Deflectors SWDK-1, RWDK-1 and RWDK-2.

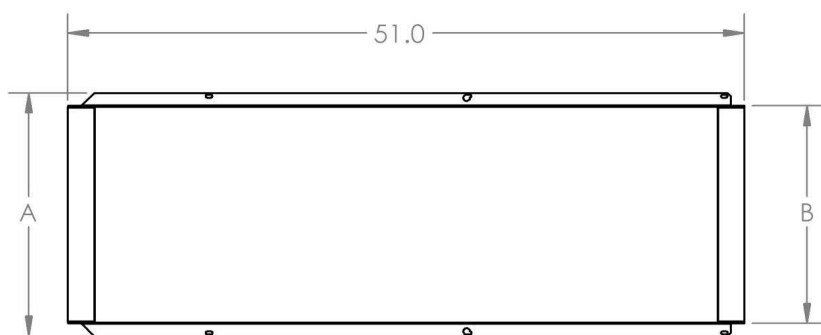

DIM.	SWDK-1	RWDK-1	RWDK-2
A	19.13	31.8	43.6
B	17.13	29.8	41.6

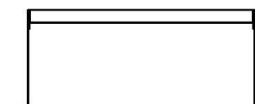

DIMENSIONS

Dimensions

Low Ambient Hood LAHK-1 (used alone for single fan modules P72 and P96 sizes).

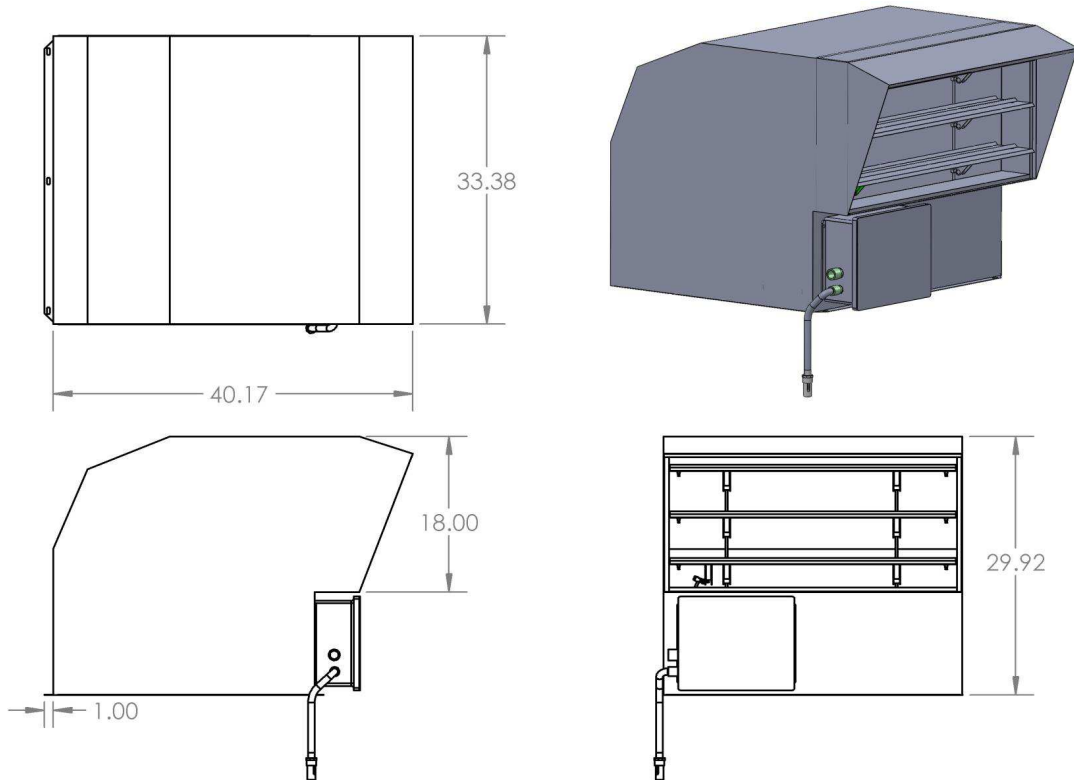

Low Ambient Hood LAHK-1 with LAHK-2 (combined for dual fan (P120 and P144) modules).

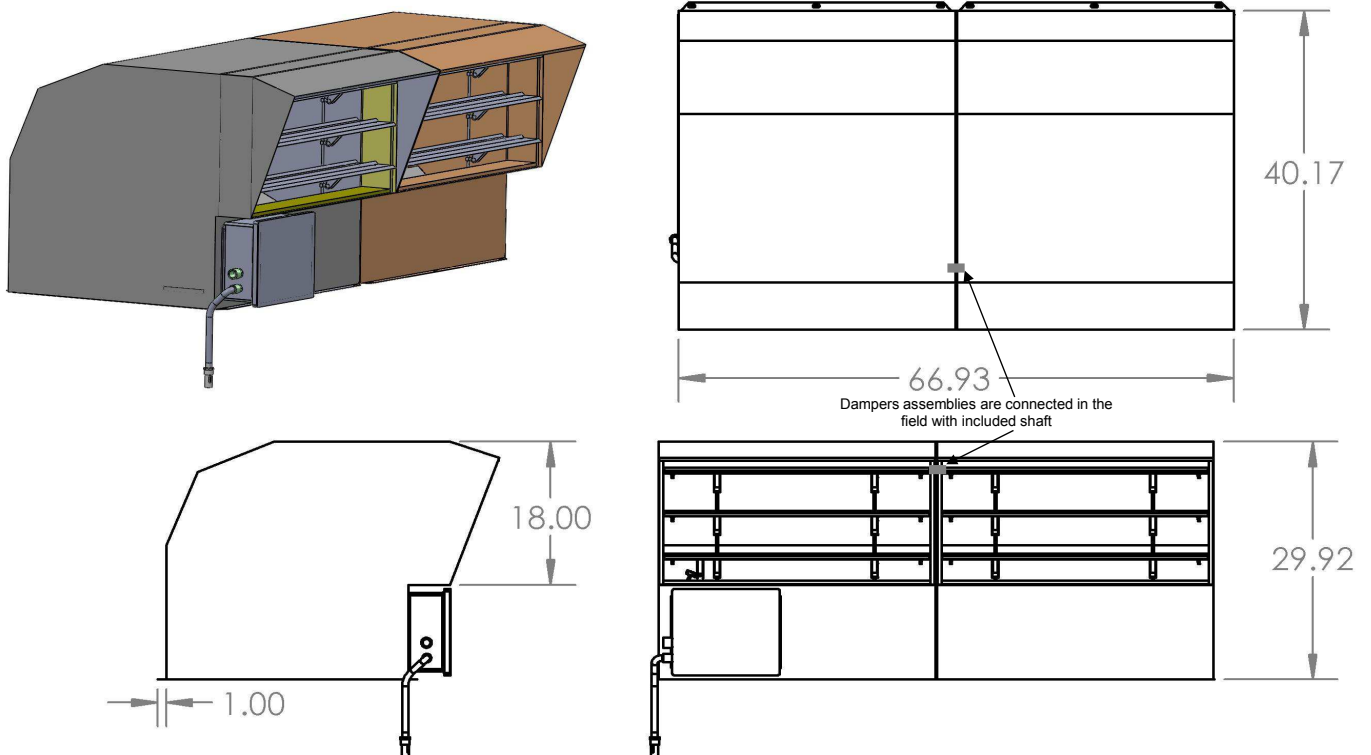

Manufactured for Mitsubishi Electric US, Inc.