

### CHURCHES RECEIVING SURVEY

Church surveys were sent on February 12, 2007 and February 15, 2007 to the following organizations. (**Bold** type indicates a response was received from the church.)

Church Name	Address	City	State	Zip Code
UNION PRIMITIVE BAPTIST	733 MOSS CREEK CIRCLE	BLOOMINGTON	IN	47401
STANFORD BAPTIST CHURCH	PO BOX 51	STANFORD	IN	47463
SOUTH UNION CHRISTIAN CHURCH	6510 S ROCKPORT RD	BLOOMINGTON	IN	47403
SCOTLAND FULL GOSPEL MISSION	RT 2, BOX 303	BLOOMFIELD	IN	47424
KENTUCKY RIDGE CHURCH	CR 75E / SR 45/58	BLOOMFIELD	IN	47424
MOUNT ZION ASSEMBLY OF GOD	7425 S. HARMONY ROAD	BLOOMINGTON	IN	47401
KOLEEN METHODIST CHURCH	PO BOX 13	KOLEEN	IN	47439
HOBBIEVILLE COMMUNITY CHURCH	RT 1, Box 720	SPRINGVILLE	IN	47462
<b>HEBRON BAPTIST CHURCH OF MONROE COUNTY</b>	9900 W. ROCK EAST RD	BLOOMINGTON	IN	47401
<b>GREENE CO. CHAPEL UNITED METHODIST CHURCH</b>	RT 3, Box 504	SOLSBERRY	IN	47459
FULL GOSPEL MISSION CHURCH OF SCOTLAND	RT 2, Box 303	BLOOMFIELD	IN	47424
EMANUEL BAPTIST CHURCH	4001 S. ROGERS STREET	BLOOMINGTON	IN	47403
CLEAR CREEK CHRISTIAN CHURCH	5405 S. ROGERS STREET	BLOOMINGTON	IN	47401
<b>BETHEL CHRISTIAN CHURCH</b>	RT 1, BOX 726	SPRINGVILLE	IN	47462
PENTECOSTAL CHURCH OF JESUS CHRIST	8401 W. EVANS ROAD	BLOOMINGTON	IN	47403
<b>OLD CLIFTY CHURCH</b>	CR 975 E (OLD CLIFTY ROAD)	BLOOMFIELD	IN	47424
BUENA VISTA CHURCH	ROCK EAST ROAD	BLOOMFIELD	IN	47424
ASHCRAFT CHAPEL AND CEMETERY	CR 360S (311 E. RHORER ROAD)	BLOOMINGTON	IN	47401



## I-69 Evansville to Indianapolis Tier 2 Studies

Date: February 12, 2007

Dear Pastor:

As you may already know, the Indiana Department of Transportation (INDOT) is conducting Tier 2 environmental studies along the 142 mile I-69 project corridor from Evansville to Indianapolis. The corridor has been divided into six sections for the Tier 2 studies and each section is being independently reviewed.

DLZ Indiana, LLC is evaluating the potential human and environmental impacts associated with Section 4 of I-69 in Greene and Monroe Counties. As shown on the enclosed map, Section 4 is approximately 26 miles in length and begins near the intersection of US 231 and SR 58 in Greene County and continues north/northeast into Monroe County where it joins SR 37 just south of the City of Bloomington.

The Tier 2 study is examining a variety of issues that may affect residents within the Section 4 study area. Your church has been identified as being either within the project study area and may potentially be affected by the project. Therefore, we are requesting your assistance in identifying any issues and concerns regarding the potential relationship between I-69 and your congregation. Please take a few minutes to complete the attached survey so that we can more adequately assess the potential for impacts resulting from this project. We ask that you return this survey by February 26, 2007 in the self-addressed, stamped envelope provided, so your comments may be included in an analysis to be contained the Environmental Impact Statement to be complete in a few months.

Additional project information is available at [www.i69indyevn.org](http://www.i69indyevn.org). You may also contact our project office at (800) 506-8869 for additional information.

Very truly yours,

Bruce Hudson  
I-69 Section 4 Project Manager

Section 4 Project Office  
3802 Industrial Boulevard  
Suite 2  
Bloomington, IN 47403  
812-334-8869



## CHURCH INFORMATION SURVEY

*(Please return completed survey by March 1, 2007)*

1. Church Name: \_\_\_\_\_  
Contact Person: \_\_\_\_\_  
Address \_\_\_\_\_ Phone \_\_\_\_\_
2. Number of years at this site: \_\_\_\_\_
3. Number of employees: \_\_\_\_\_ Full Time    \_\_\_\_\_ Part Time
4. Is church property: \_\_\_\_\_ Owned    \_\_\_\_\_ Rented/Leased  
If rented/leased, who is owner of the property: \_\_\_\_\_
5. On the attached map, please mark the general area(s) within which your congregation resides. *[Please include this map in your submittal to us.]*
6. How many persons are members of the congregation? \_\_\_\_\_
7. List worship service days, times, and average weekly attendance at each.
  
8. Please list regularly scheduled (weekly/monthly/yearly) activities—other than worship services listed above—held at your facility and the date (i.e., day and /or month) and time of each. Please attach a newsletter or bulletin to highlight these activities, if that would be more convenient.





15. If you have additional issues related to the proposed project or transportation issues in general, please note:

---

Name of person responding to this survey: \_\_\_\_\_

Title / Position: \_\_\_\_\_ Phone: \_\_\_\_\_

Date: \_\_\_\_\_

*Please indicate on the label at right whether corrections / changes should be made.* →

**Please enclose this sheet and the map in the self-addressed, stamped envelope provided, and return it by March 1, 2007.**

**Thank you for your participation.**





9. If your facility hosts a preschool or childcare center, what is the approximate enrollment?

*SEE ATTACHMENT LTR*

10. Do you believe that your church will be affected (beneficially or adversely) by the project? If your answer is yes, how do you believe it will be affected?

*SEE ATTACHMENT LTR*

12. How does your congregation access your church (e.g. car, walking, other)? *SEE ATTACHMENT LTR*

13. For access by car, what roads are the generally traveled routes? *SEE ATTACHMENT LTR*

14. If there is a cemetery associated with your church, please (a) describe its location and/or identify on the map, and (b) indicate whether there is concern that the cemetery could be affected by the project.

*SEE ATTACHMENT LTR*



15. If you have additional issues related to the proposed project or transportation issues in general, please note:

SEE ATTACHMENT LTR

---

Name of person responding to this survey: SEE ATTACHMENT LTR

Title / Position: SEE ATTACHMENT LTR Phone: SEE ATTACHMENT LTR

Date: SEE ATTACHMENT LTR

Please indicate on the label at right whether  
corrections / changes should be made. →

Please enclose this sheet and the map in the  
self-addressed, stamped envelope provided,  
and return it by February 26, 2007.

Thank you for your participation.

SEE ATTACHMENT LTR FOR  
ADDRESS CORRECTION



SECTION 4 PROJECT OFFICE

Bruce Hudson, Project Manager  
DLZ Indiana, LLC  
3802 Industrial Blvd., Unit 2  
Bloomington, IN 47403

Bethel Christian Community Church  
PO Box 76  
Owensburg, IN 47453  
Loc: On Greene Cty Hwy 1250E 1.9  
miles S of Jnt Hwy 54 & 1250E

--Ref: Ltr dtd 2-12-07 requesting church input for Environmental Impact Statement (EIS)

Subj: Response of Bethel Christian Community Church on I-69 church impacts and issues

DLZ Project Manager Bruce Hudson,

In accordance with reference, the following subject responses for the I-69 study record are provided. The filing of this response was delayed because the request letter, though dated February 12, 2007, was not sent (postal meter date FEB 19 2007) and not received until after February 20, 2007. Collection and preparation of the data and preparation of response by the February 26, 2007, did not provide adequate response lead time and is not a reasonable action item time limit. Based on these circumstances, the responses are provided after your requested return date and are for inclusion in the EIS.

The responses are referenced on the survey form provided with your solicitation letter, and the individual questions (1-15) and end item preparation information are answered in the body of this letter. Survey form questions and information requests are restated in this letter to assist your survey reviewers.

CHURCH INFORMATION SURVEY

1. Church Name: Bethel Christian Community Church  
Contact Person: Rev. David Self (Pastor)  
Address: 10713 E 1000N, Odon, IN 47562 Phone: (812) 636-8502
2. Number of years at this site: 76 (Church founded 1860; building moved to current site in 1931; thereafter, additions and modifications)
3. Number of employees: 0 Full Time 1 Part Time (Paid lawn and grounds care)
4. Is church property: Yes Owned No Rented/Leased  
If rented/leased, who is owner of the property: Not applicable
5. On the attached map, please mark the general area(s) within which your congregation resides (Please include the map in your submittal to us.) Marked map attached
6. How many persons are members of the congregation? 25-30 (Membership is conferred by individual profession of salvation and attendance - No formal membership)

7. List worship service days, times, and average weekly attendance at each. Scheduled regular services as follows:

<u>DAY OF WEEK</u>	<u>TIME (Eastern Std)</u>	<u>ATTENDANCE</u>
Sunday	9:30-10:30 AM	7 - 10
Sunday	10:30-Approx Noon	25 - 30
Sunday	6:00-Approx 7:00 PM	10 - 15
Wednesday	6:00-Approx 7:00 PM	10 - 12

8. Please list regularly scheduled (weekly/monthly/yearly) activities -- other than worship services listed above -- held at your facility and the date (i.e., day and/or month) and time of each. Please attach a newsletter or bulletin to highlight these activities, if that would be more convenient.

Regularly occurring activities, in addition to scheduled services, are as follows:

<u>ACTIVITY</u>	<u>FREQUENCY</u>	<u>DATE/TIME</u>
Hallelujah Helpers	monthly	variable
Dishman Cemetery Assoc	yearly	variable
Vacation Bible School	yearly	summer
Fund raisers	quarterly	variable
Fellowship Dinners	monthly	1st Sun PM in Mo
Revival Services	1 or 2 times/yr	variable

Irregularly occurring activities (as needed - for community or church member families) in addition to scheduled activities using the church facilities are as follows:

<u>ACTIVITY</u>
Family reunions
Funeral or Interment Services
Wedding Services
Church Food Pantry

9. If your facility hosts a preschool or childcare center, what is the approximate enrollment? No preschool or childcare at this time.

10. Do you believe that your church will be affected (beneficially or adversely) by the project? If your answer is yes, how do you believe it will be affected?

Yes, church will be affected.

ADVERSELY. One of our member families will lose their home and property to the project. Home and property is in center of refined Right-of-Way (ROW). This will necessitate their relocation probably out of the community area. One of the members of this family is active in visiting current residents and new community families (usually by bicycle or walking) and invites these persons regularly to the church. This member also is a church Sunday School teacher and occasionally substitutes in pulpit ministry. The other member of this family is the alternate pianist and at times leads congregational singing and does some of the church's special singing. The church has one other individual and one other family that attend some revivals or fund raisers that will be impacted by the I-69 lane or interchange ROW.

The church accessibility would be harmed if connection to State Hwy 54 via Greene Cty Road 1250E was lost. Access via use of Greene Cty 325S to Greene Cty 1250E is not year-round reliable and at all times is difficult or impossible to use by large vehicles. (some special activity groups such as gospel singers are not able to use Greene Cty 325S to access Greene Cty 1250E from State Hwy 54 due to grade and turning restrictions of their buses). Church members and others attending church activities use the 1250E route, particularly in bad weather and to avoid the dangerous intersection at Greene Cty Hwy 1250E and Greene Cty Hwy 325S. These access issues would also have impacts for church fire and medical services.

**BENEFICIALLY:** If an I-69 interchange is located at State Hwy 54 the church pastor could use the I-69 as a shorter, better route to church. The pastor, who resides near Raglesville, IN, could use I-69 from State Hwy 231 to 54 interchange to make a shorter trip. No other current church members would likely benefit from traveling the I-69 route to church activities. The projected usages assume I-69 is not a tolled road and, of course, that the interchange is included in the road design.

11. (No question or number listed on form.)
12. How does your congregation access your church (e.g., car, walking, other)?

Travel to services/activities via car, van, and truck (all members, except one).  
Travel to services via bicycle for one member (except when prohibited by weather or darkness)

13. For access by car, what roads are the generally traveled routes?

Access to the church made via State Hwys and Greene County Hwys in the I-69 Section 4 area are listed below. Identification of utilized highways used by members at more distant locations from the church are not included for county roads outside Greene County. Highways utilized by persons only attending special or irregularly occurring activities are also not detailed in the lists; but, in the area, they would generally use at least some of the area roads identified below used by church members.

STATE HWYS	GREENE CTY HWYS
37, 45, 46,	325S, 400S/425S, 490S,
54, 58	1160E, 1250E/1150E, 1390E/1400E

14. If there is a cemetery associated with your church, please (a) describe its location and/or identify on the map, and (b) indicate whether there is concern that the cemetery could be affected by the project. Dishman Cemetery is historically associated with the church, but is governed by a non-church association.

- (a) LOCATION: Across Greene Cty Hwy 1250E from church
- (b) CONCERNS: Cemetery accessibility would be harmed if connection to State Hwy 54 via Greene Cty Road 1250E was lost. Access via use of Greene Cty 325S to Greene Cty 1250E is not year-round reliable and at all times is difficult or impossible to use by large vehicles. [For concerns of the cemetery association, contact Dishman Cemetery Trustee - Wayne Stallard, Route 1, Box 1500, Springville, IN 47462, at (812) 863-7797]

15. If you have additional issues related to the proposed project or transportation issues in general, please note:

Since a part of the church's outreach is for the community area, there are issues that impact area residents that concern the church. As already identified, our church will likely lose some members and occasional activity attenders because of ROW property condemnations.

Failure of the Indiana Department of Transportation (INDOT) to consider specific resident project impacts is an issue and matter of church spiritual, social, and community concern. It is commendable that INDOT and contractors are soliciting area churches for I-69 impacts; but failure to have I-69 community impact assessments, including in-field data collection from citizens in our geographical area, is inexcusable. The apparent lack of concern about the family and community resident interrelationships that need in-field data collection does not speak well to the claims that project management has any genuine concern for our community/family social fabric. Added to this failure, the unwillingness to offer law-provided early buyout or to approve hardship buyout for health, family, or life-impacted ROW displaced residents, especially when completing I-69 project in the Section 4 area is not going to occur for several years, is not responsible or compassionate project administration.

Since the purpose of our church is first spiritual and foremost to bring the message of Christ and personal belief and salvation, the following concerns are further expressed. Failure to understand the community, church, and area family/friends interdependency and the positive ways these community relationships enhance and establish quality of life, including spiritual life in a small rural community such as ours means the emphasis on economic development and more rapid access to large urban areas that seems to be the motivating driver of the I-69 project has too dominant weighting in the evaluation process. The general traditional national and state mind set that holds "bigger is better" and "get all YOU can while YOU can" are not the "YOU" views of Christ, this church, or area community. These views of success are ruinous to the quality of life our members and area families hold dear. Better paying employment and improved access to services such as medical care are important to church and area people. However, the general urban viewpoint is not accurate in feeling that our way of life with its rural slower methods are deprivations. These rural qualities are, in fact, not deprivations to us, but valuable assets not to be forfeited for questionable development that might come to this area from I-69. This is why it is important that in-field community impact assessments be performed by personnel that not only have an understanding of economic and access development, but the social and spiritual fabric of unique rural communities, and the data be given emphasis in establishing mitigation, or making decisions to build interstate highways through these areas. Protection of this unique quality of life and spiritual/social values in these special small, though not locally politically/governmentally organized areas is an important issue. Even as we have stated previously, some of these negative impacts to some of our church members and, to some degree to our congregation and the unwillingness of INDOT to mitigate the associated hardships and the broader group of people impacts that will occur in our community, are not right. To repeat, no in-field assessment has been made to even know what mitigation might at least minimize these impacts or the costs associated with that mitigation.

If interchanges are not provided at both State Hwy 54 and 45 in our area, our residents will have the impact of having I-69 traverse our area, but will be denied access and the other benefits the interstate might provide to this community. This access issue is another social/economic concern our church has for our community if benefits such as better emergency services are to be provided by the highway.

Name of person responding to this survey:

Charles K. Ramsden, Jr.  
Route 1 Box 1708  
Springville, IN 47462-9629

Title/Position: Bethel Member/Designated Responder Phone: (812) 863-4474

Date: 1 March 2007

Please indicate on the label at right or below whether corrections/changes should be made.

Mailing address correction, change address of record to:

BETHEL CHRISTIAN COMMUNITY CHURCH  
PO BOX 76  
OWENSBURG IN 47453

Please enclose this sheet and the map in the self-addressed, stamped envelope provided and return it by February 26, 2007.

Survey form and map enclosed with responses. Return by requested response date not possible based on reasons stated in first paragraph of this letter.

Thank you for your participation.

END OF SURVEY REQUESTED INFORMATION

The church provides this report for record to the INDOT Section 4 (I-69) contractor DLZ for study records and EIS inclusion. Information provided is to be evaluated or quoted only in full content/context. The designated responder has acted in accordance with the instruction of the church. The statements contained herein have been reviewed by the Church Pastor, the survey form/letter/map posted at the church for member examination, and are some of the issues and concerns of the church related to the I-69 project.

Charles K. Ramsden, Jr. 3-4-07  
Charles K. Ramsden, Jr. (Bethel Church  
Member/Designated Representative)

David Self 3-4-07  
David Self (Bethel Church Pastor)

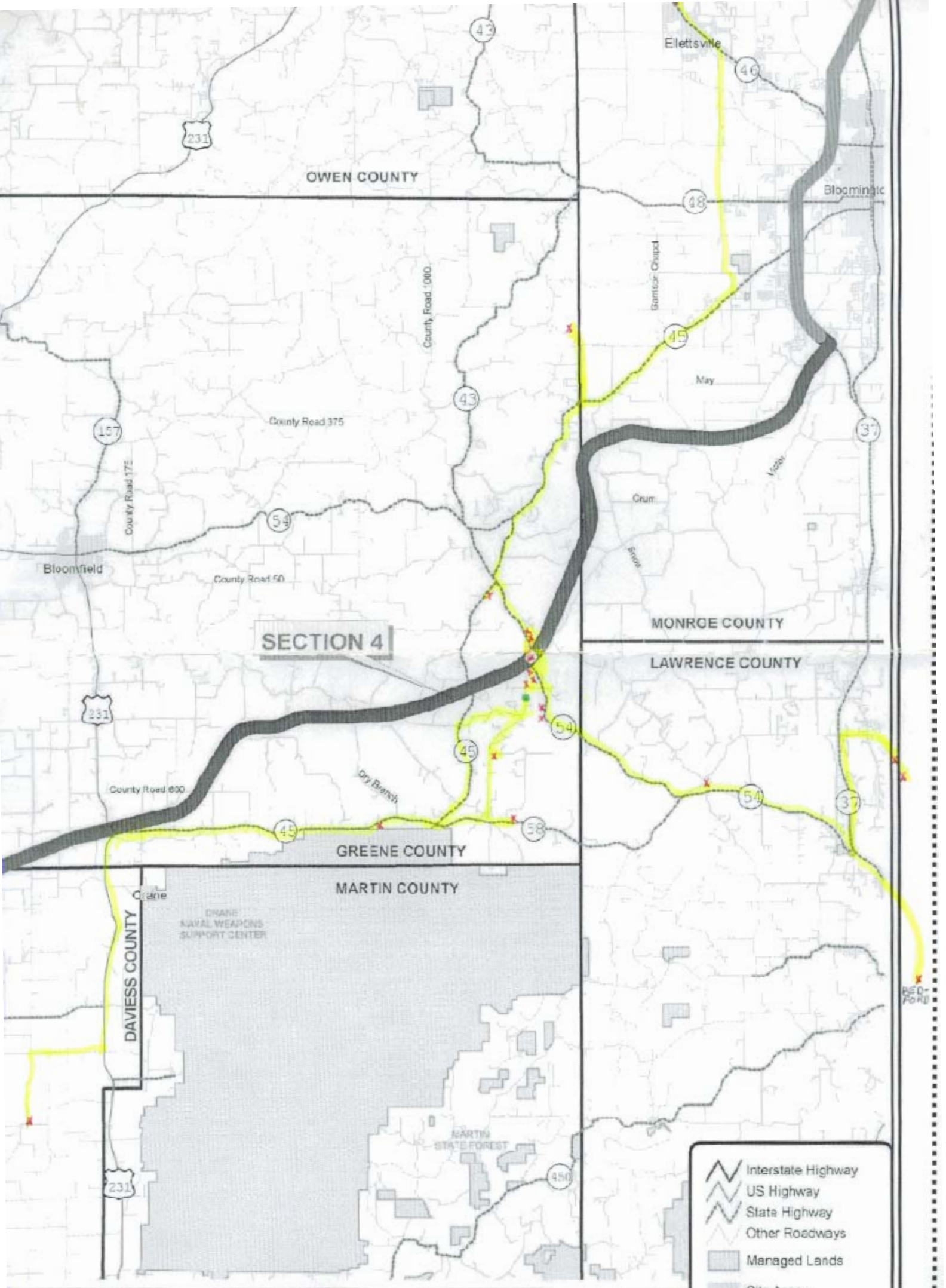

**SECTION 4**

- Interstate Highway
- US Highway
- State Highway
- Other Roadways
- Managed Lands
- City Areas
- Section 4

Section 4 (From US 231 to SR 37)  
The Approved Corridor 3C





### CHURCH INFORMATION SURVEY

(Please return completed survey by February 26, 2007)

1. Church Name: Greene County Chapel United Methodist  
Contact Person: Bill Buskirk  
Address RR 3 Box 504 Phone 812-855-9747  
Solsberry, IN 47459
2. Number of years at this site: 125
3. Number of employees: 1 Full Time      Part Time
4. Is church property:  Owned  Rented/Leased  
If rented/leased, who is owner of the property: \_\_\_\_\_
5. On the attached map, please mark the general area(s) within which your congregation resides. [Please include this map in your submittal to us.]
6. How many persons are members of the congregation? 85
7. List worship service days, times, and average weekly attendance at each.
- |                         |           |              |    |
|-------------------------|-----------|--------------|----|
| Church & Sunday School, | Sundays   | 9:30 - 11:30 | 65 |
| Bible Study             | Sundays   | 4:00 - 5:30  | 10 |
| " "                     | Thursdays | 7:00 - 8:00  | 5  |
8. Please list regularly scheduled (weekly/monthly/yearly) activities—other than worship services listed above—held at your facility and the date (i.e., day and /or month) and time of each. Please attach a newsletter or bulletin to highlight these activities, if that would be more convenient.
- |              |                     |                  |  |
|--------------|---------------------|------------------|--|
| Kids Club -  | Sundays             | 6:00 - 7:00 pm   |  |
| Ladies Group | monthly 2nd Tuesday | 10:00 - 12:00 pm |  |



9. If your facility hosts a preschool or childcare center, what is the approximate enrollment?

N/A

10. Do you believe that your church will be affected (beneficially or adversely) by the project? If your answer is yes, how do you believe it will be affected?

Not Sure

12. How does your congregation access your church (e.g. car, walking, other)?

CAR

13. For access by car, what roads are the generally traveled routes?

State Road 45  
Solsberry County Road  
County Line Road

14. If there is a cemetery associated with your church, please (a) describe its location and/or identify on the map, and (b) indicate whether there is concern that the cemetery could be affected by the project.

Yes East of Church building





15. If you have additional issues related to the proposed project or transportation issues in general, please note:

---

Name of person responding to this survey: Bill Buskirk

Title / Position: Treasurer Phone: 812-855-9747

Date: 2/21/07

Please indicate on the label at right whether corrections / changes should be made. →

Please enclose this sheet and the map in the self-addressed, stamped envelope provided, and return it by February 26, 2007.

Thank you for your participation.

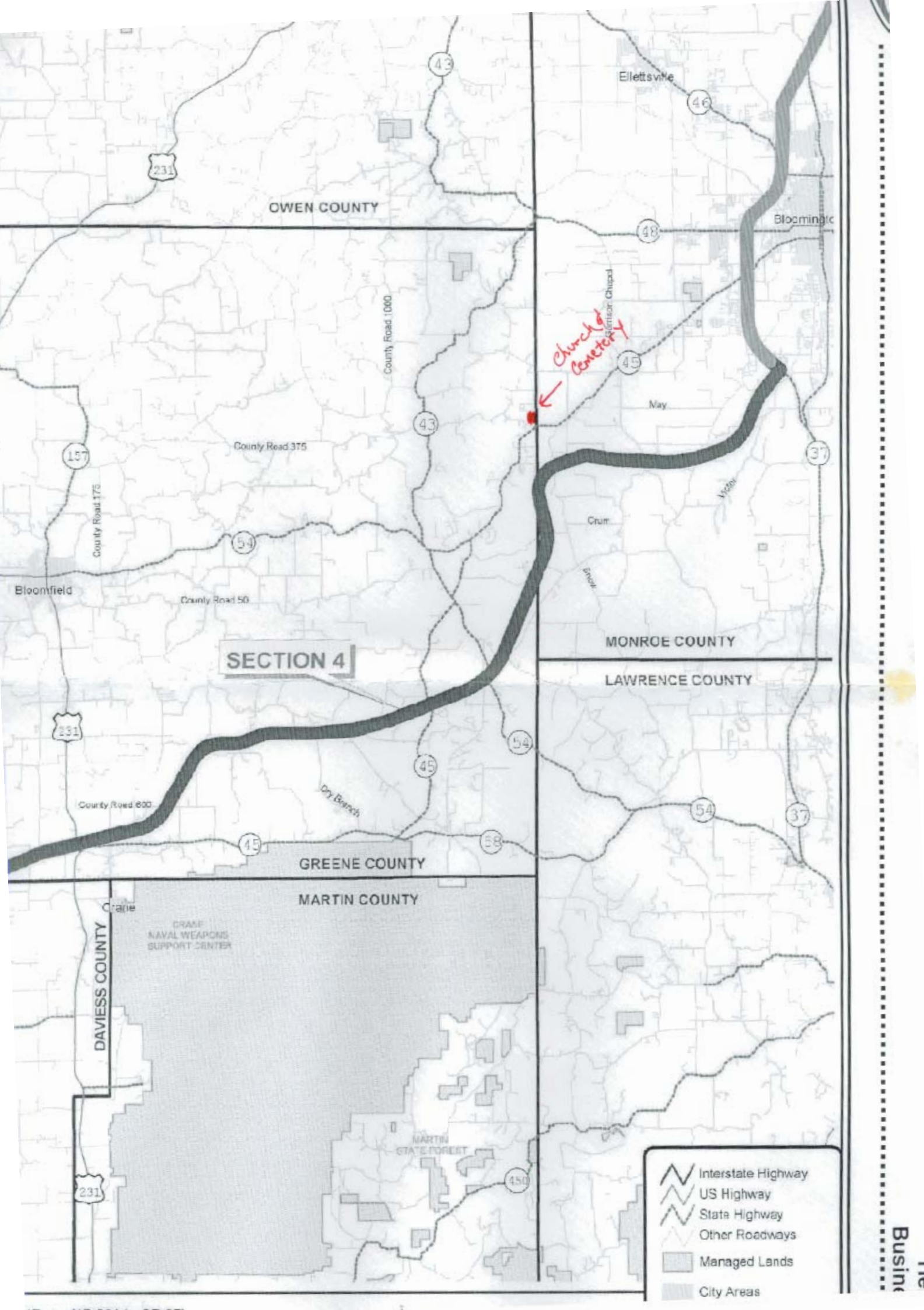

**SECTION 4**

*Church & Cemetery*

- Interstate Highway
- US Highway
- State Highway
- Other Roadways
- Managed Lands
- City Areas



**CHURCH INFORMATION SURVEY**

*(Please return completed survey by February 26, 2007)*

1. Church Name: Hebrew Regular Baptist Church  
Contact Person: TERRY L. MYERS - 812 863 7716  
Address 9900 W. Rock East Rd. Phone 812 825 1771  
Blgtn, IN 47403

2. Number of years at this site: Approx 140 yrs +

3. Number of employees:  Full Time  Part Time

4. Is church property:  Owned  Rented/Leased

If rented/leased, who is owner of the property: \_\_\_\_\_

5. On the attached map, please mark the general area(s) within which your congregation resides. *[Please include this map in your submittal to us.]*

6. How many persons are members of the congregation? \_\_\_\_\_

7. List worship service days, times, and average weekly attendance at each.

<u>Sunday</u>	<u>9:30 AM - 11:30 AM</u>	<u>- Attendance 20</u>
	<u>6:00 PM - 8:00 PM</u>	<u>Attendance 15</u>
<u>Wed</u>	<u>7:00 PM - 8:00 PM</u>	<u>Attendance 12</u>

8. Please list regularly scheduled (weekly/monthly/yearly) activities—other than worship services listed above—held at your facility and the date (i.e., day and /or month) and time of each. Please attach a newsletter or bulletin to highlight these activities, if that would be more convenient.

9. If your facility hosts a preschool or childcare center, what is the approximate enrollment?

N/A

10. Do you believe that your church will be affected (beneficially or adversely) by the project? If your answer is yes, how do you believe it will be affected?

Yes  
Do not know if there will be community growth or if access to the church will be hindered.

12. How does your congregation access your church (e.g. car, walking, other)?

CAR

13. For access by car, what roads are the generally traveled routes?

Highway 54, Highway 45, Rock East Rd.

14. If there is a cemetery associated with your church, please (a) describe its location and/or identify on the map, and (b) indicate whether there is concern that the cemetery could be affected by the project.

N/A



15. If you have additional issues related to the proposed project or transportation issues in general, please note:

---

Name of person responding to this survey: TERRY L. MYERS  
Title / Position: DEACON / TRUSTEE Phone: 812 863 7716  
Date: 2/25/07

Please indicate on the label at right whether  
corrections / changes should be made. →

Please enclose this sheet and the map in the  
self-addressed, stamped envelope provided,  
and return it by February 26, 2007.

Thank you for your participation.

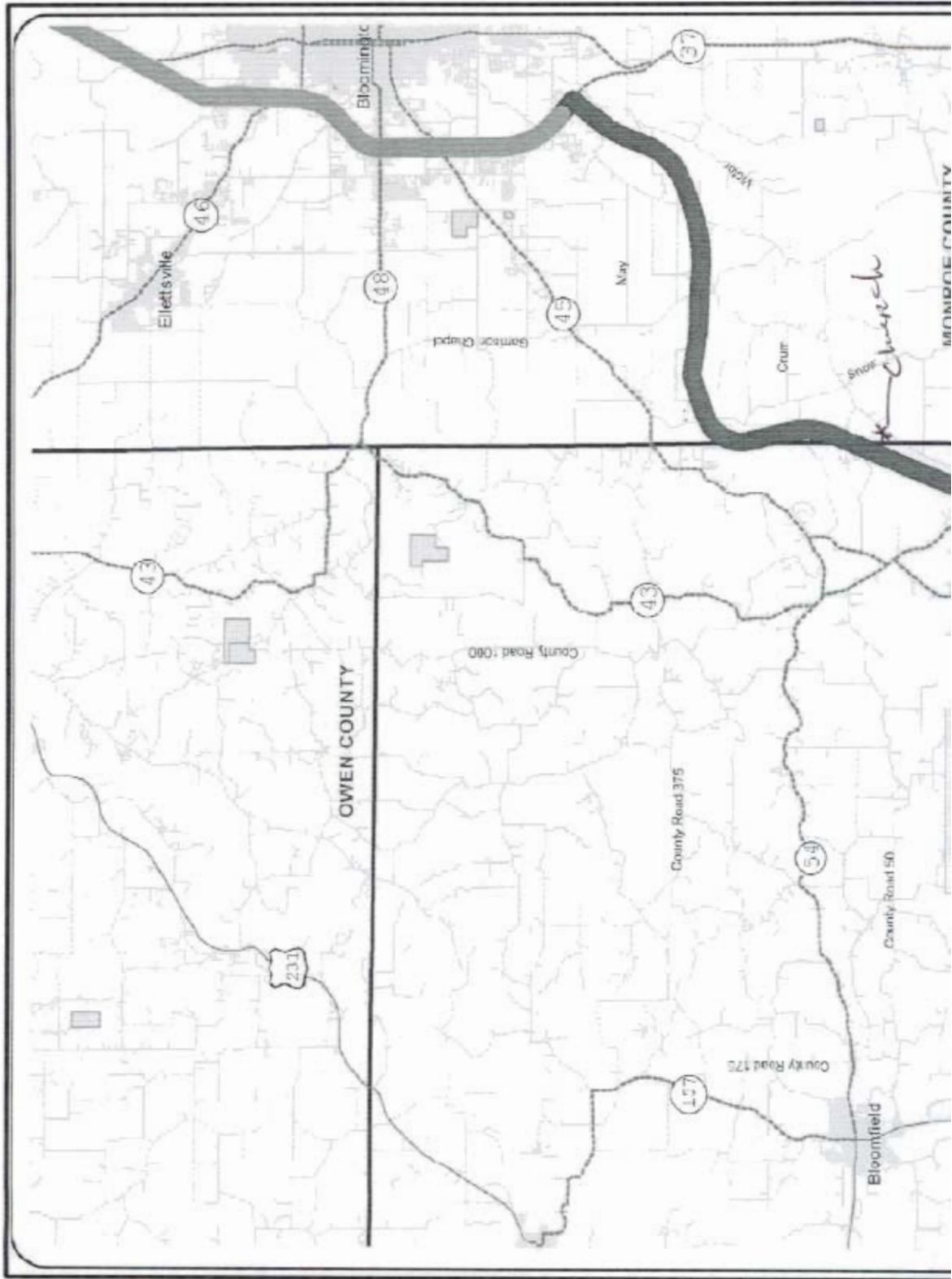



I-69 Evansville to Indianapolis Tier 2 Studies

March 30, 2007

Old Clifty Church  
c/o Anne Wilcoxon  
RR 3 Box 304  
Bloomfield, IN 47424

Ms. Wilcoxon,

Thank you for responding to our survey, the information collected during this process is an important part of planning the highway. In response to your request for maps of the potential interchange locations, please find the enclosed documents. Note that these are conceptual drawings of potential interchanges; not all interchanges depicted will be part of the final plans. If you have any further questions, please contact our office at (800) 506-8869.

Very truly yours,

Bruce Hudson  
Section 4 Project Manager

Section 4 Project Office  
3802 Industrial Boulevard  
Suite 2  
Bloomington, IN 47403  
812-334-8869



**CHURCH INFORMATION SURVEY**

(Please return completed survey by February 26, 2007)

1. Church Name: OLD CLIFTY CHURCH  
Contact Person: ANN WILCOXEN  
Address Rt 3 Box 304 Phone 812 863 4418

2. Number of years at this site: CIVIL WAR  
3. Number of employees: — Full Time — Part Time  
4. Is church property:  Owned — Rented/Leased  
If rented/leased, who is owner of the property: \_\_\_\_\_

5. On the attached map, please mark the general area(s) within which your congregation resides. [Please include this map in your submittal to us.]  
ALL COUNTIES SHOWN IN MAP + FROM OTHER STATES  
6. How many persons are members of the congregation? ?  
AND I KNOW MONTHLY PART STATE  
7. List worship service days, times, and average weekly attendance at each.

8. Please list regularly scheduled (weekly/monthly/yearly) activities—other than worship services listed above—held at your facility and the date (i.e., day and /or month) and time of each. Please attach a newsletter or bulletin to highlight these activities, if that would be more convenient.  
HOME COMING - 2ND WEEK AUG. 2007  
CANDLE LIGHT SERVICE - DEC 24 11 75





9. If your facility hosts a preschool or childcare center, what is the approximate enrollment?

X

10. Do you believe that your church will be affected (beneficially or adversely) by the project? If your answer is yes, how do you believe it will be affected?

NO EFFECT

12. How does your congregation access your church (e.g. car, walking, other)?

CAR

13. For access by car, what roads are the generally traveled routes?

ROAD 225 SOUTH BLACK TOP  
275 S THE OTHER END IS 300 GRAVEL  
295 S BLACK TOP.

14. If there is a cemetery associated with your church, please (a) describe its location and/or identify on the map, and (b) indicate whether there is concern that the cemetery could be affected by the project.

NO

2 FAMILY GRAVEYARDS CLOSE TO CHURCH



15. If you have additional issues related to the proposed project or transportation issues in general, please note:

DON'T WANT TOLL ROAD

Name of person responding to this survey: ANN WILCOXEN

Title / Position: SECRETARY Phone: 812 863 4418

Date: 3-1-07

Please indicate on the label at right whether corrections / changes should be made. →



Please enclose this sheet and the map in the self-addressed, stamped envelope provided, and return it by February 26, 2007.

Thank you for your participation.

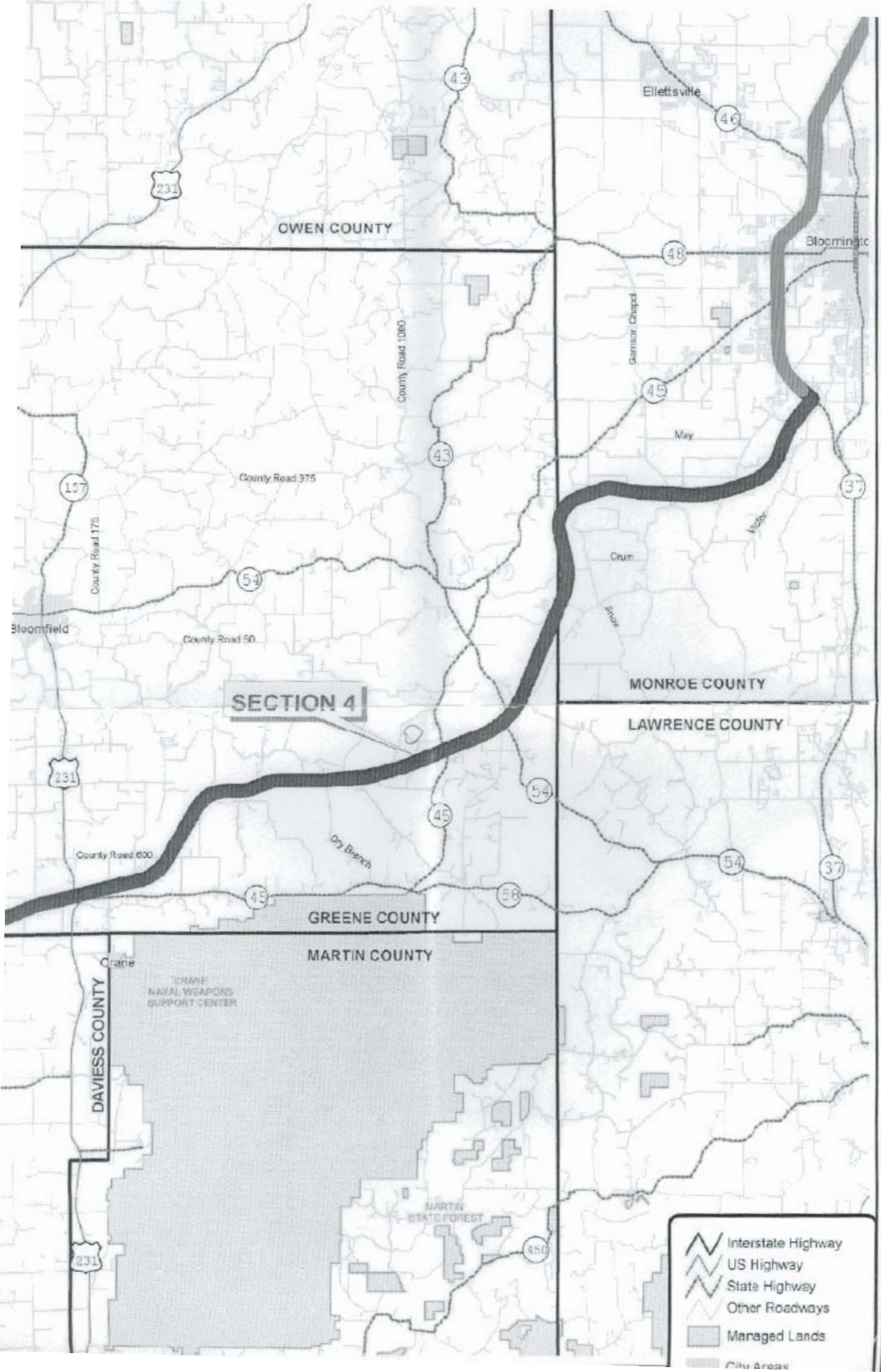
OLD CLIFTY CHURCH (NOT CHURCH)  
% care of  
ANN WILCOXEN  
RR #3 BOX 304  
BLOOMFIELD, IN 47424



**SECTION 4**

-  Interstate Highway
-  US Highway
-  State Highway
-  Other Roadways
-  Managed Lands
-  City Areas