





NEMO MISSION

Our 2010 product line is the result of 8 years of devoted labor and half a million years or so of developing better tools for shelter and survival. NEMO is about what we have just discovered and what we have known for a long time. It's about beautiful design and intelligent engineering. It's about serene cloudless days and bitter cold nights spent battling snow drifts and frostbite. It's about bringing two worlds together: the world of design and technology and the actual world where we test ourselves and our inventions. We are pursuing perfection. It is an epic journey, often elusive, demanding youthful energy, creativity, and courage. We have come a long way in our travels and we promise never to yield in our determination. Like our ancestors who explored new places for the first time, we will change the common idea of what is possible.



NEMO's spirit is in adventure. Without the beautiful wild places where adventures are made, our spirit dies. We are committed to reducing our environmental impact. Finding the right path forward takes a great deal of research, problem solving and commitment. And finding the right path is only the first challenge, walking that path is the real test. NEMO has been making strides to use more sustainable materials, to repurpose byproducts of manufacturing, and to recycle products at the end of their useful life. We are taking steps for the future of our planet and hope you will do the same. To learn more about NEMO's GRN™ efforts, please visit our website.



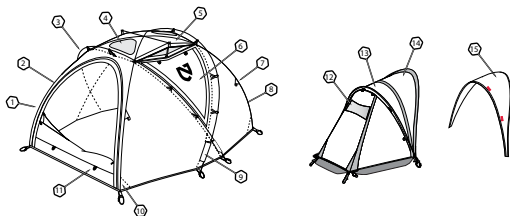

- | | |
|--|---|
| 1. Internal Poles | 9. Pole Sleeves |
| 2. Zipper for Vestibule Attachment | 10. Reinforced Corner Pockets |
| 3. External Poles | 11. Door Tie-backs |
| 4. UVX Window | 12. UVX Window |
| 5. Internally Deployable Struted Vents | 13. Zip-on Vestibule |
| 6. Dual Side Doors | 14. Upper Vestibule Panel |
| 7. Multiple Guy-out Points | 15. Connection Panel (with red Velcro®) |
| 8. 2nd Main Door | |



Capacity:	3
Minimum Weight:	7.5 lbs (3.5 kg)
Packed Weight:	10.3 lbs (4.7 kg)
Packed Dimensions:	18" x 8" dia (46 x 20 cm)
Frame:	5 DAC 9 / 9.6 / 10.25 mm Featherlite® NSL
Shell Fabric:	OSMO™ Waterproof Breathable
Vestibule Fabric:	30D PU Nylon
Floor Fabric:	70D PU Nylon
Floor Dimensions:	90" x 75" (229 x 191 cm)
Interior Height:	48" (122 cm)
Floor Area:	43 sq ft (4.0 sq m)
Vestibule Area:	12 sq ft (1.1 sq m)

MOKI™
3 PERSON



Preparing Your Tent

1. Lay out the contents of your Moki™ tent, and make sure that you received the following: tent shell, four long poles, one short pole, one curved vestibule pole, vestibule, upper vestibule panel, connection panel with red Velcro®, pole stuff sack, dry bag style stuff sack, storage stuff sack, 10 stakes, guy lines, Seamgrip® with nozzle, Tear-aid™ fabric repair patches, and pole repair sleeve.

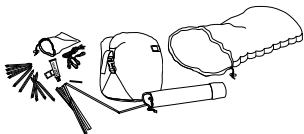

2. NOTE: TENT IS NOT FULLY WATERPROOF UNTIL IT IS SEAM SEALED. In some areas of the tent, seams are sewn directly through the tent shell to create a very strong construction. Water can leak through these areas so it is necessary to cover the stitching with Seamgrip®. The Seamgrip® also adds strength so you may choose to apply it to all exterior seams. However, it is only necessary in the areas highlighted in red below (pole wraps, pole clips, and APRI™ connections).

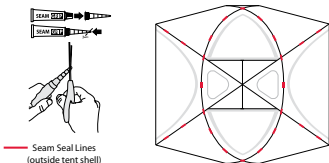

Seam Seal Lines
(outside tent shell)

On the outside of your tent, clean any dirt or moisture off the surface. Carefully squeeze the Seamgrip® through the applicator tip onto the stitching. Use only enough to completely cover the stitching. Be careful not to contaminate zippers or Velcro®. Allow at least 24 hours for curing before use. If the Seamgrip® remains tacky, you can lightly dust the fully cured Seamgrip® with talcum powder.

Cover stitches on the outside of the tent shell.

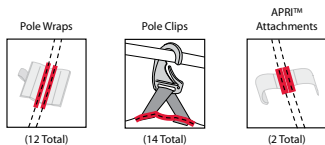

MOKI™

Defending Against Every Element.

When we say 4 season, we mean it. Our ambassadors take Moki™ to the Himalayas and we use it for surf trips on the coast. Over half of Moki's™ single-wall exterior is convertible to mesh, which gives you the flexibility and comfort you need in any climate. A large vestibule is included with Moki™ and an optional, additional vestibule can be zipped to the opposite door for extra gear storage. With the ability to link together, add insulation, or unzip half the tent shell to expose mesh, Moki™ is the perfect base camp for all of your adventures

MOKI™ Innovations

1. Year-Round Comfort: Moki™ is designed to be comfortable in all four seasons, no matter the weather. You can convert roughly half of Moki's™ shell to mesh by tying back its four large doors. Guy out the side doors and open the overhead vents to provide maximum ventilation in the rain. Add APRI™ insulation (sold separately) for added warmth on the coldest nights.



2. Linking Moki™ Tents: Setting up a base camp or traveling with a crowd? The unique vestibule design of Moki™ allows two or more tents to connect. Use one as a sleeping quarters and the other for gear storage or a gathering place. To connect tents, zip the connection panel to the upper vestibule panel and join them to the tents where the vestibules would attach. The connection panel is similar to the upper vestibule panel but has red Velcro®.



3. Accessibility: The full-size included vestibule provides plenty of additional space for gear storage and a dry entry during bad weather. On sunny days, the vestibule is easily removed by unzipping it from the tent. Side doors add extra exits and provide a convenient way to load gear in and out of the tent. Open the door and stand up for a morning stretch or brush your teeth without having to put your shoes on.

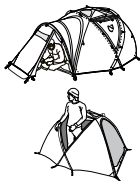

Optional Accessories

1. **Moki™ Footprint:** To install the Moki™ Footprint, slip the split rings over each of the eight corresponding corner anchors. Make sure the Footprint is not exposed under the tent shell or it could collect water in a rain storm.



2. **Moki™ Pawprint™:** Connect the button snaps on the corners of the Pawprint™ to the button snaps on the inside corners of the tent. Attach the sides of the Pawprint™ with Velcro® to the sides of the tent.



3. **Extra Moki™ Vestibule:** For extra gear storage, add a vestibule to your second door. This vestibule is identical to the one included with Moki™. Vestibules can be used on either door.



4. **Moki™ APRI™:** The Moki™ APRI™ is built for the most brutal conditions on the planet. It is made from a metallized fabric laminate that substantially increases the temperature inside the tent while staying completely breathable.

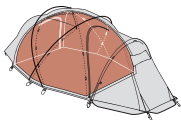

It is easiest to install the APRI™ before the inner poles are in position. Lay the APRI™ on top of the poles and connect the snaps on the corners to the upper snap in the corners of the tent. Place the pole ends in the large button snaps like the usual setup.



Pull the Velcro® tabs on the inside of Moki™ through the slits of the APRI™ and connect them to the inside. Connect the Velcro® along the sides at floor level.

5. **Moki™ Link™:** The Moki™ Link™ enhances the living space between two Moki™ tents. Use it as a communal meeting space, versatile entrance, sleeping area for pets, or covered storage for your wet gear.



To install, first zip the Connection Panel (included with each Moki™ tent) to both sides of the Link™. Insert a pole into each pole sleeve. Finish by zipping the Connection panels to the Moki™ tent doors and staking in place. Make sure to close all snaps.





NEMO Quality

There is a reason why our logo resembles a medieval shield. If you've ever seen an authentic medieval shield or piece of armor, the detail and quality of craftsmanship are astonishing. Hours were spent shaping and perfecting every component knowing the gravity of purpose and the need for reliable performance. At NEMO, we take the same approach to quality. We know from our own experience how vital a tent can be for comfort and survival. Your tent is your home in the wilderness and your armor against the elements. We obsess over every design decision to ensure you get the greatest comfort and protection possible. Our process begins with pencil and paper and evolves methodically through computer modeling, prototyping, testing, and development. We use all the latest tools, software, manufacturing methods, and materials. If we aren't happy with what's available, we make our own. We strive to design and build the best tents on the planet. We stand behind our shield, the symbol of NEMO quality.

To learn more, please visit our website at www.nemoequipment.com.

NEMO Warranty

NEMO guarantees every product we sell. We put great effort into choosing the best materials and providing you with the highest level of workmanship. We proudly stand behind everything we make. NEMO products carry a lifetime warranty against defects in workmanship and materials to original owner, with proof of purchase. Warranted products will be replaced or repaired at NEMO's discretion. NEMO does not warranty products against normal wear and tear, unauthorized modifications or alterations, improper use, improper maintenance, misuse or neglect or if the product is used for a purpose for which it is not intended. Except as expressly set forth in these terms and conditions, NEMO is not liable for any direct, indirect or consequential damages arising out of or resulting from the use of a NEMO product. The warranties set forth in these terms and conditions are in lieu of all other warranties, express or implied, including without limitation, implied warranties of merchantability or fitness for a particular purpose.

If you are having a problem with your NEMO product, please visit www.nemoequipment.com/tent-manufacturer-warranty or call NEMO Customer Service at 1-800-997-9301.

We will do our best to see that you are satisfied with your NEMO product. Our goal is to get you back in the outdoors as quickly as we can.

**WARNING**

Never place your stove, campfire, or other flame source in or near your tent. Never cook, light, or refuel a stove or any other heat source inside your tent. Death by suffocation and/or serious burns is possible.

Maintain adequate ventilation inside your tent at all times. Death by suffocation is possible.

Anchor your tent properly at all times to reduce the risk of loss or injury to the tent or occupants.

Carefully consider the possibility of falling rocks or tree limbs, lightning strikes, flash floods, avalanches, strong winds, and other hazards when choosing a campsite to reduce the risk of loss or injury.

If you have additional questions, please contact NEMO Equipment, Inc. directly at 800-997-9301.

NOTE: All 2010 NEMO tents meet the CPAI-84 standard for flame retardancy.



Printed on Recycled Paper



www.nemoequipment.com

©2010 NEMO Equipment, Inc.

INSTRUCTIONS FOR SETUP

To contact NEMO Customer Service
Email: journey@nemoequipment.com
Phone: 800-997-9301



1 Stake Corners (optional)

Secure the corner anchors by pounding the stakes into the ground with a rock or hard object. If the ground is too hard, trap the stakes under a rock or another heavy object.



2 Attach Outer Poles

Insert a long black pole through the short black sleeve on Moki's™ side and into grommet on red webbing. Repeat on opposite side. Repeat with second pole and grommets on black webbing. Clip tent to poles.

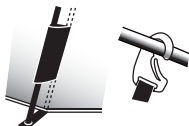

3 Insert Inner Poles

Place a grey pole through an open main door to a far corner so the pole sits in metal button. Bending the pole, place the other end in metal button on opposite corner. Repeat with second grey pole. Secure with Velcro® wraps.

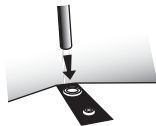

4 Insert Top Pole

Holding webbing finger loop, insert short black pole between grommets on top of tent. Open vents and doors to desired configuration.



5 Attach Vestibule

Insert prebent pole through sleeve on the vestibule, locking pole tips in the grommets. Zip vestibule to upper vestibule. Zip upper vestibule to either tent door. Stake corners and tension.



©2010 NEMO Equipment, Inc.



Remember to leave no trace. Before leaving your campsite take a thorough look around making sure you have not left anything behind, out of place, or damaged.

MOKI™