

Design Competition Rules

The following rules apply to all Design Competitions. Note that only non-professionals may compete.

1. General Regulations (pages 7-8), Judging Criteria (page 9) and the *Ontario Judging and Exhibiting Standards for Horticulture and Floral Design* (2003 edition) apply.
2. Exhibitors are requested to notify Convenors as soon as possible, which dates and classes they wish to enter. Do not wait to be called. Space will be reserved for each exhibit upon receipt of the completed Non-Professional Design Registration form, or when notice is received by letter or telephone. **Exhibitors unable to fulfill their responsibility must find their own substitute.**
3. Exhibitors may enter any number of classes, but may submit only one exhibit in each class.
4. All classes are limited to 5 exhibits each entry day except where noted in the Schedule.
5. First day exhibits will be received between 7:00 a.m. and 12:30 p.m. on Thursday, March 14, 2013. First day exhibits must be removed at 7:00 p.m. on Tuesday, March 19, 2013.
6. Second day exhibits will be received between 8:00 p.m., Tuesday, March 20 and 1:00 a.m., Wednesday, or between 7:00 a.m. and 9:00 a.m. on Wednesday, March 20, 2013.
7. All designs must be in place and ready for the Passing Committee at the following times:

Thursday, March 14, by 12:30 p.m. for judging at 1:00 p.m.

(They must remain in place until Tuesday, March 19 at 7:00 p.m.)

Wednesday, March 20 by 9:00 a.m. for judging at 9:30 a.m.

There will be a warning bell 15 minutes prior to the time of clearing the judging area on both entry days.

8. All exhibits must be removed promptly on Sunday, March 24 at **5:00 p.m.** Failure to do so will result in the exhibitor being billed for the cost of removal.
9. International Flower Show Rules, World Association of Flower Arrangers (WAFA) will apply.
 - An exhibit is made of plant material, with or without accessories, within a space specified in the Show Schedule.

- Plant material must predominate over all other components of the exhibit.
- The use of artificial plant material is forbidden unless stated in the regulations.
- Fresh plant material must be in water or in water-retaining material unless such material remains turgid throughout the event.
- Painted and/or artificially coloured plant material may be used unless otherwise stated in the regulations.

10. **All designs must be made and staged by the exhibitors themselves. Any competitor receiving help with put-in other than help that is physically necessary will be disqualified.**

11. All exhibitors are asked to leave their completed entry sheet with their entry at the time of entry. It should include: name, class, date, a list of material in the design, including both common and botanical names and explanation of containers of interest. See *Snippy Tips #1*. **Novice designation must be included on the entry sheet.** The list of material in the design should be duplicated, in block capitals or typed to be available for the judges.

12. Check with your class convenor to see that your entry meets all requirements set out in the schedule. **A design which does not comply will not be judged.** This will be at the sole discretion of the Design Committee Chair. **You may not leave the design area until your entry is accepted by the Passing Committee.** This will be indicated by the letter **P** marked on your entry card.

Regarding liability - see General Regulations page 8.

Scale of Judging Points

(except where otherwise stated)

Design: Organization of the elements and principles	35 points
Conformance: Compliance with scheduled requirements, theme	25 points
Creativity: Originality of concept in choice of components, and/or organization of design elements according to the principles of design	20 points
Distinction and Condition: Marked superiority and physical state of plant material at time of judging	20 points

Scale of Points for Tables: see *Ontario Judging Standards* (2003 edition)

Scale of Points for Miniatures: see *Ontario Judging Standards* (2003 edition)

Deductions will be proportionate to the degree of non-compliance.

Design Competitions

“THE MAGIC OF SPRING”

The Garden Club of Toronto Classes

Open to members of The Garden Club of Toronto

NOVICE CLASS

Open to members of The Garden Club of Toronto who have not previously won a red ribbon in any major Garden Club of Toronto Show or Canada Blooms Show (excluding monthly Neil Cup and Margaret Dove competitions)

Class 101 Charming

A table centerpiece

Staged: on a solid pedestal 91.5cm high with a 30cmsquare top (36"x12"x12"), mounted on a base 91.5cmx91.5cmx15cm high (36"x36"x6") against a background panel 91.5cm wide x 183cm high (36"x72")

Area Allotted: 91.5cmx91.5cmx183cm (36"x36"x72")

Background, base and pedestal colour:
Mystical Grape *2071-30

Convenors: Donna Buss
Janet Marsh Frosst

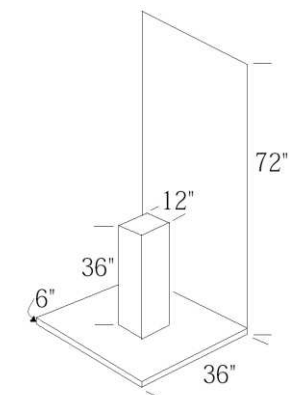

416-446-2843
416-483-4714

Class 102A Wondrous

102B A design

**Entry
Day 2
only**

Staged: on a base 122cmx122cmx10cm high (48"x48"x4") against a background panel 122cm wide x 244cm high (48"x96")

Area Allotted: 122cmx122cmx244cm (48"x48"x96")

Background and base colour:
Sweet Pea *2031-30

Convenor: Sue Schaal

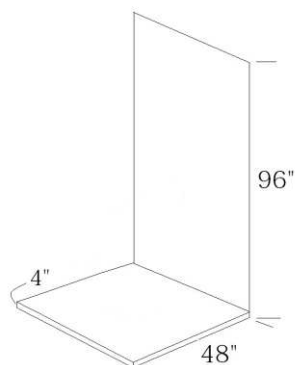

416-922-7875

* Benjamin Moore paint number

Class 103 Magnetic

A synergistic design

Staged: on a floating shelf 122cm wide x 61cm deep (48"x24") at a height of 91.5cm (36") against a background 122cm wide x 213cm high (48"x84"). Design may trail below the shelf

Area Allotted: 122cm wide x 61cm deep x 213cm high (48"x24"x84")

Background and shelf colour:
Sweet Pea *2031-30

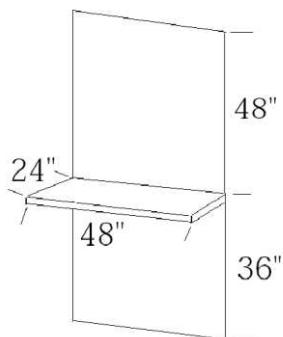

Convenors: Joyce Moffat
Linda Alcock

416-445-0813
416-481-9894

Class 104 Enchanting

A functional table

Note: Objects may be hung from the top of the wall, however, nothing is to be placed on the ground.

Staged: on a round table 99cm in diameter x 74cm high (39"x29") on the ground, against a wall 122cm wide x 244cm high (48"x96")

Area Allotted: 122cmx122xmx244cm (48"x48"x96")

Background colour: Mystical Grape
*2071-30

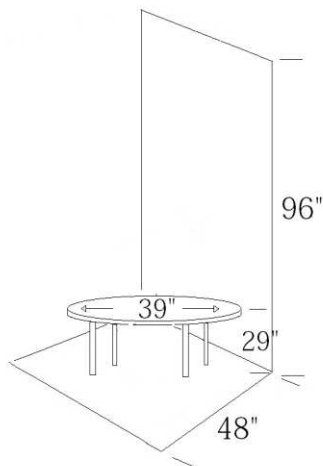

Convenors: Sue Schaal
Heather Bosman

416-922-7875
905-877-1533

* Benjamin Moore paint number

Class 107 Awesome

An abstract design

Staged: in a niche. Design may be hung. Nothing to be attached to the walls.

Area Allotted: 111.5cm wide x 81cm deep x 142 cm high (44"x32"x56")

Niche colour: Sweet Pea *2031-30

Set colour: Mystical Grape *2071-30

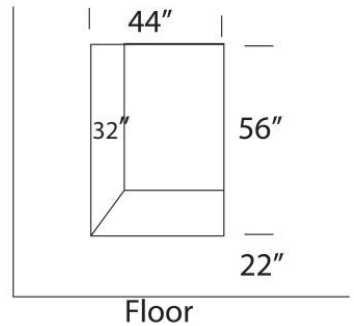

Convenor: Trudy Grantham
Diana Kennedy

416-691-5333
905-983-1187

Class 108A Devilish

108B A cake (any flavour) made of plant material

Staged: on a 30cm (12") round tube topped with a disk 46cm (18") in diameter. Height: 5 entries at 91.5cm (36") and 5 entries at 107cm (42").

Area Allotted: 91.5cm wide x 91.5 cm deep (36"x36"). No height restriction.

Tube and disk colour:
Sweet Pea *2031-30

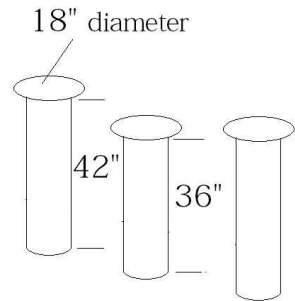

Convenors: Judy James
Trish Symons

416-960-2010
519-941-2175

* Benjamin Moore paint number

Class 109 Bedazzling

A modern mass

Staged: on a black wrought iron pedestal 91.5cm high 30.5cm square top (36"x12"x12") on a round base 122cm x 10cm high (48" x 4") background is 122cm x 244cm (48" x 96")

Area Allotted: 122cm x 122cm x 244cm (48" x 48" x 96")

Base and background colour:
Mystical Grape *2071-30

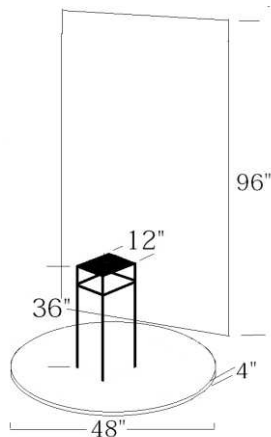

Convenors: Judy Zinni
Sandra Williamson

905-820-3807
519-855-9552

OPEN CLASSES

Open to all members of garden clubs and horticultural societies
including The Garden Club of Toronto

Class 110A Spellbinding

110B A design to suggest a piece of jewellery using dried and/or treated plant material, equipped to hang on a wall. (A judicious amount of dyed and/or painted material permitted.)

Entry Day 1 only – to remain in place for 10 days.

10 entries

Staged: The design should be contained within the display board. 46cm x 46cm (18" x 18") Entry must be equipped to hang.

Area allotted: 46cm x 46cm (18"x18")

Background colour: Mystical Grape 2071-30

Display board colour:
Cotton Balls *2145-70

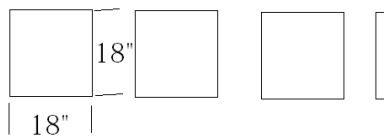

Convenors: Lynda Summerville
Ursula Eley

416-690-5434
416-699-4353

* Benjamin Moore paint number

Class 111 Magical

A collage, an abstract design. (See OJES).

An unframed, low-relief design of dried, pressed and/or preserved plant material, equipped to hang on a board (28"x28") either vertically or horizontally. Not to exceed 61cm x 40cm (24"x16") and not less than 35.5cm x 30.5cm (14"x12").

Maximum depth of design: 5cm (2").

Note: Entries must be received or registered by February 15, 2013, and removed on Sunday March 24, 2013 at 5:00p.m.

Background colour:

Mystical Grape *2071-30

Board colour:

Cotton Balls *2145-70

Convenors: Irina Code

519-660-1823

Lynda Summerville

416-690-5434

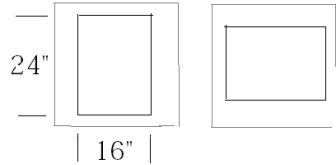

Open to all members of garden clubs and horticultural societies *other than* The Garden Club of Toronto.

Class 112 Houdini

A design incorporating metal

Staged: on a pedestal 30cm square and 91.5cm high (12" x 12" x 36") on a base 122cm x 122cm x 5cm (48" x 48" x 2") **Background** is 122cm x 213cm (48" x 84").

Area Allotted: 122cm x 122cm x 213cm (48" x 48" x 84")

Background, base and pedestal colour: Mystical Grape *2071-30

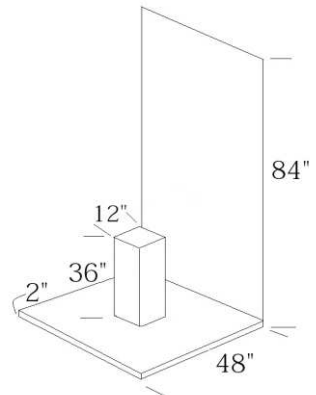

Convenors: Brigitte Ballhausen
Lil Taggart

416-927-8711
289-891-9668

* Benjamin Moore paint number

INTERNATIONAL CLASS

Class 113 CAPTIVATING

**Entry
Day 1
only**

A design

Staged: on a base 122cm x 122cm x 10cm high (48"x48"x4") against a background panel 122cm wide x 244cm high (48" x 96")

Area Allotted: 122cm x 122cm x 244cm high (48"x48"x96")

Base and Background colour:

Sweet Pea *2031-30

Note: Exhibits to remain in place until 7pm on March 19.

Exhibitors may view the set Wednesday, March 13 but no installation is to take place before 7:00 a.m. Thursday, March 14.

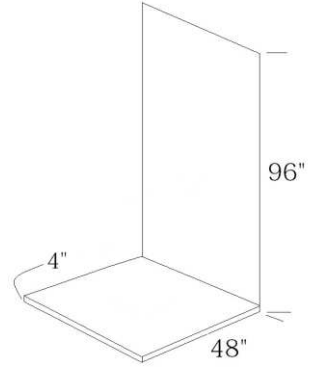

Convenor: Margaret Taylor 416-440-1344

IKEBANA CLASS

Class 114 AWAKENING

Ikebana design

Staged: on a pedestal 76cm (30") high with a 46cm (18") square top against a background 91.5cm wide x 183cm high (36"x72")

Area Allotted: 91.5cm x 91.5cm x 183cm (36"x36"x72"). Design may extend below the top of the pedestal.

Background and pedestal colour:

Sweet Pea *2031-30

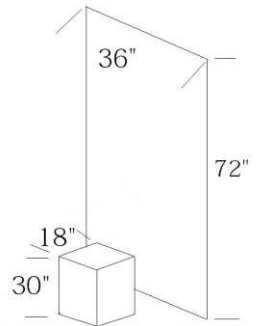

Convenors: Sue Clarkson
Saskia Kessler

416-763-3918
416-445-6731