

# Rinnai

## Gas Log Flame Fires



Experience Our Innovation

## Experience Our Innovation

---

For 40 years Australians have been enjoying the comfort, convenience and reliability of Rinnai gas appliances. Our innovative products are designed with the environment in mind, with low emission technology and high efficiencies, as well as a host of other great features.

Rinnai is committed to ongoing innovation - delivering efficient, well designed and engineered lifestyle solutions offering a host of benefits including ambience, versatility, control and reliability. Backed with extensive warranties and after sales service teams, Rinnai is proud to be the No.1 choice for gas space heating in Australia.

Through innovation, we will endeavour to continue offering superior ranges of home appliances that provide a clear insight into what the future holds for Australian homes.

### Why choose Rinnai

There are many types of heating systems available for Australian homes. Rinnai heating systems bring you the latest advanced technologies that provide you with choices that can meet individual needs. Whether relating to safety, convenience, available space, environmental needs or ongoing running costs, Rinnai will have a system that suits.

### CONTENTS

- 03 Important tips
- 04 Heater Selector
- 05 Sizing and Installation
- 06 Slimfire Flame Fire
- 08 Royale Flame Fire
- 10 Sapphire Flame Fire
- 12 Symmetry Flame Fire
- 14 Aspiration Flame Fire
- 16 Luminaire Flame Fire
- 18 Specifying Guide
- 22 Specifications
- 23 Other Rinnai Products



## Important Tips for heater selection

### Energy Star Ratings

Energy Star ratings are an industry wide independent rating that gives an indication of how efficiently a heater operates. The more stars the greater the efficiency. Typically Portable gas heaters have around 5.9 Stars with the majority of flued heaters around 4.0 to 4.5 Stars. Some older type heaters are not as efficient, however they still perform extremely well with large heat outputs.

### The Environment

In Australian homes, heating & cooling amounts to around 23% of household energy use – second only to hot water. Gas is one of the most greenhouse friendly fuel sources available and selection of a Rinnai gas heater can assist with our global need to reduce carbon emissions. In addition, the better insulated your home, the less work the heater needs to do, the less gas you will use and the less impact on the environment.

### Comparison of Energy use around the home

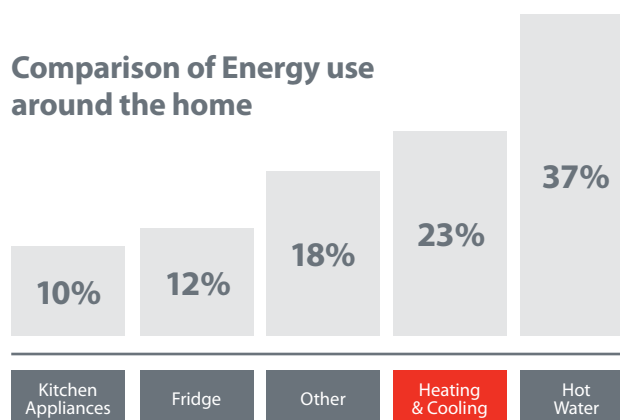

Source: Department of Environmental & Climate Change NSW

### Running Costs

Rinnai gas heaters are designed to be highly efficient, and when used correctly, are a very economical form of home heating. The running cost of gas heaters compare very well to other forms of heating. Straight electric heating is by far the most expensive, with both gas heaters and electric reverse cycle heaters comparatively less expensive.

When comparing differing forms of heating in relation to running costs, it is important that the comparison is based on the same kW output of heat. Once we are comparing 'apples with apples', the calculation of the running cost is then based on the energy used (kW input) to achieve that output. The actual tariffs that are charged are listed on energy bills.

### Selecting the right heater

It is very important that careful consideration is given to selecting the correct model/size of any heater. Critical factors such as the area to be heated, along with specific design and insulation characteristics of a home must all be considered. On the next page there is a heater selector relating to correct sizing or you can use our on-line version at [www.rinnai.com.au](http://www.rinnai.com.au). In general, heater sizing should be based on the kW output of the heater. As a very rough guide to heating performance (based on our heating zones):

<b>Very Cold Zone:</b>	1 kW output will heat approx 8.5m <sup>2</sup>
<b>Cold Zone:</b>	1 kW output will heat approx 10m <sup>2</sup>
<b>Cool Zone:</b>	1 kW output will heat approx 13m <sup>2</sup>
<b>Mild Zone:</b>	1 kW output will heat approx 16m <sup>2</sup>
<b>i.e. a 7.3 kW output heater in a Cool Zone will heat approx 95m<sup>2</sup></b>	

#### HANDY HINT

**The MJ input of heaters should not be used for comparison. The kW output is the only true 'apples for apples' method.**

**As an example, a 25MJ input, 5.9 Star heater has a larger heat output than a 25MJ 3.1 Star heater.**

## step 1 climate

Pictured on the right is a climate map of Australia that shows four winter climate zones relevant to Rinnai Heaters; Mild, Cool, Cold and Very Cold. It is important that you choose the correct zone that suits an application, as it directly relates to the performance of the heater. Detailed State maps can be found on the 'heater selector' page of our website: [www.rinnai.com.au](http://www.rinnai.com.au).

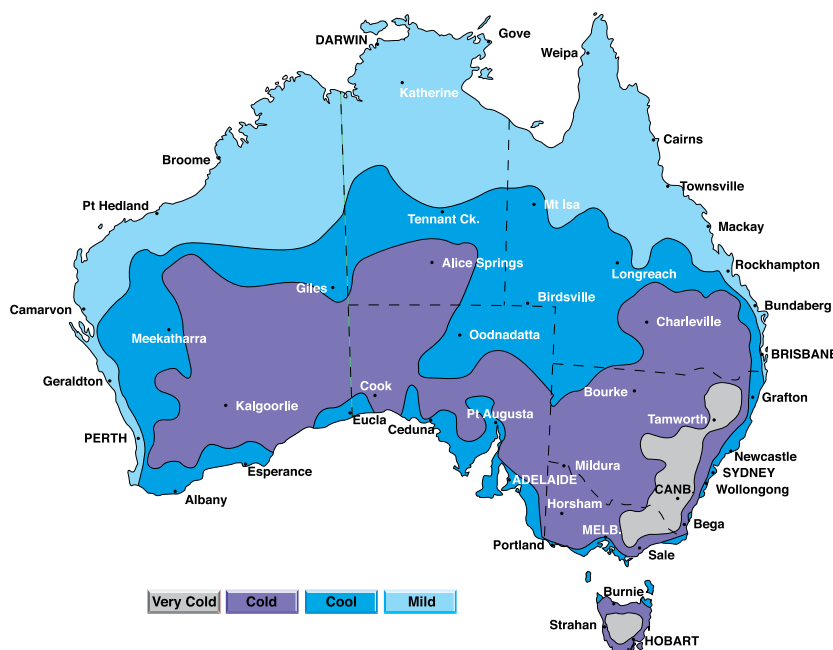

## step 2 heating area

It is also important that you consider the size of the heating area. This includes adjacent rooms through permanently open doorways and hallways. On pages 10-12 you will find the approximate maximum area that the unit will heat based on the climate zones (ie. Step 1).

Calculate your selected Rinnai Heater's Capacity			
1. Selected Heater		4. 'Heats up to' Capacity (see specifications)	m <sup>2</sup>
2. Climate/Zone		5. Less Heat Loss (see specifications)	%
3. Total area you are going to heat (length x width)	m <sup>2</sup>	6. Adjusted Capacity	m <sup>2</sup>

↑ Your area should be less than the Adjusted Capacity ↑

## step 3 heat loss

Not all homes will have all of the features listed in the table to the right. Consequently, this will affect the heating capacity. Place a ✓ alongside each of the design features if they are relevant to your home. Everywhere there is a ✓, an adjustment to the 'Heats up to' capacity will need to be made.

Please note that this is only a guide and individual house designs and locations may vary.

Contact the Rinnai Helpline if you require further assistance  
1300 555 545.

**calculate on-line  
in 3 easy steps**

✓	Heat Loss Factors		Deduct	Example
<input type="checkbox"/>	No Ceiling Insulation	-10%	_____ %	
<input type="checkbox"/>	House built on stumps (not a slab)	-5%	_____ %	-5%
<input type="checkbox"/>	No carpets on floors	-5%	_____ %	-5%
<input type="checkbox"/>	No drapes on windows	-5%	_____ %	
<input type="checkbox"/>	Uncurtained window area exceeding 15.0m <sup>2</sup>	-10%	_____ %	
<input type="checkbox"/>	Ceiling height exceeding 2.4m			
<input type="checkbox"/>	If Yes, height 2.5 - 2.8m	-3%	_____ %	
	2.8 - 3.0m	-5%	_____ %	
	3.0m +	-7%	_____ %	
	Reversible Ceiling Fan (positive)	+5%	_____ %	
<input type="checkbox"/>	<b>HEAT LOSS FACTOR</b>	<b>TOTAL</b>	_____ %	<b>-10%</b>

As an example, you wish to purchase a Slimfire gas log flame fire, live in the 'Cool' zone, and have an area to heat of 65m<sup>2</sup>. The recommended 'Heats up to' capacity for this model is 68m<sup>2</sup>, however you also have no carpets on the floor and a house built on stumps. The heat loss total percentage is -10% (-5% + -5% = -10%) which is deducted from the 68m<sup>2</sup> (the capacity of your heater) as a % to reduce it to 61m<sup>2</sup>. This will no longer heat your desired 65m<sup>2</sup>. The next model up is the Royale Inbuilt with a 'Heats up to' capacity of 93m<sup>2</sup>, less the 10% heat loss = 84m<sup>2</sup>, which will adequately heat the area.



## Sizing and Installation

### Correct Sizing

Correctly sizing your heater is vital for optimum performance and ultimately your comfort. To assist you with the right selection, we have divided Australia into four winter climate zones; mild, cool, cold and very cold. These zones relate directly to the 'Heats up to' capacities in the specification tables. They are to be used as a guideline only and assume a well insulated home with carpets, wall and ceiling insulation and curtains on windows.

A detailed Heater Selector is available on-line at [www.rinnai.com.au](http://www.rinnai.com.au). Postcode driven, it simply assists in calculating your heat loss factors. It takes into account features such as high ceilings, polished floorboards and large uncovered windows and then selects the appropriate Rinnai appliances. Detailed State heating zone maps can also be found.

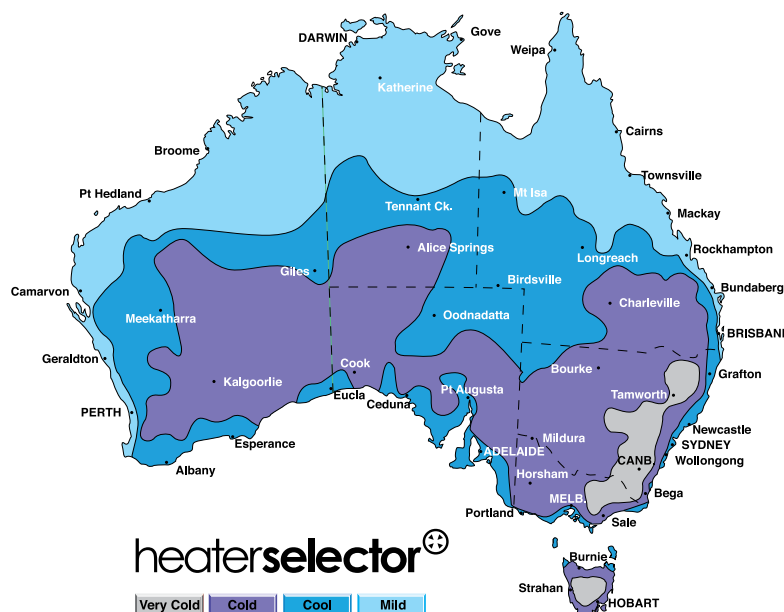

### Installation Flexibility

Rinnai understands that not all households have existing masonry fireplaces which is not an issue with a Zero Clearance Box. This allows installation against combustible materials such as wall studs - the Aspiration and Symmetry fires are already zero clearance by design. For the Royale, Slimfire and Sapphire ranges, a separate Zero Clearance Box needs to be purchased and installed as shown below.



**Rinnai**



The **Slimfire** has a compact slimline design ideal for renovations and replacement of older heaters

- **Designed to fit easily** into most existing fireplaces, easy replacement for old style space heaters
- **No flue required** when installed into a sound masonry fireplace, reducing installation costs
- **Realistic flame picture with 3 Heat settings**, adjust according to your needs
- **Gentle 2 Speed Fan** allowing for even and quiet heat distribution
- **Electronic Ignition** for seamless one touch operation
- Suitable for **small to medium** sized rooms
- Available in both Natural Gas and LPG

#### Console Kit

Designed for convenience, the Slimfire console is ideal for situations where a false fireplace is not desired or where there is no masonry fireplace, providing flexibility and reduced installation costs. Purchased in addition to the Slimfire, the kit simply assembles around the fire allowing it to be installed against a wall utilising an "in wall" flue system.



Slimfire Console Kit



Metallic Black



Stainless Steel

#### Options

##### Models

Inbuilt  
Console

##### Colour

Metallic Black  
Stainless Steel

##### Note

- Separate flueing required with Console Kit and non-masonry installations. Please refer to page 20
- Zero Clearance Kit available separately
- Mandatory Dress Guards not shown for illustrative purposes
- Pictures may vary slightly from actual models. Please check in-store



**Rinnai**





The Rinnai **Royale** Gas Log Flame Fire features the classic design of a wood fire

- **The look & feel of a traditional wood fire** without all the hassle and the mess
- **Full Electronic Thermostatic Control**, select a desired temperature which is then maintained by the heater (select auto-off function)
- **Dual Digital Timers** allows for on and off programming for both mornings and evenings
- **Pre-heat Mode** ensures your room is pre-heated by the time programmed
- **Flame Function** overrides the thermostat and maintains a constant flame picture when only the ambience of the flames is desired
- **Powerful 2 speed fan** allowing for even heat distribution
- **Electronic Ignition** for seamless one touch operation
- **Child Lock** prevents unwanted access
- **Remote Control** with on/off and temperature control
- Suitable for **large open plan living** areas
- Available in both Natural Gas and LPG



Inbuilt in Black



Freestanding in Black



Royale Freestanding in Black



Top Mounted Control Panel (Inbuilt)



Remote Control (All Models)

### Options

#### Models

Inbuilt  
Freestanding

#### Colours

Metallic Black

#### Note

- Separate flueing required on all models
- Please refer to page 20, Zero Clearance Kit available separately for inbuilt models, Mandatory Dress Guards not shown for illustrative purposes.

**Rinnai**



## Rinnai's **Sapphire** Flame Fire, now with new fascia options

- Ideal for new homes, renovations or simply replacing an old wood fire
- Clean burning technology enhancing energy efficiency - **4.1 Stars**
- **Powerful 6.97kW heat output** suitable for heating large open plan areas
- **Instant heat source** with the ambience and glow of flickering flames
- Realistic Australian **Eucalyptus Log Set**
- **Optional Remote Control** featuring programmable timer, flame override and fully thermostatic operation for added comfort
- **Stylish Glass Fascia** for added protection
- Available in both Natural Gas and LPG

### 4 models allowing flexible installation options including:

**Existing Masonry Fireplaces** - fits into almost all existing masonry fireplaces, no flueing is usually necessary if fireplace is in a sound condition.

**False Fireplace Installation (Zero Clearance)** – enables the construction of a false or mock fireplace. Zero Clearance box ordered separately.

**Freestanding Plinth Option** – A traditional gas log flame fire design with the unit resting on an elevated plinth. Plinth Kit ordered separately.

**Freestanding (Floor Mounted) Option** – This freestanding design has a more contemporary feel with the unit simply resting on the same size base. Console Kit ordered separately.



Sapphire Freestanding with Plinth



Full Function Remote Control



Fascia Detail



inbuilt in All Silver



Freestanding Plinth in All Black (Selected stores only)



Stainless Steel on Black fascia

### Options

#### Colours

- Stainless Steel on Black Fascia
- All Black Fascia (Selected stores only)
- All Silver (Stainless steel) fascia

#### Note

- Separate flueing required on Freestanding models. Please refer to page 21.

\* Check online for availability in-store



**Rinnai**





## The **Symmetry** Gas Log Flame Fire designed to be the focal point of your living environment

- Wide panoramic landscape orientation
- Flush against the wall stylish modern design
- **Fully thermostatic operation** for convenience and comfort
- **Multiple timers** - 4 periods per day can be programmed at varying temperatures. Ideal for mornings, daytime, evening and overnight.
- Gentle flickering flame offering a warm realistic **ambience**
- Design registered Australian **Eucalyptus Log Set**
- Fine mesh **Dress Guard** for added protection
- Powerful multi-speed fan to assist with even heat distribution
- **Direct Vent Flue system**, Vertical or horizontal flue termination available allowing flexible installation options
- High energy efficiency - **4.2 Stars**
- **Room sealed appliance** for superior indoor air quality - combustion air drawn directly from outside
- **Full function 'RF' Remote** (no need to point directly at the unit) with an easy to read LCD screen
- **Inbuilt Zero Clearance** so it can be installed in false fireplaces
- Available in both Natural Gas and LPG



Black



Silver (Selected stores only\*)



Symmetry in Black



Remote Control



Dress Guard

### Options

#### Colour

Black

Silver (Selected stores only\*)

#### Note

- Separate flueing is required  
Please refer to page 19
- Mandatory Dress Guard not shown for illustrative purposes
- Not suitable for retrofitting into an existing masonry fireplace

#### Handy Tip

The Symmetry is particularly suited to new homes and renovations where the fire can be installed at the framing stage

\* Check online for availability in-store.

**Rinnai**



## The **Aspiration** Gas Log Flame Fire embodies state of the art technology and modern styling

- **Modern design** perfect for new homes and renovations
- **Double glazed fascia** with no mesh screen required
- **High efficiency** power flued heater with flexible installation options
- **Superior indoor air quality** with zero emissions into the room, ideal for those susceptible to allergies or air quality issues - combustion air drawn from outside
- **Thermostatically Controlled** with 7 Heat settings and a 3 speed fan – allowing for even heat distribution for comfort and convenience
- **Dual Digital Timers** allow for on and off programming for both mornings and evenings
- **Pre-heat Mode** ensures your room is pre-heated by the time programmed
- **Flame Function** overrides the thermostat and maintains a constant flame picture when only the ambiance of the flames is desired
- **Inbuilt Zero Clearance**, no need for a fireplace as it can be safely installed in a combustible cavity
- **Electronic Ignition** for seamless one touch operation
- **Remote Control** featuring LCD display and control of all heater functions
- Suitable for **large open plan living** areas
- Available in Natural Gas as standard. LPG models converted to order



Aspiration in Stainless Steel



Remote Control



Realistic Flame Pattern



Flat Metal in Stainless Steel



Flat Metal in Black



Curved Glass in Black

### Options

#### Models

Flat Metal  
Curved Glass

#### Colours

Metal in Black or Stainless Steel  
Curved Glass in Black only

#### Note

- Fire and Fascias purchased separately
- Zero Clearance by design
- Separate flueing required on all models. Please refer to page 19

#### Handy Tip

Change the look of your Aspiration down the track by purchasing a new fascia



**Rinnai**





# Introducing the latest inspiration for outdoor entertainment the Rinnai **Luminaire** Outdoor Gas Flame Fire

Available as a simple freestanding fire or with single or double sided (see-through) cabinets with optional doors.

- Flexible design options that enables installation virtually anywhere outdoors
- Has a large natural flickering flame through a layer of white quartz stones
- Simple ignition with variable flame effect control
- Constructed from quality durable materials
- LPG unit can run on 9kg gas bottle with a simple connection the same as standard BBQs
- Can be converted to Natural Gas and permanently plumbed for convenience
- Suitable for both domestic and commercial hospitality installations

## The range at a glance

### Freestanding Outdoor Fire

- Most versatile installation option
- Minimum installation requirements
- Mesmorising flame patterns, providing a focal point for guests to gather
- Stylish stainless steel cover to protect burner when unit not in use.

### Single Sided Outdoor Fire

- Most popular design option
- Durable stainless steel cabinet
- Can be finished (clad) to suit any outdoor setting
- Optional glass doors

### Open See Through Outdoor Fire

- Flames are viewed from both sides, creating the feeling of space
- Becomes a centerpiece of an outdoor area
- Can be finished (clad) to suit any outdoor setting
- Optional glass doors for both sides

Specification Luminaire Outdoor Flame Fire		Freestanding	Single Sided Cabinet	Open See through Cabinet	Freestanding in an enclosed Cabinet
Gas Input MJ/h	LPG (Low-High)	25-45			
	NG (Low-High)	22-41			
Dimensions mm's (Height x Width x Depth)		197 x 1080 x 400			
Inbuilt Dimensions mm's (Height x Width x Depth)			555 x 1180 x 500*	500 x 1150 x 470*	



Single Sided



Freestanding



Open See Through

### Options

#### Models

Freestanding  
Single Sided  
Open See-Through

#### Colours

Black (Freestanding)  
Stainless Steel (Single Sided & Open See-Through)

## 4 Easy Steps to Specifying your Flame Fire

---

1

### Select Flame Fire

Use our easy heater selector guide to choose the correct sized flame fire to suit your heating needs. Choose from any of the six Rinnai Flame Fires styles.

- classic (Slimfire, Royale),
- contemporary (Symmetry, Sapphire, Aspiration)
- or outdoor (Luminaire)

2

### Select Installation Type

Depending on whether its an existing or mock fireplace, the location of your fireplace and gas connection, the type of install will vary accordingly. Use our easy guide to find the best install solution to suit your needs. Make sure you also consult an installer.

3

### Order Components (as required)

Depending on the installation type, you will need to order relevant flueing components accordingly. Use our guide for easy reference.

4

### Select Fascias / Media / Accessories (as required)

Last but not least, remember to select your preferred fascias, media or accessories (as required) to suit your environment & complete the look of your flame fire.

# Specification Guide

## (1) Aspiration Gas Log Flame Fire Power Flueing - ASPENG/L (Engine only)

### (2) Installation Type

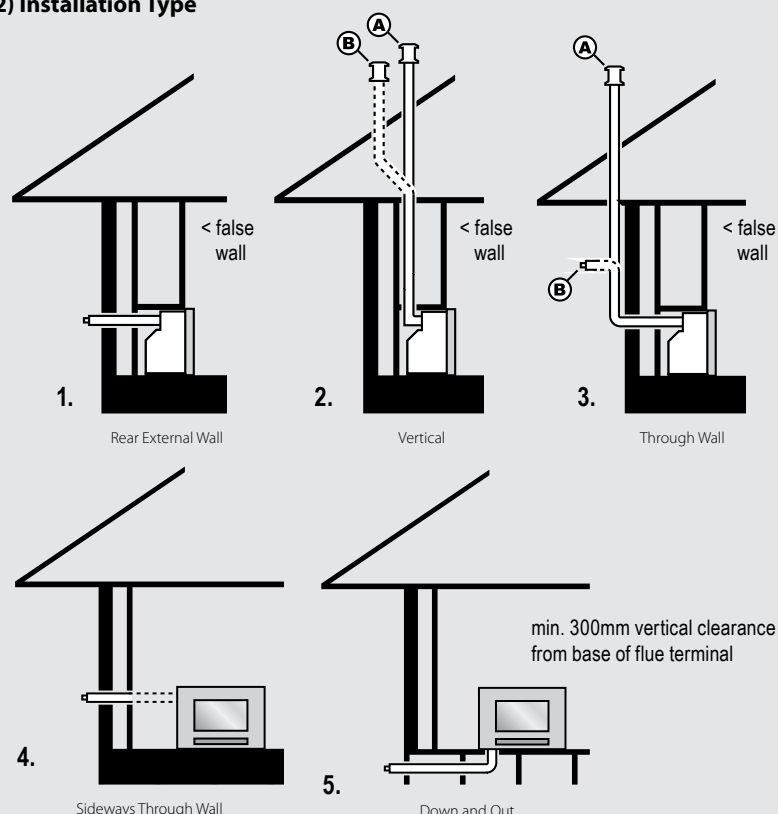

### (3) Order Components

#### Order Code

1	Direct Flue Kit	ASPDFK
2A	Vertical 'On Wall' Kit* Co-Ax Pipe 900mm* Roof Cowl	ASPKIT03 ESPIPE900 ESROOFCOWL
2B	Vertical 'On Wall' Kit* Co-Ax Pipe 900mm* Bend (2 x 45°) Roof Cowl	ASPKIT03 ESPIPE900 ESBEND ESROOFCOWL
3A	Direct Flue Kit Co-Ax Pipe 900mm* Bend (2 x 45°) Condensate Trap Roof Cowl	ASPDFK ESPIPE900 ESBEND ESCONDK ESROOFCOWL
3B	Direct Flue Kit Co-Ax Pipe 900mm* 2 Sets of Bends (2 x 45°) Condensate Trap Wall Terminal Kit	ASPDFK ESPIPE900 ESBEND x 2 ESCONDK ESWTKIT
4	Vertical 'On Wall' Kit* Co-Ax Pipe 900mm* Wall Terminal Kit	ASPKIT03 ESPIPE900 ESWTKIT
5	Vertical 'On Wall' Kit* Co-Ax Pipe 900mm* Bend (2 x 45°) Wall Terminal Kit	ASPKIT03 ESPIPE900 ESBEND ESWTKIT

### (4) Fascias

Slimline Metallic Black Fascia  
Slimline Stainless Steel Fascia

### Order Code

FLFASPFBB  
FLFASPFSS

### Fascias

Radius Glass Black Fascia

### Order Code

FLFASPFBBG

### Installation Clearances

Sides of appliance	100mm
Above appliance	250mm
In front	1000mm

\*includes condensate trap \*order lengths as required

## (1) Symmetry Gas Log Flame Fire - KSYMBN/L (Black) & KSYMSN/L (Silver)\*

### (2) Installation Type

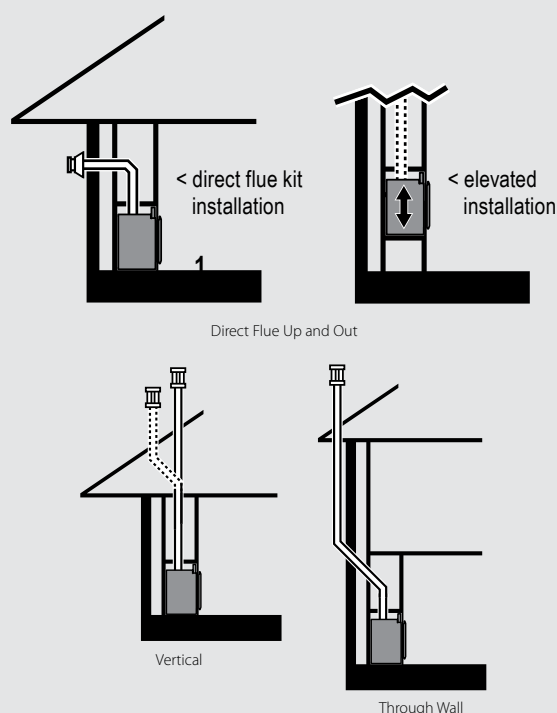

The Direct Flue Kit covers the majority of installations. Separate components are available for other installations as shown.

### (3) Order Components

#### Order Code

1. Direct Flue Kit

SYMDFK

#### Individual Components

90mm Flue Length  
230mm Flue length  
300mm Flue length  
600mm Flue length  
1200mm Flue length  
275-370 (adjustable) Flue length  
90° Elbow  
45° Elbow  
High Wind (Roof) Terminal Cap  
Square Horizontal (Wall) Cap

RDV903  
RDV907  
RDV906  
RDV904  
RDV902  
RDV911  
RDV990G  
RDV945G  
RDV991  
RDV984

\* Fascia Comes together with engine as a kit. Silver fascia in selected stores only. Check online for availability in store. Symmetry flueing combinations vary for each installation. Please refer to the installation instructions or online at [www.rinnai.com.au](http://www.rinnai.com.au)

### (4) Fascias

Black Fascia\*  
Silver Fascia\*

### Installation Clearances

Sides of appliance	400mm
Above appliance	400mm
In front	1000mm

**(1) Royale ETR Gas Log Flame Fire - RFSTROSN/L (Freestanding) or RIBTROSN/L (Inbuilt) - engine only.**

**(2) Installation Type**

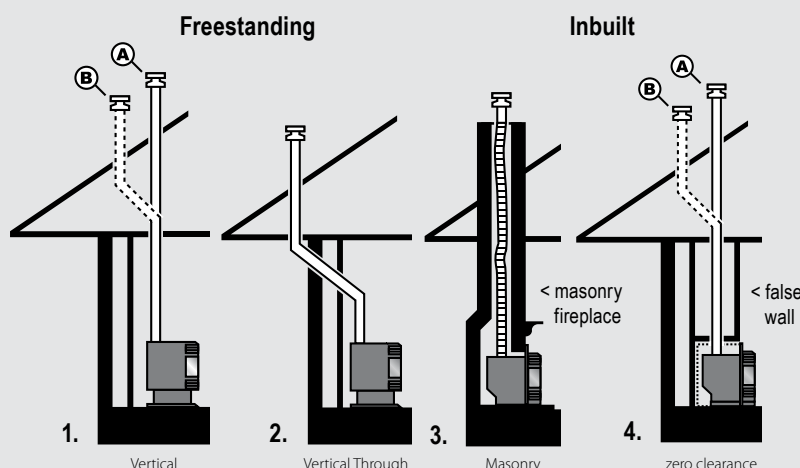

**(3) Order Components**

		Order Code
1A	Vertical Twin Skin Flue Kit (3.6m)	FLFKIT05B
1B	Vertical Twin Skin Flue Kit (3.6m) Twin Skin Offset	FLFKIT05B FLFBENDB
2	Thru-wall Twin Skin Flue Kit (3.6m) inc. 1x900mm Powder Coated & 3x900mm Galvanised Twin Skin Flues, Cowl & Wall Penetration Kit	FLFTWKITB
3	Flexiliner Flue Kit (5.0m)	FLEXLINER05
4A	Vertical Twin Skin Flue Kit (3.6m)	FLFKIT05B
4B	Vertical Twin Skin Flue Kit (3.6m) Twin Skin Offset	FLFKIT05B FLFBENDB

**(4) Inbuilt Zero Clearance Frame Dimensions**

(See installation instructions for full details)

745mm H x 810mm W x 440mm D (min.)

Metallic Black Zero Box

ZEROR1

**Freestanding Accessories**

450mm Twin Skin Flue  
900mm Twin Skin Flue  
45° Twin Skin Offset  
900mm Galvanised Flue Ext Twin Skin

**Order Code**

FLF0450MB  
FLF0900MB  
FLFBENDB  
FLFEXT03

**Inbuilt Accessories**

50mm Plinth  
45° Twin Skin Offset

**Order Code**

FLFRPB  
FLFBENDB

For Thru-Wall double storey applications, please order the 3.6 metre Thru-Wall Twin Skin Kit (FLFKIT03) and additional lengths of 900mm Galvanised Flue Extensions (FLFEXT03) as required

**Installation Clearances**

Sides of appliance 400mm  
Above appliance 400mm  
Back of draft diverter 100mm  
In front 1000mm

\*Nominate Metallic Black or Titanium

**(1) Slimfire Gas Log Flame Fire - SIBN/L (Black) or SIBSN/L (Stainless Steel)\***

**(2) Installation Type**

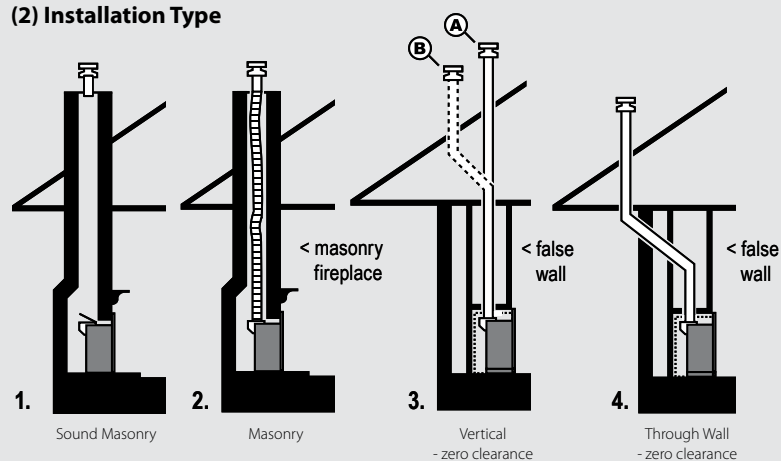

**(3) Order Components**

		Order Code
1	No Flue	N/A
2	Flexiliner Flue Kit	FLEXLINER03
3A	Vertical Twin Skin Flue Kit	FLFKIT05B
3B	Vertical Twin Skin Flue Kit Twin Skin Offset	FLFKIT05B FLFBENDB
4	Vertical Twin Skin Flue Kit Thru-wall Twin Skin Flue Kit	FLFKIT05B FLFTWKITB

**Inbuilt Zero Clearance Frame Dimensions**

(See installation instructions for full details)

675mm H x 685mm W x 370mm D (min.)

Metallic Black Zero Box

ZEROS

Titanium Zero Box

ZEROS2

**(4) Fascias**

Metallic Black Fascia  
Stainless Steel Fascia

**Order Code**

FLFSFB  
FLFSFSS

**Sided Fascia**

Inspiration 3 Sided Fascia - Duracote  
Inspiration 3 Sided Fascia - Black  
Inspiration 4 Sided Fascia - Duracote  
Inspiration 4 Sided Fascia - Black

INSP3FD  
INSP3FD  
INSP4FD  
INSP4FB

**Mantles**

Inspiration Mantle - Cherry  
Inspiration Mantle - Beech

INSPMC  
INSPMB

**Accessories**

Fluebox Adaptor  
50mm Plinth (Masonry Fireplaces only)  
90mm Ext Top 3-sided Surround (Black only)

**Order Code**

FLFAD1  
FLFSP\*  
FLFSBEXT

**Console Kit**

Extends protrusion of the Slimfire by 300mm.  
Kit includes sides, top and base plinth.  
All other components supplied by installing plumber

Metallic Black Console Kit  
Stainless Steel Console Kit

FLFSCB  
FLFSCSS

**Installation Clearances**

From top of glass 300mm  
From sides of glass 300mm  
In front 1000mm

\*Nominate Metallic Black or Stainless Steel/\*Fascia comes with engine for slimfire.



(1) Sapphire Gas Log Flame Fire - SAPN/L (Engine only)

(2) Installation Type

Inbuilt

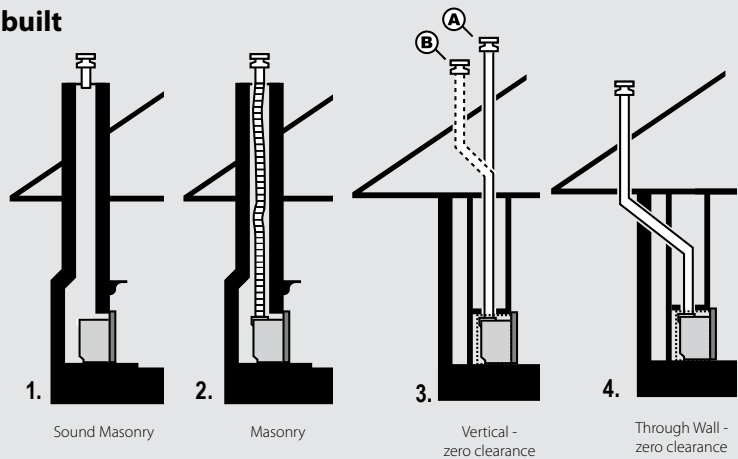

Freestanding (floor & plinth)

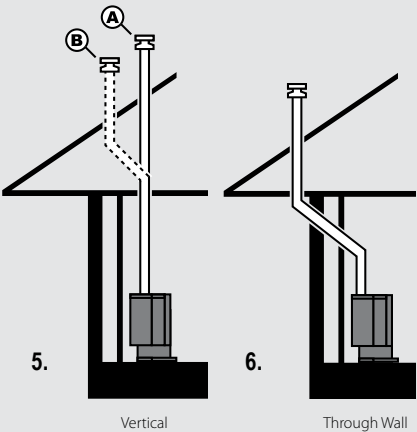

(3) Order Components

Order Code

Inbuilt	1	No Flue	N/A
	2	Flexiliner Flue Kit (5.0m)	FLEXILINER05
	3A	Vertical Twin Skin Flue Kit (3.6m)	FLFKIT05G
	3B	Vertical Twin Skin Flue Kit (3.6m) Twin Skin Offset	FLFKIT05G FLFBENDG
Freestanding	4	Vertical Twin Skin Flue Kit Thru-wall Twin Skin Flue Kit	FLFKIT05G FLFTWKITG
	5A	Vertical Twin Skin Flue Kit (3.6m)	FLFKIT05G
	5B	Vertical Twin Skin Flue Kit (3.6m) Twin Skin Offset	FLFKIT05G FLFBENDG
	6	Vertical Twin Skin Flue Kit Thru-wall Twin Skin Flue Kit	FLFKIT05G FLFTWKITG

(4) Accessories

Order Code

450mm Twin Skin Flue	FLF0450MG
900mm Twin Skin Flue	FLF0900MG
1200mm x 145mm Twin Skin Flue	FLFEXT03
Remote Control Accessory	SAPRM
Spigot Assembly (Zero Clearance & Freestanding)	SAPFSSA











Inbuilt Zero Clearance Cavity Dimensions

650mm H x 800mm W x 420mm D (min.)

Zero Box

SAPZEROCLR

## Gas Log Flame Fire Specifications

Model		Aspiration		Symmetry	Royale ETR		Slimfire	Sapphire			
											
Style		Slimline Metal	Radius Glass	Inbuilt	Free-standing	Inbuilt	Inbuilt	Masonry	Zero Clearance	Freestanding Floor	Free-standing
Visual Dimensions (mm)	H	675	675	640	755	695	645	660	660	760	837
	W	900	900	1110	650	910	750	865	865	865	865
	D	90	126	13	560	167	335	462	462	425	425
Inbuilt Cavity Dimensions (mm)	H	660	660	845	N/A	595-675	550-630	600	650	N/A	N/A
	W	860	860	1100-1125	N/A	600-800	595-700	695	800	N/A	N/A
	D	450 <sup>(2)</sup>	450 <sup>(2)</sup>	Min 600	N/A	Min. 405	Min. 360	370	420	N/A	N/A
Colours		Metallic Black or Stainless Steel	Black	Black	Metallic Black	Metallic Black	Metallic Black or Stainless Steel	Black outer frame with Stainless Steel inner frame			
Gas Types		NG Only <sup>(1)</sup>		NG Only	NG/LPG			NG/LPG			
Gas Input MJ/h	Low	8	8	19	8	8	7.7	14	14	14	14
	High	31.5 <sup>(3)</sup>	31.5 <sup>(3)</sup>	33	35	33	25	30	30	30	30
kW Output		6.0	6.0	7.5	7.4	6.6	5.0	6.97	6.97	6.97	6.97
'Heats up to' Capacity (m <sup>2</sup> )	Very Cold	47	47	67	66	58	42	60	60	60	60
	Cold	56	56	80	79	69	50	70	70	70	70
	Cool	74	74	108	106	93	68	95	95	95	95
	Mild	85	85	124	122	109	77	108	108	108	108
AS4553 Efficiency Star Rating		4.0 <sup>(4)</sup>	4.0 <sup>(4)</sup>	4.2	2.5	2.6	2.8	4.1	4.1	4.1	4.1
AS4553 Emissions Star Rating NG & LPG		6.0	6.0	6.0	6.0	6.0	6.0	6.0	6.0	6.0	6.0
Thermostatic or Manual Control		Thermostatic					Manual 3 Settings	Manual/Remote Thermostat			
Dual Timers		Yes	Yes		Yes	Yes					
Multiple Timers (4 Periods)				Yes				Yes, with optional remote control			
Preheat Feature		Yes	Yes		Yes	Yes					
Auto Off Mode		Yes	Yes	Yes	Yes	Yes		Yes	Yes	Yes	Yes
Override Button		Yes	Yes		Yes	Yes					
Flame Function		Yes	Yes		Yes	Yes		Yes	Yes	Yes	Yes
Child Lock or Lock Button		Yes	Yes		Yes	Yes					
Warranty	Heat Exchange	10 years pro rata <sup>(5)</sup>									
	Fan	2 years									
	All Other Parts	1 year									
	Free Labour	1 year									

### Please note:

(1) Lpg conversions are available at an additional cost and are made to order

(2) Suitable for direct, vertical or horizontal flueing. 500mm required for down and out flue applications. See installation instructions for full details

(3) 31.5 MJ/h when installed with a direct flue. Gas input 28MJ/h when installed with an extended flue

(4) 4.0 Stars when installed with a direct flue. Increases to 5.2 Stars when installed with an extended flue

(5) Full replacement costs in the first year, reducing 10% per year thereafter.

240V power is required with all models and a power cord & plug is fitted. In most cases this cord is standard on the right hand side of the appliance. The Royale & Slimfire Flame Fires also allow you to have the electrical cord on either the right or left hand side.

To hide the power cord, it is permissible to have the unit 'hardwired' behind wall cavities as long as it is in accordance with the Standard AS/NZS3000 and done by a qualified electrical tradesperson such as an electrician. In short, this means that it must be wired with an accessible double pole isolation switch.

Dimensions are subject to production tolerances and may vary slightly from those given.

Rinnai Australia Pty. Ltd. Reserves the right to make modifications and change specifications without notice. We will however endeavour to communicate any major changes well before implementation.

## Additional Rinnai Gas Appliances

---

In addition to the heating products in this brochure, Rinnai have many other great appliances to compliment both indoor and outdoor lifestyle solutions.

### Gas Boosted Solar Hot Water

Gas Boosted Systems are powered with the same technology as the Rinnai INFINITY. This means you can enjoy the benefits of Continuous Flow hot water, pre-heated with energy from the sun. For further information on applicable rebates, please refer to our on-line estimator at [rinnai.com.au](http://rinnai.com.au)

### Gas Continuous Flow Hot Water

Australia's No.1, the Rinnai INFINITY offers the convenience of temperature controlled hot water that never runs out. Compact and highly efficient, these units all boast a 5+ Star energy rating

### Portable Gas Space Heating

The Rinnai range of Portable Heaters are a highly efficient and flexible home heating alternative. They require no installation and can be stored away when not used. There are 3 forms of heating available - Radiant heat, Convection heat gently circulated with a fan and a combination of both Radiant and Convection heat.

### Flued Gas Space Heating

The Rinnai range of Flued Heaters are permanently installed in a home utilising fixed fluing to ensure there are no indoor emissions. They offer powerful heat in a wide range of designs and styles. They are perfect for homes undergoing renovations and in particular extensions where an additional efficient heating source is required.

### Need help with an installation?

In most situations Rinnai retailers can assist with the installation of our appliances. Should this not be the case, Rinnai has an installation service available direct to the end-user. Any installation of a Rinnai appliance is a specialist process and requires trained professional installers to ensure safe and efficient operation of the appliance. This is particularly relevant for connection to gas, electrical changeovers and the installation of Solar Collectors. Our Rinnai installers are not only very familiar with our products, but are fully insured and OH&S compliant. Be confident in your installation by employing Rinnai Service.

**For further information, please call 1300 555 545**

### Request a brochure

If you would like a brochure from any of product ranges you can call 13 14 19 or view and download online at [rinnai.com.au](http://rinnai.com.au)



All Greenhouse Gas emissions associated with producing this printed product have been offset.

*This product is 100% Carbon Neutral*



**RECYCLED**

Paper made from recycled material

**FSC® C014308**

# Rinnai



Gas Boosted Solar Hot Water



INFINITY 26Plus Continuous Flow Hot Water



Flued Gas Space Heating



Portable Gas Space Heating

The Rinnai logo consists of the word "Rinnai" in a white, bold, sans-serif font, centered within a solid red rectangular background.

**Rinnai**

**RINNAI AUSTRALIA PTY. LTD.**

ABN 74 005 138 769

10-11 Walker Street Braeside VIC 3195

For further information visit

**[www.rinnai.com.au](http://www.rinnai.com.au)**

**or call 1300 555 545**