

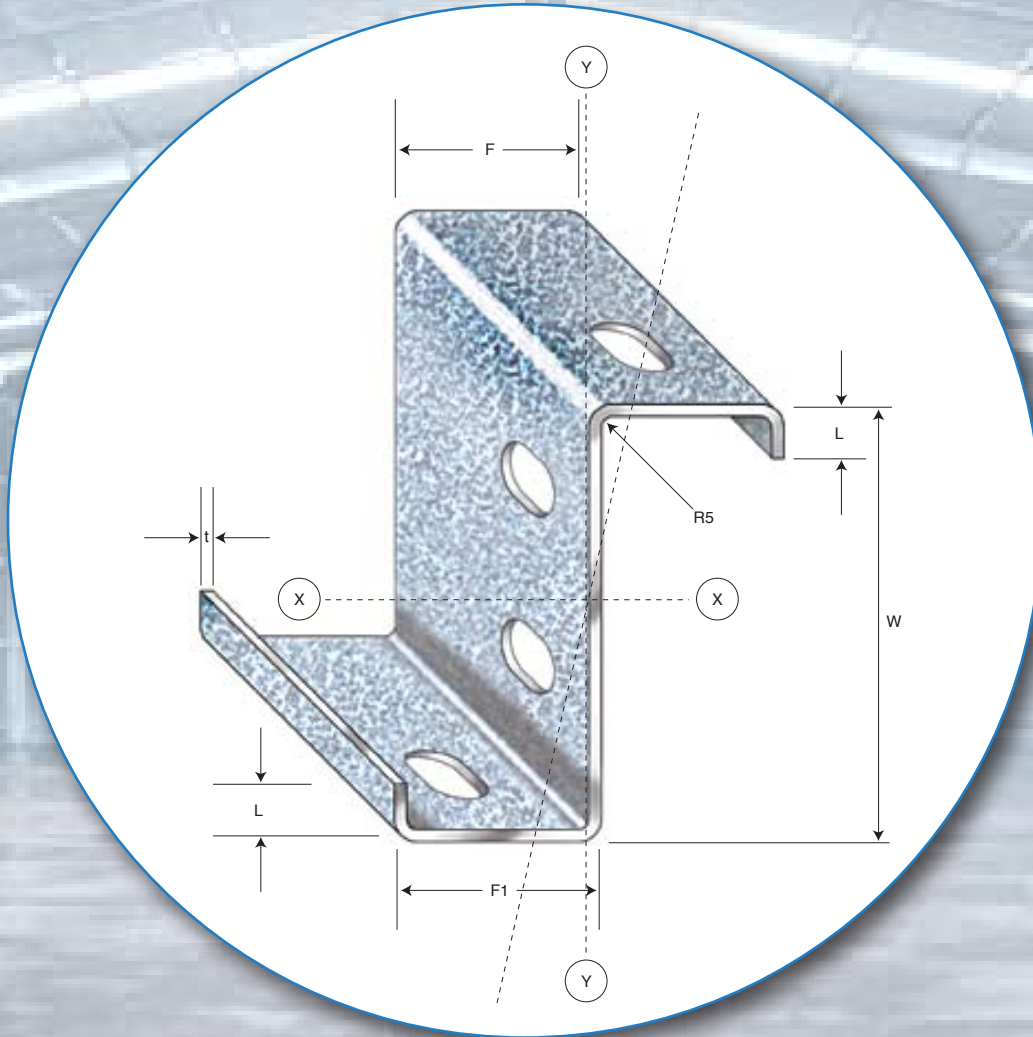

Steelline

JH STEPHENSON



Steelline Purlins

Dimensions - C Sections

Purlin Section	W mm	F mm	L mm	Thickness BMT mm	Section Mass kg/m
C10010	102	51	12.5	1.0	1.78
C10012	102	51	13.0	1.2	2.10
C10015	102	51	14.0	1.5	2.62
C10019	102	51	15.0	1.9	3.29
C15010	152	64	14.5	1.0	2.37
C15012	152	64	15.0	1.2	2.89
C15015	152	64	16.0	1.5	3.59
C15019	152	64	17.0	1.9	4.51
C15024	152	64	18.5	2.4	5.70
C20015	203	76	16.0	1.5	4.49
C20019	203	76	19.5	1.9	5.74
C20024	203	76	21.0	2.4	7.24
C25019	254	76	19.0	1.9	6.50
C25024	254	76	20.5	2.4	8.16
C30024	300	96	28.0	2.4	10.09

Dimensions - Z Sections

Purlin Section	W mm	F1 mm	F mm	L mm	Thickness BMT mm	Section Mass kg/m
Z10010	102	53	49	12.5	1.0	1.78
Z10012	102	53	49	13.0	1.2	2.10
Z10015	102	53	49	14.0	1.5	2.62
Z10019	102	53	49	15.0	1.9	3.29
Z15010	152	65	61	14.5	1.0	2.37
Z15012	152	65	61	15.0	1.2	2.89
Z15015	152	65	61	16.0	1.5	3.59
Z15019	152	65	61	17.0	1.9	4.51
Z15024	152	65	61	18.5	2.4	5.70
Z20015	203	79	74	16.0	1.5	4.49
Z20019	203	79	74	19.5	1.9	5.74
Z20024	203	79	74	21.0	2.4	7.24
Z25019	254	79	74	19.0	1.9	6.50
Z25024	254	79	74	20.5	2.4	8.16
Z30024	300	100	93	28.0	2.4	10.09

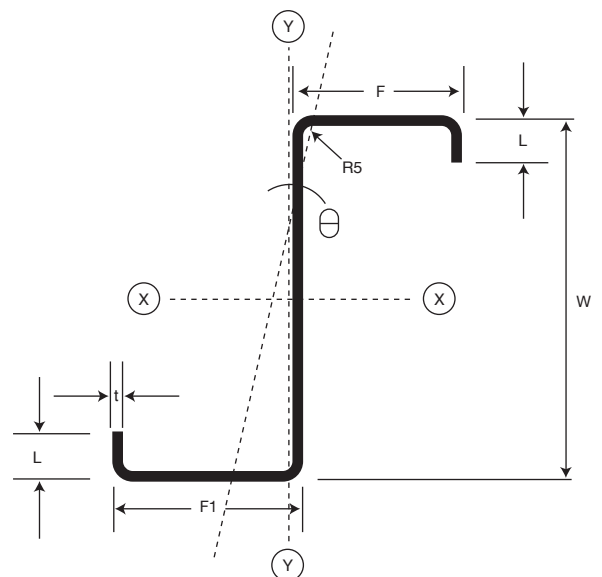
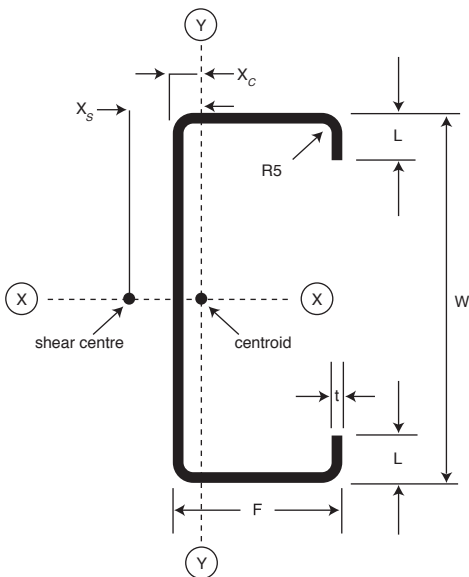

Quick Selection Purlin Chart for Carports and Garages (mm) - One (1) row of Bridging (10,000mm height)

Section	Wind Speed 33m/sec			Wind Speed 41m/sec			Wind Speed 50m/sec		
	900	1200	1500	900	1200	1500	900	1200	1500
C10010	4500	4200	3900	3900	3600	3300	3400	3200	2700
C10012	4900	4400	4200	4200	3900	3600	3700	3400	3100
C10015	5300	4900	4600	4600	4200	3900	4000	3700	3400
C10019	5800	5400	5000	5100	4600	4400	4500	4100	3800
C15012	6400	5900	5500	5500	5200	4800	4900	4500	4200
C15015	6900	6400	5900	5900	5500	5100	5200	4700	4500
C15019	7500	7000	6600	6600	6200	5700	5900	5400	5000
C15024	8100	7500	7200	7200	6700	6200	6400	5900	5500
C20015	8200	7600	7100	7200	6800	6200	6400	5900	5400
C20019	9200	8500	8000	8000	7500	6900	7100	6500	6100
C20024	9900	9200	8700	8700	8100	7500	7800	7200	6700
C25019	9900	9200	8700	8700	8000	7500	7600	7100	6600
C25024	10600	9800	9400	9300	8700	8100	8100	7700	7200

NOTE: These tables to be used as a guide only. Independent engineering is required for purlins and girts and is not available in this brochure.

- ▶ Galvaspan® G450 - Z350
- ▶ Terrain Category 3
- ▶ Roof Structure 0.1 kn/m
- ▶ Pressure Coefficient -0.9
- ▶ One (1) Row of Bridging
- ▶ Cleated or bracketed fixing only
(No Flange Bolting)
- ▶ Results are for a minimum of two spans
- ▶ Maximum 10.0m above General Level Terrain



Steeline

PURLINS & GIRTS

Dimensions in mm

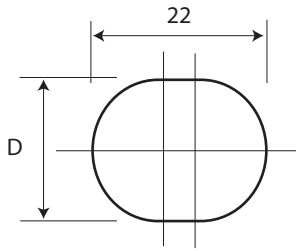

Standard elongated punched hole.
Holes equally spaced above and below centre line.

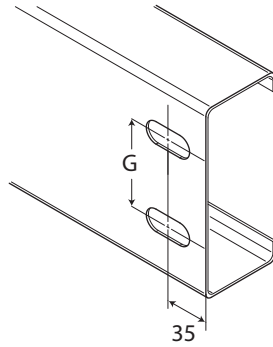

Nominal Section 60

Size (mm)	G (mm)	D
100	40	18
150 - VIC only	70	18
150 - Other states	60	18
200	110	18
250	160	18
300	210	22

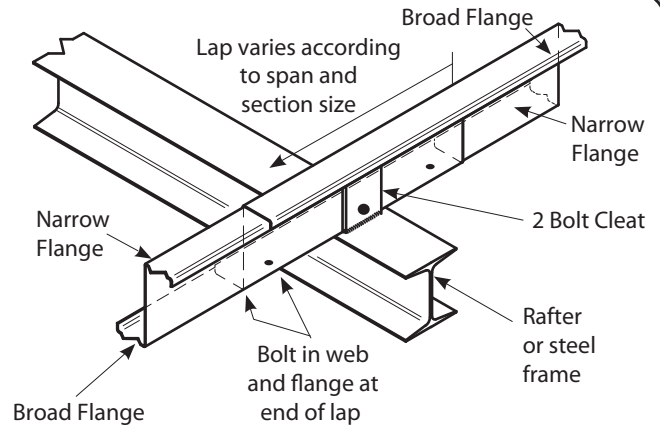
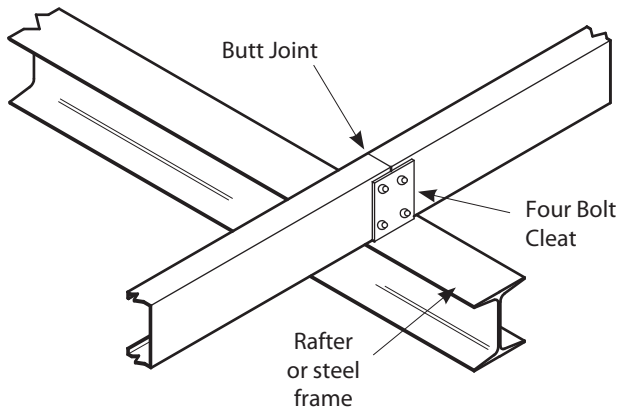

PURLINS ACCESSORIES

Purlin Bolts

M12 Size PB1230 standard purlin bolt (grade 4.6):
M12x30mm with nut



Fascia Bolts

PB1230 fascia bolt (grade 4.6):
M12x30mm with nut

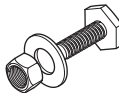

Purlin Bolts

M12 Size PB1230 standard purlin bolt (grade 4.6):
M16x45mm with nut



Adaptor Bracket

(4 bolts)
200 - 150
200 - 100
150 - 100

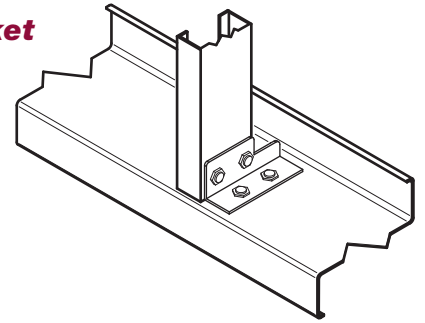

General Purpose Bracket 6 holes: 18mm diam

Cat. NO	A	B	C	D	E	F
GPB100	14	40	14	35	50	25
GPB150	23	64	23	35	65	25
GPB200	24	110	24	35	75	25
GPB250	24	160	24	35	75	25

Clamp Plate

Cat. NO	A mm
AC100	90
AC150	140
AC200	190
AC250	240

Angle Connector

Cat. NO	A mm
AC100	90
AC150	140
AC200	190
AC250	240

General Purpose Bracket

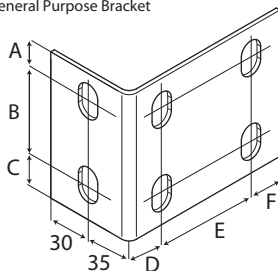

Clamp Plate

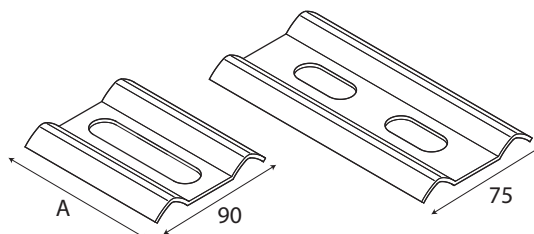

Angle Connector

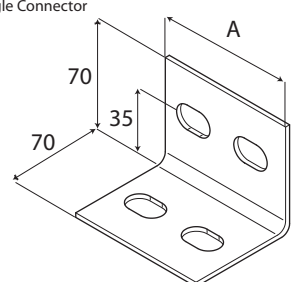

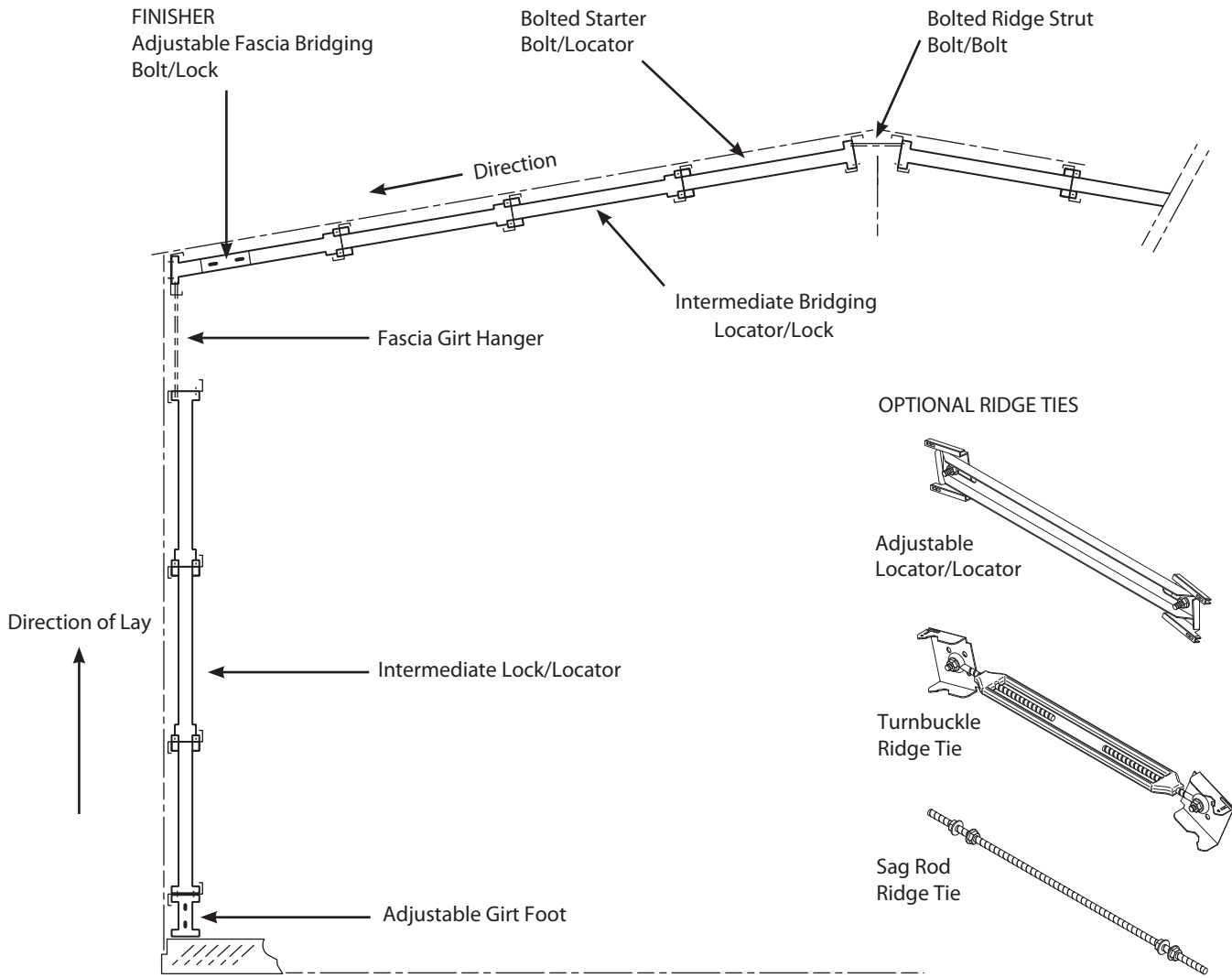

Intermediate Bridging

Place locator end through purlin holes as per Diagram 1. Snap the next piece of bridging into place by pushing the lock into the locator.



Diagram 1

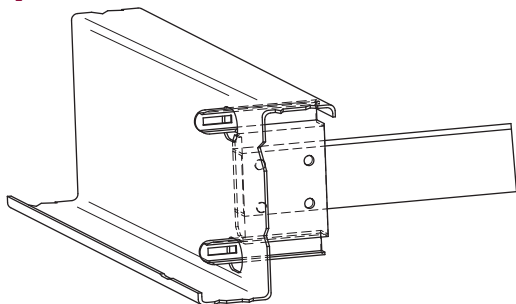
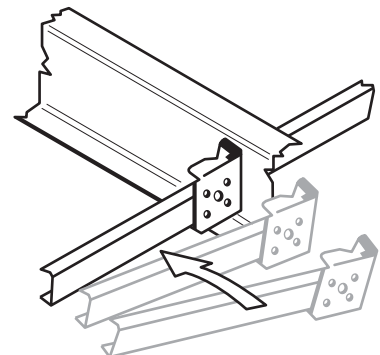

Diagram 2



Order Form PURLIN



GEELONG

75 Heales Road Corio 3214
Facsimile 03 5274 6200

LAVERTON

11 Westside Drive Laverton North 3026
Facsimile 03 9314 5675

Client				Date / /			Sheet No.
Project							
By	Checked	Holes	Other Options	Finish	Delivery Date	Sales Docket	Z/C

Broad Flange

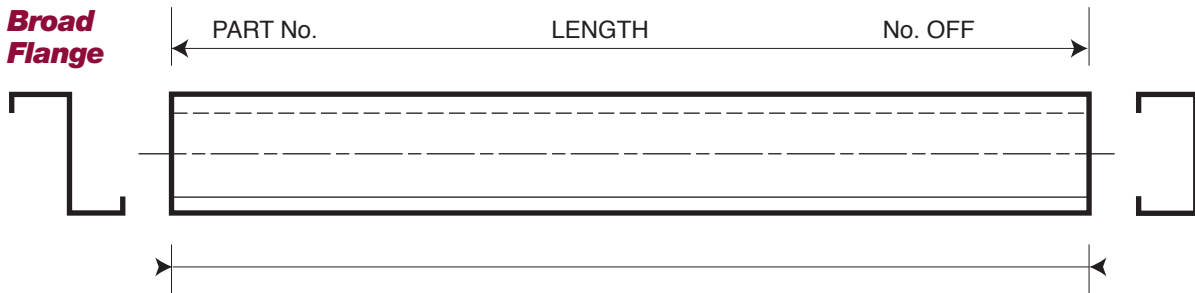

Broad Flange

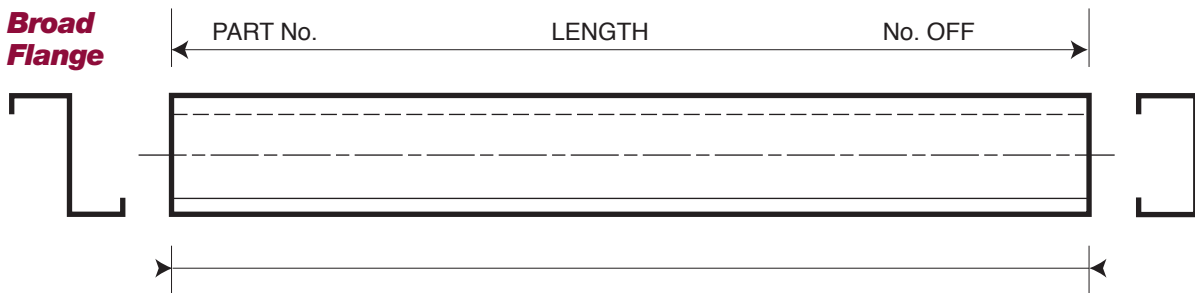

Broad Flange

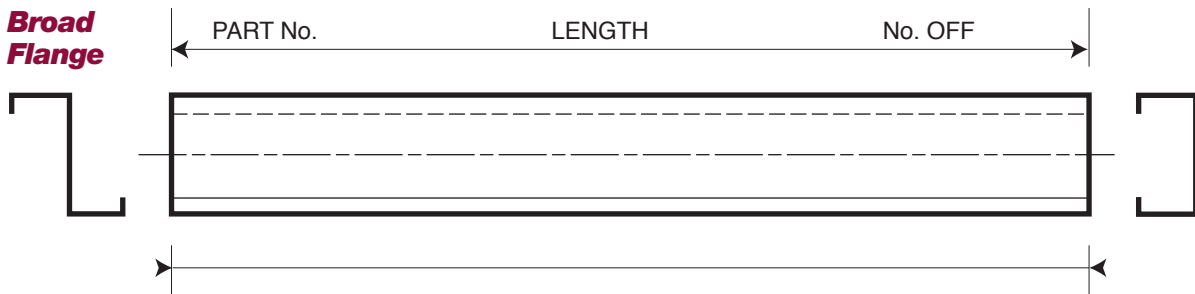



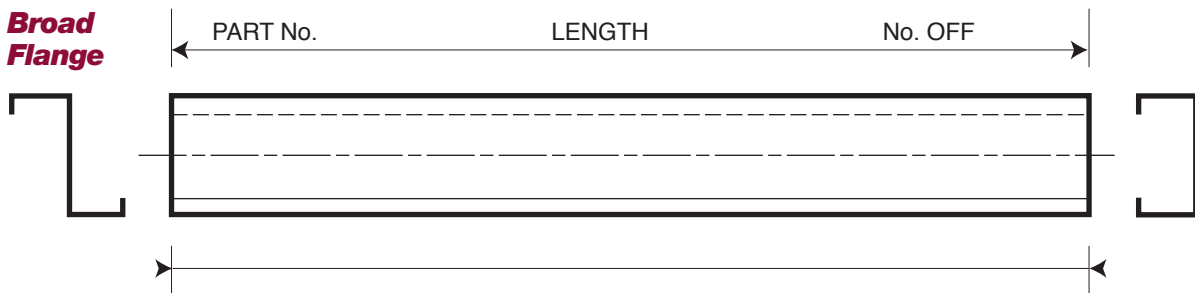



Broad Flange



Roof And Wall Sheet Selection Tables









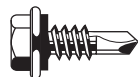

Max Spans

PROFILE	B.M.T. mm	Mass Kg/M ²	Profile Cover	Rib Depth	Min Pitch	Roof Internal	Roof End	Wall Internal
CORRUGATED HI-TEN 	.42	4.3	.762	16	5° (1 in 12)	1200 1600	900 1200	1800 2400
	.48	4.9						
CORRUGATED CURVING 	.60	6.1	.762	17	5° (1 in 12)	1200	900	1800
MULTICLAD HI-TEN 	.42	4.3	.762	29	2° (1 in 30)	1500 2000	1000 1500	2200 2800
	.48	4.9						
MULTISPAN HI-TEN 	.42	4.7	.700	24	3° (1 in 20)	2100 2800	1500 1800	2900 3000
	.48	5.3						
LOKDEK 680 	.42	4.79	.680	41	2° 1° (1 in 50)	1800 2400 3000	1500 1800 2400
	.48	5.45						
	.60	6.75						
GP PANEL 	.35	3.4	.825	12	1000
	.42	4.0						1200
MINI CORRUGATED 	.42	3.9	.825	6	900
	.48	4.42						1000

Fixing Screws

Steel Fix

Timber Fix

No. 10 x 16 mm HEX HD TEKS		No. 12 x 25 mm HEX HD TYPE 17	
No. 12 x 35 mm HEX HD TEKS		No. 12 x 40 mm HEX HD TYPE 17	
No. 12 x 45 mm HEX HD TEKS		No. 12 x 50 mm HEX HD TYPE 17	
No. 10 x 16 mm WAF HD TEKS		No. 12 x 65 mm HEX HD TYPE 17	
M6 11 x 50 mm ROOF ZIP		10 x 30 mm RIPPLE TEKS	

Whilst every care is taken in the preparation of these specifications, Steeline JH Stephenson Pty Ltd accept no responsibility for the accuracy of the information supplied.

Steeline
JH STEPHENSON

JH STEPHENSON & SON PTY LTD
ABN 52 004 570 370

GEE LONG
75 Heales Road Corio 3214
Telephone 03 5274 6222

LAVERTON
11 Westside Drive Laverton North 3026
Telephone 03 9314 1044

www.steeline.com.au

