

*Converted to Water Inspection Well*

FILE NOTATIONS

Entered in N I D File   
Entered On S R Sheet   
Location Map Pinned   
Card Indexed   
I W R for State or Fee Land

Checked by Chief *R.D.*  
Copy N I D to Field Office   
Approval Letter *In Unit*  
Disapproval Letter

COMPLETION DATA:

Date Well Completed *4-22-61* Location Inspected *Water Inspection Well*  
OW  VA  *Converted to* TA  Bond   
GW  OS  PA  State of Fee Land

LOGS FILED

Diller's Log *5-15-61*  
Electric Logs (No. ) *4*  
E  I  E-I  GR  GR-N  Micro   
Lat  Mi-L  Sonic  Others *Cement Bond Log*

\* This well was converted to a water inspection well as of January, 1963

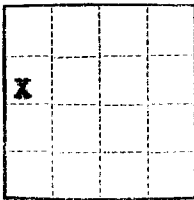

(SUBMIT IN TRIPLICATE)

UNITED STATES  
DEPARTMENT OF THE INTERIOR  
GEOLOGICAL SURVEY

Land Office Salt Lake City  
Lease No. U-0559  
Unit Red Wash

SUNDRY NOTICES AND REPORTS ON WELLS

NOTICE OF INTENTION TO DRILL.....	<input checked="" type="checkbox"/>	SUBSEQUENT REPORT OF WATER SHUT-OFF.....	
NOTICE OF INTENTION TO CHANGE PLANS.....		SUBSEQUENT REPORT OF SHOOTING OR ACIDIZING.....	
NOTICE OF INTENTION TO TEST WATER SHUT-OFF.....		SUBSEQUENT REPORT OF ALTERING CASING.....	
NOTICE OF INTENTION TO RE-DRILL OR REPAIR WELL.....		SUBSEQUENT REPORT OF RE-DRILLING OR REPAIR.....	
NOTICE OF INTENTION TO SHOOT OR ACIDIZE.....		SUBSEQUENT REPORT OF ABANDONMENT.....	
NOTICE OF INTENTION TO PULL OR ALTER CASING.....		SUPPLEMENTARY WELL HISTORY.....	
NOTICE OF INTENTION TO ABANDON WELL.....			

(INDICATE ABOVE BY CHECK MARK NATURE OF REPORT, NOTICE, OR OTHER DATA)

February 8, 1961

Well No. 12-21A (146) is located 1980 ft. from N line and 660 ft. from W line of sec. 21  
SW 1/4 NW 1/4 21 T7S R22E SLBM  
(1/4 Sec. and Sec. No.) (Twp.) (Range) (Meridian)  
Red Wash Uintah Utah  
(Field) (County or Subdivision) (State or Territory)

The elevation of the Kelly Bushing ~~check face~~ above sea level is 5000 ft. (estimated)

DETAILS OF WORK

(State names of and expected depths to objective sands; show sizes, weights, and lengths of proposed casings; indicate mudding jobs, cementing points, and all other important proposed work)

It is proposed to drill a well at the above location to produce oil from the lower Green River formation.  
 Cement 10-3/4" casing at 215'  
 Cement 7" casing below lowermost productive interval with sufficient cement to fill to 4000'.  
 Top Green River 2800'  
 "H" Point 4910'  
 "K" Point 5495'

I understand that this plan of work must receive approval in writing by the Geological Survey before operations may be commenced.

Company California Oil Company, Western Division

Address P. O. Box 455

Vernal

Utah

By C. V. Clifton

Title District Superintendent

USGS-3, O&GCC-1, Gulf-1, Cantkins-1,  
LCS III-1, File-1

(SUBMIT IN TRIPLICATE)

Land Office Salt Lake City  
Lease No. U-0559  
Unit Red Wash

X			

UNITED STATES  
DEPARTMENT OF THE INTERIOR  
GEOLOGICAL SURVEY

SUNDRY NOTICES AND REPORTS ON WELLS

NOTICE OF INTENTION TO DRILL.....	X	SUBSEQUENT REPORT OF WATER SHUT-OFF.....	
NOTICE OF INTENTION TO CHANGE PLANS.....		SUBSEQUENT REPORT OF SHOOTING OR ACIDIZING.....	
NOTICE OF INTENTION TO TEST WATER SHUT-OFF.....		SUBSEQUENT REPORT OF ALTERING CASING.....	
NOTICE OF INTENTION TO RE-DRILL OR REPAIR WELL.....		SUBSEQUENT REPORT OF RE-DRILLING OR REPAIR.....	
NOTICE OF INTENTION TO SHOOT OR ACIDIZE.....		SUBSEQUENT REPORT OF ABANDONMENT.....	
NOTICE OF INTENTION TO PULL OR ALTER CASING.....		SUPPLEMENTARY WELL HISTORY.....	
NOTICE OF INTENTION TO ABANDON WELL.....			

(INDICATE ABOVE BY CHECK MARK NATURE OF REPORT, NOTICE, OR OTHER DATA)

February 8, 1961

Well No. 12-21A <sup>(146)</sup> is located 1980 ft. from [N] line and 660 ft. from [W] line of sec. 21  
SW 1/4 NW 1/4 21 T7S R22E SLBM  
(1/4 Sec. and Sec. No.) (Twp.) (Range) (Meridian)  
Red Wash Uintah Utah  
(Field) (County or Subdivision) (State or Territory)

The elevation of the ~~drill floor~~ <sup>Kelly Bushing</sup> above sea level is 5000 ft. (estimated)

DETAILS OF WORK

(State names of and expected depths to objective sands; show sizes, weights, and lengths of proposed casings; indicate mudding jobs, cementing points, and all other important proposed work)

It is proposed to drill a well at the above location to produce oil from the lower Green River formation.

Cement 10-3/4" casing at 215'

Cement 7" casing below lowermost productive interval with sufficient cement to fill to 4000'.

Top Green River 2800'

"H" Point 4910'

"K" Point 5495'

I understand that this plan of work must receive approval in writing by the Geological Survey before operations may be commenced.

Company California Oil Company, Western Division

Address P. O. Box 455

Vernal

Utah

By C. V. Chatterton *2/8/61*  
Title District Superintendent

USGS-3, O&GCC-1, Gulf-1, Carikins-1, LCS III-1, File-1

047 CC-5LC 12  
5

U. S. LAND OFFICE Salt Lake City  
SERIAL NUMBER U-0559  
LEASE OR PERMIT TO PROSPECT \_\_\_\_\_

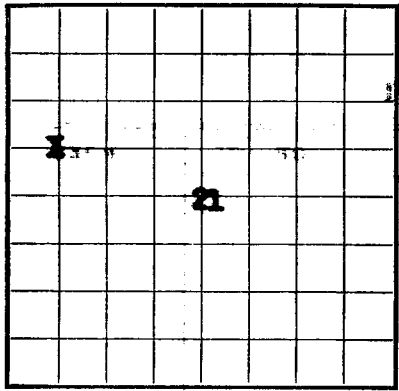

LOCATE WELL CORRECTLY

UNITED STATES  
DEPARTMENT OF THE INTERIOR  
GEOLOGICAL SURVEY

**LOG OF OIL OR GAS WELL**

Company California Oil Co., Western Div. Address Box 455, Vernal, Utah  
Lessor or Tract U-0559 Field Red Wash State Utah  
Well No. 12-21 Sec. 21 T. 7S R. 22E Meridian Salt Lake County Uintah  
Location 1980 ft. S. of N. Line and 660 ft. E. of W. Line of Section 21 Elevation 5029' KB  
(Perkirk floor relative to sea level)

The information given herewith is a complete and correct record of the well and all work done thereon so far as can be determined from all available records.

Signed R. L. GREEN  
Title Division Superintendent

Date May 9, 1961

The summary on this page is for the condition of the well at above date.

Commenced drilling February 28, 1961 Finished drilling April 9, 1961

**OIL OR GAS SANDS OR ZONES**  
(Denote gas by G)

No. 1, from 5192 to 5200  
No. 2, from 5526 to 5534  
No. 3, from 5534 to 5546  
No. 4, from 5546 to 5554  
No. 5, from \_\_\_\_\_ to \_\_\_\_\_  
No. 6, from \_\_\_\_\_ to \_\_\_\_\_

**IMPORTANT WATER SANDS**

No. 1, from \_\_\_\_\_ to \_\_\_\_\_ No. 3, from \_\_\_\_\_ to \_\_\_\_\_  
No. 2, from \_\_\_\_\_ to \_\_\_\_\_ No. 4, from \_\_\_\_\_ to \_\_\_\_\_

**CASING RECORD**

Circular notches cut at

Size casing	Weight per foot	Threads per inch	Make	Amount	Kind of shoe	Cut and pulled from	EXAMINER		EXAMINER
							DATE	TIME	
10-3/4"	40.54			190.25' Baker Casing			5192		
7"	28.4			5705.00'			5546		

**MUDDING AND CEMENTING RECORD**

Size casing	Where set	Number sacks of cement	Method used	Mud gravity	Amount of mud used
10-3/4"	205'	170 sack common			
7"	570'	400 sack API Class A			

**PLUGS AND ADAPTERS**

Heaving plug—Material \_\_\_\_\_ Length \_\_\_\_\_ Depth set \_\_\_\_\_

OLD MARK

Adapters—Material \_\_\_\_\_ Size \_\_\_\_\_

**SHOOTING RECORD**

Size	Shell used	Explosive used	Quantity	Date	Depth shot	Depth cleaned out

**TOOLS USED**

Rotary tools were used from surface feet to 570<sup>4</sup> feet, and from \_\_\_\_\_ feet to \_\_\_\_\_ feet

Cable tools were used from \_\_\_\_\_ feet to \_\_\_\_\_ feet, and from \_\_\_\_\_ feet to \_\_\_\_\_ feet

**DATES**

Put to producing April 22, 1961

The production for the first 24 hours was 305 barrels of fluid of which 12.86% was oil; \_\_\_\_\_% emulsion; 96% water; and \_\_\_\_\_% sediment. Gravity, °Bé. 25.5

If gas well, cu. ft. per 24 hours \_\_\_\_\_ Gallons gasoline per 1,000 cu. ft. of gas \_\_\_\_\_

Rock pressure, lbs. per sq. in. \_\_\_\_\_

**EMPLOYEES**

\_\_\_\_\_, Driller \_\_\_\_\_, Driller  
 \_\_\_\_\_, Driller \_\_\_\_\_, Driller

**FORMATION RECORD**

FROM—	TO—	TOTAL FEET	FORMATION
0	2800	2800	Shale and sand
2800	570 <sup>4</sup>	290 <sup>4</sup>	Sand and shale

*Copy H.L.C.*  
(SUBMIT IN TRIPLICATE)

Land Office **Salt Lake City**  
Lease No. **U-0999**  
Unit **Red Wash**

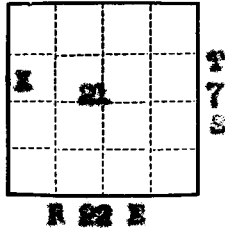

UNITED STATES  
DEPARTMENT OF THE INTERIOR  
GEOLOGICAL SURVEY

**SUNDRY NOTICES AND REPORTS ON WELLS**

NOTICE OF INTENTION TO DRILL.....		SUBSEQUENT REPORT OF WATER SHUT-OFF.....
NOTICE OF INTENTION TO CHANGE PLANS.....		SUBSEQUENT REPORT OF SHOOTING OR ACIDIZING.....
NOTICE OF INTENTION TO TEST WATER SHUT-OFF.....		SUBSEQUENT REPORT OF ALTERING CASING.....
NOTICE OF INTENTION TO RE-DRILL OR REPAIR WELL.....		SUBSEQUENT REPORT OF RE-DRILLING OR REPAIR.....
NOTICE OF INTENTION TO SHOOT OR ACIDIZE.....		SUBSEQUENT REPORT OF ABANDONMENT.....
NOTICE OF INTENTION TO PULL OR ALTER CASING.....	<input checked="" type="checkbox"/>	SUPPLEMENTARY WELL HISTORY.....
NOTICE OF INTENTION TO ABANDON WELL.....		

(INDICATE ABOVE BY CHECK MARK NATURE OF REPORT, NOTICE, OR OTHER DATA)

Vernal, Utah                      August 16                      19 **62**

Well No. **(12-21A) 146** is located **1900** ft. from **[N]** line and **660** ft. from **[W]** line of sec. **21**  
**SW 1/4** **SE 1/4** **21**                      **7E**                      **22E**                      **RLM**  
(1/4 Sec. and Sec. No.)                      (Twp.)                      (Range)                      (Meridian)  
**Red Wash**                      **Uintah**                      **Utah**  
(Field)                      (County or Subdivision)                      (State or Territory)

The elevation of the ~~corridor floor~~ above sea level is **5029** ft.

**DETAILS OF WORK**

(State names of and expected depths to objective sands; show sizes, weights, and lengths of proposed casings; indicate mudding jobs, cementing points, and all other important proposed work)

**It is proposed to convert subject well to water injection as follows:**

- 1. Run radioactive tracer interface survey.**
- 2. Block squeeze as warranted with inco cement.**
- 3. Perforate intervals 5968-5966, 5946-5949, 5932-5936, 5922-5927 and 5490-5494' with 2 jets per foot.**
- 4. Acidize above perforations.**
- 5. Run injection string.**

I understand that this plan of work must receive approval in writing by the Geological Survey before operations may be commenced.

Company **California Oil Company, Western Division**                      Original Signed by  
 Address **P. O. Box 455**                      **R. W. PATTERSON**  
 \_\_\_\_\_ **Vernal, Utah**                      By \_\_\_\_\_ **R. W. PATTERSON**  
 \_\_\_\_\_ Title **Field Superintendent**

**UNCL, 11-3; OCM, 11-1; Gulf, Denver-1, Coulkins-1; RL-1; File-1**

6-16  
NFC  
to  
OP

Copy H-L

Budget Bureau No. 42-R358.4.  
Form Approved.

Form 9-381a  
(Feb. 1951)

(SUBMIT IN TRIPLICATE)

Land Office Salt Lake City

Lease No. U-0559

Unit Red Wash

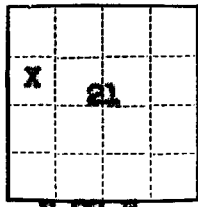

UNITED STATES  
DEPARTMENT OF THE INTERIOR  
GEOLOGICAL SURVEY

SUNDRY NOTICES AND REPORTS ON WELLS

NOTICE OF INTENTION TO DRILL.....	SUBSEQUENT REPORT OF WATER SHUT-OFF.....	
NOTICE OF INTENTION TO CHANGE PLANS.....	SUBSEQUENT REPORT OF SHOOTING OR ACIDIZING.....	
NOTICE OF INTENTION TO TEST WATER SHUT-OFF.....	SUBSEQUENT REPORT OF ALTERING CASING.....	
NOTICE OF INTENTION TO RE-DRILL OR REPAIR WELL.....	SUBSEQUENT REPORT OF RE-DRILLING OR REPAIR.....	
NOTICE OF INTENTION TO SHOOT OR ACIDIZE.....	SUBSEQUENT REPORT OF ABANDONMENT.....	
NOTICE OF INTENTION TO PULL OR ALTER CASING.....	SUPPLEMENTARY WELL HISTORY.....	
NOTICE OF INTENTION TO ABANDON WELL.....	<u>Subsequent Report of Conversion to Water Injection</u>	<u>X</u>

(INDICATE ABOVE BY CHECK MARK NATURE OF REPORT, NOTICE, OR OTHER DATA)

Vernal, Utah November 20, 1963

Well No. (12-21A) 146 is located 1980 ft. from [N] line and 660 ft. from [E] line of sec. 21  
SW 1/4 NW 1/4 21 7S 22E S12M  
(1/4 Sec. and Sec. No.) (Twp.) (Range) (Meridian)  
Red Wash Utah Utah  
(Field) (County or Subdivision) (State or Territory)

The elevation of the ~~land surface~~ Kelly Bushing above sea level is 5029 ft.

DETAILS OF WORK

(State names of and expected depths to objective sands; show sizes, weights, and lengths of proposed casings; indicate mudding jobs, cementing points, and all other important proposed work)

- Subject well was converted to West End water injection service as follows:
1. Ran Radioactive Channel Determination Survey.
  2. Cement squeezed well to seal blanks between  $K_A$  - K interval and K -  $J_2$  intervals.
  3. Abrasijetted 3 - 60° slots at 5565' ( $K_A$ ), 5548, 5534, 5525' (K), and 5492 ( $J_2$ ).
  4. Set Baker Model "F" packers at 5556, 5510, 5480'.
  5. Ran injection tubing and started injecting water at 2400 BPD and 1550 tbg. psi.

Production Before: 30 BOPD, 10 BHPD, 20 MCF/D.

I understand that this plan of work must receive approval in writing by the Geological Survey before operations may be commenced.

Company California Oil Company, Western Division

Address P. O. Box 455

Original Signed by  
R. W. PATTERSON

Vernal, Utah

By R. W. PATTERSON

Title Unit Superintendent

UEGS, SLC-3; OMOCC, SLC-1; Gulf, Okla. City-1; Gulf, Casper-1; Oulkins-1; Hubble-1; File-1

WELL NO: 12-21A (146)

PROPERTY: Section 21A

RED WASH FIELD

HISTORY OF OIL OR GAS WELL

Kerr-McGee Oil Industries, Inc. moved in and rigged up.  
Spudded at 6:00 P.M., February 28, 1961.  
Drilled 15" hole surface to 210'.

March 1, 1961

Cemented 10-3/4" casing at 205' with 170 sack common cement.  
Drilled 9" hole 210' to 980'.

March 2, 1961 to March 16, 1961

Drilled 9" hole 980' to 5639'.

March 17, 1961

Drilled 9" hole 5639' to 5704'.

Ran Schlumberger Induction ES and recorded from 5701' to 205'. Microcaliper and recorded from 5706' to 2000'. TGR 2800', H 4930', I 5103', J 5378', J<sub>E</sub> 5483', K 5519' (-490'), K<sub>A</sub> 5556', K<sub>B</sub> 5616', K<sub>D</sub> 5698'.  
Made two runs with sidewall sample gun.

Depth	Rec.	Description
5705'	1/2"	Ss, lt gry, al s & p, v fn-fn gr, rnded, fri, good por & perm, NSOFC.
5701'	3/4"	SAA, w/some wh clay, cem, fri, poor por & perm, NSOFC.
5678'	3/4"	Ss, lt gry, v fn gr, silty, much wh clay, cem, tight, NSOFC.
5673'	1-1/2"	Ss, lt gry, fn gr, subrnded, mod fri, mottled w/wh clay cem, mod tight, mottled dull brn fluor & dk brn dead oil stn, slow lt blue streaming cut.
5663'	None	
5665'	3/4"	Ss, wh, lt gry, v fn gr, subrnded, much wh clay cem, tight, NSOFC.
5548'	1/2"	Ss, clr qtz, fn gr, ang, mod hard, much blk hydrocarbon (?) residue, dull brn fluor, stream lt blue-yell cut, slow to fast cut.
5546'	1"	Ss, dk gry, v fn gr, silty, subrnded, mod hard, well cem, mod tight, dk brn oil stn, dull brn fluor, stream lt blue-yell cut.
5535'	1"	Ss, lt gry, v fn gr, subrnded, mod fri, fair por & perm, even dk brn oil stn, even golden fluor, stream lt blue-wh cut.
5532'	1/2"	SAA.
5525'	None	
5523'	1-1/2"	Ss, lt gry, v fn gr, subrnded, mod fri, much wh clay cem, mottled w/wh clayey shale, even dk brn oil stn & gold fluor on Ss, stream lt blue-yell cut.
5521'	3/4"	SAA, mostly sh as above.
5506'	3/4"	Ss, lt gry, v fn gr, subrnded, mod fri, much wh clay cem, mod tight, highly mottled w/wh clayey shale, even lt brn oil stn & even gold fluor on Ss, stream lt blue-wh cut.



WELL NO: 12-21A (146)

PROPERTY: Section 21A

RED WASH FIELD

Depth	Rec.	Description
5493'	None	
5490'	1/2"	Ss as above, few thin lam sh as above, even gold fluor, even lt brn oil stn, stream lt blue-wh cut.
5385'	1/4"	Ss, lt gry, fn gr, ang, mod hard, fair por & perm, some weak (flushed?) lt brn oil stn & lt orange-gold fluor, wk slow lt yell stream cut.
5307'	3/4"	Ss, lt gry, fn gr, subrnded, ostracodal, hard, tight, much wh clay cem, NSOFC.
5273'	None	

March 18, 1961

DST #1 interval 5522-5549'. Set packers at 5517, 5522 and 5549'. Opened tool at 2:05 A.M. for 2 min initial flow, 45 min ICIP, 1 hr flow test and 1 hr FCIP. No gas to surface. Had a light, slightly heading blow of air at an est rate of 1 to 2 M/D. Recovered 152'. Top 50' oil, bottom 102' gassy, slightly oily (5-10%) thin mud.

Pressures	IH	ICIP	IF	FF	FCIP	FH
Top	2846	1428	30	76	1087	2846

DST #2 interval 5659-5667'. Set packers at 5654, 5659 and 5667'. Opened tool at 7:13 P.M. for 2 min initial flow test, 45 min ICIP, 1 hr flow test and 45 min FCIP. No gas to surface. Had a light blow of air est 2-3 M/D, steadily declining to est less than 1/2 M/D rate at end of 1 hr test. Rec 110', top 20' gassy mud with a scum of oil, bottom 90' thin mud grading to muddy water with flecks oil.

Pressures	IH	ICIP	IF	FF	FCIP	FH
Bottom	2913	2338	30	70	2236	2913

March 19, 1961

DST #3 interval 5486-5510'. Set packers at 5481', 5486' and 5510'. Opened tool at 2:30 A.M. for 2 min initial flow, 45 min ICIP, 1 hr flow test and 45 min FCIP. No gas to surface. Had a light blow est 3-4 M/D rate, declining to almost dead in 1 hr. Rec 60' slightly gassy mud.

Pressures	IH	ICIP	IF	FF	FCIP	FH
Top	2720	630	15	20	521	2720

DST #4A interval 5262-5704'. Set packers at 5257, 5262 and 5286'. Opened tool at 9:20 A.M. for 2 min initial flow, 45 min ICIP, 2 hr flow test and 45 min FCIP. No gas to surface. Had a steadily increasing blow of air to a max rate of 1.8 M/D in 35 min. Next 35 min had a steadily decreasing, slightly heading blow of air to a rate too small to measure. Last 50 min of test had a barely perceptible heading blow of air. Rec 4590' rise. Top 1500' slightly gassy mud, bottom 3090' gassy thin salt water contaminated mud grading to gassy, fluffy, muddy water.

Pressures	IH	ICIP	IF	FF	FCIP	FH
Top	2609	2238	275	2000	2203	2609

DST #4 interval 5262-5301'. 2 hrs NGTS. Rec 640', top 455' gassy mud, bottom 185' gassy muddy water testing 0.3 ohmmeters at 85° F.

WELL NO: 12-21A (146)

PROPERTY: Section 21A

RED WASH FIELD

March 20, 1961

DST #5 interval 5262-5301'. Set packers at 5257, 5262 and 5301'. Opened tool at 11:37 P.M. (3-19-61) for 3 min initial flow, 45 min ICIP, 2 hr flow test, 45 min FCIP. No gas to surface. Had a weak steady blow of air for 2 hr test. Rec 640'. Top 455' fluffy gas cut mud w/occasional fleck of oil, bottom 185' gassy salt water.

Pressures	IH	ICIP	IF	FF	FCIP	FH
Top	2720	2210	39	73	2004	2720

Cemented 7", 23#, J-55 casing at 5704' with 400 sacks API Class A cement.

March 21, 1961

Ran Schlumberger gamma collar log from 5658-4000'. Schlumberger pick-up 5661'. Ran Schl cement bond log 5658-3000'. Good to excellent bond, top cement 4000'.

Hung 2-1/2" tubing in annulus frac spool above BOPE, tbg collar on bottom. 178 jts 2-1/2" UE 6.5# tubing landed at 5632.49'. Rig released 11:00 P.M., March 21, 1961.

April 6, 1961

R&R Well Service moved on location and rigged up.

April 7, 1961

Spotted 400 gallons inhibited Hcl and Hf acid at 5507'. McCullough shot triple frac notch cutter at 5546, 5534, 5526'. Attempted to break down notches with up to 3500 psi, no success. Shot triple frac notch cutter at 5492'.

April 8, 1961

Ran Baker retrievable bridge plug and Retrieve-A-Matic full bore packer on 2-1/2" tubing. Set BP at 5570', FB packer at 5540'. Spotted 200 gals acid at tool, attempted to break down notch 5546' with up to 6000 psi, no success. Pulled FB packer to 5510', attempted to break down notches 5546, 5534, 5526' with no success to 5500 psi. Spotted 400 gallons acid. Broke down notches above at 5000 psi to 600 psi. Pumped in at 2200 psi and 5 BPM. Inst. shut in 600 psi.

Set full bore at 5400', bridge plug at 5510'. Spotted 200 gals acid. Pressure tested BP to 3500 psi, held OK. Broke down notch at 5492' w/5000 psi to 3500 psi at 6.5 BPM. Inst. shut in 1100 psi.

Pulled B.P. and full bore out of hole.

Sand-oil frac'd perf'd intervals 5492-5546' with 24,000 gallons BF #5, 24,000# 20-40 sand, 1200# 12-16 aluminum pellets and 1200# Adomite. Pumped in 4000 gals BF and Adomite pad, 8000 gallons BF with 2#/gal sand, 4000 gallons with 0.3#/gal aluminum. Max pressure 3200 psi at 23 BPM start, declining to 2300 psi at 36 BPM end of flush. Flushed with 216 bbls lease waste water. Inst. shut in 1000 psi, average rate 30-1/2 BPM. Used two HT 400's (2000 hyd HF) and one 85 BPM blender. Total pumping time 26 mins.

WELL NO: 12-21A (146)

PROPERTY: Section 21A

RED WASH FIELD

April 9, 1961

Ran tubing.

Tubing detail:

1 - 2-1/2" perf. G. A.	31.35'
1 - 2-1/2" sub J-55	8.06'
1 PSN	0.95'
174 jts 2-1/2" J-55	5506.42'
K.B.D.	12.50'
	<u>5559.28'</u>

Ran rods and pump.

Rod detail:

1 pump top-3-cup No. 134  
 64 x 3/4" x 25' Plain  
 69 x 3/4" x 25' W.H.  
 86 x 7/8" x 25' W.H.  
 1 - 2' x 7/8" sub. Plain  
 1 - 22' P.R. - 1-1/2"

**UNITED STATES  
DEPARTMENT OF THE INTERIOR  
GEOLOGICAL SURVEY**

SUBMIT IN TRIPPLICATE\*  
(Other instructions on reverse side)

Form approved.  
Budget Bureau No. 42-R-33

**SUNDRY NOTICES AND REPORTS ON WELLS**

(Do not use this form for proposals to drill or to deepen or plug back to a different reservoir.  
Use "APPLICATION FOR PERMIT—" for such proposals.)

<p>1. OIL WELL <input type="checkbox"/> GAS WELL <input type="checkbox"/> OTHER <input checked="" type="checkbox"/> <b>Water Injection</b></p> <p>2. NAME OF OPERATOR <b>Chevron Oil Company - Western Division</b></p> <p>3. ADDRESS OF OPERATOR <b>P. O. Box 599 Denver, Colorado 80201</b></p> <p>4. LOCATION OF WELL (Report location clearly and in accordance with any State requirements.* See also space 17 below.) <b>At surface</b></p> <p><b>1980' FNL &amp; 660' FWL</b></p>		<p>5. LEASE DESIGNATION AND SERIAL NO. <b>U-0559</b></p> <p>6. IF INDIAN, ALLOTTEE OR TRIBE NAME</p> <p>7. UNIT AGREEMENT NAME <b>Red Wash</b></p> <p>8. FARM OR LEASE NAME <b>Unit</b></p> <p>9. WELL NO. <b>146 (12-21A)</b></p> <p>10. FIELD AND POOL, OR WILDCAT <b>Red Wash</b></p> <p>11. SEC., T., R., M., OR BLE. AND SURVEY OR AREA <b>S 21, T7S, R22E, SLBM</b></p> <p>12. COUNTY OR PARISH <b>Uintah</b></p> <p>13. STATE <b>Utah</b></p>
14. PERMIT NO.	15. ELEVATIONS (Show whether DF, RT, GR, etc.) <b>KB 5029'</b>	

16. Check Appropriate Box To Indicate Nature of Notice, Report, or Other Data

NOTICE OF INTENTION TO:		SUBSEQUENT REPORT OF:	
TEST WATER SHUT-OFF <input type="checkbox"/>	PULL OR ALTER CASING <input type="checkbox"/>	WATER SHUT-OFF <input type="checkbox"/>	REPAIRING WELL <input type="checkbox"/>
FRACTURE TREAT <input type="checkbox"/>	MULTIPLE COMPLETE <input type="checkbox"/>	FRACTURE TREATMENT <input type="checkbox"/>	ALTERING CASING <input type="checkbox"/>
SHOOT OR ACIDIZE <input type="checkbox"/>	ABANDON* <input type="checkbox"/>	SHOOTING OR ACIDIZING <input type="checkbox"/>	ABANDONMENT* <input type="checkbox"/>
REPAIR WELL <input type="checkbox"/>	CHANGE PLANS <input type="checkbox"/>	(Other) <b>Altered Injection Profile</b>	<input checked="" type="checkbox"/>

\*NOTE: Report results of multiple completion on Well Completion or Recompletion Report and Log form.

17. DESCRIBE PROPOSED OR COMPLETED OPERATIONS (Clearly state all pertinent details, and give pertinent dates, including estimated date of starting any proposed work. If well is directionally drilled, give subsurface locations and measured and true vertical depths for all markers and zones pertinent to this work.)\*

The following work has been completed.

1. Milled Model F pkr @ 5480' & 5510' & 5556'.
2. Cleaned out to PBTD @ 5572'.
3. Set Baker CIBP @ 5560'.
4. Perforated the following intervals w/2 jets/ft: 5537-31', 5526-18'; 5495-86'; and 5397-80'.
5. Broke down the following intervals:

Interval	Rate	Press	ISIP
5518-37	5 BPM	2500	1200
5486-95	5 BPM	2700	2000
5380-97	6 BPM	2200	1000

6. Pressure tested CIBP @ 5560' to 3000#. Held OK.
7. Land tbg @ 5433' w/Lokset pkr @ 5431'.

Injection Prior to Workover: 865 BPD @ 2180 psi  
 Injection After Workover: 720 BWPD @ 1150 (tbg)  
 576 BWPD @ 1100 (csg)

Work Started 8-25-73  
 Work Completed 9-15-73

18. I hereby certify that the foregoing is true and correct

SIGNED Original Signed by **J. W. GREER** TITLE Division Dirg. Supt. DATE 10-16-73

(This space for Federal or State office use)

ACCEPTED [Signature] TITLE DISTRICT ENGINEER  
 APPROVED BY [Signature] DATE OCT 19 1973  
 CONDITIONS OF APPROVAL, IF ANY:

UNITED STATES  
DEPARTMENT OF THE INTERIOR  
GEOLOGICAL SURVEY

SUBMIT IN TRIPLICATE  
(Other instructions on re-  
verse side)

Form approved.  
Budget Bureau No. 42-R1424.

SUNDRY NOTICES AND REPORTS ON WELLS

(Do not use this form for proposals to drill or to deepen or plug back to a different reservoir.  
Use "APPLICATION FOR PERMIT—" for such proposals.)

1. OIL WELL <input type="checkbox"/> GAS WELL <input type="checkbox"/> OTHER <input checked="" type="checkbox"/> Water Injection		5. LEASE DESIGNATION AND SERIAL NO. 4-0559
2. NAME OF OPERATOR Chevron U.S.A. Inc.		6. IF INDIAN, ALLOTTEE OR TRIBE NAME
3. ADDRESS OF OPERATOR P. O. Box 599, Denver, Colorado 80201		7. UNIT AGREEMENT NAME Red Wash
4. LOCATION OF WELL (Report location clearly and in accordance with any State requirements.* See also space 17 below.) At surface 1980' FNL & 660' (SW/4 NW/4)		8. FARM OR LEASE NAME
14. PERMIT NO.	15. ELEVATIONS (Show whether DF, RT, GR, etc.) KB 5029	9. WELL NO. 146 (12-21 A)
		10. FIELD AND POOL, OR WILDCAT Red Wash
		11. SEC., T., R., M., OR BLK. AND SURVEY OR AREA S21, T7S, R22E SLBM
		12. COUNTY OR PARISH Uintah
		13. STATE UTAH

16. Check Appropriate Box To Indicate Nature of Notice, Report, or Other Data

NOTICE OF INTENTION TO:

TEST WATER SHUT-OFF

FRACTURE TREAT

SHOOT OR ACIDIZE

REPAIR WELL

(Other)

PULL OR ALTER CASING

MULTIPLE COMPLETE

ABANDON\*

CHANGE PLANS

SUBSEQUENT REPORT OF:

WATER SHUT-OFF

FRACTURE TREATMENT

SHOOTING OR ACIDIZING

(Other)

REPAIRING WELL

ALTERING CASING

ABANDONMENT\*

(NOTE: Report results of multiple completion on Well Completion or Recompletion Report and Log form.)

17. DESCRIBE PROPOSED OR COMPLETED OPERATIONS (Clearly state all pertinent details, and give pertinent dates, including estimated date of starting any proposed work. If well is directionally drilled, give subsurface locations and measured and true vertical depths for all markers and zones pertinent to this work.)\*

It is proposed to clean out well to 5,560', pressure test casing for leaks and cement squeeze if necessary, acidize well and replace tubing as follows:

- MIR & RU POOH with tubing string and packer.
- GIH with bit, casing scraper, work string and clean out to 5,560 POOH.
- GIH w/RBP and Packer. Set above top perforations. Pressure test casing and cement squeeze, if necessary.
- Move RBP and Packer to straddle intervals 5380 - 5548'.
- Acidize. See attached.
- POOH w/RBP and Packer
- RIH w/plastic lined tubing and packer. Set packer above 5,360'.
- Place

APPROVED BY THE DIVISION OF  
OIL, GAS, AND MINING

DATE: Nov. 16, 1977

BY: P. H. [Signature]

- 3 - USGS
- 2 - State
- 3 - Partners
- 1 - JCB
- 1 - DLD
- 1 - Sec.
- 1 - File

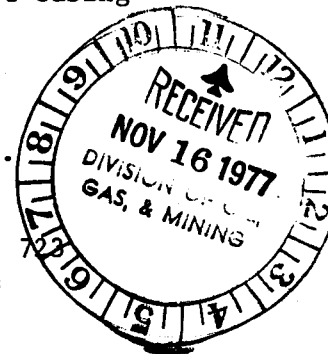

No additional surface disturbances required for this activity.

No additional surface disturbances required for this activity.

18. I hereby certify that the foregoing is true and correct

SIGNED [Signature]

TITLE Engineering Assistant

DATE Nov 14, 1977

(This space for Federal or State office use)

APPROVED BY \_\_\_\_\_  
CONDITIONS OF APPROVAL, IF ANY:

TITLE \_\_\_\_\_

DATE \_\_\_\_\_

WELL NAME: RWU #146 (12-21A)

FIELD: Red Wash

PROPOSED TREATMENT PROCEDURE

1. Objective: Increase injection rate.
2. Size and type of treatment: 2,200 gallons 15% HCL
3. Intervals to be treated: 5,547-48, 5531-37, 5518-26, 5486-95, 5380-97
4. Treatment down casing or tubing: work string
5. Method of localizing its effects: Straddle perfs. with retrievable Bridge Plug and Packer.
6. Disposal of treating fluid: Spent acid to be swabbed back.
7. Name of company to do work: Dowell, Halliburton or Western
8. Anticipated additional surface disturbances: None
9. Estimated work date: December 1, 1977
10. Present status, current production and producing interval: Injecting

<u>Date</u>	<u>BOPD</u>	<u>MCFD</u>	<u>BWPD</u>
10/77			204 Down Tubing 22 Down Casing - Tubing Annulus

**UNITED STATES  
DEPARTMENT OF THE INTERIOR  
GEOLOGICAL SURVEY**

SUBMIT IN TRIPLICATE\*  
(Other instructions on re-  
verse side)

Form approved.  
Budget Bureau No. 42-R1424.

5. LEASE DESIGNATION AND SERIAL NO.  
4-0559

6. IF INDIAN, ALLOTTEE OR TRIBE NAME

7. UNIT AGREEMENT NAME

Red Wash

8. FARM OR LEASE NAME

9. WELL NO.

146 (A-31A)

10. FIELD AND POOL, OR WILDCAT

Red Wash

11. SEC., T., R., M., OR BLK. AND SURVEY OR ABBA

Sec 21, T7S, R22E, SLBM

12. COUNTY OR PARISH

Uintah

13. STATE

UT

**SUNDRY NOTICES AND REPORTS ON WELLS**  
(Do not use this form for proposals to drill or to deepen or plug back to a different reservoir.  
Use "APPLICATION FOR PERMIT—" for such proposals.)

1. OIL WELL  GAS WELL  OTHER  Water Injection

2. NAME OF OPERATOR  
Chevron U.S.A. Inc.

3. ADDRESS OF OPERATOR  
P. O. Box 599, Denver, CO 80201

4. LOCATION OF WELL (Report location clearly and in accordance with any State requirements.  
See also space 17 below.)  
At surface

1980' FNL & 660' (SW $\frac{1}{4}$  NW $\frac{1}{4}$ )

14. PERMIT NO.

15. ELEVATIONS (Show whether DF, ST, OR, etc.)

KB 5029

16. Check Appropriate Box To Indicate Nature of Notice, Report, or Other Data

NOTICE OF INTENTION TO:

TEST WATER SHUT-OFF

FRACTURE TREAT

SHOOT OR ACIDISE

REPAIR WELL

(Other)

FULL OR ALTER CASING

MULTIPLE COMPLETION

ABANDON\*

CHANGE PLANS

SUBSEQUENT REPORT OF:

WATER SHUT-OFF

FRACTURE TREATMENT

SHOOTING OR ACIDISING

(Other)

REPAIRING WELL

ALTERING CASING

ABANDONMENT\*

(Note: Report results of multiple completion on Well Completion or Recompletion Report and Log form.)

17. DESCRIBE PROPOSED OR COMPLETED OPERATIONS (Clearly state all pertinent details, and give pertinent dates, including estimated date of starting any proposed work. If well is directionally drilled, give subsurface locations and measured and true vertical depths for all markers and zones pertinent to this work.)

Well was cleaned out and acidized as follows:

1. MIR & RU. POOH with tubing string and packer.
2. GIH with bit, casing scraper, work string and clean out to 5560'. POOH.
3. GIH w/RBP and packer. Set above top perforations. Pressure test casing. No need for cement squeeze.
4. Move RBP and packer to straddle intervals 5380-5548'.
5. Acidize. See attached.
6. POOH w/RBP and packer.
7. RIH w/plastic lined tubing and packer. Set packer above 5360'.
8. Place well on injection service.

No additional surface disturbances required for this activity.

- 3-USGS
- 2-State
- 3-Partners
- 1-JCB
- 1-DLD
- 1-Sec 723
- 1-File

I hereby certify that the foregoing is true and correct

SIGNED

*J. J. Johnson*

TITLE

J. J. Johnson

Engineering Assistant

DATE

June 21, 1978

(This space for Federal or State office use)

APPROVED BY

CONDITIONS OF APPROVAL, IF ANY:

TITLE

DATE

WELL NAME RWU #146 (12-21A)

FIELD NAME Red Wash

COMPLETED TREATMENT PROCEDURE

1. Size and type of treatment: 2350 gals 15% HCl.
2. Intervals treated: 5547-48, 5531-37, 5518-26, 5486-95, 5380-97
3. Treatment down casing or tubing. Work String
4. Methods used to localize effects: Straddle perms with retrievable bridge plug and packer.
5. Disposal of treating fluid: Spent acid swabbed back.
  
6. Depth to which well was cleaned out: 5550
7. Time spent bailing and cleaning out: 3 Days
8. Date of work: May 4, 1978
9. Company who performed work: Dowell
10. Production interval: 5380-5548
11. Status and production before treatment:

<u>Date</u>	<u>BOPD</u>	<u>MCFD</u>	<u>BWPD</u>
10/77			204 Down tubing 22 Down casing tubing annulus.
  
12. Status and production after treatment:

<u>Date</u>	<u>BOPD</u>	<u>MCFD</u>	<u>BWPD</u>
6/19/78			576 Injection 115#



STATE OF UTAH  
 DIVISION OF OIL, GAS, AND MINING  
 ROOM 4241 STATE OFFICE BUILDING  
 SALT LAKE CITY, UTAH 84114  
 (801) 533-5771  
 (RULE 1-5)

FORM NO. DOGM-UIC-1

IN THE MATTER OF THE APPLICATION OF  
Chevron U.S.A. Inc.  
 ADDRESS P. O. Box 599  
Denver, CO ZIP 80201  
 INDIVIDUAL  PARTNERSHIP  CORPORATION   
 FOR ADMINISTRATIVE APPROVAL TO DISPOSE OR  
 INJECT FLUID INTO THE ...RWU No. 146... WELL  
 SEC. 21 TWP. 7S RANGE 22E  
Uintah COUNTY, UTAH

CAUSE NO. \_\_\_\_\_

ENHANCED RECOVERY INJ. WELL	<input checked="" type="checkbox"/>
DISPOSAL WELL	<input type="checkbox"/>

APPLICATION

Comes now the applicant and shows the Division the following:

1. That Rule 1-5 (b) 6 authorizes administrative approval of enhanced recovery injections or disposal operations.
2. That the applicant submits the following information.

Lease Name <u>U-0559</u>	Well No. <u>146 (12-21A)</u>	Field <u>Red Wash</u>	County <u>Uintah</u>
Location of Enhanced Recovery Injection or Disposal Well <u>SW 1/4 NW 1/4</u> Sec. <u>21</u> Twp. <u>7S</u> Rge. <u>22E</u>			
New Well To Be Drilled Yes <input type="checkbox"/> No <input checked="" type="checkbox"/>	Old Well To Be Converted Yes <input type="checkbox"/> No <input checked="" type="checkbox"/>	Casing Test Yes <input checked="" type="checkbox"/> No <input type="checkbox"/> Date <u>3/1/61</u>	
Depth-Base Lowest Known Fresh Water Within 1/2 Mile <u>2700</u>	Does Injection Zone Contain Oil-Gas-Fresh Water Within 1/2 Mile YES <input checked="" type="checkbox"/> NO <input type="checkbox"/>		State What oil & gas
Location of Fresh Water from the Green River Injection Source(s) <u>River</u>		Geologic Name(s) and Depth of Source(s) <u>Not Applicable</u>	
Geologic Name of Injection Zone <u>Green River</u>		Depth of Injection Interval <u>5380</u> to <u>5548</u>	
a. Top of the Perforated Interval: <u>5380</u>	b. Base of Fresh Water: <u>2700</u>	c. Intervening Thickness (a minus b) <u>2680</u>	
Is the intervening thickness sufficient to show fresh water will be protected without additional data? <input checked="" type="checkbox"/> YES <input type="checkbox"/> NO			
Lithology of Intervening Zones <u>sand-shale</u>			
Injection Rates and Pressures Maximum = <u>2500 B/D</u> , Working = <u>800</u> B/D Maximum = <u>3000 psi</u> , Working = <u>2000</u> PSI			
The Names and Addresses of Those To Whom Copies of This Application and Attachments Have Been Sent			
<u>Bureau of Land Management, State of Utah</u>			
<u>1400 University Club Building</u>			
<u>136 East South Temple</u>			
<u>Salt Lake City, Utah 84111</u>			

**RECEIVED**  
JUL 20 1983

State of Colorado  
 County of Denver

R.H. Elliott  
 Applicant

Before me, the undersigned authority, on this day personally appeared R.H. ELLIOTT known to me to be the person whose name is subscribed to the above instrument, who being by me duly sworn on oath states, that he is duly authorized to make the above report and that he has knowledge of the facts stated therein, and that said report is true and correct.

Suscribed and sworn to before me this 19 day of July, 19 83

SEAL  
 My commission expires July 5, 1987  
 My address is:  
Colorado Divd.  
Denver, CO 80222

Luis J. Thompson  
 Notary Public in and for Colorado

1. Attach qualitative and quantitative analysis of fresh water from 2 or more producing wells within 1 mile of injection well showing location of wells and date samples were taken, or statement as to why samples were not submitted.
2. Attach qualitative and quantitative analysis of representative sample of water to be injected.
3. Attach plat showing subject well and all known oil and gas wells, abandoned, drilling and dry holes within 1/2 mile, together and with name of operator.
4. Attach Drillers Log (Form DOGM-UIC-2). (Appropriate Surety must be on file with Conservation Division.)
5. Attach Electric or Radioactivity Log of Subject well (if released).
6. Attach schematic drawing of subsurface facilities including; Size, setting depth, amount of cement used measured or calculated tops of cement surface, intermediate (if any) and production casings; size and setting depth of tubing; type and setting depth of packer; geologic name of injection zone showing top and bottom of injection interval.
7. The original and 6 copies of application, and one complete set of attachments shall be mailed to the Division.
8. Deliver 1 copy of application to landowner on whose land injection well is located and to each operator of a producing leasehold within 1/2 mile of injection well.
9. Affidavit of mailing or delivery shall be filed not later than five days after the application is filed.
10. Notice that an application has been filed shall be published by the Division in a newspaper of general circulation in the county in which the well is located. The Division shall file proof of publication before the application is approved. The notice shall include name and address of applicant, location of proposed injection or disposal well, injection zone, injection pressure and volume. If no written objection is received within 15 days from date of publication the application will be approved administratively.
11. A well shall not be used for injection or disposal unless completed machine accounting Form DOGM-UIC-3b is filed September 1st, each year.
12. Approval of this application, if granted, is valid only as long as there is no substantial change in the operations set forth in the application. A substantial operation change requires the approval of a new application.
13. If there is less intervening thickness required by Rule I-5 (b) 4 attach sworn evidence and data.

**CASING AND TUBING DATA**

NAME OF STRING	SIZE	SETTING DEPTH	SACKS CEMENT	TOP OF CEMENT	TOP DETERMINED BY
Surface	10-3/4"	205	170	surface	returns
Intermediate					
Production	7"	5704	400	± 4000	calculated
Tubing	2-7/8"	5360	Name - Type - Depth of Tubing Packer Baker FH Hydrostatic packer @ 5347'		
Total Depth 5704	Geologic Name - Inj. Zone Green River	Depth - Top of Inj. Interval 5380	Depth - Base of Inj. Interval 5548		

SKETCH - SUBSURFACE FACILITY

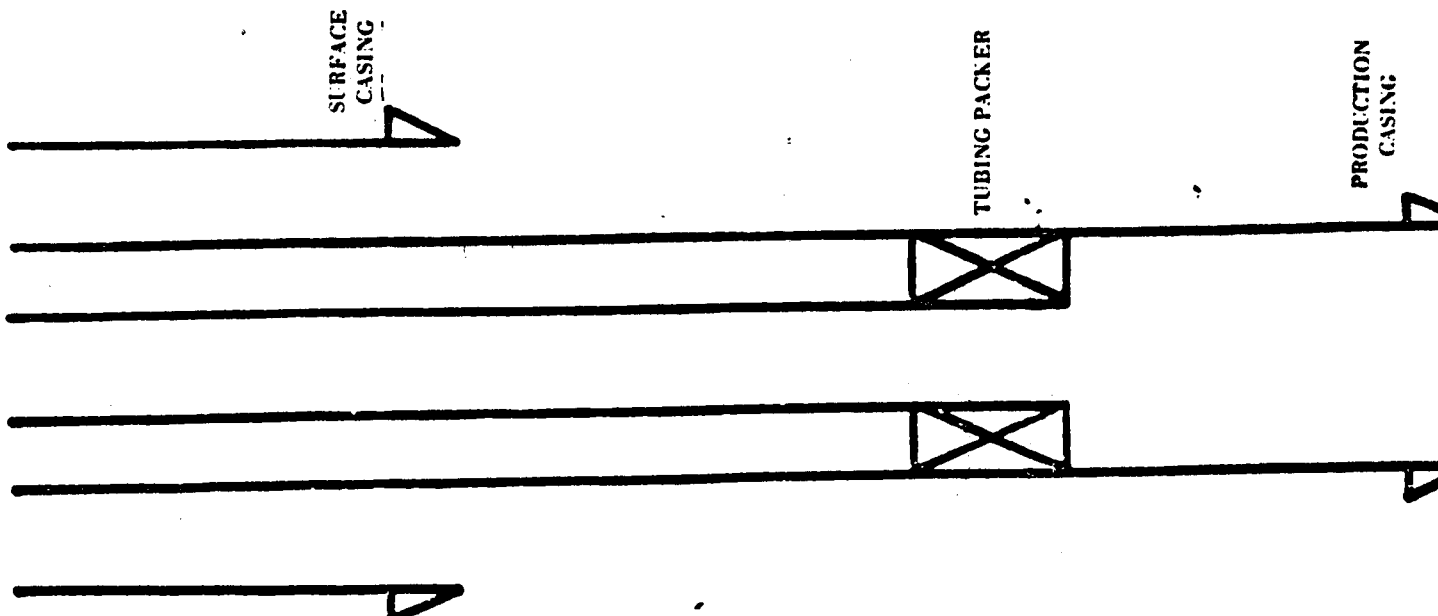

CHECKLIST FOR INJECTION WELL APPLICATION AND FILE REVIEW  
\* \* \* \* \*

Operator: Chevron Well No. 12-21A (146)  
 County: Ventura T 75 R 22E Sec. 21 API# 43-047-16492  
 New Well  Conversion  Disposal Well  Enhanced Recovery Well

	YES	NO
UIC Forms Completed	<input checked="" type="checkbox"/>	<input type="checkbox"/>
Plat including Surface Owners, Leaseholders, and wells of available record	<input checked="" type="checkbox"/>	<input type="checkbox"/>
Schematic Diagram	<input checked="" type="checkbox"/>	<input type="checkbox"/>
Fracture Information	<input checked="" type="checkbox"/>	<input type="checkbox"/>
Pressure and Rate Control	<input checked="" type="checkbox"/>	<input type="checkbox"/>
Adequate Geologic Information	<input checked="" type="checkbox"/>	<input type="checkbox"/>

Fluid Source

Greenview

Analysis of Injection Fluid Yes  No  TDS 5460

Analysis of Water in Formation to be injected into Yes  No  TDS 21667

Known USDW in area Ventura Depth 2700

Number of wells in area of review 3 Prod. 2 P&A 0  
 Water 0 Inj. 1

Aquifer Exemption Yes  NA

Mechanical Integrity Test Yes  No

Date 8-31-84 Type Incer

Comments: Top of Cement 4000 Bottom 57024

Reviewed by: [Signature]

(To be filed within 30 days after drilling is completed)

DEPARTMENT OF NATURAL RESOURCES AND ENERGY

DIVISION OF OIL, GAS, AND MINING  
Room 4241 State Office Building  
Salt Lake City, Utah 84114

COUNTY LEASE NO.

API NO 43-047-05458

640 Acres

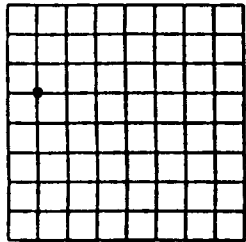

Locate Well Correctly and Outline Lease

COUNTY Uintah SEC. 21 TWP. 7S RGE. 22E

COMPANY OPERATING Chevron U.S.A. Inc.

OFFICE ADDRESS P. O. Box 599

TOWN Denver STATE CO ZIP 80201

FARM NAME Red Wash WELL NO. 146

DRILLING STARTED 2/28 1961 DRILLING FINISHED 3/17 1961

DATE OF FIRST PRODUCTION 4/22/61 COMPLETED 4/9/61

WELL LOCATED SW    % NW    %

663 FT. FROM SE OF    % SEC. & 655 FT. FROM WL OF    % SEC.

ELEVATION BERRICK FLOOR KB 5029 GROUND 5017

TYPE COMPLETION

Single Zone X Order No. \_\_\_\_\_

Multiple Zone \_\_\_\_\_ Order No. \_\_\_\_\_

Comingled \_\_\_\_\_ Order No. \_\_\_\_\_

LOCATION EXCEPTION \_\_\_\_\_ Order No. \_\_\_\_\_ Penalty \_\_\_\_\_

OIL OR GAS ZONES

Name	From	To	Name	From	To
Green River	4500	5600			

CASING & CEMENT

Casing Set				Csg. Test	Cement		
Size	Wgt	Grade	Feet	Psi	Sex	Fillup	Top
10-3/4"	40.5#	J-55	205	*	170	-	surface
7"	23#	J-55	5704	2000	400	-	4000

TOTAL DEPTH 5704

PACKERS SET DEPTH 5347

COMPLETION & TEST DATA BY PRODUING FORMATION

1

2

3

FORMATION	1	2	3
Green River			
SPACING & SPACING ORDER NO.	80-acre spacing		
CLASSIFICATION (Oil; Gas; Dry; Inj. Well)	Enhanced recovery		
PERFORATED	5380-97	5492	5524 1/2
	5486-95	5525	5533 1/2
INTERVALS	5518-26	5534	5547 1/2
	5531-37	5548	
ACIDIZED? Yes	All perforated intervals		
FRACTURE TREATED? No	-		

INITIAL TEST DATA

Date	4/22/61		
Oil. bbl./day	11		
Oil Gravity	25.5		
Gas. Cu. Ft./day	80	MCF	CF
Gas-Oil Ratio Cu. Ft./Bbl.	7273		
Water-Bbl./day	294		
Pumping or Flowing	pumping		
CHOKE SIZE			
FLOW TUBING PRESSURE			

A record of the formations drilled through, and pertinent remarks are presented on the reverse.

*R.H. Elliott* (use reverse side)

I, the undersigned, being first duly sworn upon oath, state that this well record is true, correct and complete according to the records of this office and to the best of my knowledge and belief.

Telephone (303) 691-7437 R.H. Elliott - Area Prod Supt.  
My commission expires July 31, 1961 Name and title of representative of company

My business address is: \_\_\_\_\_  
Subscribed and sworn to before me this 19 day of July, 1961

\* Test CO 80223 1/1/61, but our records do not show a value for the pressure test.

*Leslie J. Thompson*

Well file

Red Wash Unit #12-21A

PLAT SHOWING LOCATION OF THE CALIFORNIA OIL  
COMPANY WELL IN THE SW $\frac{1}{4}$  OF THE NW $\frac{1}{4}$  SECTION  
21, TOWNSHIP 7 SOUTH, RANGE 22 EAST, SALT  
LAKE BASE AND MERIDIAN.

Scale of plat 1" = 400 feet.

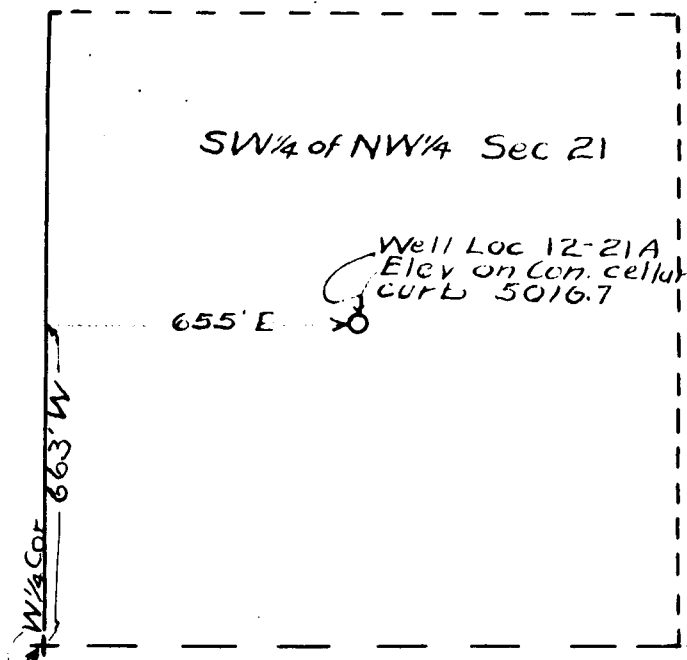

I, Leon P. Christensen, of Vernal, Utah do hereby certify that this plat correctly shows the location of the well shown hereon as surveyed by me on January 23, 1961, that elevations were run on February 12, 1961. Well is located at a point 663 feet North and 655 feet East of the West quarter corner, Section 21, Township 7 South, Range 22 East, Salt Lake Meridian.

*Leon P. Christensen*  
Prof. Engr. and Land Surveyor



Ground Level 5017'

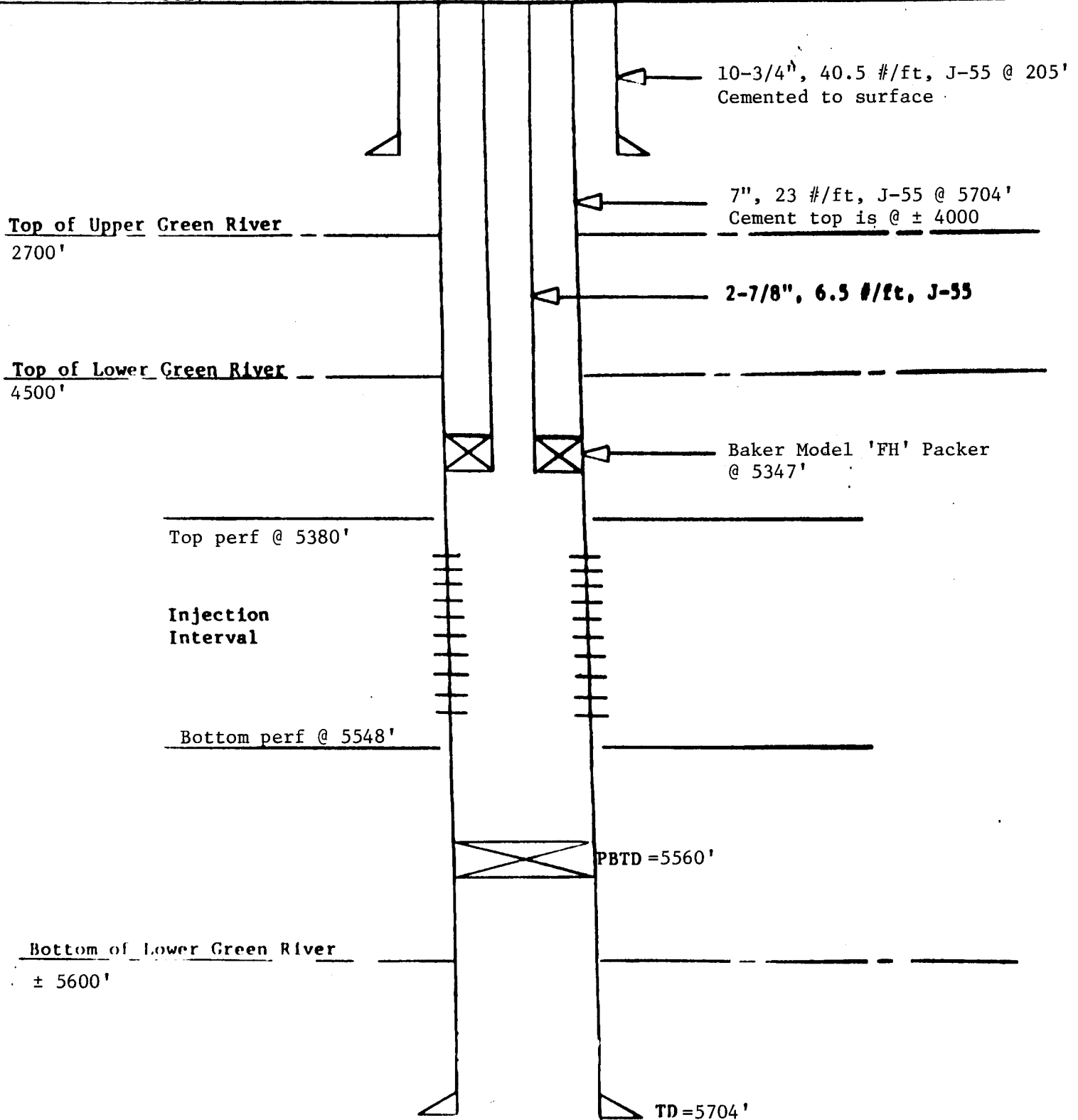

Red Wash Unit 146 (12-21A)  
Wellbore Schematic

## CBL DESCRIPTIONS

### Injection Well

#### **RWU No. 146 (12-21A)**

The CBL indicates the cement top is at + 4000'. The cement bond from 4000' to 5000' is of poor quality. Generally, from 5000' to 5560' the bonding is fair. Poorly bonded sections exist from 5100' to 5130' and 5340' to 5380'. The injection interval is from 5380' to 5548'.

### Offset Producers

#### **RWU No. 73 (32-21A) - SI**

A cement bond log is not available for No. 73 (32-21A). The cement top is calculated to be at 3880' from the first stage and 400' from the second stage of the cement job. The DV tool is at 2209'. The production interval is 1980'-2036' in the Uinta Formation.

#### **RWU No. 86 (23-21A)**

The cement bond in No. 86 is generally of fair quality from the cement top at 3950' to TD. Good and poor sections are indicated throughout the cemented interval. Perforations exist within the gross interval 5955'-6125'.

UNITED STATES  
DEPARTMENT OF THE INTERIOR  
BUREAU OF LAND MANAGEMENT

FORM APPROVED  
Budget Bureau No. 1004-0135  
Expires: March 31, 1993

SUNDRY NOTICES AND REPORTS ON WELLS

Do not use this form for proposals to drill or to deepen or reentry to a different reservoir.  
Use "APPLICATION FOR PERMIT—" for such proposals

**SUBMIT IN TRIPLICATE**

1. Type of Well  
Oil  Gas   
Well  Well  Other  W14

2. Name of Operator  
CHEVRON U.S.A. PRODUCTION CO.

3. Address and Telephone No.  
P.O. BOX 599, DENVER, CO. 80201 (303) 930-3691

4. Location of Well (Footage, Sec., T., R., M., or Survey Description)  
1980 CNL  
663 FSL, 666 FWL, SEC. 21, T7S, R22E

5. Lease Designation and Serial No.  
U - 0559

6. If Indian, Allottee or Tribe Name

7. If Unit or CA, Agreement Designation  
RED WASH

8. Well Name and No.  
146 (12-21A)

9. API Well No.  
43-047-16492

10. Field and Pool, or Exploratory Area  
RED WASH - GRN. RIVER

11. County or Parish, State  
UINTAH, UTAH

12. CHECK APPROPRIATE BOX(S) TO INDICATE NATURE OF NOTICE, REPORT, OR OTHER DATA

TYPE OF SUBMISSION	TYPE OF ACTION
<input type="checkbox"/> Notice of Intent <input checked="" type="checkbox"/> Subsequent Report <input type="checkbox"/> Final Abandonment Notice	<input type="checkbox"/> Abandonment <input type="checkbox"/> Recompletion <input type="checkbox"/> Plugging Back <input type="checkbox"/> Casing Repair <input type="checkbox"/> Altering Casing <input checked="" type="checkbox"/> Other <u>STATUS</u> <input type="checkbox"/> Change of Plans <input type="checkbox"/> New Construction <input type="checkbox"/> Non-Routine Fracturing <input type="checkbox"/> Water Shut-Off <input type="checkbox"/> Conversion to Injection <input type="checkbox"/> Dispose Water <small>(Note) Report results of multiple completion on Well Completion or Recompletion Report and Log form.)</small>

13. Describe Proposed or Completed Operations (Clearly state all pertinent details, and give pertinent dates, including estimated date of starting any proposed work. If well is directionally drilled, give subsurface locations and measured and true vertical depths for all markers and zones pertinent to this work.)

THIS WELL IS SHUT-IN WHILE UPGRADING WELL TEST FACILITIES. WE WILL RE-EVALUATE STATUS AFTER WELL TEST FACILITIES UPGRADES HAVE BEEN COMPLETED.

- 3 - BLM
- 3 - STATE
- 1 - JTC
- 1 - WELL FILE
- 1 - JLW

**RECEIVED**

APR 09 1992

DIVISION OF  
OIL, GAS & MINING

14. I hereby certify that the foregoing is true and correct  
Signed J. Watson Title PERMIT SPECIALIST Date 3/30/92

(This space for Federal or State office use)

Approved by: \_\_\_\_\_ Title \_\_\_\_\_ Date \_\_\_\_\_  
Conditions of approval, if any:

Title 18 U.S.C. Section 1001, makes it a crime for any person knowingly and willfully to make to any department or agency of the United States any false, fictitious or fraudulent statements or representations as to any matter within its jurisdiction.





**Chevron U.S.A. Inc.**  
P.O. Box 455, Vernal, UT 84078 • Phone (801) 789-2442

**FEBRUARY 15, 1993**

**ANNUAL REPORT OF  
SHUT-IN WELLS  
WONSITS VALLEY STATE/FEDERAL UNIT  
UINTAH COUNTY, UTAH**

**BUREAU OF LAND MANAGEMENT  
170 SOUTH 500 EAST  
VERNAL, UT 84078**

**GENTLEMEN:**

Enclosed, please find the annual report of shut-in wells in Red Wash Unit. If you have any questions, please call the above address.

**Sincerely,**

---

**J.T. CONLEY  
AREA OPERATIONS SUPERVISOR**

sdm  
Enclosures

cc: State of Utah  
Department of Natural Resources  
Division of Oil, Gas and Mining  
355 West North Temple  
3 Triad Center, Suite 350  
Salt Lake City, UT 84180-1203

**RECEIVED**

**FEB 18 1993**

**DIVISION OF  
OIL GAS & MINING**



**Chevron U.S.A. Inc.**  
P.O. Box 455, Vernal, UT 84078 • Phone (801) 789-2442

**FEBRUARY 15, 1993**

**ANNUAL REPORT OF  
SHUT-IN WELLS  
RED WASH UNIT  
UINTAH COUNTY, UTAH**

**BUREAU OF LAND MANAGEMENT  
170 SOUTH 500 EAST  
VERNAL, UT 84078**

**GENTLEMEN:**

Enclosed, please find the annual report of shut-in wells in Red Wash Unit. If you have any questions, please call the above address.

**Sincerely,**

  
\_\_\_\_\_  
**J.T. CONLEY  
AREA OPERATIONS SUPERVISOR**

sdm  
Enclosures

cc: State of Utah  
Department of Natural Resources  
Division of Oil, Gas and Mining  
355 West North Temple  
3 Triad Center, Suite 350  
Salt Lake City, UT 84180-1203

Buttram Energies, Inc.  
6303 Waterford Boulevard, Suite 220  
Oklahoma City, OK 73116

**RECEIVED**

**FEB 18 1993**

**DIVISION OF  
OIL GAS & MINING**

UNITED STATES  
DEPARTMENT OF THE INTERIOR  
BUREAU OF LAND MANAGEMENT

FORM APPROVED  
Budget Bureau No. 1004-0135  
Expires: March 31, 1993

SUNDRY NOTICES AND REPORTS ON WELLS

Do not use this form for proposals to drill or to deepen or reentry to a different reservoir.  
Use "APPLICATION FOR PERMIT—" for such proposals

- 5. Lease Designation and Serial No.  
**U-0559**
- 6. If Indian, Allottee or Tribe Name
- 7. If Unit or CA, Agreement Designation  
**Red Wash Unit**
- 8. Well Name and No.  
**RWU #146 (12-21A)**
- 9. API Well No.  
**43-047-16492**
- 10. Field and Pool, or Exploratory Area  
**Red Wash-Grn. River**
- 11. County or Parish, State  
**Uintah, Utah**

**SUBMIT IN TRIPLICATE**

- 1. Type of Well  
Oil  Gas   
Well  Well   Other
- 2. Name of Operator  
**Chevron U.S.A. Inc.**
- 3. Address and Telephone No.  
**P.O. Box 455, Vernal, Utah 84078 (801) 789-2442**
- 4. Location of Well (Footage, Sec., T., R., M., or Survey Description)  
**663' FSL, 663' FWL, S21-T7S-R22E  
1980' FNL 0**

12. CHECK APPROPRIATE BOX(s) TO INDICATE NATURE OF NOTICE, REPORT, OR OTHER DATA

TYPE OF SUBMISSION	TYPE OF ACTION
<input type="checkbox"/> Notice of Intent	<input type="checkbox"/> Abandonment
<input checked="" type="checkbox"/> Subsequent Report	<input type="checkbox"/> Recompletion
<input type="checkbox"/> Final Abandonment Notice	<input type="checkbox"/> Plugging Back
	<input type="checkbox"/> Casing Repair
	<input type="checkbox"/> Altering Casing
	<input checked="" type="checkbox"/> Other _____
	<input type="checkbox"/> Change of Plans
	<input type="checkbox"/> New Construction
	<input type="checkbox"/> Non-Routine Fracturing
	<input type="checkbox"/> Water Shut-Off
	<input type="checkbox"/> Conversion to Injection
	<input type="checkbox"/> Dispose Water

(Note) Report results of multiple completion on Well Completion or Recompletion Report and Log form.)

13. Describe Proposed or Completed Operations (Clearly state all pertinent details, and give pertinent dates, including estimated date of starting any proposed work. If well is directionally drilled, give subsurface locations and measured and true vertical depths for all markers and zones pertinent to this work.)

Well test facility upgrades were completed during 1992. We plan to re-evaluate this shut-in injection well during 1993.

**RECEIVED**  
FEB 18 1993  
DIVISION OF  
OIL GAS & MINING

14. I hereby certify that the foregoing is true and correct  
Signed *[Signature]* Title *Petroleum Engineer* Date 2/15/93

(This space for Federal or State office use)  
Approved by: \_\_\_\_\_ Title \_\_\_\_\_ Date \_\_\_\_\_  
Conditions of approval, if any:

Title 18 U.S.C. Section 1001, makes it a crime for any person knowingly and willfully to make to any department or agency of the United States any false, fictitious or fraudulent statements or representations as to any matter within its jurisdiction.

⊛ See instruction on Reverse Side

UNITED STATES  
DEPARTMENT OF THE INTERIOR  
BUREAU OF LAND MANAGEMENT

FORM APPROVED  
Budget Bureau No. 1004-0135  
Expires: March 31, 1993

SUNDRY NOTICES AND REPORTS ON WELLS

Do not use this form for proposals to drill or to deepen or reentry to a different reservoir.  
Use "APPLICATION FOR PERMIT—" for such proposals

**SUBMIT IN TRIPLICATE**

1. Type of Well  
Oil  Gas   
Well  Well  Other

2. Name of Operator  
**Chevron U.S.A. Inc.**

3. Address and Telephone No.  
**P.O. Box 455, Vernal, Utah 84078 (801) 789-2442**

4. Location of Well (Footage, Sec., T., R., M., or Survey Description)  
**663' FSL, 665' FWL, SEC. 21, T7S, R22E  
1980 FNL 660'**

5. Lease Designation and Serial No.  
**U-0559**

6. If Indian, Allottee or Tribe Name

7. If Unit or CA, Agreement Designation  
**Red Wash Unit**

8. Well Name and No.  
**RWU #146 (12-21A)**

9. API Well No.  
**43-047-16492**

10. Field and Pool, or Exploratory Area  
**Red Wash-Grn. River**

11. County or Parish, State  
**Uintah, Utah**

12. CHECK APPROPRIATE BOX(S) TO INDICATE NATURE OF NOTICE, REPORT, OR OTHER DATA

TYPE OF SUBMISSION	TYPE OF ACTION
<input checked="" type="checkbox"/> Notice of Intent	<input checked="" type="checkbox"/> Abandonment
<input type="checkbox"/> Subsequent Report	<input type="checkbox"/> Recompletion
<input type="checkbox"/> Final Abandonment Notice	<input type="checkbox"/> Plugging Back
	<input type="checkbox"/> Casing Repair
	<input type="checkbox"/> Altering Casing
	<input type="checkbox"/> Other _____
	<input type="checkbox"/> Change of Plans
	<input type="checkbox"/> New Construction
	<input type="checkbox"/> Non-Routine Fracturing
	<input type="checkbox"/> Water Shut-Off
	<input type="checkbox"/> Conversion to Injection
	<input type="checkbox"/> Dispose Water

(Note) Report results of multiple completion on Well Completion or Recompletion Report and Log form.)

13. Describe Proposed or Completed Operations (Clearly state all pertinent details, and give pertinent dates, including estimated date of starting any proposed work. If well is directionally drilled, give subsurface locations and measured and true vertical depths for all markers and zones pertinent to this work.)

We propose to P&A the subject well per the attached procedure.

**RECEIVED**

JUG 12 1993

ACCEPTED BY THE STATE  
OF UTAH DIVISION OF  
OIL, GAS, AND MINING

DIVISION OF  
OIL GAS & MINING

DATE: **8-3-93**  
BY: *[Signature]*

14. I hereby certify that the foregoing is true and correct.  
Signed: *[Signature]* Title: **Oper Assistant** Date: **07/30/93**

(This space for Federal or State office use)  
Federal Approval of this Action is Necessary  
Approved by: \_\_\_\_\_ Title \_\_\_\_\_ Date \_\_\_\_\_  
Conditions of approval, if any:

RED WASH UNIT  
UINTAH COUNTY, UTAH

RWU #146 (12-21A)  
PLUGGING PROCEDURE

1. MIRU. ND WH AND NU BOPE.
2. RELEASE BAKER FH PACKER AT 5341' AND TOH.
3. CLEAN OUT TO ~5350'. SET CIBP AT 5300' AND DUMP BAIL 25' OF CEMENT ON TOP. DISPLACE WELLBORE TO ~2700' WITH 9.2 PPG BRINE.
4. OIL SHALE INTERVAL WHICH BLM NORMALLY REQUIRES TO BE ISOLATED DOES NOT APPEAR TO EXIST AT THIS LOCATION. NEXT PLUG IS TO CAP THE TOP OF THE GREEN RIVER FORMATION AT 2800'. PERFORATE AT 2900' AND SET CICR AT 2800'. SQUEEZE ~55 SX. CLASS H CEMENT BELOW CICR AND SPOT ~25 SX. CLASS H CEMENT ON TOP OF CICR. CIRCULATE CLEAN AND DISPLACE WELLBORE WITH 9.2 PPG BRINE.
5. PERFORATE AT 300' AND ESTABLISH CIRCULATION DOWN 7" CASING AND UP 7" X 10-3/4" ANNULUS. CEMENT CASING AND ANNULUS FROM 300' TO SURFACE USING ~165 SX. CLASS H CEMENT.
6. CUT OFF WELLHEAD AND INSTALL DRY HOLE MARKER.
7. NOTIFY OPERATIONS TO REHABILITATE LOCATION PER BLM GUIDELINES.



**PLUGGING AND ABANDONMENT PLAN**

<b>NAME AND ADDRESS OF FACILITY</b> RED WASH UNIT PO BOX 455 VERNAL UT 84078	<b>NAME AND ADDRESS OF OWNER/OPERATOR</b> CHEVRON USA PRODUCTION CO PO BOX 455 VERNAL UT 84078
---	---

<b>LOCATE WELL AND OUTLINE UNIT ON SECTION PLAT — 640 ACRES</b> _____ _____ _____ _____ _____ _____ _____ _____ _____ _____	<b>STATE</b> <b>COUNTY</b> UT            Uintah	<b>PERMIT NUMBER</b> UT02436
---	--	---------------------------------

**SURFACE LOCATION DESCRIPTION**  
 SW 1/4 OF NW 1/4 OF SECTION 21 TOWNSHIP 7S RANGE 22E

**LOCATE WELL IN TWO DIRECTIONS FROM NEAREST LINES OF QUARTER SECTION AND DRILLING UNIT**

Surface 663      S  
 Location \_\_\_\_\_ ft. from (N/S) \_\_\_\_\_ line of quarter section  
 and 665      W  
 \_\_\_\_\_ ft. from (E/W) \_\_\_\_\_ line of quarter section

<b>TYPE OF AUTHORIZATION</b> <input type="checkbox"/> Individual Permit <input type="checkbox"/> Area Permit <input checked="" type="checkbox"/> Rule  Number of Wells <u>1</u>	<b>WELL ACTIVITY</b> <input type="checkbox"/> CLASS I <input checked="" type="checkbox"/> CLASS II <input type="checkbox"/> Brine Disposal <input checked="" type="checkbox"/> Enhanced Recovery <input type="checkbox"/> Hydrocarbon Storage <input type="checkbox"/> CLASS III
Lease Name <b>RED WASH UNIT</b>	Well Number <b>#146(12-21A)</b>

**CASING AND TUBING RECORD AFTER PLUGGING**      **METHOD OF EMPLACEMENT OF CEMENT PLUGS**

SIZE	WT/LB. FT.	TO BE PUT IN WELL (ft.)	TO BE LEFT IN WELL (ft.)	HOLE SIZE
10 3/4	40.5	N/A	205	15
7	23	N/A	5704	9

The Balance Method  
 The Dump Bailer Method  
 The Two-Plug Method  
 Other

CEMENTING TO PLUG AND ABANDON DATA	PLUG #1	PLUG #2	PLUG #3	PLUG #4	PLUG #5	PLUG #6	PLUG #7
Size of hole or Pipe in which Plug Will Be Placed (inches)	7	7	7				
Depth to Bottom of Tubing or Drill Pipe (ft.)	5300	2900	300				
Sacks of Cement To Be used (each plug)	73	75	165				
Slurry volume To Be Pumped (cu. ft.)	7.7	79	175				
Sealed Top of Plug (ft.)	5265	2700	SURE				
Measured Top of Plug (ft. (aced ft.))							
Slurry wt. (Lb./Gal.)	16.4	16.4	16.4				
Type Cement or Other Material (Class III)	H	H	H				

**LIST ALL OPEN HOLE AND/OR PERFORATED INTERVALS AND INTERVALS WHERE CASING WILL BE VARIED (If any)**

From	To	From	To
SEE ATTACHED SCHEMATIC.			

Estimated Cost to Plug wells  
 \$25000

**CERTIFICATION**

*I certify under the penalty of law that I have personally examined and am familiar with the information submitted in this document and all attachments and that, based on my inquiry of those individuals immediately responsible for obtaining the information, I believe that the information is true, accurate, and complete. I am aware that there are significant penalties for submitting false information, including the possibility of fine and imprisonment. (Ref. 40 CFR 144.32)*

<b>NAME AND OFFICIAL TITLE: Please type or print</b> J.T. CONLEY RED WASH AREA TEAM LEADER	<b>SIGNATURE</b> 	<b>DATE SIGNED</b> 7-13-93
--	----------------------	-------------------------------



UNITED STATES ENVIRONMENTAL PROTECTION AGENCY

REGION VIII

999 18th STREET - SUITE 500  
DENVER, COLORADO 80202-2466

SEP 3 1993

RECEIVED  
SEP 09 1993

Ref: 8WM-DW

CERTIFIED MAIL  
RETURN RECEIPT REQUESTED

DIVISION OF  
OIL, GAS & MINING

Mr. John T. Conley  
Chevron U.S.A. Production Company  
P. O. Box 455  
Vernal, UT 84078

RE: UNDERGROUND INJECTION CONTROL (UIC)  
Approval of P & A Plans  
Red Wash Unit (RWU)  
Uintah County, Utah

Dear Mr. Conley:

In accordance with the telephone conversation between your Mr. Steve McPherson and Chuck Williams of this office, we have reviewed and hereby approve the revised plugging and abandonment plans as submitted, dated July 22, 1993, for the following wells:

RED WASH FIELD

EPA PERMIT NO.

RWU #98 (21-22A)  
RWU #22 (41-18C)  
RWU #105 (32-29A)  
RWU #117 (14-21A)  
RWU #146\*(12-21A)

UT2000-02359  
UT2000-02427  
UT2000-02431  
UT2000-02432  
UT2000-02436

T. 7S, R. 22E, S-21

16492

Within sixty (60) days from the date of plugging and abandonment operations, please submit EPA Form 7520-13, Plugging Record, (copy enclosed), for each well, showing the details as to how each well was actually plugged.

Please direct all correspondence to the ATTENTION: CHUCK WILLIAMS, CITING MAIL CODE 8WM-DW. Thank you for your continued cooperation.

Sincerely,

Max H. Dodson, Director  
Water Management Division

Enclosure

UNITED STATES  
DEPARTMENT OF THE INTERIOR  
BUREAU OF LAND MANAGEMENT

FORM APPROVED  
Budget Bureau No. 1004-0135  
Expires: March 31, 1993

**SUNDRY NOTICES AND REPORTS ON WELLS**

Do not use this form for proposals to drill or to deepen or reentry to a different reservoir  
Use "APPLICATION FOR PERMIT--" for such proposals

**SUBMIT IN TRIPLICATE**

1. Type of Well  
 Oil Well     Gas Well     Other

2. Name of Operator  
**CHEVRON U.S.A. PRODUCTION COMPANY**

3. Address and Telephone No.  
**P. O. BOX 455, VERNAL, UT 84078 (801) 781-4302**

4. Location of Well (Footage, Sec., T., R., M., or Survey Description)  
**663' FSL, 665' FWL, SEC. 21, T7S/R22E**

5. Lease Designation and Serial No.  
**U-0559**

6. If Indian, Allottee or Tribe Name

7. If Unit or C.A. Agreement Designation  
**RED WASH UNIT**

8. Well Name and No.  
**RWU #146 (12-21A)**

9. API Well No.  
**43-047-16492**

10. Field and Pool, or Exploratory Area  
**RED WASH-GRN. RIVER**

11. County or Parish, State  
**UINTAH, UTAH**

12. CHECK APPROPRIATE BOX(S) TO INDICATE NATURE OF NOTICE, REPORT, OR OTHER DATA

TYPE OF SUBMISSION	TYPE OF ACTION
<input type="checkbox"/> Notice of Intent	<input type="checkbox"/> Abandonment
<input checked="" type="checkbox"/> Subsequent Report	<input type="checkbox"/> Recompletion
<input type="checkbox"/> Final Abandonment Notice	<input type="checkbox"/> Plugging Back
	<input type="checkbox"/> Casing Repair
	<input type="checkbox"/> Altering Casing
	<input checked="" type="checkbox"/> Other <u>6 MOS. EXTENSION (P&amp;A)</u>
	<input type="checkbox"/> Change of Plans
	<input type="checkbox"/> New Construction
	<input type="checkbox"/> Non-Routine Fracturing
	<input type="checkbox"/> Water Shut-Off
	<input type="checkbox"/> Conversion to Injection
	<input type="checkbox"/> Dispose Water

(Note) Report results of multiple completion on Well Completion or Recompletion Report and Log form.)

13. Describe Proposed or Completed Operations (Clearly state all pertinent details, and give pertinent dates, including estimated date of starting any proposed work. If well is directionally drilled, give subsurface locations and measured and true vertical depths for all markers and zones pertinent to this work)

**We request a 6 mos. extension on our proposal to P&A the subject well.**

RECEIVED BY THE STATE  
 2-17-94  
 DATE: 2-17-94  
 BY: J Matthews

FEB 16 1994

14. I hereby certify that the foregoing is true and correct.  
 Signed: Chris Hough Title: Operations Assistant Date: 02/14/94

(This space for Federal or State office use)

Approved by: \_\_\_\_\_ Title: \_\_\_\_\_ Date: \_\_\_\_\_

Conditions of approval, if any

Title 18 U.S.C. Section 1001, makes it a crime for any person knowingly and willfully to make to any department or agency of the United States any false, fictitious or fraudulent statements or representations as to any matter within its jurisdiction.



UNITED STATES  
DEPARTMENT OF THE INTERIOR  
BUREAU OF LAND MANAGEMENT

FORM APPROVED  
Budget Bureau No. 1004-0135  
Expires: March 31, 1993

**SUNDRY NOTICES AND REPORTS ON WELLS**

Do not use this form for proposals to drill or to deepen or reentry to a different reservoir  
Use "APPLICATION FOR PERMIT--" for such proposals

5. Lease Designation and Serial No.

U-0559

6. If Indian, Allottee or Tribe Name

7. If Unit or CA, Agreement Designation

RED WASH UNIT

8. Well Name and No.

RWU #146 (12-21A)

9. API Well No.

43-047-16492

10. Field and Pool, or Exploratory Area

RED WASH-GRN. RIVER

11. County or Parish, State

UINTAH, UTAH

**SUBMIT IN TRIPLICATE**

1. Type of Well

Oil Gas  
 Well  Well  Other

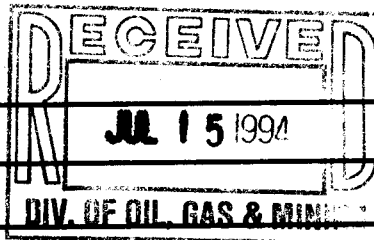

2. Name of Operator

CHEVRON U.S.A. PRODUCTION COMPANY

3. Address and Telephone No.

11002 EAST 17500 SOUTH, VERNAL, UT 84078-8526 (801) 781-4302

4. Location of Well (Footage, Sec., T., R., M., or Survey Description)

663' FSL, 665' FWL, SEC. 21, T7S/R22E

12. CHECK APPROPRIATE BOX(S) TO INDICATE NATURE OF NOTICE, REPORT, OR OTHER DATA

TYPE OF SUBMISSION	TYPE OF ACTION
<input type="checkbox"/> Notice of Intent	<input checked="" type="checkbox"/> Abandonment
<input checked="" type="checkbox"/> Subsequent Report	<input type="checkbox"/> Recompletion
<input type="checkbox"/> Final Abandonment Notice	<input type="checkbox"/> Plugging Back
	<input type="checkbox"/> Casing Repair
	<input type="checkbox"/> Altering Casing
	<input type="checkbox"/> Other _____
	<input type="checkbox"/> Change of Plans
	<input type="checkbox"/> New Construction
	<input type="checkbox"/> Non-Routine Fracturing
	<input type="checkbox"/> Water Shut-Off
	<input type="checkbox"/> Conversion to Injection
	<input type="checkbox"/> Dispose Water

(Note) Report results of multiple completion on Well Completion or Recompletion Report and Log form.)

13. Describe Proposed or Completed Operations (Clearly state all pertinent details, and give pertinent dates, including estimated date of starting any proposed work. If well is directionally drilled, give subsurface locations and measured and true vertical depths for all markers and zones pertinent to this work)

Subject injector was P&A'd between 7/7/94 and 7/12/94 as follows:

- MIRU. Tested casing to 500 PSI; good.
- Perforated at 5334' using 4 JSPF.
- RIH with bit and scraper to 5325'. Circulated well clean.
- POOH with bit and scraper and set CIBP at 5290'. Tested casing to 500 PSI; good. Dump balled 35' cement on top.
- Perforated at 3850' using 4 JSPF. RIH with 7" CICR to 5232'.
- Set CICR at 3608'. Tested casing to 500 PSI; good. Tested tubing to 1500 PSI; good. Pumped 90 sx. Class H Cement below CICR, stung out and spotted 10 sx on top.
- Perforated at 2900' using 4 JSPF. RIH with 7" CICR to 2565'. Tested casing to 500 PSI; good. Pumped 125 sx. Class H Cement below CICR and spotted 10 sx. on top.
- Perforated at 255' using 4 JSPF. Established circulation down casing and up annulus. Pumped 150 sx. Class H Cement to surface, hole stood full.
- Cut off wellhead, installed P&A marker and notified Operations to reclaim location.

All voids between cement plugs were filled with 9.2 ppg brine. P&A operations were witnessed by Bill Owens with the BLM.

14. I hereby certify that the foregoing is true and correct.  
Signed \_\_\_\_\_

Title Operations Assistant

Date 07/13/94

(This space for Federal or State office use)

Approved by: \_\_\_\_\_

Title \_\_\_\_\_

Date \_\_\_\_\_

Conditions of approval, if any \_\_\_\_\_

Title 18 U.S.C. Section 1001, makes it a crime for any person knowingly and willfully to make to any department or agency of the United States any false, fictitious or fraudulent statements or representations as to any matter within its jurisdiction.





# United States Department of the Interior

## BUREAU OF LAND MANAGEMENT

Utah State Office  
P.O. Box 45155  
Salt Lake City, UT 84145-0155

**RECEIVED**

FEB 07 2000

DIVISION OF  
OIL, GAS AND MINING

IN REPLY REFER TO  
UT-931

February 4, 2000

Shenandoah Energy Inc.  
Attn: Rae Cusimano  
475 17<sup>th</sup> Street, Suite 1000  
Denver, Colorado 80202

Re: Red Wash Unit  
Uintah County, Utah

Gentlemen:

On December 30, 1999, we received an indenture whereby Chevron U.S.A. Inc. resigned as Unit Operator and Shenandoah Energy Inc. was designated as Successor Unit Operator for the Red Wash Unit, Uintah County, Utah.

This indenture was executed by all required parties and the signatory parties have complied with Sections 5 and 6 of the unit agreement. The instrument is hereby approved effective February 4, 2000. In approving this designation, the Authorized Officer neither warrants nor certifies that the designated party has obtained all required approval that would entitle it to conduct operations under the Red Wash Unit Agreement.

Your statewide (Utah) oil and gas bond No. 0969 will be used to cover all operations within the Red Wash Unit.

It is requested that you notify all interested parties of the change in unit operator. Copies of the approved instruments are being distributed to the appropriate federal offices, with one copy returned herewith.

Sincerely,

/s/ Robert A. Henricks

Robert A. Henricks  
Chief, Branch of Fluid Minerals

Enclosure

cc: Chevron U.S.A. Inc.

bcc: Field Manager - Vernal (w/enclosure)  
Division of Oil, Gas & Mining  
Minerals Adjudication Group U-932  
File - Red Wash Unit (w/enclosure)  
MMS - Data Management Division  
Agr. Sec. Chron  
Fluid Chron

UT931:TAThompson:tt:2/4/00

Well Status Report  
Utah State Office  
Bureau of Land Management

Lease	Api Number	Well Name	QTR	Section	Township	Range	Well Status	Operator
UTU0116	4304715258	144 (21-18B) RED WAS NENW	18	T	7S	R23E TA	CHEVRON U S A INCORPORATED	
UTU081	4304715259	145 (24-13B) RED WAS SESW	13	T	7S	R23E OSI	CHEVRON U S A INCORPORATED	
<del>UTU0559</del>	<del>4304716492</del>	<del>146 (12-21A) RED WAS SWNW</del>	<del>21</del>	<del>T</del>	<del>7S</del>	<del>R22E P+A</del>	<del>CHEVRON U S A INCORPORATED</del>	
UTU081	4304715260	147 (22-22B) RED WAS SENW	22	T	7S	R23E POW	CHEVRON U S A INCORPORATED	
UTU081	4304715261	148 (13-22B) RED WAS NWSW	22	T	7S	R23E WIW	CHEVRON U S A INCORPORATED	
<del>UTU0571</del>	<del>4304715262</del>	<del>149 (21-33A) RED WAS NENW</del>	<del>33</del>	<del>T</del>	<del>7S</del>	<del>R22E P+A</del>	<del>CHEVRON U S A INCORPORATED</del>	
UTU02148	4304715145	15 (32-17C) RED WASH SWNE	17	T	7S	R24E PGW	CHEVRON U S A INCORPORATED	
UTU081	4304715263	150 (31-22B) RED WAS NWNE	22	T	7S	R23E TA	CHEVRON U S A INCORPORATED	
UTU081	4304715264	151 (42-14B) RED WAS SENE	14	T	7S	R23E POW	CHEVRON U S A INCORPORATED	
<del>UTU02148</del>	<del>4304716493</del>	<del>152 (41-17C) RED WAS NENE</del>	<del>17</del>	<del>T</del>	<del>7S</del>	<del>R24E P+A</del>	<del>CHEVRON U S A INCORPORATED</del>	
UTU02025	4304715265	153 (14-29B) RED WAS SWSW	29	T	7S	R23E POW	CHEVRON U S A INCORPORATED	
<del>STATE</del>	<del>4304716494</del>	<del>154 (41-32B) RED WAS NENE</del>	<del>32</del>	<del>T</del>	<del>7S</del>	<del>R23E P+A</del>	<del>CHEVRON USA INC</del>	
<del>UTU0571</del>	<del>4304715266</del>	<del>155 (23-33A) RED WAS NESW</del>	<del>33</del>	<del>T</del>	<del>7S</del>	<del>R22E P+A</del>	<del>CHEVRON U S A INCORPORATED</del>	
UTU081	4304715267	156 (23-15B) RED WAS NESW	15	T	7S	R23E WIW	CHEVRON U S A INCORPORATED	
UTU02025	4304715268	158 (32-30B) RED WAS SWNE	30	T	7S	R23E POW	CHEVRON U S A INCORPORATED	
<del>UTU0571</del>	<del>4304715269</del>	<del>159 (14-33A) RED WAS SWSW</del>	<del>33</del>	<del>T</del>	<del>7S</del>	<del>R22E P+A</del>	<del>CHEVRON U S A INCORPORATED</del>	
UTU02030	4304716475	16 (43-28B) RED WASH NESE	28	T	7S	R23E TA	CHEVRON U S A INCORPORATED	
UTU081	4304715270	160 (32-15B) RED WAS SWNE	15	T	7S	R23E POW	CHEVRON U S A INCORPORATED	
UTU02030	4304715271	161 (14-20B) RED WAS SWSW	20	T	7S	R23E TA	CHEVRON U S A INCORPORATED	
UTU02030	4304715272	162 (12-20B) RED WAS SWNW	20	T	7S	R23E TA	CHEVRON U S A INCORPORATED	
<del>UTU0570</del>	<del>4304715273</del>	<del>163 (34-33A) RED WAS SWSE</del>	<del>33</del>	<del>T</del>	<del>7S</del>	<del>R22E P+A</del>	<del>CHEVRON U S A INCORPORATED</del>	
UTU02025	4304715274	164 (12-28B) RED WAS SWNW	28	T	7S	R23E POW	CHEVRON U S A INCORPORATED	
UTU0566	4304715275	165 (32-26B) RED WAS SWNE	26	T	7S	R23E TA	CHEVRON U S A INCORPORATED	
<del>UTU0562</del>	<del>4304715276</del>	<del>166 (23-14A) RED WAS NESW</del>	<del>14</del>	<del>T</del>	<del>7S</del>	<del>R22E ABD</del>	<del>CHEVRON U S A INCORPORATED</del>	
UTU0567	4304715277	167 (23-21B) RED WAS NESW	21	T	7S	R23E POW	CHEVRON U S A INCORPORATED	
UTU082	4304715278	168 (23-24B) RED WAS NESW	24	T	7S	R23E TA	CHEVRON U S A INCORPORATED	
UTU0569	4304715146	17 (41-20B) RED WASH NENE	20	T	7S	R23E POW	CHEVRON U S A INCORPORATED	
UTU081	4304716495	170 (41-15B) RED WAS NENE	15	T	7S	R23E TA	CHEVRON U S A INCORPORATED	
<del>UTU0570</del>	<del>4304715279</del>	<del>171 (32-33A) RED WAS SWNE</del>	<del>33</del>	<del>T</del>	<del>7S</del>	<del>R22E P+A</del>	<del>CHEVRON U S A INCORPORATED</del>	
UTU02030	4304715280	172 (21-30B) RED WAS NENW	30	T	7S	R23E TA	CHEVRON U S A INCORPORATED	
UTU0569	4304716496	173 (21-21B) RED WAS NENW	21	T	7S	R23E WIW	CHEVRON U S A INCORPORATED	
UTU0933	4304715281	174 (21-20B) RED WAS NENW	20	T	7S	R23E WIW	CHEVRON U S A INCORPORATED	
<del>UTU0558</del>	<del>4304715282</del>	<del>175 (34-28A) RED WAS SWSE</del>	<del>28</del>	<del>T</del>	<del>7S</del>	<del>R22E ABD</del>	<del>CHEVRON U S A INCORPORATED</del>	
UTU02030	4304715283	176 (31-28B) RED WAS NWNE	28	T	7S	R23E TA	CHEVRON U S A INCORPORATED	
UTU02030	4304715284	177 (42-28B) RED WAS SENE	28	T	7S	R23E POW	CHEVRON U S A INCORPORATED	
UTU081	4304715285	178 (22-13B) RED WAS SENW	13	T	7S	R23E TA	CHEVRON U S A INCORPORATED	
<del>UTU0570</del>	<del>4304715286</del>	<del>179 (43-33A) RED WAS NESE</del>	<del>33</del>	<del>T</del>	<del>7S</del>	<del>R22E P+A</del>	<del>CHEVRON U S A INCORPORATED</del>	
<del>UTU02149</del>	<del>4304715147</del>	<del>18 (41-19C) RED WASH NENE</del>	<del>19</del>	<del>T</del>	<del>7S</del>	<del>R24E ABD</del>	<del>CHEVRON U S A INCORPORATED</del>	
UTU082	4304715287	180 (31-23B) RED WAS NWNE	23	T	7S	R23E TA	CHEVRON U S A INCORPORATED	
UTU02025	4304715288	181 (34-30B) RED WAS SWSE	30	T	7S	R23E POW	CHEVRON U S A INCORPORATED	
UTU0933	4304716497	182 (14-21B) RED WAS SWSW	21	T	7S	R23E TA	CHEVRON U S A INCORPORATED	
UTU081	4304715289	183 (33-13B) RED WAS NWSE	13	T	7S	R23E WIW	CHEVRON U S A INCORPORATED	
UTU0566	4304715290	184 (23-26B) RED WAS NESW	26	T	7S	R23E TA	CHEVRON U S A INCORPORATED	
UTU081	4304716498	185 (41-14B) RED WAS NENE	14	T	7S	R23E WIWSI	CHEVRON U S A INCORPORATED	
<del>UTU02030</del>	<del>4304716499</del>	<del>186 (12-30B) RED WAS SWNW</del>	<del>30</del>	<del>T</del>	<del>7S</del>	<del>R23E P+A</del>	<del>CHEVRON U S A INCORPORATED</del>	
UTU02030	4304715291	188 (23-20B) RED WAS NESW	20	T	7S	R23E TA	CHEVRON U S A INCORPORATED	
STATE	4304715292	189 (41-16B) RED WAS NENE	16	T	7S	R23E TA	CHEVRON U S A INCORPORATED	
UTU0566	4304715148	19 (34-26B) RED WASH SWSE	26	T	7S	R23E GSI	CHEVRON U S A INCORPORATED	
<del>UTU0560</del>	<del>4304716500</del>	<del>190 (34-29A) RED WAS SWSE</del>	<del>29</del>	<del>T</del>	<del>7S</del>	<del>R22E P+A</del>	<del>CHEVRON U S A INCORPORATED</del>	

**OPERATOR CHANGE WORKSHEET**

**ROUTING**

1. GLH		4-KAS
2. CDW	<input checked="" type="checkbox"/>	5-SP <input checked="" type="checkbox"/>
3. JLT		6-FILE

Enter date after each listed item is completed

**X Change of Operator (Well Sold)**

Designation of Agent

Operator Name Change (Only)

Merger

The operator of the well(s) listed below has changed, effective:

01-01-2000

**FROM:** (Old Operator):

CHEVRON USA INC  
 Address: 11002 E. 17500 S.  
 VERNAL, UT 84078-8526

Phone: 1-(435)-781-4300  
 Account No. N0210

**TO:** ( New Operator):

SHENANDOAH ENERGY INC  
 Address: 11002 E. 17500 S.  
 VERNAL, UT 84078

Phone: 1-(435)-781-4300  
 Account N4235

**CA No.**

**Unit: RED WASH**

**WELL(S)**

NAME	API NO.	ENTITY NO.	SEC. TWN RNG	LEASE TYPE	WELL TYPE	WELL STATUS
RWU 166 (23-14A)	43-047-15276	5670	14-07S-22E	FEDERAL	OW	PA
RWU 146 (12-21A)	43-047-16492	99998	21-07S-22E	FEDERAL	OW	PA
RWU 175 (34-28A)	43-047-15282	5670	28-07S-22E	FEDERAL	OW	PA
RWU 149 (21-33A)	43-047-15262	5670	33-07S-22E	FEDERAL	OW	PA
RWU 155 (23-33A)	43-047-15266	5670	33-07S-22E	FEDERAL	OW	PA
RWU 159 (14-33A)	43-047-15269	5670	33-07S-22E	FEDERAL	OW	PA
RWU 163 (34-33A)	43-047-15273	5670	33-07S-22E	FEDERAL	OW	PA
RWU 171 (32-33A)	43-047-15279	5670	33-07S-22E	FEDERAL	OW	PA
RWU 160 (32-15B)	43-047-15270	5670	15-07S-23E	FEDERAL	OW	P
RWU 162 (12-20B)	43-047-15272	5670	20-07S-23E	FEDERAL	OW	TA
RWU 17 (41-20B)	43-047-15146	5670	20-07S-23E	FEDERAL	OW	TA
RWU 167 (23-21B)	43-047-15277	5670	21-07S-23E	FEDERAL	OW	P
RWU 147 (22-22B)	43-047-15260	5670	22-07S-23E	FEDERAL	OW	P
RWU 168 (23-24B)	43-047-15278	5670	24-07S-23E	FEDERAL	OW	TA
RWU 165 (32-26B)	43-047-15275	5670	26-07S-23E	FEDERAL	GW	S
RWU 164 (12-28B)	43-047-15274	5670	28-07S-23E	FEDERAL	OW	P
RWU 153 (14-29B)	43-047-15265	5670	29-07S-23E	FEDERAL	OW	P
RWU 158 (32-30B)	43-047-15268	5670	30-07S-23E	FEDERAL	OW	P
RWU 172 (21-30B)	43-047-15280	5670	30-07S-23E	FEDERAL	OW	TA
RWU 154 (41-32B)	43-047-16494	5670	32-07S-23E	FEDERAL	OW	PA
RWU 15 (32-17C)	43-047-15145	99998	17-07S-24E	FEDERAL	OW	P
RWU 152 (41-17C)	43-047-16493	5670	17-07S-24E	FEDERAL	GW	PA

**OPERATOR CHANGES DOCUMENTATION**

- (R649-8-10) Sundry or legal documentation was received from the **FORMER** operator on: 12-30-1999
- (R649-8-10) Sundry or legal documentation was received from the **NEW** operator on: 08-09-2000

3. The new company has been checked through the **Department of Commerce, Division of Corporations Database** on: 08-23-2000
4. Is the new operator registered in the State of Utah: YES Business Number: 224885
5. If **NO**, the operator was contacted on: \_\_\_\_\_
6. **Federal and Indian Lease Wells:** The BLM and or the BIA has approved the (merger, name change, or operator change for all wells listed on Federal or Indian leases on: 02/04/2000
7. **Federal and Indian Units:** The BLM or BIA has approved the successor of unit operator for wells listed on: 02/04/2000
8. **Federal and Indian Communization Agreements ("CA"):** The BLM or the BIA has approved the operator change for all wells listed involved in a CA on: N/A
9. **Underground Injection Control ("UIC") Proj:** The Division has approved UIC Form 5, **Transfer of Authority to Inject**, for the enhanced/secondary recovery unit/project for the water disposal well(s) listed on: \_\_\_\_\_

**DATA ENTRY:**

1. Changes entered in the **Oil and Gas Database** on: 09/11/2000
2. Changes have been entered on the **Monthly Operator Change Spread Sheet** on: 09/11/2000
3. Bond information entered in RBDMS on: N/A
4. Fee wells attached to bond in RBDMS on: N/A

**STATE BOND VERIFICATION:**

1. State well(s) covered by Bond No.: N/A

**FEE WELLS - BOND VERIFICATION/LEASE INTEREST OWNER NOTIFICATION:**

1. (R649-3-1) The **NEW** operator of any fee well(s) listed has furnished a bond: N/A
2. The **FORMER** operator has requested a release of liability from their bond on: N/A  
The Division sent response by letter on: N/A
3. (R649-2-10) The **FORMER** operator of the Fee wells has been contacted and informed by a letter from the Division of their responsibility to notify all interest owners of this change on: \_\_\_\_\_

**FILMING:**

1. All attachments to this form have been **MICROFILMED** on: 03-09-01

**FILING:**

1. **ORIGINALS/COPIES** of all attachments pertaining to each individual well have been filled in each well file on: \_\_\_\_\_

**COMMENTS:**

\_\_\_\_\_

\_\_\_\_\_

\_\_\_\_\_

\_\_\_\_\_

\_\_\_\_\_

\_\_\_\_\_

\_\_\_\_\_

\_\_\_\_\_