



ROCK ISLAND  
ILLINOIS

**25<sup>th</sup> Avenue Resurfacing,  
12<sup>th</sup> Street to 17<sup>th</sup> Street**

**THE CITY OF ROCK ISLAND, ILLINOIS**

**JOB NO. 2770**

Engineering  
1309 Mill Street  
Rock Island, IL 61201  
(309) 732-2200

**25<sup>th</sup> Avenue Resurfacing  
12<sup>th</sup> Street to 17<sup>th</sup> Street**  
(Job No. 2770)

The City of Rock Island, Illinois



ROCK ISLAND  
ILLINOIS

I hereby certify that these specifications were prepared by me or under my direct personal supervision and that I am a duly Registered Professional Engineer under the laws of the State of Illinois.

  
Justin J. Johnson, P.E.

Date: 4/11/16  
Registration No. 00620050973  
My license expires Nov 30, 2017



# CITY OF ROCK ISLAND

## Mayor

Dennis E. Pauley

## City Clerk

Aleisha Patchin

## Alderman

|                        | <u>Ward</u> |
|------------------------|-------------|
| Ivory D. Clark         | 1           |
| Virgil J. Mayberry     | 2           |
| Paul "P.J." Foley      | 3           |
| Stephen L. Tollenaer   | 4           |
| Kate Hotle             | 5           |
| Joshua Schipp          | 6           |
| Charles O. Austin, III | 7           |

## City Manager

Thomas Thomas

## Public Works Director

Randall D. Tweet

## City Engineer

Michael J. Kane, P.E.

# **TABLE OF CONTENTS**

|   |                |
|---|----------------|
| Invitation for Bids.....  | A-1            |
| Instructions to Bidders.....  | ITB-1          |
| Special Provisions .....  | PG-1 to PG-21  |
| Check Sheet for Supplemental Specifications & Recurring<br>Special Provisions ..... | PG-22 to PG-23 |
| Proposal.....   | P-1 to P-3     |
| Local Agency Proposal Bid Bond .....  | BB-1           |
| Schedule of Prices .....  | BP-1           |
| Contract.....   | C-1 to C-2     |
| Performance, Labor, Material and Maintenance Bond.....                              | B-1 to B-3     |
| Illinois Department of Labor Prevailing Wages for Rock Island County .....          | W-1 to W-7     |
| Illinois Substance Abuse Prevention Program .....                                   | SA-1           |

## **INVITATION FOR BIDS**

Sealed bids shall be accepted by the City of Rock Island at the Office of the City Engineer until 9:00 a.m. Tuesday, April 19, 2016, on the following project:

**25<sup>th</sup> Avenue Resurfacing  
12<sup>th</sup> Street to 17<sup>th</sup> Street  
Job No. 2770**

An electronic copy of the specifications, proposals and drawings may be obtained from the Office of the City Engineer, Public Works Facility, 1309 Mill Street, Rock Island, Illinois 61201, Telephone: (309) 732-2200. They may also be electronically downloaded from the City's website at: <http://www.rigov.org/bids.aspx>

A hard copy set of the plans and specifications can be obtained at the above address for a non-refundable fee of \$35.00.

The Contractor will be responsible for complying with all local, state, and federal regulations pertaining to this project including the State of Illinois law relating to prevailing wage and preference to citizens on public works.

The City of Rock Island is committed to preserving equal rights for all of its citizens during the construction of its public works projects and encourages minority contractors to submit bids for this work. The City also encourages bidders to consider hiring subcontractors and employees of all racial and ethnic backgrounds.

The City reserves the right to reject any or all bids and to waive informalities or technicalities.



---

Michael J. Kane, P.E.  
City Engineer

# INSTRUCTIONS TO BIDDERS

## Plan and Proposal Documents Prepared by:

The City of Rock Island - Engineering Division  
1309 Mill Street  
Rock Island, Illinois 61201-3226

## The Proposal to be Submitted Before:

Tuesday, April 19<sup>th</sup>, 2016 at 9:00 a.m.

## Proposal Items to be Signed and/or Filled in:

1. Proposal Form ..... P-1 to P-3
2. Schedule of Prices ..... BP-1 and BP-2
3. Proposal Guaranty (Bid Bond, Bank Draft, Bank Cashier's Check, Certified Check, or completion of the City of Rock Island Proposal Bid Bond Form) ..... P-2 or BB-3

## Completion Date:

Friday, July 15<sup>th</sup>, 2016.

## Specifications:

This contract shall be in accordance with the ***“Standard Specifications for Road and Bridge Construction,”*** adopted April 1, 2016; the ***“Supplemental Specifications and Recurring Special Provisions”*** as indicated on the Check Sheet, adopted April 1, 2016; and the ***Special Provisions*** contained within these contract documents.

## Performance, Labor, Material and Maintenance Bond

The successful Bidder shall be required to provide a Performance, Labor, Material and Maintenance Bond on the form included in these specifications.

**SPECIAL PROVISIONS**

TABLE OF CONTENTS

|  |                |
|--|----------------|
| SP-1. General .....  | PG-2           |
| SP-2. Equal Employment Opportunity Policy.....   | PG-2           |
| SP-3. Illinois Laws Relating to Prevailing Wage and Preference to Illinois Citizens..... | PG-3           |
| SP-4. City of Rock Island Ordinances Relating to Storm Water.....                        | PG-4           |
| SP-5. Insurance .....  | PG-6           |
| SP-6. Substance Abuse Prevention Program.....  | PG-6           |
| SP-7. Construction Debris .....  | PG-6           |
| SP-8. Description of Work .....  | PG-7           |
| SP-9. Refuse Collection.....   | PG-7           |
| SP-10. Earth Excavation.....   | PG-7           |
| SP-11. Pavement Removal (PCC Milling) .....  | PG-8           |
| SP-12. Pavement Removal .....  | PG-8           |
| SP-13. Portland Cement Concrete Pavement (jointed), 7" (With Integral Curb).....         | PG-8           |
| SP-14. Combination Curb and Gutter Removal.....  | PG-9           |
| SP-15. Curb, of the Type Specified .....   | PG-9           |
| SP-16. Driveway Pavement Removal.....  | PG-10          |
| SP-17. Geotechnical Fabric for Ground Stabilization .....                                | PG-10          |
| SP-18. Hot-Mix Asphalt Binder Course, IL-9.5, N50, 1- <sup>1/2</sup> ".....              | PG-10          |
| SP-19. Hot-Mix Asphalt Surface Course, IL-9.5, N50, 1- <sup>1/2</sup> ".....             | PG-11          |
| SP-20. Mixture, for Cracks, Joints, and Flangeways .....                                 | PG-12          |
| SP-21. Area Reflective Crack Control .....   | PG-12          |
| SP-22. Aggregate Base Course, Type A .....   | PG-12          |
| SP-23. Portland Cement Concrete Residential Driveway, 6".....                            | PG-13          |
| SP-24. Sidewalk Removal .....  | PG-13          |
| SP-25. Portland Cement Concrete Sidewalk, 5".....  | PG-14          |
| SP-26. Portland Cement Concrete Sidewalk, 6" (Pedestrian Curb Ramp) .....                | PG-14          |
| SP-27. Catch Basin, to be Adjusted with Type C Grate .....                               | PG-15          |
| SP-28. Catch Basin, to be Adjusted .....   | PG-16          |
| SP-29. Manholes, to be Adjusted with New Frame Grate & Lid.....                          | PG-16          |
| SP-30. Manholes, to be Adjusted .....  | PG-17          |
| SP-31. Valve Box, to be Adjusted.....  | PG-18          |
| SP-32. Domestic Water Valve Box, to be Adjusted.....                                     | PG-18          |
| SP-33. Removing Water Manholes .....   | PG-19          |
| SP-34. Sodding.....  | PG-19          |
| SP-35. Trench Backfill.....  | PG-20          |
| SP-36. Project Signs.....  | PG-20          |
| SP-37. Traffic Control and Protection .....  | PG-20          |
| Check Sheet for Supplemental Specifications & Recurring Special Provisions .....         | PG-22 to PG-23 |

## **SPECIAL PROVISIONS**

### **SP-1. GENERAL**

The following Special Provisions supplement: “*Standard Specifications for Road and Bridge Construction*”, adopted April 1, 2016; “*Supplemental Specifications and Recurring Special Provisions*,” indicated on the Check Sheet, adopted April 1, 2016; and “*Standard Specifications for Water and Sewer Main Construction in Illinois*”, adopted July, 2010. The *Special Provisions* included herein shall apply to and govern the proposed improvement designated as:

**17<sup>th</sup> Street Resurfacing  
12<sup>th</sup> Street to 17<sup>th</sup> Street  
City of Rock Island  
Job No. 2770**

In case of conflict with any part or parts of said specifications, said special provisions shall take precedent and shall govern.

### **SP-2. EQUAL EMPLOYMENT OPPORTUNITY POLICY**

Federal and State laws prohibit discrimination against any employee or applicant for employment because of race, creed, color, national origin, sex, political affiliation, age and physical or mental handicap unrelated to ability. They further require elimination of discrimination in employment with regards to upgrading, demotion, transfer, recruitment, advertising, layoff, termination, rates of pay, forms of compensation, selection for training (including apprenticeship) of employees, as well as any other personnel actions.

- A. The Contractor agrees to post Equal Employment Opportunity notices in conspicuous places (e.g. at company headquarters, around time clocks, at work sites, on company bulletin boards, in lunchrooms) available to employees and applicants for employment.
- B. The Contractor shall in all solicitation or advertisements for employees to be hired under this contract state that all qualified applicants will receive consideration for employment without regard to race, color, creed, religion, sex, national origin, political affiliation, or age.



**SP-3. ILLINOIS LAWS RELATING TO PREVAILING WAGE AND PREFERENCE TO ILLINOIS CITIZENS**

- A. *Illinois Prevailing Wage Act*: This contract calls for the construction of a “public work,” within the meaning of the Illinois Prevailing Wage Act, 820 ILCS 130/.01 et seq. (“the Act”). The Act requires contractors and subcontractors to pay laborers, workers and mechanics performing services on public works projects no less than the “prevailing rate of wages” (hourly cash wages plus fringe benefits) in the county where the work is performed. For information regarding current prevailing wage rates, please refer to the Illinois Department of Labor’s website at:

<http://www.illinois.gov/idol/Laws-Rules/CONMED/Pages/Rates.aspx>

All contractors and subcontractors rendering services under this contract must comply with all requirements of the Act, including but not limited to, all wage, notice and record keeping duties. The scale of wages shall be posted by the Contractor in prominent and easily accessible places at the site of work. If the Department of Labor revises the wage rates, the revised rate shall apply to this contract and the contractor or subcontractor will not be allowed additional compensation on account of said revisions. Contractor shall continually check the scale of wages during the work and update the posted documents as needed. The monitoring and posting of rates by Contractor shall be included in the contract and not measured or paid separately.

- B. The Contractor and each subcontractor shall “Make and keep, for a period of not less than 5 years from the date of the last payment on a contract or subcontract for public works, records of all laborers, mechanics, and other workers employed by them on the project; the records shall include each worker's name, address, telephone number when available, social security number, classification or classifications, the worker’s gross and net wages paid in each pay period, the number of hours worked each day, and the starting and ending times of work each day, the worker’s starting and ending times of work each day, the worker’s hourly wage rate, the worker’s hourly overtime wage rate, the worker’s hourly fringe benefit rates, the name and address of each fringe benefit fund, the plan sponsor of each fringe benefit, if applicable, and the plan administrator of each fringe benefit, if applicable;”

Prior to the City making payment, the Contractor shall “No later than the fifteenth day of each calendar month file a certified payroll for the immediately preceding month with the City. A certified payroll must be filed for only those calendar months during which construction has occurred. The certified payroll

shall consist of a complete copy of the records identified above, but may exclude the starting and ending times of work each day.

The certified payroll shall be accompanied by a statement signed by the Contractor or subcontractor or an officer, employee, or agent of the Contractor or subcontractor which avers that: (i) he or she has examined the certified payroll records required to be submitted by the Act and such records are true and accurate; (ii) the hourly rate paid to each worker is not less than the general prevailing rate of hourly wages required by this Act; and (iii) the contractor or subcontractor is aware that filing a certified payroll that he or she knows to be false is a Class A misdemeanor. The submittal and any additional requests for a certified payroll shall be included in the contract and not measured or paid separately.

- C. *Illinois Preference Act*: Whenever there is a period of excessive unemployment in Illinois, which is defined herein as any month immediately following two (2) consecutive calendar months during which the level on unemployment in the State of Illinois has exceeded 5% as measured by the United States Bureau of Labor Statistics in its monthly publication of employment and unemployment figures, the Contractor shall employ only Illinois laborers. "Illinois laborer" means any person who has resided in Illinois for at least thirty-days (30) and intends to remain and Illinois resident.

Other laborers may be used when Illinois laborers as defined herein are not available, or are incapable of performing the particular type of work involved, if so certified by the Contractor and approved by the Engineer. The Contractor may place no more than three (3) of his regularly employed non-resident executives and technical experts, who do not qualify as Illinois laborers, to do work encompassed by the Contract during periods of excessive unemployment.

#### **SP-4. CITY OF ROCK ISLAND ORDINANCES RELATING TO STORM WATER**

The Contractor shall take sufficient precautions to prevent the pollution of streams, lakes, wetlands and storm sewers in accordance with Article 107.23 of the Standard Specifications and the City of Rock Island's storm-water ordinance. A City of Rock Island Grading and Drainage Permit shall be obtained for this project.

Waste disposal, solid waste, industrial waste, yard waste and any other pollutants of waste on any construction site shall be controlled through the use of Best Management Practices (BMP's). Waste or recycling containers shall be provided and maintained by the Contractor on construction sites where there is the potential for release of waste.

Uncontained waste, or other stockpiled materials, that may blow, wash or otherwise be released from the site is prohibited.

Portland cement concrete, or any materials resulting from the cleaning of vehicles or equipment containing or used in transporting, or placing PCC or ACC concrete shall not be allowed on construction sites, or into any storm drain, catch basin or stream, unless an disposal site within the construction limits is approved of by the Engineer.

BMP's shall be implemented to prevent the release of sediment from construction sites. Disturbed areas shall be minimized, disturbed soil managed and construction site entrances managed to prevent sediment tracking. Excessive sediment tracked onto public streets shall be removed immediately.

The Engineer shall approve all BMP's and any other measures required to meet the above regulations.

To insure a prompt response to incidents involving storm water runoff, the Contractor shall provide a telephone number where a responsible individual can be contacted 24 hours a day.

When the Engineer is notified, or determines a storm water deficiency exists, the Engineer will notify and direct the Contractor to correct the deficiency within a specified time. The specified time, which begins upon notification to the Contractor, will be from ½ hour to 12 hours based upon the urgency of the situation and the nature of the deficiency. The Engineer shall be the sole judge. The deficiency may be any lack of repair, maintenance or non-compliance with the storm water control plan or the City's Storm Water Ordinance.

If the Contractor fails to correct the deficiency within the specified time, a daily monetary deduction will be imposed for each calendar day, or fraction thereof the deficiency exists. The calendar day(s) will begin with notification to the Contractor and end with the Engineer's acceptance of the correction. The daily monetary deduction will be either \$1,000 or 0.05% of the awarded contract value whichever is greater.

In addition, if the Contractor fails to respond, the Engineer may correct the deficiency and the cost thereof will be deducted from monies due or which may become due the Contractor. This corrective action will in no way relieve the Contractor of their contractual requirements of responsibilities.

Costs, including a \$10 permit fee, for adhering to *CITY OF ROCK ISLAND ORDINANCES RELATING TO STORM WATER*, shall be included with pavement replacement items.

#### **SP-5. INSURANCE**

The Contractor shall obtain and keep in force the insurance coverage specified in Article 107.27 of the Standard Specifications. The insurance coverage shall name the City of Rock Island, its officers and employees as additional insured with respect to the liability coverage. Certified copies of the original policies or certificate(s) of insurance, by the insurer(s) issuing the policies and endorsements shall be submitted to the City prior to the beginning of the work. All costs for insurance specified therein shall be incidental to this contract.

#### **SP-6. SUBSTANCE ABUSE PREVENTION PROGRAM**

In addition to all other labor requirements set forth in this proposal and in the Standard Specification for Road and Bridge Construction, adopted by the Department, during the performance of this contract, the Contractor for itself, its assignees, and successors in interest (hereinafter referred to as the "Contractor") agrees as follows:

Substance Abuse Prevention Program, Public Act 95-0635. Before the Contractor and any Subcontractor commences work, the Contractor and any Subcontractor shall have in place a written Substance Abuse Prevention Program for the prevention of substance abuse among its employees which meets or exceeds the requirements in Public Act 95-0635 or shall have a collective bargaining agreement in effect dealing with the subject matter of P. A. 95-0635.

The Contractor and any Subcontractor shall file with the public body engaged in the construction of the public works: a copy of the substance abuse prevention program along with a cover letter certifying that their program meets the requirements of the Act, or a letter certifying that the Contractor or a Subcontractor has a collective bargaining agreement in effect dealing with the subject matter of this Act.

#### **SP-7. CONSTRUCTION DEBRIS**

The Contractor shall not conduct any generation, transportation, or recycling of construction or demolition debris, clean or general or uncontaminated soil generated during construction, remodeling, repair, and demolition of utilities, structures and roads that is not commingled with any waste, without the maintenance of documentation identifying the hauler, generator, place of origin of the debris or soil, the weight or volume of the debris or soil, and the location, owner, and operator of the facility where

the debris of soil was transferred, disposed, recycled or treated. The Contractor must maintain this documentation for a period of at least 3 years.

#### **SP-8. DESCRIPTION OF WORK**

The proposed work is within the City of Rock Island on 25<sup>th</sup> Avenue from 12<sup>th</sup> Street to west of 17<sup>th</sup> Street and consists of milling existing asphalt cement concrete and overlaying with asphalt cement concrete. In addition to resurfacing of the street surface, construction shall include minor sewer construction and utility adjustments.

All construction and related paper work (including change orders and final quantities) shall respectively be completed by ***Friday, July 15, 2016***. Liquidated damages shall be assessed according to Article 108.09 of the Standard Specifications for any work that remains uncompleted after the above stated completion dates.

#### **SP-9. REFUSE COLLECTION**

Each Thursday, the Contractor shall collect the resident's refuse & recycling carts and place at a location outside of the construction limits agreed upon by the Contractor and City prior to the beginning of work. This work must be done prior to 7:30 A.M. Tuesday, every week even if the weather conditions preclude other work. Payment for this work shall be included in the contract and no extra compensation will be allowed.

#### **SP-10. EARTH EXCAVATION**

Earth excavation shall consist of the removal, disposal and compaction of earth excavated from underneath new pavements for subbase placement in accordance with Sections 202 and 301 of the Standard Specifications. Excavated material shall not be stockpiled on existing pavements and shall be removed without excess spillage.

If wet or otherwise unsuitable soils are encountered, the Engineer shall be notified to determine what remedial action shall be taken. The Contractor shall not request a compaction test until they are confident that the area being tested has sufficient density, 95% of the material's maximum standard Proctor dry density (ASTM D-698).

This work will be paid for at the contract unit price per cubic yard (yd<sup>3</sup>) of *EARTH EXCAVATION*, which price shall include hauling, and costs of compaction of the subgrade and disposal of the excavated material.

**SP-11. PAVEMENT REMOVAL (PCC MILLING)**

The existing Portland cement concrete shall be removed in accordance with the applicable portions of Section 440 of the Standard Specifications. The requirement of a milling machine having a 12' wide by 28" diameter drum shall be waived.

Surface removal shall extend from the curb line through the parking lane. Removal shall be no more than 3" in depth at the curb and be tapered to the existing asphalt surface at the drive lane as shown in plan. The PCC millings shall be properly disposed of by contractor.

Payment will be at the contract unit price per square yard (yd<sup>2</sup>) for *PAVEMENT REMOVAL (PCC MILLING)*, and disposal shall be considered incidental to this pay item.

**SP-12. PAVEMENT REMOVAL**

The removal of any pavements including brick pavement shall be performed in accordance with Section 440 of the Standard Specifications. Pavement removal shall be to existing joints if available, or saw cuts with a depth of one third ( $\frac{1}{3}$ ) the pavement thickness. The brick pavement shall be salvaged and stockpiled at the City's storage yard, 1309 Mill Street.

No additional compensation will be allowed to replace material excavated below the item being removed unless approved of by the Engineer. Any unapproved excavation shall be filled with aggregate base course at the Contractor's expense.

Payment will be at the contract unit price per square yard (yd<sup>2</sup>) for *PAVEMENT REMOVAL* which price shall include material disposal and saw cuts.

**SP-13. PORTLAND CEMENT CONCRETE PAVEMENT (JOINTED), 7" (WITH INTEGRAL CURB)**

Portland Cement Concrete (PCC) pavement (jointed), 7" (with integral curb) shall be constructed at the plan locations, or where required by the Engineer, in accordance with Section 420 of the Standard Specifications and the plan sheets. Concrete placed next to existing pavement shall be edged.

Longitudinal and transverse joints shall be installed to match existing joints, or as directed by the Engineer, with at least 12' and 15' maximum spacing, respectively. Expansion joints,  $\frac{1}{2}$ " thick, shall be placed at the plan locations or as directed by the Engineer. Joints shall be constructed and sealed in accordance with City of Rock Island (CRI) Standards 102, 103, 104, and 115.

The Contractor may substitute expansion tie anchors for deformed bars where they are required in longitudinal joints. Expansion anchor ties shall be internally threaded expanding anchors produced from cold finished low carbon steel of the AISI 1000 or 1200 series. Anchors shall be given a corrosion resistance coating of electrically deposited zinc followed by a clear chromate dip which meets or exceeds the requirements of U.S. Government Specification QQ-Z-325 Type II, Class 3. The anchor ties shall have a minimum pull out capacity of 7500 lbs. Expansion tie anchors shall be  $\frac{3}{4}$ " diameter and be installed into the vertical edge of the existing PCC pavement at its mid-depth on 30" centers. Individual anchor locations may be shifted at least 5" away from existing cracks, joints and unsound concrete. Installation shall conform to the manufacturer's recommendations.

This work will be paid for at the contract unit price per square yard (yd<sup>2</sup>) of *PORTLAND CEMENT CONCRETE PAVEMENT (JOINTED), 7" (WITH INTEGRAL CURB)*, which price shall include all required joints.

#### **SP-14. COMBINATION CURB & GUTTER REMOVAL**

This work shall be in accordance with Section 440 of the Standard Specifications. Curb & gutter shall be removed to existing joints if available or full depth saw cuts as directed by the Engineer.

It shall be the responsibility of the Contractor to protect items adjacent to the curb & gutter during the removal. These items typically include any adjacent curbs, driveways, intersecting sidewalks, light poles, fire hydrants, traffic light poles, landscaping walls, pavements and all other structures that are not scheduled for removal. The Contractor to the satisfaction of the Engineer shall repair any damaged items. No additional compensation will be allowed to replace any items damaged during removal, unless approved of by the Engineer prior to removal of the curb & gutter.

No additional compensation will be allowed to replace any material excavated from below the item being removed, unless approved of by the Engineer. The excavation shall be filled with crushed stone (IDOT Gradation CA-6) placed and compacted according to Section 301 of the Standard Specifications.

Payment shall be at the contract unit price per foot (ft) for *COMBINATION CURB & GUTTER REMOVAL*, which price shall include material disposal and full depth saw cuts.

#### **SP-15. CURB, OF THE TYPE AND KIND SPECIFIED**

Combination concrete curb & gutter shall be constructed according to Section 606 of the Standard Specifications and CRI Standard 105. All combination concrete curb & gutter

shall be the same thickness as the existing pavement, but in no case less than eight inches (8") of PCC shall be placed for gutter thickness.

This work will be paid for at the contract unit price per lineal foot for *Combination Concrete Curb & Gutter, Type M-6.18 (modified)*; to include all removal and disposal, material, equipment, and labor needed to construct the curb as described herein.

#### **SP-16. DRIVEWAY PAVEMENT REMOVAL**

Driveway pavement shall be removed to existing joints if available, or full depth saw cuts as directed by the Engineer in accordance with Section 440 of the Standard Specifications.

No additional compensation will be allowed to replace any material excavated from below the item being removed, unless approved of by the Engineer. The excavation shall be filled with crushed stone (IDOT Gradation CA-6) placed and compacted according to Section 301 of the Standard Specifications.

This work will be paid for at the contract unit price per square yard (yd<sup>2</sup>) for *DRIVEWAY PAVEMENT REMOVAL*, which price shall include material disposal and full depth saw cuts.

#### **SP-17. GEOTECHNICAL FABRIC FOR GROUND STABILIZATION**

This work shall consist of furnishing all materials and labor required to install geotechnical fabric for ground stabilization in accordance with the applicable portions of Section 210 of the Standard Specifications. The geotechnical fabric shall be placed as directed by the Engineer on the soil subgrade under all aggregate base course areas and extend 1' behind the proposed curb line and then 6" vertically in all directions.

Geotechnical fabric shall be measured in place, but the vertical portions of the fabric that extends upward at the outside edges of the aggregate and any overlaps will not be measured for payment. Payment will be made at the contract unit price per square yard (yd<sup>2</sup>) for *GEOTECHNICAL FABRIC FOR GROUND STABILIZATION*.

#### **SP-18. HOT-MIX ASPHALT BINDER COURSE, IL-9.5, N50, 1-1/2"**

Hot-mix asphalt binder course shall be in accordance with Section 406 of the Standard Specifications.



The following mixture requirements are applicable for all bituminous concrete binder courses on this project:

| <b>Mixture Uses</b>                     | <b>Binder</b>    |
|---|------------------|
| AC/PG                                   | PG 64-22         |
| Design Air Voids                        | 4.0 @ N50        |
| Mixture Composition (Gradation Mixture) | IL 9.5 or IL12.5 |
| Friction Aggregate                      | N/A              |

A mix design, with laboratory data, shall be submitted to the Engineer for approval before any bituminous concrete is placed.

In the event of sudden rain, the loading additional trucks shall immediately stop. Material in transit may be laid at the Contractor's risk providing the base course is free of standing water and the mixture's proper temperature is maintained. Approval to unload the trucks in transit shall not relax the requirements for quality, density or smoothness of the bituminous mixture being placed.

This work will be paid for at the contract unit price per ton (ton) for *HOT-MIX ASPHALT BINDER COURSE, IL-9.5, N50, 1-1/2"*, which price shall include all required equipment, QC/QA testing, material, and labor.

**SP-19. HOT-MIX ASPHALT SURFACE COURSE, IL-9.5, N50, 1-1/2"**

Hot-mix asphalt surface course shall be in accordance with Section 406 of the Standard Specifications.

The following mixture requirements are applicable for all bituminous concrete surface courses on this project:

| <b>Mixture Uses</b>                     | <b>Binder</b>     |
|---|-------------------|
| AC/PG                                   | PG 64-22          |
| Design Air Voids                        | 4.0 @ N50         |
| Mixture Composition (Gradation Mixture) | IL 9.5 or IL 12.5 |
| Friction Aggregate                      | D Surface         |

A mix design, with laboratory data, shall be submitted to the Engineer for approval before any bituminous concrete is placed.

In the event of sudden rain, the loading additional trucks shall immediately stop. Material in transit may be laid at the Contractor's risk providing the base course is free of standing water and the mixture's proper temperature is maintained. Approval to unload the trucks in transit shall not relax the requirements for quality, density or smoothness of the bituminous mixture being placed.

This work will be paid for at the contract unit price per ton (ton) for *HOT-MIX ASPHALT SURFACE COURSE, IL-9.5, N50, 1-½"*, which price shall include all required equipment, QC/QA testing, material, and labor.

#### **SP-20. MIXTURE FOR CRACKS, JOINTS, AND FLANGEWAYS**

Mixture for cracks, joints, and flangeways shall be placed according to the applicable portions of Section 406 of the Standard Specifications. All open cracks, joints and flangeways shall be cleaned prior to filling completely with mixture for cracks, joints, and flangeways.

Payment for this item will be the contract unit price per ton (ton) for *MIXTURE FOR CRACKS, JOINTS, AND FLANGEWAYS*, which price shall include cleaning cracks and joints.

#### **SP-21. AREA REFLECTIVE CRACK CONTROL**

Area reflective crack control shall be installed on clean pavement in accordance with Section 443 of Standard Specifications.

The area reflective crack control shall cover all joints and any cracks designated by the Engineer. Fabric shall be sufficiently bonded to the base course prior to placing prime coat. The Contractor, at their expense, prior to overlaying, shall replace any damaged fabric.

This work shall be paid at the contract unit price per square yard (yd<sup>2</sup>) of *AREA REFLECTIVE CRACK CONTROL*.

#### **SP-22. AGGREGATE BASE COURSE, TYPE A, CA-6**

Aggregate base course, type A shall be constructed according to Section 351 of the Standard Specifications. This material shall be a crushed limestone that meets the

requirements for IDOT Gradation CA-6 and be compacted to 100 % of the material's maximum standard Proctor density (ASTM D-698).

Payment will be made at the contract unit price per ton (Ton) of *AGGREGATE BASE COURSE, TYPE A, CA-6*, which price shall include hauling, placement and compaction.

**SP-23. PORTLAND CEMENT CONCRETE DRIVEWAY PAVEMENT, 6"**

PCC pavement shall be constructed according to Section 423 of the Standard Specifications and CRI Standard 106 or 107. Driveway shall be at least eight (6") inches thick.

Expansion joints one half inch ( $\frac{1}{2}$ " ) thick shall be placed wherever driveways abut intersecting curbs, sidewalks and fire hydrants. Expansion joints shall consist of preformed joint filler placed with the top of the joint one-quarter inch ( $\frac{1}{4}$ " ) below the driveway's surface. Joints that abut curbing shall be sealed with an approved joint sealant.

This work will be paid for at the contract unit price per square yard *PORTLAND CEMENT CONCRETE DRIVEWAY PAVEMENT, 6"*, which price shall include all required expansion joints, topsoil and grass seed.

**SP-24. SIDEWALK REMOVAL**

This work shall be in accordance with Section 440 of the Standard Specifications. Sidewalk removal shall be to existing joints if available, or full depth saw cuts as directed by the Engineer.

No additional compensation will be allowed to replace any material excavated from below the item being removed, unless approved of by the Engineer. The excavation shall be filled with crushed stone (IDOT Gradation CA-6) placed and compacted according to Section 301 of the Standard Specifications.

This work will be paid for at the contract unit price per square foot (ft<sup>2</sup>) of *SIDEWALK REMOVAL*, which price shall include material disposal and full depth saw cuts.

#### **SP-25. PORTLAND CEMENT CONCRETE SIDEWALK, 5"**

PCC sidewalk, 5" shall be constructed at the plan locations, and where required by the Engineer, in accordance with Section 424 of the Standard Specifications and CRI Standard 108.

Expansion joints ½" thick shall be placed where sidewalks abut curbs, driveways, intersecting sidewalks, light poles, fire hydrants, traffic light poles and all other structures. Expansion joints shall consist of preformed joint filler placed with the top of the joint ¼" below the sidewalk's surface. Where the sidewalk is constructed beside pavements or curbing having expansion joints, the expansion joints in the sidewalk shall be placed opposite the existing expansion joint as nearly as possible.

This work will be paid for at the contract unit price per square foot (ft<sup>2</sup>) for *PORTLAND CEMENT CONCRETE SIDEWALK, 5"*, which price shall include all required joints.

#### **SP-26. PORTLAND CEMENT CONCRETE SIDEWALK, 6" (PEDESTRIAN CURB RAMP)**

Where required by the Engineer, PCC sidewalk, 6" (pedestrian curb ramps) shall be installed in accordance with *Section 424 of the Standard Specifications* and *CRI Standard 109A*. PCC curb ramps shall be at least 6" thick. Where the ramp intersects the curb at an angle of 60° or less, two #4 reinforcing bars shall be placed as shown on *CRI Standard 109A*. The reinforcing bars shall be 30" in length.

Wherever the ramp abuts the curb, expansion joints ½" thick shall be placed. Expansion joints shall consist of preformed joint filler placed with the top of the joint ¼" below the ramp's surface. Joints that abut curbing shall be sealed with an approved joint sealant.

A vitrified polymer composite (VCP) warning tile, cast iron detectable warning plate, or high strength concrete panel with truncated domes shall be installed in the ramp as shown on *CRI Standard 109A* and according to individual manufacture's specifications. The tile, plate or panel shall be brick red in color or cast gray iron. Warning tiles shall be ***Engineered Plastics, Inc Armor Tile***, or approved equal. Cast iron detectable warning plates shall be ***Neenah Foundry Company Component No: 4984-0001***, or approved equal. High strength concrete panels shall be ***CASTinTact Detectable Warning Panel***, or approved equal.

This work will be paid for at the contract unit price per square foot (ft<sup>2</sup>) for *PORTLAND CEMENT CONCRETE SIDEWALK, 6" (PEDESTRIAN CURB RAMP)*, which price shall include all reinforcing steel, tactile/detectable warning tiles/plates/panel and joints.

**SP-27. CATCH BASIN, TO BE ADJUSTED, AS SPECIFIED WITH TYPE C GRATE**

This work shall include adjusting catch basins to grade in accordance with Section 602 of the Standard Specifications, Section 33 of the Standard Specifications for Water and Sewer Main Construction in Illinois, and CRI Standard 205.

Existing pavement shall be saw cut and removed for a distance not exceeding 12" outside the base of the frame.

Catch basins adjusted within rigid pavements shall require portland cement concrete to be placed to match adjacent pavement thickness and shall be considered incidental to the adjustment work. All pavements that are within the curb and gutter areas shall be finished smooth and even, and given a light brush finish while the concrete is still workable.

Catch basins adjusted within flexible pavements shall require Class SI concrete to be placed to the top of the binder course in accordance with Article 602.10(c) of the Standard Specification, or as directed by the Engineer, and shall be considered incidental to the adjustment work.

Expansion tie anchors shall be used to tie new pavement to existing PCC pavements and shall be considered incidental to the adjustment work. For adjustments that are adjacent to the placement of new pavement, the reinforcement shall be as shown in CRI Standard 204.

The new frame and grate shall be stamped with "*DUMP NO WASTE, DRAINS TO RIVER*" and be one of the following:

- \* ***Neenah Foundry Co; Model No. R-3290 with type C grate,***
- \* ***East Jordan Iron Works; Model No. 7030 with type M2 grate and type T1 back,***
- \* ***Or approved equal.***

This work shall be paid for at the contract unit price each (EACH) for *CATCH BASINS TO BE ADJUSTED WITH NEW FRAME & TYPE C GRATE, SINGLE, OR CATCH BASINS TO BE ADJUSTED WITH NEW FRAME & TYPE C GRATE, DOUBLE* which price shall include all necessary labor and materials.

**SP-28. CATCH BASIN, TO BE ADJUSTED**

This work shall include adjusting catch basins to grade in accordance with Section 602 of the Standard Specifications, Section 33 of the Standard Specifications for Water and Sewer Main Construction in Illinois, and CRI Standard 205.

Existing pavement shall be saw cut and removed for a distance not exceeding 12" outside the base of the frame.

Catch basins adjusted within rigid pavements shall require portland cement concrete to be placed to match adjacent pavement thickness and shall be considered incidental to the adjustment work. All pavements that are within the curb and gutter areas shall be finished smooth and even, and given a light brush finish while the concrete is still workable.

Catch basins adjusted within flexible pavements shall require Class SI concrete to be placed to the top of the binder course in accordance with Article 602.10(c) of the Standard Specification, or as directed by the Engineer, and shall be considered incidental to the adjustment work.

Expansion tie anchors shall be used to tie new pavement to existing PCC pavements and shall be considered incidental to the adjustment work. For adjustments that are adjacent to the placement of new pavement, the reinforcement shall be as shown in CRI Standard 204.

Work will be paid for at the contract unit price each (each) for *CATCH BASIN, TO BE ADJUSTED*, which price shall include all required labor and materials.

**SP-29. MANHOLES TO BE ADJUSTED WITH NEW FRAME GRATE & LID**

Manholes shall be adjusted to grade at the plan locations according to Section 602 of the Standard Specifications, Section 32 of the Standard Specifications for Water and Sewer Main Construction in Illinois, CRI Standards 201 and 305, and the plan sheets.

After the completion of paving operations, manholes' frames and lids shall be flush with the new pavement (within  $\pm \frac{1}{8}$ "). Any manholes that are found to be  $\frac{1}{8}$ " higher/lower than the surrounding pavement shall be readjusted by the contractor in accordance with this special provision, until they are flush with the pavement. All costs associated with readjustment of castings shall be at the Contractor's expense.

Existing pavement shall be saw cut and removed for a distance not exceeding 12" outside the base of the frame.

Manholes adjusted within rigid pavements shall require portland cement concrete to be placed to match adjacent pavement thickness and shall be considered incidental to the adjustment work. All surface pavements within the curb and gutter, driveway, or sidewalk shall be finished smooth and even, and given a light brush finish while the concrete is still workable.

Manholes adjusted within flexible pavements shall require Class SI concrete to be placed to the top of the binder course in accordance with Article 602.10(c) of the Standard Specification, or as directed by the Engineer, and shall be considered incidental to the adjustment work.

$\frac{3}{4}$ " expansion tie anchors shall be used to tie new pavement to existing PCC pavements and shall be considered incidental to the adjustment work. For adjustments that are adjacent to the placement of new pavement, the reinforcement shall be as shown in CRI Standard 305.

Manholes shall be fitted with new frames and lids and be one of the following:

- ***Neenah Foundry Co; Model No. R-1713 with a solid self-sealing lid,***
- ***East Jordan Iron Works; Model No. 1050 EXHD with a solid self-sealing lid,***
- ***Or approved equal.***

Payment shall be at the contract unit price each (each) for the following:

- ***MANHOLES TO BE ADJUSTED WITH NEW FRAME AND GRATE OR LID*** which price includes salvage and transportation of frames and lids.

### **SP-30. MANHOLES TO BE ADJUSTED**

Manholes shall be adjusted to grade at the plan locations according to Section 602 of the Standard Specifications, Section 32 of the Standard Specifications for Water and Sewer Main Construction in Illinois, CRI Standards 201 and 305, and the plan sheets.

After the completion of paving operations, manholes' frames and lids shall be flush with the new pavement (within  $\pm \frac{1}{8}$ "). Any manholes that are found to be  $\frac{1}{8}$ " higher/lower than the surrounding pavement shall be readjusted by the contractor in accordance with this special provision, until they are flush with the pavement. All costs associated with readjustment of castings shall be at the Contractor's expense.

Existing pavement shall be saw cut and removed for a distance not exceeding 12" outside the base of the frame.

Manholes adjusted within rigid pavements shall require portland cement concrete to be placed to match adjacent pavement thickness and shall be considered incidental to the adjustment work. All surface pavements within the curb and gutter, driveway, or sidewalk shall be finished smooth and even, and given a light brush finish while the concrete is still workable.

Manholes adjusted within flexible pavements shall require Class SI concrete to be placed to the top of the binder course in accordance with Article 602.10(c) of the Standard Specification, or as directed by the Engineer, and shall be considered incidental to the adjustment work.

$\frac{3}{4}$ " expansion tie anchors shall be used to tie new pavement to existing PCC pavements and shall be considered incidental to the adjustment work. For adjustments that are adjacent to the placement of new pavement, the reinforcement shall be as shown in CRI Standard 305.

Payment shall be at the contract unit price each (each) for *MANHOLES TO BE ADJUSTED*, which price includes salvage and transportation of frames and lids.

#### **SP-31. VALVE BOX, TO BE ADJUSTED**

Valve boxes shall be adjusted at the plan locations, or where required by the engineer, in accordance with Division IV of the Standard Specifications for Water and Sewer Main Construction.

Valve boxes that are found to be  $\frac{1}{8}$ " higher/lower than the surrounding pavement shall be readjusted in accordance with this special provision, until they are flush with the pavement. All costs associated with readjustment of castings shall be at the Contractor's expense.

This work shall be paid for at the contract unit price each (ea.) for *VALVE BOX, TO BE ADJUSTED*, which price shall include all required labor and materials.

#### **SP-32. DOMESTIC WATER VALVE BOX, TO BE ADJUSTED**

Domestic water valve boxes shall be adjusted at the plan locations, or where required by the engineer, in accordance with City of Rock Island Standards 303 and 305, and Division IV of the Standard Specifications for Water and Sewer Main Construction and City of Rock Island.

Valve boxes that are found to be  $\frac{1}{8}$ " higher/lower than the surrounding pavement shall be readjusted in accordance with this special provision, until they are flush with the



pavement. All costs associated with readjustment of castings shall be at the Contractor's expense.

This work shall be paid for at the contract unit price each (ea.) for DOMESTIC WATER VALVE BOX, TO BE ADJUSTED, which price shall include all required labor and materials.

### **SP-33. REMOVING WATER MANHOLE**

Manholes shall be removed at the plan locations in accordance with City of Rock Island Standard 304, Section 605 of the Standard Specifications, and the plan sheets to be replaced with a valve box. Manhole frames and covers shall be salvaged, transported and stockpiled by the Contractor at the City's the storage yard at 2300 15<sup>th</sup> Avenue by the Contractor.

Valve boxes shall be the following:

- \* ***Tyler 6860-DD complete with #6 base or equivalent,***
- \* ***Or approved equal.***

Bottom section for valve box shall have slots for installation on #6 bases. Valve box lids must be marked "Water".

The Contractor shall install valve boxes upon the valve with the use of a ***Valve Box Adaptor II as manufactured by Adaptor, Inc. or an approved equal.*** The adaptor shall be installed in accordance with the manufacturer's specifications in lieu of hardwood blocking and shall be incidental to the valve and box installation. The valve box shall be considered incidental to the water manhole removal.

This work shall be paid for at the contract unit price each (each) for ***REMOVING MANHOLES***, which price shall include salvage and transportation of the frame and lid.

### **SP-34. SODDING**

Sod placement shall consist of preparing the ground surface, placing sod and watering the sod according to Section 252 of Standard Specifications. Prior to placing sod, the ground surface shall be worked, watered and fertilized according to Article 252.03 of the Standard Specifications. Water shall be applied to the sod with a spray application in accordance with Article 252.08.

Sod shall be in a live, healthy condition and knitted to the soil to be acceptable. All unacceptable sod shall be removed, replaced and/or watered at the Engineer's direction.

Payment shall be at the contract unit price per square yard (yd<sup>2</sup>) for *SODDING*, which price shall include all required fertilizer, materials and watering.

### **SP-35. PROJECT SIGNS**

Project signs shall be painted and placed in accordance with Section 720 of the Standard Specifications and the detail shown in the plans. The Engineer prior to construction shall approve sign materials. The signs shall be painted white with blue letters and the signboard shall be 5' long x 3' wide.

The signs shall be mounted on Type III barricades at each end of the project with exact locations determined in the field.

Payment will be at the contract unit price each (each) for *PROJECT SIGNS*, which price shall include all required labor and materials.

### **SP-36. TRAFFIC CONTROL AND PROTECTION**

Traffic control shall be in accordance with Section 700 of the Standard Specifications, all applicable guidelines in the Illinois Manual on Uniform Traffic Control Devices for Streets and Highways, these Special Provisions, and the details and standards contained in the plans.

Special attention is called to Articles 107.09 and 107.14 of the Standard Specifications for Road and Bridge Construction and the following:

- Standards 701901-01 sheets 1 thru 3, Standard 701501-06, Standard 701606 sheets 1 and 2 and Standard 701801-04 as shown in plan;
- All barricades to be left overnight shall be equipped with working flashing lights;
- Access to fire hydrants, catch basins, side streets and alleys shall be maintained whenever possible;

The Contractor shall provide, erect and maintain the required barricades and signs to protect the work and public in accordance with the proper traffic control standard. This work shall be done with minimal inconvenience and safety hazards to the public. If the traffic control at any location is inadequate, and the Contractor is unable to correct the problem, the City will make all necessary corrections. These costs will be billed to the Contractor.

At the pre-construction meeting, the Contractor shall furnish the name of an individual in their direct employ who is to be responsible for the installation and maintenance of traffic

control. If the installation and maintenance are to be accomplished by a subcontractor, consent shall be requested of the Engineer at the time of the pre-construction meeting in accordance with Article 108.01 of the Standard Specifications. This shall not relieve the Contractor of the foregoing requirement for a responsible individual in his direct employ.

Payment will be at the contract lump sum price (L.S.) for *TRAFFIC CONTROL & PROTECTION*, which price shall include all necessary labor, signage and barricades and their removal.

CHECK SHEET  
FOR  
RECURRING SPECIAL PROVISIONS

Adopted April 1, 2016

The following RECURRING SPECIAL PROVISIONS indicated by an "X" are applicable to this contract and are included by reference:

| <u>CHECK SHEET #</u> | <u>RECURRING SPECIAL PROVISIONS</u>   | <u>PAGE NO.</u> |
|----------------------|---|-----------------|
| 1                    | <input type="checkbox"/> Additional State Requirements for Federal-Aid Construction Contracts         | 1               |
| 2                    | <input type="checkbox"/> Subletting of Contracts (Federal-Aid Contracts)                              | 4               |
| 3                    | <input type="checkbox"/> EEO  | 5               |
| 4                    | <input type="checkbox"/> Specific EEO Responsibilities Non Federal-Aid Contracts                      | 15              |
| 5                    | <input type="checkbox"/> Required Provisions - State Contracts  | 20              |
| 6                    | <input type="checkbox"/> Asbestos Bearing Pad Removal   | 26              |
| 7                    | <input type="checkbox"/> Asbestos Waterproofing Membrane and Asbestos Hot-Mix Asphalt Surface Removal | 27              |
| 8                    | <input type="checkbox"/> Temporary Stream Crossings and In-Stream Work Pads                           | 28              |
| 9                    | <input type="checkbox"/> Construction Layout Stakes Except for Bridges                                | 29              |
| 10                   | <input type="checkbox"/> Construction Layout Stakes   | 32              |
| 11                   | <input type="checkbox"/> Use of Geotextile Fabric for Railroad Crossing                               | 35              |
| 12                   | <input type="checkbox"/> Subsealing of Concrete Pavements   | 37              |
| 13                   | <input type="checkbox"/> Hot-Mix Asphalt Surface Correction   | 41              |
| 14                   | <input type="checkbox"/> Pavement and Shoulder Resurfacing  | 43              |
| 15                   | <input type="checkbox"/> Patching with Hot-Mix Asphalt Overlay Removal                                | 44              |
| 16                   | <input type="checkbox"/> Polymer Concrete   | 45              |
| 17                   | <input type="checkbox"/> PVC Pipeliner  | 47              |
| 18                   | <input type="checkbox"/> Bicycle Racks  | 48              |
| 19                   | <input type="checkbox"/> Temporary Portable Bridge Traffic Signals                                    | 50              |
| 20                   | <input type="checkbox"/> Work Zone Public Information Signs   | 52              |
| 21                   | <input type="checkbox"/> Nighttime Inspection of Roadway Lighting                                     | 53              |
| 22                   | <input type="checkbox"/> English Substitution of Metric Bolts   | 54              |
| 23                   | <input type="checkbox"/> Calcium Chloride Accelerator for Portland Cement Concrete                    | 55              |
| 24                   | <input type="checkbox"/> Quality Control of Concrete Mixtures at the Plant                            | 56              |
| 25                   | <input type="checkbox"/> Quality Control/Quality Assurance of Concrete Mixtures                       | 64              |
| 26                   | <input type="checkbox"/> Digital Terrain Modeling for Earthwork Calculations                          | 80              |
| 27                   | <input type="checkbox"/> Pavement Marking Removal   | 82              |
| 28                   | <input type="checkbox"/> Preventive Maintenance – Bituminous Surface Treatment                        | 83              |
| 29                   | <input type="checkbox"/> Preventive Maintenance – Cape Seal   | 89              |
| 30                   | <input type="checkbox"/> Preventive Maintenance – Micro-Surfacing                                     | 104             |
| 31                   | <input type="checkbox"/> Preventive Maintenance – Slurry Seal   | 115             |
| 32                   | <input type="checkbox"/> Temporary Raised Pavement Markers  | 125             |
| 33                   | <input type="checkbox"/> Restoring Bridge Approach Pavements Using High-Density Foam                  | 126             |

CHECK SHEET  
FOR  
LOCAL ROADS AND STREETS RECURRING SPECIAL PROVISIONS

Adopted April 1, 2016

The following LOCAL ROADS AND STREETS RECURRING SPECIAL PROVISIONS indicated by an "X" are applicable to this contract and are included by reference:

LOCAL ROADS AND STREETS RECURRING SPECIAL PROVISIONS

| <u>CHECK SHEET #</u> |   | <u>PAGE NO.</u> |
|----------------------|---|-----------------|
| LRS 1                | <b>Reserved</b> .....   | 130             |
| LRS 2                | <input type="checkbox"/> Furnished Excavation .....                                       | 131             |
| LRS 3                | <input type="checkbox"/> Work Zone Traffic Control Surveillance .....                     | 132             |
| LRS 4                | <input type="checkbox"/> Flaggers in Work Zones .....                                     | 133             |
| LRS 5                | <input type="checkbox"/> Contract Claims .....  | 134             |
| LRS 6                | <input type="checkbox"/> Bidding Requirements and Conditions for Contract Proposals ..... | 135             |
| LRS 7                | <input type="checkbox"/> Bidding Requirements and Conditions for Material Proposals ..... | 141             |
| LRS 8                | <b>Reserved</b> .....   | 147             |
| LRS 9                | <input type="checkbox"/> Bituminous Surface Treatments .....                              | 148             |
| LRS 10               | <b>Reserved</b> .....   | 149             |
| LRS 11               | <input type="checkbox"/> Employment Practices .....                                       | 150             |
| LRS 12               | <input type="checkbox"/> Wages of Employees on Public Works .....                         | 152             |
| LRS 13               | <input type="checkbox"/> Selection of Labor .....   | 154             |
| LRS 14               | <input type="checkbox"/> Paving Brick and Concrete Paver Pavements and Sidewalks .....    | 155             |
| LRS 15               | <input type="checkbox"/> Partial Payments .....   | 158             |
| LRS 16               | <input type="checkbox"/> Protests on Local Lettings .....                                 | 159             |
| LRS 17               | <input type="checkbox"/> Substance Abuse Prevention Program .....                         | 160             |
| LRS 18               | <input type="checkbox"/> Multigrade Cold Mix Asphalt .....                                | 161             |

# PROPOSAL

TO THE OWNER, CITY OF ROCK ISLAND

1. PROPOSAL OF \_\_\_\_\_

\_\_\_\_\_  
(Name and Address of Bidder )

For the improvements, designated as follows: \_\_\_\_\_

**JOB NO. 2770 – 25<sup>th</sup> Avenue Resurfacing, 12<sup>th</sup> Street to 17<sup>th</sup> Street**

2. The plans for the proposed improvements are those prepared by

**CITY OF ROCK ISLAND ENGINEERING DIVISION**

and which cover the work described in paragraph 1 above.

The specifications herein referred to are: This contract shall be in accordance with the **“Standard Specifications for Road and Bridge Construction,”** adopted April 1, 2016; the **“Supplemental Specifications and Recurring Special Provisions”** as indicated on the Check Sheet, adopted April 1, 2016; and the **Special Provisions** contained within these contract documents.

3. The undersigned agrees to complete all work covered by this contract by

**July 15, 2016**

4. Accompanying this proposal is a bank draft, IDOT paper bid bond, bank cashier’s check, bid bond or certified check, complying with the requirements of the specifications made payable to **THE CITY OF ROCK ISLAND**. The amount of the check, bid bond or draft is at least five percent (5%) of the amount bid \_\_\_\_\_

\_\_\_\_\_  
(\$ \_\_\_\_\_).

If this proposal is accepted and the undersigned shall fail to execute a contract and contract bond as required herein, it is hereby agreed that the amount of the check or draft or bidder’s bond substituted in lieu thereof, shall become the property of the Owner, and shall be considered as payment of damages due to delay and other causes suffered by the Owner because of the failure to execute said contract and contract bond; otherwise said check or draft, or bidder’s bond substituted in lieu thereof shall be returned to the undersigned.

ATTACH BANK DRAFT, BANK CASHIER'S CHECK, BID BOND OR CERTIFIED CHECK HERE

In the event that one check, bid bond or draft is intended to cover two or more proposals, the amount must be equal to the sum of the proposal guarantees of the individual proposals covered.

5. The undersigned acknowledges receipt of the following ADDENDA:

| <u>No.</u> | <u>Date</u> |
|------------|-------------|
| _____      | _____       |
| _____      | _____       |
| _____      | _____       |

6. The undersigned submits herewith this schedule of prices covering the work to be performed under this contract. Each pay item should have a unit price and a total price. The unit price shall govern if no total price is shown or if there is a discrepancy between the product of the unit price multiplied by the quantity. If a unit price is omitted, the total price will be divided by the quantity in order to establish a unit price. A bid will be declared unacceptable if neither a unit price nor a total price is shown.

7. The undersigned firm certifies that it has not been convicted of bribery or attempting to bribe an officer or employee of the State of Illinois or the City of Rock Island, nor has the firm made an admission of guilt of such conduct which is a matter of record, nor has an official, agent, or employee of the firm committed bribery or attempted bribery on behalf of the firm and pursuant to the direction or authorization of a responsible official of the firm. The undersigned firm further certifies that it is not barred from bidding on this contract as a result of conviction for the violation of the State laws prohibiting bid-rigging or bid-rotating.

(If an Individual)

Signature of Bidder \_\_\_\_\_

Business Address \_\_\_\_\_

\_\_\_\_\_  
\_\_\_\_\_

(If a Partnership)

Firm Name \_\_\_\_\_

Signed By \_\_\_\_\_

Business Address

(Insert Name  
and Address  
of All Partners)

\_\_\_\_\_  
\_\_\_\_\_

\* \* \* \* \*

(If a Corporation)

Corporate Name \_\_\_\_\_

Signed By \_\_\_\_\_  
(President)

Business Address \_\_\_\_\_

\_\_\_\_\_

(Insert Names  
of Officers)

President \_\_\_\_\_

Secretary \_\_\_\_\_

Treasurer \_\_\_\_\_

Attest:

\_\_\_\_\_  
Secretary





Route \_\_\_\_\_
County \_\_\_\_\_
Local Agency \_\_\_\_\_
Section \_\_\_\_\_

RETURN WITH BID

PAPER BID BOND

WE \_\_\_\_\_ as PRINCIPAL,
and \_\_\_\_\_ as SURETY,
are held jointly, severally and firmly bound unto the above Local Agency (hereafter referred to as "LA") in the penal sum of 5% of the total bid price, or for the amount specified in the proposal documents in effect on the date of invitation for bids whichever is the lesser sum. We bind ourselves, our heirs, executors, administrators, successors, and assigns, jointly pay to the LA this sum under the conditions of this instrument.

WHEREAS THE CONDITION OF THE FOREGOING OBLIGATION IS SUCH that, the said PRINCIPAL is submitting a written proposal to the LA acting through its awarding authority for the construction of the work designated as the above section.

THEREFORE if the proposal is accepted and a contract awarded to the PRINCIPAL by the LA for the above designated section and the PRINCIPAL shall within fifteen (15) days after award enter into a formal contract, furnish surety guaranteeing the faithful performance of the work, and furnish evidence of the required insurance coverage, all as provided in the "Standard Specifications for Road and Bridge Construction" and applicable Supplemental Specifications, then this obligation shall become void; otherwise it shall remain in full force and effect.

IN THE EVENT the LA determines the PRINCIPAL has failed to enter into a formal contract in compliance with any requirements set forth in the preceding paragraph, then the LA acting through its awarding authority shall immediately be entitled to recover the full penal sum set out above, together with all court costs, all attorney fees, and any other expense of recovery.

IN TESTIMONY WHEREOF, the said PRINCIPAL and the said SURETY have caused this instrument to be signed by their respective officers this \_\_\_\_\_ day of \_\_\_\_\_

Principal

\_\_\_\_\_  
(Company Name) \_\_\_\_\_  
By: \_\_\_\_\_ By: \_\_\_\_\_  
(Signature and Title) (Signature and Title)

(If PRINCIPLE is a joint venture of two or more contractors, the company names, and authorized signatures of each contractor must be affixed.)

Surety

\_\_\_\_\_  
(Name of Surety) By: \_\_\_\_\_  
(Signature of Attorney-in-Fact)

STATE OF ILLINOIS,  
COUNTY OF \_\_\_\_\_  
I, \_\_\_\_\_, a Notary Public in and for said county,  
do hereby certify that \_\_\_\_\_

(Insert names of individuals signing on behalf of PRINCIPAL & SURETY)

who are each personally known to me to be the same persons whose names are subscribed to the foregoing instrument on behalf of PRINCIPAL and SURETY, appeared before me this day in person and acknowledged respectively, that they signed and delivered said instruments as their free and voluntary act for the uses and purposes therein set forth.

Given under my hand and notarial seal this \_\_\_\_\_ day of \_\_\_\_\_

My commission expires \_\_\_\_\_  
(Notary Public)

ELECTRONIC BID BOND

[ ] Electronic bid bond is allowed (box must be checked by LA if electronic bid bond is allowed)

The Principal may submit an electronic bid bond, in lieu of completing the above section of the Proposal Bid Bond Form. By providing an electronic bid bond ID code and signing below, the Principal is ensuring the identified electronic bid bond has been executed and the Principal and Surety are firmly bound unto the LA under the conditions of the bid bond as shown above. (If PRINCIPAL is a joint venture of two or more contractors, an electronic bid bond ID code, company/Bidder name title and date must be affixed for each contractor in the venture.)

Electronic Bid Bond ID Code

Electronic Bid Bond ID Code

\_\_\_\_\_  
(Company/Bidder Name)  
\_\_\_\_\_  
(Signature and Title) \_\_\_\_\_  
Date



## City of Rock Island - Public Works Department - Engineering Division

### Schedule of Prices

**Project: 25th Avenue Resurfacing, 12th Street to 17th Street**

**Job No. 2770**

**Bid Date: Tuesday, April 19, 2016 at 9:00 A.M.**

(\* For complete information covering these items, see specifications)

| <b>Item No.</b>                 | <b>Description</b>  | <b>Approx. Quantity</b> | <b>Units</b> | <b>Unit Price</b> | <b>Total</b> |
|---------------------------------|---|-------------------------|--------------|-------------------|--------------|
| 1                               | Portland Cement Concrete, Surface Removal (Cold Milling)          | 6,481.2                 | SY           |                   |              |
| 2                               | Pavement Removal  | 772.8                   | SY           |                   |              |
| 3                               | Earth Excavation  | 132.0                   | CY           |                   |              |
| 4                               | Geotechnical Fabric For Ground Stabilization                      | 772.8                   | SY           |                   |              |
| 5                               | Aggregate Base Course, Type A                                     | 215.0                   | Ton          |                   |              |
| 6                               | Portland Cement Concrete Pavement, (Jointed), 7" (With Integral C | 772.8                   | SY           |                   |              |
| 7                               | Combination Curb And Gutter Removal                               | 394.5                   | FT.          |                   |              |
| 8                               | Combination Concrete Curb And Gutter, Type M-6.18 (Modified)      | 394.5                   | FT.          |                   |              |
| 9                               | Mixture For Cracks, Joints, And Flangeways                        | 8.0                     | Ton          |                   |              |
| 10                              | Area Reflective Crack Control Treatment                           | 6,481.2                 | SY           |                   |              |
| 11                              | Hot-Mix Asphalt Binder Course, IL-9.5, N50, 1-1/2"                | 550.0                   | Ton          |                   |              |
| 12                              | Hot-Mix Asphalt Surface Course, IL-9.5, N50, 1-1/2"               | 550.0                   | Ton          |                   |              |
| 13                              | Driveway Pavement Removal   | 139.8                   | SY           |                   |              |
| 14                              | Portland Cement Concrete Residential Driveway, 6"                 | 139.8                   | SY           |                   |              |
| 15                              | Portland Cement Concrete, Pedestrian Curb Ramp, 6"                | 524.6                   | SF           |                   |              |
| 16                              | Sidewalk Removal  | 2960.2                  | SF           |                   |              |
| 17                              | Portland Cement Concrete Sidewalk, 4"                             | 2534.1                  | SF           |                   |              |
| 18                              | Catch Basin Single to be Adjusted with Type C Grate               | 1.0                     | Each         |                   |              |
| 19                              | Catch Basin Double to be Adjusted with Type C Grate               | 1.0                     | Each         |                   |              |
| 20                              | Catch Basin Single to be Adjusted                                 | 1.0                     | Each         |                   |              |
| 21                              | Catch Basin Double to be Adjusted                                 | 1.0                     | Each         |                   |              |
| 22                              | Manholes To Be Adjusted With New Frame and Lid                    | 4.0                     | Each         |                   |              |
| 23                              | Manholes To Be Adjusted   | 3.0                     | Each         |                   |              |
| 24                              | Water Manhole to be Removed                                       | 3.0                     | Each         |                   |              |
| 25                              | Gate Valve and Box To Be Adjusted                                 | 7.0                     | Each         |                   |              |
| 26                              | Domestic Water Valve to be Adjusted                               | 5.0                     | Each         |                   |              |
| 27                              | Sodding   | 700.0                   | SY           |                   |              |
| 28                              | Project Signs   | 2.0                     | Each         |                   |              |
| 29                              | Traffic Control And Protection                                    | 1.0                     | LS           |                   |              |
| <b>Bidder's Total Proposal:</b> |   |                         |              |                   |              |

# CONTRACT

THIS AGREEMENT, made this \_\_\_\_\_ day of \_\_\_\_\_, 20\_\_\_\_, by and between City of Rock Island herein called "OWNER", acting through its City Manager and

\_\_\_\_\_ (A corporation) (a partnership)  
STRIKE OUT INAPPLICABLE TERMS (An individual doing business as)  
of \_\_\_\_\_, \_\_\_\_\_  
Address City  
\_\_\_\_\_ And County of \_\_\_\_\_  
State

herein after called "CONTRACTOR",

WITNESSETH: That for and in consideration of the payments and agreements hereinafter mentioned, to be made and performed by the OWNER, the CONTRACTOR hereby agrees with the OWNER to commence and complete the construction described as follows:

***Job No. 2770 – 25<sup>th</sup> Avenue Resurfacing, 12<sup>th</sup> Street to 17<sup>th</sup> Street***

hereinafter called the Project, for the sum of \_\_\_\_\_

\_\_\_\_\_ (\$ \_\_\_\_\_), and all extra work in connection therewith, under the terms as stated in the General and Special Conditions of the Contract; and at his (its or their) own proper cost and expense to furnish all the materials, supplies, machinery equipment, tools, superintendence, labor, insurance, other accessories and services necessary to complete the said project in accordance with the conditions and prices stated in the proposal, the General Conditions, and Special Provisions of the Contract, the plans which include all maps, plats, blue prints, and other drawings and printed or written explanatory matter thereof, the specifications and contract documents therefore as prepared by

CITY OF ROCK ISLAND ENGINEERING, herein entitled the Engineer.

The CONTRACTOR hereby agrees to commence work under this contract on or before a date to be specified in a written "Notice to Proceed" of the OWNER and to fully complete the project on or before **Friday, July 15, 2016**.

The CONTRACTOR further agrees to pay as liquidated damages, the sum of \_\_\_\_\_ (\$ \_\_\_\_\_ ) for each consecutive calendar day thereafter.

The OWNER agrees to pay the Contractor in CITY FUNDS for the performance of the contract, subject to additions and deductions, As provided in the Standard Specifications of the Contract,

IN WITNESS WHEREOF, the parties to these presents have executed this contract in six (6) counterparts, each of which shall be deemed an original, in the year and date first above mentioned.

CITY OF ROCK ISLAND  
OWNER

By \_\_\_\_\_  
City Manager

Seal

ATTEST

\_\_\_\_\_  
City Clerk

\_\_\_\_\_  
CONTRACTOR

By: \_\_\_\_\_

Title \_\_\_\_\_

Seal

\_\_\_\_\_  
Secretary

\_\_\_\_\_  
Witness

**PERFORMANCE, LABOR, MATERIAL AND MAINTENANCE BOND**

KNOW ALL MEN THESE PRESENTS: That \_\_\_\_\_

\_\_\_\_\_

as principal, and \_\_\_\_\_

\_\_\_\_\_

as surety, are held and firmly bound to the City of Rock Island, Illinois, in the sum of \_\_\_\_\_  
\_\_\_\_\_ (\$ \_\_\_\_\_)

to be paid to the City of Rock Island, Illinois, and for the lawful payment said sum, we and each of us, hereby bond ourselves , our heirs, our executors, administrators, successors, and assigns firmly by these presents.

The conditions of this bond is such that:

WHEREAS, the above-named principal did on the \_\_\_\_\_  
day of \_\_\_\_\_, 20\_\_\_\_\_, enter into a contract with the City of  
Rock Island, Illinois for:

**25<sup>th</sup> Avenue Resurfacing, 12<sup>th</sup> Street to 17<sup>th</sup> Street  
City of Rock Island Job No. 2770**

NOW, THEREFORE, if the above-named principal shall well and truly:

1. Keep and perform all of the contract of his, its, or their part to be kept and performed, and faithfully comply with all of the laws of the State of Illinois and all of the ordinances of the City of Rock Island, Illinois, applicable to the aforesaid contract and this bond and conditions of said contract, and at the time stipulated in said contract or within a reasonable time if no time is stipulated;

2. Pay for any and all materials, lubricants, oil, gasoline, grain, hay, feed, coal, and coke, repairs on machinery, groceries and foodstuffs, equipment and tools consumed or used in connection with construction with the work fore described, and all insurance premiums both for compensation and for all other kinds of insurance on said work above described, and for all labor performed in the work whether by the principal or by subcontractor or otherwise and at the prevailing hourly rate of wages made applicable to the work as specified by the contractor (if the prevailing hourly rate of wages shall have been so specified):

3. Maintenance any public improvement installed or constructed under said contract from defective material or workmanship in said work for a period of two (2) years from the date of acceptance of said work.

Then this obligation shall be void, otherwise, it shall remain in full force and effect.

It is understood and agreed that this bond is executed and furnished under the provisions of Chapter 29, Paragraph 15 et. seq. of the Illinois Revised Statutes, 1983. Further, the principal and surety on this bond agree that all the undertakings, covenants, terms, conditions and agreements of the contract or contracts entered into between the principal and the City of Rock Island will be performed and fulfilled and to pay all persons, firms, and corporations having contracts with the principal or with subcontractors, all just claims due them under the provisions of such contracts for labor performed or material furnished in the performance of the contract on account of which this bond is given, when such claims are not satisfied out of the contract price of the contract on the account of which this bond is given, after final settlement between the officer, board, commission or agent of the City of Rock Island and the principal has been made.

It is understood and agreed that this bond shall not be avoided because of changes in the plans or specifications for the work or because of extensions of time for the performances of the work and the surety above-named does hereby waive notice of and does hereby consent to any such changes or extensions of time.

It is understood and agreed that any person entitled to payment for any of the matters upon which this bond is conditioned shall have the right to sue upon such bond in the name of the City of Rock Island, Illinois, for his use and benefit for the recovery of such payment. It is further agreed that no such suit shall be instituted until the expiration of one hundred and twenty (120) days after the date of the last item of work or the furnishing of the last item of materials except in the case where final settlement between the City of Rock Island and the contractor shall have been made prior to the expiration of the 120-day period, in which case, action may be taken immediately following such final settlement; nor shall any action of any kind be brought later than six (6) months after the acceptance by the City of Rock Island for the work. Any person making claims as aforesaid, must provide notice of said claims as provided in Chapter 29, Paragraph 16, Illinois Revised Statutes, 1983. However, defects in the notice shall not deprive the claimant of this right of action, unless it shall affirmatively appear that such defeat has prejudiced the rights of an interested party.

It is hereby expressly agreed that this bond is also given as a guaranty against defective material or workmanship in the work covered by the contract and as a guaranty that all of said work shall remain in good condition for two (2) years from the date of acceptance of same; provided, no suit shall be upon said guaranties more than two (2) years and forty-five (45) days following the acceptance of the said work.

In addition to any other remedies which may be had by the City of Rock Island, Illinois, under this bond, the City may, in case of default or abandonment of the contract herein before referred to notify the surety hereto by registered or certified mail directed to the surety or to its attorney-in-fact for it authorized at the time of the execution of this bond that such default or abandonment has occurred, which such notice need not be detailed but may be in generalities, and the surety shall have the obligation to inquire into the nature of such default from the date of such notice proceed toward completion without undue delay of the improvements in accordance with the contract aforesaid; and in the event of default on the part of the surety to proceed to complete as aforesaid, the City of Rock Island, shall have the right

- (a) To itself complete the work and upon completion to be reimbursed by the principal, the surety or both of them for the cost of said completion including cost of readvertisement, preparation of new plans, contracts etc., and all other ordinary and reasonable expenses in connection with completion of the work; or
- (b) At the election of the City of Rock Island, the City may relet the contract and the said City of Rock Island, Illinois, is hereby appointed and constituted trustee for and on behalf of the property owners affected by said contract to collect, and if necessary, sue on behalf of such property owners for the loss that may sustain by reasons of the principal's default or abandonment of his aforementioned contract with the City.

The parties hereto agree that should any litigation arise out of this bond, the venue for such litigation shall be in the Circuit Court of Rock Island County, Illinois, and the parties hereto expressly waive all rights to venue inconsistent herewith.

IN WITNESS WHEREOF, we have hereto set our hands and seals this \_\_\_\_\_ day of \_\_\_\_\_, 20\_\_\_\_\_, or have caused these presents to be executed by our authorized agent on the same day and year.

\_\_\_\_\_  
\_\_\_\_\_  
\_\_\_\_\_  
\_\_\_\_\_

# Rock Island County Prevailing Wage for July 2015

(See explanation of column headings at bottom of wages)

| Trade Name           | RG | TYP | C | Base   | FRMAN  | M-F>8 | OSA  | OSH  | H/W   | Pensn | Vac   | Trng  |
|----------------------|----|-----|---|--------|--------|-------|------|------|-------|-------|-------|-------|
| =====                | == | === | = | =====  | =====  | ===== | ==== | ==== | ===== | ===== | ===== | ===== |
| ASBESTOS ABT-GEN     |    | BLD |   | 24.230 | 25.680 | 1.5   | 1.5  | 2.0  | 6.750 | 9.370 | 0.000 | 0.800 |
| ASBESTOS ABT-GEN     |    | HWY |   | 25.650 | 26.650 | 1.5   | 1.5  | 2.0  | 6.450 | 7.060 | 0.000 | 0.800 |
| ASBESTOS ABT-MEC     |    | BLD |   | 22.700 | 23.700 | 1.5   | 1.5  | 2.0  | 6.700 | 5.050 | 0.000 | 0.650 |
| BOILERMAKER          |    | BLD |   | 38.000 | 41.000 | 2.0   | 2.0  | 2.0  | 7.070 | 15.99 | 0.000 | 0.400 |
| BRICK MASON          |    | BLD |   | 27.600 | 29.100 | 1.5   | 1.5  | 2.0  | 9.400 | 6.480 | 0.000 | 0.540 |
| CARPENTER            |    | BLD |   | 27.700 | 29.090 | 1.5   | 1.5  | 2.0  | 8.610 | 10.51 | 0.000 | 0.600 |
| CARPENTER            |    | HWY |   | 29.250 | 31.000 | 1.5   | 1.5  | 2.0  | 10.00 | 12.71 | 0.000 | 0.450 |
| CEMENT MASON         |    | BLD |   | 25.950 | 27.950 | 1.5   | 1.5  | 2.0  | 6.750 | 11.24 | 0.000 | 0.500 |
| CEMENT MASON         |    | HWY |   | 25.840 | 26.840 | 1.5   | 1.5  | 2.0  | 6.750 | 11.66 | 0.000 | 0.500 |
| CERAMIC TILE FNSHER  |    | BLD |   | 20.010 | 0.000  | 1.5   | 1.5  | 2.0  | 9.400 | 6.130 | 0.000 | 0.260 |
| ELECTRIC PWR EQMT OP |    | ALL |   | 31.510 | 0.000  | 1.5   | 1.5  | 2.0  | 5.630 | 8.830 | 0.000 | 0.320 |
| ELECTRIC PWR GRNDMAN |    | ALL |   | 26.330 | 0.000  | 1.5   | 1.5  | 2.0  | 5.530 | 7.370 | 0.000 | 0.260 |
| ELECTRIC PWR LINEMAN |    | ALL |   | 39.730 | 43.700 | 1.5   | 1.5  | 2.0  | 5.790 | 11.12 | 0.000 | 0.400 |
| ELECTRICIAN          |    | BLD |   | 33.500 | 35.500 | 1.5   | 1.5  | 2.0  | 7.690 | 11.93 | 0.000 | 0.310 |
| ELECTRONIC SYS TECH  |    | BLD |   | 24.490 | 26.240 | 1.5   | 1.5  | 2.0  | 7.270 | 5.780 | 0.000 | 0.310 |
| ELEVATOR CONSTRUCTOR |    | BLD |   | 40.470 | 45.530 | 2.0   | 2.0  | 2.0  | 13.57 | 14.21 | 3.240 | 0.600 |
| GLAZIER              |    | BLD |   | 28.710 | 30.210 | 1.5   | 1.5  | 2.0  | 6.940 | 7.170 | 0.000 | 0.450 |
| HT/FROST INSULATOR   |    | BLD |   | 29.830 | 31.030 | 1.5   | 1.5  | 2.0  | 6.130 | 12.05 | 0.000 | 0.900 |
| IRON WORKER          |    | ALL |   | 30.250 | 32.670 | 1.5   | 1.5  | 2.0  | 9.490 | 12.29 | 0.000 | 0.690 |
| LABORER              |    | BLD | 1 | 22.340 | 23.230 | 1.5   | 1.5  | 2.0  | 6.750 | 7.410 | 0.000 | 0.800 |
| LABORER              |    | BLD | 2 | 23.840 | 24.790 | 1.5   | 1.5  | 2.0  | 6.750 | 7.410 | 0.000 | 0.800 |
| LABORER              |    | BLD | 3 | 24.490 | 25.470 | 1.5   | 1.5  | 2.0  | 6.750 | 7.410 | 0.000 | 0.800 |
| LABORER              |    | HWY | 1 | 26.090 | 27.090 | 1.5   | 1.5  | 2.0  | 6.750 | 9.710 | 0.000 | 0.800 |
| LABORER              |    | HWY | 2 | 26.590 | 27.590 | 1.5   | 1.5  | 2.0  | 6.750 | 9.710 | 0.000 | 0.800 |
| LABORER              |    | HWY | 3 | 27.220 | 28.220 | 1.5   | 1.5  | 2.0  | 6.750 | 9.710 | 0.000 | 0.800 |
| LATHER               |    | BLD |   | 27.700 | 29.090 | 1.5   | 1.5  | 2.0  | 8.610 | 10.51 | 0.000 | 0.600 |
| MACHINIST            |    | BLD |   | 45.350 | 47.850 | 1.5   | 1.5  | 2.0  | 7.260 | 8.950 | 1.850 | 0.000 |
| MARBLE FINISHERS     |    | BLD |   | 20.010 | 0.000  | 1.5   | 1.5  | 2.0  | 9.400 | 6.130 | 0.000 | 0.260 |
| MARBLE MASON         |    | BLD |   | 24.350 | 24.850 | 1.5   | 1.5  | 2.0  | 9.400 | 6.130 | 0.000 | 0.260 |
| MILLWRIGHT           | N  | BLD |   | 36.970 | 40.670 | 1.5   | 1.5  | 2.0  | 9.920 | 14.55 | 0.000 | 0.500 |
| MILLWRIGHT           | S  | BLD |   | 36.970 | 40.670 | 1.5   | 1.2  | 2.0  | 9.920 | 14.55 | 0.000 | 0.500 |
| OPERATING ENGINEER   |    | BLD | 1 | 31.900 | 33.900 | 1.5   | 1.5  | 2.0  | 16.55 | 9.150 | 2.000 | 0.900 |
| OPERATING ENGINEER   |    | BLD | 2 | 29.250 | 33.900 | 1.5   | 1.5  | 2.0  | 16.55 | 9.150 | 2.000 | 0.900 |
| OPERATING ENGINEER   |    | BLD | 3 | 28.200 | 33.900 | 1.5   | 1.5  | 2.0  | 16.55 | 9.150 | 2.000 | 0.900 |
| OPERATING ENGINEER   |    | BLD | 4 | 32.150 | 33.900 | 1.5   | 1.5  | 2.0  | 16.55 | 9.150 | 2.000 | 0.900 |
| OPERATING ENGINEER   |    | BLD | 5 | 32.650 | 33.900 | 1.5   | 1.5  | 2.0  | 16.55 | 9.150 | 2.000 | 0.900 |
| OPERATING ENGINEER   |    | BLD | 6 | 33.150 | 33.900 | 1.5   | 1.5  | 2.0  | 16.55 | 9.150 | 2.000 | 0.900 |
| OPERATING ENGINEER   |    | BLD | 7 | 32.900 | 33.900 | 1.5   | 1.5  | 2.0  | 16.55 | 9.150 | 2.000 | 0.900 |
| OPERATING ENGINEER   |    | HWY | 1 | 31.900 | 33.900 | 1.5   | 1.5  | 2.0  | 16.55 | 9.150 | 2.000 | 0.900 |
| OPERATING ENGINEER   |    | HWY | 2 | 29.250 | 33.900 | 1.5   | 1.5  | 2.0  | 16.55 | 9.150 | 2.000 | 0.900 |
| OPERATING ENGINEER   |    | HWY | 3 | 28.200 | 33.900 | 1.5   | 1.5  | 2.0  | 16.55 | 9.150 | 2.000 | 0.900 |
| OPERATING ENGINEER   |    | HWY | 4 | 32.150 | 33.900 | 1.5   | 1.5  | 2.0  | 16.55 | 9.150 | 2.000 | 0.900 |
| OPERATING ENGINEER   |    | HWY | 5 | 32.650 | 33.900 | 1.5   | 1.5  | 2.0  | 16.55 | 9.150 | 2.000 | 0.900 |
| OPERATING ENGINEER   |    | HWY | 6 | 33.150 | 33.900 | 1.5   | 1.5  | 2.0  | 16.55 | 9.150 | 2.000 | 0.900 |
| OPERATING ENGINEER   |    | HWY | 7 | 32.400 | 33.900 | 1.5   | 1.5  | 2.0  | 16.55 | 9.150 | 2.000 | 0.900 |
| OPERATING ENGINEER   |    | HWY | 8 | 32.900 | 33.900 | 1.5   | 1.5  | 2.0  | 16.55 | 9.150 | 2.000 | 0.900 |
| PAINTER              |    | ALL |   | 27.820 | 28.820 | 1.5   | 1.5  | 1.5  | 5.250 | 6.600 | 0.000 | 0.600 |
| PAINTER OVER 30FT    |    | ALL |   | 29.820 | 30.820 | 1.5   | 1.5  | 1.5  | 5.250 | 6.600 | 0.000 | 0.600 |
| PAINTER PWR EQMT     |    | ALL |   | 28.320 | 29.320 | 1.5   | 1.5  | 1.5  | 5.250 | 6.600 | 0.000 | 0.600 |
| PILEDRIVER           |    | BLD |   | 27.700 | 29.090 | 1.5   | 1.5  | 2.0  | 8.610 | 10.51 | 0.000 | 0.600 |
| PILEDRIVER           |    | HWY |   | 29.250 | 31.000 | 1.5   | 1.5  | 2.0  | 10.00 | 12.71 | 0.000 | 0.450 |
| PIPEFITTER           |    | ALL |   | 37.650 | 41.420 | 1.5   | 1.5  | 2.0  | 6.000 | 12.95 | 0.000 | 1.150 |
| PLASTERER            |    | BLD |   | 28.110 | 30.110 | 1.5   | 1.5  | 2.0  | 7.500 | 7.000 | 0.000 | 0.600 |



|                          |                          |                |                   |                   |                |                |                |                  |                  |                  |
|--------------------------|--------------------------|----------------|-------------------|-------------------|----------------|----------------|----------------|------------------|------------------|------------------|
| PLUMBER                  | ALL                      | 37.650         | 41.420            | 1.5               | 1.5            | 2.0            | 6.000          | 12.95            | 0.000            | 1.150            |
| ROOFER                   | BLD                      | 26.750         | 28.000            | 1.5               | 1.5            | 2.0            | 9.140          | 6.920            | 0.000            | 0.290            |
| SHEETMETAL WORKER        | BLD                      | 30.850         | 32.960            | 1.5               | 1.5            | 2.0            | 7.140          | 12.18            | 0.000            | 0.540            |
| SPRINKLER FITTER         | BLD                      | 37.120         | 39.870            | 1.5               | 1.5            | 2.0            | 8.420          | 8.500            | 0.000            | 0.350            |
| STONE MASON              | BLD                      | 27.600         | 29.100            | 1.5               | 1.5            | 2.0            | 9.400          | 0.000            | 0.000            | 0.540            |
| <del>SURVEY WORKER</del> | <del>NOT IN EFFECT</del> | <del>ALL</del> | <del>27.130</del> | <del>28.130</del> | <del>1.5</del> | <del>1.5</del> | <del>2.0</del> | <del>6.750</del> | <del>7.410</del> | <del>0.000</del> |
| 0.800                    |                          |                |                   |                   |                |                |                |                  |                  |                  |
| TERRAZZO FINISHER        | BLD                      | 20.010         | 0.000             | 1.5               | 1.5            | 2.0            | 9.400          | 6.130            | 0.000            | 0.260            |
| TERRAZZO MASON           | BLD                      | 24.350         | 24.850            | 1.5               | 1.5            | 2.0            | 9.400          | 6.130            | 0.000            | 0.260            |
| TILE LAYER               | BLD                      | 27.300         | 28.670            | 1.5               | 1.5            | 2.0            | 8.360          | 9.760            | 0.000            | 0.600            |
| TILE MASON               | BLD                      | 24.350         | 24.850            | 1.5               | 1.5            | 2.0            | 9.400          | 6.130            | 0.000            | 0.260            |
| TRUCK DRIVER             | ALL 1                    | 34.220         | 37.870            | 1.5               | 1.5            | 2.0            | 11.40          | 5.640            | 0.000            | 0.250            |
| TRUCK DRIVER             | ALL 2                    | 34.690         | 37.870            | 1.5               | 1.5            | 2.0            | 11.40          | 5.640            | 0.000            | 0.250            |
| TRUCK DRIVER             | ALL 3                    | 34.950         | 37.870            | 1.5               | 1.5            | 2.0            | 11.40          | 5.640            | 0.000            | 0.250            |
| TRUCK DRIVER             | ALL 4                    | 35.240         | 37.870            | 1.5               | 1.5            | 2.0            | 11.40          | 5.640            | 0.000            | 0.250            |
| TRUCK DRIVER             | ALL 5                    | 36.170         | 37.870            | 1.5               | 1.5            | 2.0            | 11.40          | 5.640            | 0.000            | 0.250            |
| TRUCK DRIVER             | O&C 1                    | 27.380         | 30.300            | 1.5               | 1.5            | 2.0            | 11.40          | 5.640            | 0.000            | 0.250            |
| TRUCK DRIVER             | O&C 2                    | 27.750         | 30.300            | 1.5               | 1.5            | 2.0            | 11.40          | 5.640            | 0.000            | 0.250            |
| TRUCK DRIVER             | O&C 3                    | 27.960         | 30.300            | 1.5               | 1.5            | 2.0            | 11.40          | 5.640            | 0.000            | 0.250            |
| TRUCK DRIVER             | O&C 4                    | 28.190         | 30.300            | 1.5               | 1.5            | 2.0            | 11.40          | 5.640            | 0.000            | 0.250            |
| TRUCK DRIVER             | O&C 5                    | 28.940         | 30.300            | 1.5               | 1.5            | 2.0            | 11.40          | 5.640            | 0.000            | 0.250            |
| TUCKPOINTER              | BLD                      | 27.600         | 29.100            | 1.5               | 1.5            | 2.0            | 9.400          | 6.480            | 0.000            | 0.540            |

Legend:

RG (Region)

TYP (Trade Type - All,Highway,Building,Floating,Oil & Chip,Rivers)

C (Class)

Base (Base Wage Rate)

FRMAN (Foreman Rate)

M-F>8 (OT required for any hour greater than 8 worked each day, Mon through Fri.

OSA (Overtime (OT) is required for every hour worked on Saturday)

OSH (Overtime is required for every hour worked on Sunday and Holidays)

H/W (Health & Welfare Insurance)

Pensn (Pension)

Vac (Vacation)

Trng (Training)

## Explanations

ROCK ISLAND COUNTY

MILLWRIGHT (SOUTH) - South of Interstate 80.

The following list is considered as those days for which holiday rates of wages for work performed apply: New Years Day, Memorial Day, Fourth of July, Labor Day, Thanksgiving Day, Christmas Day and Veterans Day in some classifications/counties. Generally, any of these holidays which fall on a Sunday is celebrated on the following Monday. This then makes work performed on that Monday payable at the appropriate overtime rate for holiday pay. Common practice in a given local may alter certain days of celebration. If in doubt, please check with IDOL.

Oil and chip resealing (O&C) means the application of road oils and liquid asphalt to coat an existing road surface, followed by application of aggregate chips or gravel to coated surface, and subsequent rolling of material to seal the surface.

#### EXPLANATION OF CLASSES

ASBESTOS - GENERAL - removal of asbestos material/mold and hazardous materials from any place in a building, including mechanical systems where those mechanical systems are to be removed. This includes the removal of asbestos materials/mold and hazardous materials from ductwork or pipes in a building when the building is to be demolished at the time or at some close future date.

ASBESTOS - MECHANICAL - removal of asbestos material from mechanical systems, such as pipes, ducts, and boilers, where the mechanical systems are to remain.

#### CERAMIC TILE FINISHER, MARBLE FINISHER, TERRAZZO FINISHER

Assisting, helping or supporting the tile, marble and terrazzo mechanic by performing their historic and traditional work assignments required to complete the proper installation of the work covered by said crafts. The term "Ceramic" is used for naming the classification only and is in no way a limitation of the product handled. Ceramic takes into consideration most hard tiles.

#### ELECTRONIC SYSTEMS TECHNICIAN

Installing, assembling and maintaining sound and intercom, protection alarm (security), master antenna television, closed circuit television, computer hardware and software programming and installation to the network's outlet and input (EXCLUDING all cabling, power and cable termination work historically performed by wiremen), door monitoring and control, nurse and emergency call programming and installation to the system's outlet and input (EXCLUDING all cabling, power and cable termination work historically performed by wiremen), clock and timing; and the installation and maintenance of transmit and receive antennas, transmitters, receivers, and associated apparatus which operates in conjunction with the above systems. All work associated with these system installations will be included EXCEPT (1) installation of protective metallic conduit, excluding less than ten-foot runs strictly for protection of cable, and (2) 120 volt AC (or higher) power wiring and associated hardware.

#### LABORER - BUILDING

Class 1: General laborer, carpenter tender, tool cribman, salamander tender, flagman, form handler, floor sweeper, material handler,

fencing laborer, cleaning lumber, landscaper, unloading explosives, laying of sod, planting/removal of trees, wrecking laborer, unloading of Re-Bars, scaffold worker, signal man on crane.

Class 2: Handling of materials treated with creosote, kettle men, prime mover or motorized unit used for wet concrete or handling of building materials, vibrator operator, mortar mixer, power tools used under the jurisdiction of laborers, sand points, gunnite nozzle men, welders, cutters, burners and torchmen, chain saw operator, jackhammer and drill operators, paving breakers, air tamping hammerman, concrete saw operator, concrete burning machine operator, coring machine operator - hod carrier and plasterer tender.

Class 3: Caisson worker after 6 foot depth, dynamite man, asbestos abatement worker, tunnel miners - mixerman (plaster only), pump man.

#### LABORER - HEAVY & HIGHWAY

Class 1: Rod or chain man, flagman, dumpman, spotter, broom man, landscaper, planting and removal of trees, fencing laborers, dispatcher, ticket writer, scaleman, cleaning of forms or lumber (in bone yard), laying of sod, moving and/or maintenance of flares and barricades.

Class 2: Operation of all hand, electric, air, hydraulic or mechanically powered tools under the jurisdiction of Laborers' including jackhammers, tempers, air spades, augers, concrete saws, chain saws, utility saws, rock drills, vibrators, mortar mixer, power and hand saw (when clearing timber) general laborer (not elsewhere covered), craft-tender, material checker, material handler, form handler, concrete dumper, puddler, form setter helper, explosives handler, dynamite helper, center strip, reinforcing in concrete, wire mesh handler and installer, prime mover or any mechanical device taking the place of concrete buggy or wheelbarrow, sandpoint setter, asphalt kettleman. Sheeting hammer drivers, laying and jointing of telephone conduit, gas distribution men, pipe setter on laterals, drain tiles, culvert pipe, and storm sewer catch basin leads, catch basins, manholes, batch dumpers, tank cleaners, cofferdam workers, bankman on floating plant, jointman with pipelayers. Back-up man (corker, joint maker) with pipe setter on sewer and water mains, batterboard man or laser operator on sewer and water main, labor in ditch, or tunnel, on sewer or water mains and telephone conduit. Cutters, burners, torchman, gravel box man, asphalt plant laborers, concrete plant laborer, deck hand, unloading of steel and rebar, laser beam operator, wrecking laborers.

Class 3: Asphalt raker or luteman, head form setter, head dynamite man (powderman) head string or wireline man (on paving), pipe setter on sewer or water main, gunnite nozzle man, asphalt or concrete curb machine operator, head grade man, head tunnel miner, concrete burning machine operator, coring machine operator, welder.

MATERIAL TESTER/INSPECTOR I: Hand coring and drilling for testing of materials; field inspection of uncured concrete and asphalt.

MATERIAL TESTER/INSPECTOR II: Field inspection of welds, structural steel, fireproofing, masonry, soil, facade, reinforcing steel, formwork, cured concrete, and concrete and asphalt batch plants; adjusting proportions of bituminous mixtures.

#### OPERATING ENGINEERS - BUILDING

Class 1. Shovel; Concrete Spreader; Dipper Dredge Operator; Dipper

Dredge Crane man; Dual Purpose Truck (boom, Boom, Winch, etc.); Mechanic-Welder; Pile Driver; Boom Tractor or Side Boom; Trenching Machine (40 H.P. and over); Building Hoist (1, 2 or 3 drums); Cleaning and Priming Machine; Backfiller (throw bucket); Locomotive Engineer; Concrete Paver; Slip Form Paver; Caisson Augering Machines; Mucking Machine; Asphalt Heater-Planer Unit; Laser Screed; Pug Mill; Concrete Conveyor or Pump; Mechanical loaded Log Chippers or similar machines; Group Equipment Greaser; Off-Road Haul Units; Pipe Bending; Automatic Curbing Machines; Blastholer; Self-Propelled Rotary Drill or similar machines; Work Boat; Combination Concrete Finishing Machine and Float; Asphalt Paver Screed Operator; Forklift (6,000 lb. cap. or over or working heights 28 ft. and above); Chip Spreader; Straddle Carrier; Asphalt Paver; Asphalt Plant Operator; Boring Machine (Directional, Vertical, or Horizontal); Central Redi-Mix Plant Operator; Combination Backhoe Front End loader; Concrete Breaker or Hydro-Hammer (excluding walk-behinds); Concrete Wheel Saw (Large self-propelled - excluding walk-behinds); Crusher (Stone, Concrete, Asphalt, etc.); Curing-Tinning Machine; Excavator; Farm-type Tractor Operating Scoop or Scraper or with Power Attachment; Grader; Motor Grader; Motor Patrol; Auto Grader; Form Grader; Pull Grader; Sub Grader; Elevating Grader; Guard Rail Post Driver; Hoists; Hydraulic Dredge Leverman or Engineer; Hydro-Vac truck mounted or pull type (excluding hose work), and similar equipment; Loader (Track, Rubber Tire, or Articulated); Milling Machine (excluding walk-behinds); Road Widener-Shoulder Spreader; Scraper (Self-Propelled); Self-Propelled Roller or Tire Roller (on asphalt or Blacktop); Sheep Foot or Pad Foot Compactor (excluding walk-behinds); Steel Track-Type Tractor (Dozer, Push Cat, etc.); Transfer or Shuttle Buggy (excluding motorized wheel barrows and Georgia buggies).

Class 2. Asphalt Booster; Fireman and Pump Operator at Asphalt Plant; Mud Jack; Distributor; Self-propelled Roller (other than provided for in Class I); Pump Operator (more than one well-point pump); Trench Machine (under 40 H.P.); Forklift (less than 6,000 lb. cap. or working heights below 28 ft.); Gypsum Pump; Conveyor over 20 H.P.; Light Plant; Boiler (Engineer or Fireman); Mechanical Broom; Driver on Truck Crane or similar machines; Elevator (Permanent inside or Temporary outside); Farm-Type Tractor (without Power Attachment); Grout Pump (excluding hose work).

Class 3. Skid Loader; Oiler; Mechanic's Helper; Mechanical Heater (other than steam boiler); Small Outboard Motor Boat (Safety Boat and Life Boat); Engine Driven Welding Machine; Water Pumps; Air Compressor (400 c.f.m. or over); Deck Engineers.

Class 4. Leadman - Mechanic or Equipment Greaser.

Class 5. Track Excavator with Bucket (4 cubic yard and up to but not including 6 cubic yard).

Class 6. Track Excavator with Bucket (6 cubic yard and over).

Class 7. Crane (Friction or Hydraulic, regardless of size or attachments); Tow or Push Boat.

#### OPERATING ENGINEERS- HIGHWAY

Class 1. Shovel; Concrete Spreader; Dipper Dredge Operator; Dipper Dredge Crane man; Dual Purpose Truck (Boom, Winch, etc.); Mechanic-Welder; Pile Driver; Boom Tractor or Side Boom; Building Hoist (1, 2 or 3 drums); Cleaning and Priming Machine; Backfiller (throw bucket); Locomotive Engineer; Concrete Paver; Slip Form Paver;

Caisson Augering Machines; Mucking Machine; Asphalt Heater Planer Unit; Laser Screed; Pug Mill; Concrete Conveyor or Pump (excluding truck-mounted); Mechanical loaded Log Chippers or similar machines; Group Equipment Greaser; off-road haul units; Pipe Bending; Automatic Curbing Machines; Blastholer; Self-propelled Rotary Drill or similar machines; Work Boat; Combination Concrete Finishing Machine and Float; Asphalt Paver Screed Operator; Forklift (6,000 lb. cap. or over or working heights above 28 ft.); Chip Spreader; Asphalt Paver; Asphalt Plant Operator; Boring Machine (Directional, Vertical, or Horizontal); Central Redi-Mix Plant Operator; Combination Backhoe Front End loader; Concrete Breaker or Hydro-Hammer (excluding walk-behinds); Concrete Wheel Saw (Large self-propelled - excluding walk-behinds); Crusher (Stone, Concrete, Asphalt, etc.); Curing-Tinning Machine; Excavator; Farm-Type Tractor Operating Scoop or Scraper with Power Attachment; Grader; Motor Grader; Motor Patrol; Auto Grader; Form Grader; Pull Grader; Sub Grader; Elevating Grader; Guard Rail Post Driver; Hoists; Hydraulic Dredge Leverman or Engineer; Hydro-Vac truck mounted or pull type, and similar equipment; Loader (Track, Rubber Tire, or Articulated); Milling Machine (excluding walk-behinds); Road Widener-Shoulder Spreader; Scraper (self-propelled); Self-propelled Roller or Tire Roller (on asphalt or Blacktop); Sheep Foot or Pad Foot Compactor (excluding walk-behinds); Steel Track-Type Tractor (Dozer, Push Cat, etc.); Transfer or Shuttle Buggy (excluding motorized wheel barrows and Georgia buggies); Trenching Machine (40 H.P. and over).

Class 2. Asphalt Booster; Fireman and Pump Operator at Asphalt Plant; Mud Jack; Farm-Type Tractor without Power attachment; Distributor; Straddle Carrier; Self-propelled Roller or Compactor (other than provided for in Class I); Pump Operator (more than one well-point pump); Trench Machine (under 40 H.P.); Forklift (less than 6,000 lb. capacity or working heights below 28 ft.); Conveyor over 20 H.P.; Air Compressor (400 c.f.m. or over); Light Plant; Boiler (Engineer or Fireman); Mechanical Broom; Driver on Truck Crane or similar machines; Elevator (Permanent inside or Temporary outside); Grout Pump (excluding hose work).

Class 3. Oiler; Mechanic's Helper; Mechanical Heater (other than steam boiler); Small Outboard Motor Boat (Safety Boat and Life Boat); Engine Driven Welding Machine; skid steer.

Class 4. Leadman - Mechanic or Equipment Greaser.

Class 5. Track Excavator with Bucket (4 cubic yard and up to but not including 6 cubic yard).

Class 6. Track Excavator with Bucket (6 cubic yard and over).

Class 7. Truck mounted Concrete Conveyor or Pumps Extending to 90 ft. or more.

Class 8. Crane (Friction or Hydraulic, regardless of size or attachments); Tow or Push Boat.

SURVEY WORKER - Operated survey equipment including data collectors, G.P.S. and robotic instruments, as well as conventional levels and transits.

TRUCK DRIVER - BUILDING, HEAVY AND HIGHWAY CONSTRUCTION

Class 1. Drivers on 2 axle trucks hauling less than 9 ton. Air compressor and welding machines and brooms, including those pulled by separate units, truck driver helpers, warehouse employees, mechanic helpers, greasers and tiremen, pickup trucks when hauling materials,

tools, or workers to and from and on-the-job site, and fork lifts up to 6,000 lb. capacity.

Class 2. Two or three axle trucks hauling more than 9 ton but hauling less than 16 ton. A-frame winch trucks, hydrolift trucks, vector trucks or similar equipment when used for transportation purposes. Fork lifts over 6,000 lb. capacity, winch trucks, four axle combination units, and ticket writers.

Class 3. Two, three or four axle trucks hauling 16 ton or more. Drivers on water pulls, articulated dump trucks, mechanics and working forepersons, and dispatchers. Five axle or more combination units.

Class 4. Low Boy and Oil Distributors.

Class 5. Drivers who require special protective clothing while employed on hazardous waste work.

TRUCK DRIVER - OIL AND CHIP RESEALING ONLY.

This shall encompass laborers, workers and mechanics who drive contractor or subcontractor owned, leased, or hired pickup, dump, service, or oil distributor trucks. The work includes transporting materials and equipment (including but not limited to, oils, aggregate supplies, parts, machinery and tools) to or from the job site; distributing oil or liquid asphalt and aggregate; stock piling material when in connection with the actual oil and chip contract. The Truck Driver (Oil & Chip Resealing) wage classification does not include supplier delivered materials.

#### Other Classifications of Work:

For definitions of classifications not otherwise set out, the Department generally has on file such definitions which are available. If a task to be performed is not subject to one of the classifications of pay set out, the Department will upon being contacted state which neighboring county has such a classification and provide such rate, such rate being deemed to exist by reference in this document. If no neighboring county rate applies to the task, the Department shall undertake a special determination, such special determination being then deemed to have existed under this determination. If a project requires these, or any classification not listed, please contact IDOL at 217-782-1710 for wage rates or clarifications.

#### LANDSCAPING

Landscaping work falls under the existing classifications for laborer, operating engineer and truck driver. The work performed by landscape plantsman and landscape laborer is covered by the existing classification of laborer. The work performed by landscape operators (regardless of equipment used or its size) is covered by the classifications of operating engineer. The work performed by landscape truck drivers (regardless of size of truck driven) is covered by the classifications of truck driver.



**Substance Abuse Prevention Program Certification**

Letting Date: \_\_\_\_\_ Item No.: \_\_\_\_\_  
Contract No.: \_\_\_\_\_  
Route: \_\_\_\_\_  
Section: \_\_\_\_\_  
Job No.: \_\_\_\_\_  
County: \_\_\_\_\_

The Substance Abuse Prevention on Public Works Act, Public Act 95-0635, prohibits the use of drugs and alcohol, as defined in the Act, by employees of the Contractor and by employees of all approved Subcontractors while performing work on a public works project. The Contractor/Subcontractor herewith certifies that it has a superseding collective bargaining agreement or makes the public filing of its written substance abuse prevention program for the prevention of substance abuse among its employees who are not covered by a collective bargaining agreement dealing with the subject as mandated by the Act.

A. The undersigned representative of the Contractor/Subcontractor certifies that the contracting entity has signed collective bargaining agreements that are in effect for all of its employees, and that deal with the subject matter of Public Act 95-0635.

\_\_\_\_\_  
Contractor/Subcontractor

\_\_\_\_\_  
Name of Authorized Representative (type or print)

\_\_\_\_\_  
Title of Authorized Representative (type or print)

\_\_\_\_\_  
Signature of Authorized Representative

\_\_\_\_\_  
Date

B. The undersigned representative of the Contractor/Subcontractor certifies that the contracting entity has in place for all of its employees not covered by a collective bargaining agreement that deals with the subject of the Act, the attached substance abuse prevention program that meets or exceeds the requirements of Public Act 95-0635.

\_\_\_\_\_  
Contractor/Subcontractor

\_\_\_\_\_  
Name of Authorized Representative (type or print)

\_\_\_\_\_  
Title of Authorized Representative (type or print)

\_\_\_\_\_  
Signature of Authorized Representative

\_\_\_\_\_  
Date



ROCK ISLAND  
ILLINOIS

# CITY OF ROCK ISLAND, ILLINOIS

## 25th Avenue Resurfacing 12th Street to 17th Street Job# 2770

**MAYOR**  
DENNIS E. PAULEY

**ALDERMEN**

- IVORY D. CLARK
- VIRGIL J. MAYBERRY
- PAUL J. FOLEY
- STEPHEN L. TOLLENAER
- KATIE HOTLE
- JOSHUA SCHIPP
- CHARLES AUSTIN III

**WARD**

- 1
- 2
- 3
- 4
- 5
- 6
- 7

**CITY MANAGER**  
THOMAS THOMAS

**PUBLIC WORKS DIRECTOR**  
RANDALL D. TWEET

**CITY ENGINEER**  
MICHAEL J. KANE, P.E.

**Project Location**

Begin Sta 1+00  
End Sta 16+55

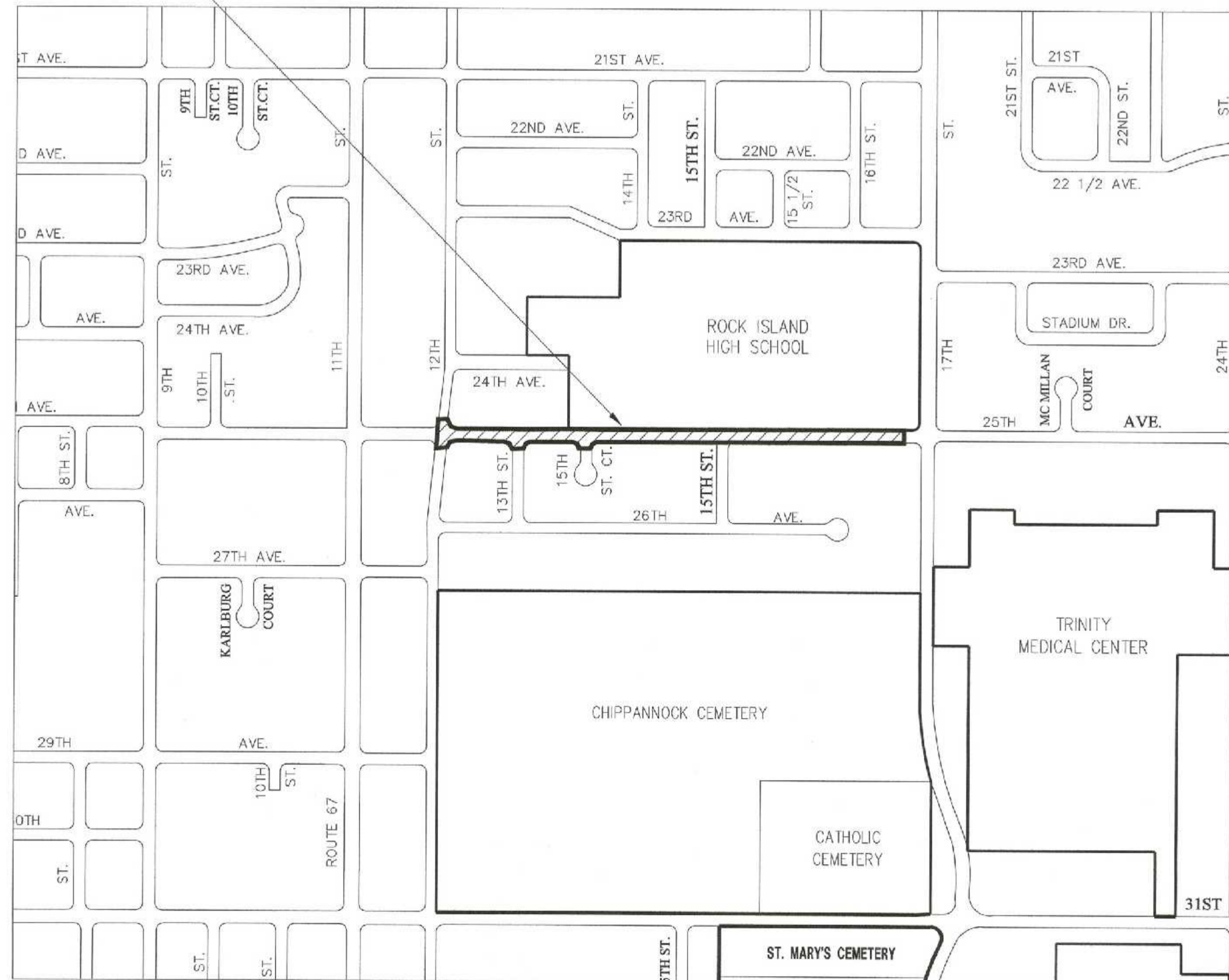

**INDEX OF SHEETS**

| Sheet Number | Title                  |
|--------------|------------------------|
| 1            | Cover                  |
| 2            | Quantities and Legend  |
| 3            | Schedule of Quantities |
| 4-8          | Plan and Profile       |



NOT TO SCALE

PROJECT LENGTH:  
1526 FEET = .29 MILE

**UTILITY OWNERS**

MIDAMERICAN ENERGY COMPANY  
2811 - 5TH AVE.  
ROCK ISLAND, ILLINOIS 61201

AMERITECH  
635 - 18TH ST.  
ROCK ISLAND, ILLINOIS 61201

MEDIACOM  
3900-26TH AVENUE  
MOLINE, ILLINOIS 61265

CITY OF ROCK ISLAND  
MUNICIPAL SERVICES DIVISION  
1309 MILL STREET  
ROCK ISLAND, ILLINOIS 61201

FOR UTILITY LOCATIONS CALL:  
J.U.L.I.E. @ 1-800-892-0123

**WARNING**



**CALL BEFORE  
YOU DIG**

**NOTE:**  
THIS PROJECT IS LOCATED IN THE  
SW 1/4 Sec 1, Twp 17N, R2W

I HEREBY CERTIFY THAT THESE PLANS WERE  
PREPARED BY ME OR UNDER MY DIRECT  
SUPERVISION AND I AM A DULY REGISTERED  
PROFESSIONAL ENGINEER UNDER THE LAWS OF  
THE STATE OF ILLINOIS.

*Justin Johnson* DATE 4/1/16  
JUSTIN J. JOHNSON, P.E. REG. #062-057973  
ASSISTANT CITY ENGINEER  
LICENSE EXPIRES: NOVEMBER 30, 2016





# LIST OF QUANTITIES

| Item No. | Description   | Plan Quantity | Units | Standard Specification Reference | Special Provision Reference | Supplemental Specifications and Recurring Special Provisions | Standard Specifications for Water and Sewer Main Construction in Illinois |
|----------|---|---------------|-------|----------------------------------|-----------------------------|--|---|
| 1        | Portland Cement Concrete, Surface Removal (Cold Milling)              | 6481.2        | SY    | 406 And 440                      | Sp - 11                     |  |   |
| 2        | Pavement Removal  | 772.8         | SY    | 440                              | Sp - 12                     |  |   |
| 3        | Earth Excavation  | 132.0         | CY    | 202                              | Sp - 10                     |  |   |
| 4        | Geotechnical Fabric For Ground Stabilization                          | 772.8         | SY    | 210                              | Sp - 17                     |  |   |
| 5        | Aggregate Base Course, Type A   | 215.0         | Ton   | 351                              | Sp - 22                     |  |   |
| 6        | Portland Cement Concrete Pavement, (Jointed), 7" (With Integral Curb) | 772.8         | SY    | 420                              | Sp - 13                     |  |   |
| 7        | Combination Curb And Gutter Removal                                   | 394.5         | FT.   | 406                              | Sp - 14                     |  |   |
| 8        | Combination Concrete Curb And Gutter, Type M-6.18 (Modified)          | 394.5         | FT.   | 443                              | Sp - 15                     |  |   |
| 9        | Mixture For Cracks, Joints, And Flangeways                            | 8.0           | Ton   | 406                              | Sp - 20                     |  |   |
| 10       | Area Reflective Crack Control Treatment                               | 6481.2        | SY    | 406                              | Sp - 21                     |  |   |
| 11       | Hot-Mix Asphalt Binder Course, IL-9.5, N50, 1-1/2"                    | 550.0         | Ton   | 440                              | Sp - 18                     |  |   |
| 12       | Hot-Mix Asphalt Surface Course, IL-9.5, N50, 1-1/2"                   | 550.0         | Ton   | 440                              | Sp - 19                     |  |   |
| 13       | Driveway Pavement Removal   | 139.8         | SY    | 424                              | Sp - 16                     |  |   |
| 14       | Portland Cement Concrete Residential Driveway, 6"                     | 139.8         | SY    | 440                              | Sp - 23                     |  |   |
| 15       | Portland Cement Concrete, Pedestrian Curb Ramp, 6"                    | 524.6         | SF    | 424                              | Sp - 26                     |  |   |
| 16       | Sidewalk Removal  | 2960.2        | SF    | 602                              | Sp - 24                     |  |   |
| 17       | Portland Cement Concrete Sidewalk, 4"                                 | 2534.1        | SF    | 602                              | Sp - 25                     |  |   |
| 18       | Catch Basin Single to be Adjusted with Type C Gate                    | 1.0           | Each  | 602                              | Sp - 27                     |  |   |
| 19       | Catch Basin Double to be Adjusted with Type C Gate                    | 1.0           | Each  | 252                              | Sp - 27                     |  |   |
| 20       | Catch Basin Single to be Adjusted                                     | 1.0           | Each  | 720                              | Sp - 28                     |  |   |
| 21       | Catch Basin Double to be Adjusted                                     | 1.0           | Each  | 701                              | Sp - 28                     |  |   |
| 22       | Manholes To Be Adjusted With New Frame and Lid                        | 4             | Each  | 440                              | Sp - 29                     |  |   |
| 23       | Manholes To Be Adjusted   | 3             | Each  | 424                              | Sp - 30                     |  |   |
| 24       | Water Manhole to be Removed   | 3             | Each  | 602                              | Sp - 33                     |  |   |
| 25       | Gate Valve and Box To Be Adjusted                                     | 7             | Each  | 602                              | Sp - 31                     |  |   |
| 26       | Domestic Water Valve to be Adjusted                                   | 5             | Each  | 602                              | Sp - 32                     |  |   |
| 27       | Sodding   | 700.0         | SY    | 252                              | Sp - 34                     |  |   |
| 28       | Project Signs   | 2             | Each  | 720                              | Sp - 35                     |  |   |
| 29       | Traffic Control And Protection  | 1.0           | LS    | 701                              | Sp - 36                     |  |   |

| LEGEND |   |
|--------|---|
|        | SURVEY CONTROL POINT                                    |
|        | TREE  |
|        | FIRE HYDRANT  |
|        | WATER VALVE   |
|        | DOMESTIC WATER VALVE                                    |
|        | GAS VALVE   |
|        | STORM MANHOLE   |
|        | SANITARY MANHOLE  |
|        | WATER MANHOLE   |
|        | TELEPHONE MANHOLE                                       |
|        | POWER POLE  |
|        | STREET LIGHT  |
|        | SIGN  |
|        | SINGLE CATCH BASIN                                      |
|        | DOUBLE CATCH BASIN                                      |
|        | PROPOSED PORTLAND CONCRETE SURFACE REMOVAL, 3"          |
|        | PROPOSED HOT-MIX ASPHALT, 3"                            |
|        | PROPOSED AREA REFLECTIVE CRACK CONTROL TREATMENT        |
|        | PROPOSED PAVEMENT REMOVAL & REPLACEMENT, 7"             |
|        | PROPOSED SIDEWALK REMOVAL & REPLACEMENT, 4"             |
|        | PROPOSED PEDESTRIAN CURB RAMP REMOVAL & REPLACEMENT, 6" |
|        | PROPOSED DRIVEWAY REMOVAL & REPLACEMENT, 6"             |
|        | EXISTING WATER MAIN, SIZE VARIES                        |
|        | EXISTING GAS MAIN                                       |
|        | EXISTING STORM SEWER                                    |
|        | EXISTING SANITARY SEWER                                 |
|        | EXISTING R.O.W. LINE                                    |

| Pedestrian Curb Ramp Standards Schedule |                    |                    |              |           |               |
|---|--------------------|--------------------|--------------|-----------|---------------|
| NO.                                     | Location           |                    |              |           |               |
|   | From               | To                 | Quantity     | Units     | IDOT Standard |
| 1                                       | 0+25.37, 18.5' Rt  | 0+35.61, 17.6' Rt  | 36.1         | SF        | 424006-01     |
| 2                                       | 0+30.38, 20.9' Lt  | 0+39.06, 18.3' Lt  | 30           | SF        | 424006-01     |
| 3                                       | 0+76.01, 17.2' Rt  | 0+89.33, 12.8' Rt  | 41.3         | SF        | 424001-07     |
| 4                                       | 0+76.41, 21.6' Lt  | 0+84.54, 23.2' Lt  | 35.9         | SF        | 424006-01     |
| 5                                       | 7+55.72, 12.5' Rt  | 7+69.67, 18.6' Rt  | 45.8         | SF        | 424001-07     |
| 6                                       | 8+07.60, 19.9' Rt  | 8+19.48, 13.1' Rt  | 36.2         | SF        | 424001-07     |
| 7                                       | 9+72.89, 20.4' Lt  | 9+80.83, 27.1' Lt  | 54.6         | SF        | 424011-01     |
| 8                                       | 11+99.78, 20.5' Lt | 12+12.34, 26.8' Lt | 84.5         | SF        | 424016-01     |
| 9                                       | 15+89.47, 20.8' Lt | 15+96.34, 25.9' Lt | 36.6         | SF        | 424016-01     |
| 10                                      | 18+07.01, 20.5' Lt | 18+20.28, 29.7' Lt | 123.4        | SF        | 424016-01     |
|   |                    |                    | <b>524.4</b> | <b>SF</b> |               |

QUANTITIES, LEGEND AND PEDESTRIAN CURB RAMP STANDARDS SCHEDULE

|   |                            |       |           |
|---|----------------------------|-------|-----------|
| <b>CITY OF ROCK ISLAND<br/>ENGINEERING DIVISION</b>   |                            |       |           |
| 25th Avenue Resurfacing<br>12th Street to 17th Street |                            |       |           |
| Job Number  | 2770                       | Date  | 3/10/2016 |
| Computer Drawing Name                                 | Spw/eng/jobs/2730/ACAD.dwg | By    | CAM       |
|   |                            | Sheet | 2         |
|   |                            | Of    | 7         |



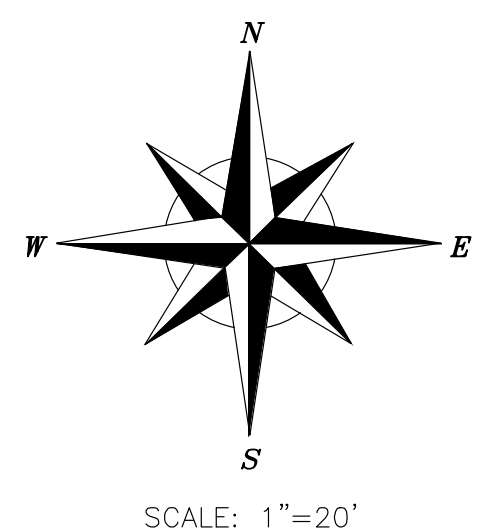
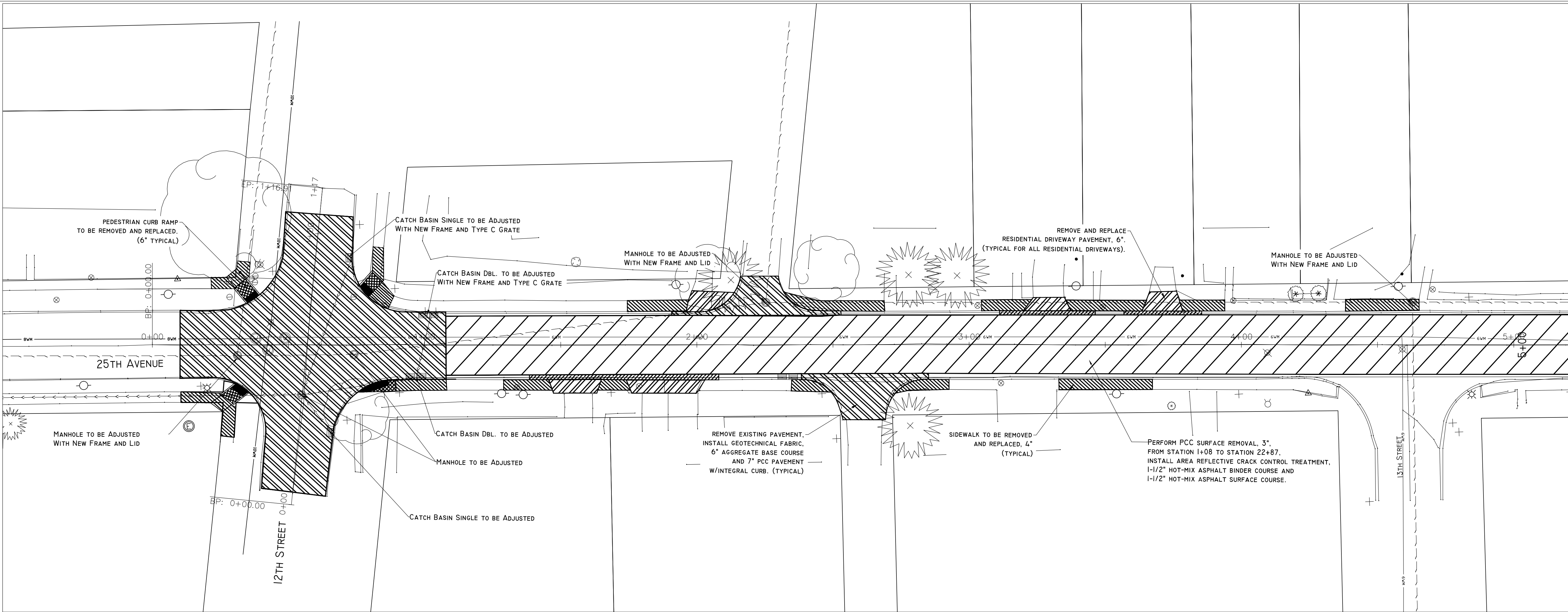

UTILITY NOTE:  
THE LOCATIONS OF BURIED AND ABOVE GROUND UTILITIES SHOWN ARE APPROXIMATE, ARE SHOWN FOR CONTRACTOR INFORMATION USE ONLY, AND ARE NOT TO BE REFERENCED FOR CONSTRUCTION PURPOSES. THE IMPLIED PRESENCE OR ABSENCE OF UTILITIES IS NOT TO BE CONTROLLED BY THE OWNER, ENGINEER, CONTRACTOR, OR SUBCONTRACTORS TO BE AN ACCURATE AND COMPLETE REPRESENTATION OF UTILITIES THAT MAY OR MAY NOT EXIST ON THE CONSTRUCTION SITE. BURIED AND ABOVE GROUND UTILITY LOCATION, IDENTIFICATION, AND MARKING IS THE SOLE RESPONSIBILITY OF THE CONTRACTOR. REROUTING, DISCONNECTION, PROTECTION, ETC. OF ANY UTILITY MUST BE COORDINATED BETWEEN THE CONTRACTOR, UTILITY COMPANY, AND OWNER. SITE SAFETY, INCLUDING THE AVOIDANCE OF HAZARDS ASSOCIATED WITH BURIED AND ABOVE GROUND UTILITIES, REMAINS THE SOLE RESPONSIBILITY OF THE CONTRACTOR.

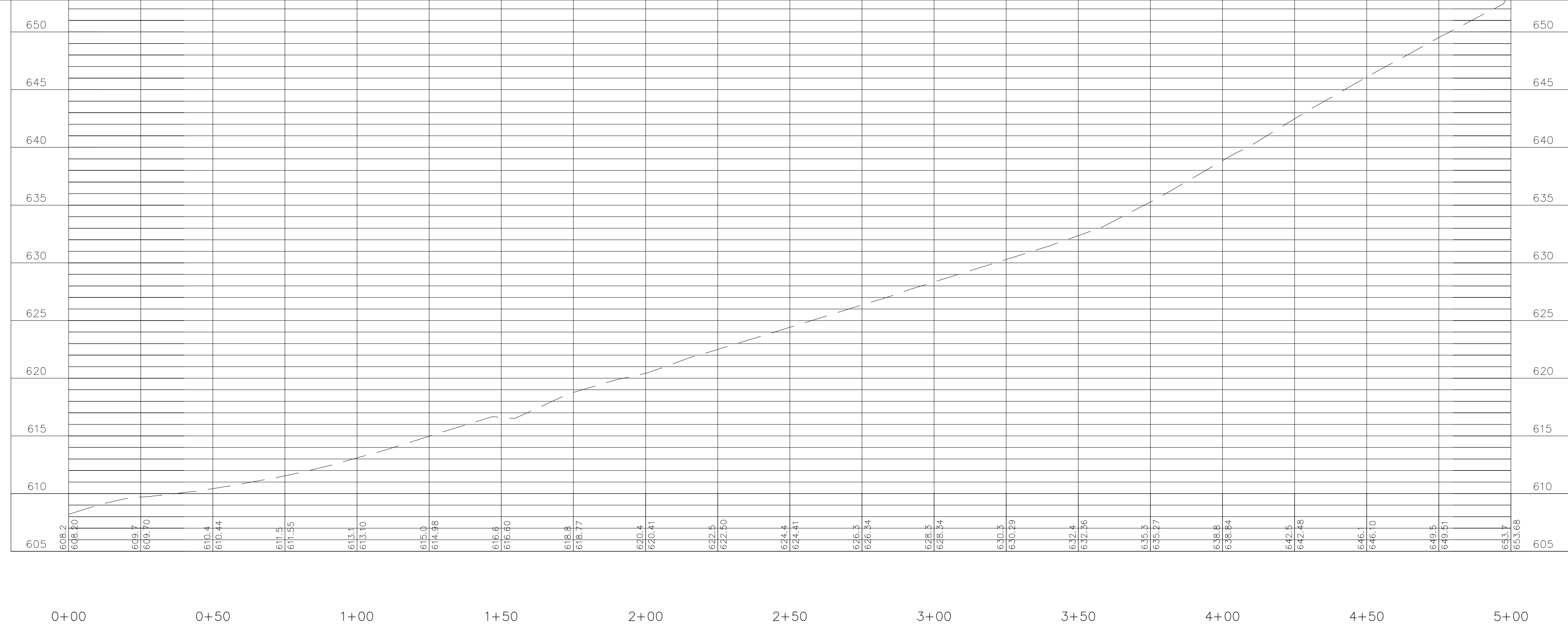

**CITY OF ROCK ISLAND**  
ENGINEERING DIVISION  
25th Avenue Resurfacing  
12th to 17th Streets

Job Number: 2770  
Date: 3/11/2016  
Computer Drawing Name: 2770/dwg  
By: CAM  
Sheet: 4  
of: 8

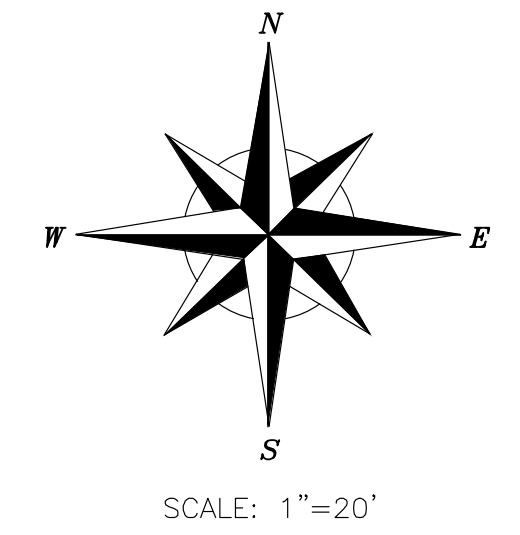
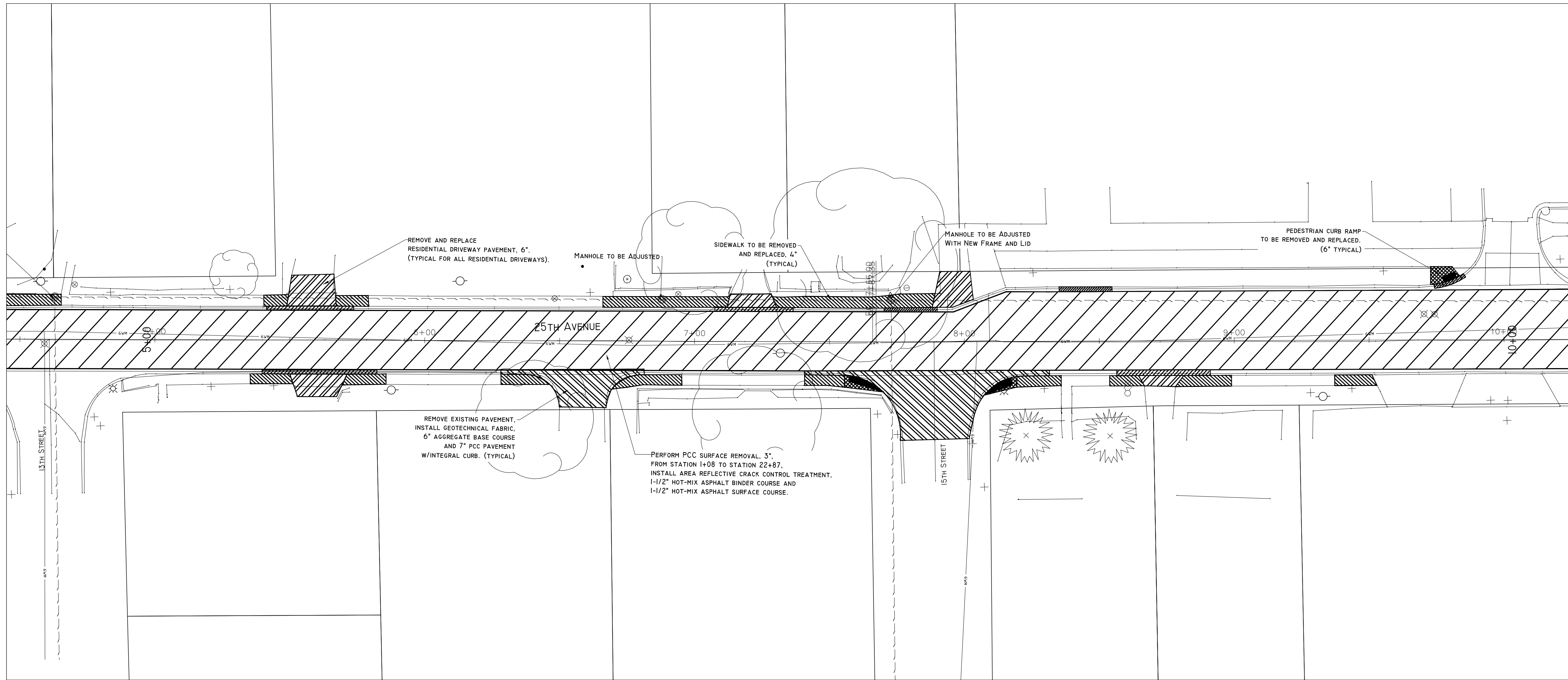

UTILITY NOTE:  
 THE LOCATIONS OF BURIED AND ABOVE GROUND UTILITIES SHOWN ARE APPROXIMATE. ARE SHOWN FOR CONTRACTOR INFORMATION USE ONLY, AND ARE NOT TO BE REFERENCED FOR CONSTRUCTION PURPOSES. THE IMPLIED PRESENCE OR ABSENCE OF UTILITIES IS NOT TO BE CONTRIBUED BY THE OWNER, ENGINEER, CONTRACTOR, OR SUBCONTRACTORS TO BE AN ACCURATE AND COMPLETE REPRESENTATION OF UTILITIES THAT MAY OR MAY NOT EXIST ON THE CONSTRUCTION SITE. BURIED AND ABOVE GROUND UTILITY LOCATION, IDENTIFICATION, AND MARKING IS THE SOLE RESPONSIBILITY OF THE CONTRACTOR. REROUTING, DISCONNECTION, PROTECTION, ETC. OF ANY UTILITY MUST BE COORDINATED BETWEEN THE CONTRACTOR, UTILITY COMPANY, AND OWNER. SITE SAFETY, INCLUDING THE AVOIDANCE OF HAZARDS ASSOCIATED WITH BURIED AND ABOVE GROUND UTILITIES, REMAINS THE SOLE RESPONSIBILITY OF THE CONTRACTOR.

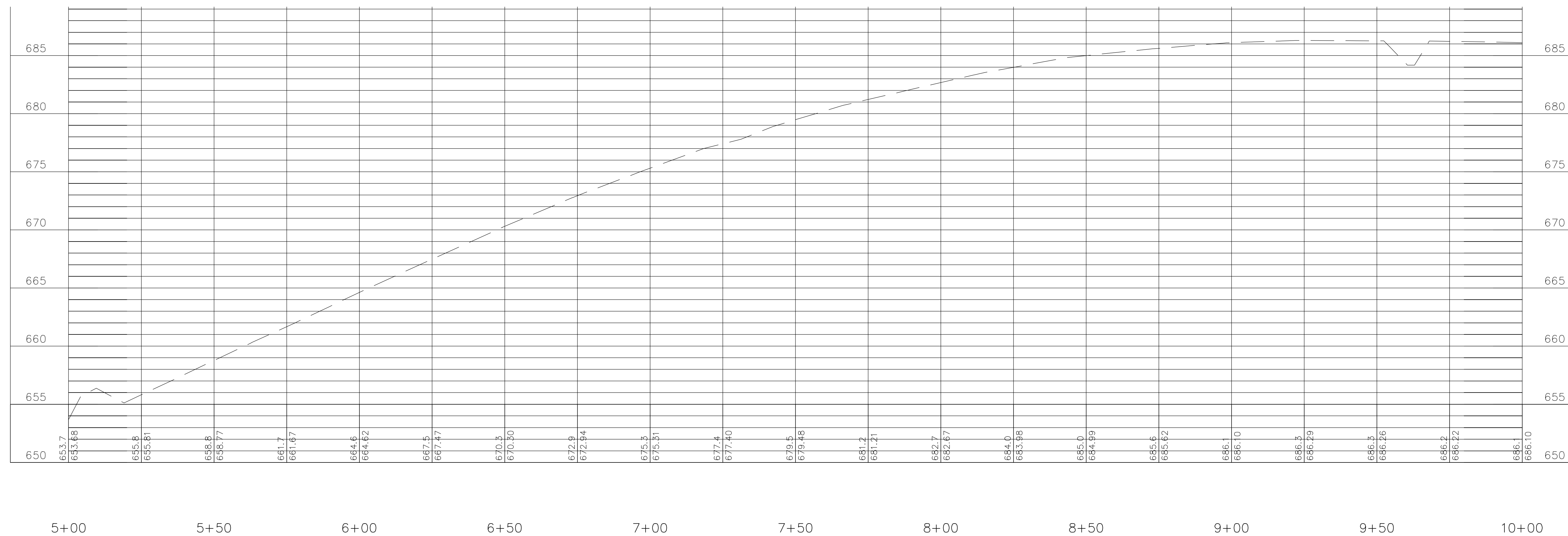

**CITY OF ROCK ISLAND**  
**ENGINEERING DIVISION**  
**25th Avenue Resurfacing**  
 12th to 17th Streets

|                       |          |       |           |
|-----------------------|----------|-------|-----------|
| Job Number            | 2770     | Date  | 3/11/2016 |
| Computer Drawing Name | 2270/dwg | By    | CAM       |
|                       |          | Sheet | 5         |
|                       |          | Of    | 8         |

ROCK ISLAND, ILLINOIS

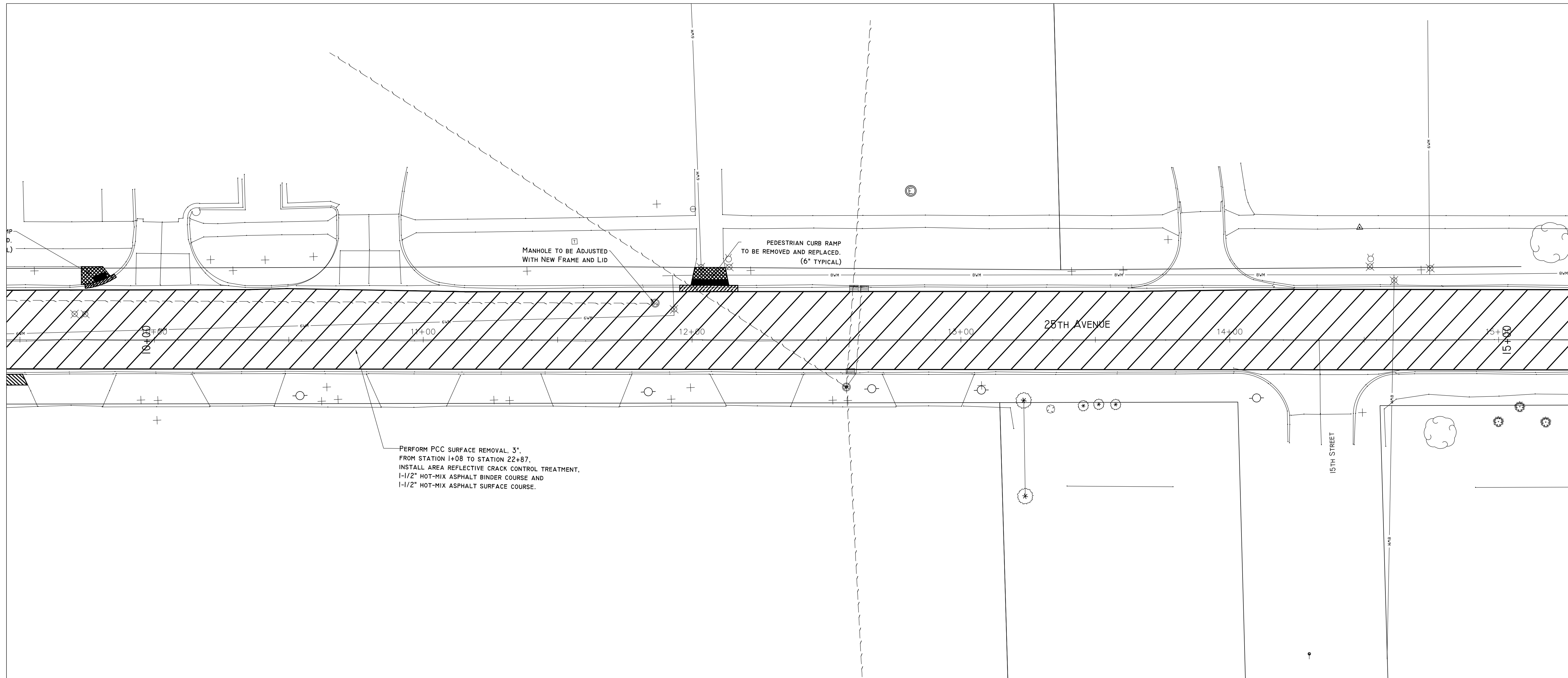

PERFORM PCC SURFACE REMOVAL, 3".  
 FROM STATION 1+08 TO STATION 22+87.  
 INSTALL AREA REFLECTIVE CRACK CONTROL TREATMENT,  
 1-1/2" HOT-MIX ASPHALT BINDER COURSE AND  
 1-1/2" HOT-MIX ASPHALT SURFACE COURSE.

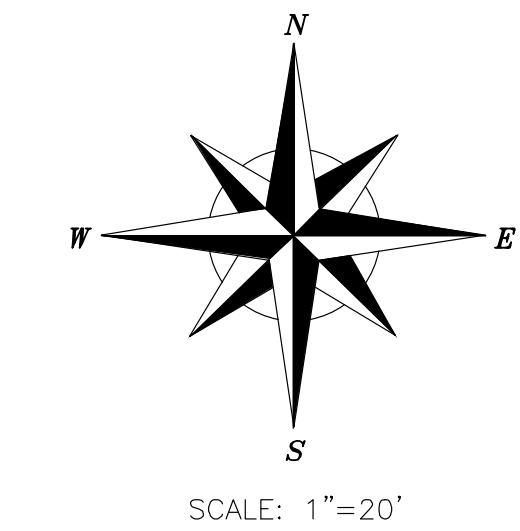

UTILITY NOTE:  
 THE LOCATIONS OF THOSE BURIED AND ABOVE GROUND UTILITIES SHOWN ARE APPROXIMATE, ARE SHOWN FOR CONTRACTOR INFORMATION USE ONLY, AND ARE NOT TO BE REFERENCED FOR CONSTRUCTION PURPOSES. THE IMPLIED PRESENCE OR ABSENCE OF UTILITIES IS NOT TO BE CONFIRMED BY THE OWNER, ENGINEER, CONTRACTOR, OR SUBCONTRACTORS TO BE AN ACCURATE AND COMPLETE REPRESENTATION OF UTILITIES THAT MAY OR MAY NOT EXIST ON THE CONSTRUCTION SITE. BURIED AND ABOVE GROUND UTILITY LOCATION, IDENTIFICATION, AND MARKING IS THE SOLE RESPONSIBILITY OF THE CONTRACTOR. REROUTING, DISCONNECTION, PROTECTION, ETC. OF ANY UTILITY MUST BE COORDINATED BETWEEN THE CONTRACTOR, UTILITY COMPANY, AND OWNER. SITE SAFETY, INCLUDING THE AVOIDANCE OF HAZARDOUS ASSOCIATED WITH BURIED AND ABOVE GROUND UTILITIES, REMAINS THE SOLE RESPONSIBILITY OF THE CONTRACTOR.

# 25th Avenue

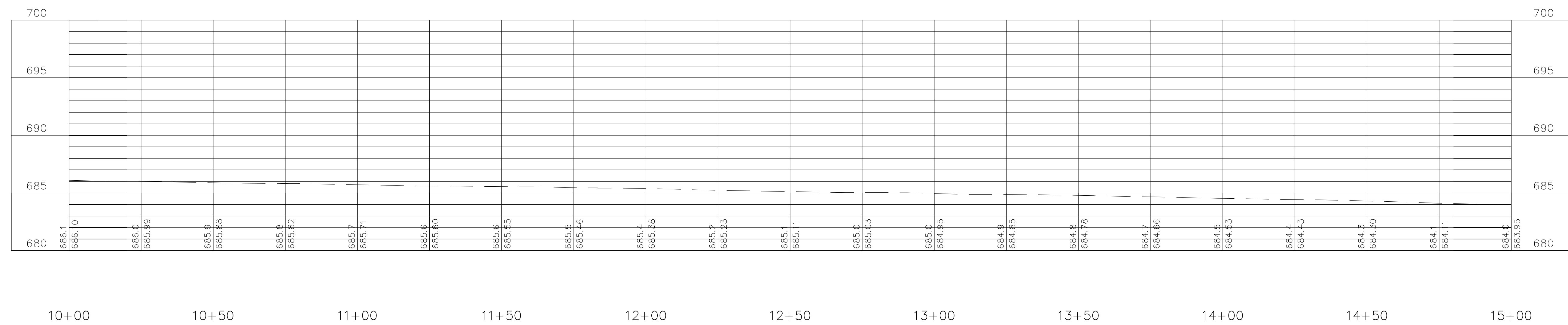

**CITY OF ROCK ISLAND**  
**ENGINEERING DIVISION**  
 25th Avenue Resurfacing  
 12th to 17th Streets

|                                   |                 |
|-----------------------------------|-----------------|
| Job Number<br>2770                | Date<br>3/10/16 |
| Computer Drawing Name<br>2770/dwg | By<br>CAM       |
| Sheet<br>6                        | Of<br>8         |

ROCK ISLAND  
 ILLINOIS

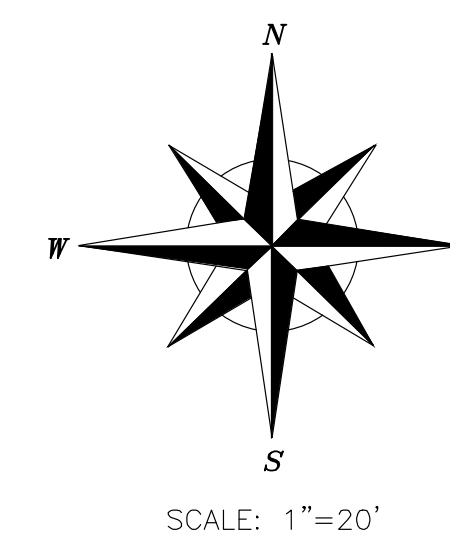
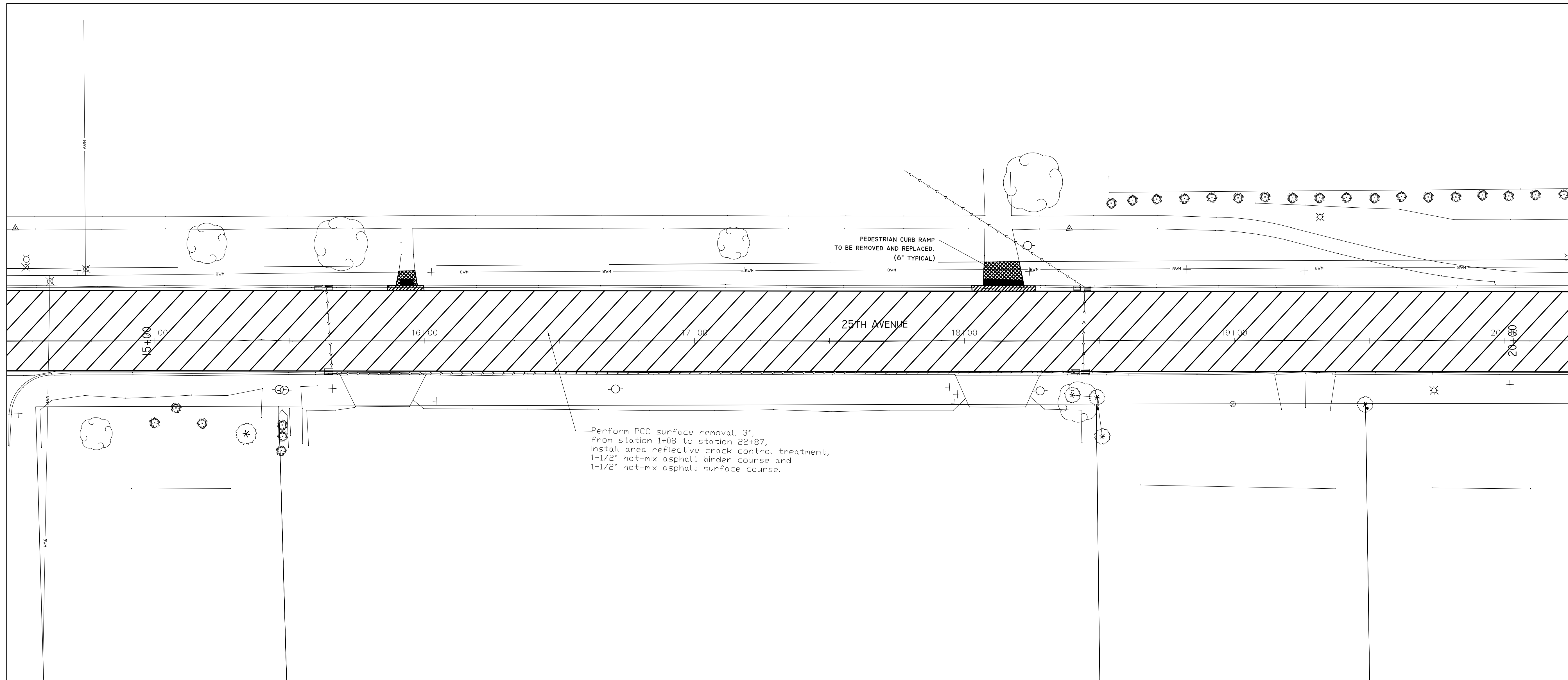

Perform PCC surface removal, 3', from station 1+08 to station 22+87, install area reflective crack control treatment, 1-1/2" hot-mix asphalt binder course and 1-1/2" hot-mix asphalt surface course.

UTILITY NOTE:  
 THE LOCATIONS OF THOSE BURIED AND ABOVE GROUND UTILITIES SHOWN ARE APPROXIMATE, ARE SHOWN FOR CONTRACTOR INFORMATION USE ONLY, AND ARE NOT TO BE REFERENCED FOR CONSTRUCTION PURPOSES. THE IMPLIED PRESENCE OR ABSENCE OF UTILITIES IS NOT TO BE CONTROLLED BY THE OWNER, ENGINEER, CONTRACTOR, OR SUBCONTRACTORS TO BE AN ACCURATE AND COMPLETE REPRESENTATION OF UTILITIES THAT MAY OR MAY NOT EXIST ON THE CONSTRUCTION SITE. BURIED AND ABOVE GROUND UTILITY LOCATION, IDENTIFICATION, AND MARKING IS THE SOLE RESPONSIBILITY OF THE CONTRACTOR. REDUCING, DISCONNECTING, PROTECTING, ETC. OF ANY UTILITY MUST BE COORDINATED BETWEEN THE CONTRACTOR, UTILITY COMPANY, AND OWNER. SITE SAFETY, INCLUDING THE AVOIDANCE OF HAZARDS ASSOCIATED WITH BURIED AND ABOVE GROUND UTILITIES, REMAINS THE SOLE RESPONSIBILITY OF THE CONTRACTOR.

# 25th Avenue

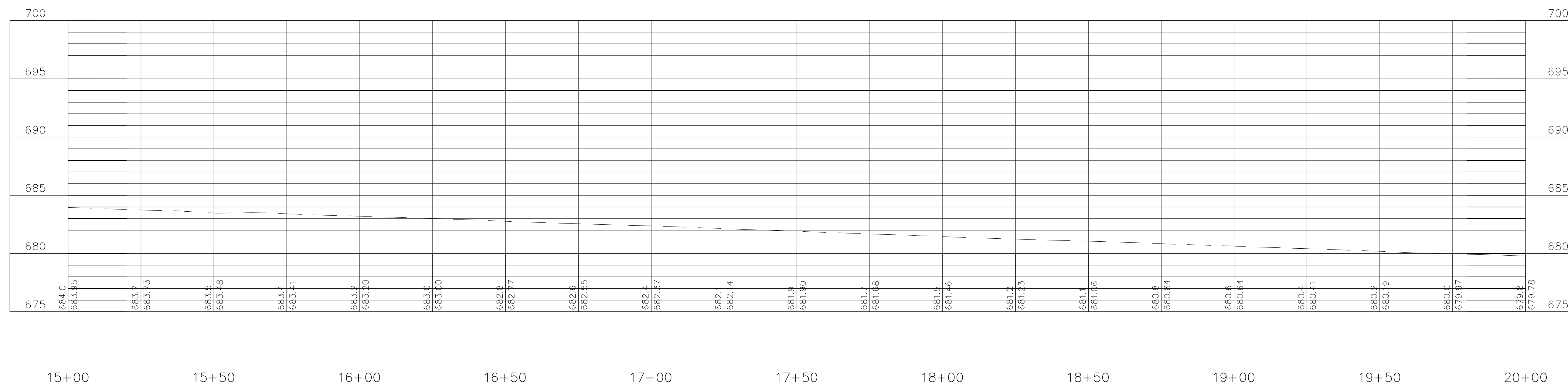

**CITY OF ROCK ISLAND**  
**ENGINEERING DIVISION**  
 25th Avenue Resurfacing  
 12th to 17th Streets

|                       |          |       |         |
|-----------------------|----------|-------|---------|
| Job Number            | 2770     | Date  | 3/10/16 |
| Computer Drawing Name | 2770/dwg | By    | CAM     |
|                       |          | Sheet | 7       |
|                       |          | Of    | 8       |

ROCK ISLAND  
ILLINOIS

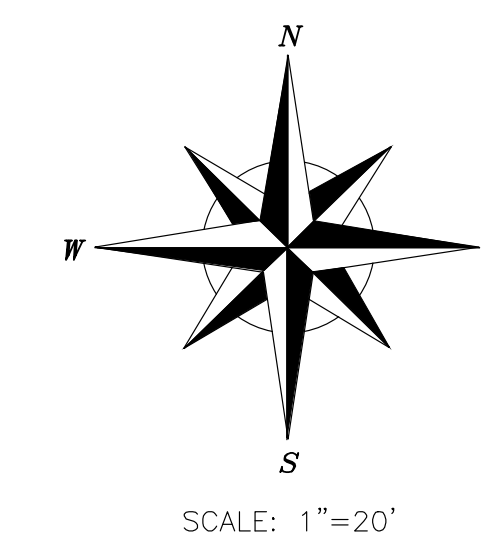
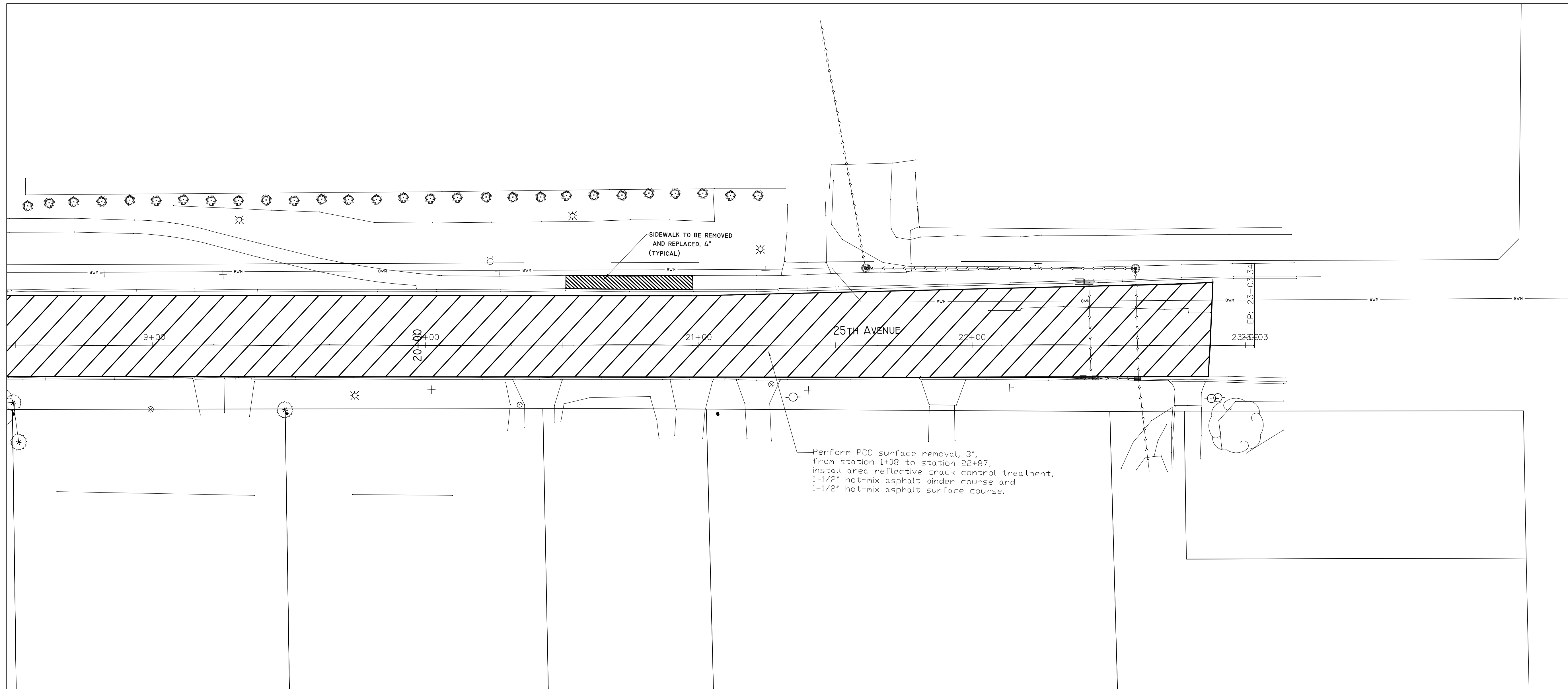

UTILITY NOTE:  
 THE LOCATIONS OF THOSE BURIED AND ABOVE GROUND UTILITIES SHOWN ARE APPROXIMATE, ARE SHOWN FOR CONTRACTOR INFORMATION USE ONLY, AND ARE NOT TO BE REFERENCED FOR CONSTRUCTION PURPOSES. THE IMPLIED PRESENCE OR ABSENCE OF UTILITIES IS NOT TO BE CONSTRUED BY THE OWNER, ENGINEER, CONTRACTOR, OR SUBCONTRACTORS TO BE AN ACCURATE AND COMPLETE REPRESENTATION OF UTILITIES THAT MAY OR MAY NOT EXIST ON THE CONSTRUCTION SITE. BURIED AND ABOVE GROUND UTILITY LOCATION, IDENTIFICATION, AND MARKING IS THE SOLE RESPONSIBILITY OF THE CONTRACTOR. REROUTING, DISCONNECTION, PROTECTION, ETC. OF ANY UTILITY MUST BE COORDINATED BETWEEN THE CONTRACTOR, UTILITY COMPANY, AND OWNER. SITE SAFETY, INCLUDING THE AVOIDANCE OF HAZARDS ASSOCIATED WITH BURIED AND ABOVE GROUND UTILITIES, REMAINS THE SOLE RESPONSIBILITY OF THE CONTRACTOR.

# 25th Avenue

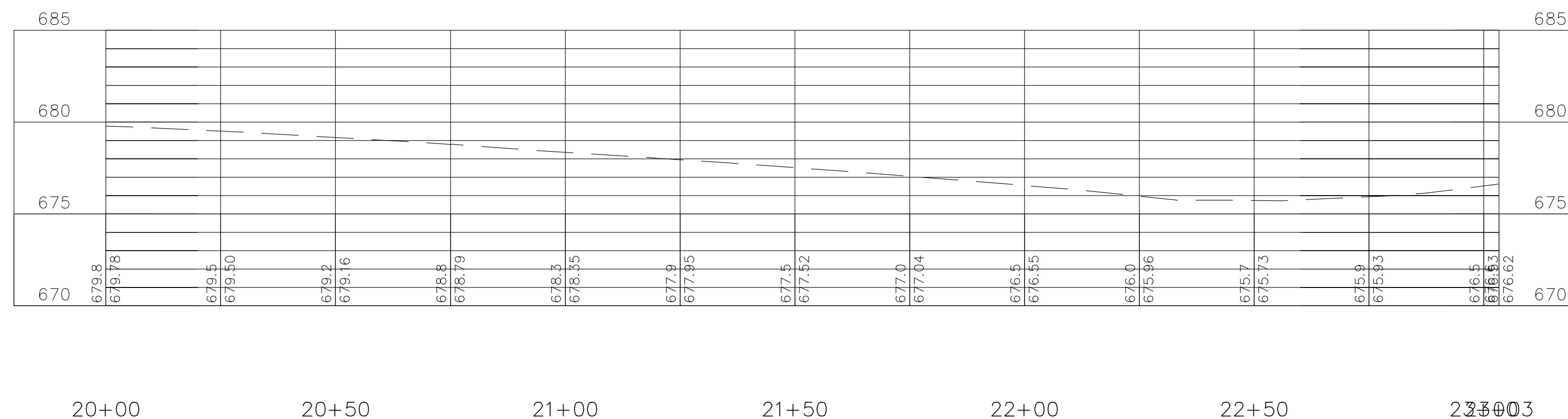

**CITY OF ROCK ISLAND**  
**ENGINEERING DIVISION**  
 25th Avenue Resurfacing  
 12th to 17th Streets

Job Number: 2770  
 Date: 3/10/16  
 By: CAM  
 Computer Drawing Name: 2770/dwg  
 Sheet: 8 of 8  
 ROCK ISLAND ILLINOIS